

SEE NOTE 5

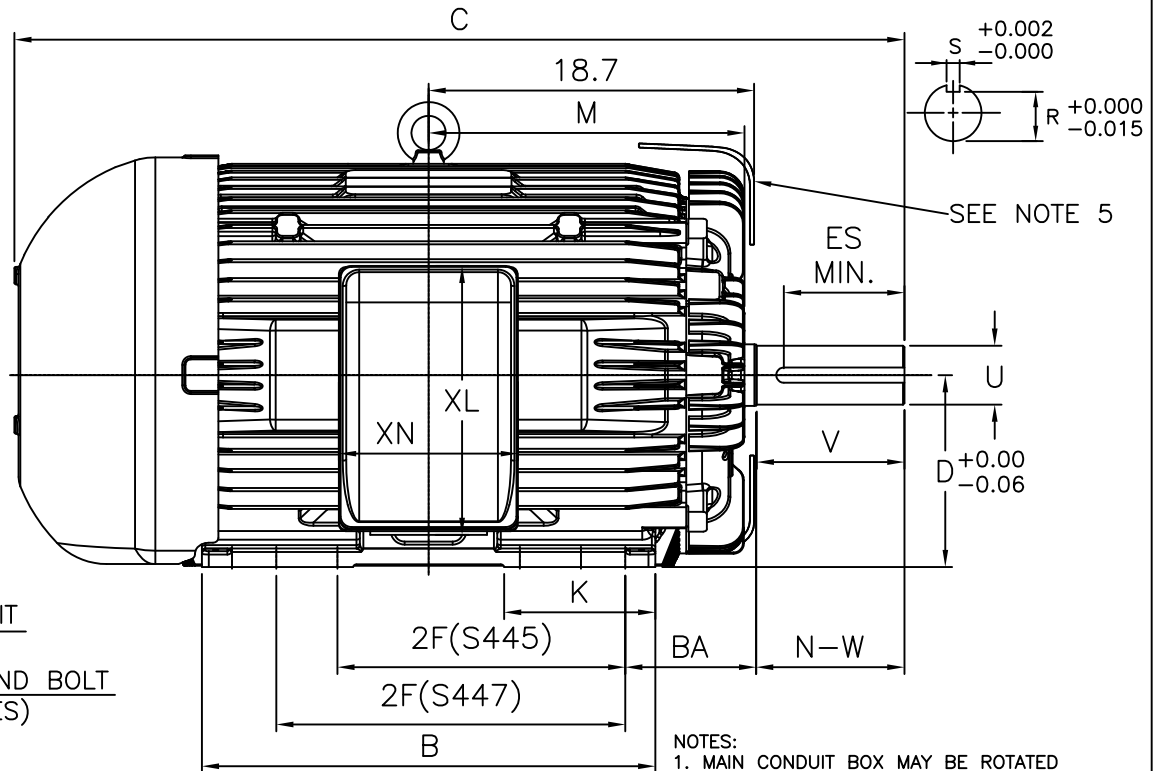
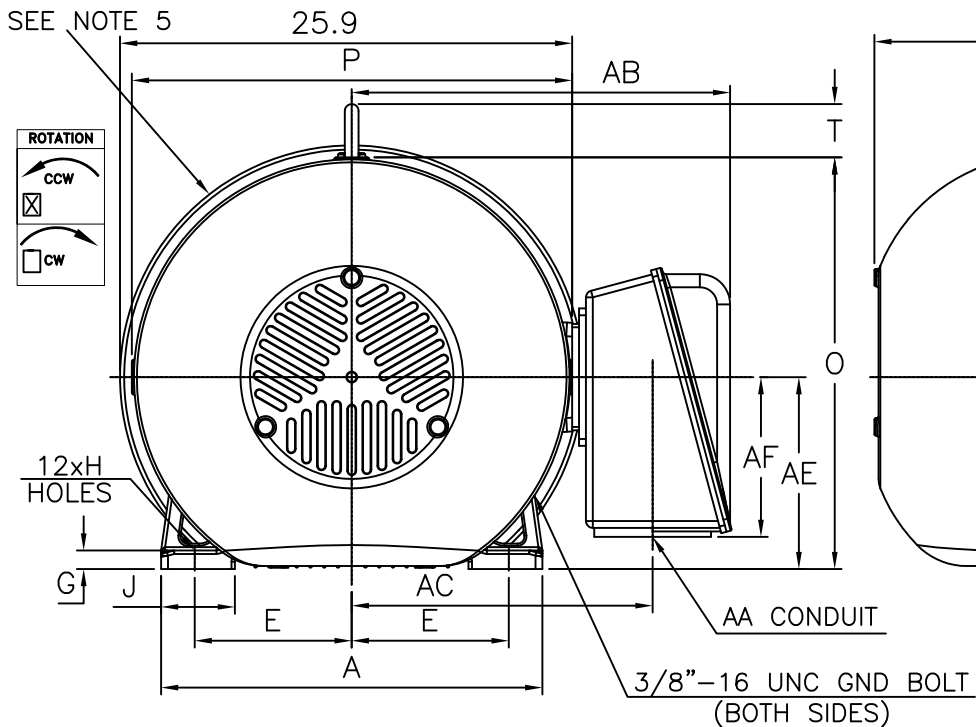

UNITS: INCHES

| FRAME SIZE | MOTOR DIMENSIONS | | | | | | | | | | | CONDUIT BOX | | | | | | | |
|------------|------------------|------|------|-------|------|------|------|------|------|-------|------|-------------|-------|-------|-------|-----|-------|-------|--|
| | A | B | C | D | G | J | K | M | O | P | T | AA[NPT] | AB | AC | AE | AF | XL | XN | |
| S445/7T | 21.85 | 26.0 | 51.0 | 11.00 | 1.06 | 4.23 | 8.67 | 18.1 | 23.6 | 25.24 | 3.05 | 3.00 | 21.69 | 17.24 | 11.00 | 9.2 | 15.42 | 10.26 | |

| FRAME SIZE | MOUNTING | | | SHAFT EXTENSION | | | | KEY SEAT | | | BEARINGS | | | MAXIMUM WEIGHT |
|------------|----------|-------------|-------|-----------------|------|------|-------|----------|-------|------|----------|-----------|--------|----------------|
| | E | 2F | H | BA | N-W | V | U | R | S | ES | LS BALL | LS ROLLER | OS | |
| S445/7T | 9.00 | 20.00/16.50 | 0.812 | 7.50 | 8.50 | 8.46 | 3.375 | 2.88 | 0.875 | 6.91 | 6318C3 | - | 6316C3 | 2500 lbs. |
| S445/7T | 9.00 | 20.00/16.50 | 0.812 | 7.50 | 8.50 | 8.46 | 3.375 | 2.88 | 0.875 | 6.91 | - | NU318C3 | 6316C3 | 2500 lbs. |

NOTES:

1. MAIN CONDUIT BOX MAY BE ROTATED IN 90° INCREMENTS
2. KEY DIMENSIONS EQUAL S x S x 6.88 (MOTOR SUPPLIED WITH KEY)
3. MOTOR WEIGHT SHOWN IS MAXIMUM HORSEPOWER IN FRAME
4. STANDARD PRODUCT USE BI-DIRECTIONAL FAN. OPPOSITE ROTATION AVAILABLE ONLY BY CONNECTION CHANGE
5. AIR DEFLECTOR TO BE USED ON 8P-125HP MOTORS.

CUSTOMER: _____ MOTOR MODEL NO.: _____

P.O. NO.: _____ HP: _____ VOLTAGE: _____ RPM(SYN.): _____ Hz: _____

FRAME SIZE: _____ PRODUCT TYPE: EQP III / EQP III 841

COMMENTS: _____

PER: _____ DATE: _____

TAG NO's.: _____

- STANDARD (NO AUX. BOXES)
 RTD AUX. BOX
 SPACE HEATER AUX. BOX
 BEARING RTD's

TOSHIBA RESERVES THE RIGHT TO MAKE CHANGES OF TECHNICAL IMPROVEMENT AND THE DATA MAY CHANGE WITHOUT NOTICE PRELIMINARYDO NOT USE FOR CONSTRUCTION, INSTALLATION, OR APPLICATION PURPOSES UNLESS THE DRAWING IS MARKED AS CERTIFIED CERTIFIED**TOSHIBA**

TOSHIBA INTERNATIONAL CORPORATION

TOTALLY-ENCLOSED FAN-COOLED
 HORIZONTAL FOOT-MOUNTED
 3 PHASE INDUCTION MOTOR
 F1 ASSEMBLY

XT SERIES

VISIT OUR WEBSITE AT:
www.toshiba.com/ind

MDSL0031-64 R01

TYPICAL MOTOR PERFORMANCE DATA

Model: 1258XDSC41A

| | | | | | | | | |
|-----------|----|------------|--------|-------|----------------|-------------|----------|--------------|
| HP | kW | Pole | FL RPM | Frame | Voltage | Hz | Phase | FL Amps |
| 125 | 90 | 8 | 890 | S447T | 575 | 60 | 3 | 123 |
| Enclosure | IP | Ins. Class | S.F. | Duty | NEMA Nom. Eff. | NEMA Design | kVA Code | Ambient (°C) |
| TEFC | 56 | F | 1.15 | CONT | 94.5 | B | | 40 C |

| | | | | | |
|--------------|--------|------|---------|----------------|------------------|
| Load | HP | kW | Amperes | Efficiency (%) | Power Factor (%) |
| Full Load | 125.00 | 93.2 | 122 | 94.9 | 80.5 |
| ¾ Load | 93.75 | 69.9 | 94 | 94.4 | 78.4 |
| ½ Load | 62.50 | 46.6 | 70 | 92.9 | 72.0 |
| ¼ Load | 31.25 | 23.3 | 50 | 87.7 | 53.3 |
| No Load | | | 39.2 | | 3.6 |
| Locked Rotor | | | 668 | | 22.4 |

| | | | | |
|-------------------|----------------------|-----------------|--------------------|----------------------------|
| Torque | | | | Rotor wk² Inertia (lb-ft²) |
| Full Load (lb-ft) | Locked Rotor (% FLT) | Pull Up (% FLT) | Break Down (% FLT) | |
| 738 | 125 | 105 | 215 | 136.36 |

| | | | | | |
|--------------------|-----|---------------------------|-----------|--------|----------------------------|
| Safe Stall Time(s) | | Sound Pressure dB(A) @ 1M | Bearings* | | Approx. Motor Weight (lbs) |
| Cold | Hot | | DE | NDE | |
| 35 | 15 | 84.8 | 6318C3 | 6316C3 | |

*Bearings are the only recommended spare part(s).

Motor Options:
Mounting:Footed,Shaft:T Shaft

| | |
|-------------|--|
| Customer | |
| Customer PO | |
| Sales Order | |
| Project # | |

Tag:

All characteristics are average expected values.

TOSHIBA INTERNATIONAL CORPORATION · HOUSTON, TEXAS U.S.A.

| | | | | | |
|-------------|------------|------------------|-------------|-------------|---------------|
| Engineering | SSuryani | Doc. Written By | D. Suarez | Doc.# / Rev | MPCF-1119 / 0 |
| Engr. Date | 12/19/2019 | Doc. Approved By | M. Campbell | Doc. Issued | 6/8/2011 |

SPEED TORQUE/CURRENT CURVE

Model: 1258XDSC41A

| | | | | | | | | |
|-------------------|---|-------------------|------------------|-------------|----------------|-------------|----------|----------------|
| HP | kW | Pole | FL RPM | Frame | Voltage | Hz | Phase | FL Amps |
| 125 | 90 | 8 | 890 | S447T | 575 | 60 | 3 | 123 |
| Enclosure | IP | Ins. Class | S.F. | Duty | NEMA Nom. Eff. | NEMA Design | kVA Code | Ambient (°C) |
| TEFC | 56 | F | 1.15 | CONT | 94.5 | B | | 40 C |
| Locked Rotor Amps | Rotor wk ² Inertia (lb-ft ²) | Torque | | | | | | Break Down (%) |
| | | Full Load (lb-ft) | Locked Rotor (%) | Pull Up (%) | | | | |
| 668 | 136.36 | 738 | 125 | 105 | | | 215 | |

Design Values

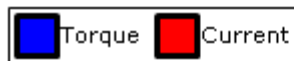
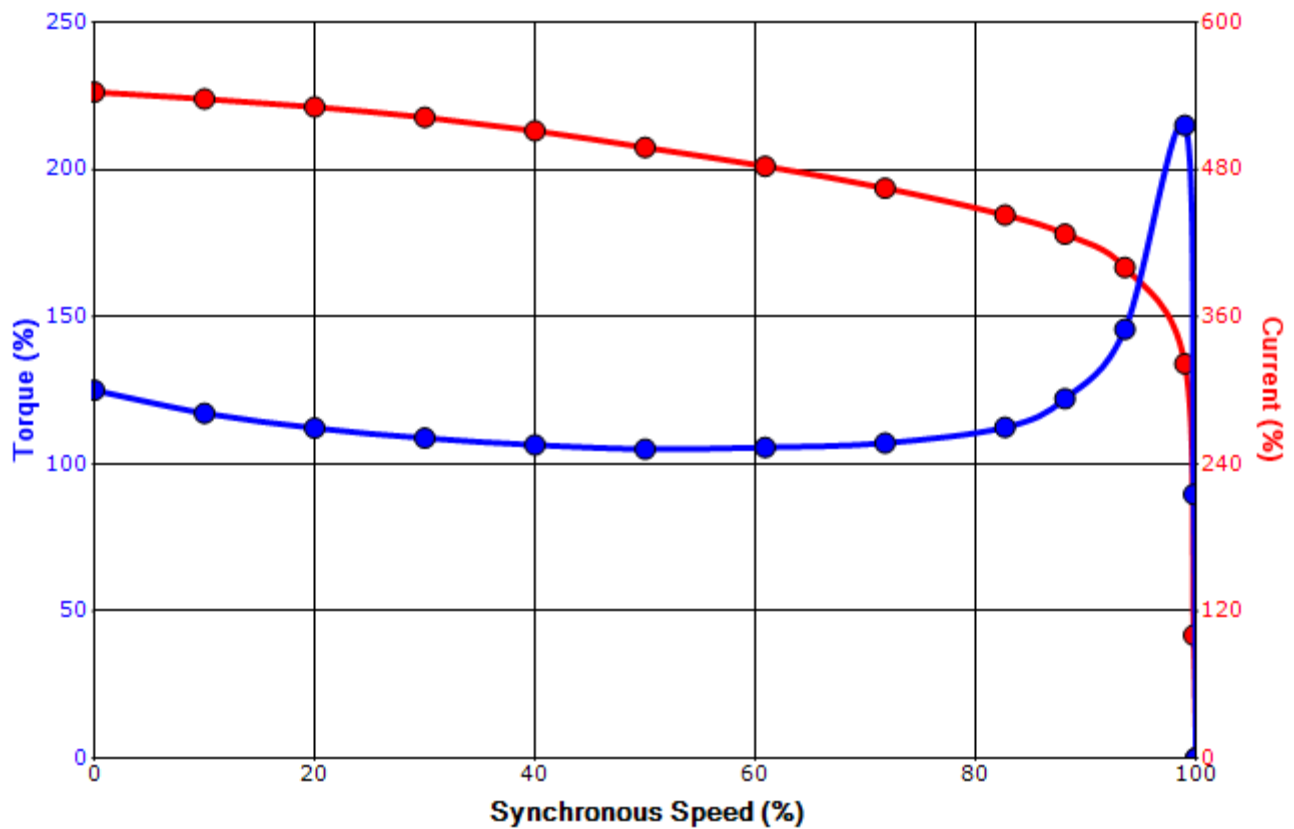

| | | | |
|-------------|--|--|-----|
| Customer | | wk ² Load Inertia (lb-ft ²) | - |
| Customer PO | | Load Type | - |
| Sales Order | | Voltage (%) | 100 |
| Project # | | Accel. Time | - |

Tag:

All characteristics are average expected values.

TOSHIBA INTERNATIONAL CORPORATION · HOUSTON, TEXAS U.S.A.

| | | | | | |
|-------------|------------|------------------|-------------|-------------|---------------|
| Engineering | SSuryani | Doc. Written By | D. Suarez | Doc.# / Rev | MPCF-1121 / 0 |
| Engr. Date | 12/19/2019 | Doc. Approved By | M. Campbell | Doc. Issued | 6/8/2011 |

Motor Connection Diagram
3 Leads - Delta Connection



Switch L1 and L2 to reverse rotation

Each lead may consist of more than one cable.
If multiple cables represent a single lead, each one of them will be labeled with the appropriate lead number.