

Data sheet for three-phase Squirrel-Cage-Motors SIMOTICS

Motor type: **GP100** FS: **364TS - 2p - 60 hp -**

Client order no.	Item-No.	Offer no.
Order no.	Consignment no.	Project
Remarks		

Electrical data

U [V]	Δ / Y	f [Hz]	P [HP]	P [kW]	n [rpm]	I Load [Amps]					LRC	Nom. Eff Load [%]			Pwr. Factor Load [%]			Torque [lb-ft]	T _A /T _N LRT [%]	T _k /T _N BDT [%]
						4/4	3/4	1/2	0	4/4		3/4	2/4	4/4	3/4	2/4				
460	Δ	60	60.00	45.00	3,600	68.00	52.10	37.40	19.00	435.0	93.6	94.1	93.8	88.0	86.0	80.0	89.0	160	249	
230	$\Delta \Delta$	60	60.00	45.00	3,600	136.00	104.13	74.87	38.00	870.0	93.6	94.1	93.8	88.0	86.0	80.0	89.0	160	249	
400	Δ	50	50.00		2,976	62.51	47.78	34.26	18.67	455.1	93.7	94.0	93.6	90.2	88.2	82.3	88.2	160	316	
200	$\Delta \Delta$	50	50.00		2,976	125.02	95.56	68.52	37.34	910.1	93.7	94.0	93.6	90.2	88.2	82.3	88.2	160	316	

Frame Type: 364TS	Type of constr.: (A) Foot mounted - End shield	Ins. Cl.: Standard Class F Insulation	Motor Prot.: (A) Without Protection	NEMA Des.: B	S.F.: 1.15
Mtr. WT: 780		Temp. Rise Cl.: B	Amb. Temp.: + 40 to -20 °C @1000 m	kVA: G	IP 54

Mechanical data

Sound level (SPL / SWL) at 60 Hz	87.0 dB(A) / 98.0 dB(A)	Thickener	Polyurea						
Octave Band Center Frequencies Hertz		Safe Stall Time Hot	16 s						
250	500	1000	2000	4000	8000	Hz	Safe Stall Time Cold	28 s	
SPL@3	74.0	77.0	82.0	83.0	77.0	67.0	dB(A)	Frame material	cast iron
Moment of inertia	8.7 Lb-ft ²		Color, paint shade	Standard Paint - RAL7030					
Ext Load Inertia Capability:	58.0 Lb ft ²		Coating (paint finish)	Standard Alkyed + Epoxy (C2)					
Bearings			Ventilation Type						
Bearing DE NDE	6314 Z C3 S0	6214 ZZ C3 S0	Method of cooling	TEFC					
Bearing_Type	Ball Bearing	Ball Bearing	Direction of rotation	Bidirectional					
AFBMA:	70BC03JP30	70BC02JPP30	Fan Material	Polypropylen ESD					
Grease			VFD	CT: 4:1 VT: 20:1					
Capacity	7.5 oz	6.7 oz	Space heaters	without					
Grease Type:	Exxon Mobile EM		Brake:	without					

Terminal box

Lead Wire Connection	9 LEAD - DELTA	Terminal box position	(3) F-1, Standard Floor Mount, T. Box LHS
Voltage	L1 L1 L1 Connected together	Material of terminal box	Stamped Steel
LOW	T1 T7 T6 T2 T8 T4 T3 T9 T5 ---	Cable entry	3" NPT
HIGH	T1 T2 T3 T4 T7-T5 T8-T6 T9		

Notes:

I_L/I_N = locked rotor current / current nominal
 M_L/M_N = locked rotor torque / torque nominal
 M_b/M_N = break down torque / nominal torque
 3) Value is valid only for DOL operation with motor design IC411
 2) at rated power / at full load

responsible dep. DI MC LVM	technical reference	created by DT Configurator	approved by	<i>Technical data are subject to change! There may be discrepancies between software and hardware versions</i>	
	document type datasheet	document status released	customer		
	title 1LE2221-3DA11-6AA3	document number	rev. 01	creation date 2022-04-08 21:54	language en
© Siemens AG 2022					

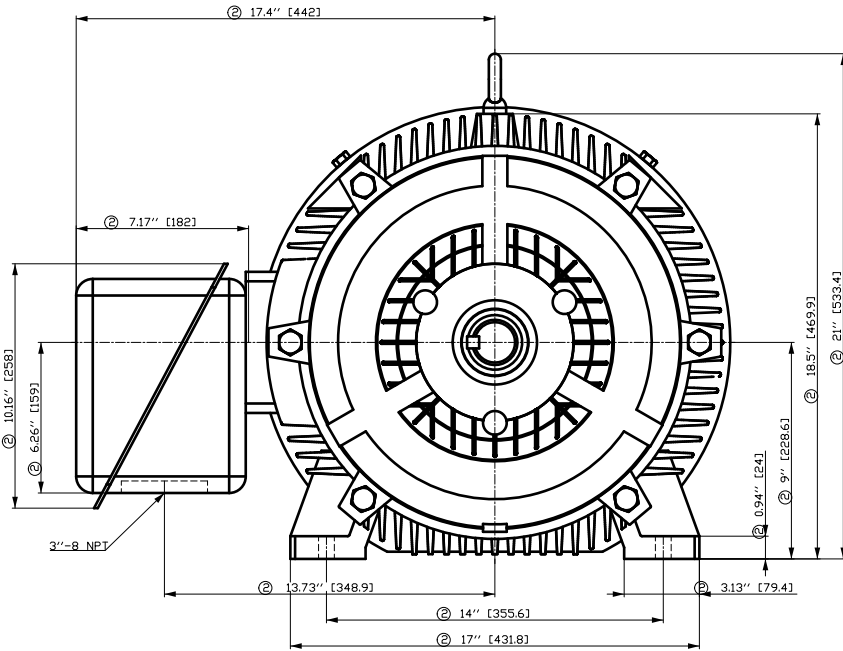

- ① Tolerances according to NEMA std.
- ② All these dimensions corresponding to assemblies and castings shall have a tolerance as per DIN standard 1686-GTB 19.
- ③ Not according to NEMA std.

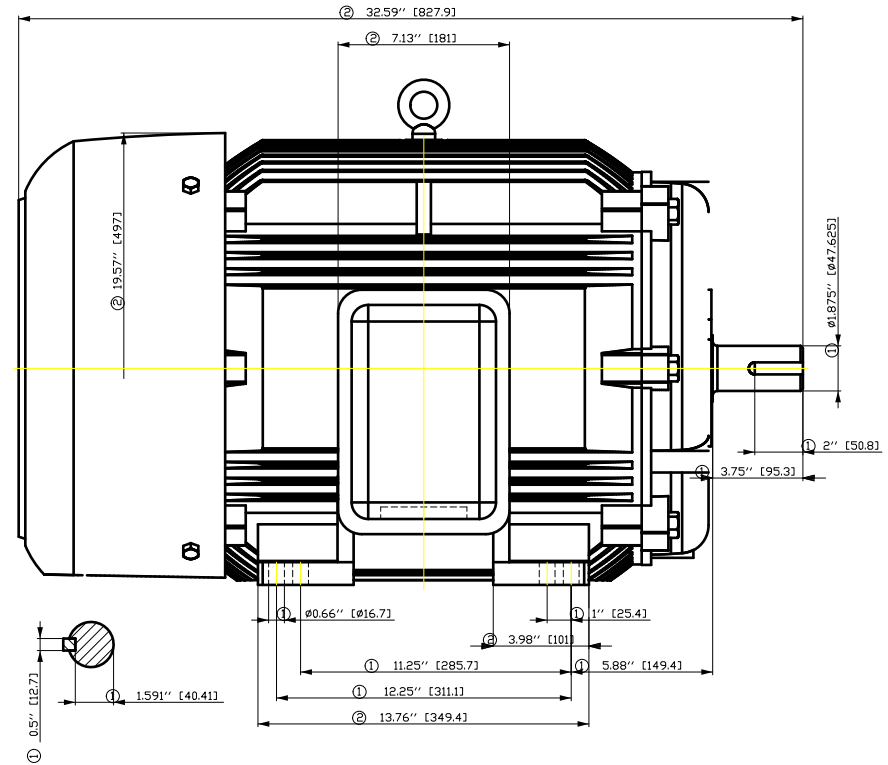

Tolerance	Surface	Material	Weight	Scale
F50GGF-HÖEFFE OEH	Author	ÖS	1.875" [47.625]	1:1
E	Creator	T a : ^ @ ~ } *		
	Approval			
	Department			
	Change Order	MLFB		
	Doc. State	I ð BGG		
	Revision	Index RS		
© Siemens AG 2018	Project No	E		
	Ref No	E		
	Doc Type			
	Paper Size	OEH		
	1st Language	^		
	2nd Language	â^		
	Sheet	F of F		

SIEMENS INDUSTRY, INC

HP 60 VOLTS < 600V RPM 3600 TYPE GP100
HZ 60 PHASE 3 FRAME 364TS NEMA B

TORQUE & CURRENT VS. SPEED

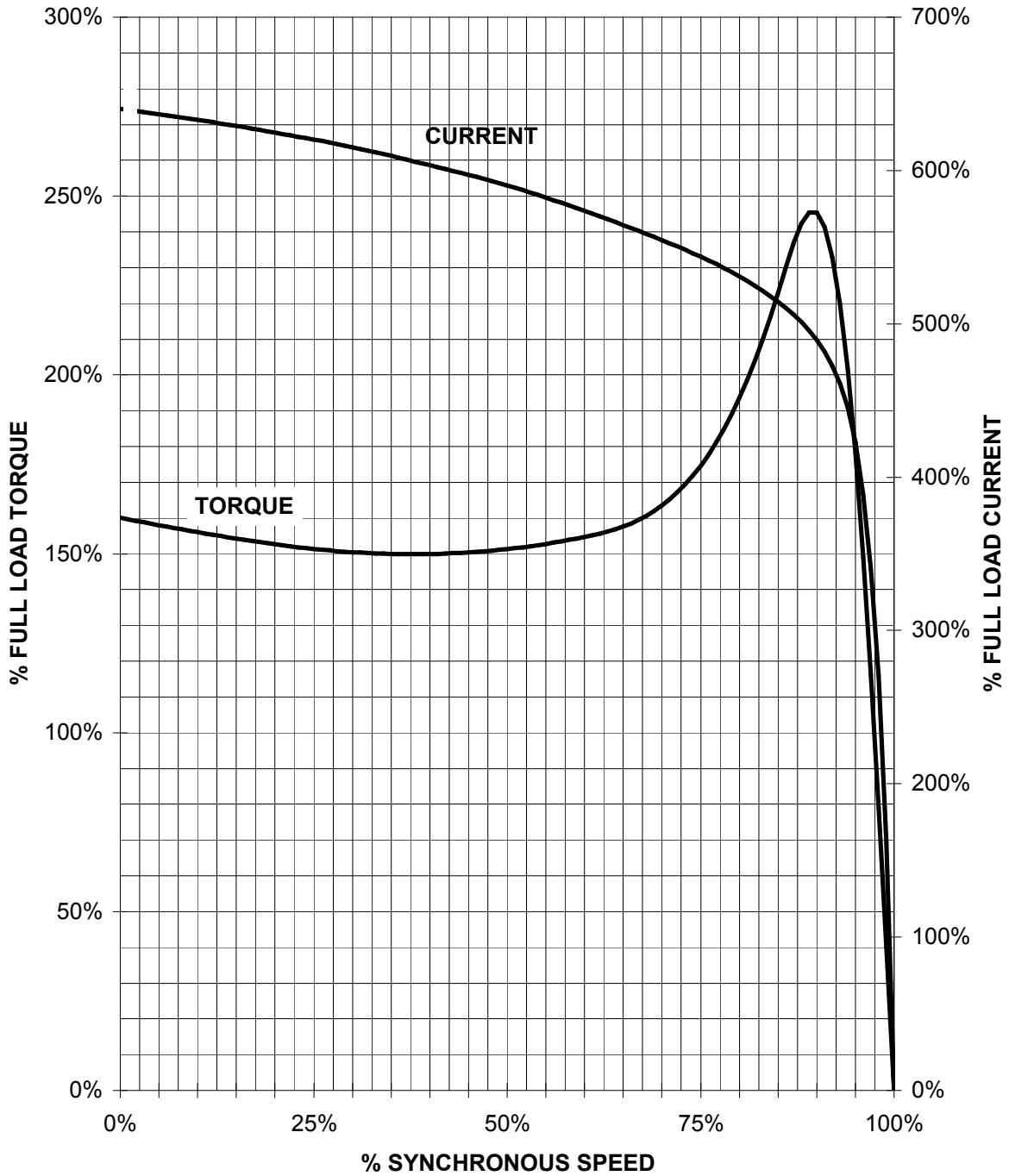

CUSTOMER: _____ ORDER#: _____

60 HP 3600 RPM 364TS FRAME 460 VOLTS 3 PHASE NEMA DESIGN B

SIEMENS INDUSTRY, INC.
PERFORMANCE CURVE
GP100

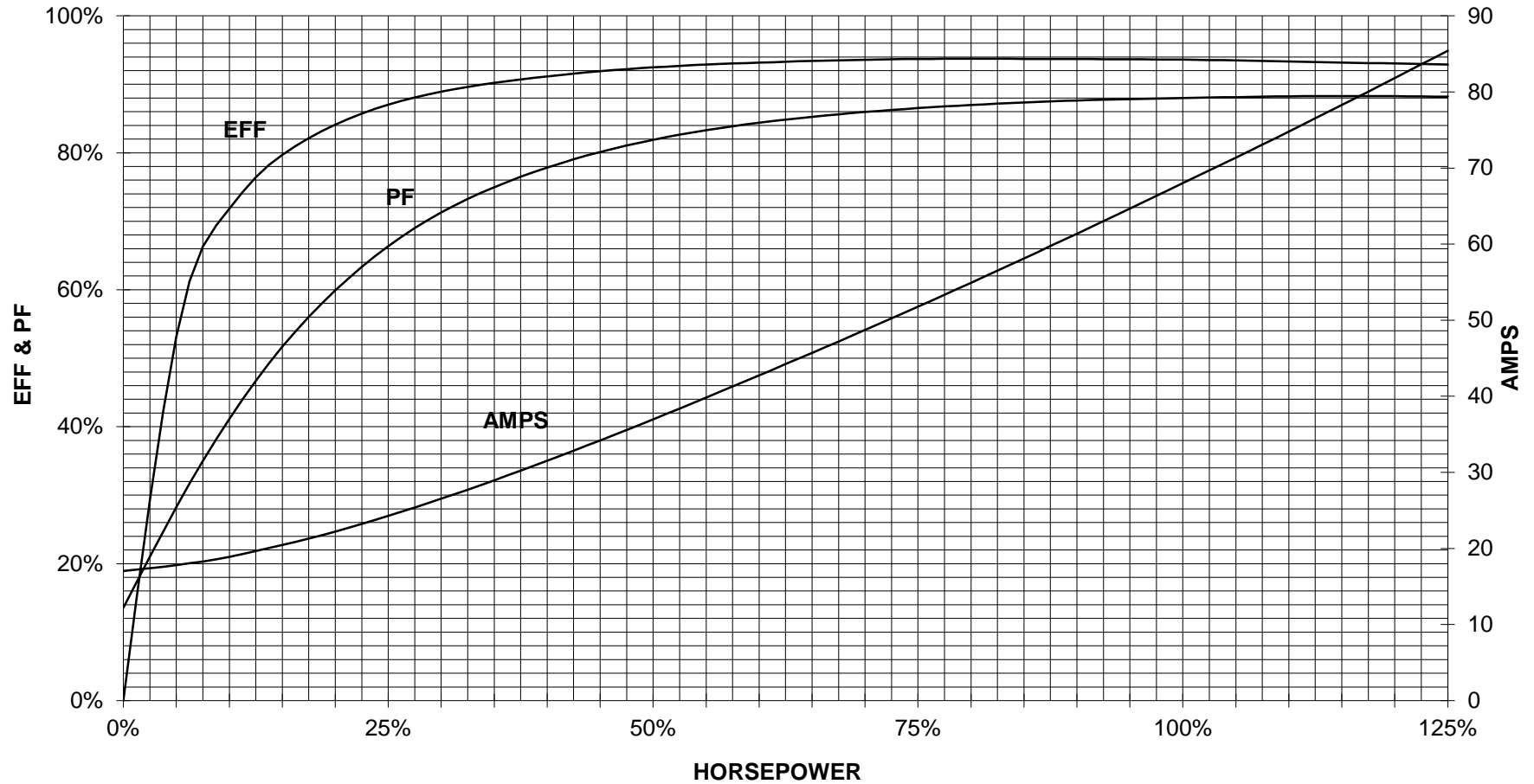

CUSTOMER _____ ORDER # _____ PO # _____

PERFORMANCE BASED ON DESIGN CALCULATIONS. SUBJECT TO CHANGE WITHOUT NOTICE.

REV. 1

Main terminal diagram

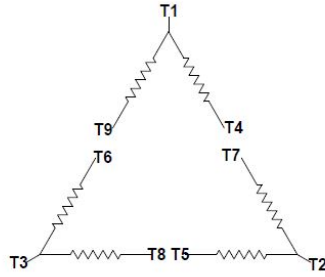

9 LEAD DELTA						
Volts	LINES			CONNECTED TOGETHER	CONN.	
	L1	L2	L3			
LOW	T1 T6	T7 T4	T8 T5	T3 T9		Δ Δ
HIGH	T1	T2	T3	T4 T7-T5 T8-T6 T9		Δ

responsible dep. DI MC LVM	technical reference	created by	approved by	Project
SIEMENS	document type Wiring Diagram	document status free		customer
	title 1LE2221-3DA11-6AA3	document number		
© Siemens AG 2019	rev. 01	creation date 12/03/2019	language en	Page 1/1