

# Data sheet for three-phase Squirrel-Cage-Motors SIMOTICS

Motor type: **SD200 NEMA Premium Next Generation** FS: **L449TS - 2p - 350 hp -**

Client order no.	Item-No.	Offer no.
Order no.	Consignment no.	Project
Remarks		

**Electrical data** **Class I Division 2 Gr. A, B, C or D T2D Class II**  
**Division 2 Gr. F or G T3C**

U [V]	$\Delta/Y$	f [Hz]	P [HP]	P [kW]	n [rpm]	I Load [Amps]					Nom. Eff Load [%]			Pwr. Factor Load [%]			Torque [lb-ft]	T <sub>A</sub> /T <sub>N</sub> LRT [%]	T <sub>k</sub> /T <sub>N</sub> BDT [%]
						4/4	3/4	1/2	0	LRC	4/4	3/4	2/4	4/4	3/4	2/4			
460	$\Delta \Delta$	60	350.00	261.10	3,570	380	289.00	205.70	102.00	2550.0	96.2	96.1	95.5	90.0	88.5	83.4	515.0	170	300

Frame Type: L449TS	Type of constr.: (A) Foot Mounted Horizontal (IMB3)	Ins. Cl.: Standard Class H Insulation	Motor Prot.: A: No Winding Protection	NEMA Des.: B	S.F.: 1.15
Mtr. WT: 2,680		Temp. Rise Cl.: B	Amb. Temp.: + 40 to °C @1000 m	kVA: G	IP 55

**Mechanical data**

Sound level (SPL / SWL) at 60 Hz	79.0 dB(A) / 91.0 dB(A)							Thickener	Polyurea
Octave Band Center Frequencies Hertz								Safe Stall Time Hot	25 s
	250	500	1000	2000	4000	8000	Hz	Safe Stall Time Cold	26 s
SPL@3	58.0	62.0	78.0	74.0	57.0	50.0	dB(A)	Frame material	Cast iron
Moment of inertia	44.9 Lb-ft <sup>2</sup>							Color, paint shade	RAL 7030
Ext Load Inertia Capability:	281.0 Lb ft <sup>2</sup>							Coating (paint finish)	Standard Alkyed + Epoxy (C2)
<b>Bearings</b>								<b>Ventilation Type</b>	
Bearing DE   NDE	6315 Z C3 S0			6315 Z C3 S0			Method of cooling	TEFC	
Bearing_Type	Ball Bearing			Ball Bearing			Direction of rotation	Bi-Directional	
AFBMA:	75BC03JP3			75BC03JP3			Fan Material	Polypropylene ESD	
<b>Grease</b>								VFD	CT: 4:1 VT: 20:1
Capacity	15 oz			15 oz			Space heaters	without	
Grease Type:	Exxon Mobil EM							Brake:	-/-

**Terminal box**

Lead Wire Connection	12 TERMINAL - Connection DELTA					Terminal box position	(1) LHS Mount - View From DE (F-1) - DE or Center of Motor
Voltage	L1	L1	L1	Connected together		Material of terminal box	Cast Iron
----	----	----	----	---	-	Cable entry	(1) 4" NPT
RUN	T12-T7-T6-T1	T10-T8-T4-T2	T11-T9-T5-T13	----	$\Delta \Delta$		

<b>Notes:</b>							
I <sub>r</sub> /I <sub>N</sub> = locked rotor current / current nominal				3) Value is valid only for DOL operation with motor design IC411			
M <sub>r</sub> /M <sub>N</sub> = locked rotor torque / torque nominal				2) at rated power / at full load			
M <sub>b</sub> /M <sub>N</sub> = break down torque / nominal torque							

responsible dep.	technical reference	created by	approved by	<i>Technical data are subject to change! There may be discrepancies between software and hardware versions</i>			
DI MC LVM		DT Configurator					

	document type	document status		customer	
	datasheet	released			
	title	document number			
	1LE6321-4HA11-2AA1				
© Siemens AG 2022	rev.	creation date	language	Page	
	01	2022-04-09 01:14	en	1/1	

刀线需  
 用文字  
 标注  
 说明  
 原因  
 及  
 措施  
 01) 审核人: [Name] 日期: [Date] 02) 审核人: [Name] 日期: [Date] 03) 审核人: [Name] 日期: [Date] 04) 审核人: [Name] 日期: [Date] 05) 审核人: [Name] 日期: [Date] 06) 审核人: [Name] 日期: [Date] 07) 审核人: [Name] 日期: [Date] 08) 审核人: [Name] 日期: [Date] 09) 审核人: [Name] 日期: [Date] 10) 审核人: [Name] 日期: [Date]

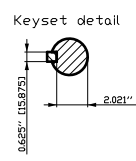
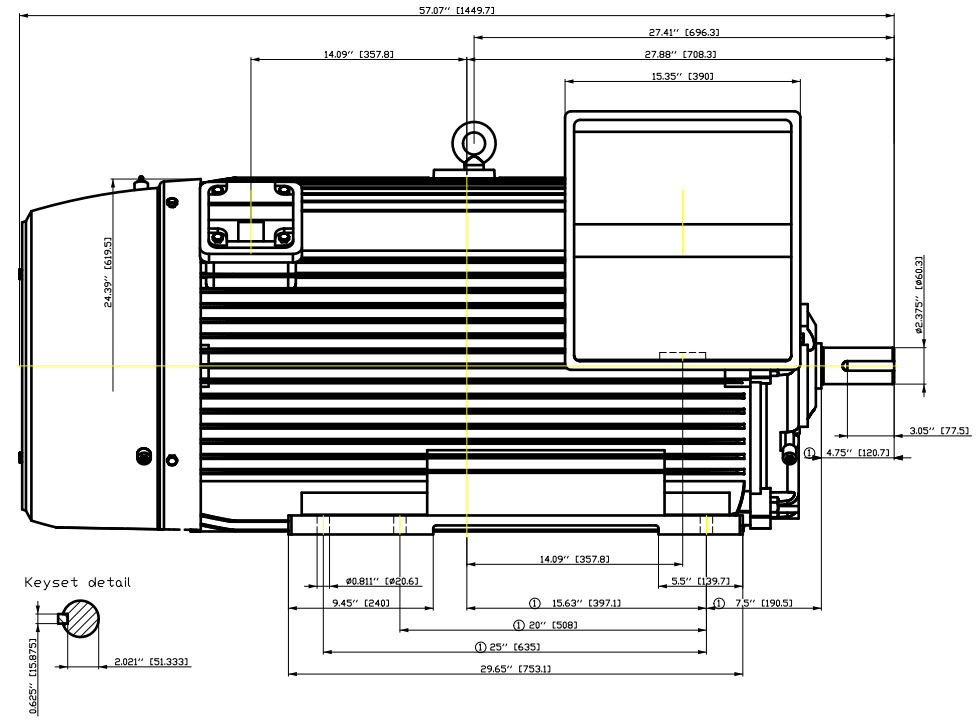
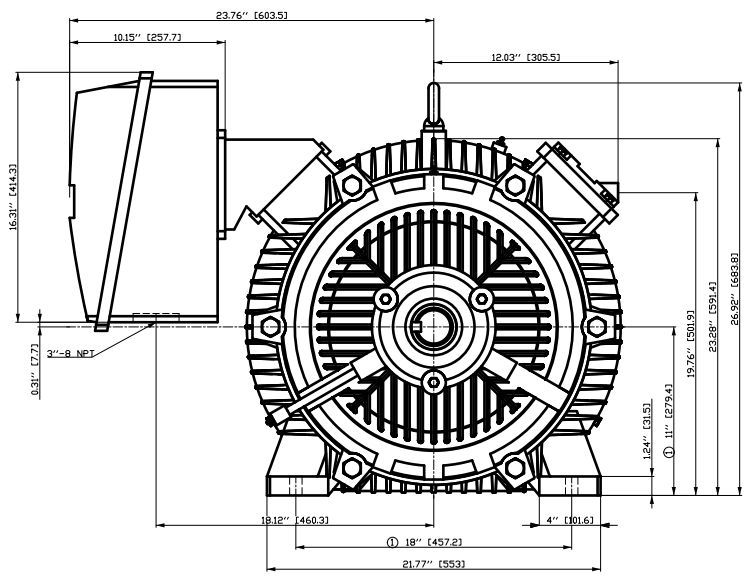

① Tolerances according to NEMA std.  
 All dimensions corresponding to assemblies and castings shall have a tolerance as per ISO 8062-3 DCTG 12.

Tolerance	Surface	Material	Weight	Scale
F50I HGF B P OFF B ODF E	Author Creator Approval Department Change Order	ÖVS T æ : ^ & @ ~ } *	E	{ {
<b>SIEMENS</b>	Doc State Revision	Item No Doc No	Doc Type Paper Size	OH
© Siemens AG 2018	Index RS	1st Language 2nd Language	Sheet	F of F

# SIEMENS INDUSTRY, INC.

HP 350 VOLTS 460 RPM 3570 TYPE SD200  
HZ 60 PHASE 3 FRAME 449T NEMA B

## TORQUE & CURRENT VS. SPEED

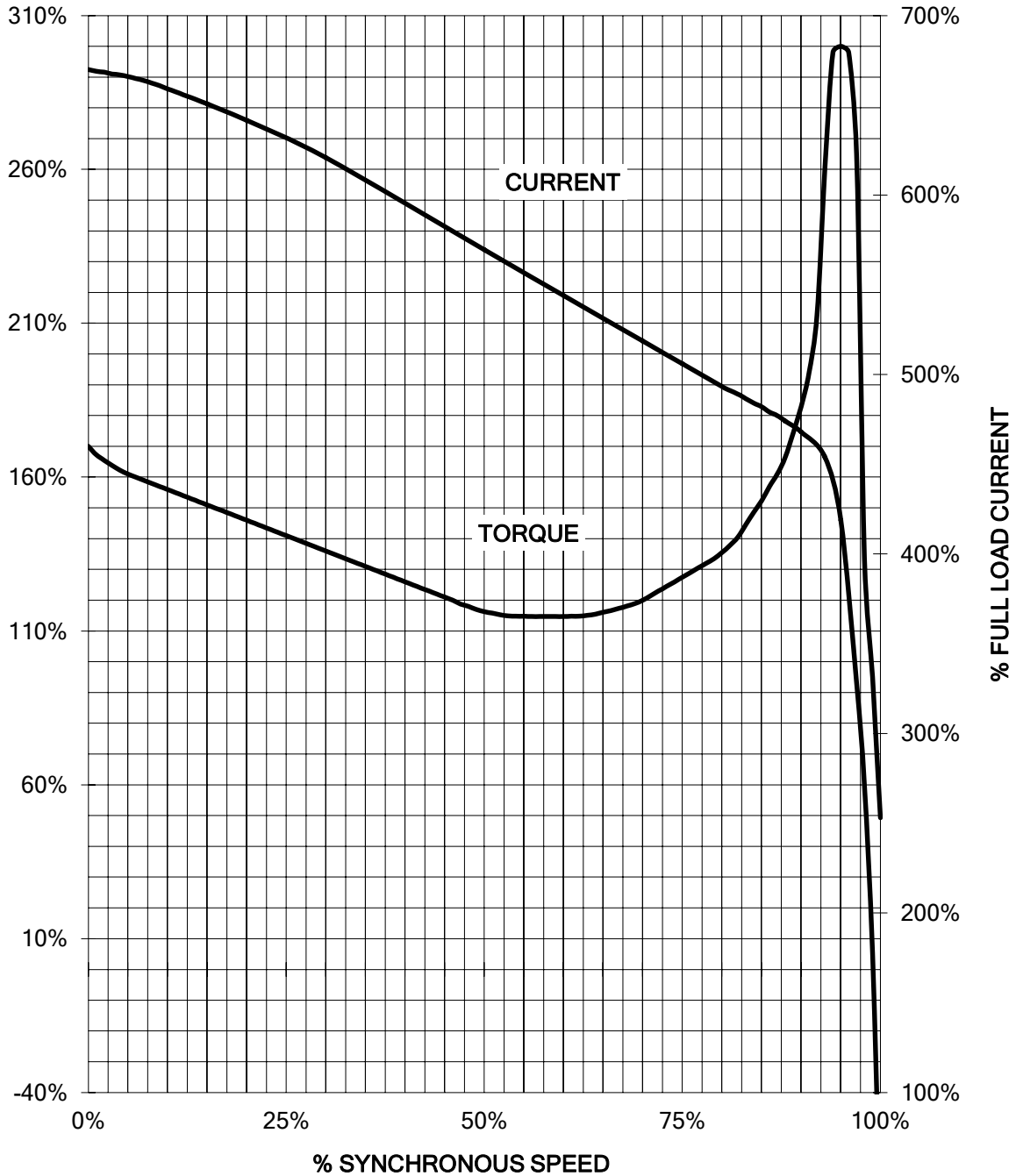

Unrestricted CUSTOMER: \_\_\_\_\_ ORDER#: \_\_\_\_\_

Main terminal diagram

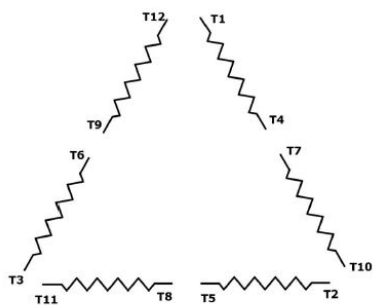

12 LEAD DELTA		
LINES	CONNECT TOGETHER	CONN.
L1	T12 - T7 - T6 - T1	ΔΔ
L2	T10 - T8 - T4 - T2	
L2	T11 - T9 - T5 - T3	

responsible dep. DI MC LVM	technical reference	created by	approved by	Project
<b>SIEMENS</b>	document type Wiring Diagram	document status free		customer
	title 1LE6321-4HA11-2AA1	document number		
© Siemens AG 2019		rev. 01	creation date 12/03/2019	language en
				Page 1/1

350 HP 3600 RPM 449T FRAME 460 VOLTS 3 PHASE NEMA DESIGN B

SIEMENS INDUSTRY, INC.  
PERFORMANCE CURVE  
SD200

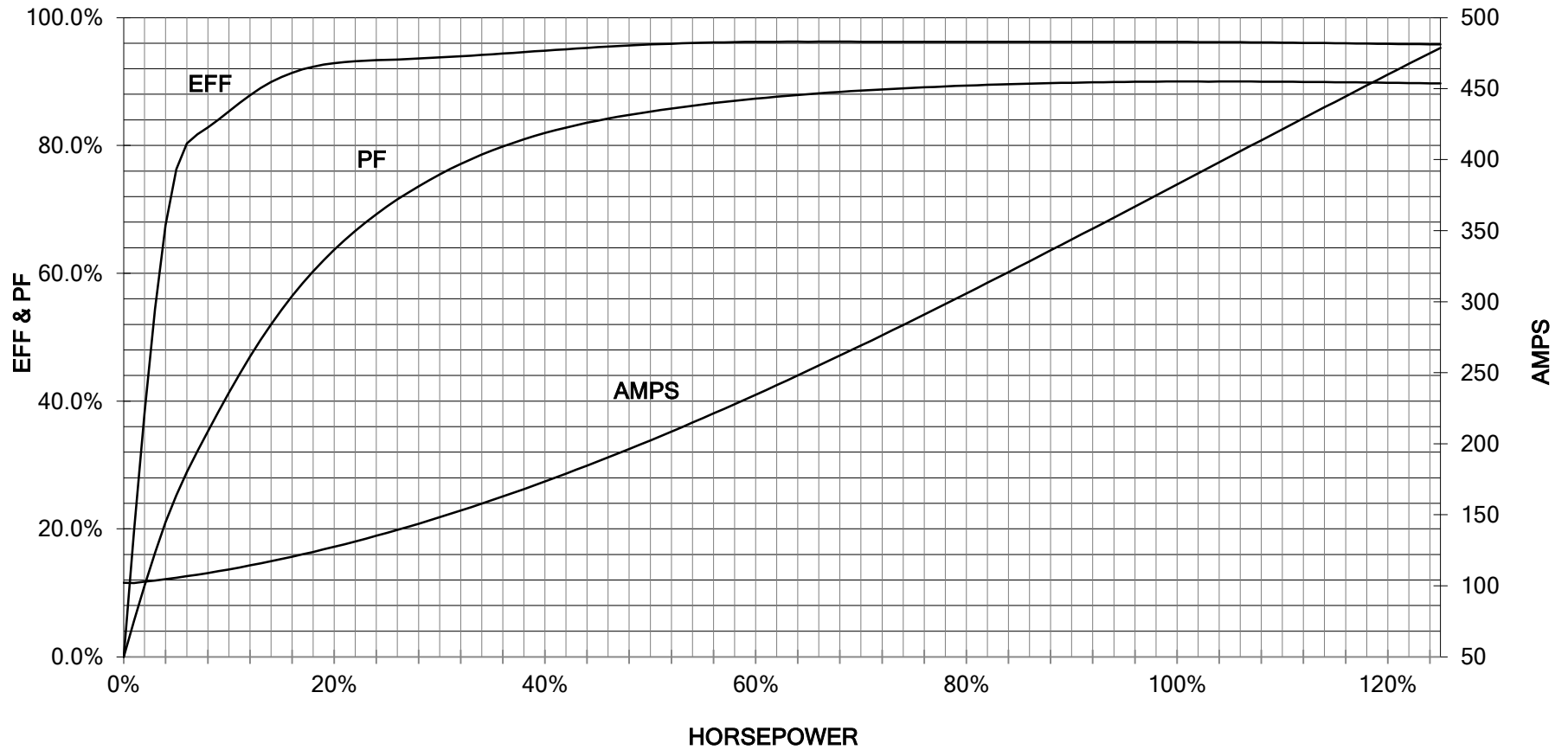

CUSTOMER: \_\_\_\_\_ ORDER #: \_\_\_\_\_

PERFORMANCE BASED ON DESIGN CALCULATIONS. SUBJECT TO CHANGE WITHOUT NOTICE.

REV. 1