

Data sheet for three-phase Squirrel-Cage-Motors SIMOTICS

Motor type: FS: 256TCV - 2p - 20 hp -

Client order no.	Item-No.	Offer no.
Order no.	Consignment no.	Project
Remarks		

Electrical data Class I, Div 1 Gr. C&D; Class II, Div1, Gr. F&G

U [V]	Δ/Y	f [Hz]	P [HP]	P [kW]	n [rpm]	I Load [Amps]					LRC	Nom. Eff Load [%]			Pwr. Factor Load [%]			Torque [lb-ft]	T _A /T _N LRT [%]	T _k /T _N BDT [%]
						4/4	3/4	1/2	0	4/4		3/4	2/4	4/4	3/4	2/4				
460		60	20.00	-/-	3,515	22.50	16.80	11.80	5.20	145.0	91.0	91.6	92.1	91.5	91.3	86.2	30.0	183	230	
230		60	20.00	-/-	3,515	45.00					91.0	91.6	92.1	91.5	91.3	86.2	30.0	183	230	

Frame Type: 256TCV	Type of constr.: (L) Round body - C-Face w/drip cover + hooks	Ins. Cl.:Insulation class F	Motor Prot.:(G) Thermostats, Klixon type, normally closed	NEMA Des.: B	S.F.: 1.15
Mtr. WT:308		Temp. Rise Cl.: B	Amb. Temp.: + to -20 °C @1000 m	kVA: G	IP IP65

Mechanical data

Sound level (SPL / SWL) at 60 Hz	67.0 dB(A) / 79.0 dB(A)		Thickener	Polyurea					
Octave Band Center Frequencies Hertz	250	500	1000	2000	4000	8000	Hz	Safe Stall Time Hot	20 s
SPL@3	dB(A)							Safe Stall Time Cold	45 s
Moment of inertia	1.4 Lb-ft ²		Frame material	cast iron					
Ext Load Inertia Capability:	21.0 Lb ft ²		Color, paint shade						
Bearings			Coating (paint finish)						
Bearing DE NDE	6309 Z C3 S0		6309 Z C3 S0	Ventilation Type					
Bearing_Type	Ball Bearing		Ball Bearing	Method of cooling	TEFC				
AFBMA:	45BC03JP30		45BC03JP30	Direction of rotation	Bidirectional				
Grease			Fan Material	Polypropylen ESD					
Capacity	0.5 oz		0.5 oz	VFD	CT: 4:1 VT: 20:1				
Grease Type:	Exxon Mobile EM		Space heaters	without					
			Brake:	-/-					

Terminal box

Lead Wire Connection	9 LEAD - WYE				Terminal box position	(3) Mounting - F-1
Voltage	L1	L1	L1	Connected together	Material of terminal box	
LOW	T1 T7	T2 T8	T3 T9	T4 T5 T6	Cable entry	-/-
HIGH	T1	T2	T3	T4 T7-T5 T8-T6 T9		

Notes:					
I _r /I _N = locked rotor current / current nominal		M _r /M _N = locked rotor torque / torque nominal		M _b /M _N = break down torque / nominal torque	
				3) Value is valid only for DOL operation with motor design IC411	
				2) at rated power / at full load	

responsible dep.	technical reference	created by	approved by	<i>Technical data are subject to change! There may be discrepancies between software and hardware versions</i>	
DI MC LVM		DT Configurator			

	document type	document status		customer	
	datasheet	released			
	title	document number			
	1MB2121-2BA21-6LG3				
© Siemens AG 2022		rev.	creation date	language	Page
		01	2022-04-08 20:16	en	1/1

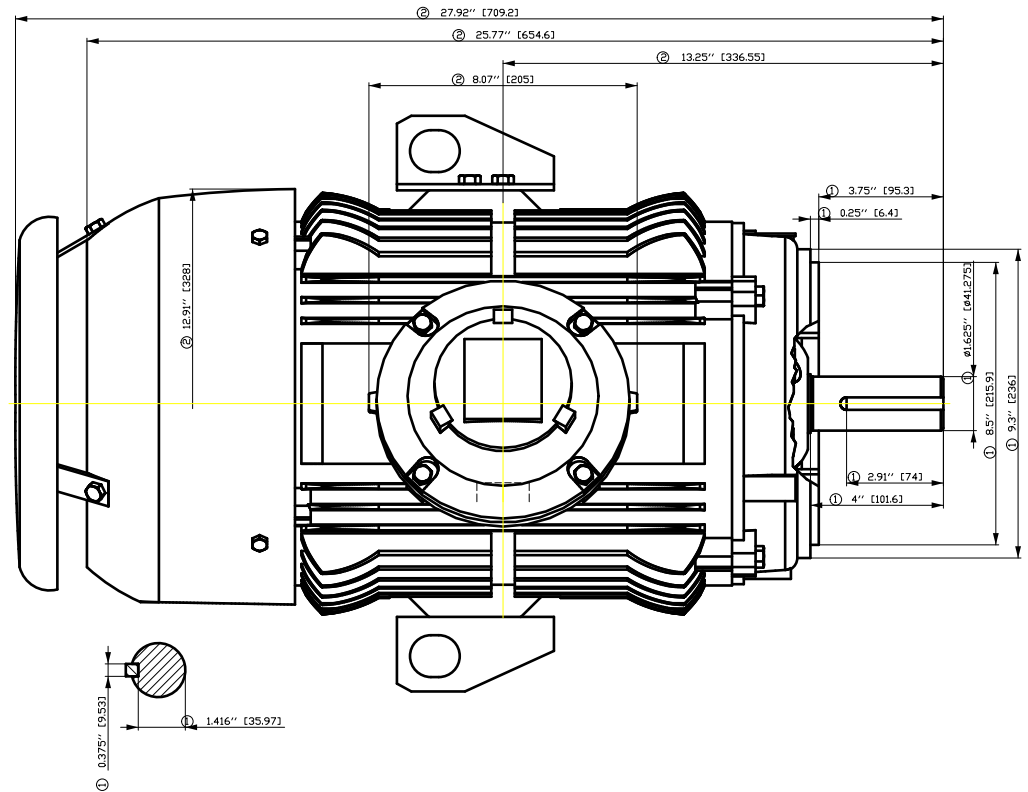
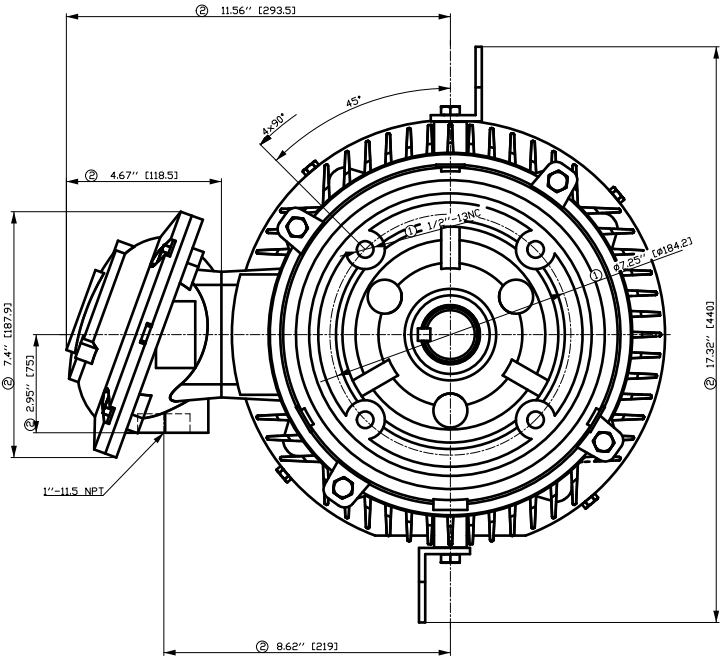

- ① Tolerances according to NEMA std.
- ② All these dimensions corresponding to assemblies and castings shall have a tolerance as per DIN standard 1686-GTB 19.
- ③ Not according to NEMA std.

Tolerance	Surface	Material	Weight É	Scale 1:1
FT ÖGFC-ÉCÓCFÉ ŠÖH É	Author Creator Approval Department Change Order	ÖVS T æ : ^@~ } *		
SIEMENS	Doc. State Revision	I ð BGG Index RS	MFB Item No Doc No	Doc Type Paper Size 1st Language 2nd Language
	© Siemens AG 2018 Project No	É	É	É F of F

刀线管
用转为平
用全图
积
 01. 02. 03. 04. 05. 06. 07. 08. 09. 10. 11. 12. 13. 14. 15. 16. 17. 18. 19. 20. 21. 22. 23. 24. 25. 26. 27. 28. 29. 30. 31. 32. 33. 34. 35. 36. 37. 38. 39. 40. 41. 42. 43. 44. 45. 46. 47. 48. 49. 50. 51. 52. 53. 54. 55. 56. 57. 58. 59. 60. 61. 62. 63. 64. 65. 66. 67. 68. 69. 70. 71. 72. 73. 74. 75. 76. 77. 78. 79. 80. 81. 82. 83. 84. 85. 86. 87. 88. 89. 90. 91. 92. 93. 94. 95. 96. 97. 98. 99. 100.

Main terminal diagram

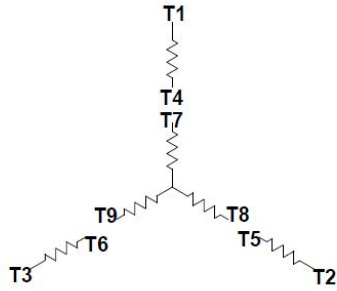

| 9 LEAD WYE | | | | | | |
|------------|----------|----------|----------|--------------------|-------|--|
| Volts | LINES | | | CONNECTED TOGETHER | CONN. | |
| | L1 | L2 | L3 | | | |
| LOW | T1
T7 | T2
T6 | T3
T9 | T4 T5 T6 | YY | |
| HIGH | T1 | T2 | T3 | T4 T7-T5 T8-T6 T9 | Y | |

Motor protection

THERMOSTATS

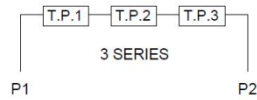

responsible dep.
DI MC LVM

technical reference

created by

approved by

Project

SIEMENS

document type
Wiring Diagram

title
1MB2121-2BA21-6LG3

document status
free

document number

customer

SIEMENS INDUSTRY, INC.

HP 20 VOLTS <600 RPM 3600 TYPE XP100
HZ 60 PHASE 3 FRAME 256T NEMA B

TORQUE & CURRENT VS. SPEED

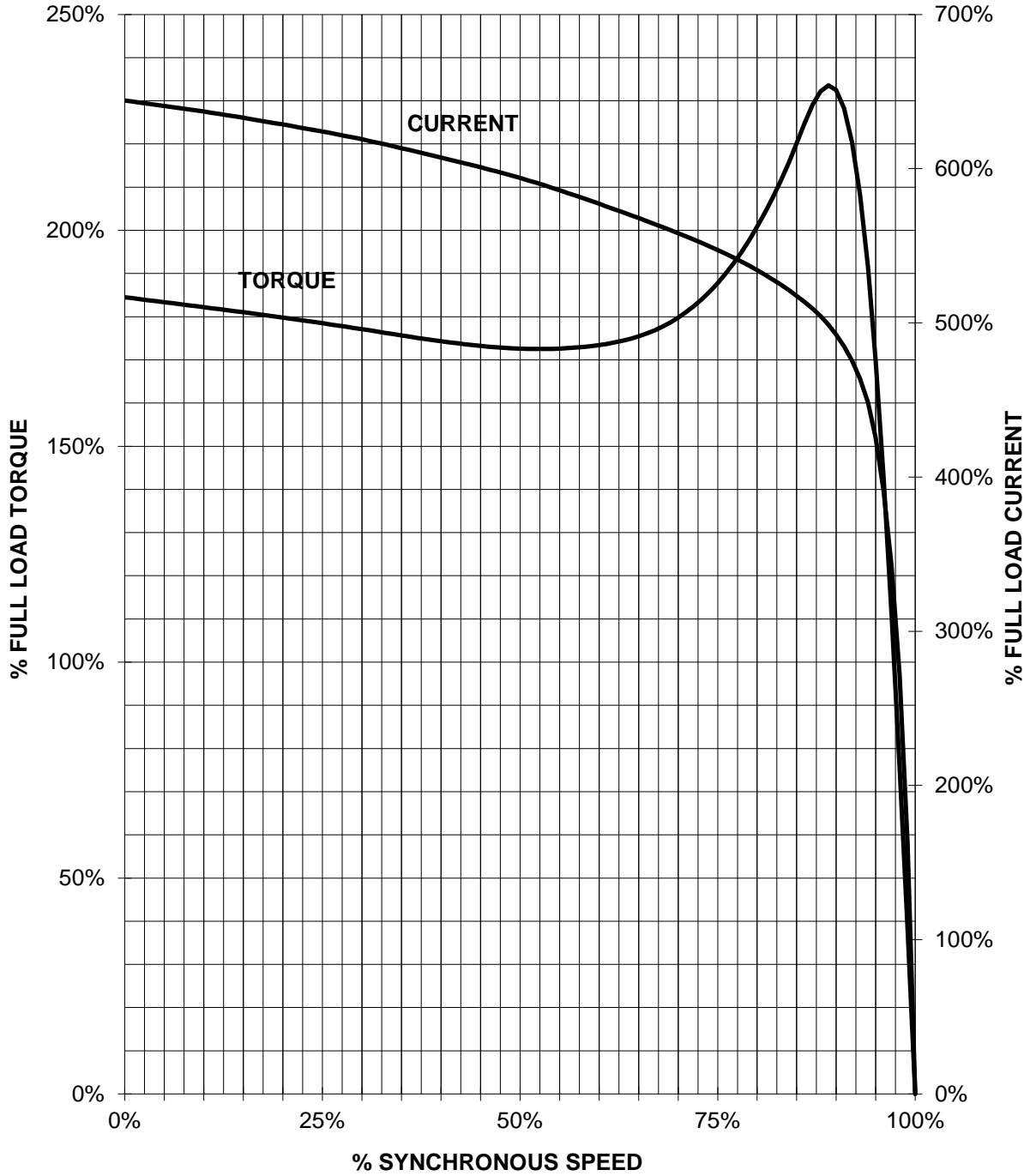

CUSTOMER: _____ ORDER#: _____