

# Data sheet for three-phase Squirrel-Cage-Motors SIMOTICS

**Motor type:** FS: 364TS - 2p - 60 hp -

|                  |                 |           |
|------------------|-----------------|-----------|
| Client order no. | Item-No.        | Offer no. |
| Order no.        | Consignment no. | Project   |

Remarks

**Electrical data** Class I, Div 1 Gr. C&D; Class II, Div1, Gr. F&G

| U [V] | $\Delta/Y$ | f [Hz] | P [HP] | P [kW] | n [rpm] | I Load [Amps] |       |       |       |       | LRC  | Nom. Eff Load [%] |      |      | Pwr. Factor Load [%] |      |      | Torque [lb-ft] | T <sub>A</sub> /T <sub>N</sub> LRT [%] | T <sub>k</sub> /T <sub>N</sub> BDT [%] |
|-------|------------|--------|--------|--------|---------|---------------|-------|-------|-------|-------|------|-------------------|------|------|----------------------|------|------|----------------|--|--|
|       |            |        |        |        |         | 4/4           | 3/4   | 1/2   | 0     | 4/4   |      | 3/4               | 2/4  | 4/4  | 3/4                  | 2/4  |      |                |  |  |
| 460   |            | 60     | 60.00  | -/-    | 3,565   | 68.00         | 52.10 | 37.40 | 19.00 | 435.0 | 93.6 | 94.1              | 93.8 | 88.0 | 86.0                 | 80.0 | 89.0 | 160            | 249                                    |  |
| 230   |            | 60     | 60.00  | -/-    | 3,565   | 136.00        |       |       |       |       | 93.6 | 94.1              | 93.8 | 88.0 | 86.0                 | 80.0 | 89.0 | 160            | 249                                    |  |

|                   |  |                             |   |              |            |
|-------------------|--|-----------------------------|---|--------------|------------|
| Frame Type: 364TS | Type of constr.: (A) Foot mounted - End shield | Ins. Cl.:Insulation class F | Motor Prot.:(G) Thermostats, Klixon type, normally closed | NEMA Des.: B | S.F.: 1.15 |
| Mtr. WT:790       |  | Temp. Rise Cl.: B           | Amb. Temp.: + to -20 °C @1000 m                           | kVA: G       | IP IP65    |

**Mechanical data**

|                                      |                                |                         |                  |
|--------------------------------------|--------------------------------|-------------------------|------------------|
| Sound level (SPL / SWL) at 60 Hz     | 87.0 dB(A) / 98.0 dB(A)        | Thickener               | Polyurea         |
| Octave Band Center Frequencies Hertz | 250 500 1000 2000 4000 8000 Hz | Safe Stall Time Hot     | 16 s             |
| SPL@3                                | dB(A)                          | Safe Stall Time Cold    | 28 s             |
| Moment of inertia                    | 8.8 Lb-ft <sup>2</sup>         | Frame material          | cast iron        |
| Ext Load Inertia Capability:         | 58.0 Lb ft <sup>2</sup>        | Color, paint shade      |                  |
| <b>Bearings</b>                      |                                | Coating (paint finish)  |                  |
| Bearing DE   NDE                     | 6314 Z C3 S0   6314 Z C3 S0    | <b>Ventilation Type</b> |                  |
| Bearing_Type                         | Ball Bearing   Ball Bearing    | Method of cooling       | TEFC             |
| AFBMA:                               | 70BC03JP30   70BC03JP30        | Direction of rotation   | Bidirectional    |
| <b>Grease</b>                        |                                | Fan Material            | Polypropylen ESD |
| Capacity                             | 7.5 oz   7.5 oz                | VFD                     | CT: n/a VT: 20:1 |
| Grease Type:                         | Exxon Mobile EM                | Space heaters           | without          |
|                                      |                                | Brake:                  | -/-              |

**Terminal box**

|                      |                                    |                          |                    |
|----------------------|------------------------------------|--------------------------|--------------------|
| Lead Wire Connection | 9 LEAD - DELTA                     | Terminal box position    | (3) Mounting - F-1 |
| Voltage              | L1 L1 L1 Connected together        | Material of terminal box |                    |
| LOW                  | T1 T7 T6 T2 T8 T4 T3 T9 T5 - - - - | Cable entry              | -/-                |
| HIGH                 | T1 T2 T3 T4 T7-T5 T8-T6 T9         |                          |                    |

Notes:

1) I<sub>r</sub>/I<sub>N</sub> = locked rotor current / current nominal  
 2) M<sub>r</sub>/M<sub>N</sub> = locked rotor torque / torque nominal  
 3) Value is valid only for DOL operation with motor design IC411  
 4) M<sub>b</sub>/M<sub>N</sub> = break down torque / nominal torque  
 5) 2) at rated power / at full load

|                  |                     |                 |             |   |
|------------------|---------------------|-----------------|-------------|---|
| responsible dep. | technical reference | created by      | approved by | <i>Technical data are subject to change! There may be discrepancies between software and customer interface</i> |
| DI MC LVM        |                     | DT Configurator |             |   |

|                   |                    |                 |          |                  |
|-------------------|--------------------|-----------------|----------|------------------|
|                   | document type      | document status | customer |                  |
|                   | datasheet          | released        |          |                  |
|                   | title              | document number | rev.     | creation date    |
|                   | 1MB2121-3DA11-6AG3 |                 | 01       | 2022-04-08 22:22 |
| © Siemens AG 2022 |                    |                 | language | Page             |
|                   |                    |                 | en       | 1/1              |

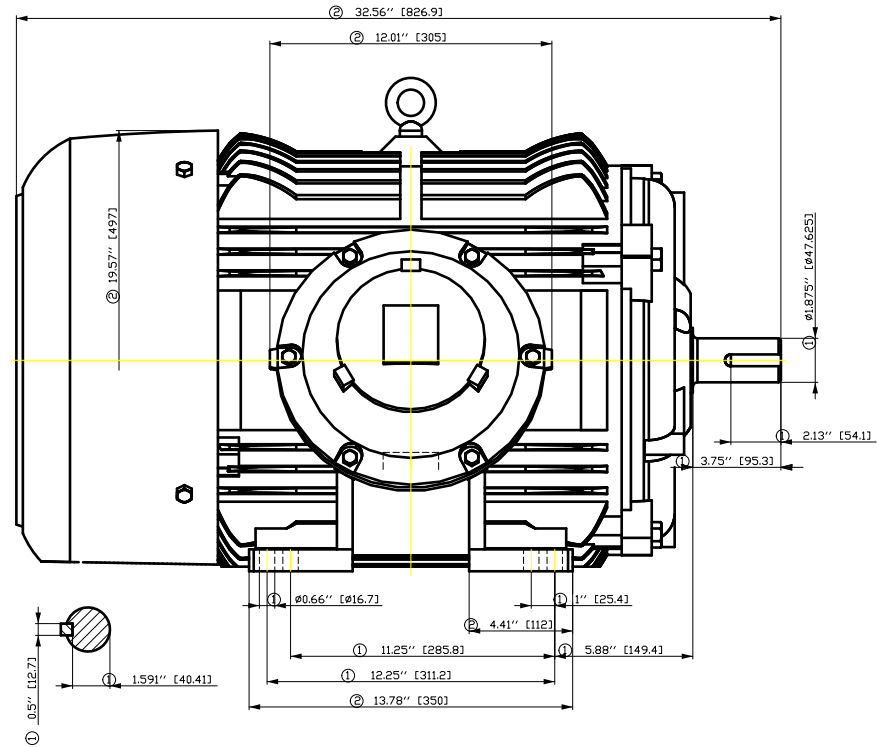
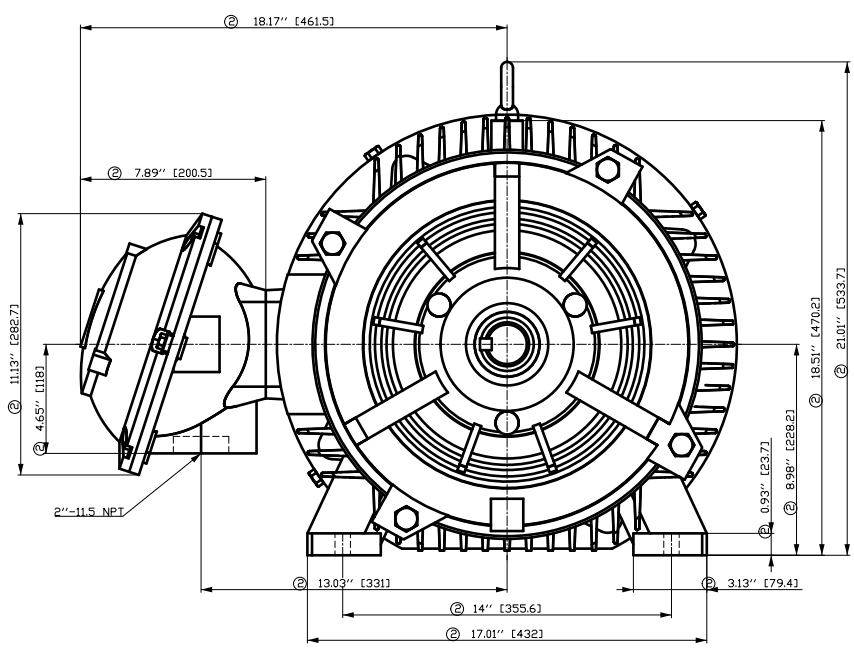

- ① Tolerances according to NEMA std.
- ② All these dimensions corresponding to assemblies and castings shall have a tolerance as per DIN standard 1686-GTB 19.
- ③ Not according to NEMA std.

|                             |   |                              |                   |  |
|-----------------------------|---|------------------------------|-------------------|--|
| Tolerance                   | Surface   | Material                     | Weight<br>E       | Scale<br>1:1   |
| FT ÖGF CF E ÖÖFF E ÖÖH<br>E | Author<br>Creator<br>Approval<br>Department<br>Change Order | ÖS<br>T a : ^ @ ~ } *<br>MFB |                   |  |
| SIEMENS                     | Doc. State<br>Revision                                      | I ÖB ÖB G<br>Index RS        | Item No<br>Doc No | Doc Type<br>Paper Size<br>1st Language<br>2nd Language |
|                             | © Siemens AG 2018<br>Project No                             | E                            | Ref No<br>E       | Sheet F of F   |

刀线管  
 用特为于  
 文全路  
 积  
 01 1113 282.7 11.13 282.7 4.65 118 2 11.5 NPT 13.03 331 14 355.6 17.01 432 3.13 79.4 0.93 23.7 8.98 228.2 18.51 470.2 21.01 533.7  
 01 32.56 826.9 12.01 305 19.57 497 1.9275 49.65 2.13 54.1 3.75 95.3 0.5 12.7 1.591 40.41 0.66 16.7 1.125 28.58 12.25 311.2 13.78 350 4.41 112 1 25.4 5.88 149.4

Main terminal diagram



| 9 LEAD DELTA |          |          |          |                    |       |     |
|--------------|----------|----------|----------|--------------------|-------|-----|
| Volts        | LINES    |          |          | CONNECTED TOGETHER | CONN. |     |
|              | L1       | L2       | L3       |                    |       |     |
| LOW          | T1<br>T6 | T7<br>T4 | T8<br>T5 | T3<br>T9           |       | Δ Δ |
| HIGH         | T1       | T2       | T3       | T4 T7-T5 T8-T6 T9  |       | Δ   |

Motor protection

THERMOSTATS

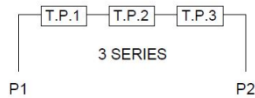

responsible dep.  
DI MC LVM

technical reference

created by

approved by

Project

**SIEMENS**

document type  
Wiring Diagram

title  
1MB2121-3DA11-6AG3

document status  
free

document number

customer

# SIEMENS INDUSTRY, INC

HP 60    VOLTS <600    RPM 3600    TYPE XP100  
HZ 60    PHASE 3    FRAME 364TS    NEMA B

## TORQUE & CURRENT VS. SPEED

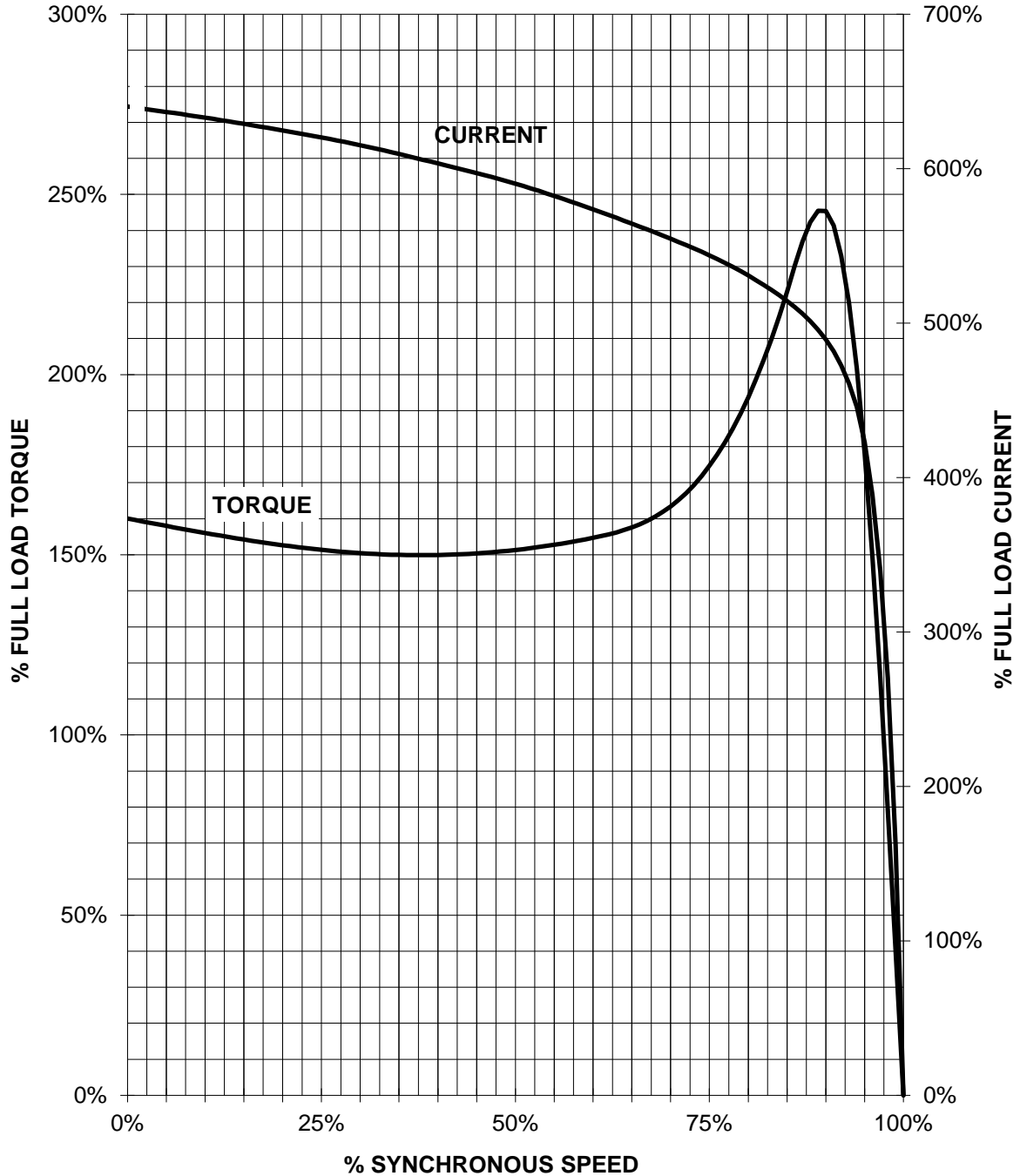

CUSTOMER: \_\_\_\_\_ ORDER#: \_\_\_\_\_

60 HP 3600 RPM 364TS FRAME 460 VOLTS 3 PHASE NEMA DESIGN B

**SIEMENS INDUSTRY, INC.**  
**PERFORMANCE CURVE**  
**XP100**

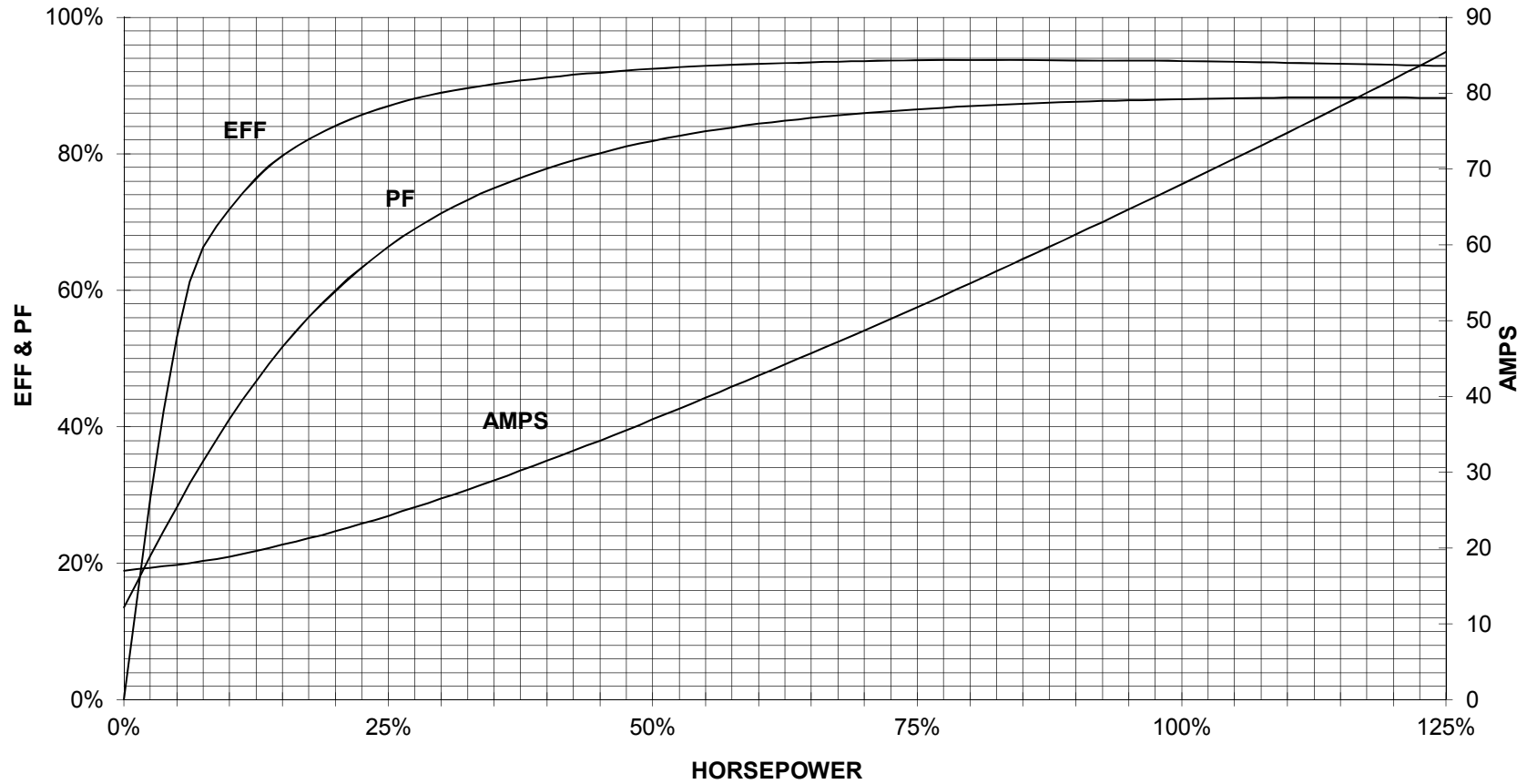

CUSTOMER \_\_\_\_\_ ORDER # \_\_\_\_\_ PO # \_\_\_\_\_

PERFORMANCE BASED ON DESIGN CALCULATIONS. SUBJECT TO CHANGE WITHOUT NOTICE.

REV. 1