



NEMA Motor Data

MLFB-Ordering data : **1MB2121-3DA21-3AG3**

Client order no. :
 Order no. :
 Offer no. :
 Remarks :

Item no. :
 Consignment no. :
 Project :

Nameplate Data	Mounting and motor protection
----------------	-------------------------------

Type	XP100	Div. 1, CI , Groups C&D, CII, Groups F&G
HP	75.0	Rating Cont.
Voltage	(13) 575V STD 60Hz	Ins. Class Insulation class F
Amps	68.8 A	S.F. 1.15
FL RPM	3565	Amb. Temp. 40 deg C
FL Efficiency	94.1 %	Temp Code T3C
FRAME	365TS	Temp. Rise Class B
DE AFBMA	70BC03JP30	NEMA Design B kVA Code G
ODE AFBMA	70BC03JP30	Mtr WT (lbs) 945
60 Hertz	3 Ph TEFC	IP 65

Type of construction	(A) Foot mounted - End shield
Motor protection	(G) Thermostats, Klixon type, normally
Terminal box design	(3) Mounting - F-1

Bearing Data		
--------------	--	--

	DE	ODE
Bearing Size	6314 Z C3 S0	6314 Z C3 S0
Bearing Type	Ball Bearing	Ball Bearing
AFBMA	70BC03JP30	70BC03JP30

Typical Performance Data					
--------------------------	--	--	--	--	--

Load	No Load	1/2	3/4	Full Load	LRC
Efficiency		93.7 %	94.3 %	94.1 %	
Power Factor		81.0	86.0	88.0	
Current (A)	17.6 A	37.0 A	52.0 A	68.8 A	434.4 A
Inverter Duty	VT	20:1	CT	n/a	

Mechanical Data				
-----------------	--	--	--	--

SAFE STALL TIME	HOT (s)	16	COLD (s)	27
Rtr wt (lbs)	188.0	Rtr WK2	11.1000	
FLT (ft-lbs)	111.0	LRT (%)	160	BDT (%) 260
Ext Load Inertia (WK2) Capability	71			

Typical Noise Data										
--------------------	--	--	--	--	--	--	--	--	--	--

A-weighted Sound	Octave Band Center Frequencies Hertz (Hz)									
Pressure Level	63	125	250	500	1000	2000	4000	8000	SPL	87
at 3 feet		59	74	77	82	83	77	67	SPwrL	98

Wiring Connection Information					
-------------------------------	--	--	--	--	--

Description	3 PHASE - 3 LEAD - DELTA				
Voltage	L1	L2	L3	Connected together	
-----	-----	-----	-----	-----	-
-----	T1	T2	T3	-----	Δ

Special design :

Lubrication Information	
-------------------------	--

Manufacturer	Mobil Polyrex EM or equal
Type	Polyurea (standard)
DE Capacity (oz.)	7.50
ODEnd Capacity (oz.)	7.50

Relubricate bearings every six months (more frequent if conditions require). See Instruction Manual.

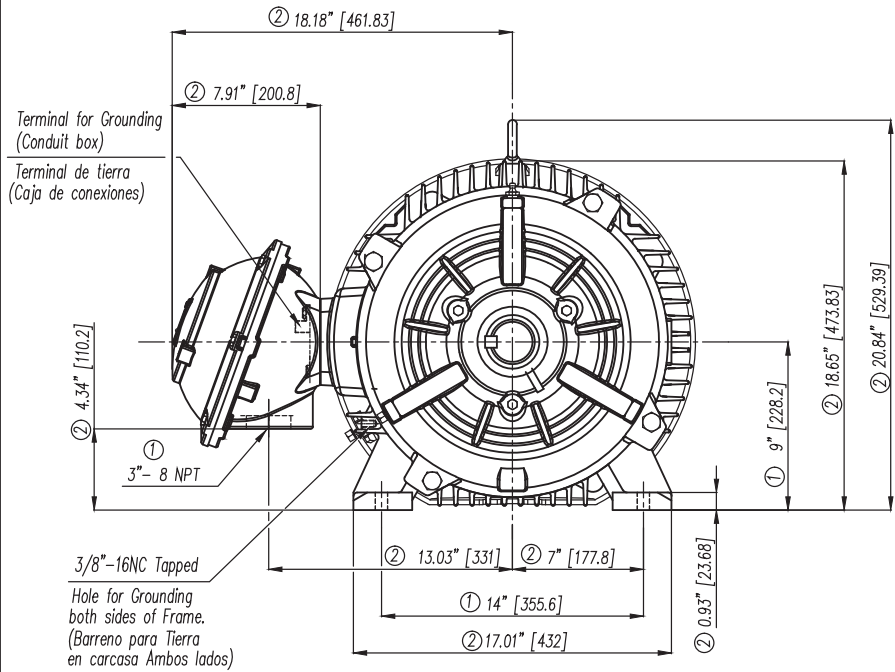

- | | |
|---|--|
| ① Tolerances According to NEMA Std. | ① Tolerancias acorde a NEMA Std. |
| ② All these dimensions corresponding to assemblies and castings shall have a tolerance as per DIN standard 1686-GTB 19. | ② Todas estas dimensiones correspondientes a ensambles y fundición en bruto tendrán una tolerancia según DIN 1686-GTB-19 |
| ③ Not According to NEMA Std. | ③ No Acorde a NEMA Std. |

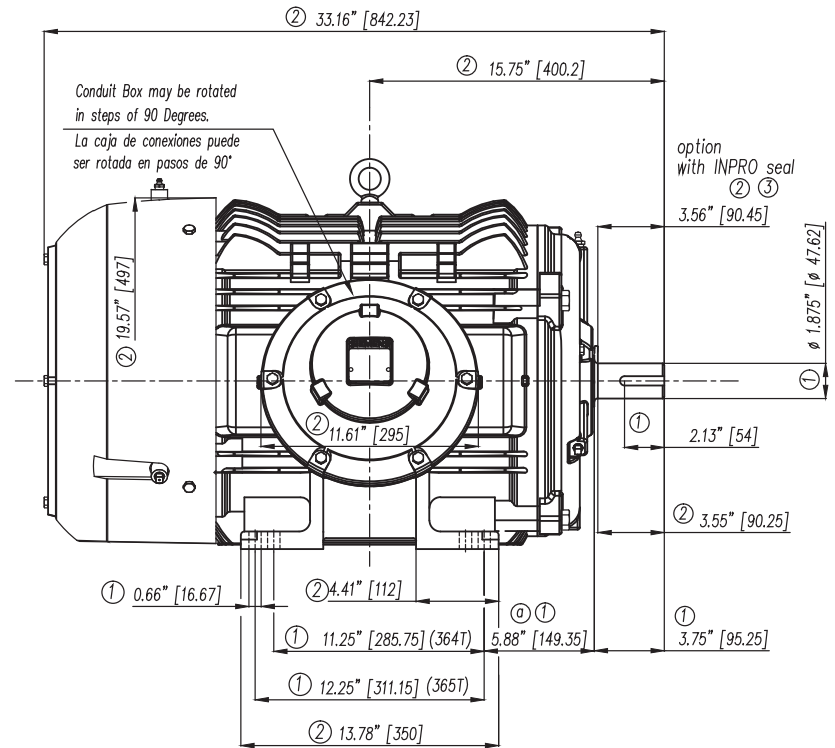
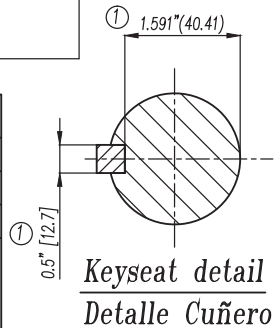

CERTIFIED PRINT/CERTIFICACION

CUSTOMER/CLIENTE						
POB/ORDEN COMPRA#			SOB/ORDEN CLIENTE#			
HP	RPM	FRAME/ARM.	TYPE/TIPO	VOLTS	PH/FAS.	HZ

Tol. in mm. acc. to/Tol. en mm. según DIN-1686-GTB-19		European Projection/Proyección Europea		a) Se corrigió distancia BA, + se actualizaron dimensiones.	
Over/desde	to/hasta	±		Modific.	
---	18	±	4.5		
18	30	±	4.7		
30	50	±	5		
50	80	±	5.5		
80	120	±	6		
120	180	±	6.5		
180	250	±	7		
250	315	±	7.5		
315	400	±	8		
400	500	±	8.5		
500	630	±	9.5		
630	800	±	10		
Date/Fecha		Name/Nombre		Outline/Dimensiones	
Drawn/Elab. 17/02/11		Guzmán		Scale/Escala ---	
Check/Rev. 18/02/11		A. Real		Type/ Tipo: Class I, Group D & C, Class II Group F & G, XP100 364/365 TS Frame/Armazón. (F1)	
Std.Ckd./Aut				3MSE 730 2075a)	
SIEMENS		GUADALAJARA FACTORY		Ref. Rep./ 3MSE 730 2075	
FABRICA GUADALAJARA				Sub	

2

1

3 PHASE - 3 LEADS - DELTA

L1	L2	L3	CONN.
T1	T2	T3	△

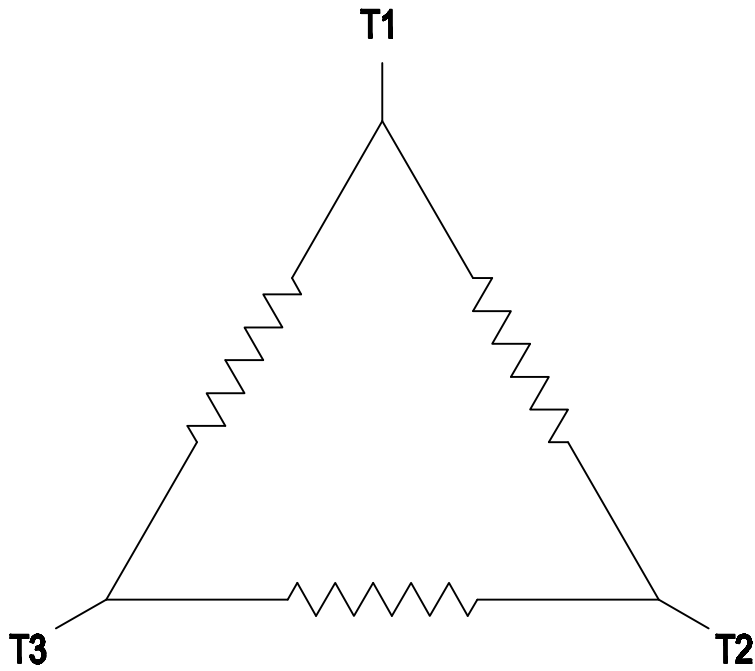

B

B

A

A

THIS IS A CAD DRAWING
DO NOT MAKE MANUAL CHANGES

01 | 09-27-07

TYPE

-CONFIDENTIAL-

PROPERTY OF

Siemens Energy & Automation, Inc.
Industrial Motor Division - Little Rock, AR

FRAME

HP

NAME

WIRING DIAGRAM

VOLTS

RPM

HZ

PH

3

Customer

PO #

SO #

DRAWN	9.24.07	DATE	JRH
CHECKED		DATE	
APP		DATE	

SHEET
1 OF 1

Sim. To

PART NO.

51-382-114-504

A

2

1

SIEMENS INDUSTRY, INC.

HP 75 VOLTS <600 RPM 3600 TYPE XP100
HZ 60 PHASE 3 FRAME 365TS NEMA B

TORQUE & CURRENT VS. SPEED

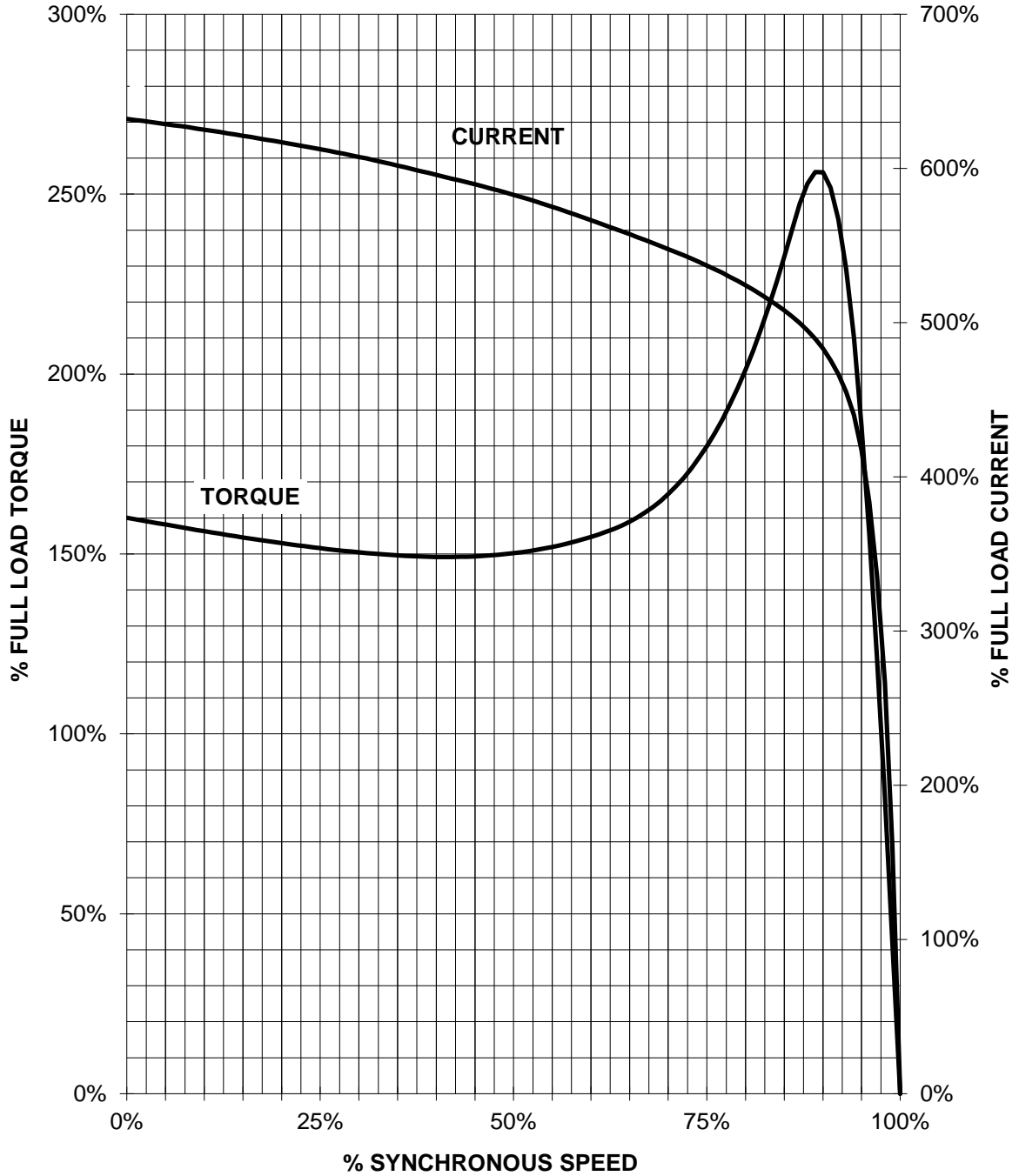

CUSTOMER: _____ ORDER#: _____

75 HP 3600 RPM 365TS FRAME 575 VOLTS 3 PHASE NEMA DESIGN B

SIEMENS INDSTRY, INC.
PERFORMANCE CURVE
XP100

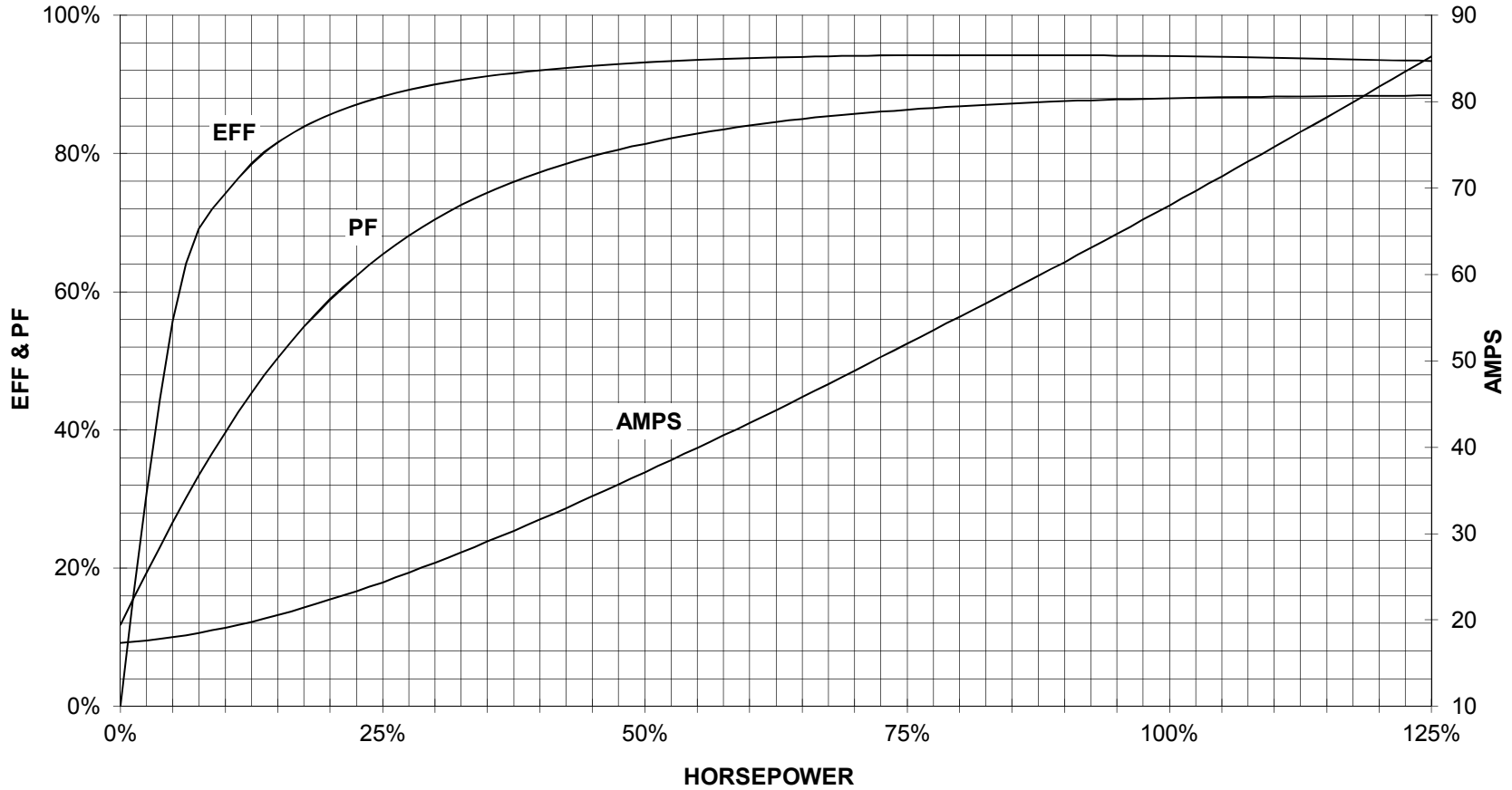

CUSTOMER _____ ORDER # _____ PO # _____

PERFORMANCE BASED ON DESIGN CALCULATIONS. SUBJECT TO CHANGE WITHOUT NOTICE.

REV. 1