

# Data sheet for three-phase Squirrel-Cage-Motors ABB

**Motor type:** FS: 324T - 2p - 40 hp -

Client order no.	Item-No.	Offer no.
Order no.	Consignment no.	Project
Remarks		

## Electrical data

Class I Division 1 Groups D

U [V]	$\Delta/Y$	f [Hz]	P [HP]	P [kW]	n [rpm]	I Load [Amps]					LRC	Nom. Eff Load [%]			Pwr. Factor Load [%]			Torque [lb-ft]	T <sub>A</sub> /T <sub>N</sub> LRT [%]	T <sub>k</sub> /T <sub>N</sub> BDT [%]
						4/4	3/4	1/2	0	4/4		3/4	2/4	4/4	3/4	2/4				
460	$\Delta$	60	40.00		3,535	45.00	34.30	24.90	12.00	290.0	93.6	94.1	94.0	89.0	87.0	80.0	60.0	150	250	
230	$\Delta\Delta$	60	40.00		3,535	90.00	68.62	49.81	24.00	580.0	93.6	94.1	94.0	89.0	87.0	80.0	60.0	150	250	
400	$\Delta$	50	30.00		2,977	39.90	31.50	25.60	17.80	293.0	92.8	92.9	92.4	87.0	83.5	7.5	53.0	200	351	
200	$\Delta\Delta$	50	30.00		2,977	79.80	63.00	51.20	35.60	586.0	92.8	92.9	92.4	87.0	83.5	7.5	53.0	200	351	

Frame Type: PMD_AAA726_001_000_XP1	Type of constr.: (A) Foot mounted - End shield	Motor Prot.:(A) No winding protection	NEMA Des.: B	S.F.: 1.15
Mtr. WT:610 lbs	Insulation Class.:Insulation class F	Temp. Rise Cl.: B	Amb. Temp.: + to -20 °C @1000 m	kVA: G IP IP65

## Mechanical data

Sound level (SPL / SWL) at 60 Hz	77.0 dB(A) / 87.0 dB(A)							Thickener	Polyurea
Octave Band Center Frequencies Hertz								Safe Stall Time Hot	22 s
	250	500	1000	2000	4000	8000	Hz	Safe Stall Time Cold	45 s
SPL@3	56.0	68.0	68.0	70.0	74.0	54.0	dB(A)	Frame material	cast iron
Moment of inertia	4.8 Lb-ft <sup>2</sup>							Color, paint shade	
Ext Load Inertia Capability:	40.0 Lb ft <sup>2</sup>							Coating (paint finish)	Standard Alkyed + Epoxy (C2)
<b>Bearings</b>								<b>Ventilation Type</b>	
Bearing DE   NDE	6312 Z C3 S0			6312 Z C3 S0				Method of cooling	TEFC
Bearing_Type	Ball Bearing			Ball Bearing				Direction of rotation	Bidirectional
AFBMA:	60BC03JP30			60BC03JP30				Fan Material	Polypropylen ESD
<b>Grease</b>								VFD	CT: 4:1 VT: 20:1
Capacity	5.5 oz			5.5 oz				Space heaters	without
Grease Type:	Exxon Mobile EM							Brake:	-/-

## Terminal box

Lead Wire Connection					9 LEAD - DELTA					Terminal box position	(3) Mounting - F-1
Voltage	L1	L2	L3	Connected together						Material of terminal box	Cast Iron
LOW	T1 T7 T6	T2 T8 T4	T3 T9 T5	---						Cable entry	-/-
HIGH	T1	T2	T3	T4 T7-T5 T8-T6 T9							

**Notes:**  
 I<sub>L</sub>/I<sub>N</sub> = locked rotor current / current nominal  
 M<sub>L</sub>/M<sub>N</sub> = locked rotor torque / torque nominal  
 M<sub>d</sub>/M<sub>N</sub> = break down torque / nominal torque  
 3) Value is valid only for DOL operation with motor design IC411  
 2) at rated power / at full load

Responsible department IN LVM	Technical reference	Created by SPC	Approved by	<i>Technical data are subject to change! There may be discrepancies between calculated and rating plate values.</i>			
	Document type Datasheet	Document status Released		customer			
	Title 1MB2221-3AA11-6AA3	Document number					
© ABB 2024	Rev. 01	Creation date 2024-03-06 20:26	Language en	Page 1/1			

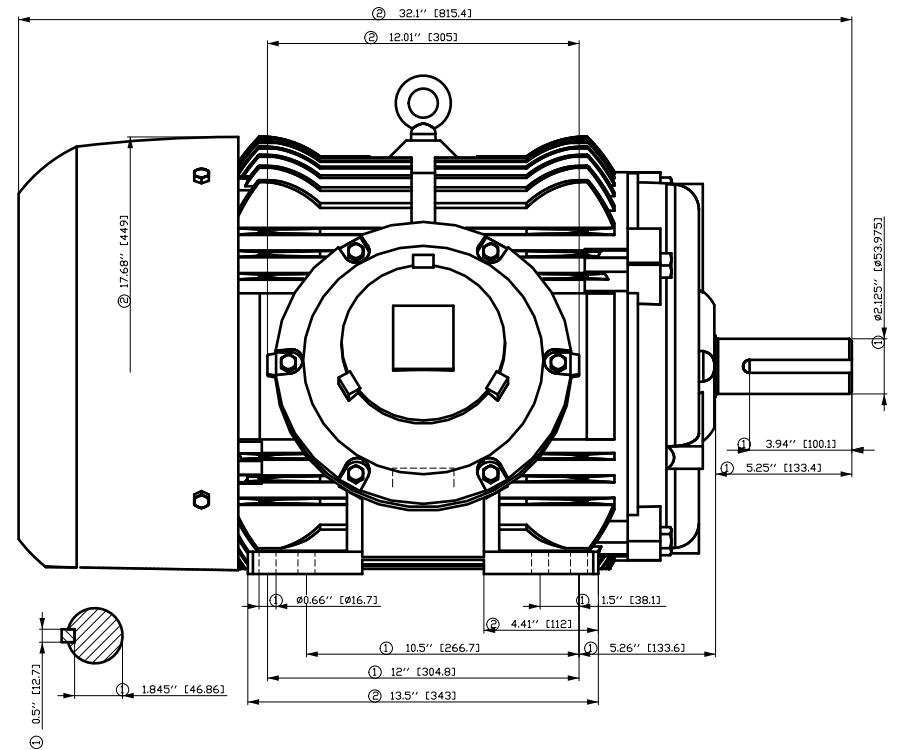
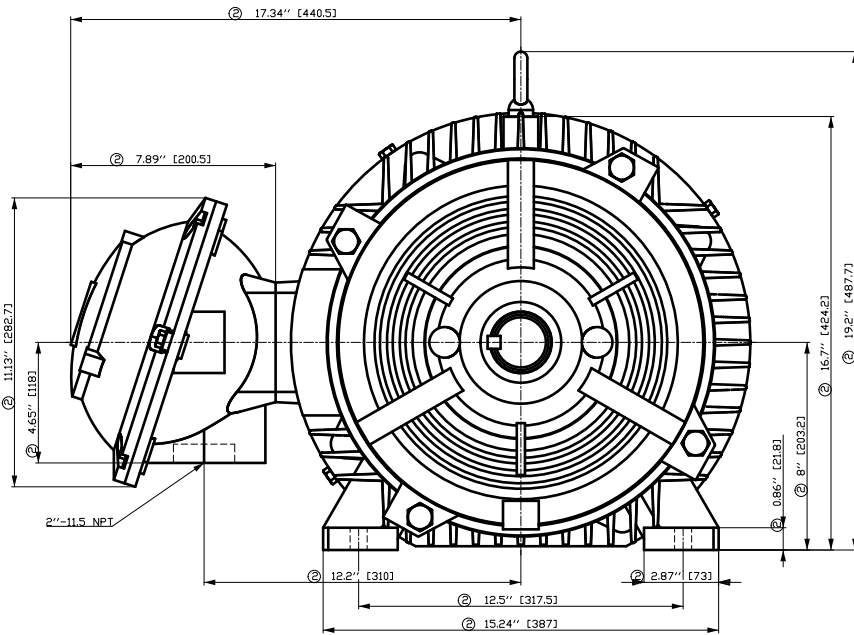

- ① Tolerances according to NEMA std.
- ② All these dimensions corresponding to assemblies and castings shall have a tolerance as per DIN standard 1686-GTB 19.
- ③ Not according to NEMA std.

Tolerance	Surface	Material	Weight	Scale	
	Author	ÖS T: 1.8.2023	E	1:1	
	Creator				
	Approval				
	Department	MFB	Doc Type	/	
	Doc State	HDB	Item No	Paper Size	CH
	Revision	Index RS	Doc No	1st Language	^
				2nd Language	â
© ABB	2023	Project No	E	Ref No	E
				Sheet	F of F

V&@a&@A) aV) \*^ A[ iâ @a) A  
V&@a&@a&A\* ab&@A &@