

Data sheet for three-phase Squirrel-Cage-Motors SIMOTICS

Motor type: **DP200 HPS - Definite Purpose motor - NEMA Premium Efficiency**

FS: **5013S - 2p - 700 hp -**

| | | |
|------------------|-----------------|-----------|
| Client order no. | Item-No. | Offer no. |
| Order no. | Consignment no. | Project |
| Remarks | | |

Electrical data

Class I Division 2 Gr. A, B, C or D T2D

| U [V] | Δ/Y | f [Hz] | P [HP] | P [kW] | n [rpm] | I Load [Amps] | | | | | Nom. Eff Load [%] | | | Pwr. Factor Load [%] | | | Torque [lb-ft] | T _A /T _N LRT [%] | T _k /T _N BDT [%] |
|-------------------|-----------------|---|--------|--------|---------------------------------------|---------------|---|--------|--------|----------------|-------------------|------------|------|----------------------|------|------|----------------|--|--|
| | | | | | | 4/4 | 3/4 | 1/2 | 0 | LRC | 4/4 | 3/4 | 2/4 | 4/4 | 3/4 | 2/4 | | | |
| 460 | $\Delta \Delta$ | 60 | 700.00 | 522.20 | 3,585 | 750 | 568.80 | 399.60 | 160.00 | 5285.0 | 95.8 | 95.6 | 94.8 | 91.1 | 90.4 | 86.5 | 1025.5 | 250 | 290 |
| Frame Type: 5013S | | Type of constr.: (A) Foot Mounted Horizontal (IMB3) | | | Ins. Cl.: Standard Class H Insulation | | Motor Prot.: K: Stator RTD's, 2 Per Phase | | | NEMA Des.: -/- | | S.F.: 1.15 | | | | | | | |
| Mtr. WT: 5,538 | | | | | Temp. Rise Cl.: B | | Amb. Temp.: + 40 to °C @1000 m | | | kVA: G | | IP 55 | | | | | | | |

Mechanical data

| | | | | | | | | | |
|--------------------------------------|--------------------------|------|-------------------------|------------------------------|-------------------|------|-------|----------------------|-----------|
| Sound level (SPL / SWL) at 60 Hz | 93.0 dB(A) / 106.0 dB(A) | | Thickener | Polyurea | | | | | |
| Octave Band Center Frequencies Hertz | | | Safe Stall Time Hot | 23 s | | | | | |
| | 250 | 500 | 1000 | 2000 | 4000 | 8000 | Hz | Safe Stall Time Cold | 28 s |
| SPL@3 | 87.0 | 77.0 | 76.0 | 75.0 | 75.0 | 70.0 | dB(A) | Frame material | Cast iron |
| Moment of inertia | 152.0 Lb-ft ² | | Color, paint shade | RAL 7030 | | | | | |
| Ext Load Inertia Capability: | 503.0 Lb ft ² | | Coating (paint finish) | Standard Alkyed + Epoxy (C2) | | | | | |
| Bearings | | | Ventilation Type | | | | | | |
| Bearing DE NDE | 6316 Z C3 S0 | | 6316 Z C3 S0 insulated | Method of cooling | TEFC | | | | |
| Bearing_Type | Ball Bearing | | Ball Bearing | Direction of rotation | Bi-Directional | | | | |
| AFBMA: | 80BC03JP3 | | 80BC03JP3 | Fan Material | Polypropylene ESD | | | | |
| Grease | | | VFD | CT: 4:1 VT: 20:1 | | | | | |
| Capacity | 9 oz | | 9 oz | Space heaters | without | | | | |
| Grease Type: | Exxon Mobil EM | | Brake: | -/- | | | | | |

Terminal box

| | | | | | | |
|----------------------|--------------------------------|--------------|---------------|--------------------|--------------------------|--|
| Lead Wire Connection | 12 TERMINAL - Connection DELTA | | | | Terminal box position | (1) LHS Mount - View From DE (F-1) - DE or Center of Motor |
| Voltage | L1 | L1 | L1 | Connected together | Material of terminal box | Cast Iron |
| --- | --- | --- | --- | --- | Cable entry | (1) 5" NPT |
| RUN | T12-T7-T6-T1 | T10-T8-T4-T2 | T11-T9-T5-T13 | --- | | |

| | | | | | |
|---|--|---|----------------------------------|---|--|
| Notes: | | | | | |
| I _r /I _N = locked rotor current / current nominal | | M _r /M _N = locked rotor torque / torque nominal | | M _b /M _N = break down torque / nominal torque | |
| 3) Value is valid only for DOL operation with motor design IC411 | | | 2) at rated power / at full load | | |

| | | | | | |
|--|---------------------|------------------|-------------|--|--|
| responsible dep. | technical reference | created by | approved by | <i>Technical data are subject to change! There may be discrepancies between software and hardware versions</i> | |
| DI MC LVM | | DT Configurator | | | |
|  | document type | document status | | customer | |
| | datasheet | released | | | |
| | title | document number | | | |
| | 1PC6521-5FA71-2AK1 | | | | |
| © Siemens AG 2022 | rev. | creation date | language | Page | |
| | 01 | 2022-04-08 01:07 | en | 1/1 | |

刀纸
用
文
全
图
形
按
图
样
印
制

凡在本公司网站上下载的图纸，其版权归本公司所有。未经许可，任何人不得擅自复制或传播。如有违反，本公司将依法追究法律责任。

凡在本公司网站上下载的图纸，其版权归本公司所有。未经许可，任何人不得擅自复制或传播。如有违反，本公司将依法追究法律责任。

凡在本公司网站上下载的图纸，其版权归本公司所有。未经许可，任何人不得擅自复制或传播。如有违反，本公司将依法追究法律责任。

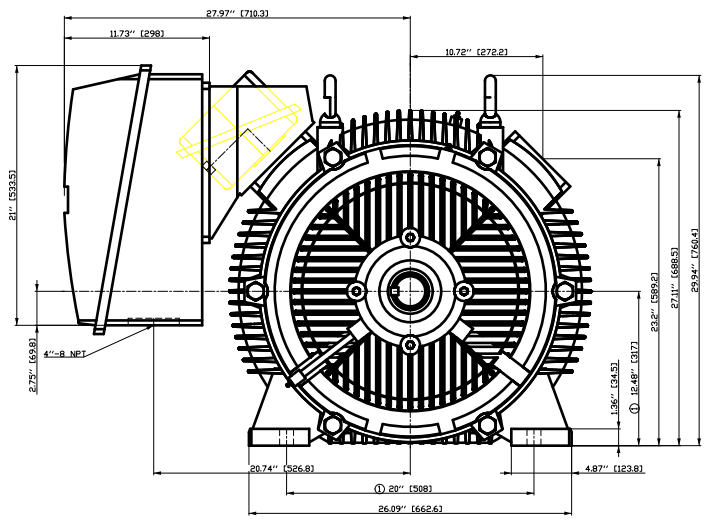

① Tolerances according to NEMA std.
All dimensions corresponding to assemblies and castings shall have a tolerance as per ISD 8062-3 DCTG 12.

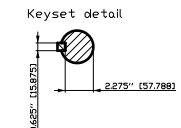
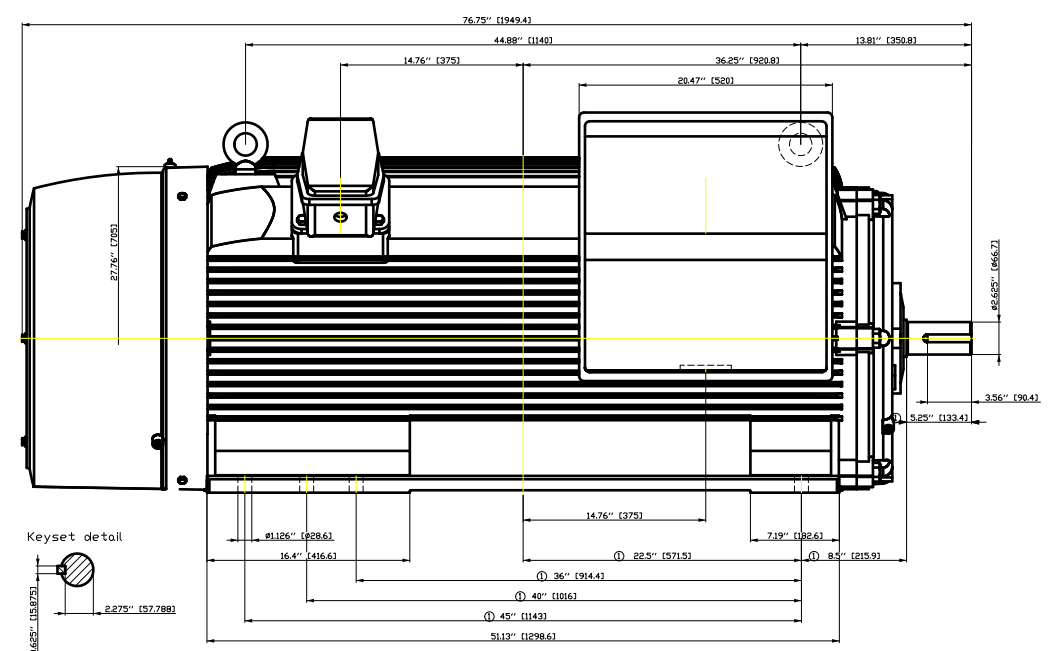

| Tolerance | Surface | Material | Weight | Scale |
|--------------------------|---|---------------------------|--|------------------------|
| | | | É | { { } |
| FÜÖI i G-EÖE FÉÖOSF É | Author Creator Approval Department Change Order | ÖVS T æ : ^æ@ } * | | |
| | Doc. State Revision | MLFB Item No Doc No | Doc Type Paper Size 1st Language 2nd Language | / C-H ^ } â ^ |
| SIEMENS | Index RS | | | |
| © Siemens AG 2018 | Project No É | Ref No É | Sheet F of F | |

SIEMENS INDUSTRY, INC.

HP 700 VOLTS 460 RPM 3585 TYPE SD200
HZ 60 PHASE 3 FRAME 5013S NEMA _____

TORQUE & CURRENT VS. SPEED

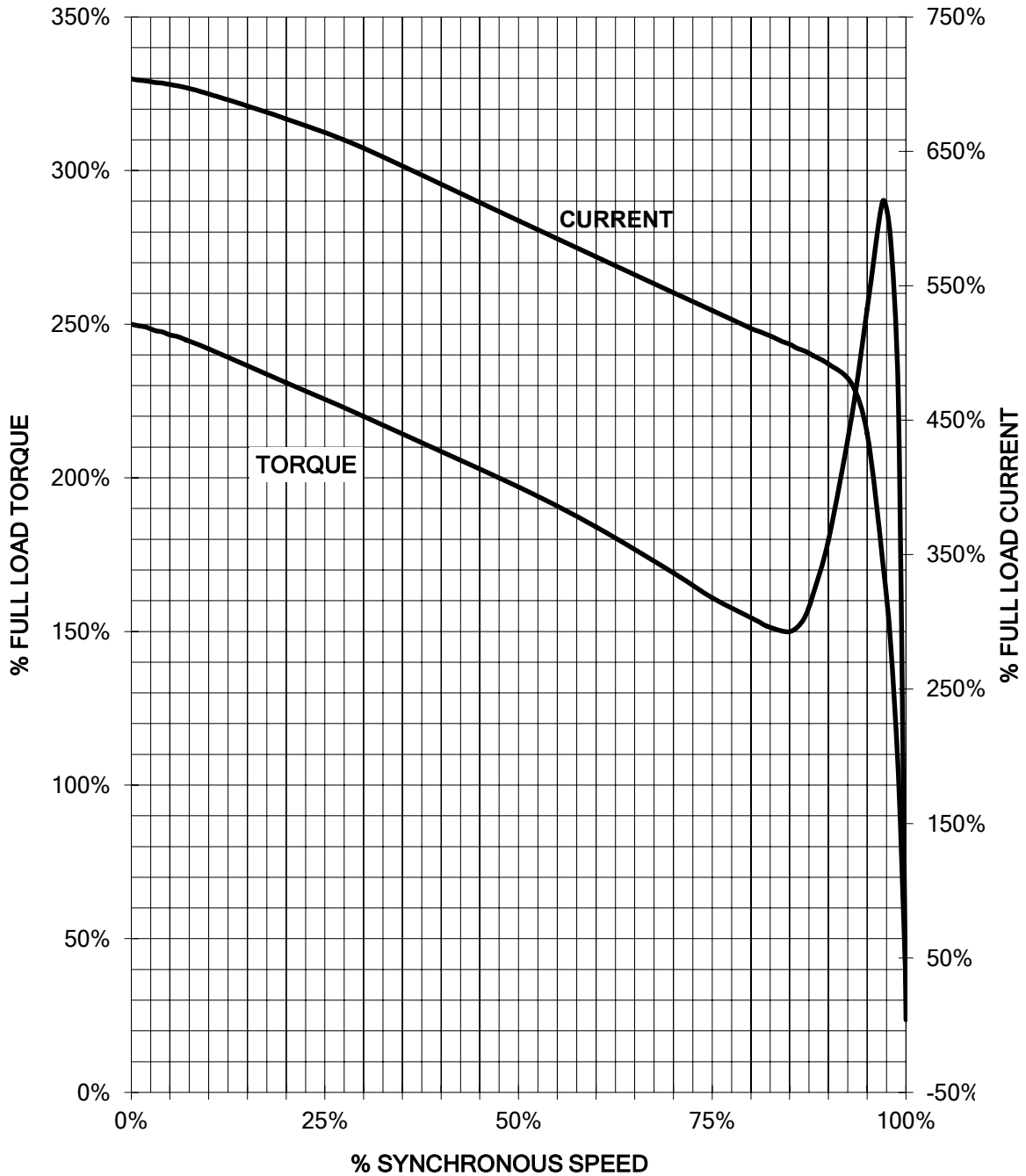

Unrestricted CUSTOMER: _____ ORDER#: _____

Main terminal diagram

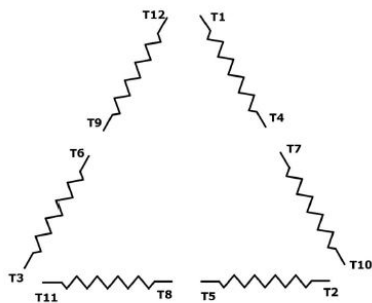

| 12 LEAD DELTA | | |
|---------------|--------------------|-------|
| LINES | CONNECT TOGETHER | CONN. |
| L1 | T12 - T7 - T6 - T1 | ΔΔ |
| L2 | T10 - T8 - T4 - T2 | |
| L2 | T11 - T9 - T5 - T3 | |

Motor protection

3 WIRE STATOR RTDs

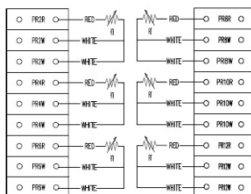

responsible dep.
DI MC LVM

technical reference

created by

approved by

Project

SIEMENS

document type
Wiring Diagram

title
1PC6521-5FA71-2AK1

document status
free

document number

customer