

PRODUCT INFORMATION PACKET

Model No: 056T34T5303

Catalog No: D390

General Purpose Motor, 0.33 HP, 3 Ph, 60 Hz, 208-230/460 V, 3600 RPM, 56C Frame, TENV



Regal and are trademarks of Regal Rexnord Corporation or one of its affiliated companies.
©2022 Regal Rexnord Corporation, All Rights Reserved. MC017097E

Nameplate Specifications

| | | | |
|------------------------|-----------------------|----------------------------|--|
| Output HP | 0.33 Hp | Output KW | 0.25 kW |
| Frequency | 60 Hz | Voltage | 208-230/460 V |
| Current | 1.6-1.8/0.90 A | Speed | 3450 rpm |
| Service Factor | 1.15 | Phase | 3 |
| Efficiency | 65 % | Power Factor | 56 |
| Duty | Continuous | Insulation Class | F |
| Design Code | B | KVA Code | T |
| Frame | 56C | Enclosure | Totally Enclosed Non Ventilated |
| Thermal Protection | No Protection | Ambient Temperature | 40 °C |
| Drive End Bearing Size | 6203 | Opp Drive End Bearing Size | 6203 |
| UL | Recognized | CSA | Y |
| CE | Y | IP Code | 43 |
| Number of Speeds | 1 | | |

Technical Specifications

| | | | |
|-----------------------|------------------------------------|-----------------------|------------------------|
| Electrical Type | Squirrel Cage Induction Run | Starting Method | Across The Line |
| Poles | 2 | Rotation | Reversible |
| Resistance Main | 33.35 Ohms | Mounting | Bolt-on Base |
| Motor Orientation | Horizontal Or Up Or Down | Drive End Bearing | Ball |
| Opp Drive End Bearing | Ball | Frame Material | Rolled Steel |
| Shaft Type | NEMA 56 | Overall Length | 10.43 in |
| Frame Length | 6.56 in | Shaft Diameter | 0.625 in |
| Shaft Extension | 2.06 in | Assembly/Box Mounting | F1 ONLY |
| Outline Drawing | A-100142-656 | Connection Drawing | A-EE7308 |

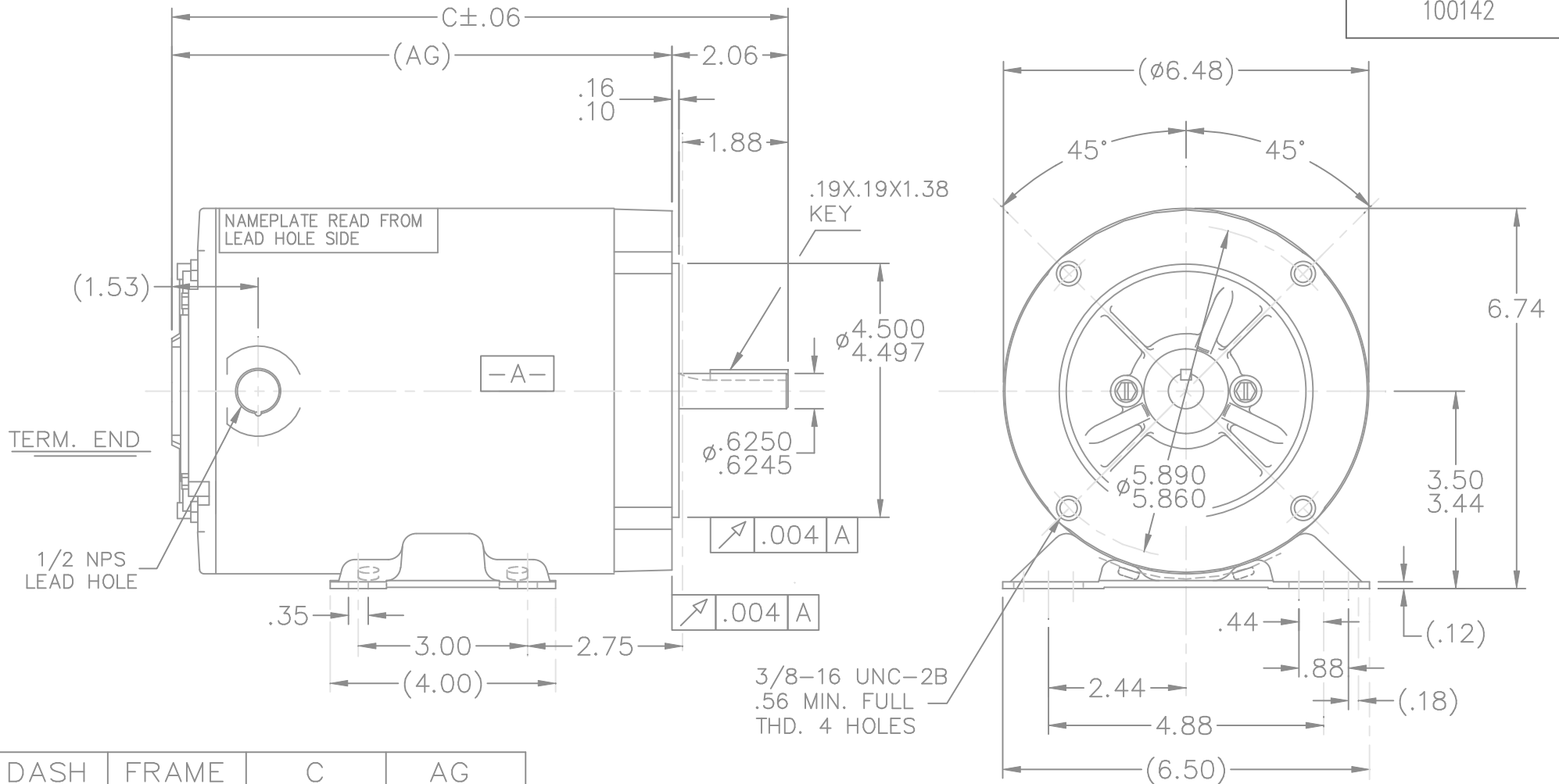

| DASH | FRAME | C | AG |
|------|-------|-------|------|
| 606 | 56-60 | 9.93 | 7.87 |
| 656 | 56-65 | 10.43 | 8.37 |
| | | | |
| | | | |

| | | | | TOLERANCES UNLESS SPECIFIED | | | DRAWN KL 04-15-1994 | | | |
|--|-----------------------------|----------------|-----|-----------------------------|--------------|---|---------------------|--------------------|---------|--------|
| | | | | DEC. | INCHES | | CHK ML 04-16-1994 | | | |
| | | | | .X | $\pm .1$ | | APPD GK 04-16-1994 | | | |
| 5 | REDRAWN IN AUTOCAD | TAT 06-29-2004 | ML | .XX | $\pm .03$ | TITLE OUTLINE 56 FR.-BB-3 PHASE-'C' FACE (DIST.) | SCALE 3=8 | | | |
| 4 | UPDATED TO NEW REAR BRACKET | BLR | | .XXX | $\pm .005$ | | REF | | | |
| 3 | REDRAWN ON CADD - NO CHANGE | KL 04-16-1994 | | .XXXX | $\pm .0005$ | MAT'L. FINISH | FMF | | | |
| NO. | REVISION | BY & DATE | CHK | ANG | $\pm 7'30''$ | | PREV | | | |
| THIS DRAWING IN DESIGN AND DETAIL IS OUR PROPERTY AND MUST NOT BE USED EXCEPT IN CONNECTION WITH OUR WORK ALL RIGHTS OF DESIGN AND INVENTION ARE RESERVED THIS IS AN ELECTRONICALLY GENERATED DOCUMENT - DO NOT SCALE THIS PRINT | | | | RFP | | CAD FILE 100142 | SIZE A | DRAWING NO. 100142 | PAGE OF | REV. 5 |
| | | | | DIST WP | | | | | | |

EE7308

THREE PHASE
DUAL VOLTAGE MOTOR



VIEW OF TERMINAL END

REF.
WINDING DIAGRAM

T8Y, T2Y, T2BL, T4BX, T2EC, T2G
T6BZ, T2B, T6BL, T4AV, T6B, T4B

OPTIONAL CORD
CONNECTION

L1 — WHITE
L2 — RED
L3 — BLACK

| NO. | REVISION | BY & DATE | CHK | ANG | TOLERANCES UNLESS SPECIFIED | | FINISH | DRAWN RM 11/20/1990 | | | | |
|--|--|----------------|-----|-------|--------------------------------|--------|---|---------------------|--------|--------------------|-----------|--------|
| | | | | | DEC. | INCHES | | | | | | |
| 5 | CHG TO REGAL LOGO | SL 09/10/2015 | AB | | | | | CHK ML 11/21/1990 | | | | |
| 4 | REVISED IEC NOTATIONS | MSG 11/15/2011 | CMN | .X | ±.1 | | | APPD SAS 04/24/2003 | | | | |
| 3 | ADDED IEC NOTATIONS... (U1), (V1) ETC. MU95194 | MSG 5/10/2010 | MJS | .XX | ±.02 | | | SCALE 1=1 | | | | |
| 2 | ADDED THE OPTIONAL CORD CONNECTION MU46318 | RDH 04/24/2003 | DRS | .XXX | ±.005 | | TITLE CONNECTION DIAGRAM 3Ø - DUAL VOLTAGE MOTOR | REF | | | | |
| 1 | REDRAWN | RM 11/20/1990 | | .XXXX | ±.0005 | | MAT'L. | FMF | | | | |
| | | | | | ±7'30" | | | PREV | | | | |
| THIS DRAWING IN DESIGN AND DETAIL IS OUR PROPERTY AND MUST NOT BE USED EXCEPT IN CONNECTION WITH OUR WORK ALL RIGHTS OF DESIGN AND INVENTION ARE RESERVED THIS IS AN ELECTRONICALLY GENERATED DOCUMENT - DO NOT SCALE THIS PRINT | | | | | | | RFP | CAD FILE ee7308 | SIZE A | DRAWING NO. EE7308 | PAGE OF 5 | REV. 5 |
| | | | | | | | DIST WP | | | | | |



Regal Beloit America, Inc.

** Subject to change without notice.

MARATHON ELECTRIC CORPORATION

TYPICAL PERFORMANCE CURVE for AC MOTOR

Customer

Curve at

460

Volts

HP 0.33&0.25

PHASE 3

Model No 56T34T5303

60

HZ

VOLTS 208-230/460&190/380

0.33

HP

Catalog No D390

HZ 60&50

RPM 3450&2850

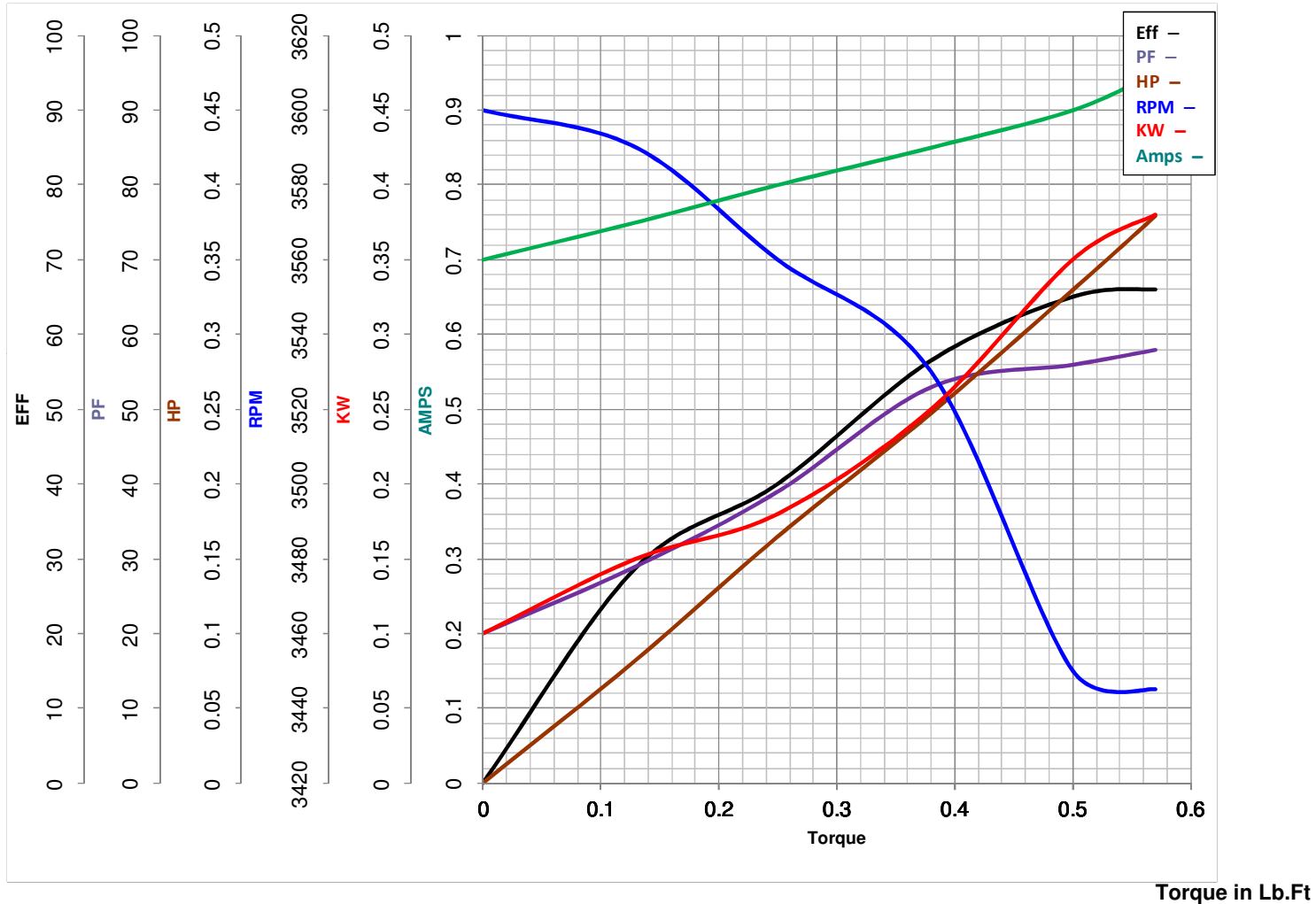

FL TORQUE 0.5 Lb.Ft
 BD TORQUE 3.8 Lb.Ft
 LR TORQUE 2.5 Lb.Ft

FL AMPS 1.6-1.8/1.9
 PU TORQUE 2.1 Lb.Ft
 LR AMPS 8

WINDING ZT206-3

Prepared By VINAYAK

Date 8/25/2017

EC Declaration of Conformity

The undersigned representing
the manufacturer:

Regal Beloit America
100 East Randolph St.
Wausau, WI 54401

and the authorized representative
established within the Community:

Marathon Electric UK
6F Thistleton Road Ind. Estate
Market Overton
Oakham, Rutland LE15 7PP UK

are committed to providing customers with products that comply with applicable regulations and international protocols to which they are subject, including the requirements of the European Parliament Directive on the Harmonization of the laws relating to electrical equipment designed for use within certain voltage limits (2014/35/EU).

Regal Beloit America declares that the following product(s), to which this declaration relates, are in conformity with the relevant sections of the EC standards listed below.

This statement supersedes any statements previously issued pertaining to the product(s) listed below and is subject to change without notice.

Model No : 056T34T5303

(Model No. may contain prefix and/or suffix characters)

Catalog No : D390

Rework No : N/A

Directives :

Low Voltage Directive 2014/35/EU

Harmonized Standards Used :

EN 60034-1: 2010 (IEC 60034-1: 2010)

EN 60034-5: 2001/A1:2007 (IEC 60034-5: 2000/A1:2006)

Authorized Representative:



Michael A. Logsdon
Vice President, Technology

Authorized Representative in the Community:



Julian Clark
Marketing Engineer

Created on 09/01/2022

CE 22