

11 10 9 8 7 6 5 4 3 2 1

Pole	HP	kW	Hz	VOLT	RPM	INS	RATING	DIMENSIONS IN	APPROX WEIGHT	BEARINGS	
4	400	298	60	460	1800	F	CONT.	INCH	3342 LB	DE: 6320	NDE: 6316

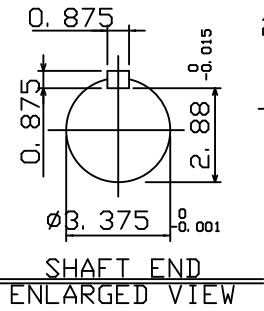
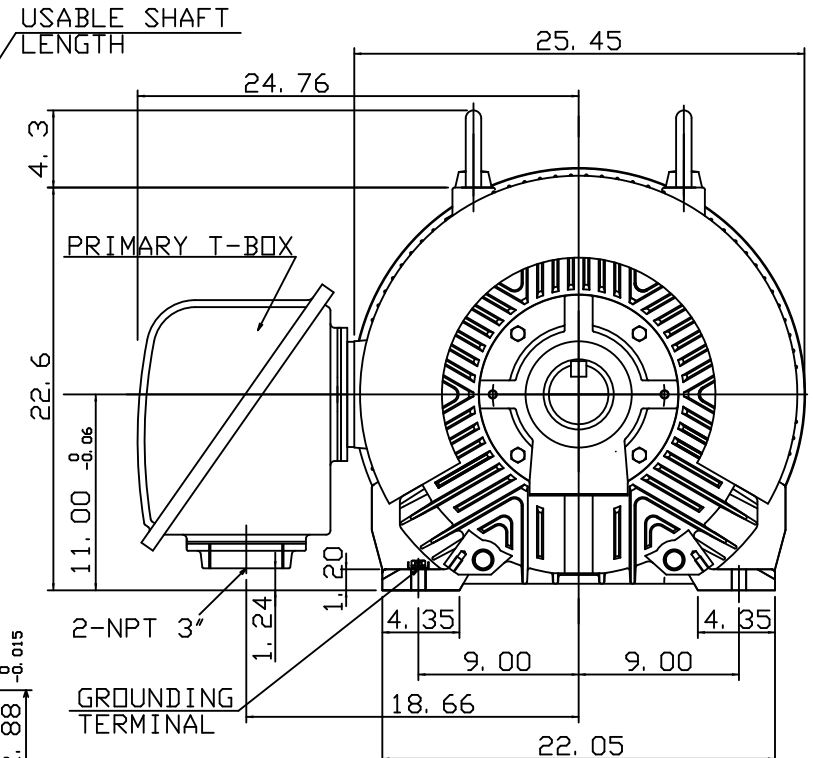
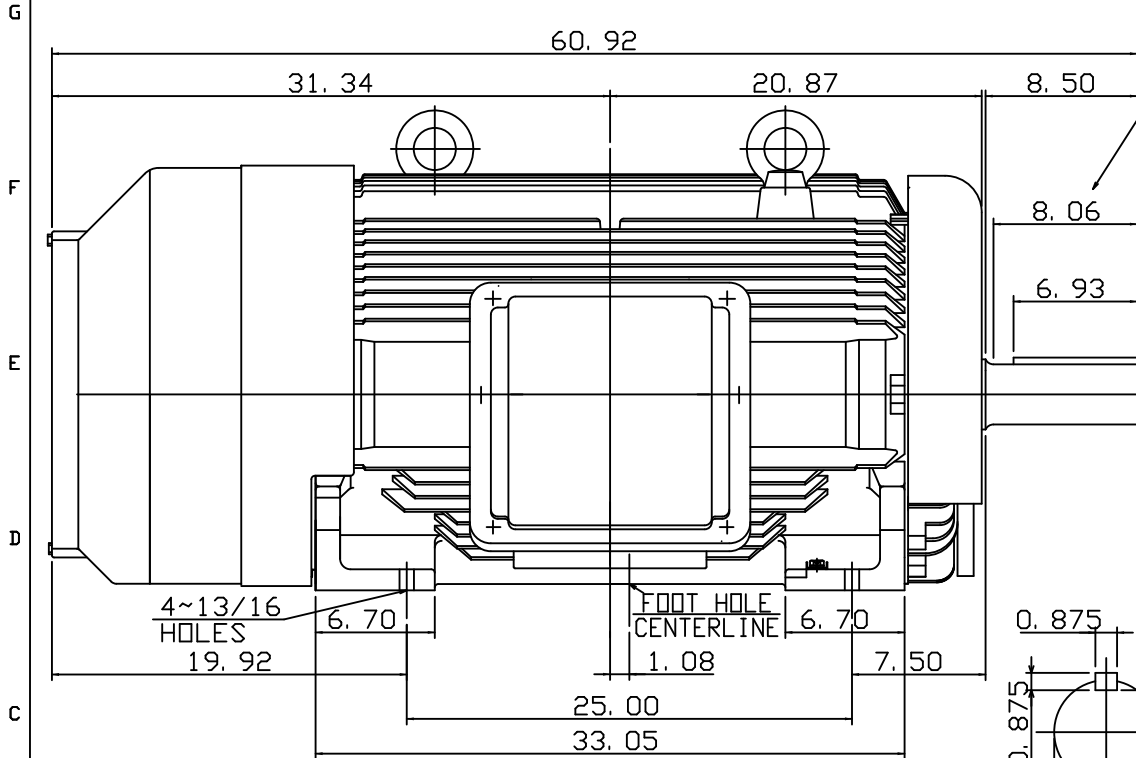

NOTE:  
 1. FOR DIRECT FLEXIBLE COUPLING  
 2. ENCLOSURE: IP55 PROTECTION  
 3. NON-SPARKING FAN

OUTLINE DIMENSIONS			
3-PHASE INDUCTION MOTOR			
MOTOR TYPE	AEHH8N	FRAME	449TX

APPD.	C. COOK	01-21-20

TEC Westinghouse

DWG NO.  
31057C578101

11 10 9 8 7 6 5 4 3 2 1

SPECIFICATION TABLE OF 3-PHASE SQUIRREL CAGE INDUCTION MOTOR	CUSTOMER		USER	
	INQ. NO.		EQUIPMENT	
	JOB NO.	TEX18X057	MACHINE	
	TOTAL SETS		ITEM NO.	

Item	Terms	Description				
1	Model	AEHH8N040400CEX04				
2	Code or Standard	Dimensions	Frame Assignment	Performance	Test	
		NEMA	TECO	NEMA	NEMA	
3	Rating	400 HP 4 Pole 460/(800) Volt 3 Phase 60 Hz				
4	Service Duty	Continuous Rating , Service Factor 1.15				
5	Starting Method	D.O.L(Direct On Line) or Y-Δ Starting				
6	Rotation	Facing The Drive End : CCW(Counter ClockWise), Available for Bi-Direction				
7	Drive Method	Direct Coupling				
8	Environment	Amb. Temp. : -15 ~ 40 °C				
		Humidity : Less Than 90 %RH				
		Altitude : Up to 3300 FT				
9	Enclosure & Protection	IP55 : Totally Enclosed		Indoor		
10	Cooling	TEFC: Totally Enclosed Fan Cooled				
11	Mounting	IM1001 : HS, Foot				
12	Dimensions	Dr#	Frame No : 449TX			
13	Frame & Bracket	Frame : Cast Iron	Bracket : Cast Iron			
14	Fan & Fan Cover	Fan :P.P.(C)	Fan Cover :Cast Iron & SPCC			
15	Terminal Box	Cast Iron				
16	Lead Terminals	[(R38-16)X2]X6				
17	Lubricant	MOBIL(EXXON) POLYREX EM				
18	Painting	Color : MUNSELL N5.0				
19	Stator Winding	Ins. Class F				
20	Rotor Conductor	Al-Die Cast	WK^2 : 135 Lb-ft^2			
21	Starting Performance	LRC 3150 Amp	LRT/FLT 140 %			
22	Operating Performance	Hz/V	60/460		Break Down Torque 370 %FLT	
		%Load	100			
		Amp.	437			
		*LRC=Lock Rotor Current	Eff.%	96.2		Temp. Rise Limit. (Resistance) Stator 115 °C At S.F. 1.15
		*LRT/FLT=Lock Rotor Torque/Full Load Torque	P.F.%	88.9		
		*FLT=Full Load Torque	R.P.M.	1788		
23	Approximate Weight					
24	Note	1.Tolerances according to NEMA MG1-12 & IEC60034-1				

APPD.	Wanghy	Apr. 15 2019		DWG NO.	31057R3297-001
CHKD.	Wanghy	Apr. 15 2019		REV.00	
DWN.	robo8898	Apr. 15 2019		1/1	

DATE:  
March 30, 2006

# CONNECTION DIAGRAM

CATALOG NO.:  
EP3504



**SCHEMATIC -  $\Delta$  / Y CONNECTION**

## ACROSS THE LINE CONNECTION



**460 VOLT CONNECTION**

## WYE START-DELTA RUN CONNECTION



**LINE  
460 VOLT START**



**LINE  
460 VOLT RUN**