



**GE INDUSTRIAL MOTORS**  
a **WOLONG** company

# Product Technical Information

June 22, 2020

Data shown is for the current revision model #. Ensure your nameplate model # matches.

<b>Model Number:</b>	<b>5KS256SAA205D2</b>
<b>Catalog Number:</b>	<b>M9154</b>
<b>Instruction Manual:</b>	GEI-56128
<b>Connection Diagram:</b>	GEM2034E-FIG3
<b>Outline Drawing:</b>	4002B5825PAP5201

## Accessory Connection Diagrams

<b>Bearing Thermocouple:</b>	None	<b>Heater:</b>	None
<b>RTD:</b>	None	<b>Thermistor:</b>	None
<b>Thermostat:</b>	None	<b>Winding Thermocouple:</b>	None
<b>Bearing RTD:</b>	None		

## Table of Contents

Specification	01
Performance Characteristics	02
Outline Drawing	03
Connection Drawing(s)	04
Spare parts	05

Marks:

<b>MODEL NUMBER:</b>	<b>5KS256SAA205D2</b>	<b>Estimated Weight:</b>	350 Lbs
<b>Outline Drawing:</b>	4002B5825PAP5201	<b>Time Rating:</b>	CONT
<b>Connection Diagram:</b>	GEM2034E-FIG3	<b>Enclosure:</b>	TEFC
<b>Instruction Book:</b>	GEI-56128	<b>Encl Construction:</b>	X\$D
<b>Design Code:</b>	25BD1163A	<b>Ambient Max(°C):</b>	40
<b>Type:</b>	KS	<b>Alt Ambient Max(°C):</b>	60
<b>Frame:</b>	256T	<b>Insulation Class:</b>	H
<b>Phases:</b>	3	<b>NEMA Design:</b>	B
<b>Poles:</b>	4	<b>Nominal Efficiency:</b>	93 %
<b>Output Power:</b>	20HP 14.8KW	<b>Guaranteed Efficiency:</b>	92.4 %
<b>RPM:</b>	1775	<b>3/4 Load Efficiency:</b>	93.7 %
<b>Voltage:</b>	230/460	<b>KVA Code:</b>	G
<b>Hertz:</b>	60	<b>Max KVAR:</b>	6.2
<b>Amps - FL:</b>	47.6/23.8	<b>Power Factor:</b>	84.5
<b>Service Factor:</b>	1.25	<b>Bearing - DE:</b>	6309ZC3
<b>Alt Service Factor:</b>	1.00	<b>Bearing - ODE:</b>	6309ZC3

Enclosure is Totally Enclosed Fan-Cooled

---

Stamped Nameplate Notes:

SF AMPS 59.0/29.5

STAMP NP249A5564P051 AS BELOW:

MODEL:5KS256SAA205D2 S/N: XXX

CSA CERTIFIED CSA09.2216219 FOR EX NA IIC 200C GC

CL 1 ZONE2 AEX NA IIC 200C;CL 1 DIV2 GRP ABCD 200C

IN -40C <= AMB <= 40C, 1.0 SF ON SINE-WAVE PWR

SURF TEMP 215C AT 1.25SF ON SINE-WAVE PWR

OR 200 C VT OR 215 C CT OR 200 C CHP PWM CONTROL

ALTERNATE RATING FOR PWM CONTROL 1.0SF 40C AMB

VT 0-60 HZ, CT 6-60 HZ , CHP 60-90 HZ.

Additional Information:

4P - T EXTN

STANDARD FLOOR MOUNT

C/BOX 137 CU IN-1.25 NPT

F1 CONDUIT BOX MOUNTING

OIL RESISTANT SLEEVING ON LEADS



**Performance Characteristics**

1st Winding 1st Connection

**Design: 25BD1163A**

**Marks:**

LOAD %	125.0	115.0	100.0	75.0	50.0	25.0	0.0
% EFF	92.13	92.56	93.31	93.72	93.6	91.02	0.00
% PF	86.08	85.73	84.7	80.92	71.85	49.8	4.4
AMPS	29.5	27.13	23.68	18.51	13.92	10.32	8.63

<b>TORQ(FL)#FT</b>	59.21	<b>TORQ(LR)%FL</b>	203.52	<b>TORQ(BD)%FL</b>	254.89
<b>AMPS(LR)</b>	135.13	<b>PF AT START</b>	0.45		

This motor is capable of two cold or one hot start with a maximum connected load inertia of 653 Lb-Ft Sq (27.49 Kg-meter Sq)at 100% voltage, where the load torque varies with the square of the speed. Acceleration time with maximum inertia and the above load type is 43 seconds. Safe stall time at 100% voltage is 98 seconds cold, 62 seconds hot. Rotor inertia is 3.01 Lb-Ft Sq (0.13 Kg-meter Sq).

<b>Open Circuit A-C:</b>	0.482	<b>Short Circuit D-C:</b>	0.014
<b>Short Circuit A-C:</b>	0.024	<b>X/R Ratio:</b>	5.127
<b>Stator Slots:</b>	48	<b>Rotor Slots:</b>	40

**Speed Torque Current Curve (First Connection, First Speed)**

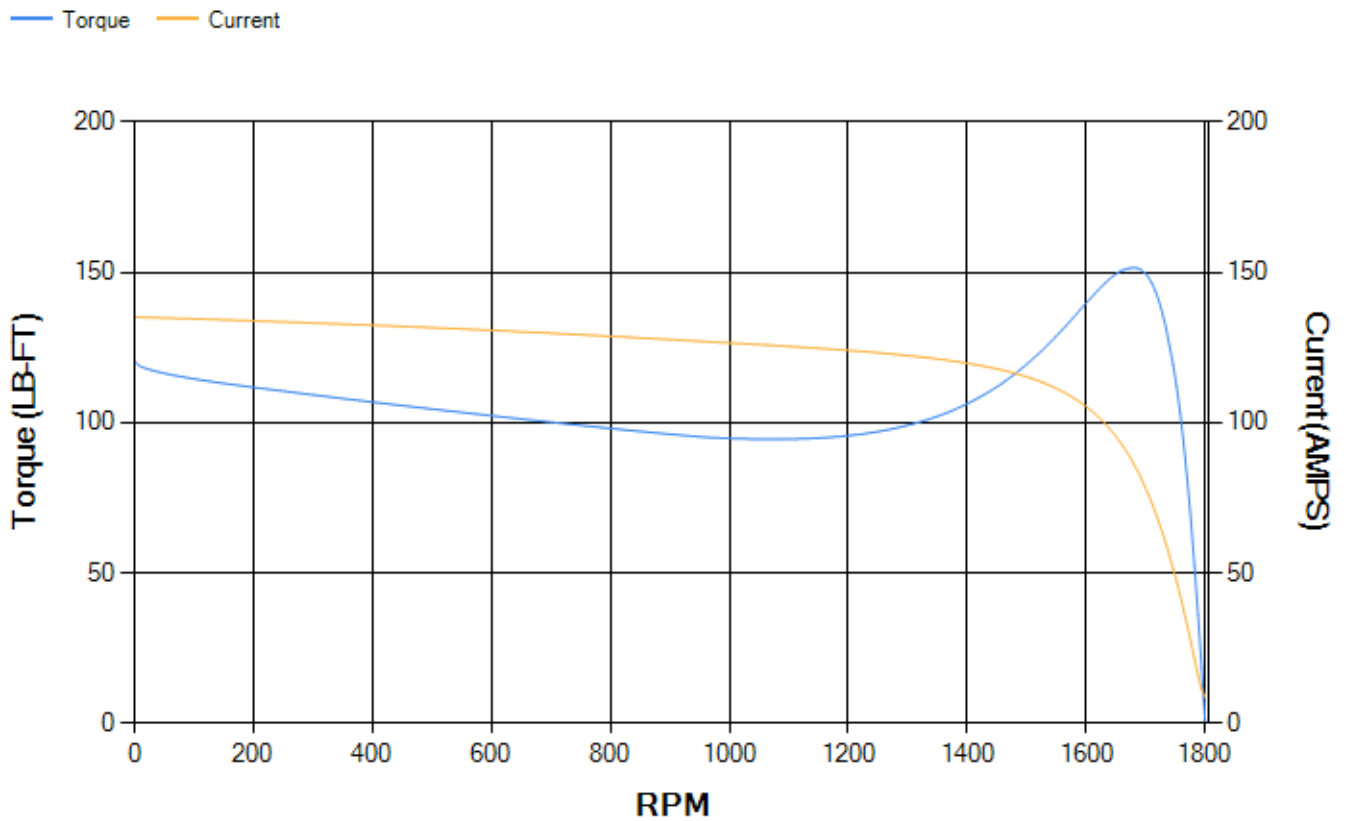

Marks:

NOTE 1: CONDUIT BOX MAY BE ASSEMBLED WITH ENTRANCE UP, DOWN OR TO EITHER SIDE.  
 NOTE 2: F1 ASSEMBLY AS SHOWN, F2 ASSEMBLY CONDUIT BOX ON OPPOSITE SIDE FROM SHOWN LOCATION.  
 NOTE 3: SHAFT RUNOUT WILL NOT EXCEED .002 T.I.R.

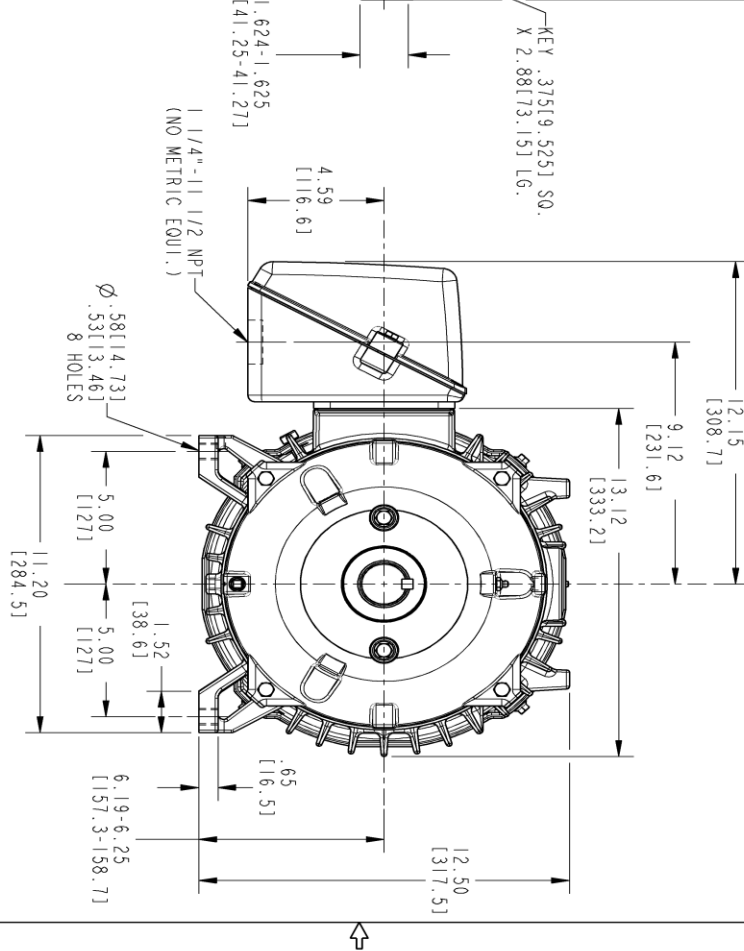
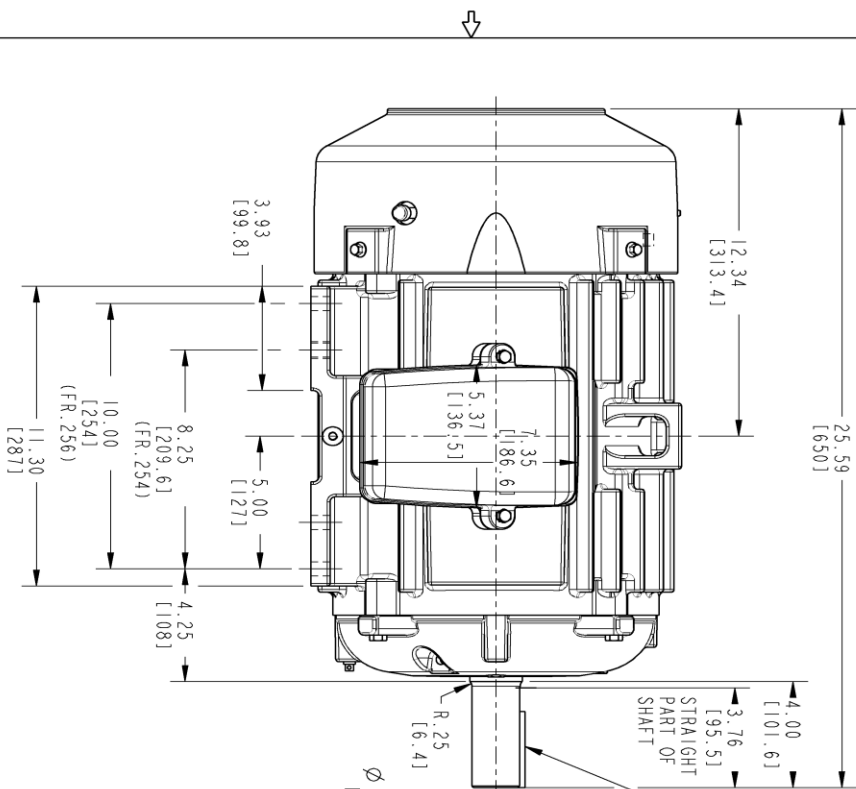

PROPRIETARY INFORMATION  
 All rights reserved. This document and the information it contains is the property of the Moting Electric America LLC and/or its affiliates. It has been provided solely for the use of the customer for the specific project and any other use, reproduction, or distribution is strictly prohibited except as expressly authorized in writing by the Moting Electric America LLC.

REV.	DESCRIPTION	DATE	APPROVED
1	NOTE X80 ULTRA DELETED	05/20/03	SANJAY
2	ISAAC# 09-0868	09/29/09	SAVANTHI
3	ISAAC# 09-1036	12/02/09	RAGHU
4	ISAAC# 12-0025	01/09/11	RAGHU
5	ISAAC# 18-0869	11/05/18	PRAASHANTH

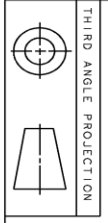

SIGNATURES	DATE	<p><b>GE INDUSTRIAL MOTORS</b>                  a WOLONG company</p> <p><b>INDUCTION MOTOR OUTLINE</b>                  STANDARD CONSTRUCTION</p> <p>FMR: FR250T TFC</p>
MODEL	01/16/02	
DETAIL	01/16/02	
DESIGN	01/16/02	
ENG		
ISSUED	01/05/02	SCALE: 0.250
SOLID MODEL: 4002B5825PAP5201		REF. No.: 4002B5825PAP201
<p><b>4002B5825PAP5201</b></p>		SHEET 1 OF 1

Marks:

**Connection Diagram**  
**GEM2034E-FIG3**

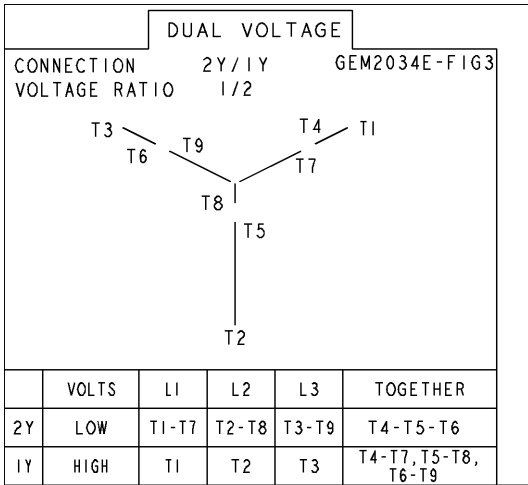

End shield Assembly		
Part Description	DE Side Part#	ODE Side Part#
End Shield	4004D5283PB1	4004D5283SE1
Bearing	235A2507EB01	235A2507EB01
Slinger/Inproseal	149C4399G02	149C4399G02

Fan & Fan Cover Assembly	
Part Description	Part#
Fan	159C6700G02
Fan Cover	4003C5788PA1

Conduit & Accessories Box Assembly	
Part Description	Part#
Conduit Box	4002B5728PA-G04

Mechanical Accessories	
Part Description	Part#
Brake	
Tachometer	

