



GE INDUSTRIAL MOTORS
a **WOLONG** company

Product Technical Information

June 23, 2020

Data shown is for the current revision model #. Ensure your nameplate model # matches.

| | |
|----------------------------|----------------------|
| Model Number: | 5KS143XAA140C |
| Catalog Number: | M9378 |
| Instruction Manual: | GEI-56128 |
| Connection Diagram: | GEM2034E-FIG1 |
| Outline Drawing: | 4002B5814PBP5311 |

Accessory Connection Diagrams

| | | | |
|------------------------------|------|------------------------------|------|
| Bearing Thermocouple: | None | Heater: | None |
| RTD: | None | Thermistor: | None |
| Thermostat: | None | Winding Thermocouple: | None |
| Bearing RTD: | None | | |

Table of Contents

| | |
|-----------------------------|----|
| Specification | 01 |
| Performance Characteristics | 02 |
| Outline Drawing | 03 |
| Connection Drawing(s) | 04 |
| Spare parts | 05 |

Marks:

| | | | |
|----------------------------|----------------------|-------------------------------|---------|
| MODEL NUMBER: | 5KS143XAA140C | Estimated Weight: | 43 Lbs |
| Outline Drawing: | 4002B5814PBP5311 | Time Rating: | CONT |
| Connection Diagram: | GEM2034E-FIG1 | Enclosure: | TEFC |
| Instruction Book: | GEI-56128 | Encl Construction: | 841 |
| Design Code: | 14BD0040A | Ambient Max(°C): | 40 |
| Type: | KS | Alt Ambient Max(°C): | -- |
| Frame: | 143TC | Insulation Class: | H |
| Phases: | 3 | NEMA Design: | B |
| Poles: | 2 | Nominal Efficiency: | 84 % |
| Output Power: | 1.5HP 1.1KW | Guaranteed Efficiency: | 82.5 % |
| RPM: | 3530 | 3/4 Load Efficiency: | 83.9 % |
| Voltage: | 460 | KVA Code: | M |
| Hertz: | 60 | Max KVAR: | 0.7 |
| Amps - FL: | 2.1 | Power Factor: | 79.0 |
| Service Factor: | 1.15 | Bearing - DE: | 6206ZC3 |
| Alt Service Factor: | -- | Bearing - ODE: | 6205ZC3 |

Enclosure is Totally Enclosed Fan-Cooled

Stamped Nameplate Notes:

IEEE-STD-841-2009
 DE BRG 30BC02JP30 ODE BRG 25BC02JP30
 STAMP NP249A5564P051 AS BELOW:
 MODEL:5KS143XAA140C S/N: XXX
 CSA CERTIFIED CSA09.2216219 FOR EX NA IIC 200 C GC
 CL1 ZONE2 AEXNAIIC 200C FOR CL1DIV2 GRP ABCD 200C
 IN -25C <= AMB <= 40C, 1.0SF ON SINE-WAVE PWR
 SURF TEMP 200 C AT 1.15 SF ON SINE-WAVE PWR
 OR 200 C VT OR 200 C CT OR 200 C CHP PWM CONTROL
 ALTERNATE RATING FOR PWM CONTROL 1.0SF 40C AMB
 VT 0-60 HZ, CT 3-60 HZ, CHP 60-90 HZ.

Additional Information:

2P - T EXTN
 STANDARD FLOOR MOUNT
 C/BOX 30 CU IN-0.75 NPT
 F1 CONDUIT BOX MOUNTING
 "C" FACE AT DE ENDSHIELD
 PAINTED FRAME ID & SHAFT,
 FAN COVER INSIDE & ODE E/S OUTSIDE
 ROUTINE AND 5 POINT VIBRATION TESTS INCL IN C/BOX
 INPRO SEAL BOTH ENDS
 GROUND SCREW ON FRAME
 SHAFT RUNOUT LIMIT .001" TIR
 COPPER WASHER UNDER HEADS OF BEARING CAP BOLTS
 APPLY TITE-SEAL (A50CD427A) ON BEARING CAP SCREWS, RABBETS,
 AND PLUG THREADS



OIL RESISTANT SLEEVING ON LEADS



Performance Characteristics

1st Winding 1st Connection

Design: 14BD0040A

Marks:

| LOAD % | 125.0 | 115.0 | 100.0 | 75.0 | 50.0 | 25.0 | 0.0 |
|--------|-------|-------|-------|-------|-------|-------|-------|
| % EFF | 84.06 | 84.32 | 84.67 | 83.83 | 80.98 | 71.27 | 0.00 |
| % PF | 83 | 81.57 | 82.69 | 71.62 | 59.46 | 39.52 | 12.53 |
| AMPS | 2.52 | 2.35 | 1.99 | 1.75 | 1.46 | 1.25 | 0.96 |

| | | | | | |
|--------------------|-------|--------------------|--------|--------------------|--------|
| TORQ(FL)#FT | 2.23 | TORQ(LR)%FL | 328.14 | TORQ(BD)%FL | 443.62 |
| AMPS(LR) | 18.18 | PF AT START | 0.57 | | |

This motor is capable of two cold or one hot start with a maximum connected load inertia of 12 Lb-Ft Sq (0.51 Kg-meter Sq)at 100% voltage, where the load torque varies with the square of the speed. Acceleration time with maximum inertia and the above load type is 23 seconds. Safe stall time at 100% voltage is 50 seconds cold, 37 seconds hot. Rotor inertia is 0.04 Lb-Ft Sq (0 Kg-meter Sq).

| | | | |
|---------------------------|-------|---------------------------|-------|
| Open Circuit A-C: | 0.254 | Short Circuit D-C: | 0.005 |
| Short Circuit A-C: | 0.01 | X/R Ratio: | 1.805 |
| Stator Slots: | 24 | Rotor Slots: | 34 |

Speed Torque Current Curve (First Connection, First Speed)

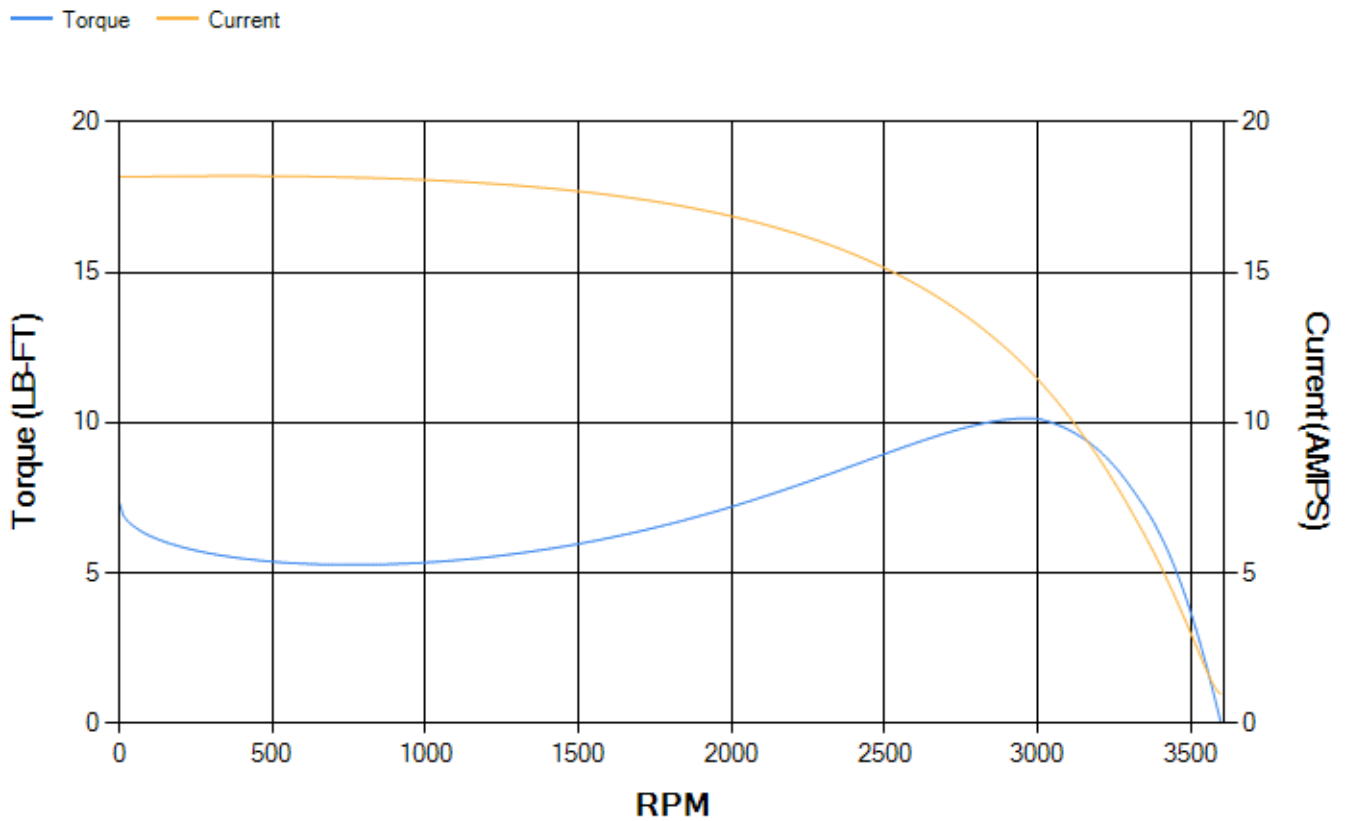

Marks:

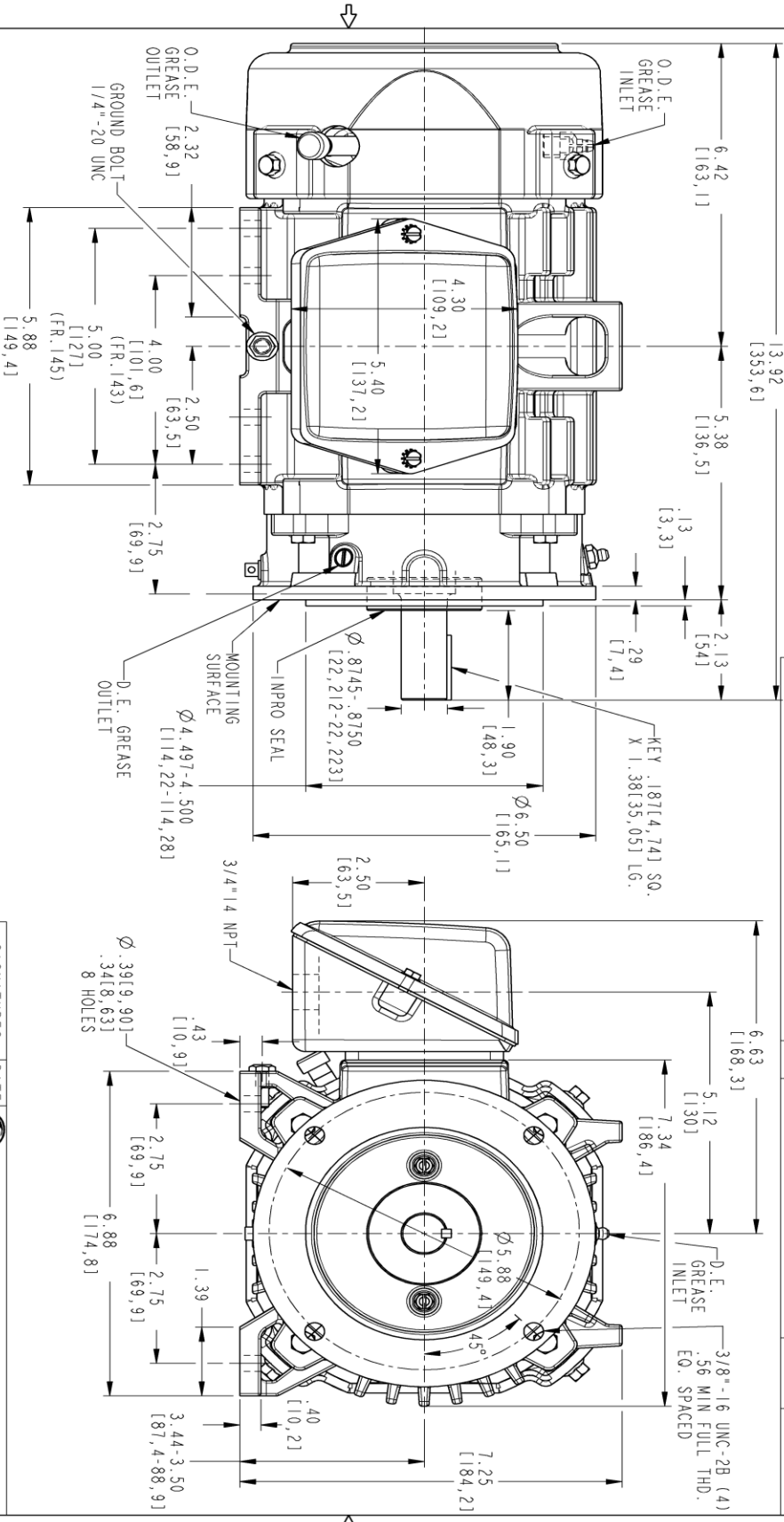

PROPRIETARY INFORMATION
 © COPYRIGHT 2018 Wolog Electric America LLC AND/OR ITS AFFILIATES.
 All rights reserved. This document and the information it contains is the property of
 the Wolog Electric America LLC and/or its affiliates. It has been provided solely for
 your use and is not to be distributed, copied, or used for any other purpose without
 the express written permission of Wolog Electric America LLC. Any other use is
 strictly prohibited except as expressly authorized in writing by
 the Wolog Electric America LLC.

| REV. | DESCRIPTION | DATE | APPROVED |
|------|---------------|----------|-----------|
| 1 | ISAC# 18-0869 | 10/23/18 | PRASHANTH |

| | |
|------------------|-----|
| SIZE DRAWING NO. | B |
| REV | 001 |
| SHEET | 1 |
| REVISIONS | |



NOTE 1: CONDUIT BOX MAY BE ASSEMBLED WITH ENTRANCE UP, DOWN OR TO EITHER SIDE.
 NOTE 2: F1 ASSEMBLY AS SHOWN. F2 ASSEMBLY CONDUIT BOX ON OPPOSITE SIDE FROM SHOWN LOCATION.
 NOTE 3: MOUNTING SURFACES WILL BE SQUARE AND CONCENTRIC WITH SHAFT WITHIN .004 T.I.R.
 NOTE 4: SHAFT RUNOUT WILL NOT EXCEED .001 T.I.R.
 NOTE 5: ALL DIMENSIONS ARE IN INCHES, BRACKETED DIMENSIONS ARE IN METRIC (MILLIMETERS).

| SIGNATURES | DATE | GE INDUSTRIAL MOTORS a Wolog company |
|-------------------------------|----------|--|
| MODEL: TEJASNI | 06/08/15 | TITLE INDUCTION MOTOR OUTLINE IEEE-841 SPEC, "C" FACE AT DE 14.50" RABBIT) FR. 143/METC TERC |
| DETAIL: TEJASNI | 06/08/15 | |
| DESIGN: ADI | 06/08/15 | |
| ENGR: VENKAT | 06/08/15 | |
| QC: [blank] | [blank] | |
| ISSUED: TEJASNI | 06/08/15 | QUALITY SIZE DRAWING 4002B5814PBP5311 |
| SOLID MODEL: 4002B5814PBP5311 | B | SCALE: 0.500 REF. No.: 4002B5814PBP5301 |

Marks:

Connection Diagram
GEM2034E-FIG1



End shield Assembly

| Part Description | DE Side Part# | ODE Side Part# |
|-------------------|---------------|----------------|
| End Shield | 4004D5289PB1 | 4004D5280SG1 |
| Bearing | 235A2502AM01 | 235A2500AF01 |
| Slinger/Inproseal | 4002B5914AM1 | 4002B5914AG1 |

Fan & Fan Cover Assembly

| Part Description | Part# |
|------------------|-----------------|
| Fan | 4001A5914AM-G01 |
| Fan Cover | 4003C5785PA1 |

Conduit & Accessories Box Assembly

| Part Description | Part# |
|------------------|-----------------|
| Conduit Box | 4002B5718PA-G01 |

Mechanical Accessories

| Part Description | Part# |
|------------------|-------|
| Brake | |
| Tachometer | |

