

DATA SHEET

Three Phase Induction Motor - Squirrel Cage



Customer :				
Product line		: NEMA Premium Efficiency Three-Phase	Product code :	14281643
			Catalog # :	00212XT3E184TC
Frame	: 182/4TC	Cooling method	: IC411 - TEFC	
Insulation class	: F	Mounting	: F-1	
Duty cycle	: Cont.(S1)	Rotation ¹	: Both (CW and CCW)	
Ambient temperature	: -20°C to +40°C	Starting method	: Direct On Line	
Altitude	: 1000 m.a.s.l.	Approx. weight ²	: 137 lb	
Protection degree	: IP55	Moment of inertia (J)	: 0.5323 sq.ft.lb	
Design	: B			
Output [HP]	2	2	2	2
Poles	6	6	6	6
Frequency [Hz]	60	50	50	50
Rated voltage [V]	230/460	380	400	415
Rated current [A]	6.26/3.13	3.66	3.59	3.56
L. R. Amperes [A]	46.9/23.5	22.0	24.1	25.3
LRC [A]	7.5x(Code L)	6.0x(Code J)	6.7x(Code K)	7.1x(Code L)
No load current [A]	4.00/2.00	1.80	1.95	2.05
Rated speed [RPM]	1165	955	960	965
Slip [%]	2.92	4.50	4.00	3.50
Rated torque [ft.lb]	9.02	11.0	10.9	10.9
Locked rotor torque [%]	300	220	260	300
Breakdown torque [%]	330	240	270	300
Service factor	1.15	1.00	1.00	1.00
Temperature rise	80 K	80 K	80 K	80 K
Locked rotor time	82s (cold) 46s (hot)	95s (cold) 53s (hot)	84s (cold) 47s (hot)	75s (cold) 42s (hot)
Noise level ²	52.0 dB(A)	49.0 dB(A)	49.0 dB(A)	49.0 dB(A)
Efficiency (%)	25%			
	50%	84.5	87.0	86.5
	75%	86.5	87.5	87.5
	100%	88.5	86.5	87.5
Power Factor	25%			
	50%	0.47	0.53	0.49
	75%	0.58	0.65	0.62
	100%	0.68	0.72	0.69
Bearing type	: <u>Drive end</u> 6307 2RS <u>Non drive end</u> 6206 2RS	Foundation loads		
Sealing	: Oil Seal Lip Seal	Max. traction	: 140 lb	
Lubrication interval	: - -	Max. compression	: 277 lb	
Lubricant amount	: - -			
Lubricant type	: Mobil Polyrex EM			
Notes USABLE @208V 6.92A SF 1.15 SFA 7.96A				
This revision replaces and cancel the previous one, which must be eliminated. (1) Looking the motor from the shaft end. (2) Measured at 1m and with tolerance of +3dB(A). (3) Approximate weight subject to changes after manufacturing process. (4) At 100% of full load.		These are average values based on tests with sinusoidal power supply, subject to the tolerances stipulated in NEMA MG-1.		
Rev.	Changes Summary		Performed	Checked
Performed by			Page	Revision
Checked by				
Date	14/04/2022			
			1 / 22	

DATA SHEET

Three Phase Induction Motor - Squirrel Cage



Customer : _____

Thermal protection

ID	Application	Type	Quantity	Sensing Temperature
1	Winding	Thermostat - 2 wires	1 x Phase	155 °C

Rev.	Changes Summary	Performed	Checked	Date
Performed by				
Checked by			Page	Revision
Date	14/04/2022		2 / 22	

TORQUE AND CURRENT VS SPEED CURVE



Three Phase Induction Motor - Squirrel Cage

Customer :

Product line : NEMA Premium Efficiency Three-Phase

Product code : 14281643

Catalog # : 00212XT3E184TC

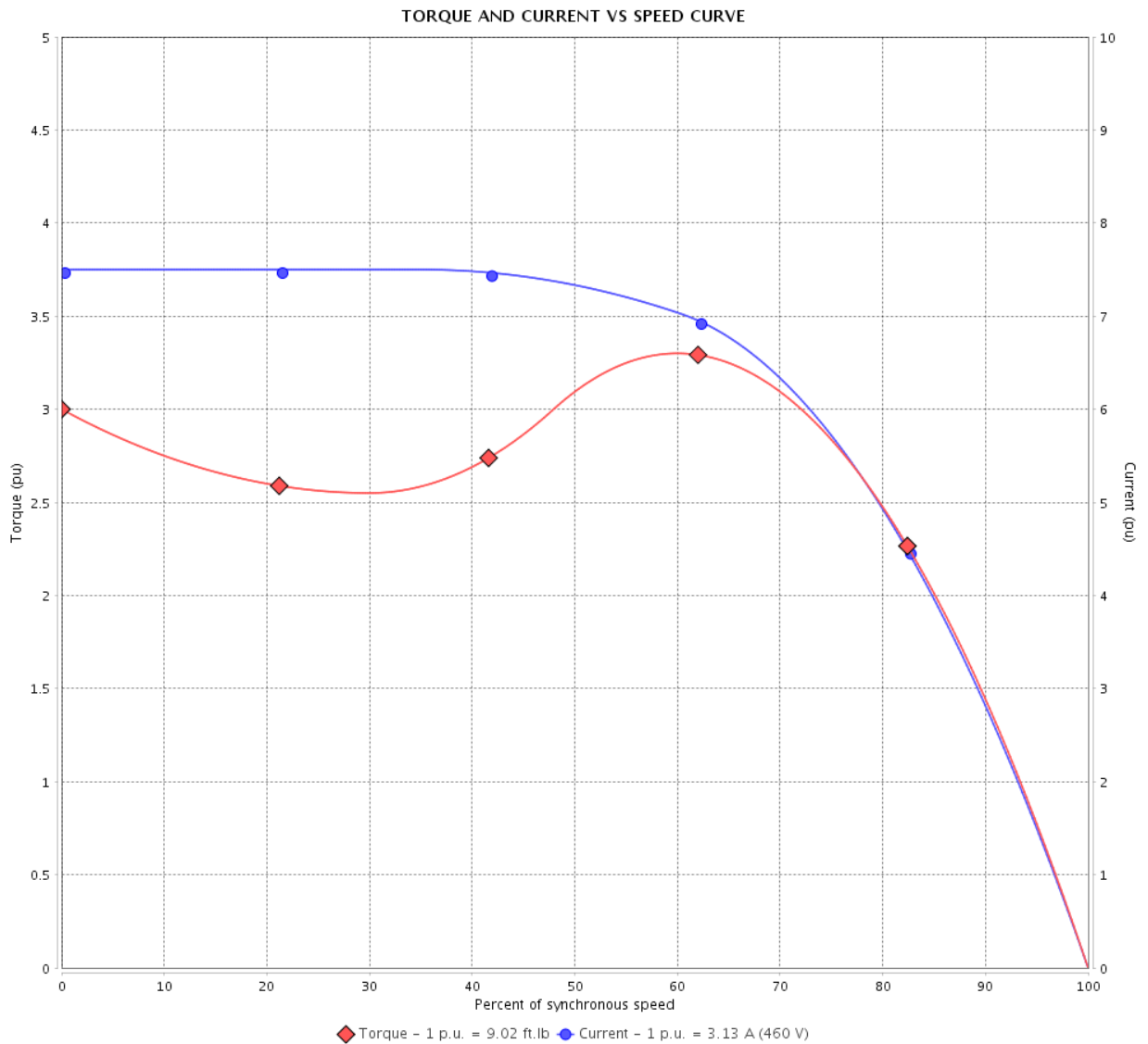

Performance : 230/460 V 60 Hz 6P

Rated current : 6.26/3.13 A
 LRC : 7.5
 Rated torque : 9.02 ft.lb
 Locked rotor torque : 300 %
 Breakdown torque : 330 %
 Rated speed : 1165 rpm

Moment of inertia (J) : 0.5323 sq.ft.lb
 Duty cycle : Cont.(S1)
 Insulation class : F
 Service factor : 1.15
 Temperature rise : 80 K
 Design : B

Locked rotor time : 82s (cold) 46s (hot)

Rev.	Changes Summary	Performed	Checked	Date
Performed by			Page 3 / 22	Revision
Checked by				
Date	14/04/2022			

TORQUE AND CURRENT VS SPEED CURVE

Three Phase Induction Motor - Squirrel Cage



Customer :

Product line : NEMA Premium Efficiency Three-Phase

Product code : 14281643

Catalog # : 00212XT3E184TC

TORQUE AND CURRENT VS SPEED CURVE

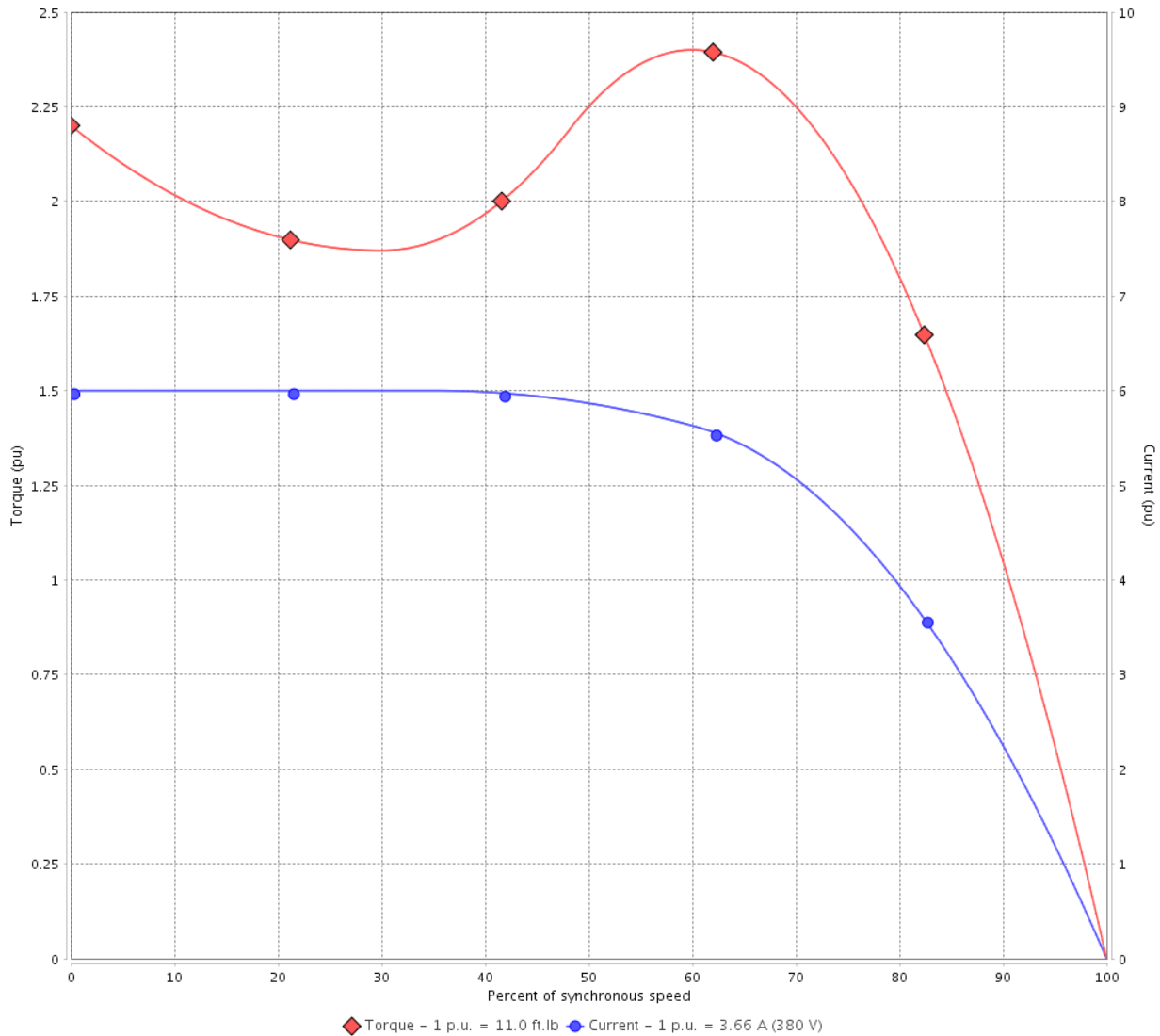

Performance : 380 V 50 Hz 6P IE4

Rated current	: 3.66 A	Moment of inertia (J)	: 0.5323 sq.ft.lb
LRC	: 6.0	Duty cycle	: Cont.(S1)
Rated torque	: 11.0 ft.lb	Insulation class	: F
Locked rotor torque	: 220 %	Service factor	: 1.00
Breakdown torque	: 240 %	Temperature rise	: 80 K
Rated speed	: 955 rpm	Design	: B

Locked rotor time : 95s (cold) 53s (hot)

Rev.	Changes Summary	Performed	Checked	Date
Performed by			Page 4 / 22	Revision
Checked by				
Date	14/04/2022			

TORQUE AND CURRENT VS SPEED CURVE



Three Phase Induction Motor - Squirrel Cage

Customer :

Product line : NEMA Premium Efficiency Three-Phase

Product code : 14281643

Catalog # : 00212XT3E184TC

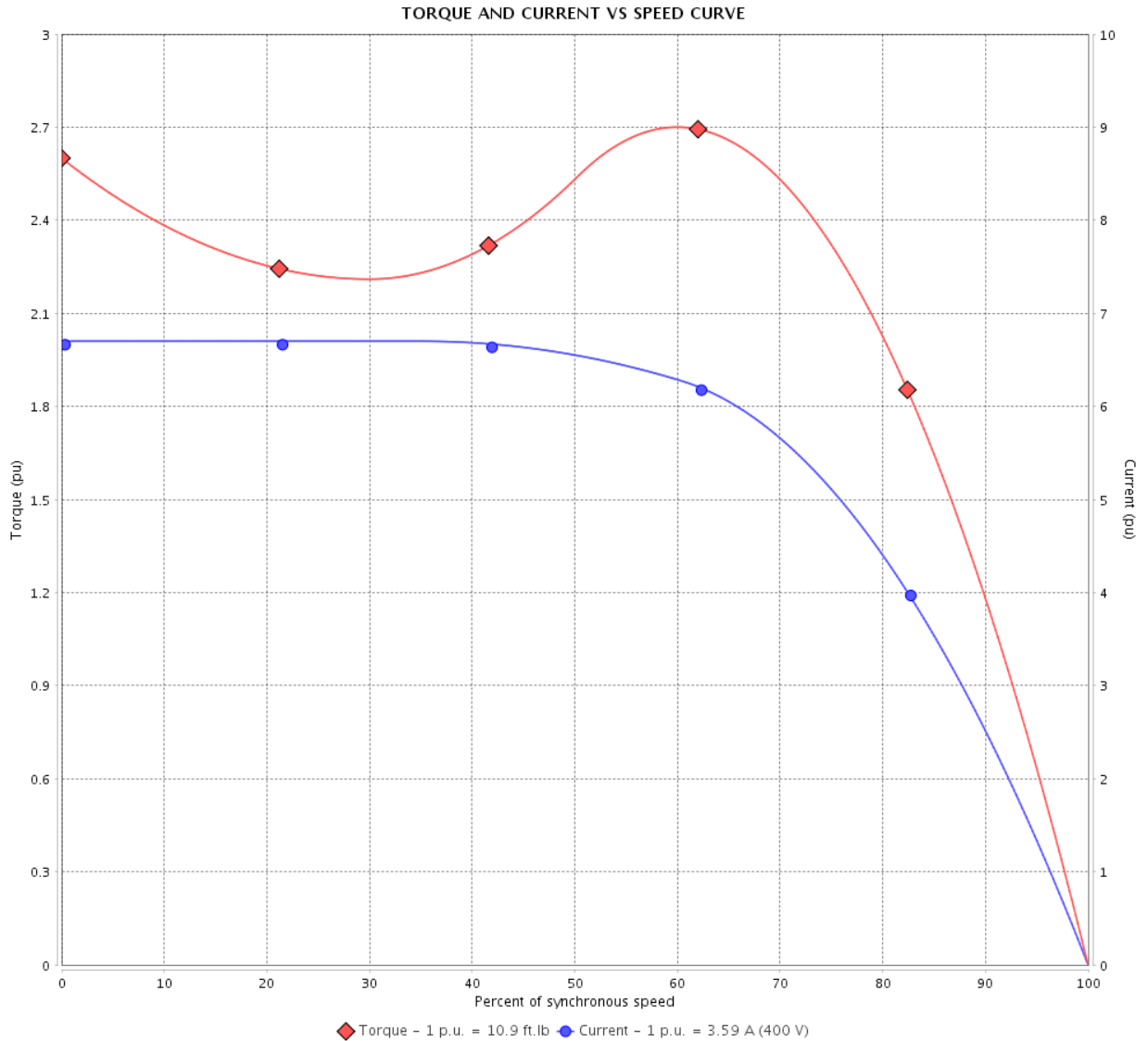

Performance : 400 V 50 Hz 6P IE4

Rated current	: 3.59 A	Moment of inertia (J)	: 0.5323 sq.ft.lb
LRC	: 6.7	Duty cycle	: Cont.(S1)
Rated torque	: 10.9 ft.lb	Insulation class	: F
Locked rotor torque	: 260 %	Service factor	: 1.00
Breakdown torque	: 270 %	Temperature rise	: 80 K
Rated speed	: 960 rpm	Design	: B

Locked rotor time : 84s (cold) 47s (hot)

Rev.	Changes Summary	Performed	Checked	Date
Performed by		Page		Revision
Checked by		5 / 22		
Date	14/04/2022			

TORQUE AND CURRENT VS SPEED CURVE

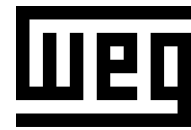

Three Phase Induction Motor - Squirrel Cage

Customer :

Product line : NEMA Premium Efficiency Three-Phase

Product code : 14281643

Catalog # : 00212XT3E184TC

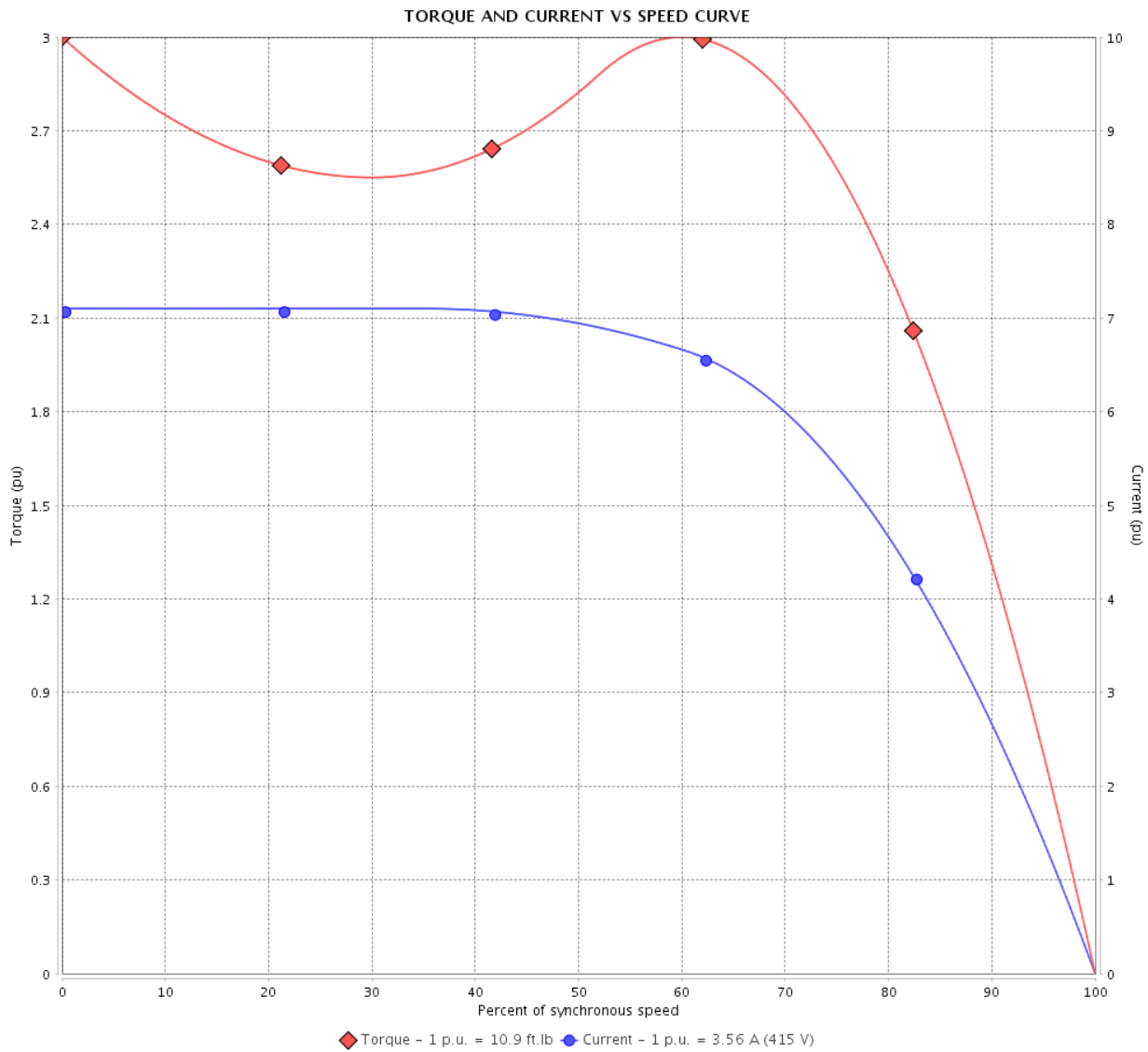

Performance : 415 V 50 Hz 6P IE4

Rated current	: 3.56 A	Moment of inertia (J)	: 0.5323 sq.ft.lb
LRC	: 7.1	Duty cycle	: Cont.(S1)
Rated torque	: 10.9 ft.lb	Insulation class	: F
Locked rotor torque	: 300 %	Service factor	: 1.00
Breakdown torque	: 300 %	Temperature rise	: 80 K
Rated speed	: 965 rpm	Design	: B

Locked rotor time : 75s (cold) 42s (hot)

Rev.	Changes Summary	Performed	Checked	Date
Performed by			Page 6 / 22	Revision
Checked by				
Date	14/04/2022			

LOAD PERFORMANCE CURVE

Three Phase Induction Motor - Squirrel Cage



Customer :

Product line : NEMA Premium Efficiency Three-Phase

Product code : 14281643

Catalog # : 00212XT3E184TC

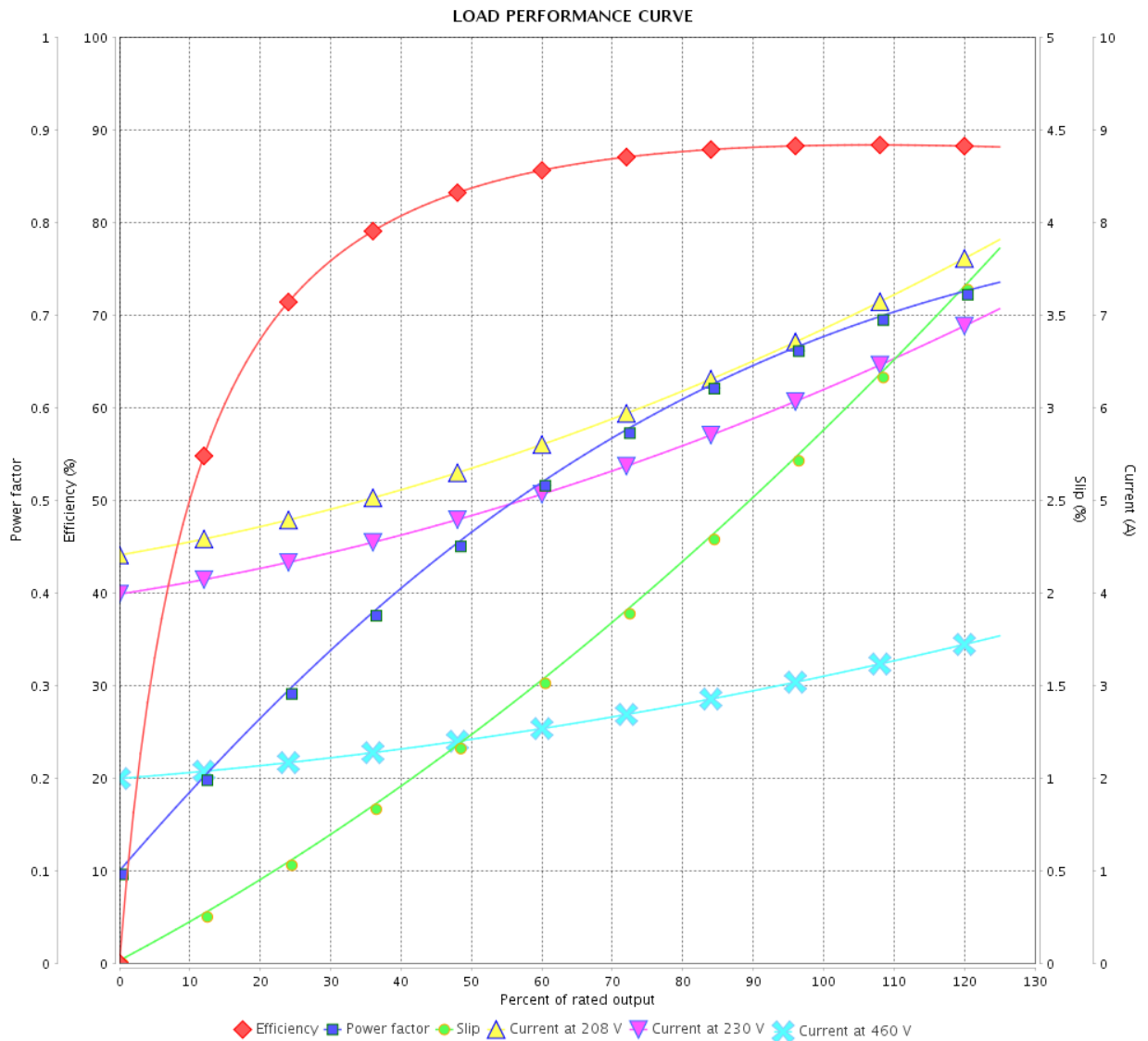

Performance : 230/460 V 60 Hz 6P

Rated current : 6.26/3.13 A
 LRC : 7.5
 Rated torque : 9.02 ft.lb
 Locked rotor torque : 300 %
 Breakdown torque : 330 %
 Rated speed : 1165 rpm

Moment of inertia (J) : 0.5323 sq.ft.lb
 Duty cycle : Cont.(S1)
 Insulation class : F
 Service factor : 1.15
 Temperature rise : 80 K
 Design : B

Rev.	Changes Summary	Performed	Checked	Date
Performed by			Page	Revision
Checked by				
Date				

LOAD PERFORMANCE CURVE

Three Phase Induction Motor - Squirrel Cage



Customer :

Product line : NEMA Premium Efficiency Three-Phase

Product code : 14281643

Catalog # : 00212XT3E184TC

LOAD PERFORMANCE CURVE

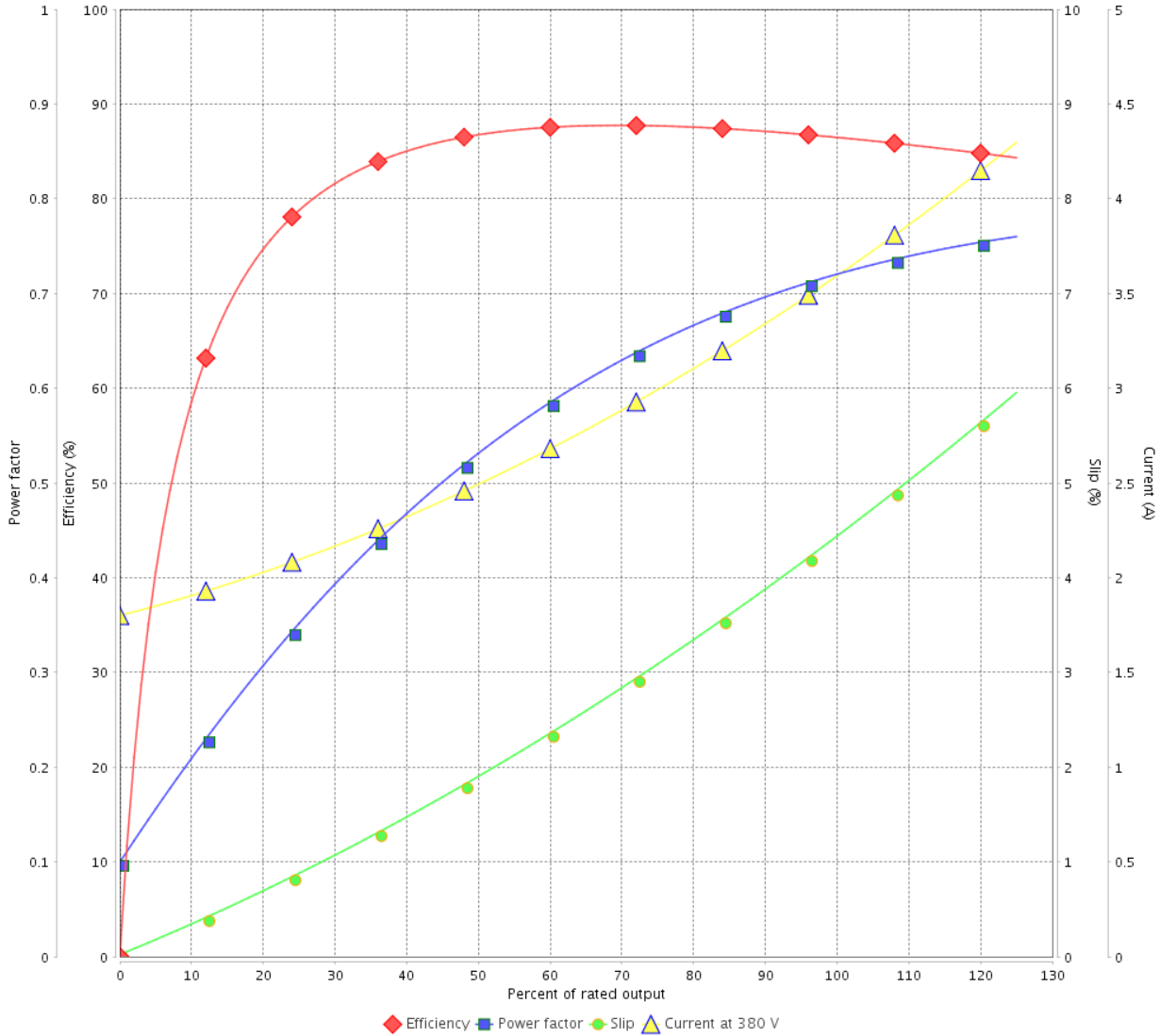

Performance : 380 V 50 Hz 6P IE4

Rated current : 3.66 A
 LRC : 6.0
 Rated torque : 11.0 ft.lb
 Locked rotor torque : 220 %
 Breakdown torque : 240 %
 Rated speed : 955 rpm

Moment of inertia (J) : 0.5323 sq.ft.lb
 Duty cycle : Cont.(S1)
 Insulation class : F
 Service factor : 1.00
 Temperature rise : 80 K
 Design : B

Rev.	Changes Summary	Performed	Checked	Date
Performed by			Page 8 / 22	Revision
Checked by				
Date	14/04/2022			

LOAD PERFORMANCE CURVE

Three Phase Induction Motor - Squirrel Cage



Customer : _____

Product line : NEMA Premium Efficiency Three-Phase

Product code : 14281643

Catalog # : 00212XT3E184TC

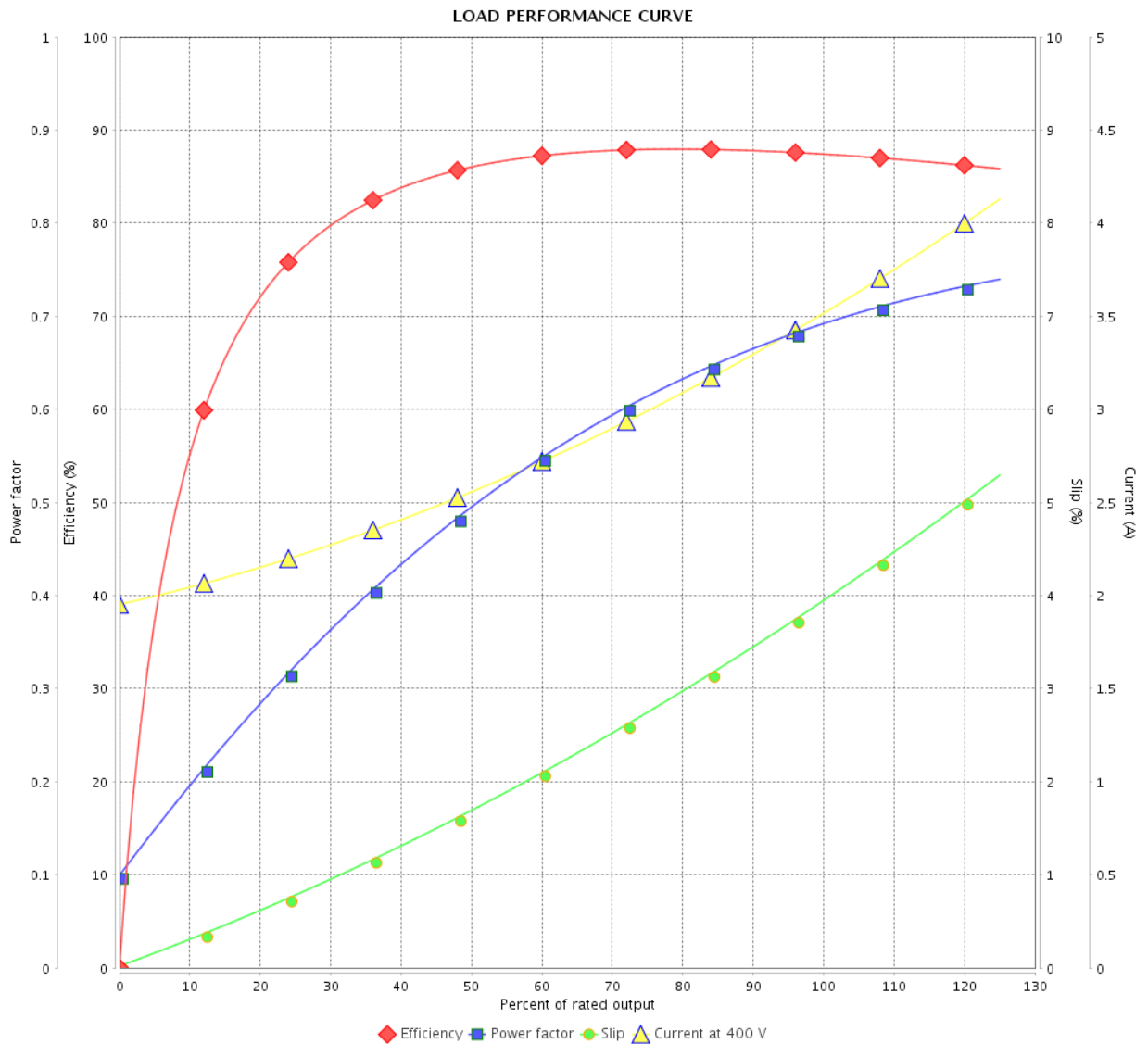

Performance : 400 V 50 Hz 6P IE4

Rated current : 3.59 A
 LRC : 6.7
 Rated torque : 10.9 ft.lb
 Locked rotor torque : 260 %
 Breakdown torque : 270 %
 Rated speed : 960 rpm

Moment of inertia (J) : 0.5323 sq.ft.lb
 Duty cycle : Cont.(S1)
 Insulation class : F
 Service factor : 1.00
 Temperature rise : 80 K
 Design : B

Rev.	Changes Summary	Performed	Checked	Date
Performed by		Page		Revision
Checked by		9 / 22		
Date		14/04/2022		

LOAD PERFORMANCE CURVE

Three Phase Induction Motor - Squirrel Cage



Customer :

Product line : NEMA Premium Efficiency Three-Phase

Product code : 14281643

Catalog # : 00212XT3E184TC

LOAD PERFORMANCE CURVE

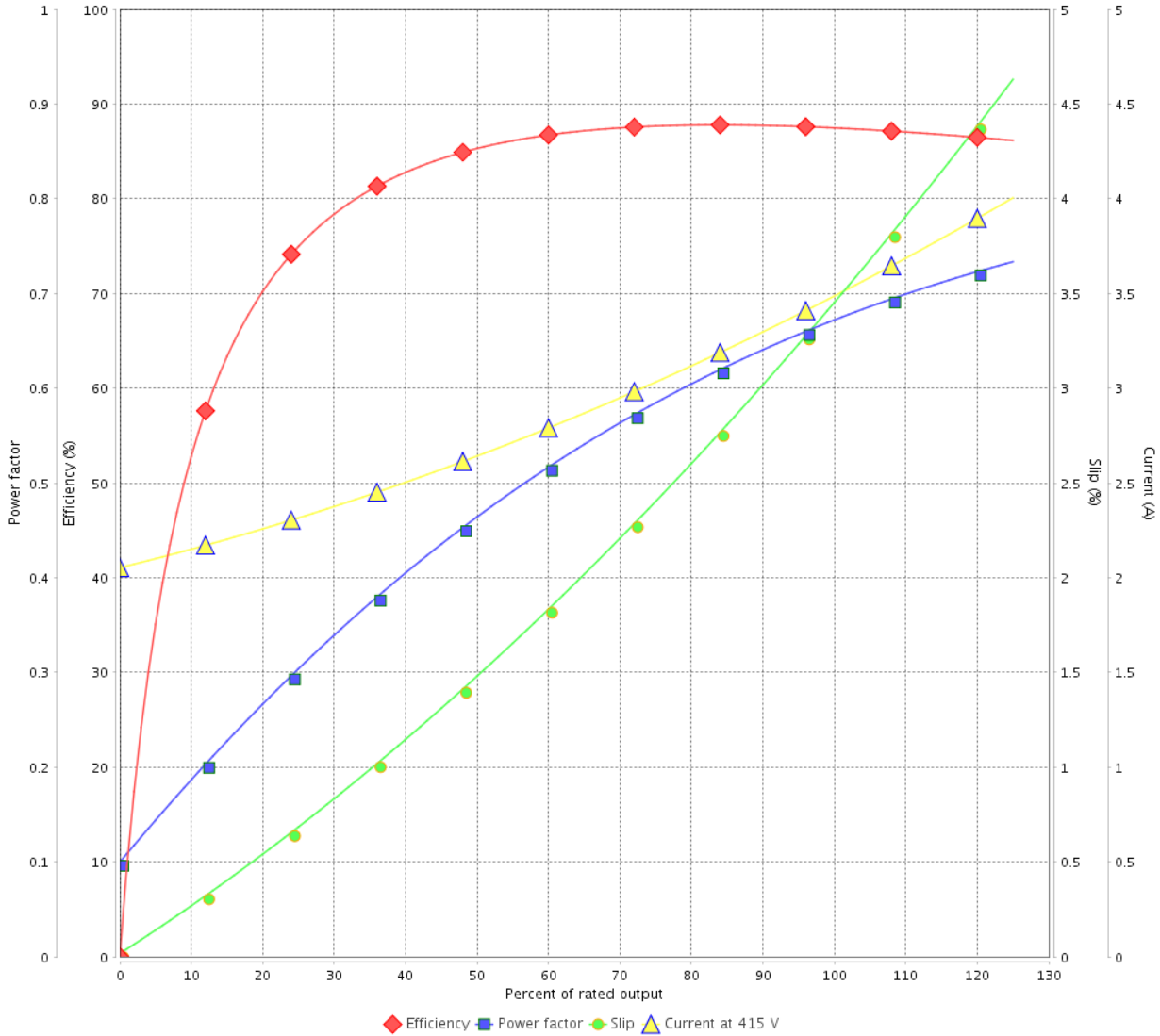

Performance : 415 V 50 Hz 6P IE4

Rated current : 3.56 A
 LRC : 7.1
 Rated torque : 10.9 ft.lb
 Locked rotor torque : 300 %
 Breakdown torque : 300 %
 Rated speed : 965 rpm

Moment of inertia (J) : 0.5323 sq.ft.lb
 Duty cycle : Cont.(S1)
 Insulation class : F
 Service factor : 1.00
 Temperature rise : 80 K
 Design : B

Rev.	Changes Summary	Performed	Checked	Date
Performed by			Page 10 / 22	Revision
Checked by				
Date	14/04/2022			

THERMAL LIMIT CURVE



Three Phase Induction Motor - Squirrel Cage

Customer :

Product line : NEMA Premium Efficiency Three-Phase
 Product code : 14281643
 Catalog # : 00212XT3E184TC

Performance : 230/460 V 60 Hz 6P

Rated current : 6.26/3.13 A	Moment of inertia (J) : 0.5323 sq.ft.lb
LRC : 7.5	Duty cycle : Cont.(S1)
Rated torque : 9.02 ft.lb	Insulation class : F
Locked rotor torque : 300 %	Service factor : 1.15
Breakdown torque : 330 %	Temperature rise : 80 K
Rated speed : 1165 rpm	Design : B

Heating constant

Cooling constant

Rev.	Changes Summary	Performed	Checked	Date
Performed by			Page 11 / 22	Revision
Checked by				
Date	14/04/2022			

THERMAL LIMIT CURVE

Three Phase Induction Motor - Squirrel Cage



Customer : _____

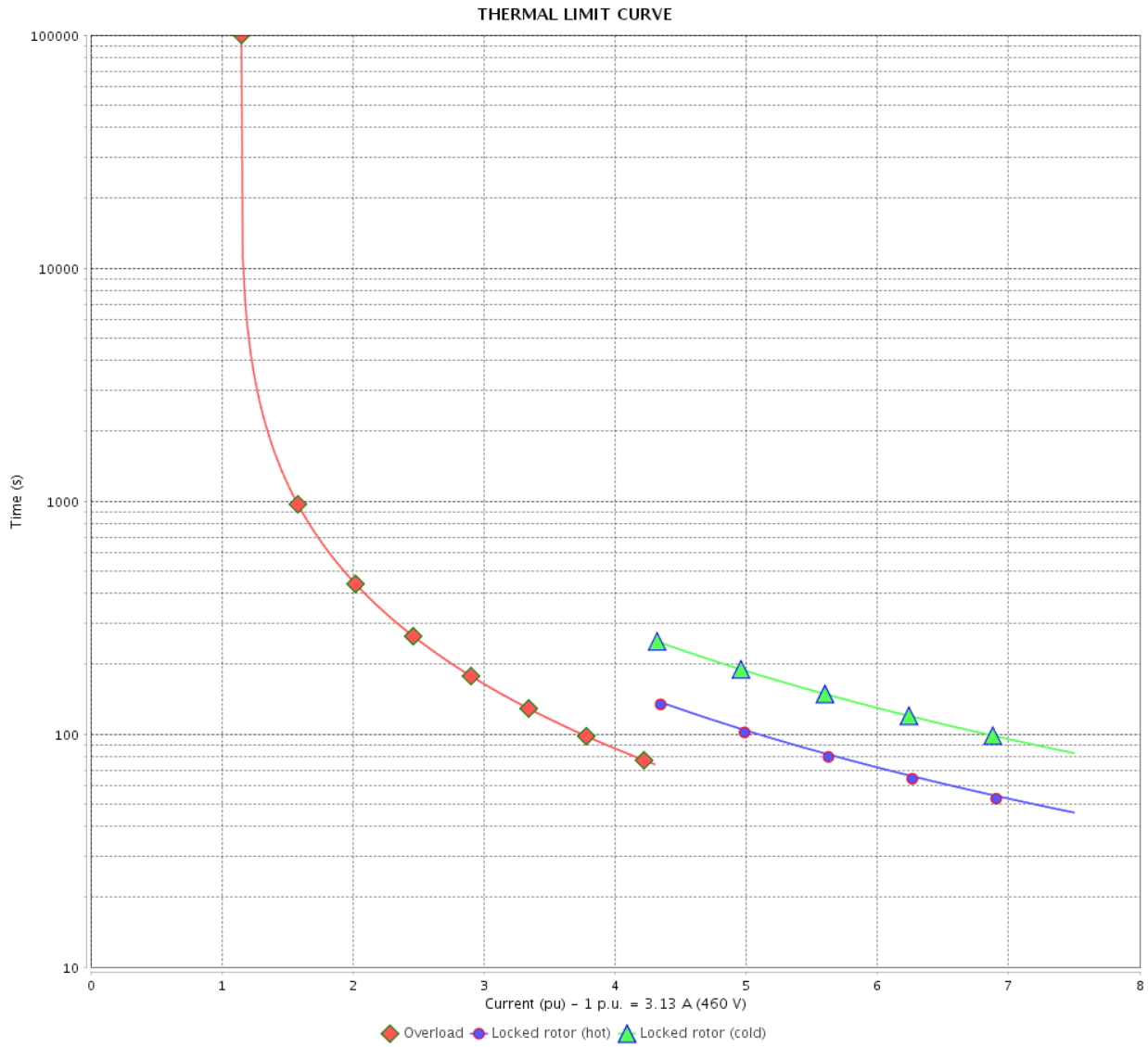

Rev.	Changes Summary	Performed	Checked	Date
Performed by		Page 12 / 22		Revision
Checked by				
Date				

THERMAL LIMIT CURVE



Three Phase Induction Motor - Squirrel Cage

Customer :

Product line : NEMA Premium Efficiency Three-Phase
 Product code : 14281643
 Catalog # : 00212XT3E184TC

Performance : 380 V 50 Hz 6P IE4

Rated current : 3.66 A	Moment of inertia (J) : 0.5323 sq.ft.lb
LRC : 6.0	Duty cycle : Cont.(S1)
Rated torque : 11.0 ft.lb	Insulation class : F
Locked rotor torque : 220 %	Service factor : 1.00
Breakdown torque : 240 %	Temperature rise : 80 K
Rated speed : 955 rpm	Design : B

Heating constant

Cooling constant

Rev.	Changes Summary	Performed	Checked	Date
Performed by			Page 13 / 22	Revision
Checked by				
Date	14/04/2022			

THERMAL LIMIT CURVE

Three Phase Induction Motor - Squirrel Cage



Customer : _____

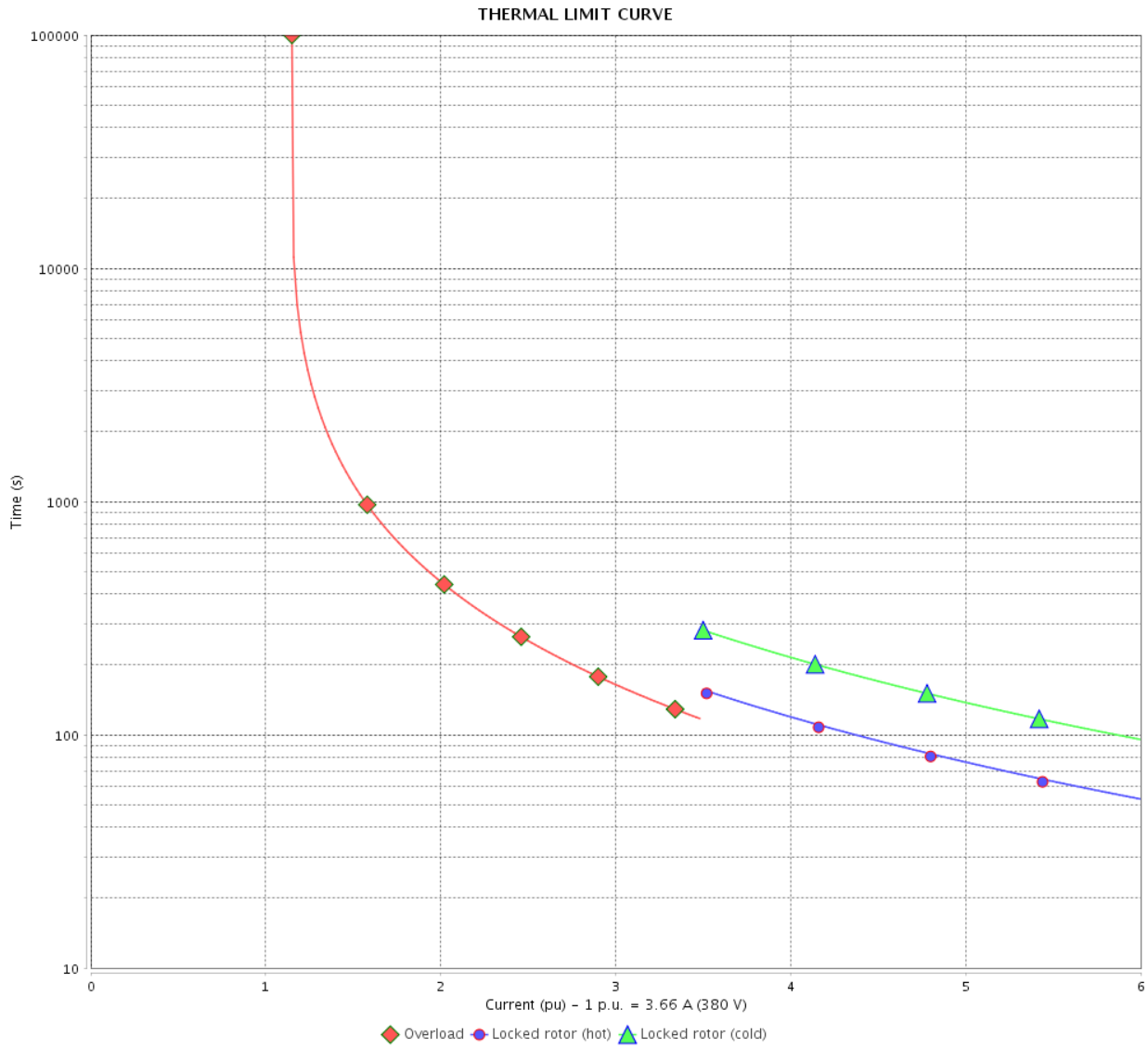

Rev.	Changes Summary	Performed	Checked	Date
Performed by		Page		Revision
Checked by		14 / 22		
Date		14/04/2022		

THERMAL LIMIT CURVE



Three Phase Induction Motor - Squirrel Cage

Customer :

Product line : NEMA Premium Efficiency Three-Phase

Product code : 14281643

Catalog # : 00212XT3E184TC

Performance : 400 V 50 Hz 6P IE4

Rated current : 3.59 A
 LRC : 6.7
 Rated torque : 10.9 ft.lb
 Locked rotor torque : 260 %
 Breakdown torque : 270 %
 Rated speed : 960 rpm

Moment of inertia (J) : 0.5323 sq.ft.lb
 Duty cycle : Cont.(S1)
 Insulation class : F
 Service factor : 1.00
 Temperature rise : 80 K
 Design : B

Heating constant

Cooling constant

Rev.	Changes Summary	Performed	Checked	Date
Performed by			Page 15 / 22	Revision
Checked by				
Date	14/04/2022			

THERMAL LIMIT CURVE

Three Phase Induction Motor - Squirrel Cage



Customer : _____

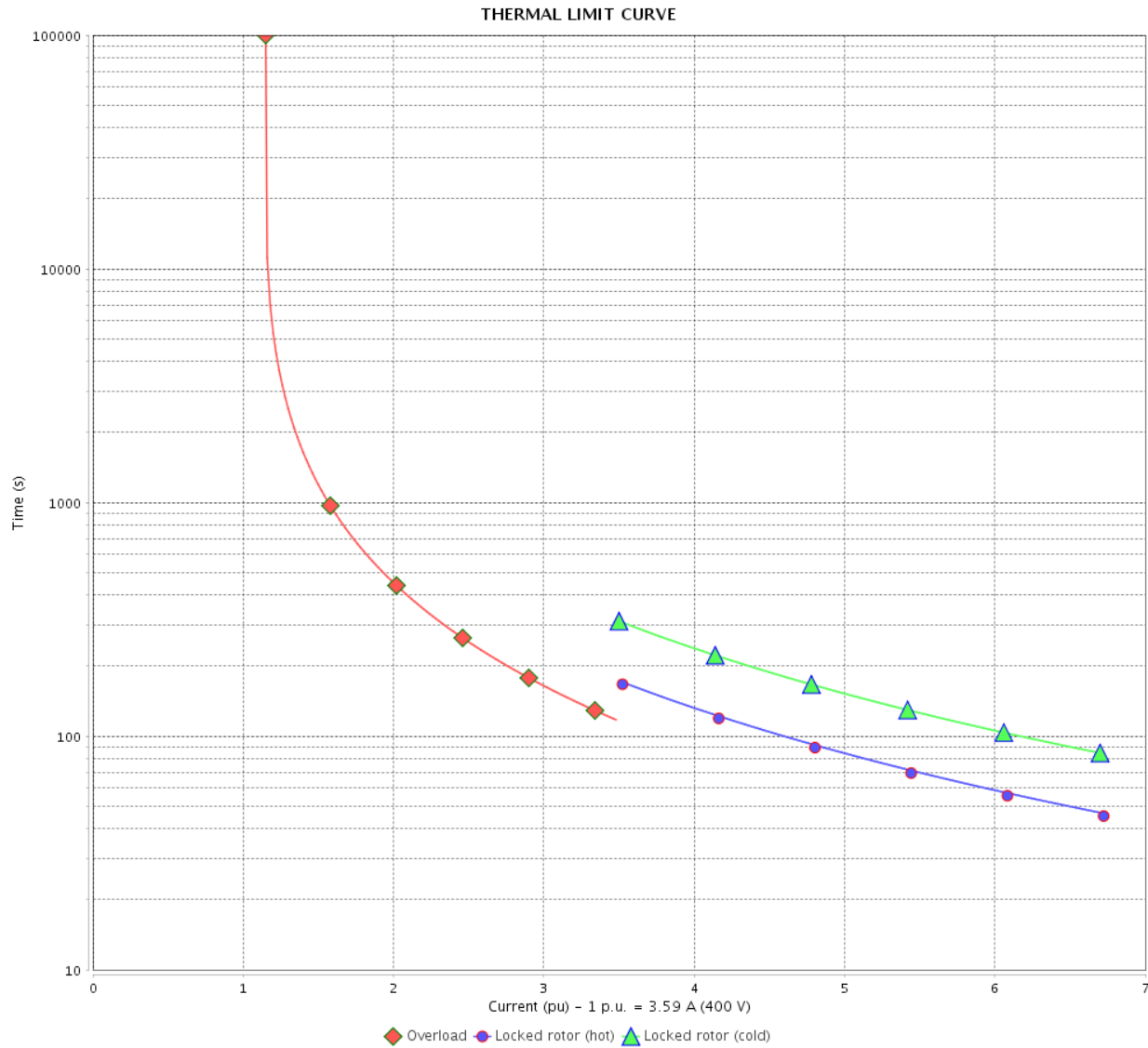

Rev.	Changes Summary	Performed	Checked	Date
Performed by		Page		Revision
Checked by		16 / 22		
Date		14/04/2022		

THERMAL LIMIT CURVE



Three Phase Induction Motor - Squirrel Cage

Customer :

Product line : NEMA Premium Efficiency Three-Phase
 Product code : 14281643
 Catalog # : 00212XT3E184TC

Performance : 415 V 50 Hz 6P IE4

Rated current : 3.56 A	Moment of inertia (J) : 0.5323 sq.ft.lb
LRC : 7.1	Duty cycle : Cont.(S1)
Rated torque : 10.9 ft.lb	Insulation class : F
Locked rotor torque : 300 %	Service factor : 1.00
Breakdown torque : 300 %	Temperature rise : 80 K
Rated speed : 965 rpm	Design : B

Heating constant

Cooling constant

Rev.	Changes Summary	Performed	Checked	Date
Performed by			Page 17 / 22	Revision
Checked by				
Date	14/04/2022			

THERMAL LIMIT CURVE

Three Phase Induction Motor - Squirrel Cage



Customer : _____

THERMAL LIMIT CURVE

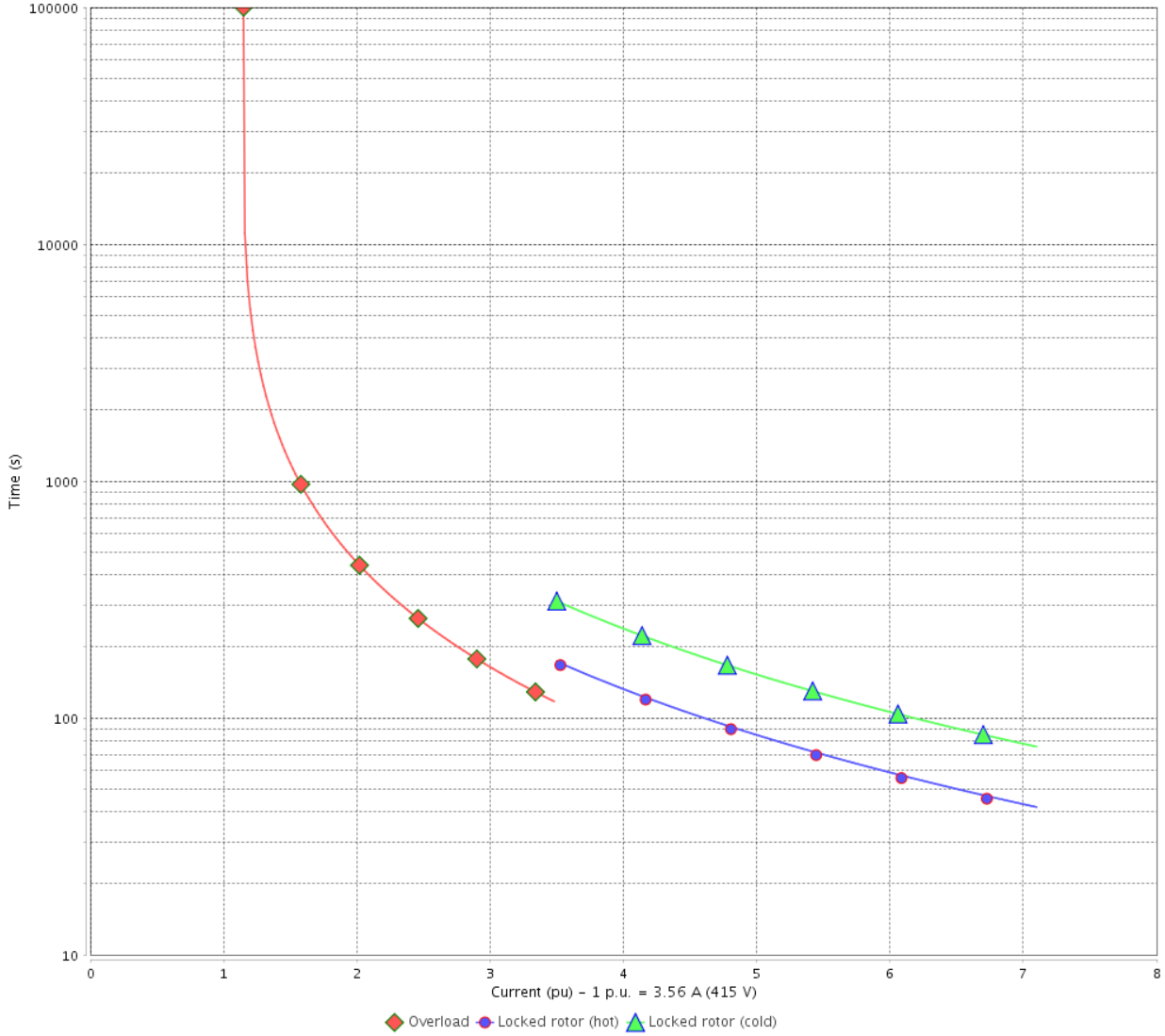

Rev.	Changes Summary	Performed	Checked	Date
Performed by			Page 18 / 22	Revision
Checked by				
Date	14/04/2022			

VFD OPERATION CURVE

Three Phase Induction Motor - Squirrel Cage



Customer :

Product line : NEMA Premium Efficiency Three-Phase

Product code : 14281643

Catalog # : 00212XT3E184TC

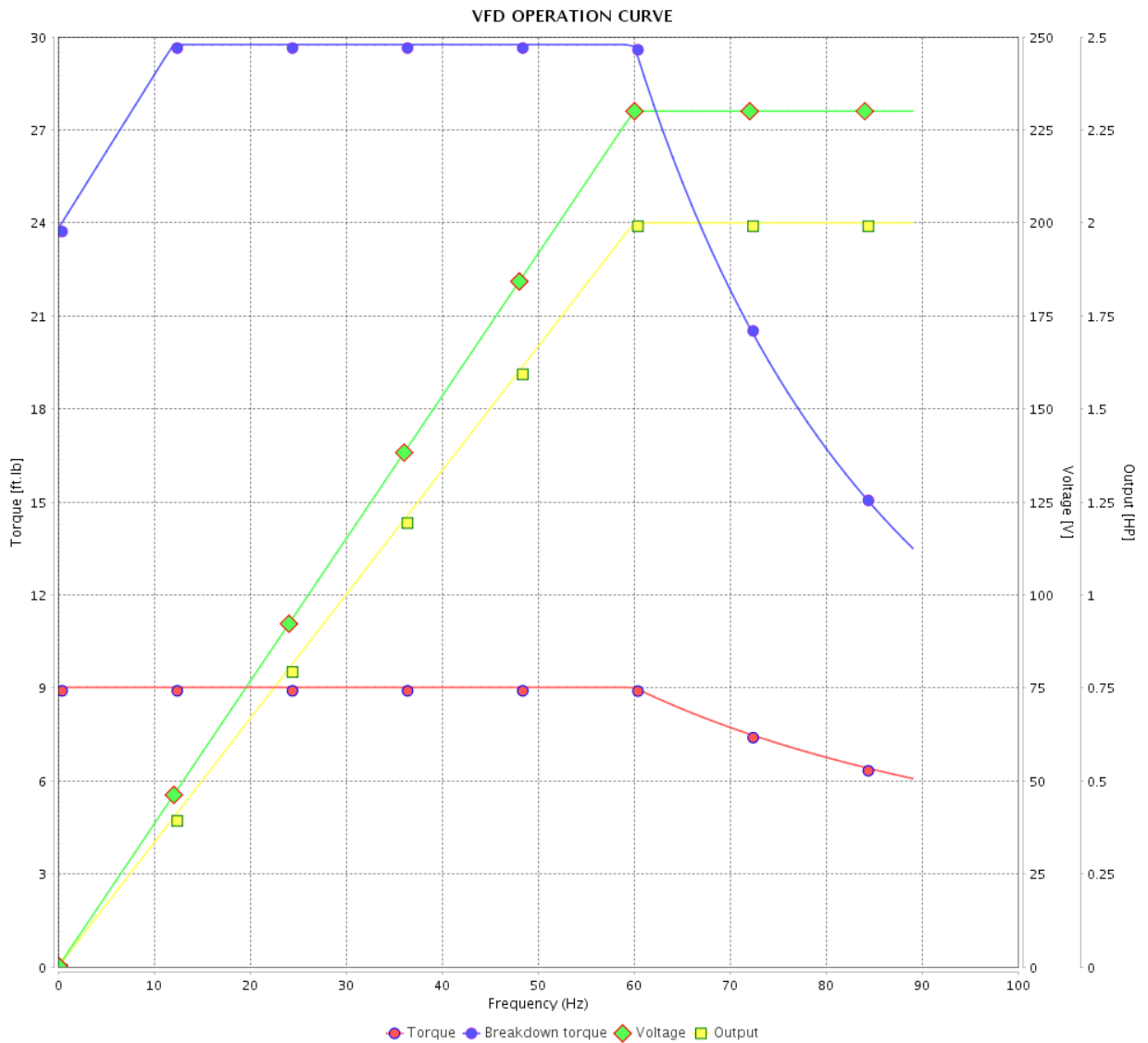

Performance : 230/460 V 60 Hz 6P

Rated current : 6.26/3.13 A
 LRC : 7.5
 Rated torque : 9.02 ft.lb
 Locked rotor torque : 300 %
 Breakdown torque : 330 %
 Rated speed : 1165 rpm

Moment of inertia (J) : 0.5323 sq.ft.lb
 Duty cycle : Cont.(S1)
 Insulation class : F
 Service factor : 1.15
 Temperature rise : 80 K
 Design : B

Rev.	Changes Summary	Performed	Checked	Date
Performed by		Page		Revision
Checked by		19 / 22		
Date		14/04/2022		

VFD OPERATION CURVE

Three Phase Induction Motor - Squirrel Cage



Customer : _____

Product line : NEMA Premium Efficiency Three-Phase

Product code : 14281643

Catalog # : 00212XT3E184TC

VFD OPERATION CURVE

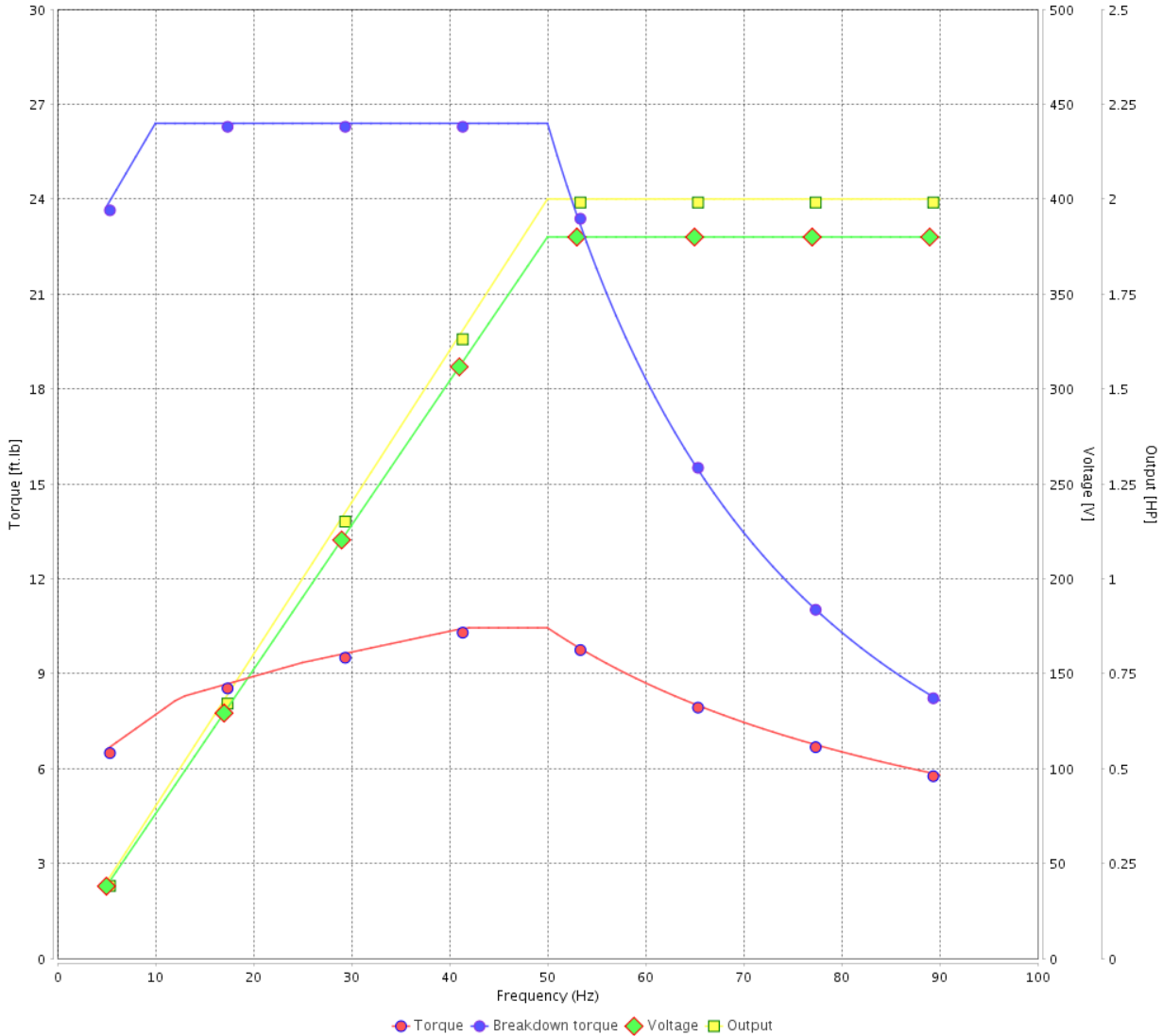

Performance : 380 V 50 Hz 6P IE4

Rated current : 3.66 A
 LRC : 6.0
 Rated torque : 11.0 ft.lb
 Locked rotor torque : 220 %
 Breakdown torque : 240 %
 Rated speed : 955 rpm

Moment of inertia (J) : 0.5323 sq.ft.lb
 Duty cycle : Cont.(S1)
 Insulation class : F
 Service factor : 1.00
 Temperature rise : 80 K
 Design : B

Rev.	Changes Summary	Performed	Checked	Date
Performed by			Page 20 / 22	Revision
Checked by				
Date	14/04/2022			

VFD OPERATION CURVE

Three Phase Induction Motor - Squirrel Cage



Customer :

Product line : NEMA Premium Efficiency Three-Phase

Product code : 14281643

Catalog # : 00212XT3E184TC

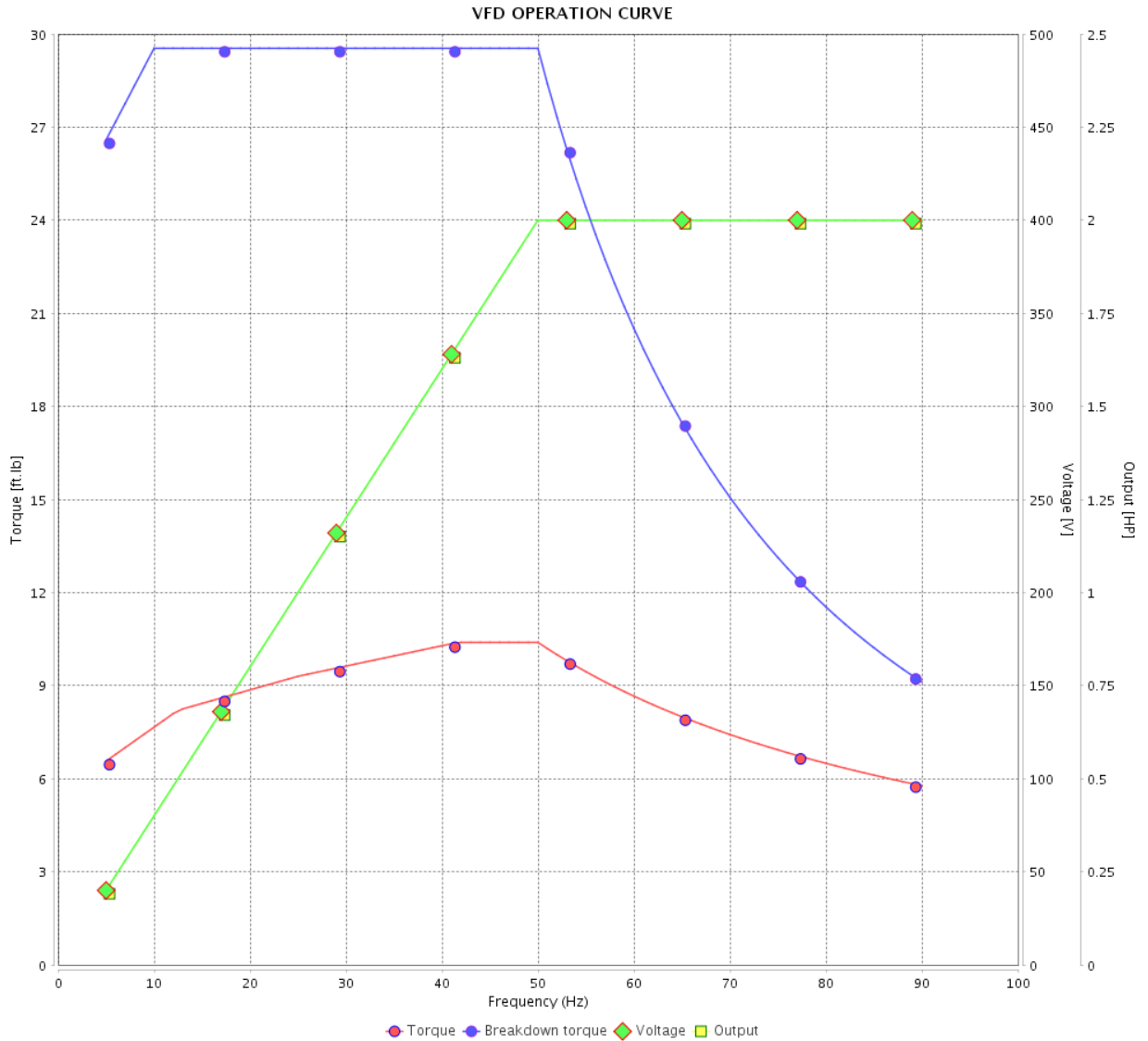

Performance : 400 V 50 Hz 6P IE4

Rated current : 3.59 A
 LRC : 6.7
 Rated torque : 10.9 ft.lb
 Locked rotor torque : 260 %
 Breakdown torque : 270 %
 Rated speed : 960 rpm

Moment of inertia (J) : 0.5323 sq.ft.lb
 Duty cycle : Cont.(S1)
 Insulation class : F
 Service factor : 1.00
 Temperature rise : 80 K
 Design : B

Rev.	Changes Summary	Performed	Checked	Date
Performed by				Page 21 / 22
Checked by				
Date	14/04/2022			
				Revision

VFD OPERATION CURVE

Three Phase Induction Motor - Squirrel Cage



Customer :

Product line : NEMA Premium Efficiency Three-Phase

Product code : 14281643

Catalog # : 00212XT3E184TC

VFD OPERATION CURVE

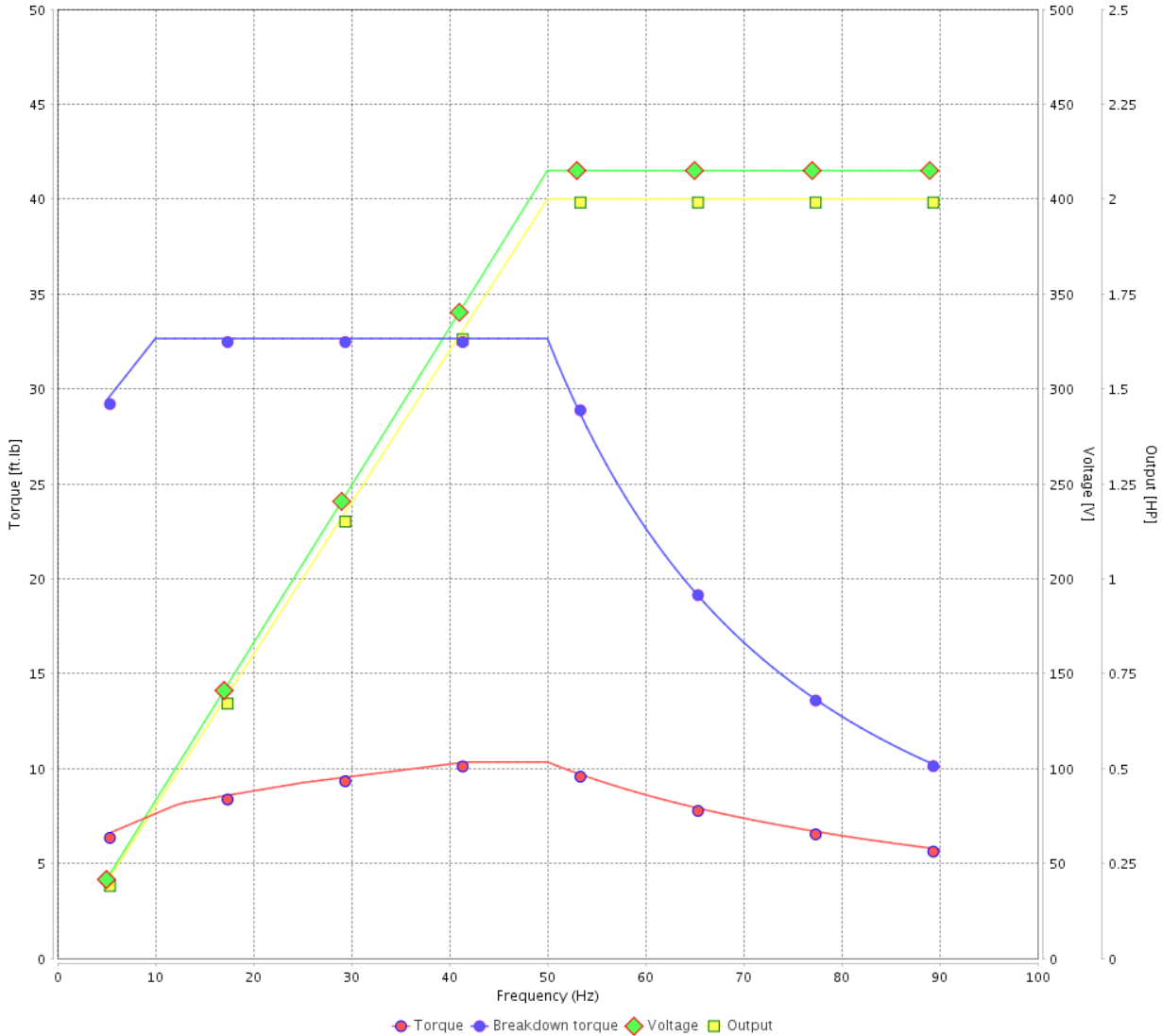

Performance : 415 V 50 Hz 6P IE4

Rated current : 3.56 A
 LRC : 7.1
 Rated torque : 10.9 ft.lb
 Locked rotor torque : 300 %
 Breakdown torque : 300 %
 Rated speed : 965 rpm

Moment of inertia (J) : 0.5323 sq.ft.lb
 Duty cycle : Cont.(S1)
 Insulation class : F
 Service factor : 1.00
 Temperature rise : 80 K
 Design : B

Rev.	Changes Summary	Performed	Checked	Date
Performed by			Page 22 / 22	Revision
Checked by				
Date	14/04/2022			

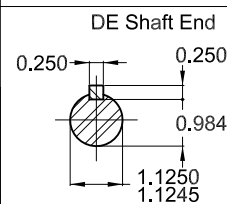
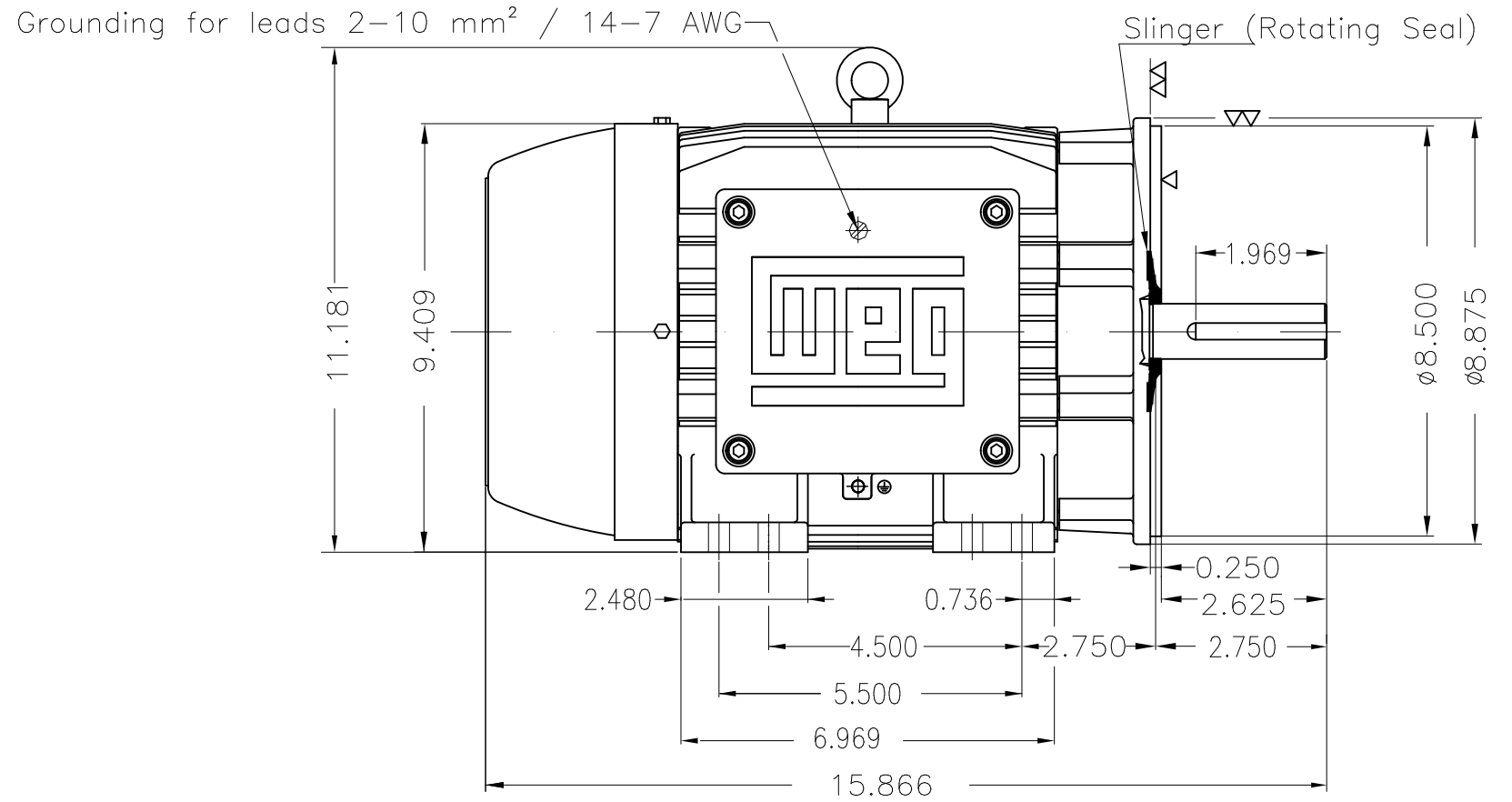
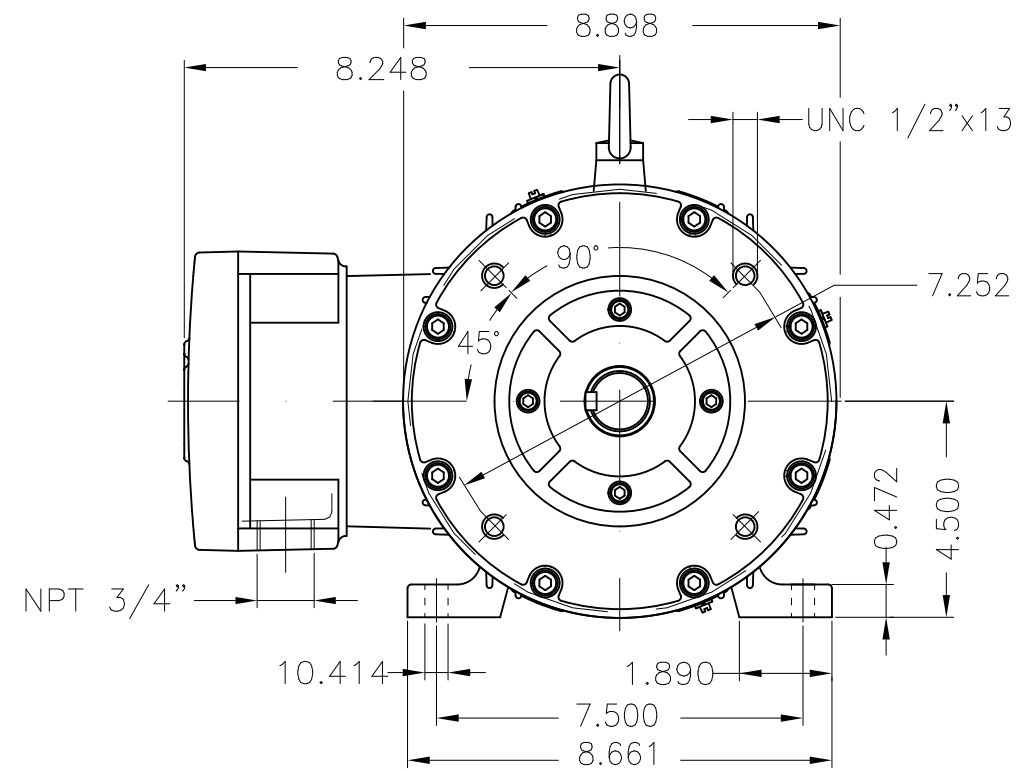

Color RAL 5009
 Painting plan 202P
 Mounting NEMA F-1
 Mounting B34R(D)

2 HP 06 Poles 60 Hz

ECM	LOC	SUMMARY OF MODIFICATIONS	EXECUTED	CHECKED	RELEASED	DATE	VER
EXECUTED	PIRWBUSER	THREE PH. MOTOR EXPLOSION PROOF PREM. EFF.					
CHECKED		FRAME 182/4TC IP55 TEFC					
RELEASED							
REL DT.	WMO	Jaragua do Sul	Product Engineering				

PREVIEW
 WDD



SHEET 1 / 1

Dimensions in inches

XME A3

MADE IN BRAZIL

**W21X NEMA**
Premium

14281643



LISTED

CC029A

Inverter Duty Motor
Severe Duty

MODEL 00212XT3E184TC

PH 3	FR 182/4TC		
HP(kW) 2.0(1.5)		HZ 60	IP55
V 230/460		A 6.26/3.13	
RPM 1165		NEMA NOM EFF 88.5%	
PF 0.68		SFA 7.20/3.60	DES B
INS CL F Δ T 80 K		SF 1.15	ENCL TEFC
DUTY CONT.		CODE L	ALT 1000 m.a.s.l.
AMB 40°C	USABLE @208V	6.92 A	SF 1.15 SFA 7.96
AMB 55°C SF1.0			
2.0HP 1.5kW 50Hz 380V 3.66A 955RPM SF1.00 EFF 86.5% (IE4)			

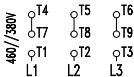
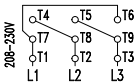

→ 6307-2RS MOBIL POLYREX EM
→ 6206-2RS

137 Lbs



TEMP CODE T3C
CSA/UL: Class I - Div. 1 - Groups C and D
CSA: Class II - Div. 1 - Groups F and G
CSA: Class I - Zone 1 - IIB

EXPLOSION PROOF MOTOR

FOR USE ON VPWM VFD 1000:1VT, 20:1CT, 1.0SF, T3C, AMB 40°C.