

DATA SHEET

Three Phase Induction Motor - Squirrel Cage



Customer :					
Product line	: NEMA Premium Efficiency Three-Phase	Product code :	14188755		
		Catalog # :	00318XT3E182JP		
Frame	: 182/4TZ	Cooling method	: IC411 - TEFC		
Insulation class	: F	Mounting	: F-1		
Duty cycle	: Cont.(S1)	Rotation ¹	: Both (CW and CCW)		
Ambient temperature	: -20°C to +40°C	Starting method	: Direct On Line		
Altitude	: 1000 m.a.s.l.	Approx. weight ²	: 126 lb		
Protection degree	: IP55	Moment of inertia (J)	: 0.2781 sq.ft.lb		
Design	: B				
Output [HP]	3	3	3	3	
Poles	4	4	4	4	
Frequency [Hz]	60	50	50	50	
Rated voltage [V]	230/460	380	400	415	
Rated current [A]	7.82/3.91	4.60	4.48	4.38	
L. R. Amperes [A]	62.6/31.3	29.4	31.4	32.4	
LRC [A]	8.0x(Code K)	6.4x(Code H)	7.0x(Code J)	7.4x(Code J)	
No load current [A]	4.20/2.10	2.02	2.20	2.34	
Rated speed [RPM]	1760	1440	1445	1450	
Slip [%]	2.22	4.00	3.67	3.33	
Rated torque [ft.lb]	8.95	10.9	10.9	10.9	
Locked rotor torque [%]	250	200	229	260	
Breakdown torque [%]	320	229	260	290	
Service factor	1.15	1.00	1.00	1.00	
Temperature rise	80 K	80 K	80 K	80 K	
Locked rotor time	50s (cold) 28s (hot)	45s (cold) 25s (hot)	45s (cold) 25s (hot)	45s (cold) 25s (hot)	
Noise level ²	56.0 dB(A)	56.0 dB(A)	56.0 dB(A)	56.0 dB(A)	
Efficiency (%)	25%	86.4	89.1	88.0	87.2
	50%	87.5	88.5	87.5	87.5
	75%	88.5	88.5	88.5	88.5
	100%	89.5	87.5	87.5	88.5
Power Factor	25%	0.35	0.41	0.38	0.35
	50%	0.59	0.67	0.63	0.59
	75%	0.71	0.78	0.75	0.72
	100%	0.79	0.83	0.81	0.79
Bearing type	: <u>Drive end</u> 6307 2RS <u>Non drive end</u> 6206 2RS	Foundation loads			
Sealing	: Oil Seal Lip Seal	Max. traction	: 139 lb		
Lubrication interval	: - -	Max. compression	: 263 lb		
Lubricant amount	: - -				
Lubricant type	: Mobil Polyrex EM				
Notes USABLE @208V 8.65A SF 1.15 SFA 9.94A					
This revision replaces and cancel the previous one, which must be eliminated. (1) Looking the motor from the shaft end. (2) Measured at 1m and with tolerance of +3dB(A). (3) Approximate weight subject to changes after manufacturing process. (4) At 100% of full load.			These are average values based on tests with sinusoidal power supply, subject to the tolerances stipulated in NEMA MG-1.		
Rev.	Changes Summary		Performed	Checked	Date
Performed by					
Checked by				Page	Revision
Date	14/04/2022			1 / 22	

DATA SHEET

Three Phase Induction Motor - Squirrel Cage



Customer : _____

Thermal protection

ID	Application	Type	Quantity	Sensing Temperature
1	Winding	Thermostat - 2 wires	1 x Phase	155 °C

Rev.	Changes Summary	Performed	Checked	Date
Performed by				
Checked by			Page	Revision
Date	14/04/2022		2 / 22	

TORQUE AND CURRENT VS SPEED CURVE



Three Phase Induction Motor - Squirrel Cage

Customer :

Product line : NEMA Premium Efficiency Three-Phase

Product code : 14188755

Catalog # : 00318XT3E182JP

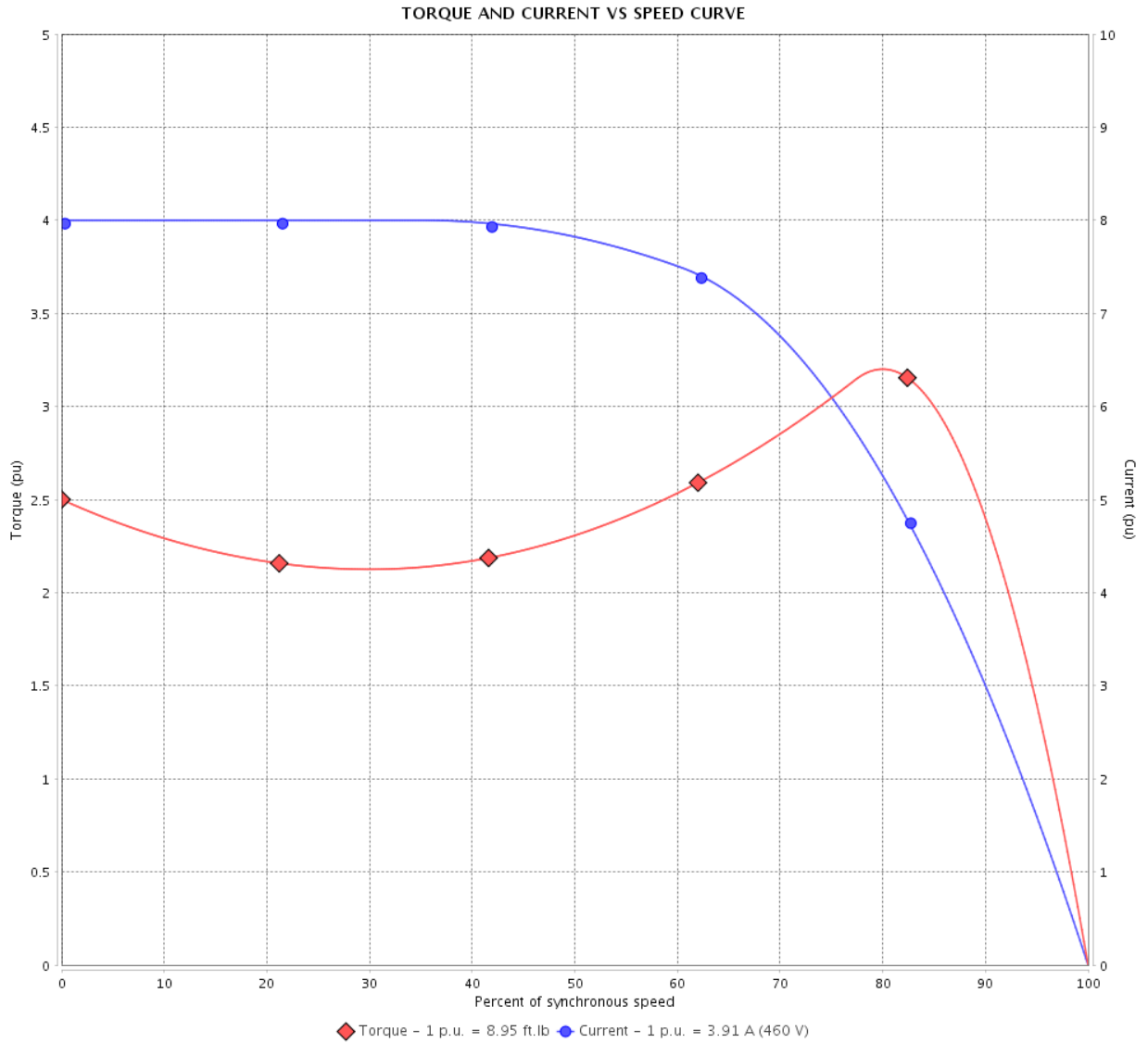

Performance : 230/460 V 60 Hz 4P

Rated current : 7.82/3.91 A
 LRC : 8.0
 Rated torque : 8.95 ft.lb
 Locked rotor torque : 250 %
 Breakdown torque : 320 %
 Rated speed : 1760 rpm

Moment of inertia (J) : 0.2781 sq.ft.lb
 Duty cycle : Cont.(S1)
 Insulation class : F
 Service factor : 1.15
 Temperature rise : 80 K
 Design : B

Locked rotor time : 50s (cold) 28s (hot)

Rev.	Changes Summary	Performed	Checked	Date
Performed by			Page	Revision
Checked by			3 / 22	
Date	14/04/2022			

TORQUE AND CURRENT VS SPEED CURVE

Three Phase Induction Motor - Squirrel Cage



Customer :

Product line : NEMA Premium Efficiency Three-Phase

Product code : 14188755

Catalog # : 00318XT3E182JP

TORQUE AND CURRENT VS SPEED CURVE

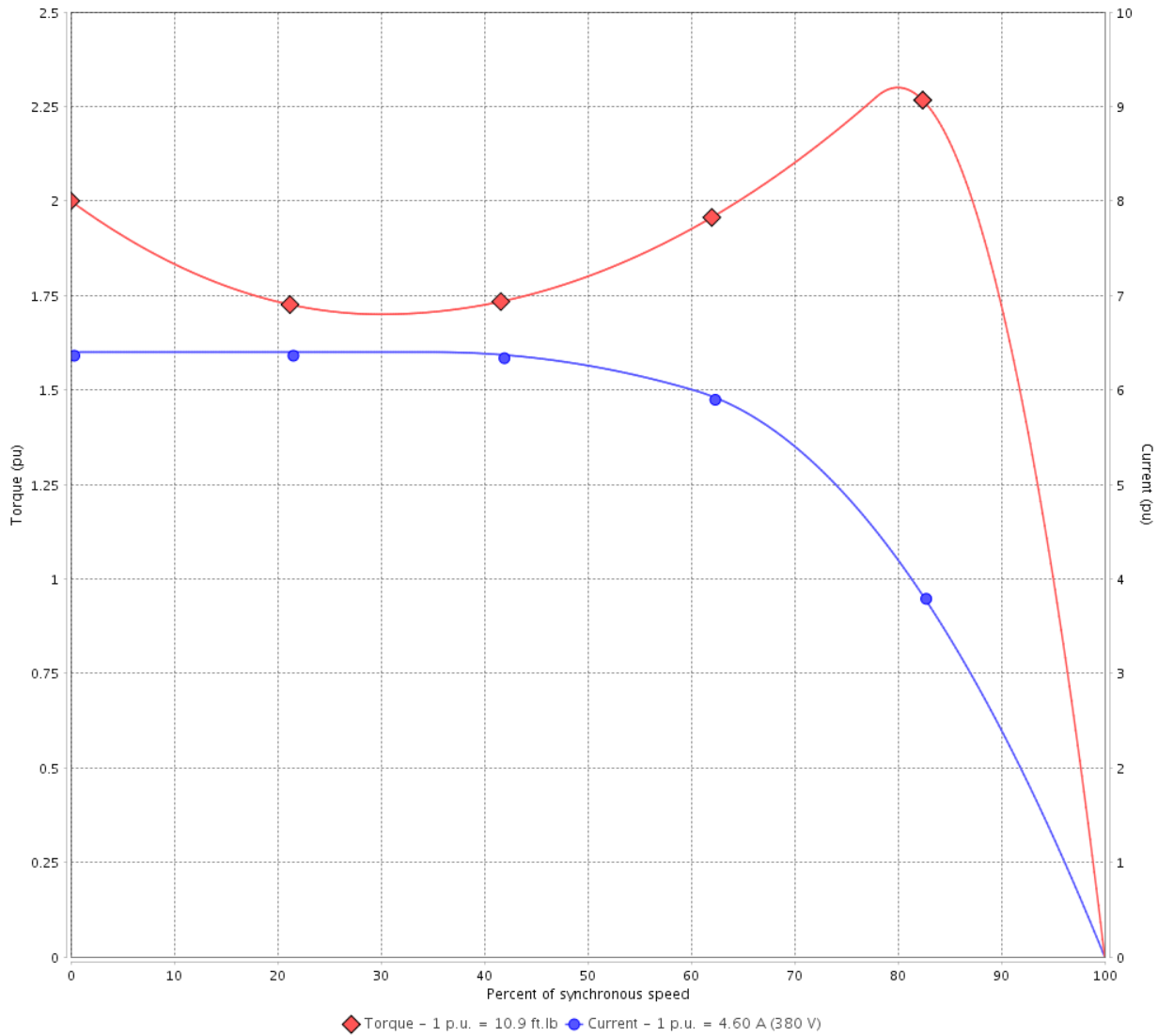

Performance : 380 V 50 Hz 4P IE3

Rated current	: 4.60 A	Moment of inertia (J)	: 0.2781 sq.ft.lb
LRC	: 6.4	Duty cycle	: Cont.(S1)
Rated torque	: 10.9 ft.lb	Insulation class	: F
Locked rotor torque	: 200 %	Service factor	: 1.00
Breakdown torque	: 229 %	Temperature rise	: 80 K
Rated speed	: 1440 rpm	Design	: B

Locked rotor time : 45s (cold) 25s (hot)

Rev.	Changes Summary	Performed	Checked	Date
Performed by			Page 4 / 22	Revision
Checked by				
Date	14/04/2022			

TORQUE AND CURRENT VS SPEED CURVE



Three Phase Induction Motor - Squirrel Cage

Customer :

Product line : NEMA Premium Efficiency Three-Phase

Product code : 14188755

Catalog # : 00318XT3E182JP

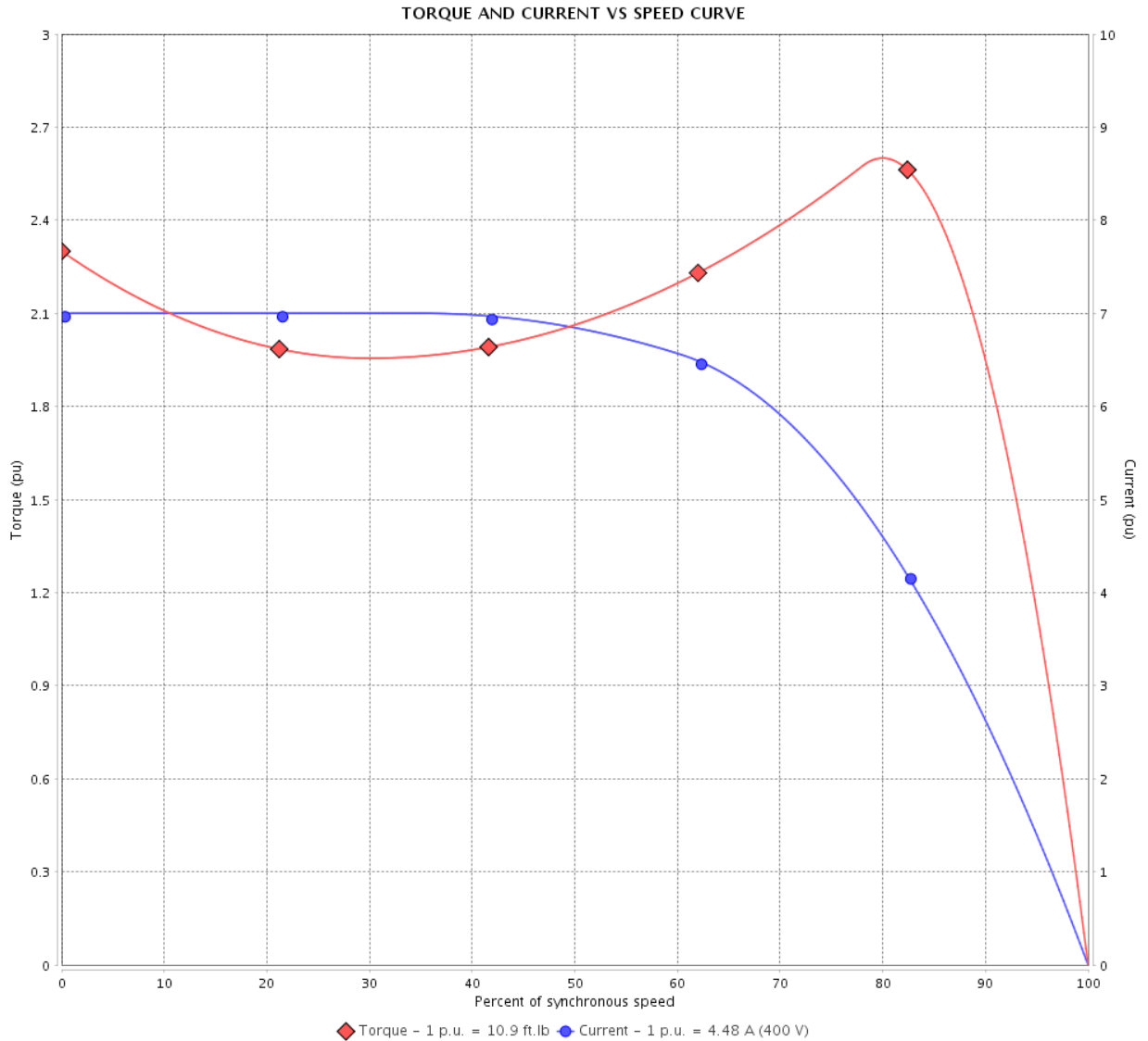

Performance : 400 V 50 Hz 4P IE3

Rated current	: 4.48 A	Moment of inertia (J)	: 0.2781 sq.ft.lb
LRC	: 7.0	Duty cycle	: Cont.(S1)
Rated torque	: 10.9 ft.lb	Insulation class	: F
Locked rotor torque	: 229 %	Service factor	: 1.00
Breakdown torque	: 260 %	Temperature rise	: 80 K
Rated speed	: 1445 rpm	Design	: B

Locked rotor time : 45s (cold) 25s (hot)

Rev.	Changes Summary	Performed	Checked	Date
Performed by			Page 5 / 22	Revision
Checked by				
Date	14/04/2022			

TORQUE AND CURRENT VS SPEED CURVE

Three Phase Induction Motor - Squirrel Cage



Customer :

Product line : NEMA Premium Efficiency Three-Phase

Product code : 14188755

Catalog # : 00318XT3E182JP

TORQUE AND CURRENT VS SPEED CURVE

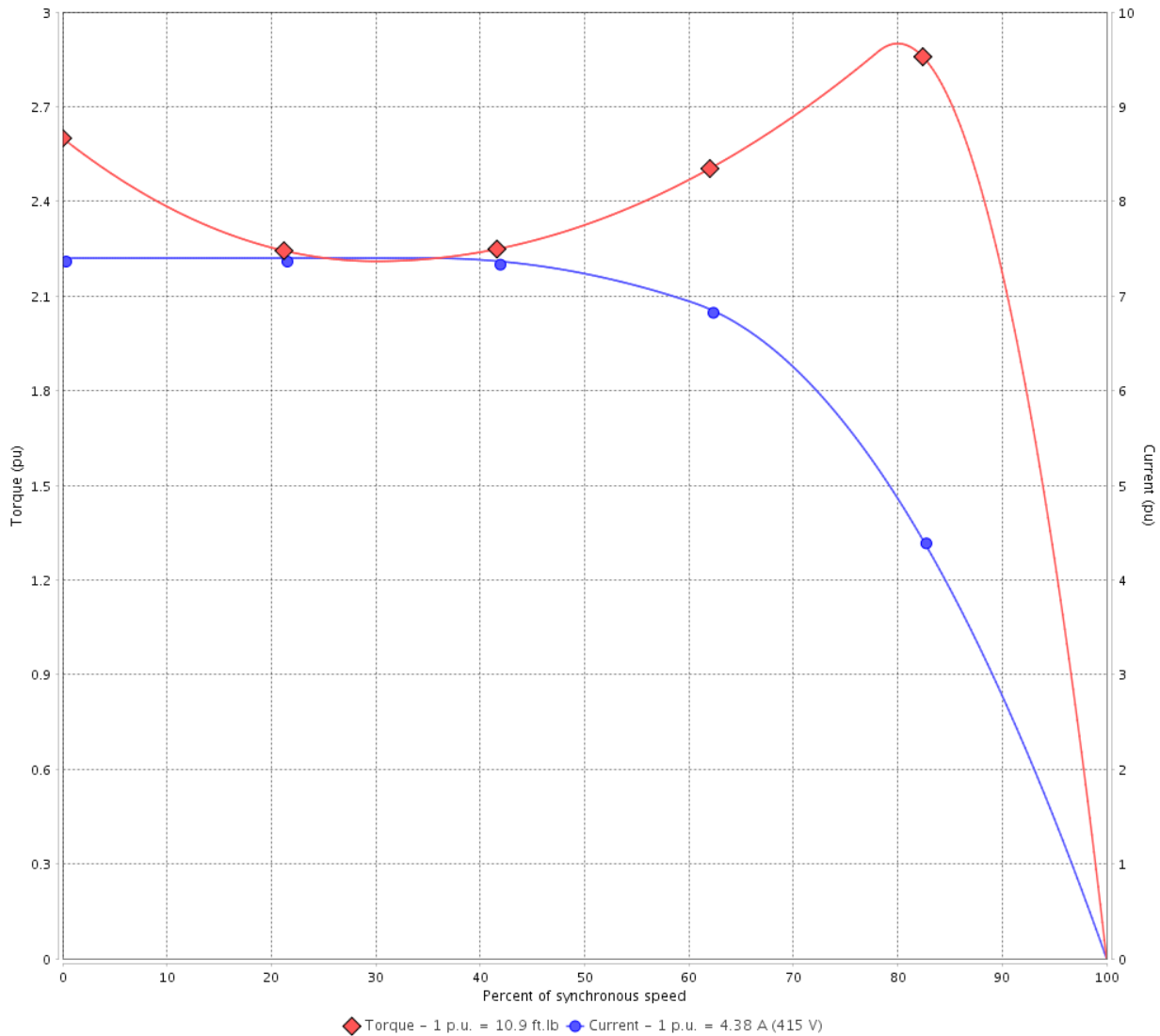

Performance : 415 V 50 Hz 4P IE3

Rated current	: 4.38 A	Moment of inertia (J)	: 0.2781 sq.ft.lb
LRC	: 7.4	Duty cycle	: Cont.(S1)
Rated torque	: 10.9 ft.lb	Insulation class	: F
Locked rotor torque	: 260 %	Service factor	: 1.00
Breakdown torque	: 290 %	Temperature rise	: 80 K
Rated speed	: 1450 rpm	Design	: B

Locked rotor time : 45s (cold) 25s (hot)

Rev.	Changes Summary	Performed	Checked	Date
Performed by			Page 6 / 22	Revision
Checked by				
Date	14/04/2022			

LOAD PERFORMANCE CURVE

Three Phase Induction Motor - Squirrel Cage



Customer :

Product line : NEMA Premium Efficiency Three-Phase

Product code : 14188755

Catalog # : 00318XT3E182JP

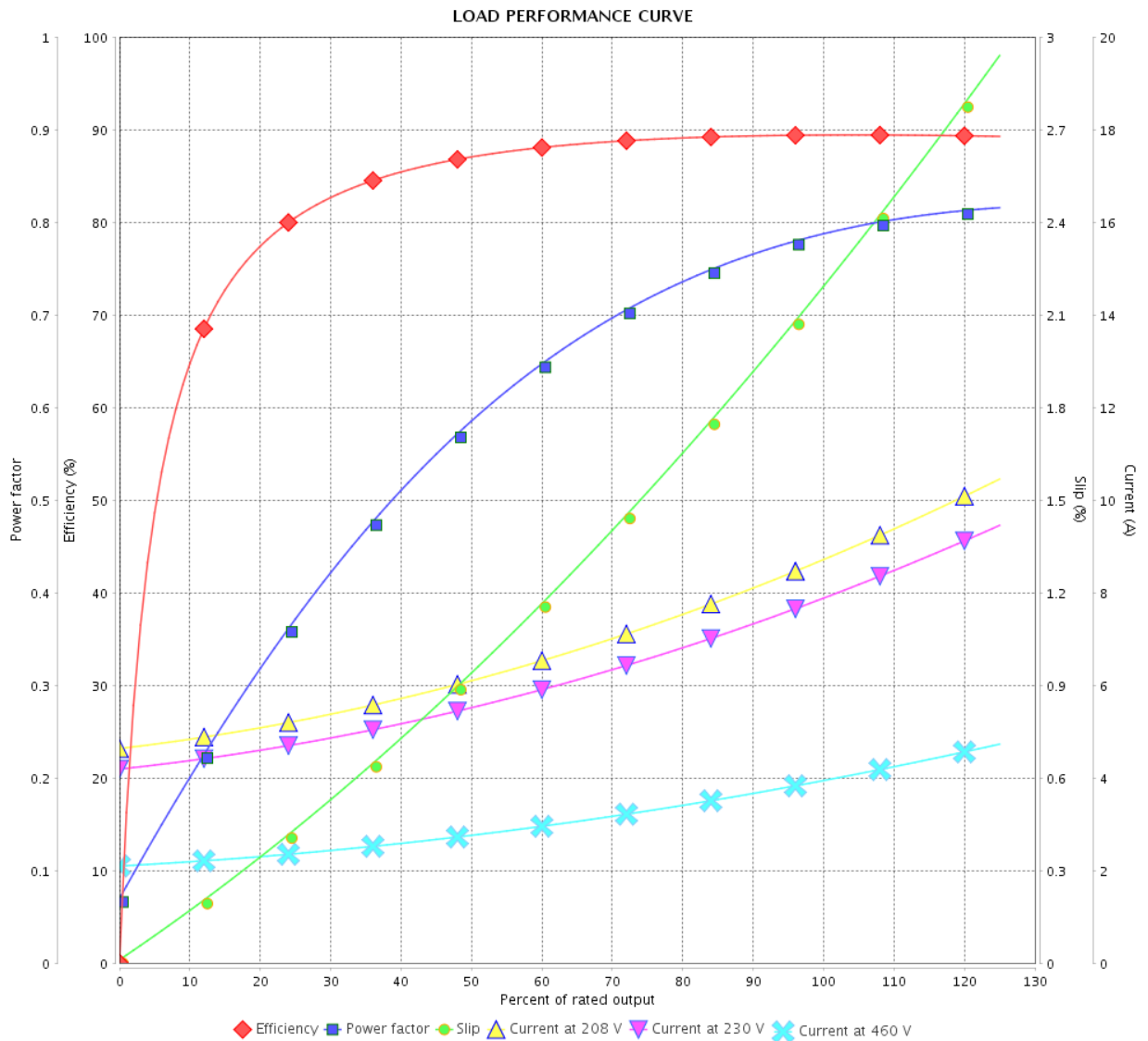

Performance : 230/460 V 60 Hz 4P

Rated current : 7.82/3.91 A
 LRC : 8.0
 Rated torque : 8.95 ft.lb
 Locked rotor torque : 250 %
 Breakdown torque : 320 %
 Rated speed : 1760 rpm

Moment of inertia (J) : 0.2781 sq.ft.lb
 Duty cycle : Cont.(S1)
 Insulation class : F
 Service factor : 1.15
 Temperature rise : 80 K
 Design : B

Rev.	Changes Summary	Performed	Checked	Date
Performed by			Page	Revision
Checked by				
Date				

LOAD PERFORMANCE CURVE

Three Phase Induction Motor - Squirrel Cage



Customer :

Product line : NEMA Premium Efficiency Three-Phase

Product code : 14188755

Catalog # : 00318XT3E182JP

LOAD PERFORMANCE CURVE

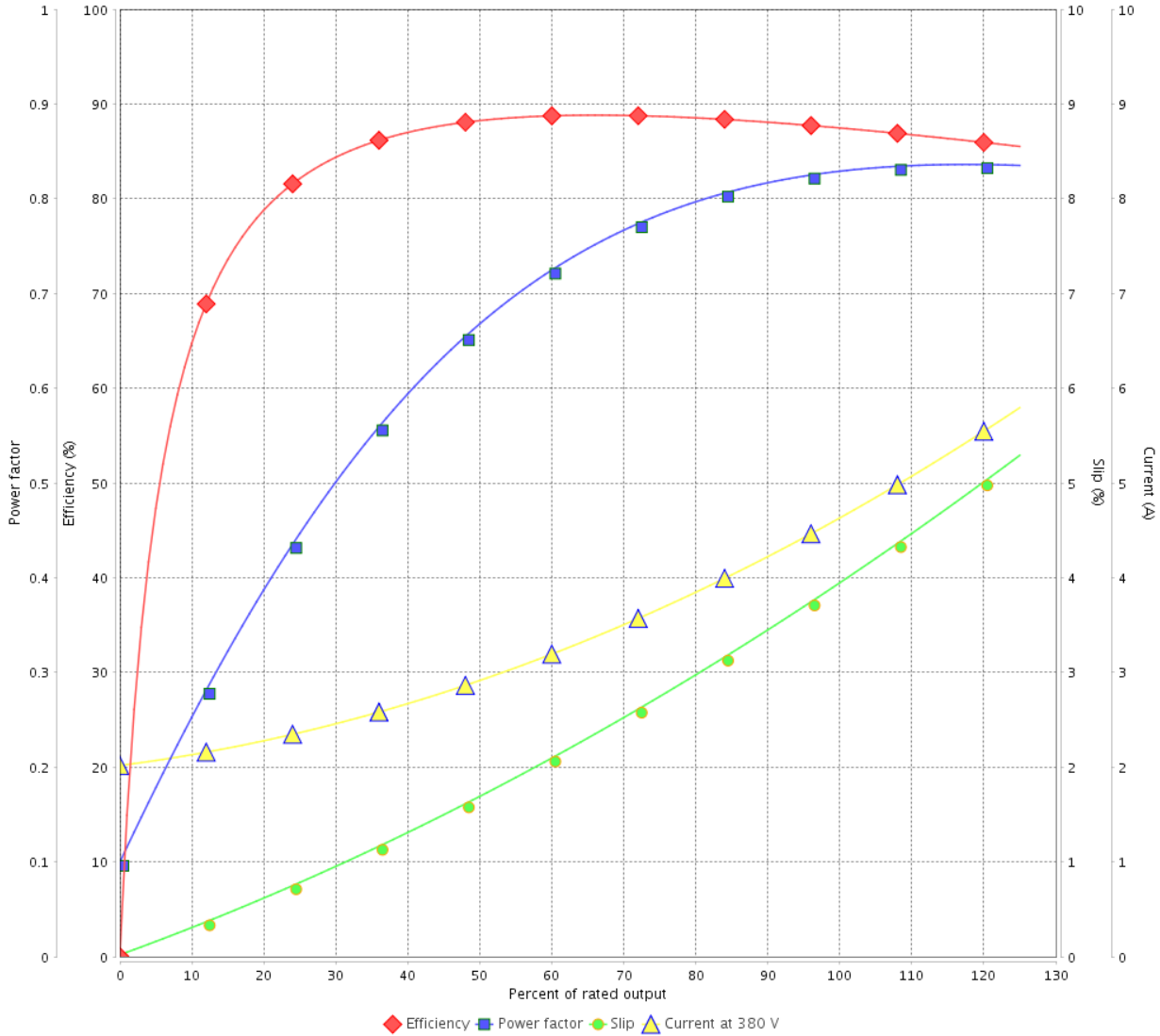

Performance : 380 V 50 Hz 4P IE3

Rated current : 4.60 A
 LRC : 6.4
 Rated torque : 10.9 ft.lb
 Locked rotor torque : 200 %
 Breakdown torque : 229 %
 Rated speed : 1440 rpm

Moment of inertia (J) : 0.2781 sq.ft.lb
 Duty cycle : Cont.(S1)
 Insulation class : F
 Service factor : 1.00
 Temperature rise : 80 K
 Design : B

Rev.	Changes Summary	Performed	Checked	Date
Performed by			Page	Revision
Checked by			8 / 22	
Date	14/04/2022			

LOAD PERFORMANCE CURVE

Three Phase Induction Motor - Squirrel Cage



Customer : _____

Product line : NEMA Premium Efficiency Three-Phase

Product code : 14188755

Catalog # : 00318XT3E182JP

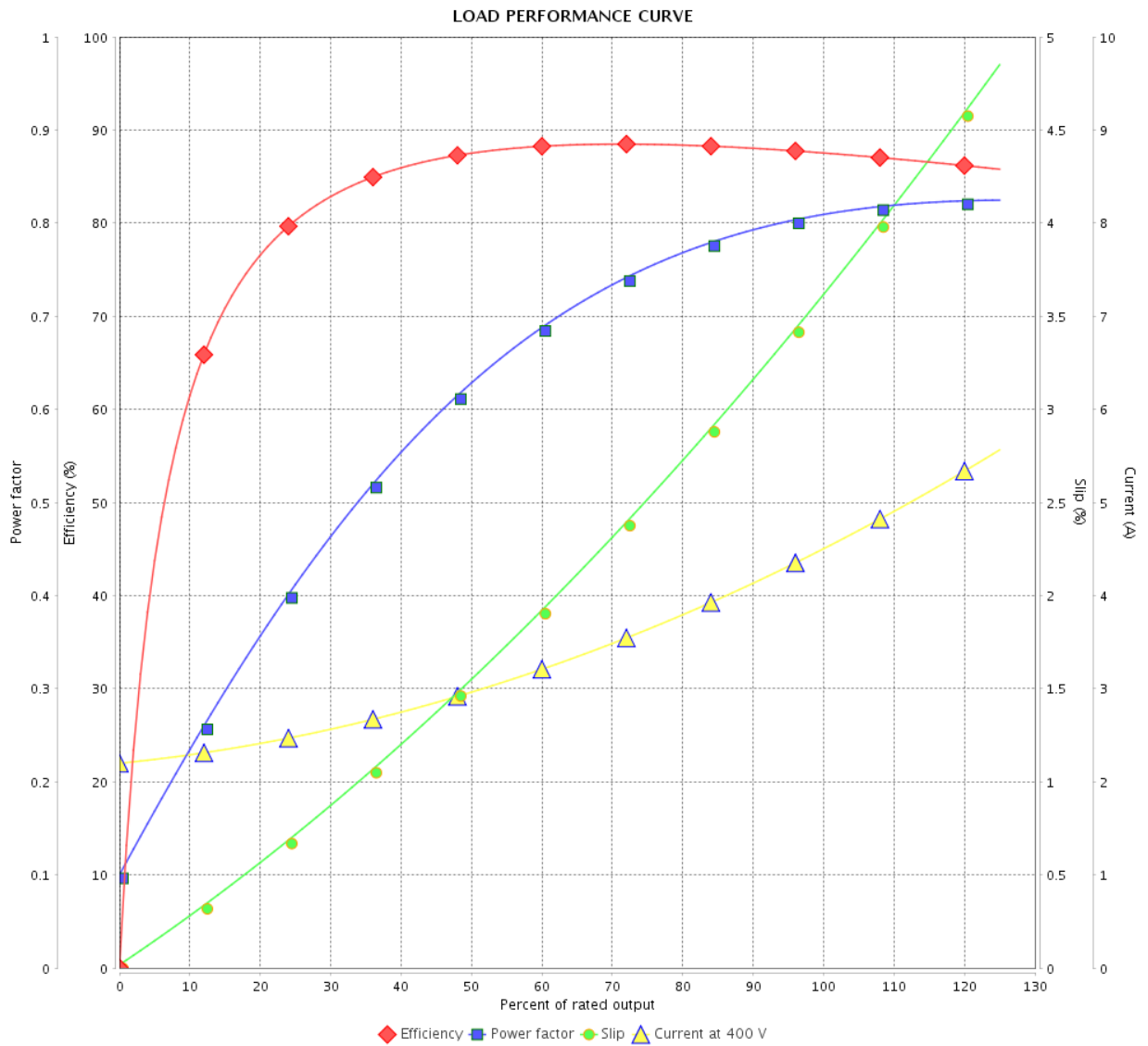

Performance : 400 V 50 Hz 4P IE3

Rated current : 4.48 A
 LRC : 7.0
 Rated torque : 10.9 ft.lb
 Locked rotor torque : 229 %
 Breakdown torque : 260 %
 Rated speed : 1445 rpm

Moment of inertia (J) : 0.2781 sq.ft.lb
 Duty cycle : Cont.(S1)
 Insulation class : F
 Service factor : 1.00
 Temperature rise : 80 K
 Design : B

Rev.	Changes Summary	Performed	Checked	Date
Performed by		Page		Revision
Checked by		9 / 22		
Date		14/04/2022		

LOAD PERFORMANCE CURVE

Three Phase Induction Motor - Squirrel Cage



Customer :

Product line : NEMA Premium Efficiency Three-Phase

Product code : 14188755

Catalog # : 00318XT3E182JP

LOAD PERFORMANCE CURVE

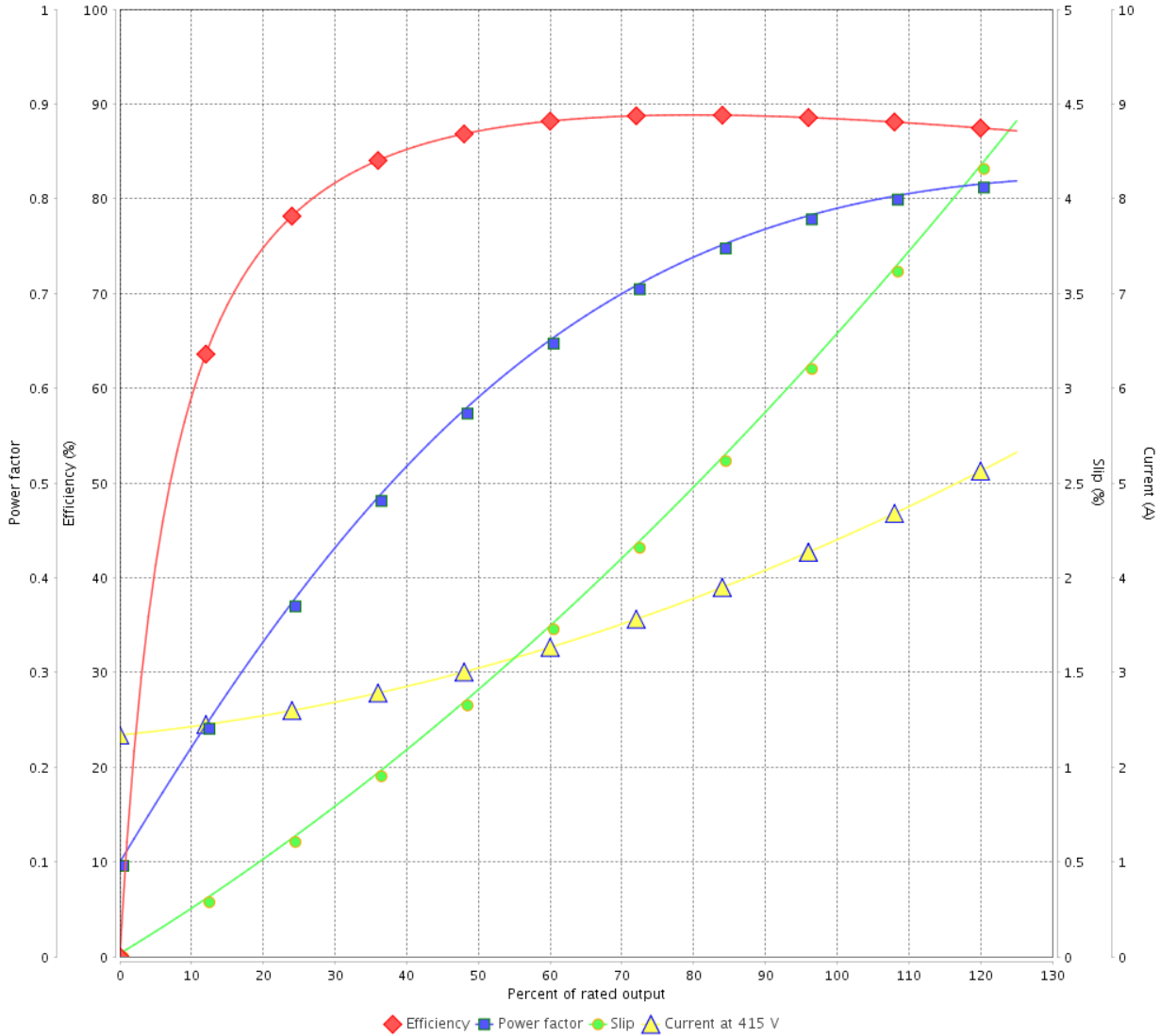

Performance : 415 V 50 Hz 4P IE3

Rated current : 4.38 A
 LRC : 7.4
 Rated torque : 10.9 ft.lb
 Locked rotor torque : 260 %
 Breakdown torque : 290 %
 Rated speed : 1450 rpm

Moment of inertia (J) : 0.2781 sq.ft.lb
 Duty cycle : Cont.(S1)
 Insulation class : F
 Service factor : 1.00
 Temperature rise : 80 K
 Design : B

Rev.	Changes Summary	Performed	Checked	Date
Performed by			Page	Revision
Checked by			10 / 22	
Date	14/04/2022			

THERMAL LIMIT CURVE



Three Phase Induction Motor - Squirrel Cage

Customer :

Product line : NEMA Premium Efficiency Three-Phase
 Product code : 14188755
 Catalog # : 00318XT3E182JP

Performance : 230/460 V 60 Hz 4P

Rated current : 7.82/3.91 A	Moment of inertia (J) : 0.2781 sq.ft.lb
LRC : 8.0	Duty cycle : Cont.(S1)
Rated torque : 8.95 ft.lb	Insulation class : F
Locked rotor torque : 250 %	Service factor : 1.15
Breakdown torque : 320 %	Temperature rise : 80 K
Rated speed : 1760 rpm	Design : B

Heating constant

Cooling constant

Rev.	Changes Summary	Performed	Checked	Date
Performed by			Page 11 / 22	Revision
Checked by				
Date	14/04/2022			

THERMAL LIMIT CURVE

Three Phase Induction Motor - Squirrel Cage



Customer : _____

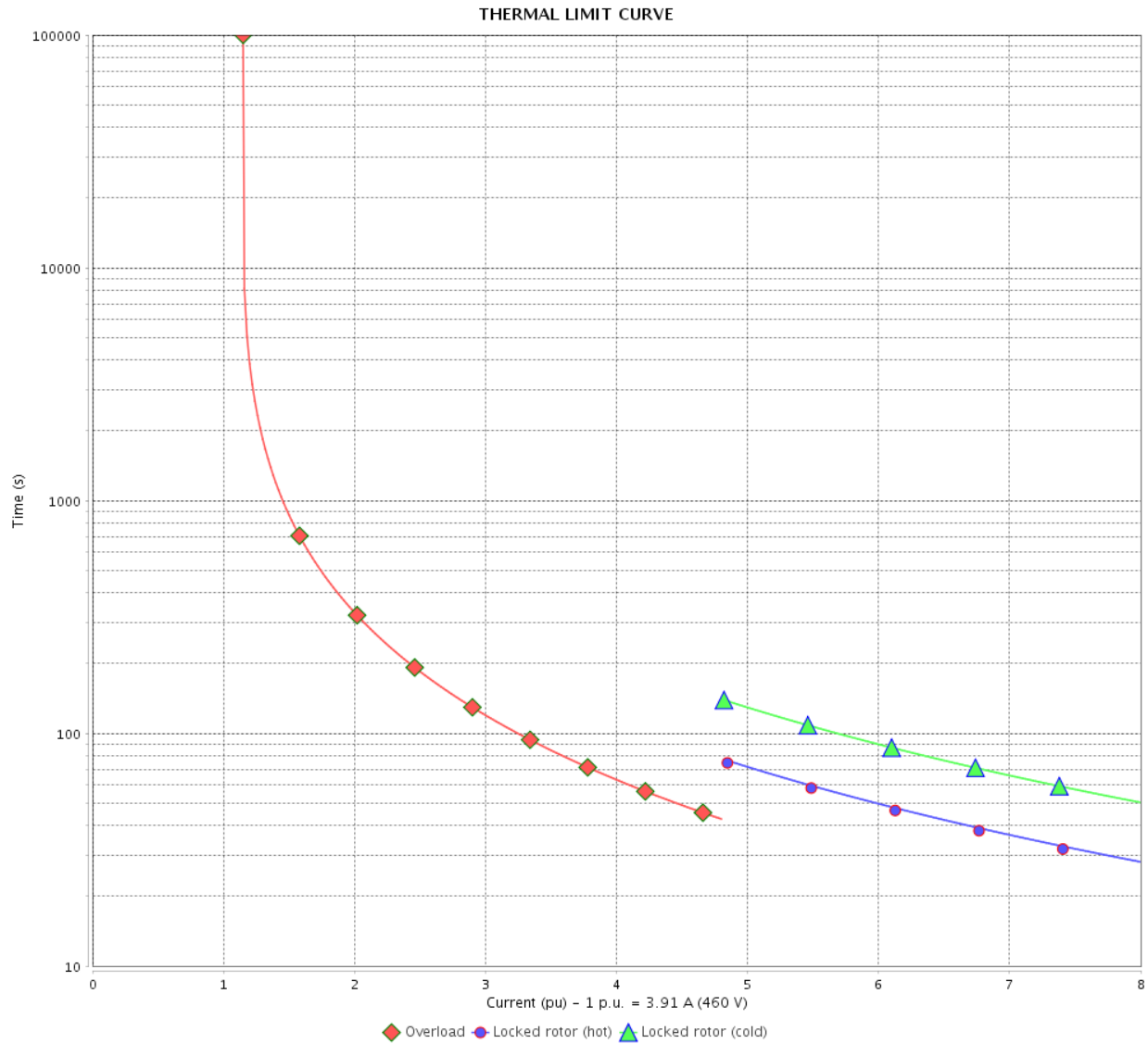

Rev.	Changes Summary	Performed	Checked	Date
Performed by		Page 12 / 22		Revision
Checked by				
Date				

THERMAL LIMIT CURVE



Three Phase Induction Motor - Squirrel Cage

Customer :

Product line : NEMA Premium Efficiency Three-Phase
 Product code : 14188755
 Catalog # : 00318XT3E182JP

Performance : 380 V 50 Hz 4P IE3

Rated current : 4.60 A	Moment of inertia (J) : 0.2781 sq.ft.lb
LRC : 6.4	Duty cycle : Cont.(S1)
Rated torque : 10.9 ft.lb	Insulation class : F
Locked rotor torque : 200 %	Service factor : 1.00
Breakdown torque : 229 %	Temperature rise : 80 K
Rated speed : 1440 rpm	Design : B

Heating constant

Cooling constant

Rev.	Changes Summary	Performed	Checked	Date
Performed by			Page 13 / 22	Revision
Checked by				
Date	14/04/2022			

THERMAL LIMIT CURVE

Three Phase Induction Motor - Squirrel Cage



Customer : _____

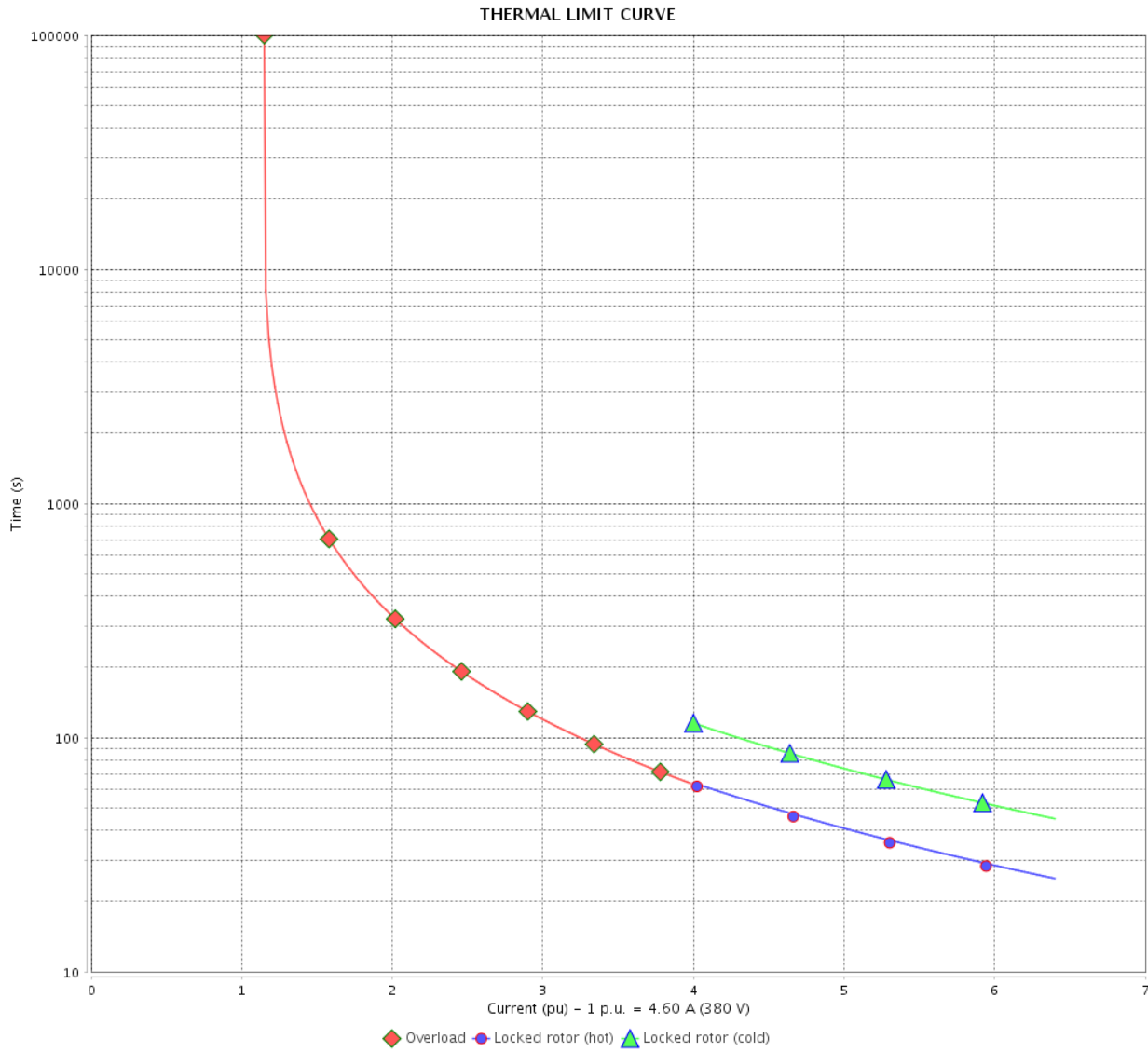

Rev.	Changes Summary	Performed	Checked	Date
Performed by		Page		Revision
Checked by		14 / 22		
Date		14/04/2022		

THERMAL LIMIT CURVE



Three Phase Induction Motor - Squirrel Cage

Customer :

Product line : NEMA Premium Efficiency Three-Phase
 Product code : 14188755
 Catalog # : 00318XT3E182JP

Performance : 400 V 50 Hz 4P IE3

Rated current : 4.48 A	Moment of inertia (J) : 0.2781 sq.ft.lb
LRC : 7.0	Duty cycle : Cont.(S1)
Rated torque : 10.9 ft.lb	Insulation class : F
Locked rotor torque : 229 %	Service factor : 1.00
Breakdown torque : 260 %	Temperature rise : 80 K
Rated speed : 1445 rpm	Design : B

Heating constant

Cooling constant

Rev.	Changes Summary	Performed	Checked	Date
Performed by			Page	Revision
Checked by				
Date	14/04/2022	15 / 22		

THERMAL LIMIT CURVE

Three Phase Induction Motor - Squirrel Cage



Customer : _____

THERMAL LIMIT CURVE

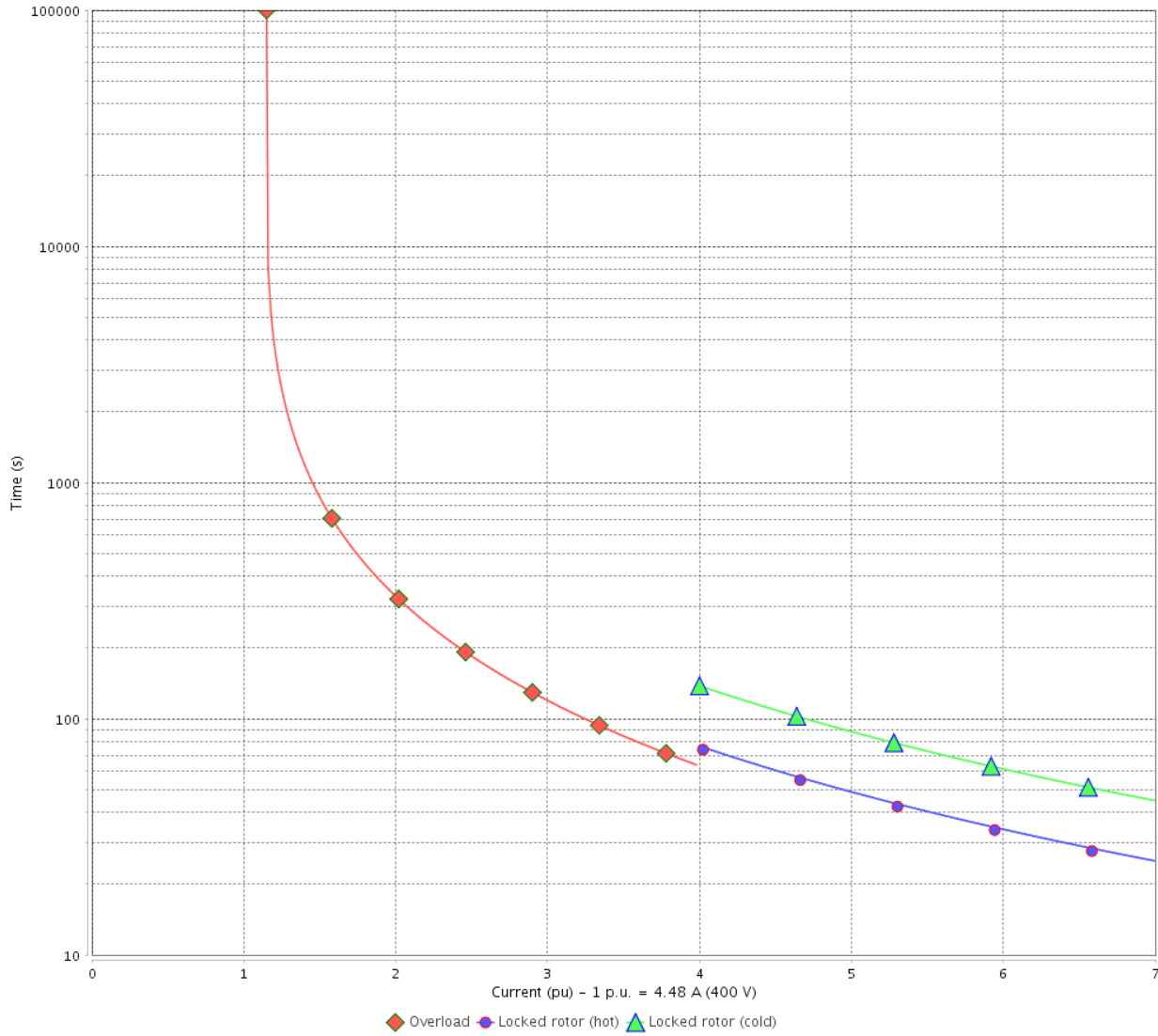

Rev.	Changes Summary	Performed	Checked	Date
Performed by		Page		Revision
Checked by		16 / 22		
Date		14/04/2022		

THERMAL LIMIT CURVE



Three Phase Induction Motor - Squirrel Cage

Customer :

Product line : NEMA Premium Efficiency Three-Phase
 Product code : 14188755
 Catalog # : 00318XT3E182JP

Performance : 415 V 50 Hz 4P IE3

Rated current : 4.38 A	Moment of inertia (J) : 0.2781 sq.ft.lb
LRC : 7.4	Duty cycle : Cont.(S1)
Rated torque : 10.9 ft.lb	Insulation class : F
Locked rotor torque : 260 %	Service factor : 1.00
Breakdown torque : 290 %	Temperature rise : 80 K
Rated speed : 1450 rpm	Design : B

Heating constant

Cooling constant

Rev.	Changes Summary	Performed	Checked	Date
Performed by			Page 17 / 22	Revision
Checked by				
Date	14/04/2022			

THERMAL LIMIT CURVE

Three Phase Induction Motor - Squirrel Cage



Customer : _____

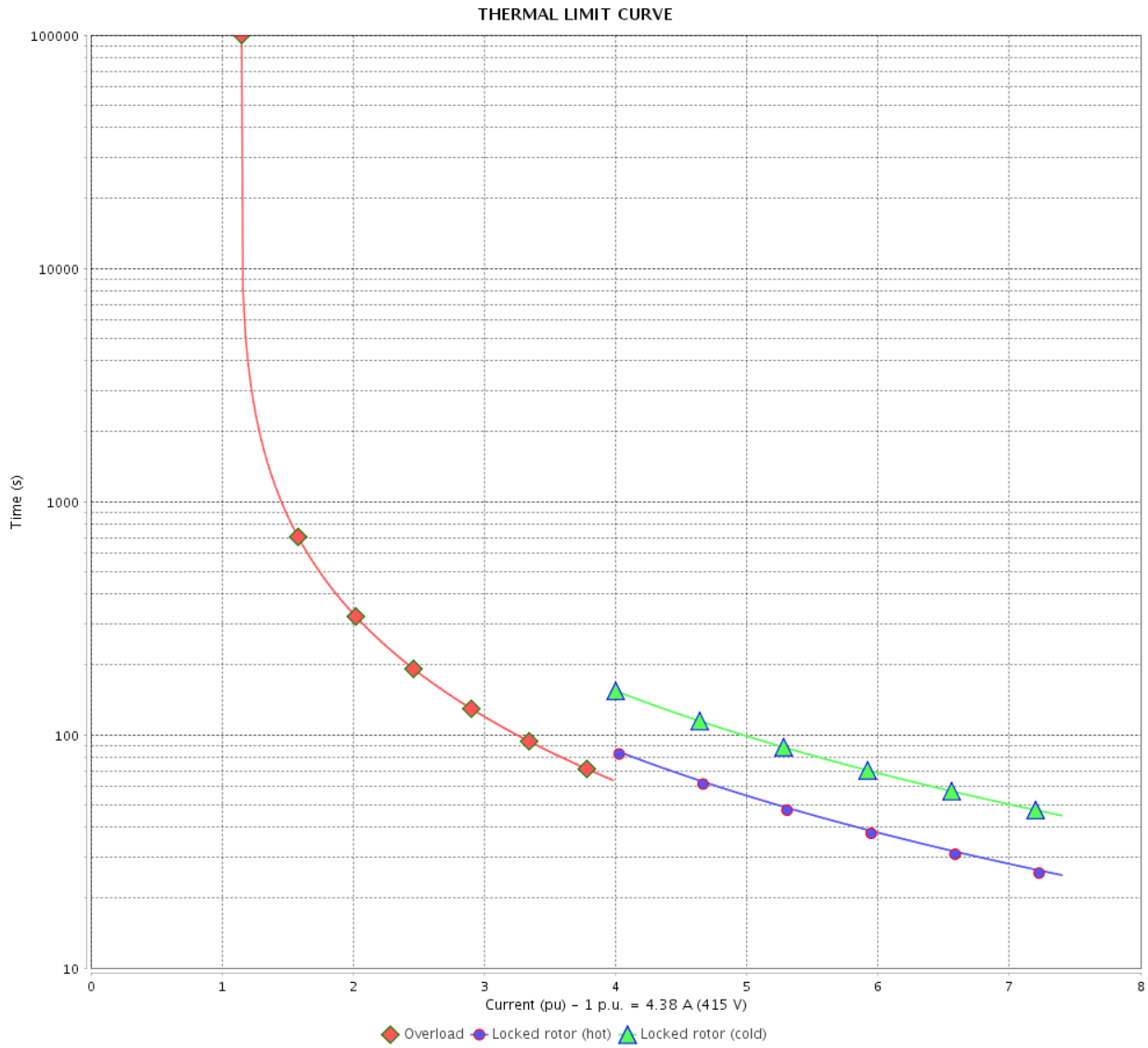

Rev.	Changes Summary	Performed	Checked	Date
Performed by		Page 18 / 22		Revision
Checked by				
Date				

VFD OPERATION CURVE

Three Phase Induction Motor - Squirrel Cage



Customer :

Product line : NEMA Premium Efficiency Three-Phase

Product code : 14188755

Catalog # : 00318XT3E182JP

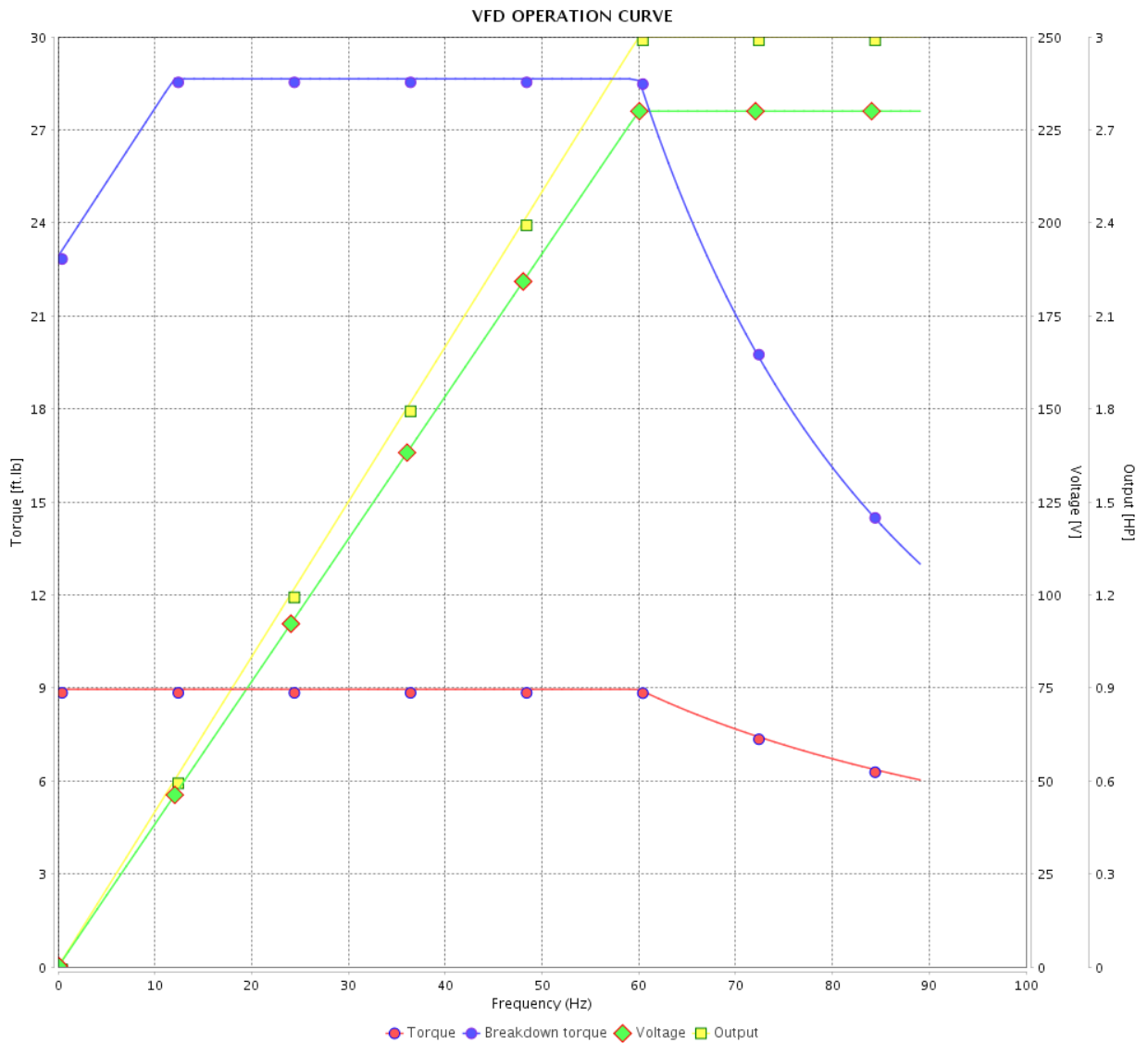

Performance : 230/460 V 60 Hz 4P

Rated current : 7.82/3.91 A
 LRC : 8.0
 Rated torque : 8.95 ft.lb
 Locked rotor torque : 250 %
 Breakdown torque : 320 %
 Rated speed : 1760 rpm

Moment of inertia (J) : 0.2781 sq.ft.lb
 Duty cycle : Cont.(S1)
 Insulation class : F
 Service factor : 1.15
 Temperature rise : 80 K
 Design : B

Rev.	Changes Summary	Performed	Checked	Date
Performed by				Page 19 / 22
Checked by				
Date	14/04/2022			

VFD OPERATION CURVE

Three Phase Induction Motor - Squirrel Cage



Customer : _____

Product line : NEMA Premium Efficiency Three-Phase

Product code : 14188755

Catalog # : 00318XT3E182JP

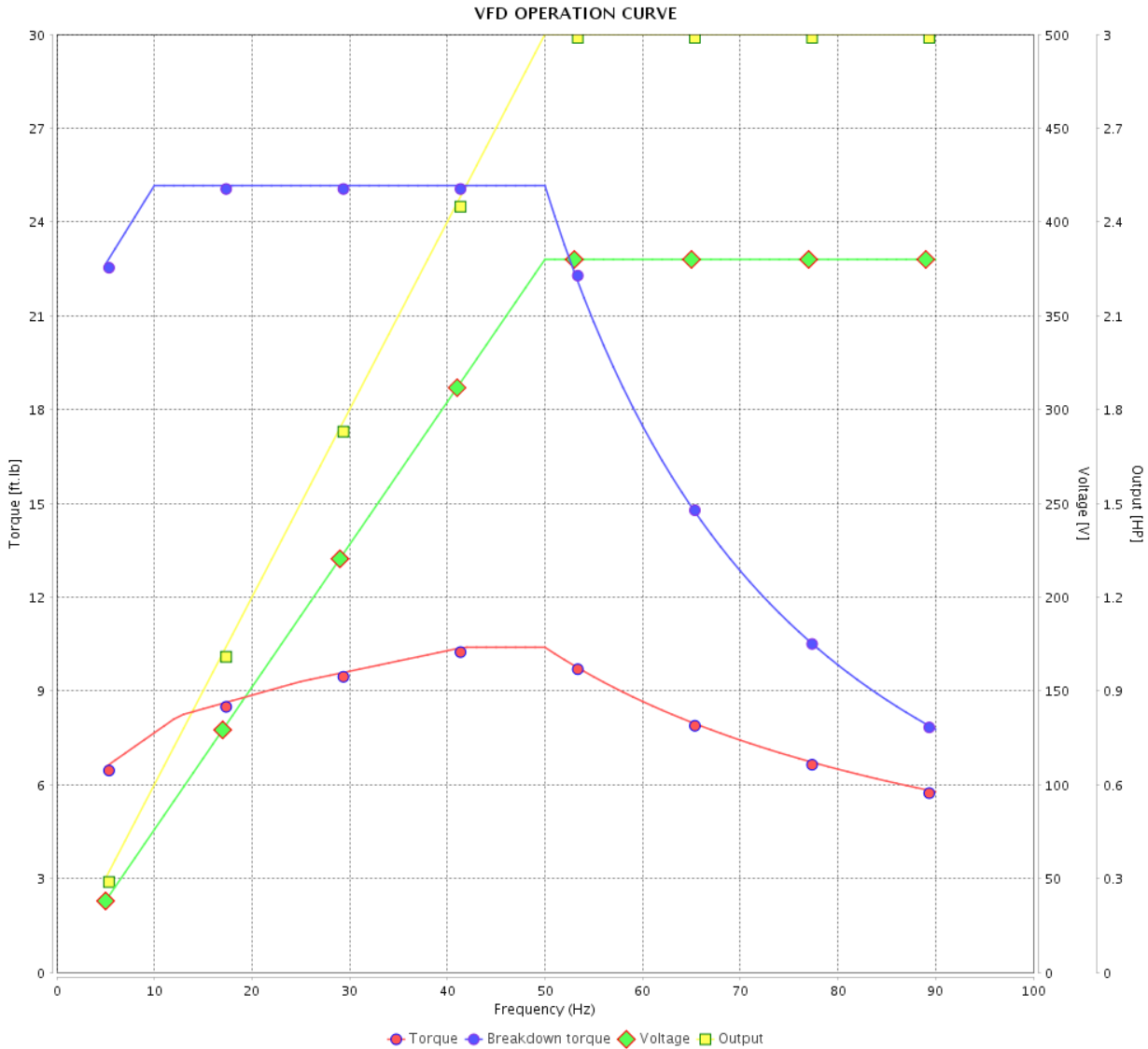

Performance : 380 V 50 Hz 4P IE3

Rated current : 4.60 A
 LRC : 6.4
 Rated torque : 10.9 ft.lb
 Locked rotor torque : 200 %
 Breakdown torque : 229 %
 Rated speed : 1440 rpm

Moment of inertia (J) : 0.2781 sq.ft.lb
 Duty cycle : Cont.(S1)
 Insulation class : F
 Service factor : 1.00
 Temperature rise : 80 K
 Design : B

Rev.	Changes Summary	Performed	Checked	Date
Performed by			Page 20 / 22	Revision
Checked by				
Date	14/04/2022			

VFD OPERATION CURVE

Three Phase Induction Motor - Squirrel Cage



Customer :

Product line : NEMA Premium Efficiency Three-Phase

Product code : 14188755

Catalog # : 00318XT3E182JP

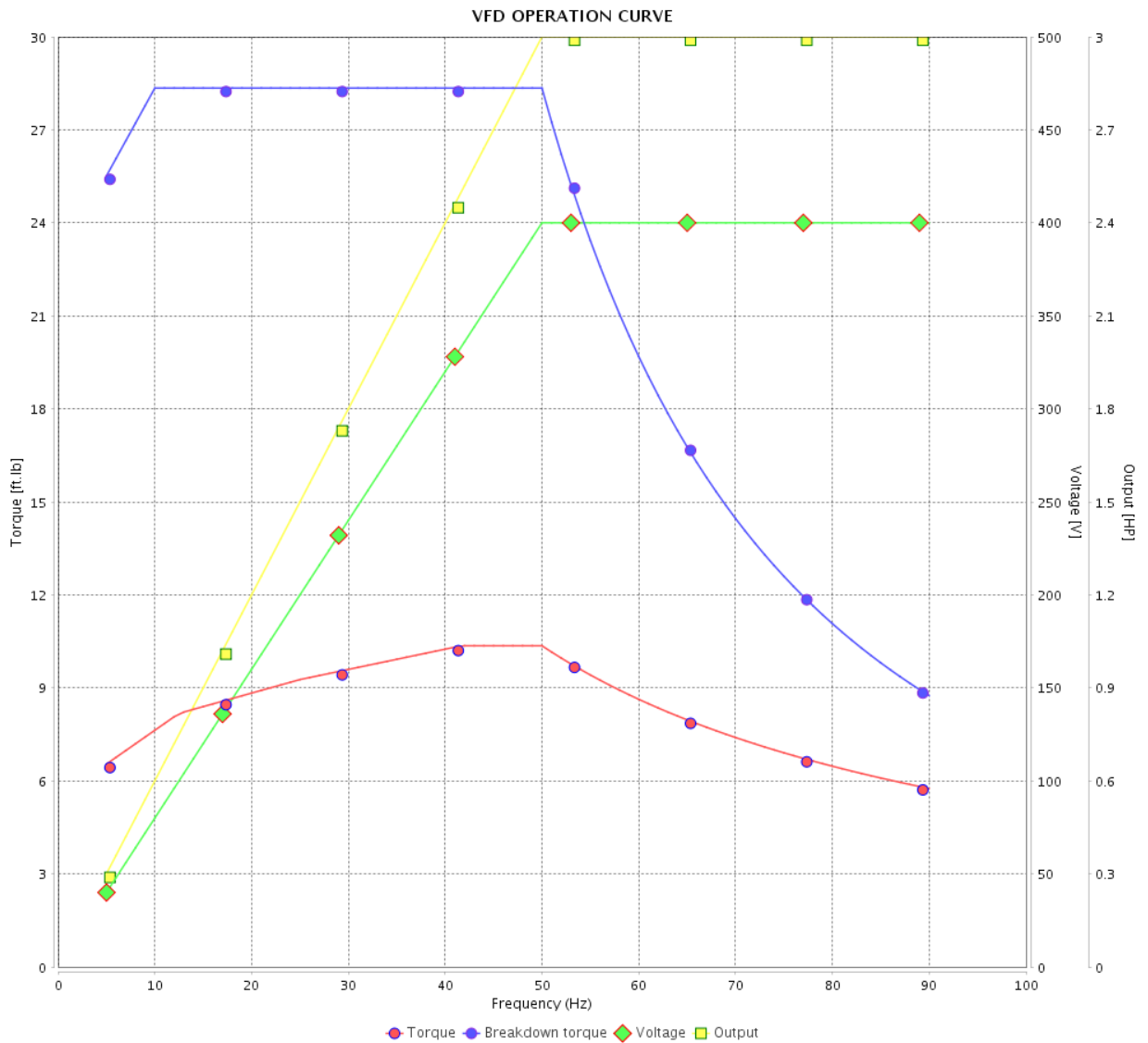

Performance : 400 V 50 Hz 4P IE3

Rated current : 4.48 A
 LRC : 7.0
 Rated torque : 10.9 ft.lb
 Locked rotor torque : 229 %
 Breakdown torque : 260 %
 Rated speed : 1445 rpm

Moment of inertia (J) : 0.2781 sq.ft.lb
 Duty cycle : Cont.(S1)
 Insulation class : F
 Service factor : 1.00
 Temperature rise : 80 K
 Design : B

Rev.	Changes Summary	Performed	Checked	Date
Performed by			Page	Revision
Checked by				
Date				
			21 / 22	

VFD OPERATION CURVE

Three Phase Induction Motor - Squirrel Cage



Customer :

Product line : NEMA Premium Efficiency Three-Phase

Product code : 14188755

Catalog # : 00318XT3E182JP

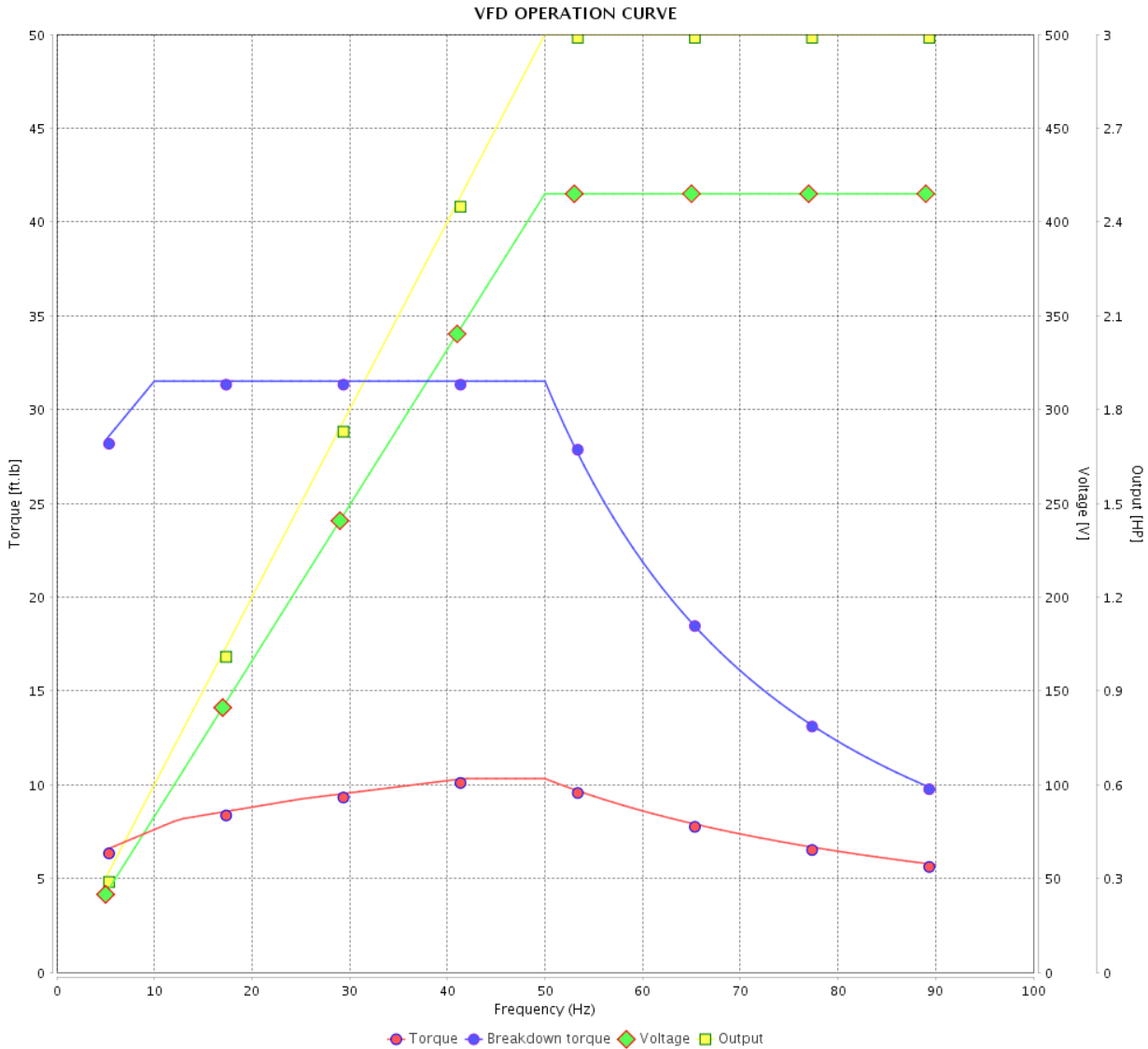

Performance : 415 V 50 Hz 4P IE3

Rated current : 4.38 A
 LRC : 7.4
 Rated torque : 10.9 ft.lb
 Locked rotor torque : 260 %
 Breakdown torque : 290 %
 Rated speed : 1450 rpm

Moment of inertia (J) : 0.2781 sq.ft.lb
 Duty cycle : Cont.(S1)
 Insulation class : F
 Service factor : 1.00
 Temperature rise : 80 K
 Design : B

Rev.	Changes Summary	Performed	Checked	Date
Performed by			Page 22 / 22	Revision
Checked by				
Date	14/04/2022			

EIXO/SHAFT	
PADRÃO/STANDARD	
OPCIONAL/OPTIONAL	
ESPECIAL/SPECIAL	X

Dimensões em polegada
Dimensions in inches

CERTIFIED WEG MOTORES
Certified document.
Not subject to changes.

THIS IS AN UPDATED REVISION, THE PREVIOUS ONE MUST BE DISREGARDED.

A
B
C
D
E

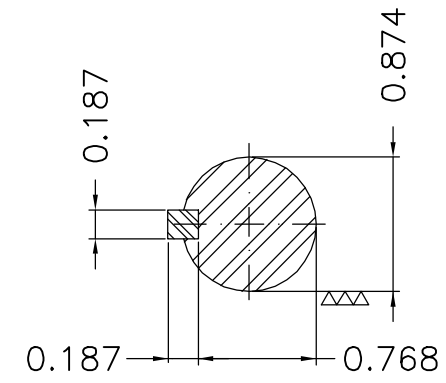
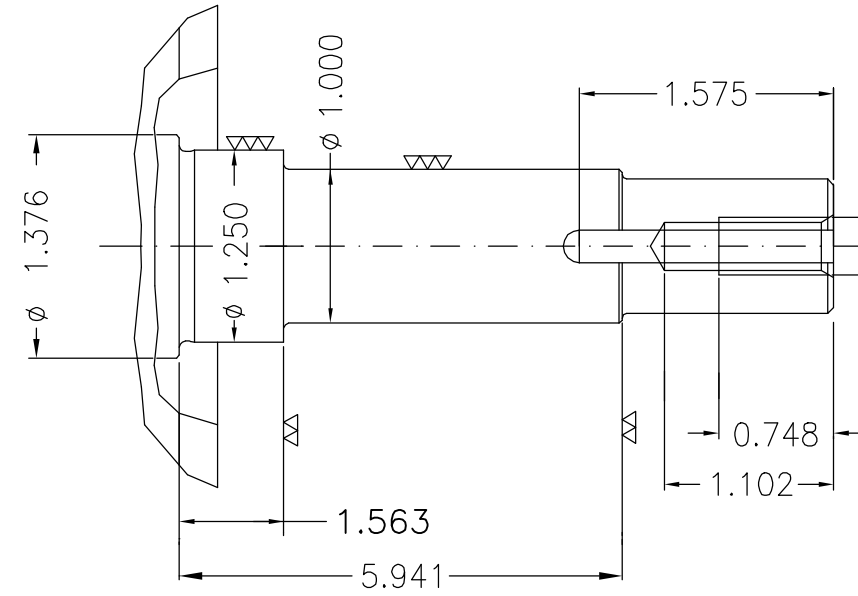
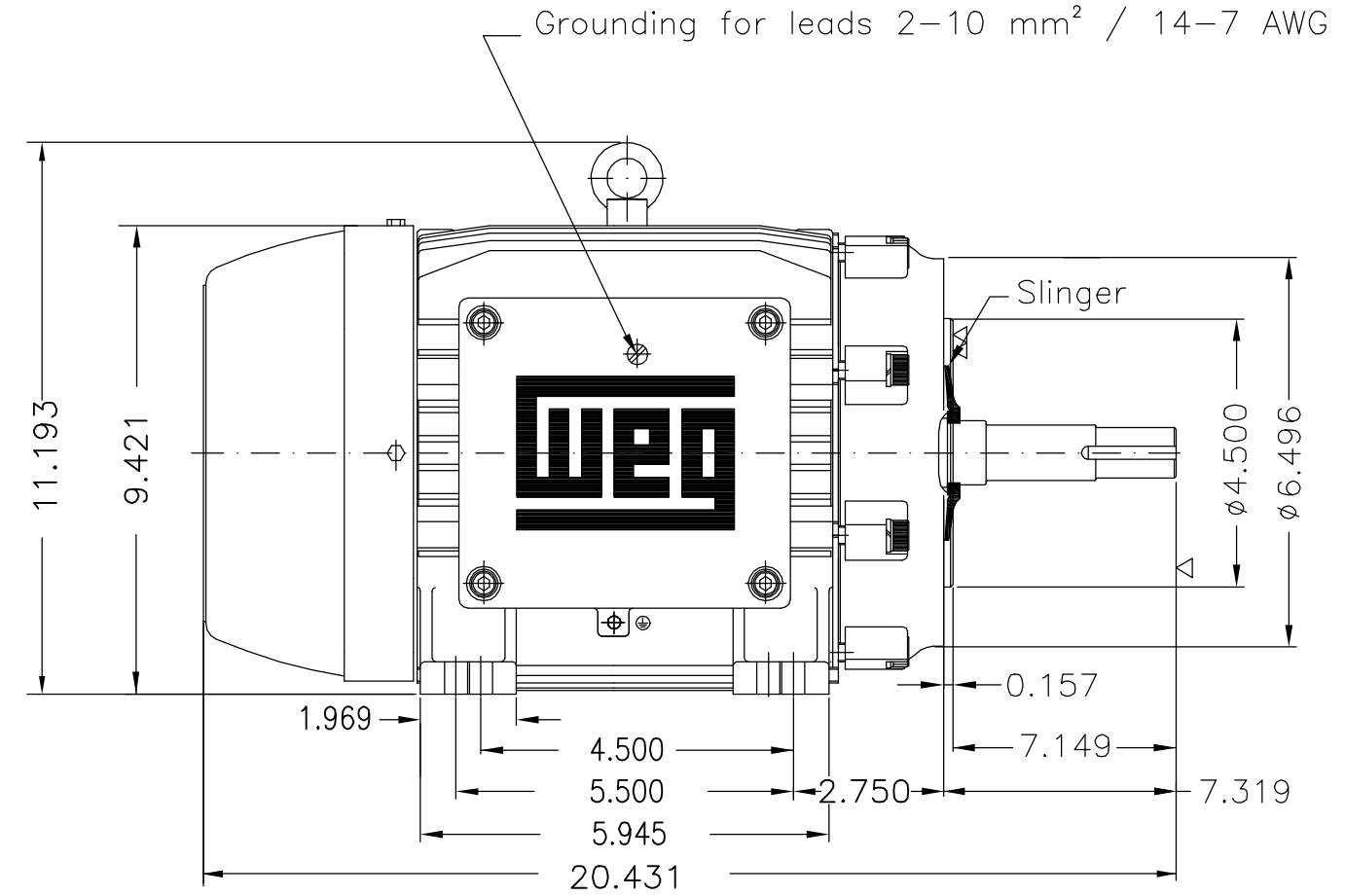
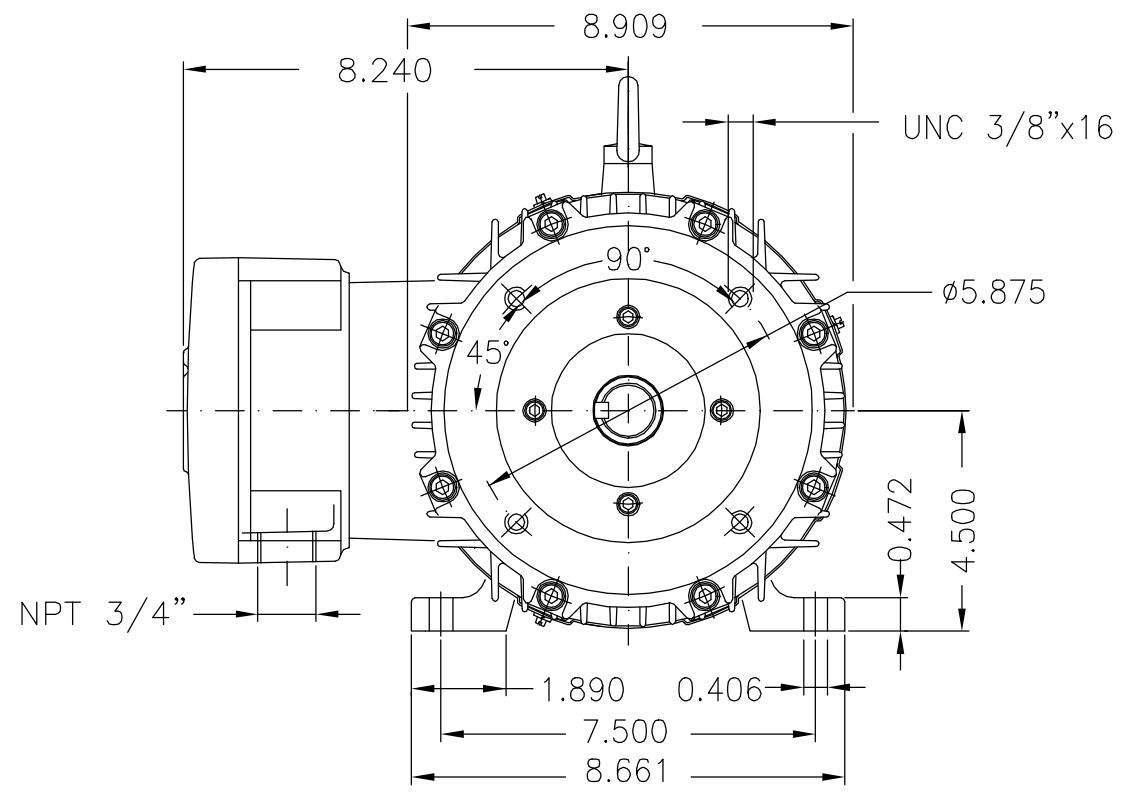

EUNC 3/8"-16 WEG TBG253

DE Shaft End

- Ponta de eixo JP / JP shaft end
- Tampa flangeada especial / Special flanged endshield
- Cor RAL 5009 / Color RAL 5009
- Plano de pintura 202P / Painting plan 202P
- Forma construtiva NEMA F-1 / Mounting NEMA F-1
- Forma construtiva B34D / Mounting B34R(D)

WEG ELECTRIC CORPORATION - WEC

500001594952		ALTERADO CONF. CLAIM 415204042	RICLAV	DALTONR	DALTONR	23.05.2019	06
500001500307	C-3	CORRIGIDO COTA "AH"	NSCHMIDT	RAFAELVARGAS	RAFAELVARGAS	11.09.2018	05
ECM	LOC	SUMMARY OF MODIFICATIONS	EXECUTED	CHECKED	RELEASED	DATE	VER
EXECUTED	NSCHMIDT	THREE-PHASE EXPLOSION PROOF MOTOR FRAME 182/4TZ IP55 TEFC	10005273980				
CHECKED	ADRIANAP		000	06			
RELEASED	ADRIANAP		SHEET 1 / 2				
REL DT	10.10.2017	WMO Jaraguá do Sul	Product Engineering				

3 HP 04 Poles 60Hz 414828739/0

UNCONTROLLED COPY RELEASED ZME A3

MADE IN BRAZIL

**W21X NEMA**
Premium

14188755



LISTED

CC029A

Inverter Duty Motor
Severe Duty

MODEL 00318XT3E182JP

PH 3	FR 182/4TZ		
HP(kW) 3.0(2.2)		HZ 60	IP55
V 230/460		A 7.82/3.91	
RPM 1760		NEMA NOM EFF 89.5%	
PF 0.79		SFA 8.99/4.50	DES B
INS CL F Δ T 80 K		SF 1.15	ENCL TEFC
DUTY CONT.		CODE K	ALT 1000 m.a.s.l.
AMB 40°C	USABLE @208V	8.65 A	SF 1.15 SFA 9.95

3.0HP 2.2kW 50Hz 380V 4.60A 1440RPM SF1.00 EFF 87.5% (IE3)

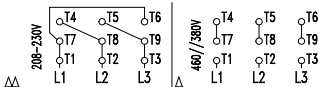

→ 6307-2RS MOBIL POLYREX EM

→ 6206-2RS

126 Lbs



TEMP CODE T3C

CSA/UL: Class I - Div. 1 - Groups C and D

CSA: Class II - Div. 1 - Groups F and G

CSA: Class I - Zone 1 - IIB

EXPLOSION PROOF MOTOR

FOR USE ON VPWM VFD 1000:1VT, 20:1CT, 1.0SF, T3C, AMB 40°C.