

DATA SHEET

Three Phase Induction Motor - Squirrel Cage



| | | | | | |
|--|---|-----------------------------|--|----------------------|----------------------|
| Customer | | | | | |
| Product line | : NEMA Premium Efficiency Three-Phase | Product code : | 14276568 | | |
| | | Catalog # : | 00518XT3E184T | | |
| Frame | : 182/4T | Cooling method | : IC411 - TEFC | | |
| Insulation class | : F | Mounting | : F-1 | | |
| Duty cycle | : Cont.(S1) | Rotation ¹ | : Both (CW and CCW) | | |
| Ambient temperature | : -20°C to +40°C | Starting method | : Direct On Line | | |
| Altitude | : 1000 m.a.s.l. | Approx. weight ² | : 133 lb | | |
| Protection degree | : IP55 | Moment of inertia (J) | : 0.3695 sq.ft.lb | | |
| Design | : B | | | | |
| Output [HP] | 5 | 5 | 5 | 5 | 5 |
| Poles | 4 | 4 | 4 | 4 | 4 |
| Frequency [Hz] | 60 | 50 | 50 | 50 | 50 |
| Rated voltage [V] | 230/460 | 380 | 400 | 415 | 415 |
| Rated current [A] | 13.1/6.57 | 7.83 | 7.54 | 7.45 | 7.45 |
| L. R. Amperes [A] | 93.3/46.6 | 47.8 | 51.3 | 53.6 | 53.6 |
| LRC [A] | 7.1x(Code J) | 6.1x(Code G) | 6.8x(Code J) | 7.2x(Code J) | 7.2x(Code J) |
| No load current [A] | 6.20/3.10 | 3.10 | 3.40 | 3.80 | 3.80 |
| Rated speed [RPM] | 1750 | 1435 | 1440 | 1445 | 1445 |
| Slip [%] | 2.78 | 4.33 | 4.00 | 3.67 | 3.67 |
| Rated torque [ft.lb] | 15.0 | 18.3 | 18.2 | 18.2 | 18.2 |
| Locked rotor torque [%] | 229 | 210 | 229 | 250 | 250 |
| Breakdown torque [%] | 300 | 229 | 260 | 290 | 290 |
| Service factor | 1.15 | 1.00 | 1.00 | 1.00 | 1.00 |
| Temperature rise | 80 K | 80 K | 80 K | 80 K | 80 K |
| Locked rotor time | 43s (cold) 24s (hot) | 36s (cold) 20s (hot) | 36s (cold) 20s (hot) | 34s (cold) 19s (hot) | 34s (cold) 19s (hot) |
| Noise level ² | 56.0 dB(A) | 56.0 dB(A) | 56.0 dB(A) | 56.0 dB(A) | 56.0 dB(A) |
| Efficiency (%) | 25% | 85.3 | 85.7 | 85.8 | 85.8 |
| | 50% | 86.5 | 86.0 | 86.5 | 86.5 |
| | 75% | 88.5 | 86.5 | 87.0 | 87.0 |
| | 100% | 89.5 | 86.5 | 87.5 | 87.5 |
| Power Factor | 25% | 0.36 | 0.43 | 0.39 | 0.35 |
| | 50% | 0.59 | 0.67 | 0.63 | 0.59 |
| | 75% | 0.71 | 0.77 | 0.74 | 0.72 |
| | 100% | 0.79 | 0.83 | 0.81 | 0.79 |
| Bearing type | : <u>Drive end</u> 6307 2RS <u>Non drive end</u> 6206 2RS | Foundation loads | | | |
| Sealing | : Oil Seal Lip Seal | Max. traction | : 270 lb | | |
| Lubrication interval | : - - | Max. compression | : 403 lb | | |
| Lubricant amount | : - - | | | | |
| Lubricant type | : Mobil Polyrex EM | | | | |
| Notes | | | | | |
| USABLE @208V 14.5A SF 1.15 SFA 16.7A | | | | | |
| This revision replaces and cancel the previous one, which must be eliminated. (1) Looking the motor from the shaft end. (2) Measured at 1m and with tolerance of +3dB(A). (3) Approximate weight subject to changes after manufacturing process. (4) At 100% of full load. | | | These are average values based on tests with sinusoidal power supply, subject to the tolerances stipulated in NEMA MG-1. | | |
| Rev. | Changes Summary | | Performed | Checked | Date |
| Performed by | | | | | |
| Checked by | | | | Page | Revision |
| Date | 12/04/2022 | | | 1 / 22 | |

DATA SHEET

Three Phase Induction Motor - Squirrel Cage



Customer : _____

Thermal protection

| ID | Application | Type | Quantity | Sensing Temperature |
|----|-------------|----------------------|-----------|---------------------|
| 1 | Winding | Thermostat - 2 wires | 1 x Phase | 155 °C |

| Rev. | Changes Summary | Performed | Checked | Date |
|--------------|-----------------|-----------|---------|----------|
| Performed by | | | | |
| Checked by | | | Page | Revision |
| Date | 12/04/2022 | | 2 / 22 | |

TORQUE AND CURRENT VS SPEED CURVE



Three Phase Induction Motor - Squirrel Cage

Customer :

Product line : NEMA Premium Efficiency Three-Phase

Product code : 14276568

Catalog # : 00518XT3E184T

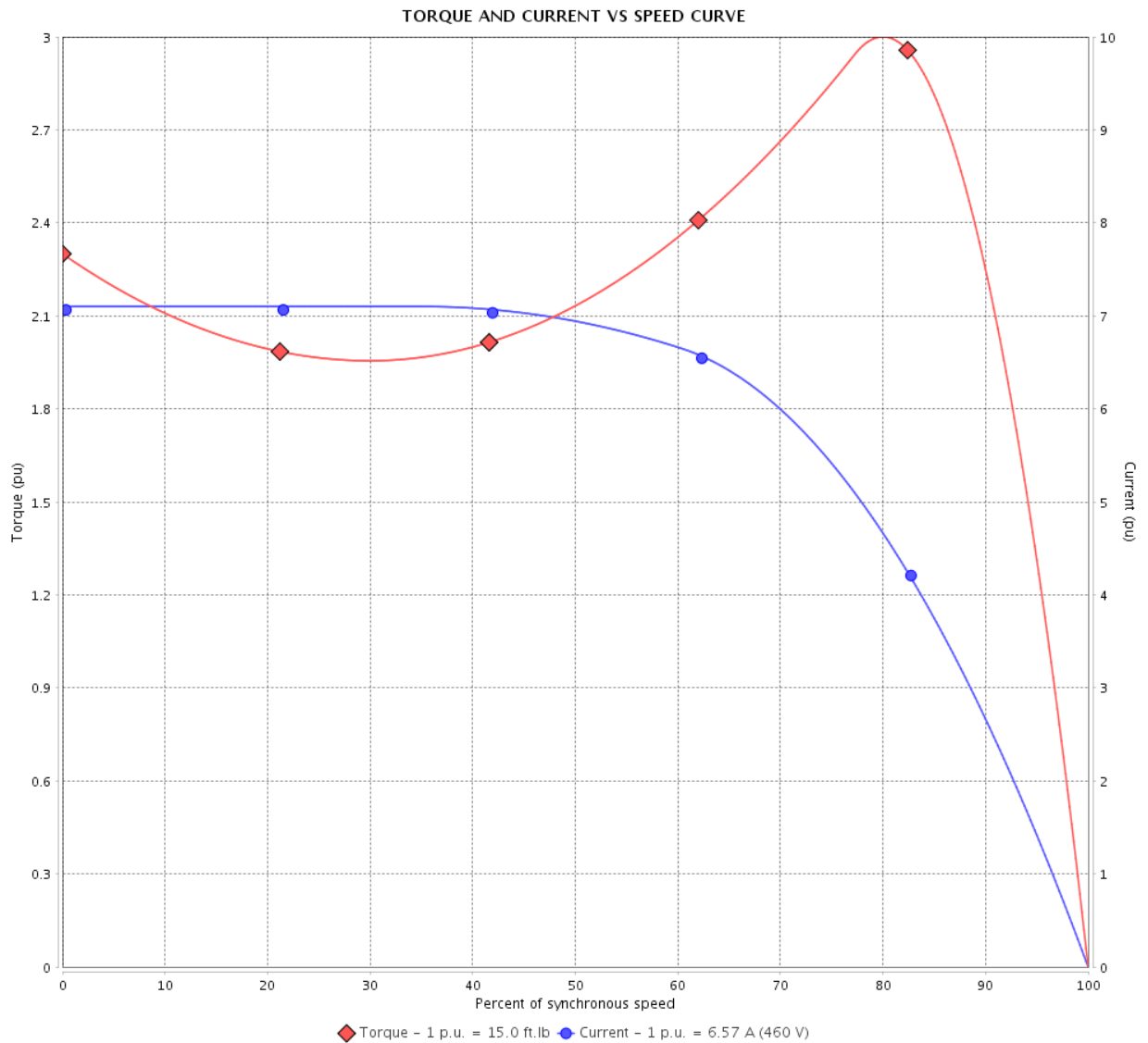

Performance : 230/460 V 60 Hz 4P

Rated current : 13.1/6.57 A
 LRC : 7.1
 Rated torque : 15.0 ft.lb
 Locked rotor torque : 229 %
 Breakdown torque : 300 %
 Rated speed : 1750 rpm

Moment of inertia (J) : 0.3695 sq.ft.lb
 Duty cycle : Cont.(S1)
 Insulation class : F
 Service factor : 1.15
 Temperature rise : 80 K
 Design : B

Locked rotor time : 43s (cold) 24s (hot)

| Rev. | Changes Summary | Performed | Checked | Date |
|--------------|-----------------|-----------|----------------|----------|
| | | | | |
| Performed by | | | Page 3 / 22 | Revision |
| Checked by | | | | |
| Date | 12/04/2022 | | | |

TORQUE AND CURRENT VS SPEED CURVE

Three Phase Induction Motor - Squirrel Cage



Customer :

Product line : NEMA Premium Efficiency Three-Phase

Product code : 14276568

Catalog # : 00518XT3E184T

TORQUE AND CURRENT VS SPEED CURVE

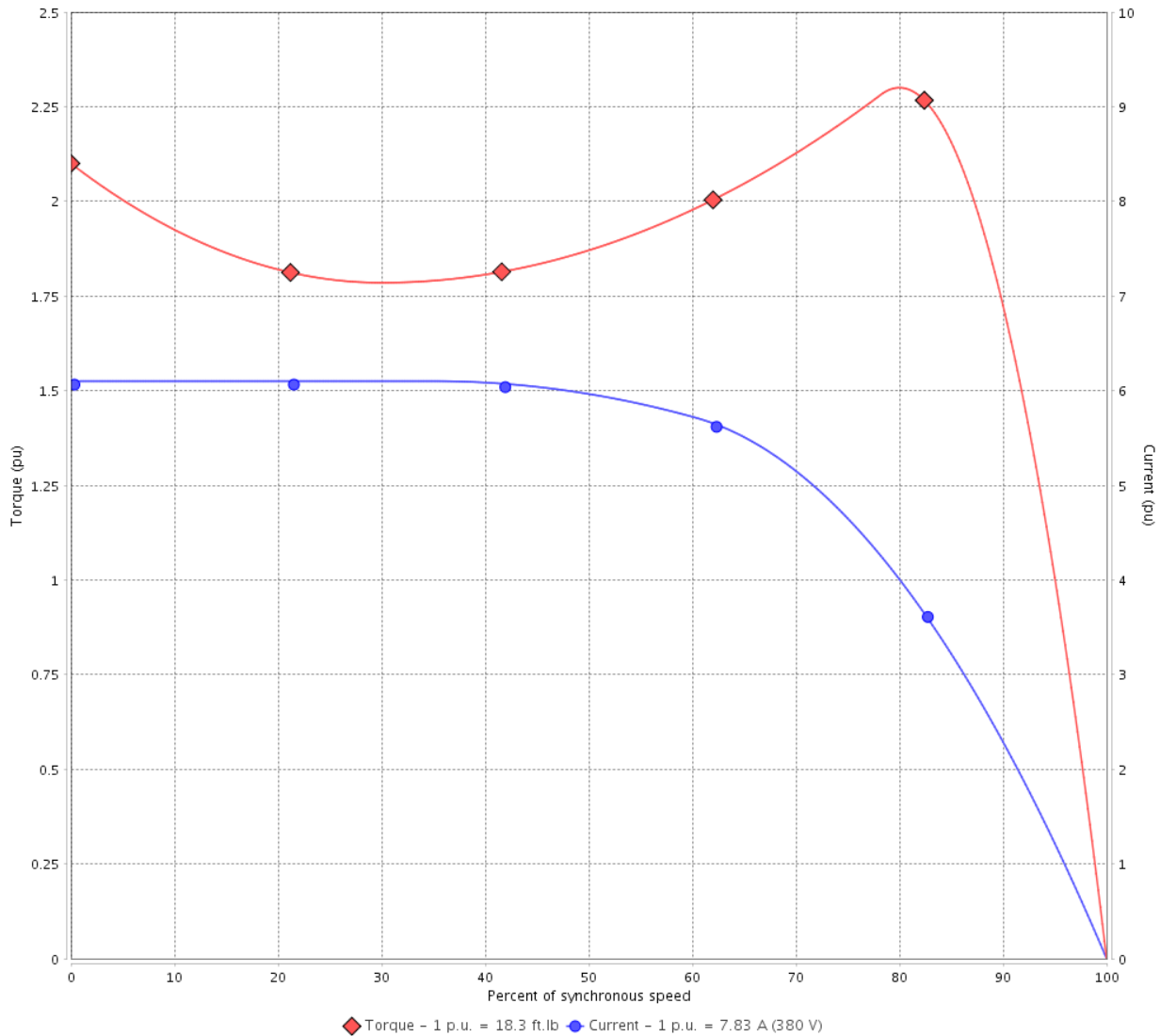

Performance : 380 V 50 Hz 4P IE2

| | | | |
|---------------------|--------------|-----------------------|-------------------|
| Rated current | : 7.83 A | Moment of inertia (J) | : 0.3695 sq.ft.lb |
| LRC | : 6.1 | Duty cycle | : Cont.(S1) |
| Rated torque | : 18.3 ft.lb | Insulation class | : F |
| Locked rotor torque | : 210 % | Service factor | : 1.00 |
| Breakdown torque | : 229 % | Temperature rise | : 80 K |
| Rated speed | : 1435 rpm | Design | : B |

Locked rotor time : 36s (cold) 20s (hot)

| Rev. | Changes Summary | Performed | Checked | Date |
|--------------|-----------------|-----------|----------------|----------|
| | | | | |
| Performed by | | | Page 4 / 22 | Revision |
| Checked by | | | | |
| Date | 12/04/2022 | | | |

TORQUE AND CURRENT VS SPEED CURVE



Three Phase Induction Motor - Squirrel Cage

Customer :

Product line : NEMA Premium Efficiency Three-Phase

Product code : 14276568

Catalog # : 00518XT3E184T

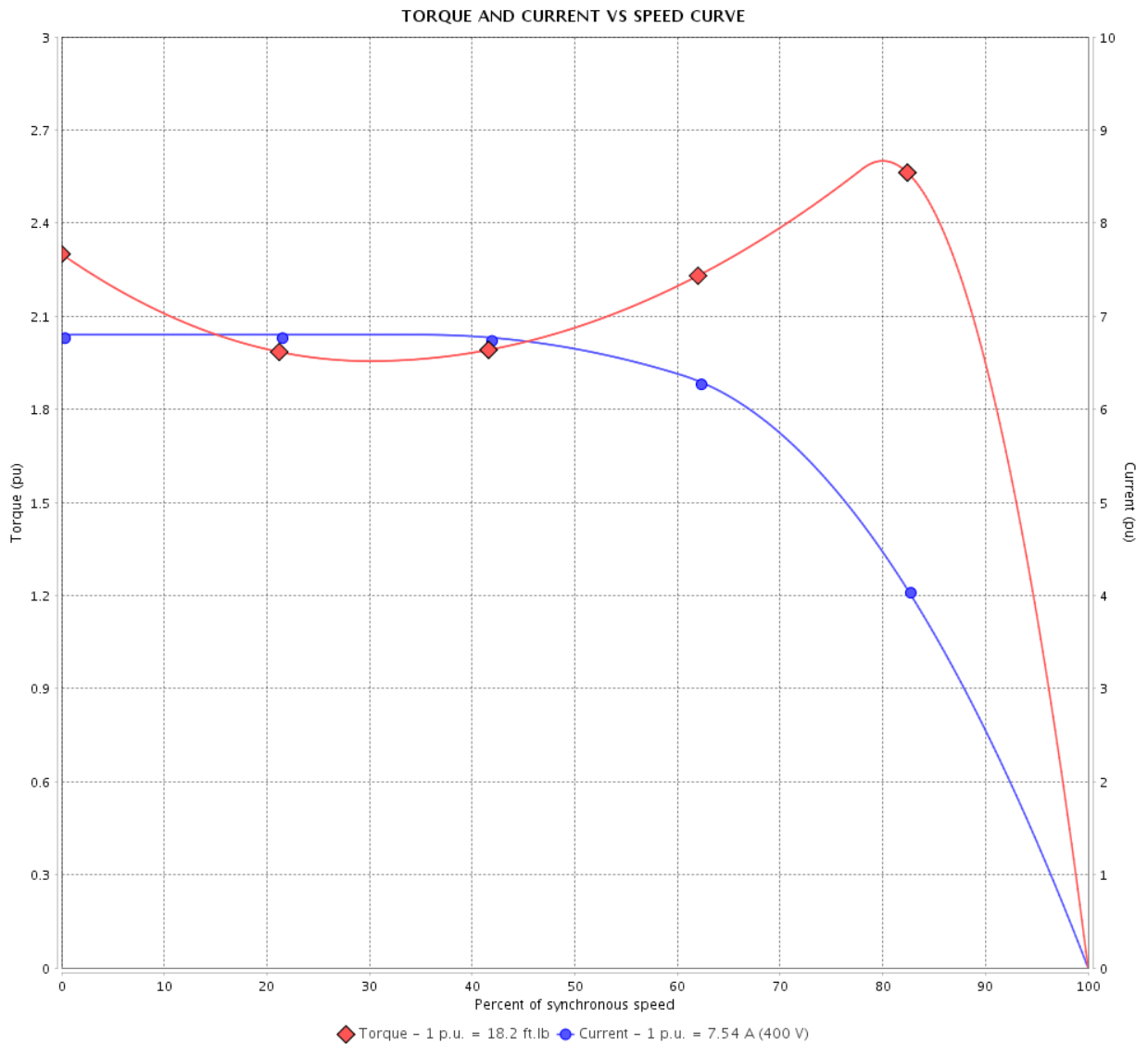

Performance : 400 V 50 Hz 4P IE2

Rated current : 7.54 A
 LRC : 6.8
 Rated torque : 18.2 ft.lb
 Locked rotor torque : 229 %
 Breakdown torque : 260 %
 Rated speed : 1440 rpm

Moment of inertia (J) : 0.3695 sq.ft.lb
 Duty cycle : Cont.(S1)
 Insulation class : F
 Service factor : 1.00
 Temperature rise : 80 K
 Design : B

Locked rotor time : 36s (cold) 20s (hot)

| Rev. | Changes Summary | Performed | Checked | Date |
|--------------|-----------------|-----------|----------------|----------|
| | | | | |
| Performed by | | | Page 5 / 22 | Revision |
| Checked by | | | | |
| Date | 12/04/2022 | | | |

TORQUE AND CURRENT VS SPEED CURVE

Three Phase Induction Motor - Squirrel Cage



Customer :

Product line : NEMA Premium Efficiency Three-Phase

Product code : 14276568

Catalog # : 00518XT3E184T

TORQUE AND CURRENT VS SPEED CURVE

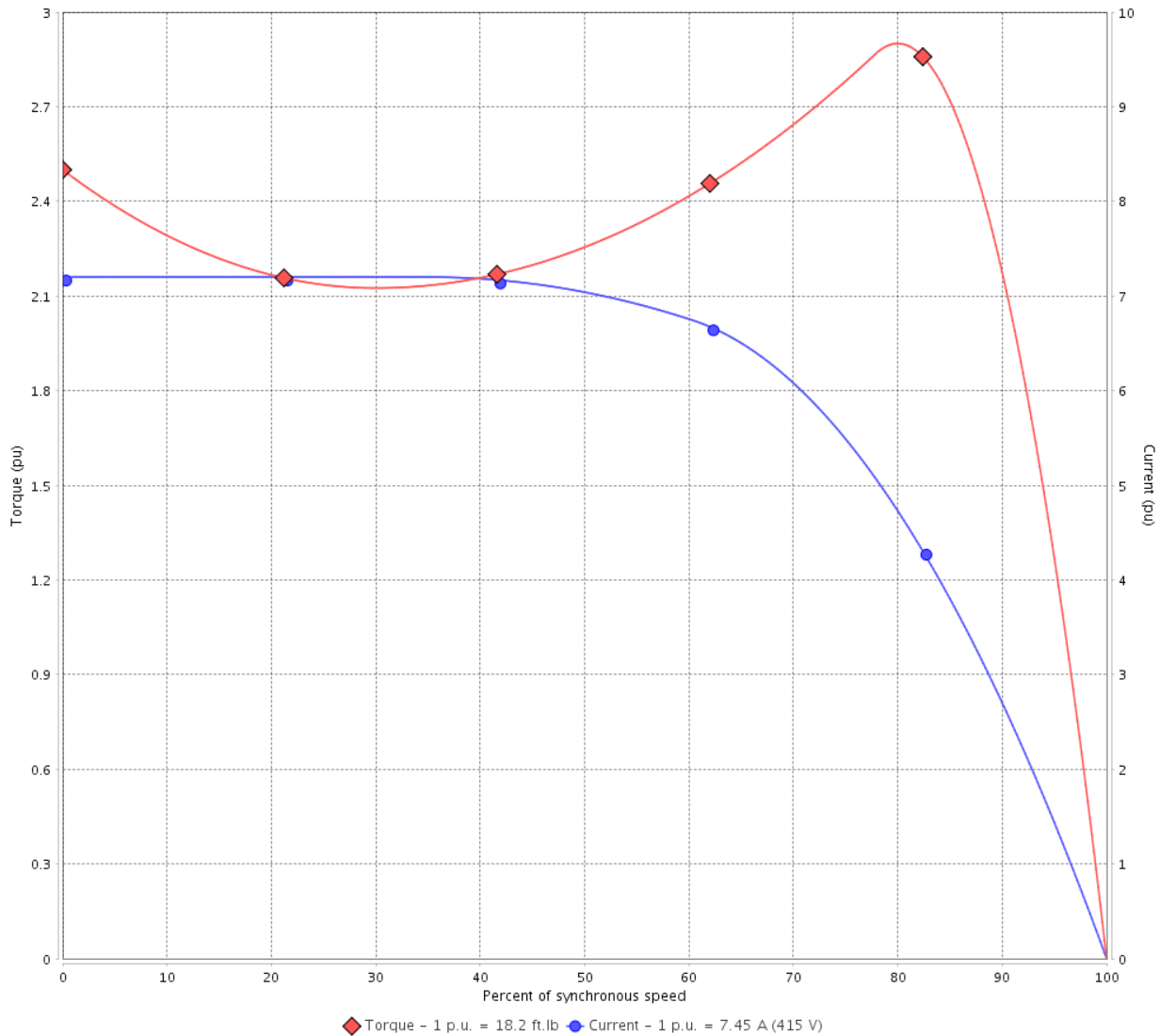

Performance : 415 V 50 Hz 4P IE2

| | | | |
|---------------------|--------------|-----------------------|-------------------|
| Rated current | : 7.45 A | Moment of inertia (J) | : 0.3695 sq.ft.lb |
| LRC | : 7.2 | Duty cycle | : Cont.(S1) |
| Rated torque | : 18.2 ft.lb | Insulation class | : F |
| Locked rotor torque | : 250 % | Service factor | : 1.00 |
| Breakdown torque | : 290 % | Temperature rise | : 80 K |
| Rated speed | : 1445 rpm | Design | : B |

Locked rotor time : 34s (cold) 19s (hot)

| Rev. | Changes Summary | Performed | Checked | Date |
|--------------|-----------------|-----------|----------------|----------|
| | | | | |
| Performed by | | | Page 6 / 22 | Revision |
| Checked by | | | | |
| Date | 12/04/2022 | | | |

LOAD PERFORMANCE CURVE

Three Phase Induction Motor - Squirrel Cage



Customer : _____

Product line : NEMA Premium Efficiency Three-Phase

Product code : 14276568

Catalog # : 00518XT3E184T

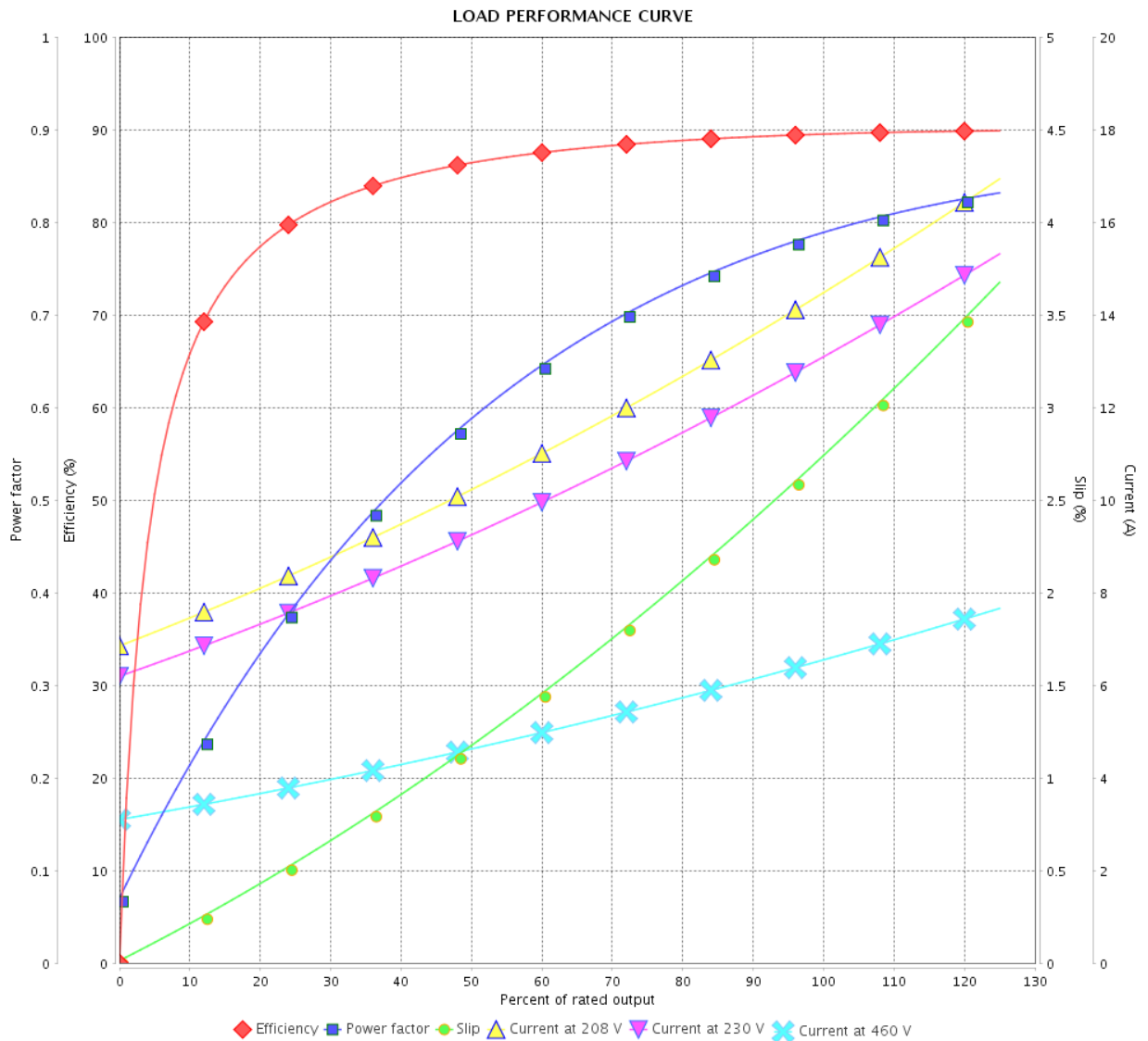

Performance : 230/460 V 60 Hz 4P

Rated current : 13.1/6.57 A
 LRC : 7.1
 Rated torque : 15.0 ft.lb
 Locked rotor torque : 229 %
 Breakdown torque : 300 %
 Rated speed : 1750 rpm

Moment of inertia (J) : 0.3695 sq.ft.lb
 Duty cycle : Cont.(S1)
 Insulation class : F
 Service factor : 1.15
 Temperature rise : 80 K
 Design : B

| Rev. | Changes Summary | Performed | Checked | Date |
|--------------|-----------------|-----------|---------|----------|
| | | | | |
| Performed by | | | Page | Revision |
| Checked by | | | | |
| Date | | | | |

LOAD PERFORMANCE CURVE

Three Phase Induction Motor - Squirrel Cage



Customer : _____

Product line : NEMA Premium Efficiency Three-Phase

Product code : 14276568

Catalog # : 00518XT3E184T

LOAD PERFORMANCE CURVE

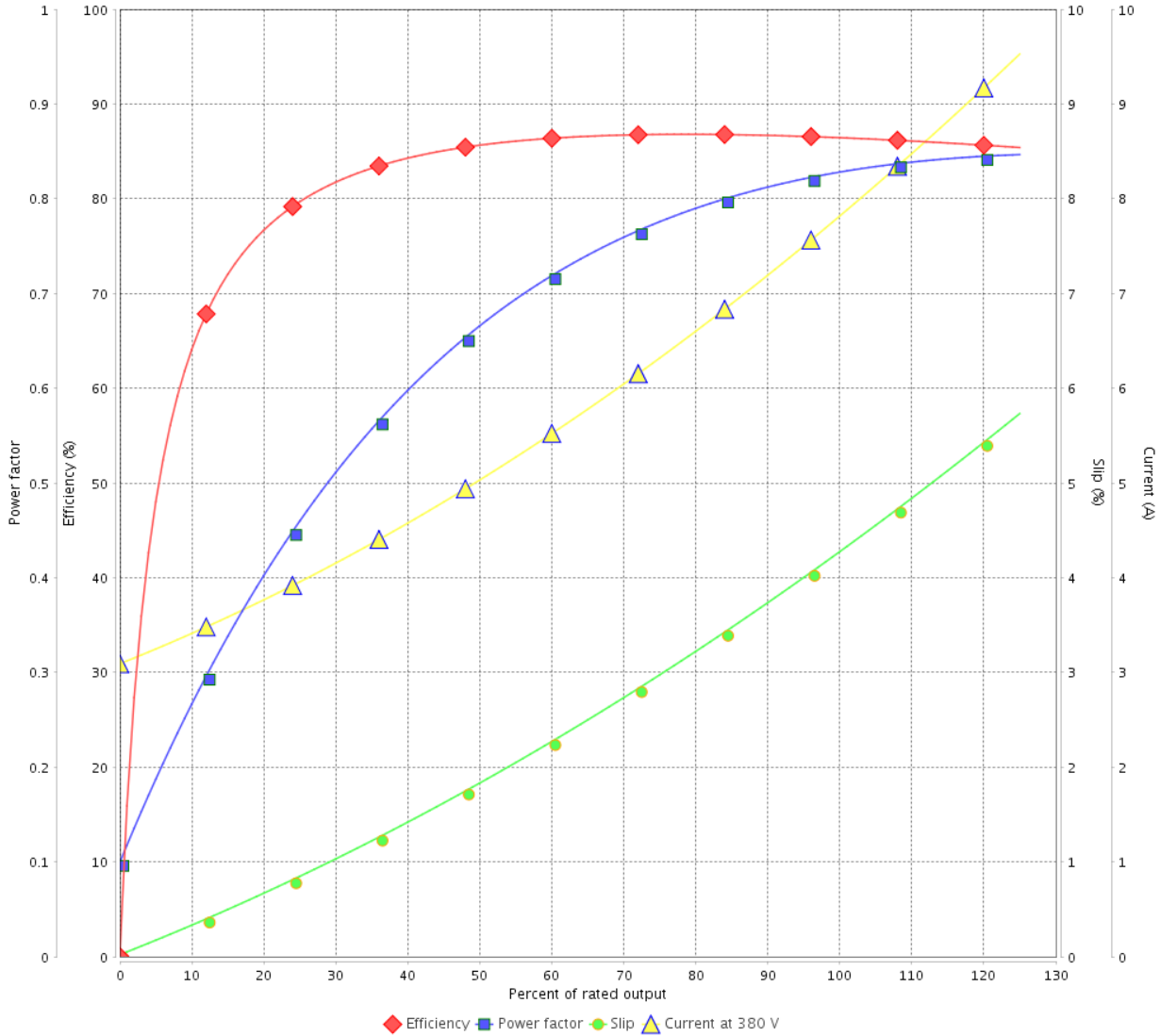

Performance : 380 V 50 Hz 4P IE2

Rated current : 7.83 A
 LRC : 6.1
 Rated torque : 18.3 ft.lb
 Locked rotor torque : 210 %
 Breakdown torque : 229 %
 Rated speed : 1435 rpm

Moment of inertia (J) : 0.3695 sq.ft.lb
 Duty cycle : Cont.(S1)
 Insulation class : F
 Service factor : 1.00
 Temperature rise : 80 K
 Design : B

| Rev. | Changes Summary | Performed | Checked | Date |
|--------------|-----------------|-----------|----------------|----------|
| | | | | |
| Performed by | | | Page 8 / 22 | Revision |
| Checked by | | | | |
| Date | 12/04/2022 | | | |

LOAD PERFORMANCE CURVE

Three Phase Induction Motor - Squirrel Cage



Customer : _____

Product line : NEMA Premium Efficiency Three-Phase

Product code : 14276568

Catalog # : 00518XT3E184T

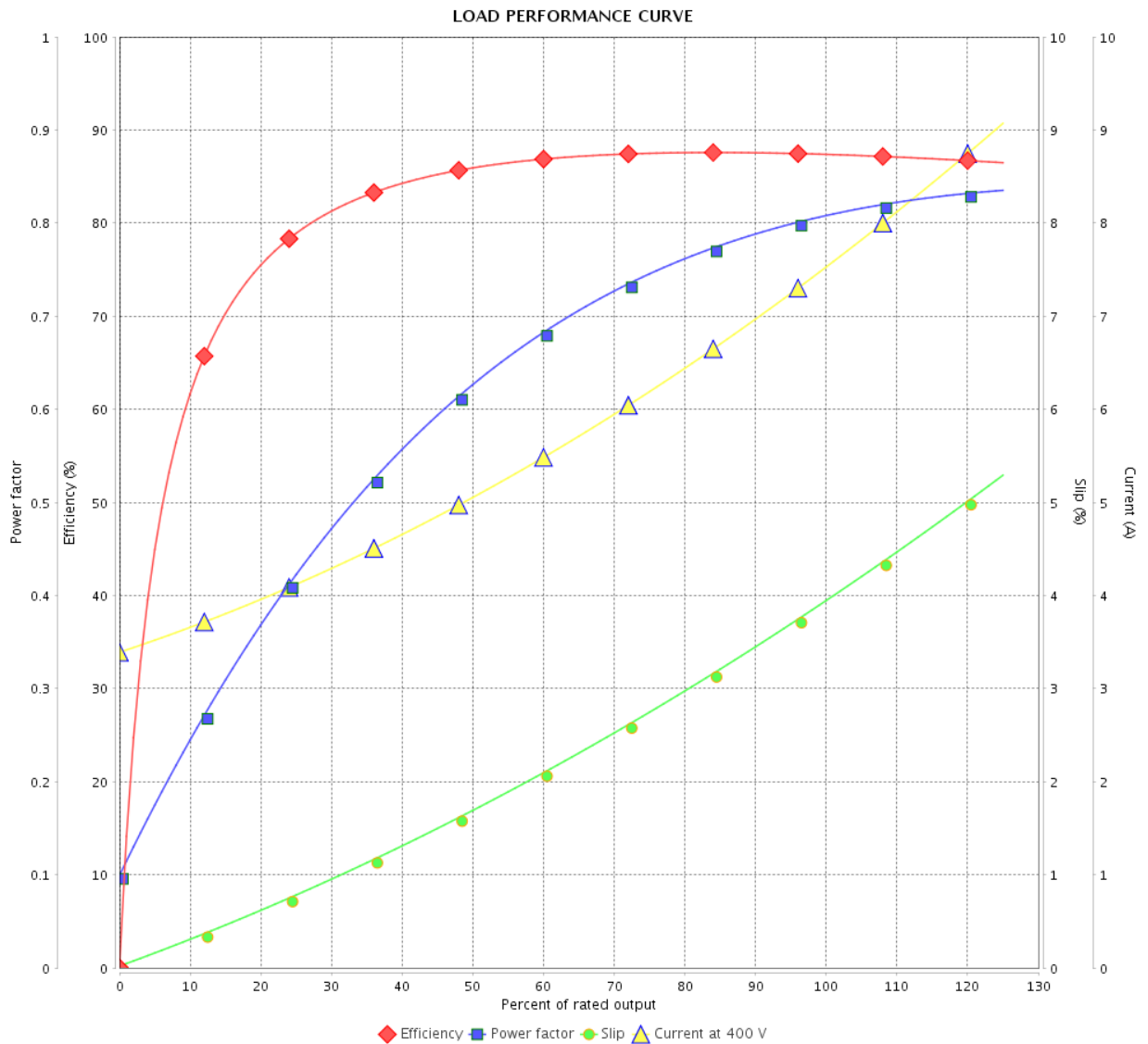

Performance : 400 V 50 Hz 4P IE2

Rated current : 7.54 A
 LRC : 6.8
 Rated torque : 18.2 ft.lb
 Locked rotor torque : 229 %
 Breakdown torque : 260 %
 Rated speed : 1440 rpm

Moment of inertia (J) : 0.3695 sq.ft.lb
 Duty cycle : Cont.(S1)
 Insulation class : F
 Service factor : 1.00
 Temperature rise : 80 K
 Design : B

| Rev. | Changes Summary | Performed | Checked | Date |
|--------------|-----------------|-----------|---------|----------|
| | | | | |
| Performed by | | Page | | Revision |
| Checked by | | 9 / 22 | | |
| Date | 12/04/2022 | | | |

LOAD PERFORMANCE CURVE

Three Phase Induction Motor - Squirrel Cage



Customer :

Product line : NEMA Premium Efficiency Three-Phase

Product code : 14276568

Catalog # : 00518XT3E184T

LOAD PERFORMANCE CURVE

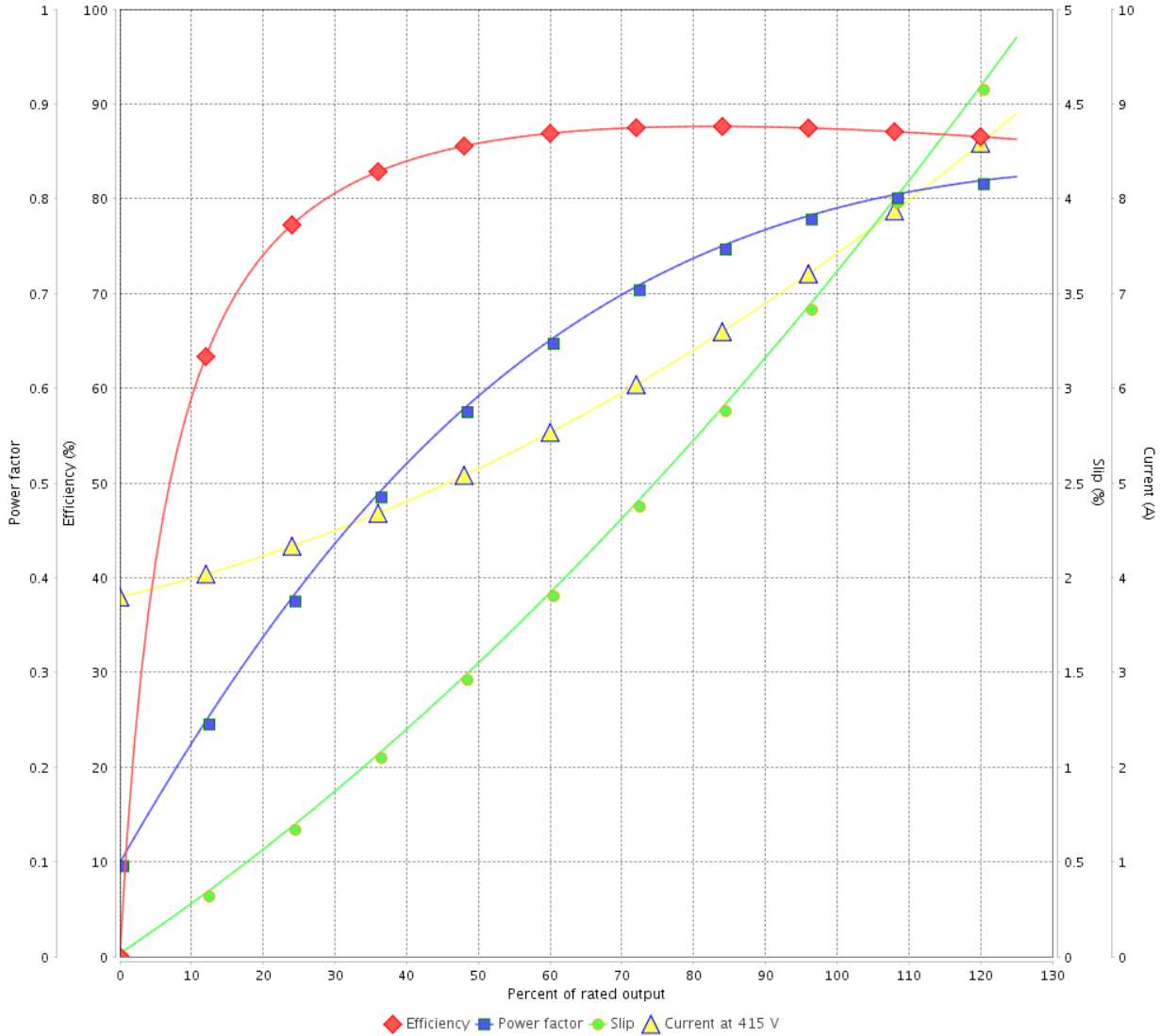

Performance : 415 V 50 Hz 4P IE2

Rated current : 7.45 A
 LRC : 7.2
 Rated torque : 18.2 ft.lb
 Locked rotor torque : 250 %
 Breakdown torque : 290 %
 Rated speed : 1445 rpm

Moment of inertia (J) : 0.3695 sq.ft.lb
 Duty cycle : Cont.(S1)
 Insulation class : F
 Service factor : 1.00
 Temperature rise : 80 K
 Design : B

| Rev. | Changes Summary | Performed | Checked | Date |
|--------------|-----------------|-----------|-----------------|----------|
| | | | | |
| Performed by | | | Page 10 / 22 | Revision |
| Checked by | | | | |
| Date | 12/04/2022 | | | |

THERMAL LIMIT CURVE



Three Phase Induction Motor - Squirrel Cage

Customer :

Product line : NEMA Premium Efficiency Three-Phase
 Product code : 14276568
 Catalog # : 00518XT3E184T

Performance : 230/460 V 60 Hz 4P

| | |
|-----------------------------|---|
| Rated current : 13.1/6.57 A | Moment of inertia (J) : 0.3695 sq.ft.lb |
| LRC : 7.1 | Duty cycle : Cont.(S1) |
| Rated torque : 15.0 ft.lb | Insulation class : F |
| Locked rotor torque : 229 % | Service factor : 1.15 |
| Breakdown torque : 300 % | Temperature rise : 80 K |
| Rated speed : 1750 rpm | Design : B |

Heating constant
 Cooling constant

| Rev. | Changes Summary | Performed | Checked | Date |
|--------------|-----------------|-----------|-----------------|----------|
| | | | | |
| Performed by | | | Page 11 / 22 | Revision |
| Checked by | | | | |
| Date | 12/04/2022 | | | |

THERMAL LIMIT CURVE

Three Phase Induction Motor - Squirrel Cage



Customer : _____

THERMAL LIMIT CURVE

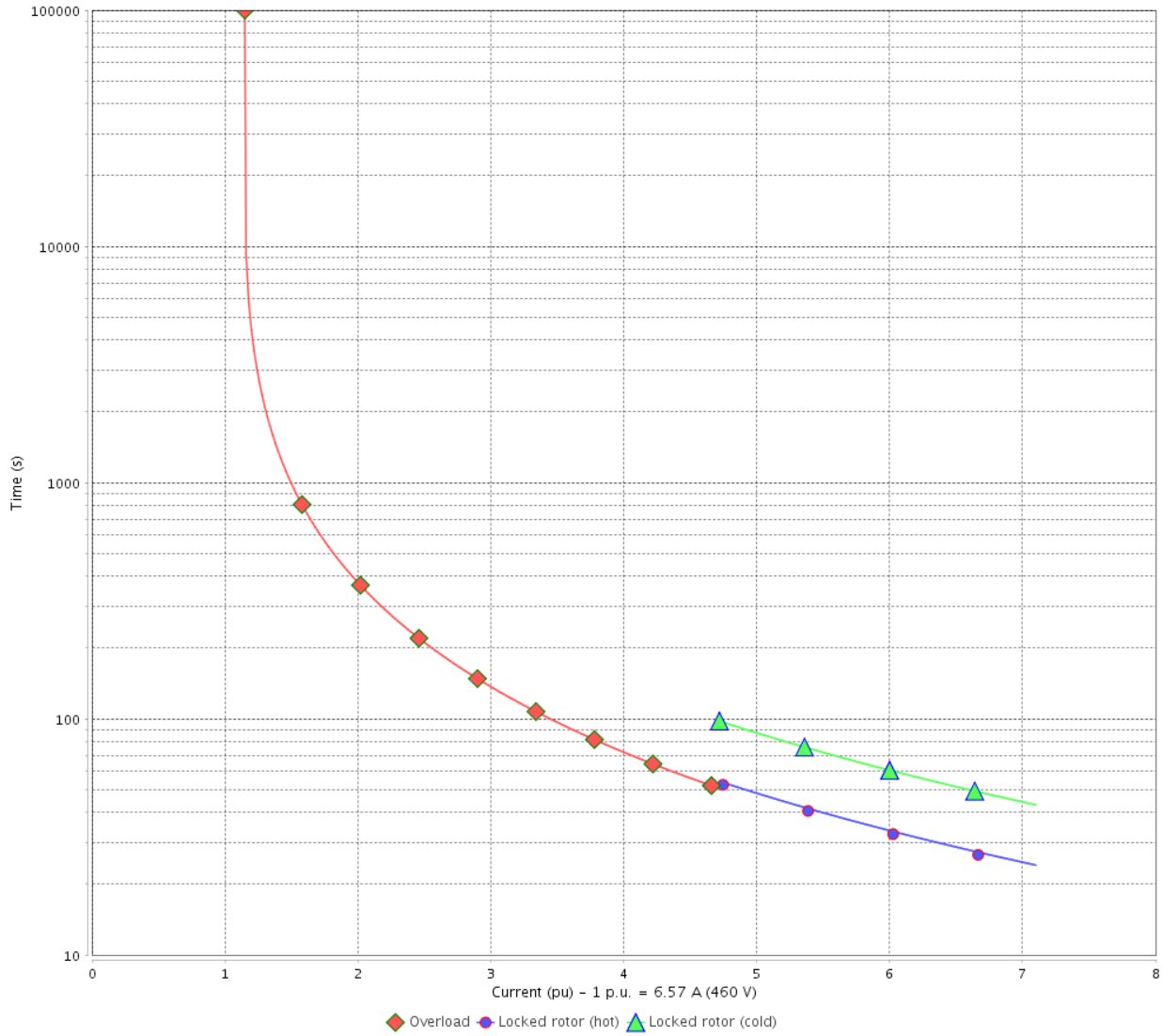

| Rev. | Changes Summary | Performed | Checked | Date |
|--------------|-----------------|-----------|-----------------|----------|
| | | | | |
| Performed by | | | Page 12 / 22 | Revision |
| Checked by | | | | |
| Date | 12/04/2022 | | | |

THERMAL LIMIT CURVE



Three Phase Induction Motor - Squirrel Cage

Customer :

Product line : NEMA Premium Efficiency Three-Phase
 Product code : 14276568
 Catalog # : 00518XT3E184T

Performance : 380 V 50 Hz 4P IE2

| | |
|-----------------------------|---|
| Rated current : 7.83 A | Moment of inertia (J) : 0.3695 sq.ft.lb |
| LRC : 6.1 | Duty cycle : Cont.(S1) |
| Rated torque : 18.3 ft.lb | Insulation class : F |
| Locked rotor torque : 210 % | Service factor : 1.00 |
| Breakdown torque : 229 % | Temperature rise : 80 K |
| Rated speed : 1435 rpm | Design : B |

Heating constant

Cooling constant

| Rev. | Changes Summary | Performed | Checked | Date |
|--------------|-----------------|-----------|-----------------|----------|
| | | | | |
| Performed by | | | Page 13 / 22 | Revision |
| Checked by | | | | |
| Date | 12/04/2022 | | | |

THERMAL LIMIT CURVE

Three Phase Induction Motor - Squirrel Cage



Customer : _____

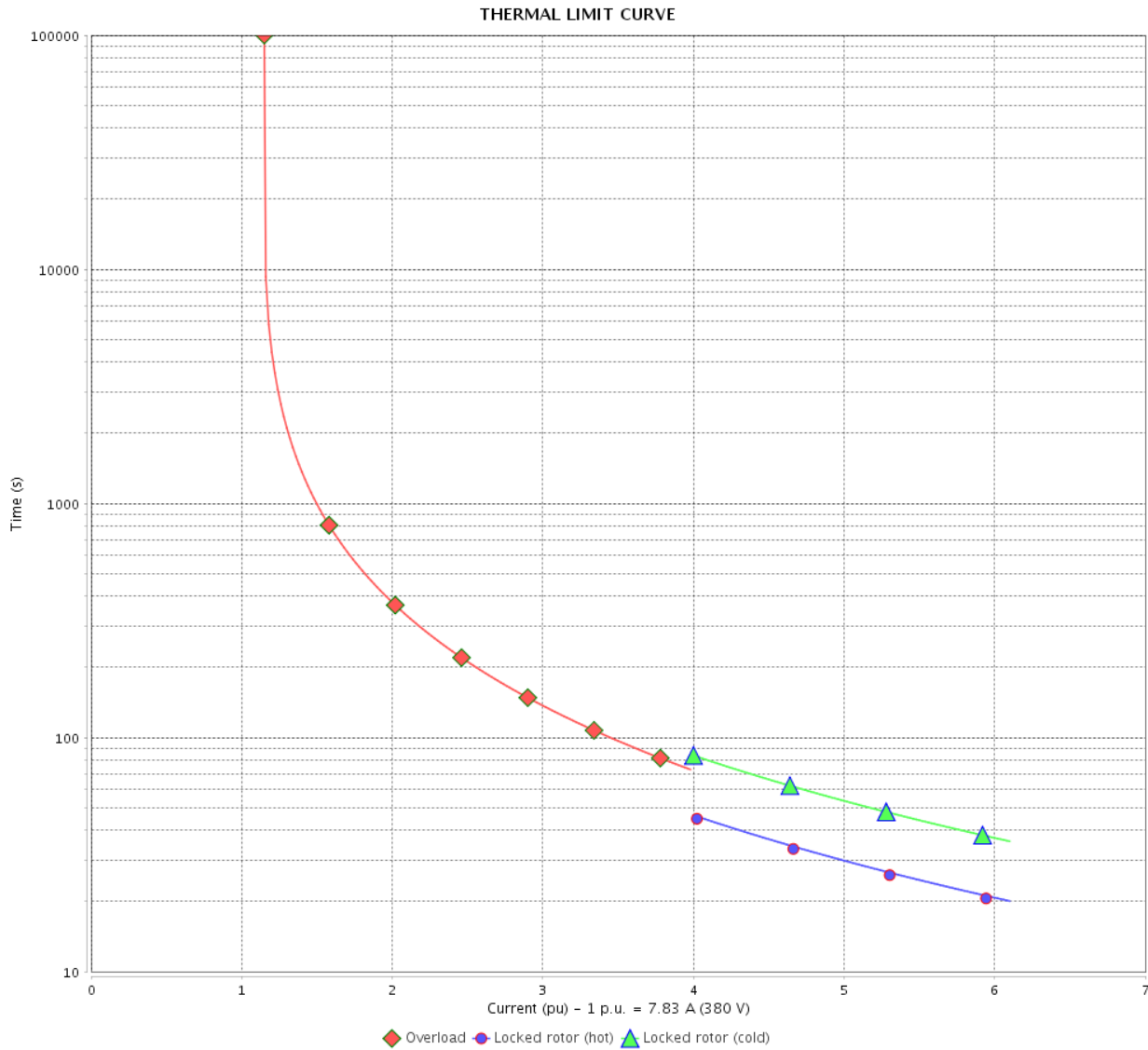

| Rev. | Changes Summary | Performed | Checked | Date |
|--------------|-----------------|------------|---------|----------|
| | | | | |
| Performed by | | Page | | Revision |
| Checked by | | 14 / 22 | | |
| Date | | 12/04/2022 | | |

THERMAL LIMIT CURVE



Three Phase Induction Motor - Squirrel Cage

Customer :

Product line : NEMA Premium Efficiency Three-Phase
 Product code : 14276568
 Catalog # : 00518XT3E184T

Performance : 400 V 50 Hz 4P IE2

| | |
|-----------------------------|---|
| Rated current : 7.54 A | Moment of inertia (J) : 0.3695 sq.ft.lb |
| LRC : 6.8 | Duty cycle : Cont.(S1) |
| Rated torque : 18.2 ft.lb | Insulation class : F |
| Locked rotor torque : 229 % | Service factor : 1.00 |
| Breakdown torque : 260 % | Temperature rise : 80 K |
| Rated speed : 1440 rpm | Design : B |

Heating constant

Cooling constant

| Rev. | Changes Summary | Performed | Checked | Date |
|--------------|-----------------|-----------|---------|----------|
| | | | | |
| Performed by | | | Page | Revision |
| Checked by | | | | |
| Date | 12/04/2022 | 15 / 22 | | |

THERMAL LIMIT CURVE

Three Phase Induction Motor - Squirrel Cage

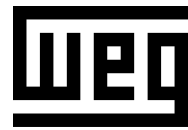

Customer : _____

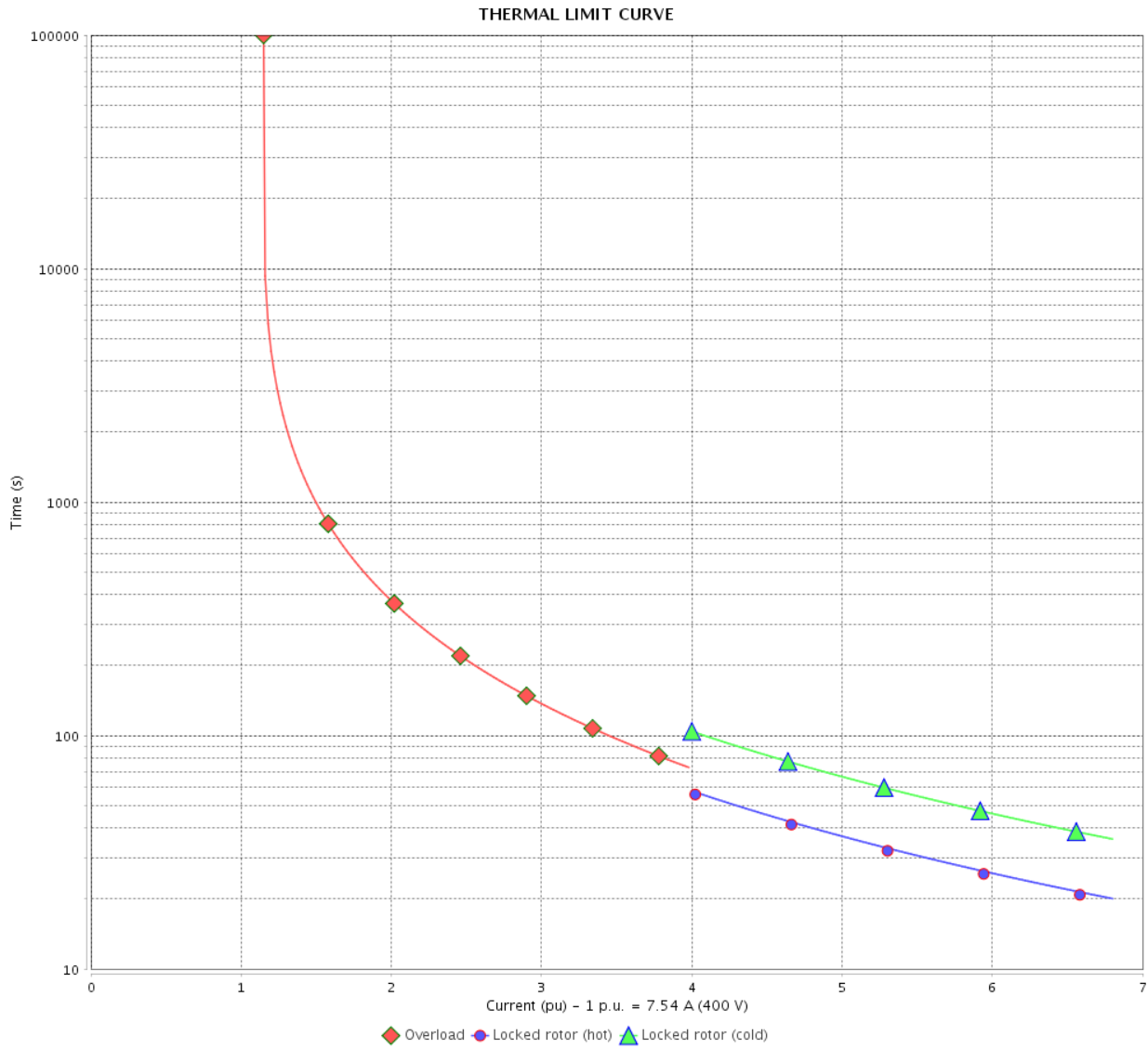

| Rev. | Changes Summary | Performed | Checked | Date |
|--------------|-----------------|------------|---------|----------|
| | | | | |
| Performed by | | Page | | Revision |
| Checked by | | 16 / 22 | | |
| Date | | 12/04/2022 | | |

THERMAL LIMIT CURVE



Three Phase Induction Motor - Squirrel Cage

Customer :

Product line : NEMA Premium Efficiency Three-Phase
 Product code : 14276568
 Catalog # : 00518XT3E184T

Performance : 415 V 50 Hz 4P IE2

| | |
|-----------------------------|---|
| Rated current : 7.45 A | Moment of inertia (J) : 0.3695 sq.ft.lb |
| LRC : 7.2 | Duty cycle : Cont.(S1) |
| Rated torque : 18.2 ft.lb | Insulation class : F |
| Locked rotor torque : 250 % | Service factor : 1.00 |
| Breakdown torque : 290 % | Temperature rise : 80 K |
| Rated speed : 1445 rpm | Design : B |

Heating constant

Cooling constant

| Rev. | Changes Summary | Performed | Checked | Date |
|--------------|-----------------|-----------|-----------------|----------|
| | | | | |
| Performed by | | | Page 17 / 22 | Revision |
| Checked by | | | | |
| Date | 12/04/2022 | | | |

THERMAL LIMIT CURVE

Three Phase Induction Motor - Squirrel Cage



Customer : _____

THERMAL LIMIT CURVE

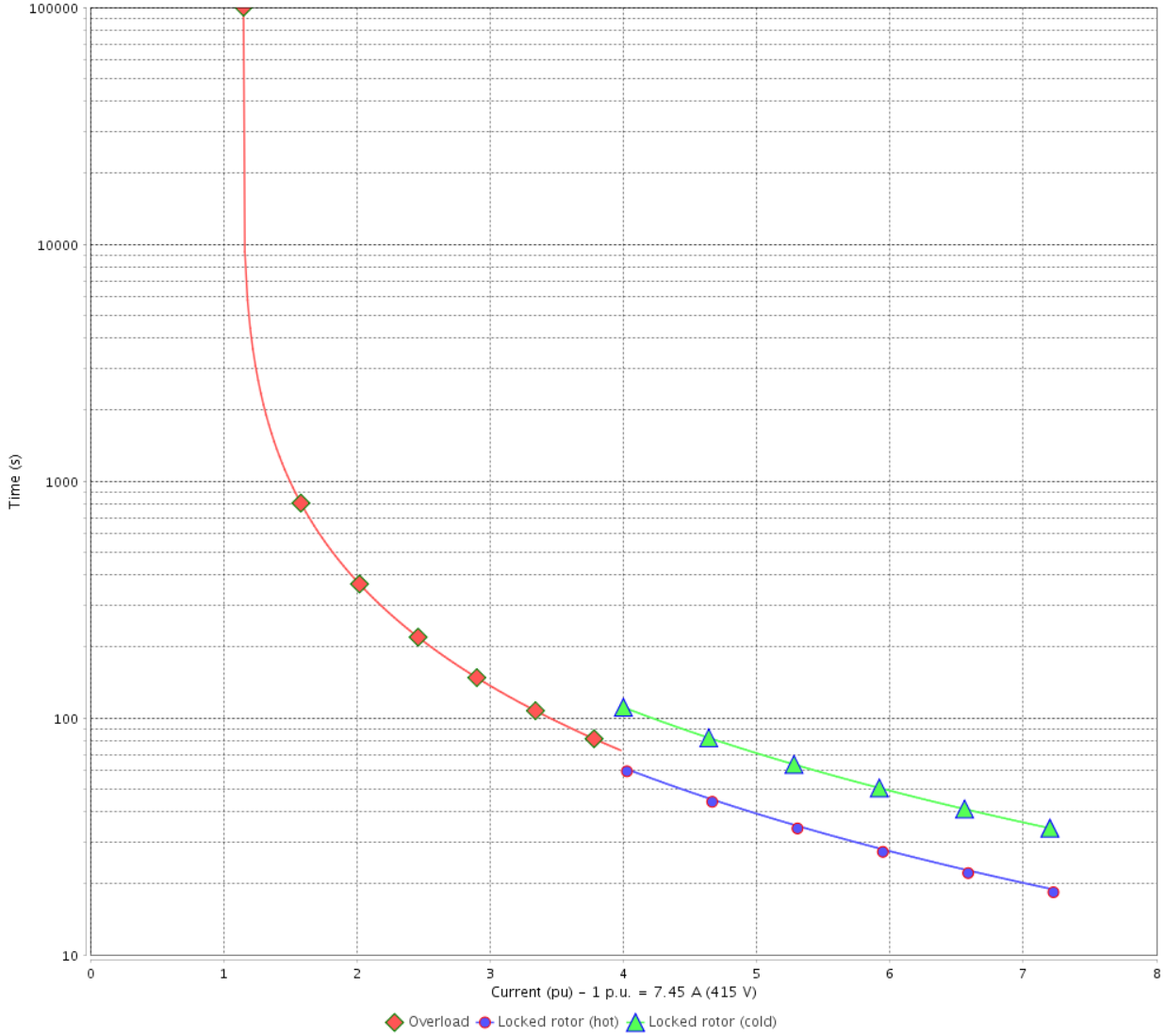

| Rev. | Changes Summary | Performed | Checked | Date |
|--------------|-----------------|-----------|---------|----------|
| | | | | |
| Performed by | | | Page | Revision |
| Checked by | | | | |
| Date | | | | |

VFD OPERATION CURVE

Three Phase Induction Motor - Squirrel Cage



Customer :

Product line : NEMA Premium Efficiency Three-Phase

Product code : 14276568

Catalog # : 00518XT3E184T

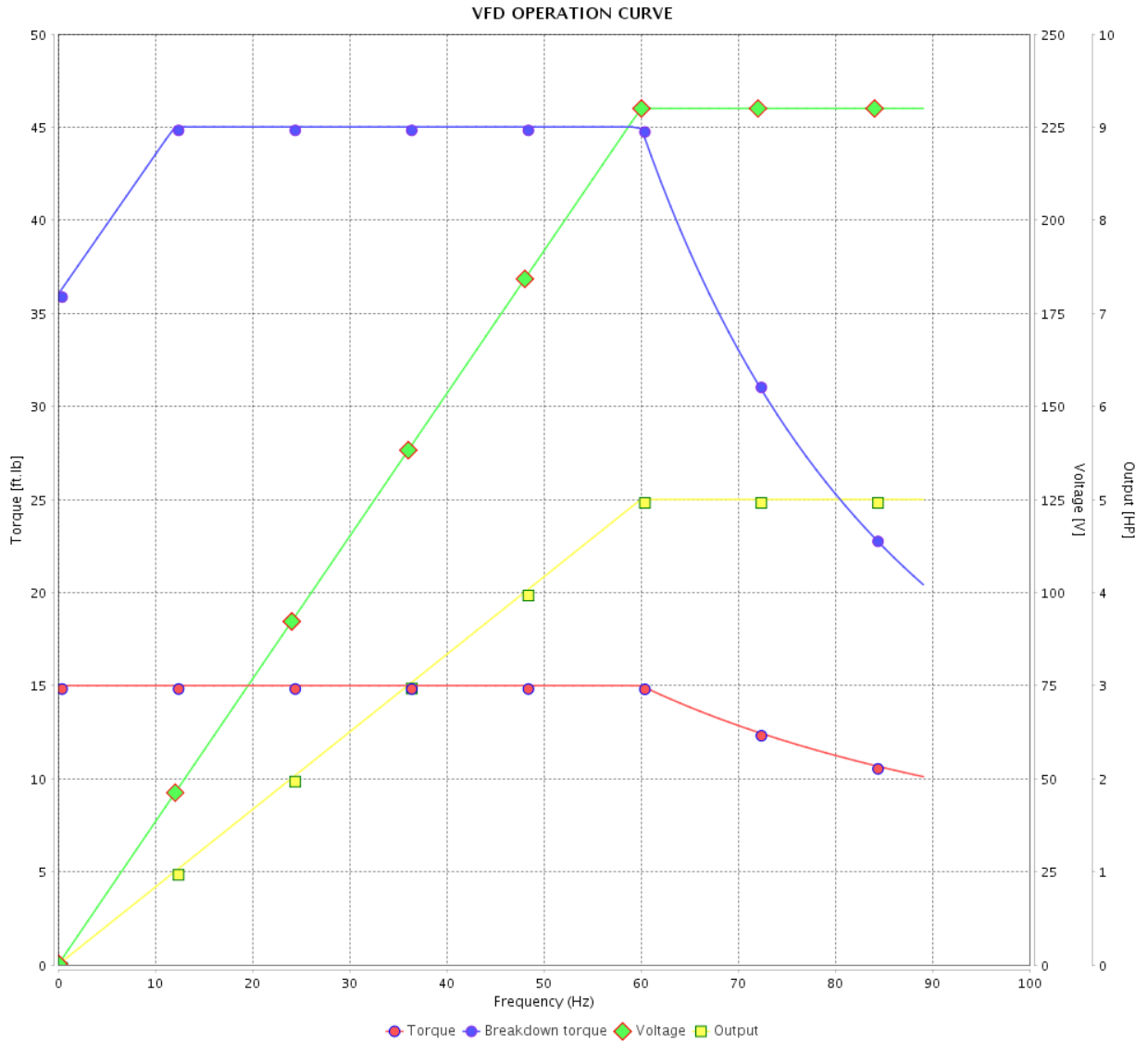

Performance : 230/460 V 60 Hz 4P

Rated current : 13.1/6.57 A
 LRC : 7.1
 Rated torque : 15.0 ft.lb
 Locked rotor torque : 229 %
 Breakdown torque : 300 %
 Rated speed : 1750 rpm

Moment of inertia (J) : 0.3695 sq.ft.lb
 Duty cycle : Cont.(S1)
 Insulation class : F
 Service factor : 1.15
 Temperature rise : 80 K
 Design : B

| Rev. | Changes Summary | Performed | Checked | Date |
|--------------|-----------------|-----------|---------|-----------------|
| | | | | |
| Performed by | | | | Page 19 / 22 |
| Checked by | | | | |
| Date | 12/04/2022 | | | |

VFD OPERATION CURVE

Three Phase Induction Motor - Squirrel Cage



Customer : _____

Product line : NEMA Premium Efficiency Three-Phase

Product code : 14276568

Catalog # : 00518XT3E184T

VFD OPERATION CURVE

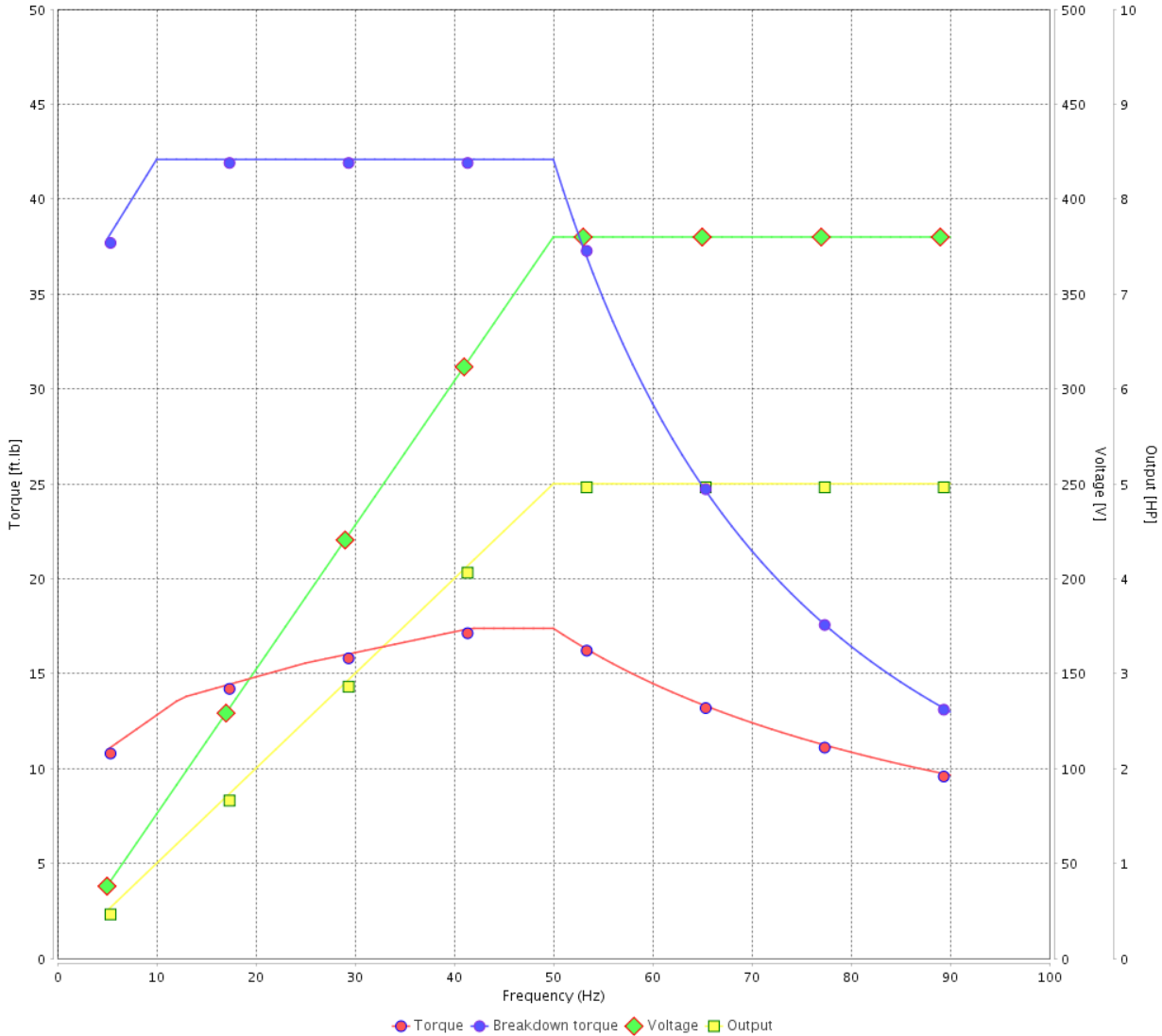

Performance : 380 V 50 Hz 4P IE2

Rated current : 7.83 A
 LRC : 6.1
 Rated torque : 18.3 ft.lb
 Locked rotor torque : 210 %
 Breakdown torque : 229 %
 Rated speed : 1435 rpm

Moment of inertia (J) : 0.3695 sq.ft.lb
 Duty cycle : Cont.(S1)
 Insulation class : F
 Service factor : 1.00
 Temperature rise : 80 K
 Design : B

| Rev. | Changes Summary | Performed | Checked | Date |
|--------------|-----------------|-----------|-----------------|----------|
| | | | | |
| Performed by | | | Page 20 / 22 | Revision |
| Checked by | | | | |
| Date | 12/04/2022 | | | |

VFD OPERATION CURVE

Three Phase Induction Motor - Squirrel Cage



Customer : _____

Product line : NEMA Premium Efficiency Three-Phase

Product code : 14276568

Catalog # : 00518XT3E184T

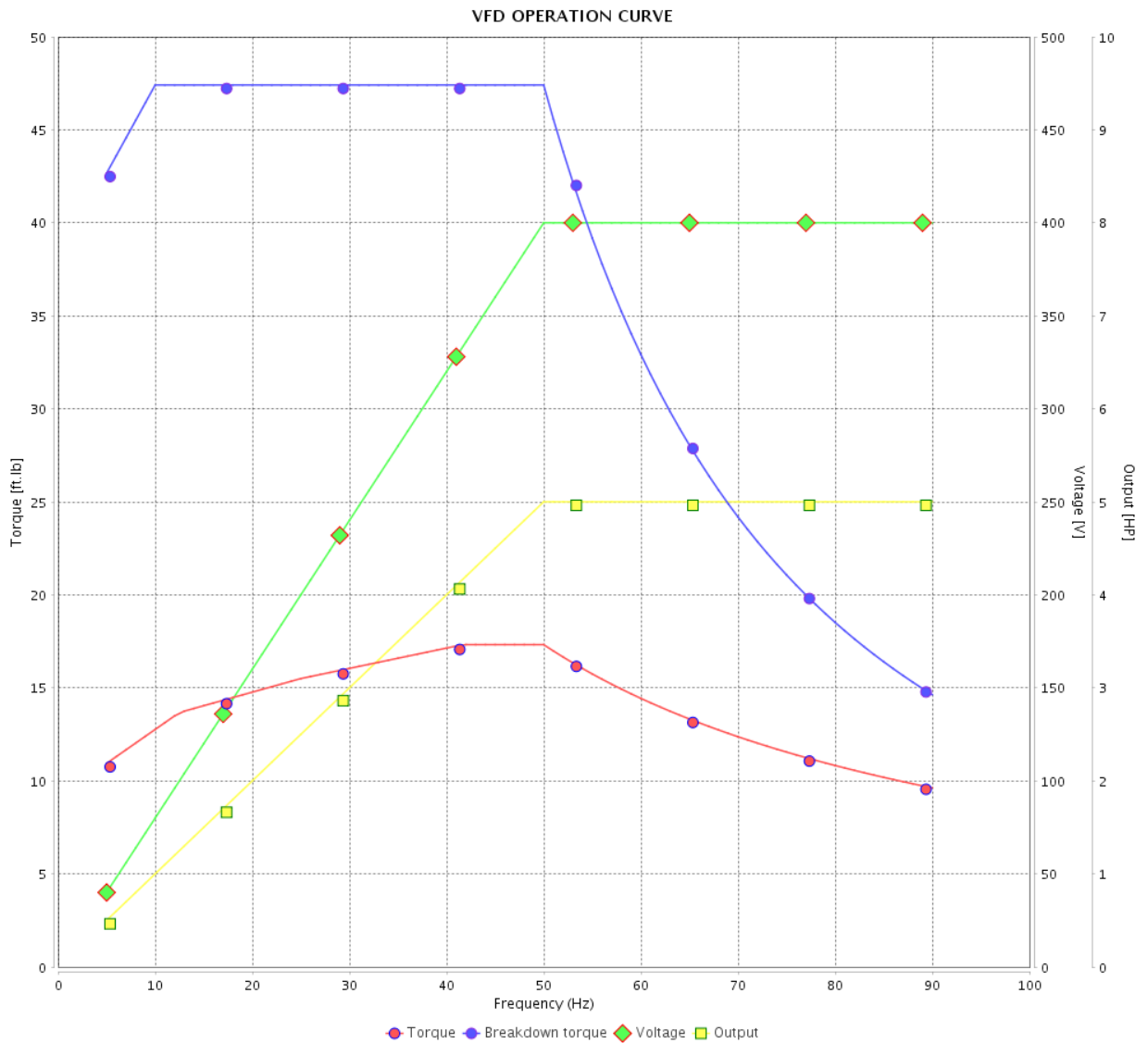

Performance : 400 V 50 Hz 4P IE2

Rated current : 7.54 A
 LRC : 6.8
 Rated torque : 18.2 ft.lb
 Locked rotor torque : 229 %
 Breakdown torque : 260 %
 Rated speed : 1440 rpm

Moment of inertia (J) : 0.3695 sq.ft.lb
 Duty cycle : Cont.(S1)
 Insulation class : F
 Service factor : 1.00
 Temperature rise : 80 K
 Design : B

| Rev. | Changes Summary | Performed | Checked | Date |
|--------------|-----------------|-----------|-----------------|----------|
| | | | | |
| Performed by | | | Page 21 / 22 | Revision |
| Checked by | | | | |
| Date | 12/04/2022 | | | |

VFD OPERATION CURVE

Three Phase Induction Motor - Squirrel Cage



Customer :

Product line : NEMA Premium Efficiency Three-Phase

Product code : 14276568

Catalog # : 00518XT3E184T

VFD OPERATION CURVE

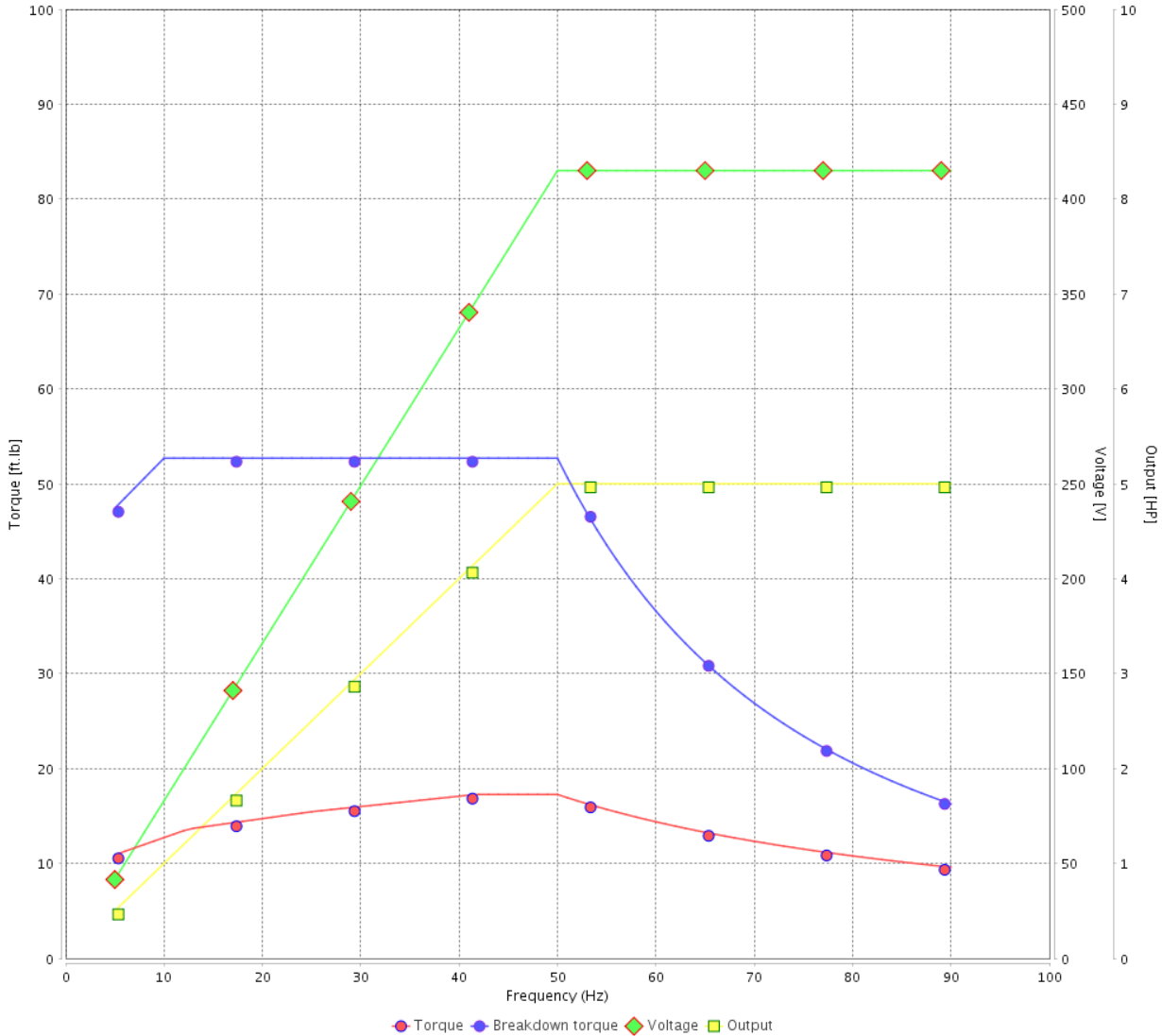

Performance : 415 V 50 Hz 4P IE2

Rated current : 7.45 A
 LRC : 7.2
 Rated torque : 18.2 ft.lb
 Locked rotor torque : 250 %
 Breakdown torque : 290 %
 Rated speed : 1445 rpm

Moment of inertia (J) : 0.3695 sq.ft.lb
 Duty cycle : Cont.(S1)
 Insulation class : F
 Service factor : 1.00
 Temperature rise : 80 K
 Design : B

| Rev. | Changes Summary | Performed | Checked | Date |
|--------------|-----------------|-----------|-----------------|----------|
| | | | | |
| Performed by | | | Page 22 / 22 | Revision |
| Checked by | | | | |
| Date | 12/04/2022 | | | |

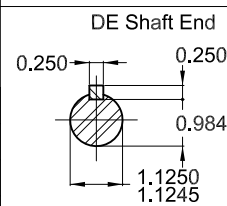
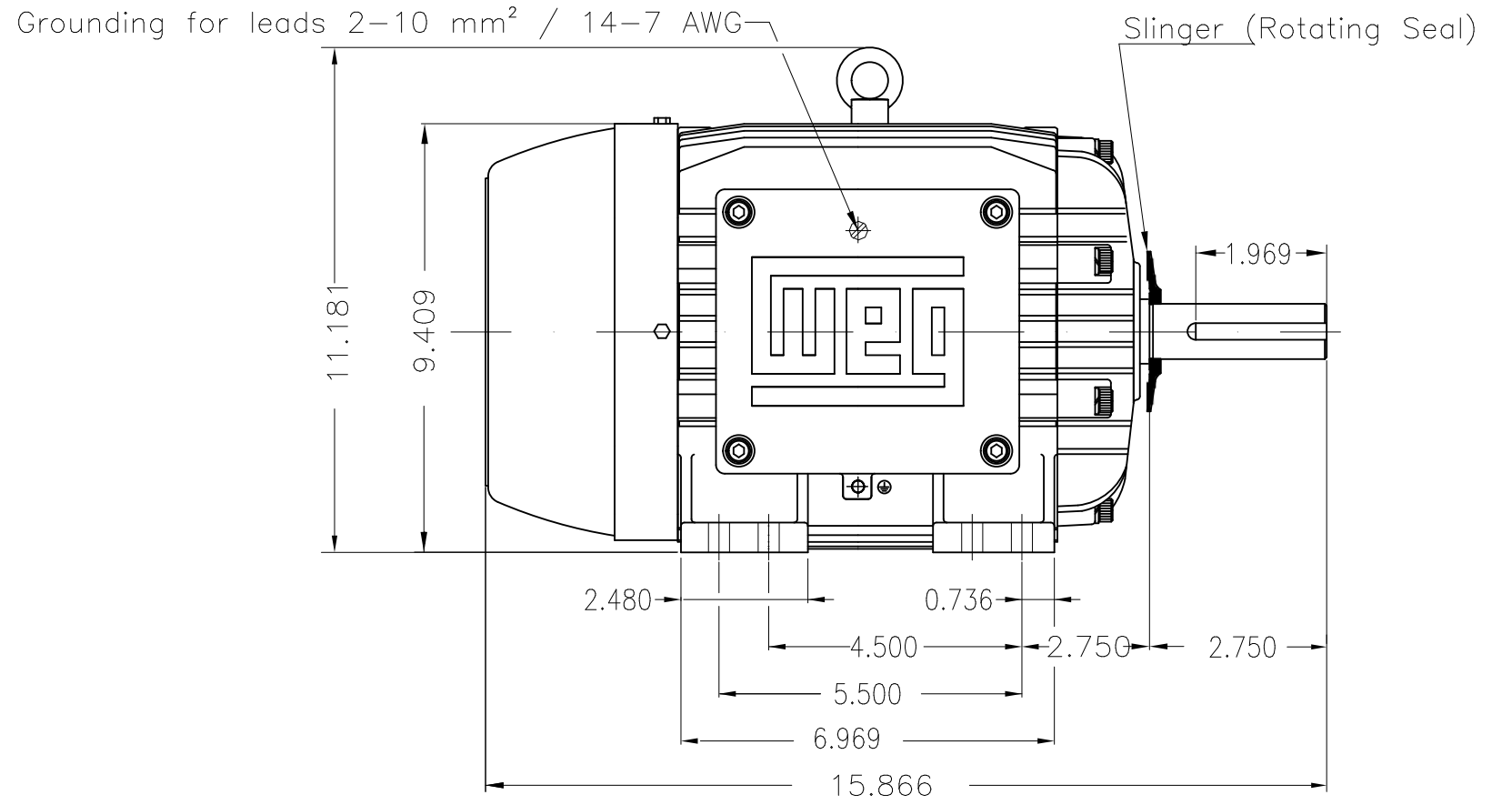
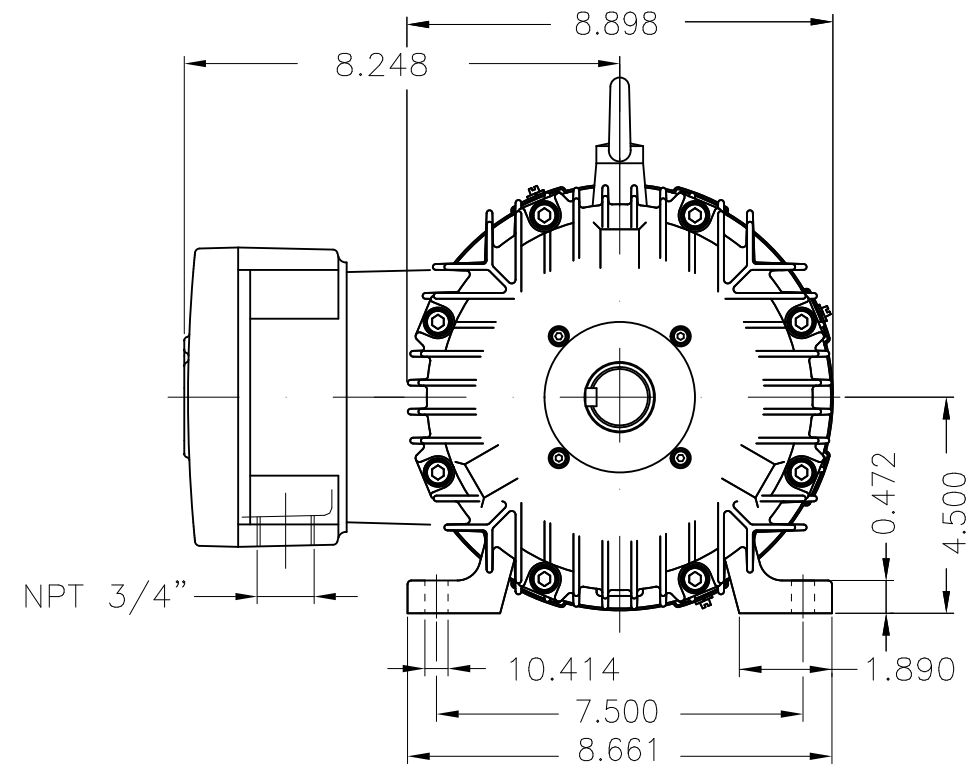

Color RAL 5009
 Painting plan 202P
 Mounting NEMA F-1
 Mounting B3R(D)

5 HP 04 Poles 60 Hz

Dimensions in inches

| ECM | LOC | SUMMARY OF MODIFICATIONS | EXECUTED | CHECKED | RELEASED | DATE | VER |
|----------|-----------|--|---------------------|---------|----------|------|-----|
| EXECUTED | PIRWBUSER | THREE PH. MOTOR EXPLOSION PROOF PREM. EFF. | | | | | |
| CHECKED | | FRAME 182/4T IP55 TEFC | | | | | |
| RELEASED | | | | | | | |
| REL DT. | WMO | Jaragua do Sul | Product Engineering | | | | |

PREVIEW
 WDD



SHEET 1 / 1

MADE IN BRAZIL

**W21X NEMA**
Premium

14276568

CC029A

Inverter Duty Motor
Severe Duty

LISTED

MODEL 00518XT3E184T

| | | | |
|--|--------------|--------------------|-------------------|
| PH 3 | FR 182/4T | | |
| HP(kW) 5.0(3.7) | | HZ 60 | IP55 |
| V 230/460 | | A 13.1/6.57 | |
| RPM 1750 | | NEMA NOM EFF 89.5% | |
| PF 0.79 | | SFA 15.1/7.56 | DES B |
| INS CL F Δ T 80 K | | SF 1.15 | ENCL TEFC |
| DUTY CONT. | | CODE J | ALT 1000 m.a.s.l. |
| AMB 40°C | USABLE @208V | 14.5 A | SF 1.15 SFA 16.7 |
| AMB 55°C SF1.0 | | | |
| 5.0HP 3.7kW 50Hz 380V 7.83A 1435RPM SF1.00 EFF 86.5% (IE2) | | | |

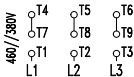
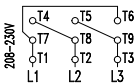

→ 6307-2RS MOBIL POLYREX EM
→ 6206-2RS

132 Lbs



TEMP CODE T3C
CSA/UL: Class I - Div. 1 - Groups C and D
CSA: Class II - Div. 1 - Groups F and G
CSA: Class I - Zone 1 - IIB

EXPLOSION PROOF MOTOR

FOR USE ON VPWM VFD 1000:1VT, 20:1CT, 1.0SF, T3C, AMB 40°C.