

# DATA SHEET

## Three Phase Induction Motor - Squirrel Cage



Customer :				
Product line	: NEMA Premium Efficiency Three-Phase	Product code :	12445969	
		Catalog # :	00718ET3E213TC-W22	
Frame	: 213/5TC	Cooling method	: IC411 - TEFC	
Insulation class	: F	Mounting	: F-1	
Duty cycle	: Cont.(S1)	Rotation <sup>1</sup>	: Both (CW and CCW)	
Ambient temperature	: -20°C to +40°C	Starting method	: Direct On Line	
Altitude	: 1000 m.a.s.l.	Approx. weight <sup>2</sup>	: 169 lb	
Protection degree	: IP55	Moment of inertia (J)	: 1.34 sq.ft.lb	
Design	: B			
Output [HP]	7.5	7.5	7.5	7.5
Poles	4	4	4	4
Frequency [Hz]	60	50	50	50
Rated voltage [V]	230/460	380	400	415
Rated current [A]	18.4/9.18	11.0	10.5	10.3
L. R. Amperes [A]	130/65.2	61.6	65.1	69.0
LRC [A]	7.1x(Code H)	5.6x(Code F)	6.2x(Code G)	6.7x(Code H)
No load current [A]	8.80/4.40	4.00	4.30	4.55
Rated speed [RPM]	1765	1455	1460	1460
Slip [%]	1.94	3.00	2.67	2.67
Rated torque [ft.lb]	22.3	27.1	27.0	27.0
Locked rotor torque [%]	220	170	190	210
Breakdown torque [%]	310	240	270	290
Service factor	1.25	1.25	1.25	1.25
Temperature rise	80 K	80 K	80 K	80 K
Locked rotor time	36s (cold) 20s (hot)	27s (cold) 15s (hot)	27s (cold) 15s (hot)	27s (cold) 15s (hot)
Noise level <sup>2</sup>	58.0 dB(A)	56.0 dB(A)	56.0 dB(A)	56.0 dB(A)
Efficiency (%)	25%	88.6	89.2	89.2
	50%	89.5	89.5	89.5
	75%	91.0	89.5	90.2
	100%	91.7	89.6	90.2
Power Factor	25%	0.40	0.47	0.43
	50%	0.66	0.72	0.69
	75%	0.76	0.81	0.78
	100%	0.82	0.85	0.84
Bearing type	: <u>Drive end</u> 6308 ZZ <u>Non drive end</u> 6207 ZZ	Foundation loads		
Sealing	: V'Ring V'Ring	Max. traction	: 357 lb	
Lubrication interval	: - -	Max. compression	: 526 lb	
Lubricant amount	: - -			
Lubricant type	: Mobil Polyrex EM			
Notes USABLE @208V 19.9A SF 1.15 SFA 22.9A				
This revision replaces and cancel the previous one, which must be eliminated. (1) Looking the motor from the shaft end. (2) Measured at 1m and with tolerance of +3dB(A). (3) Approximate weight subject to changes after manufacturing process. (4) At 100% of full load.		These are average values based on tests with sinusoidal power supply, subject to the tolerances stipulated in NEMA MG-1.		
Rev.	Changes Summary	Performed	Checked	Date
Performed by				
Checked by			Page	Revision
Date	13/04/2022		1 / 21	

# TORQUE AND CURRENT VS SPEED CURVE

## Three Phase Induction Motor - Squirrel Cage



Customer :

Product line : NEMA Premium Efficiency Three-Phase

Product code : 12445969

Catalog # : 00718ET3E213TC-W22

TORQUE AND CURRENT VS SPEED CURVE

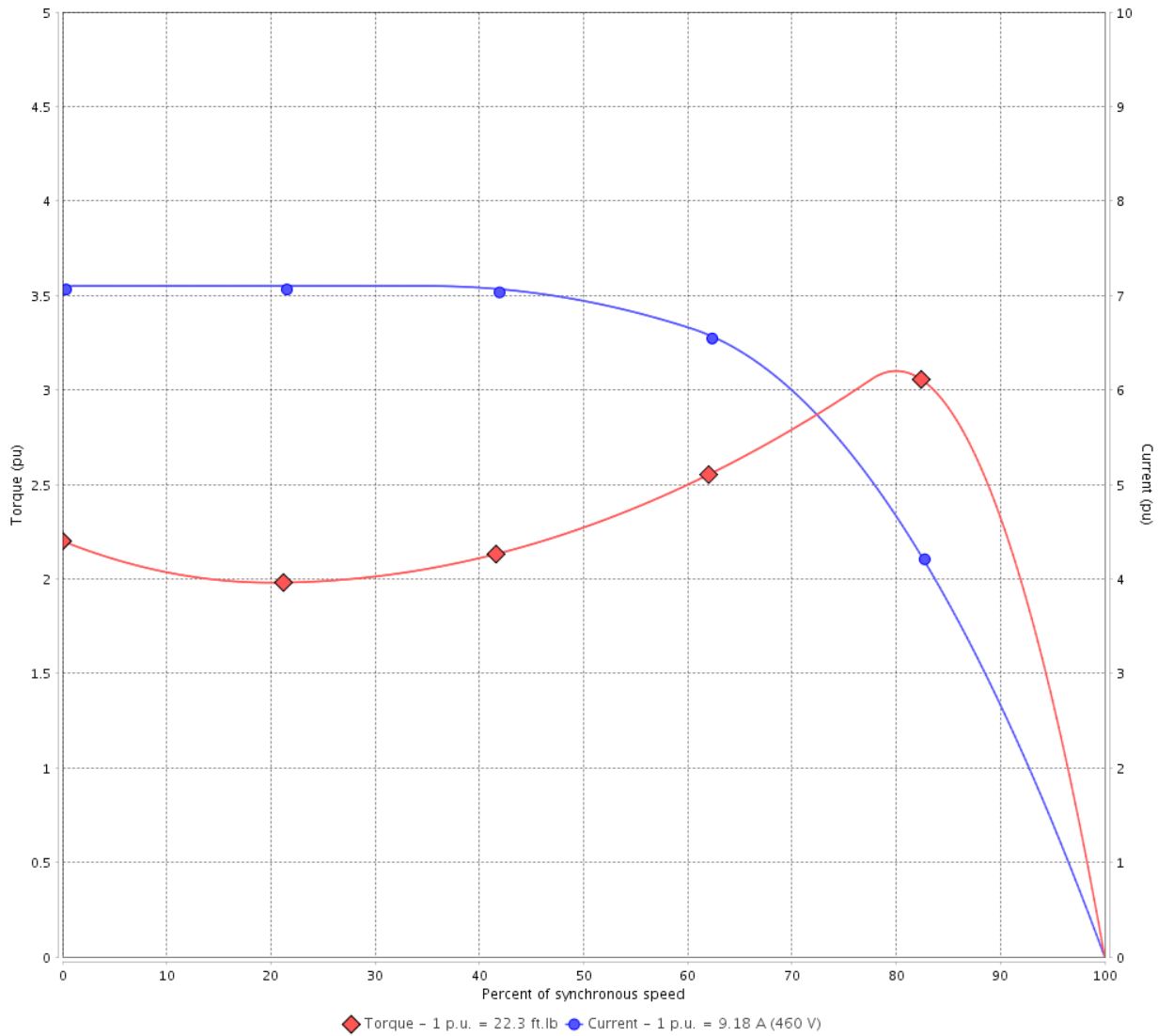

Performance : 230/460 V 60 Hz 4P

Rated current	: 18.4/9.18 A	Moment of inertia (J)	: 1.34 sq.ft.lb
LRC	: 7.1	Duty cycle	: Cont.(S1)
Rated torque	: 22.3 ft.lb	Insulation class	: F
Locked rotor torque	: 220 %	Service factor	: 1.25
Breakdown torque	: 310 %	Temperature rise	: 80 K
Rated speed	: 1765 rpm	Design	: B

Locked rotor time : 36s (cold) 20s (hot)

Rev.	Changes Summary	Performed	Checked	Date
Performed by			Page 2 / 21	Revision
Checked by				
Date	13/04/2022			

# TORQUE AND CURRENT VS SPEED CURVE



## Three Phase Induction Motor - Squirrel Cage

Customer :

Product line : NEMA Premium Efficiency Three-Phase

Product code : 12445969

Catalog # : 00718ET3E213TC-W22

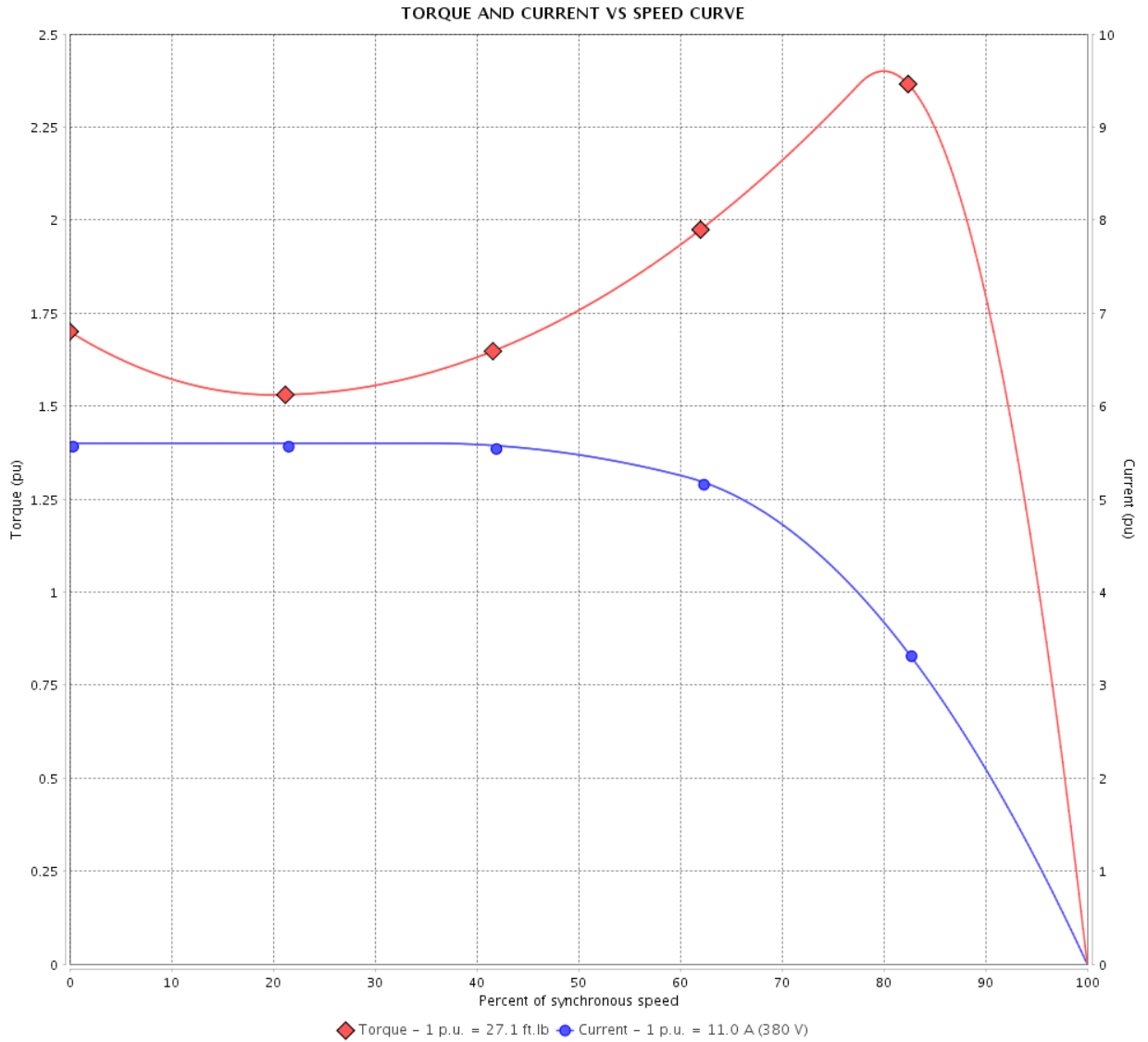

Performance : 380 V 50 Hz 4P IE3

Rated current	: 11.0 A	Moment of inertia (J)	: 1.34 sq.ft.lb
LRC	: 5.6	Duty cycle	: Cont.(S1)
Rated torque	: 27.1 ft.lb	Insulation class	: F
Locked rotor torque	: 170 %	Service factor	: 1.25
Breakdown torque	: 240 %	Temperature rise	: 80 K
Rated speed	: 1455 rpm	Design	: B

Locked rotor time : 27s (cold) 15s (hot)

Rev.	Changes Summary	Performed	Checked	Date
Performed by			Page 3 / 21	Revision
Checked by				
Date	13/04/2022			

# TORQUE AND CURRENT VS SPEED CURVE

Three Phase Induction Motor - Squirrel Cage



Customer :

Product line : NEMA Premium Efficiency Three-Phase

Product code : 12445969

Catalog # : 00718ET3E213TC-W22

TORQUE AND CURRENT VS SPEED CURVE

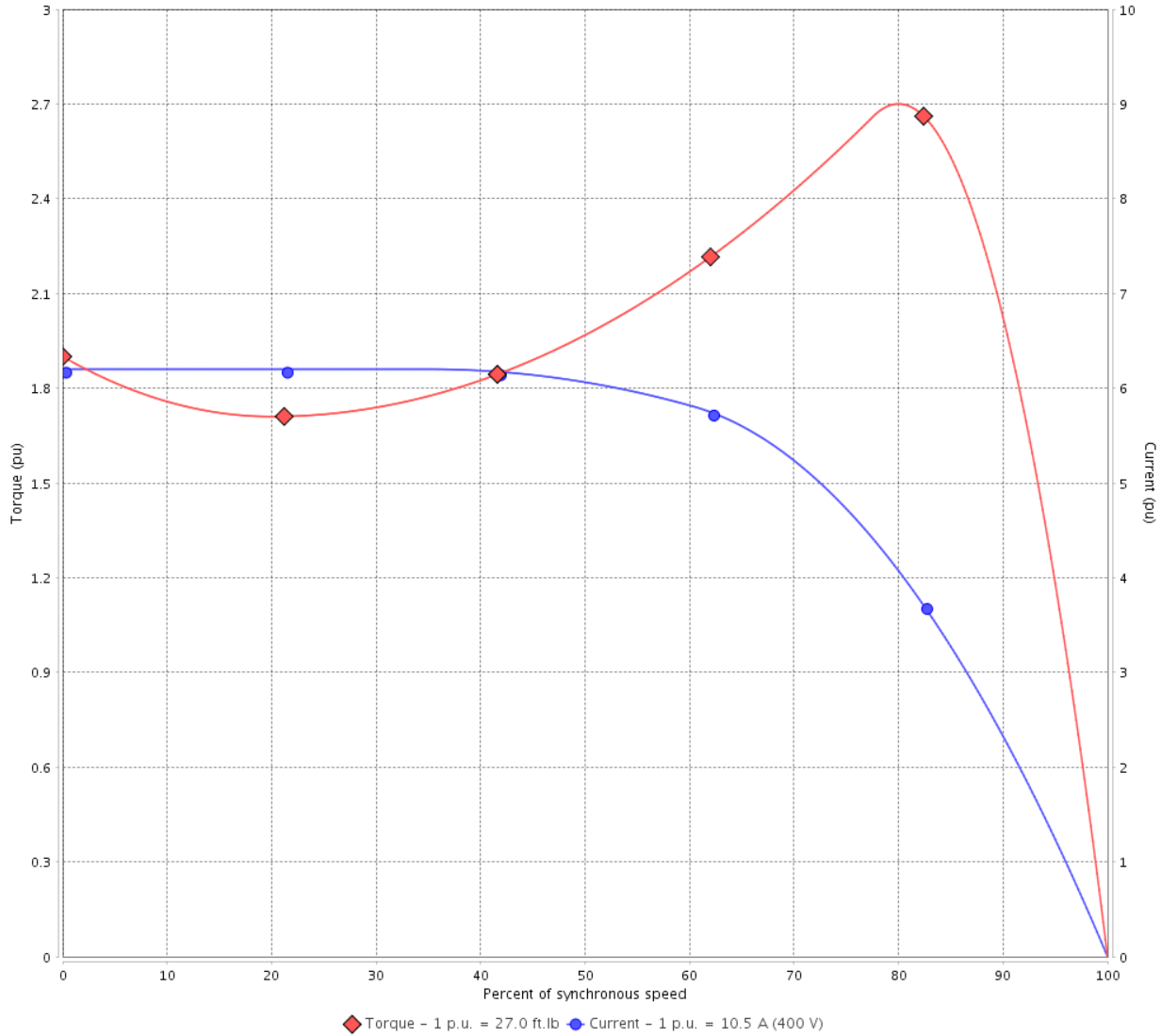

Performance : 400 V 50 Hz 4P IE3

Rated current	: 10.5 A	Moment of inertia (J)	: 1.34 sq.ft.lb
LRC	: 6.2	Duty cycle	: Cont.(S1)
Rated torque	: 27.0 ft.lb	Insulation class	: F
Locked rotor torque	: 190 %	Service factor	: 1.25
Breakdown torque	: 270 %	Temperature rise	: 80 K
Rated speed	: 1460 rpm	Design	: B

Locked rotor time : 27s (cold) 15s (hot)

Rev.	Changes Summary	Performed	Checked	Date
Performed by			Page 4 / 21	Revision
Checked by				
Date	13/04/2022			

# TORQUE AND CURRENT VS SPEED CURVE



## Three Phase Induction Motor - Squirrel Cage

Customer :

Product line : NEMA Premium Efficiency Three-Phase

Product code : 12445969

Catalog # : 00718ET3E213TC-W22

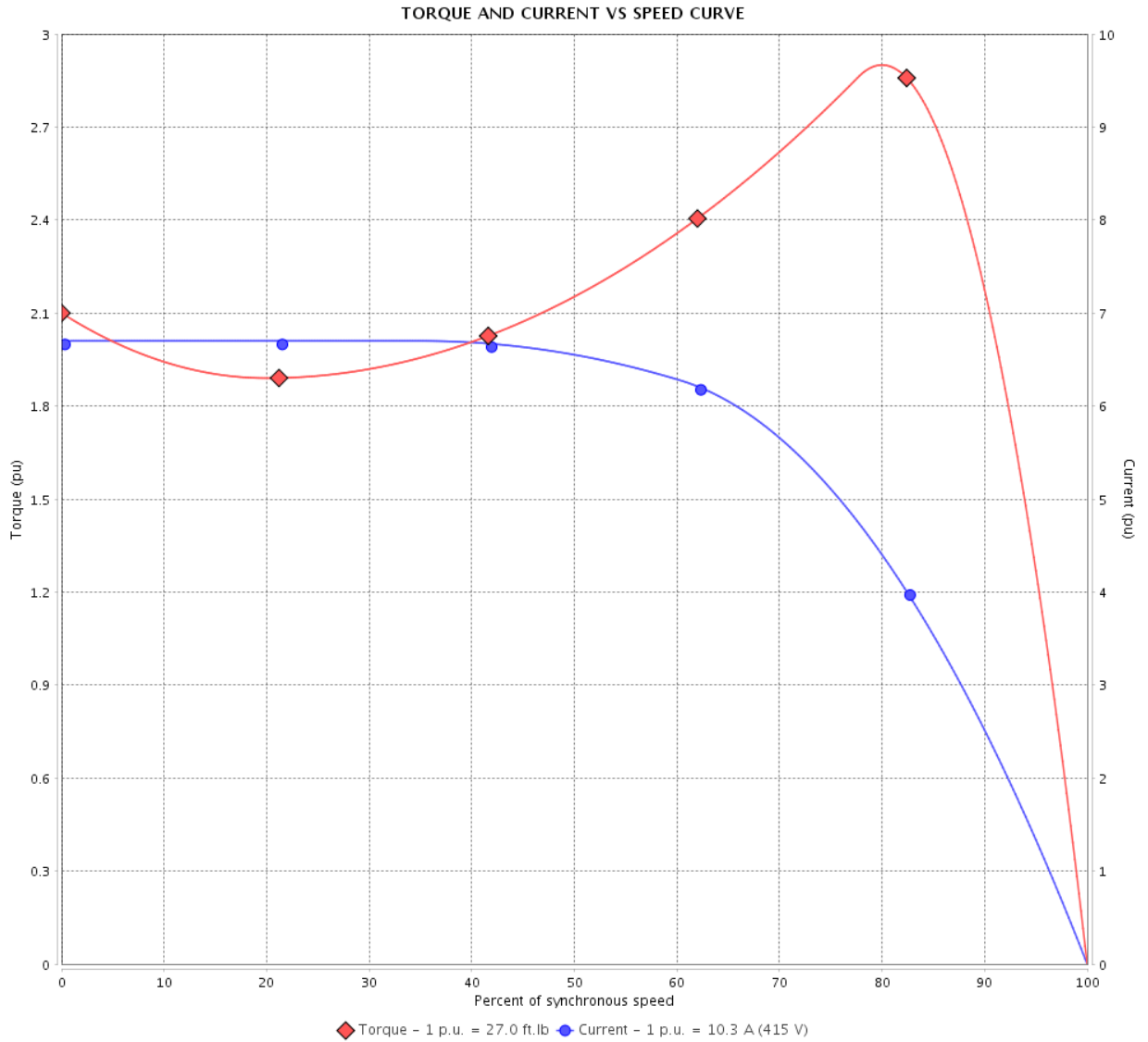

Performance : 415 V 50 Hz 4P IE3

Rated current	: 10.3 A	Moment of inertia (J)	: 1.34 sq.ft.lb
LRC	: 6.7	Duty cycle	: Cont.(S1)
Rated torque	: 27.0 ft.lb	Insulation class	: F
Locked rotor torque	: 210 %	Service factor	: 1.25
Breakdown torque	: 290 %	Temperature rise	: 80 K
Rated speed	: 1460 rpm	Design	: B

Locked rotor time : 27s (cold) 15s (hot)

Rev.	Changes Summary	Performed	Checked	Date
Performed by			Page 5 / 21	Revision
Checked by				
Date	13/04/2022			

# LOAD PERFORMANCE CURVE

Three Phase Induction Motor - Squirrel Cage



Customer :

Product line : NEMA Premium Efficiency Three-Phase

Product code : 12445969

Catalog # : 00718ET3E213TC-W22

LOAD PERFORMANCE CURVE

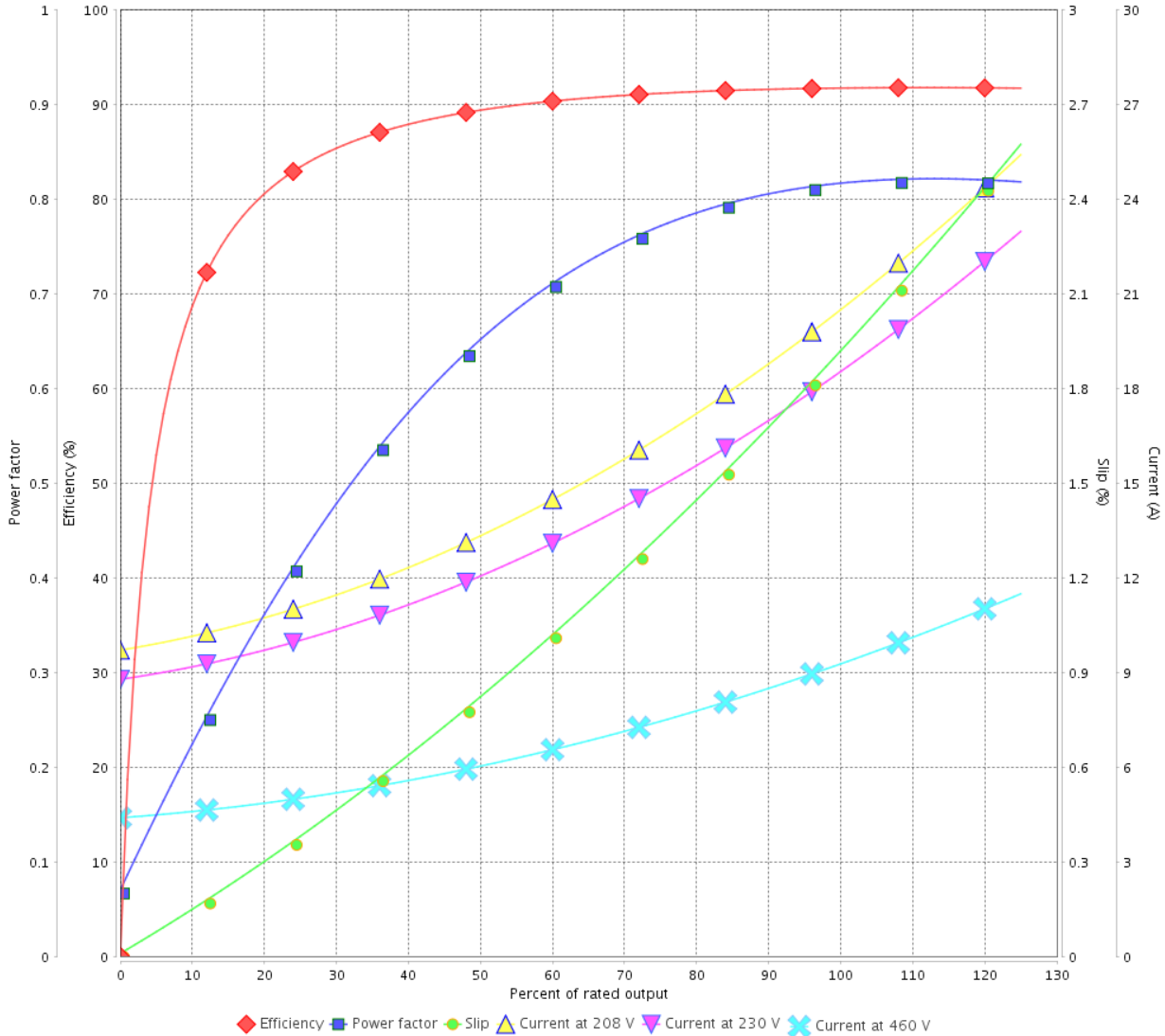

Performance : 230/460 V 60 Hz 4P

Rated current : 18.4/9.18 A  
 LRC : 7.1  
 Rated torque : 22.3 ft.lb  
 Locked rotor torque : 220 %  
 Breakdown torque : 310 %  
 Rated speed : 1765 rpm

Moment of inertia (J) : 1.34 sq.ft.lb  
 Duty cycle : Cont.(S1)  
 Insulation class : F  
 Service factor : 1.25  
 Temperature rise : 80 K  
 Design : B

Rev.	Changes Summary	Performed	Checked	Date
Performed by			Page 6 / 21	Revision
Checked by				
Date	13/04/2022			

# LOAD PERFORMANCE CURVE

## Three Phase Induction Motor - Squirrel Cage



Customer :

Product line : NEMA Premium Efficiency Three-Phase

Product code : 12445969

Catalog # : 00718ET3E213TC-W22

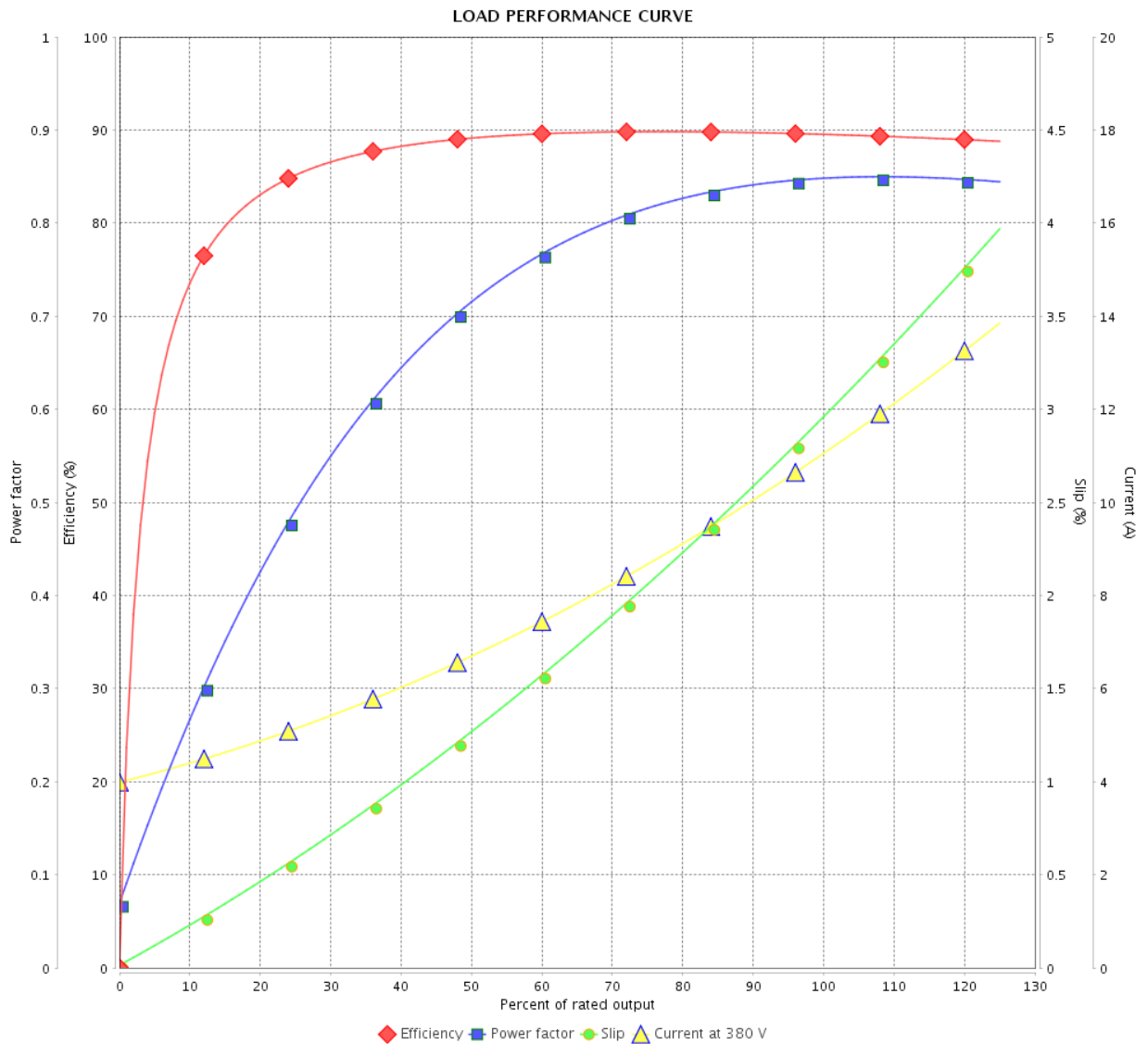

Performance : 380 V 50 Hz 4P IE3

Rated current : 11.0 A  
 LRC : 5.6  
 Rated torque : 27.1 ft.lb  
 Locked rotor torque : 170 %  
 Breakdown torque : 240 %  
 Rated speed : 1455 rpm

Moment of inertia (J) : 1.34 sq.ft.lb  
 Duty cycle : Cont.(S1)  
 Insulation class : F  
 Service factor : 1.25  
 Temperature rise : 80 K  
 Design : B

Rev.	Changes Summary	Performed	Checked	Date
Performed by		Page		Revision
Checked by		7 / 21		
Date		13/04/2022		

# LOAD PERFORMANCE CURVE

Three Phase Induction Motor - Squirrel Cage



Customer :

Product line : NEMA Premium Efficiency Three-Phase

Product code : 12445969

Catalog # : 00718ET3E213TC-W22

LOAD PERFORMANCE CURVE

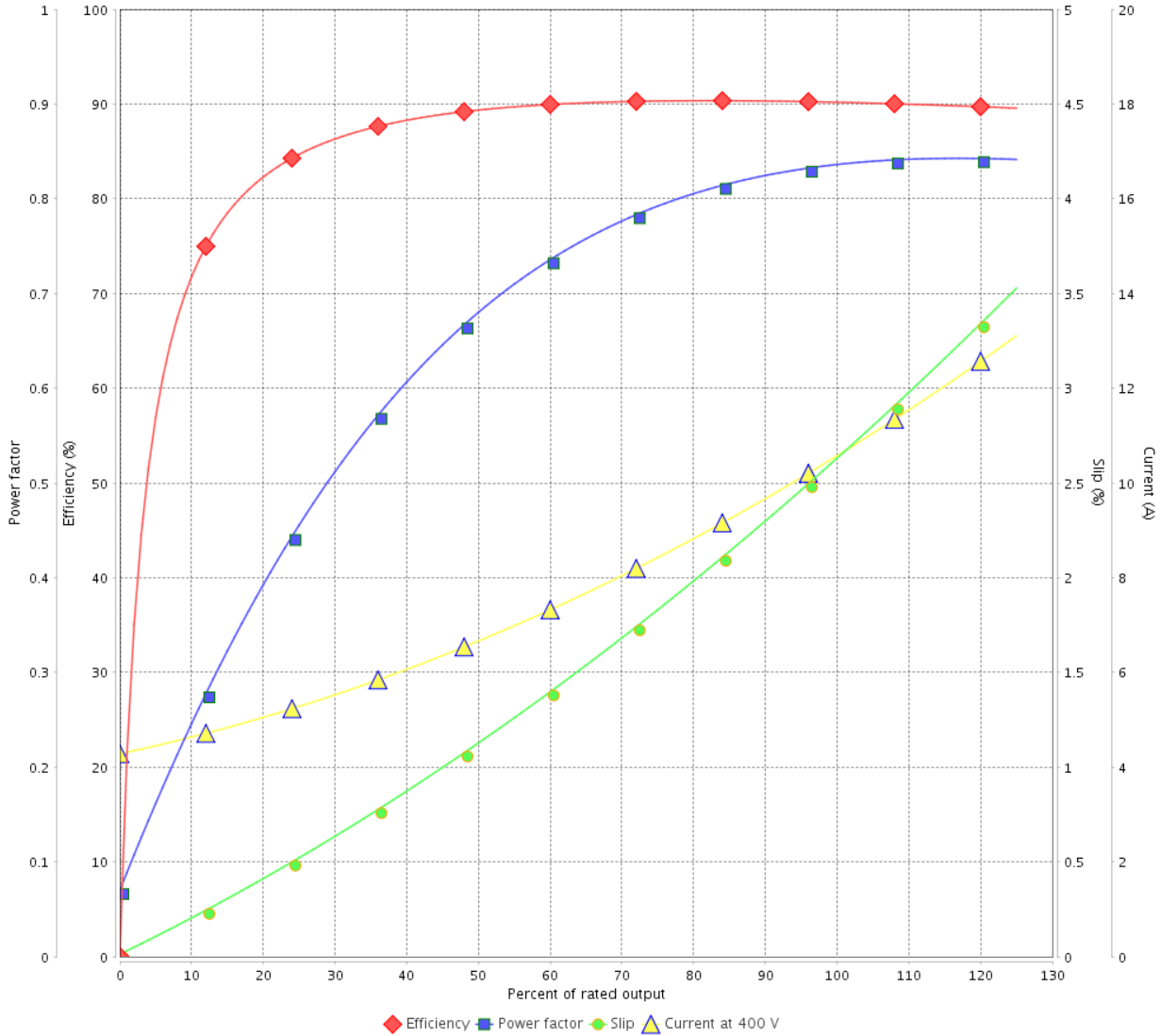

Performance : 400 V 50 Hz 4P IE3

Rated current : 10.5 A  
 LRC : 6.2  
 Rated torque : 27.0 ft.lb  
 Locked rotor torque : 190 %  
 Breakdown torque : 270 %  
 Rated speed : 1460 rpm

Moment of inertia (J) : 1.34 sq.ft.lb  
 Duty cycle : Cont.(S1)  
 Insulation class : F  
 Service factor : 1.25  
 Temperature rise : 80 K  
 Design : B

Rev.	Changes Summary	Performed	Checked	Date
Performed by			Page 8 / 21	Revision
Checked by				
Date	13/04/2022			



# LOAD PERFORMANCE CURVE

## Three Phase Induction Motor - Squirrel Cage



Customer : \_\_\_\_\_

Product line : NEMA Premium Efficiency Three-Phase

Product code : 12445969

Catalog # : 00718ET3E213TC-W22

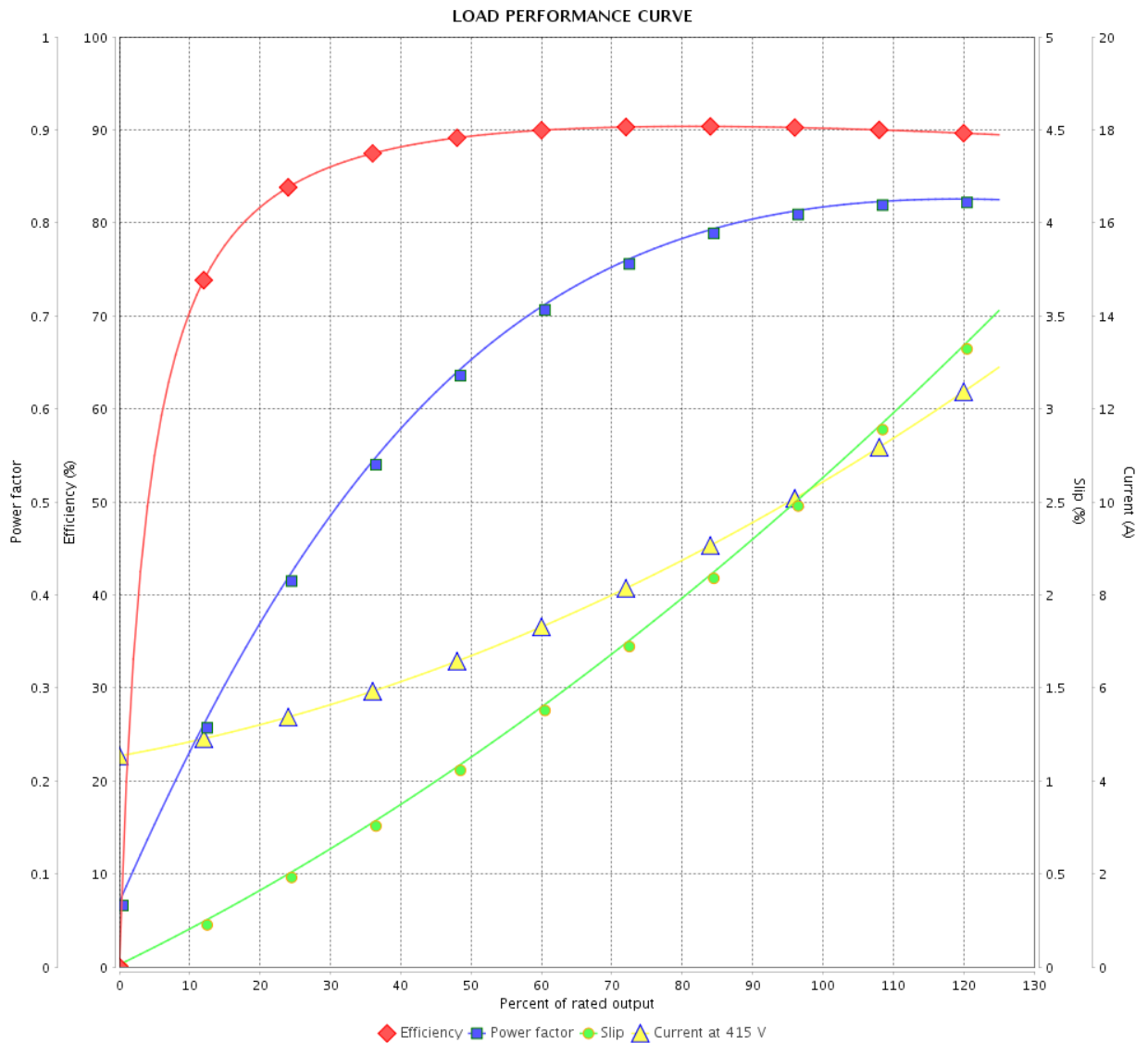

Performance : 415 V 50 Hz 4P IE3

Rated current : 10.3 A  
 LRC : 6.7  
 Rated torque : 27.0 ft.lb  
 Locked rotor torque : 210 %  
 Breakdown torque : 290 %  
 Rated speed : 1460 rpm

Moment of inertia (J) : 1.34 sq.ft.lb  
 Duty cycle : Cont.(S1)  
 Insulation class : F  
 Service factor : 1.25  
 Temperature rise : 80 K  
 Design : B

Rev.	Changes Summary	Performed	Checked	Date
Performed by		Page		Revision
Checked by		9 / 21		
Date		13/04/2022		

# THERMAL LIMIT CURVE



## Three Phase Induction Motor - Squirrel Cage

Customer :

Product line : NEMA Premium Efficiency Three-Phase  
Product code : 12445969  
Catalog # : 00718ET3E213TC-W22

Performance : 230/460 V 60 Hz 4P

Rated current	: 18.4/9.18 A	Moment of inertia (J)	: 1.34 sq.ft.lb
LRC	: 7.1	Duty cycle	: Cont.(S1)
Rated torque	: 22.3 ft.lb	Insulation class	: F
Locked rotor torque	: 220 %	Service factor	: 1.25
Breakdown torque	: 310 %	Temperature rise	: 80 K
Rated speed	: 1765 rpm	Design	: B

Heating constant

Cooling constant

Rev.	Changes Summary	Performed	Checked	Date
Performed by				
Checked by			Page	Revision
Date	13/04/2022		10 / 21	

# THERMAL LIMIT CURVE

Three Phase Induction Motor - Squirrel Cage



Customer : \_\_\_\_\_

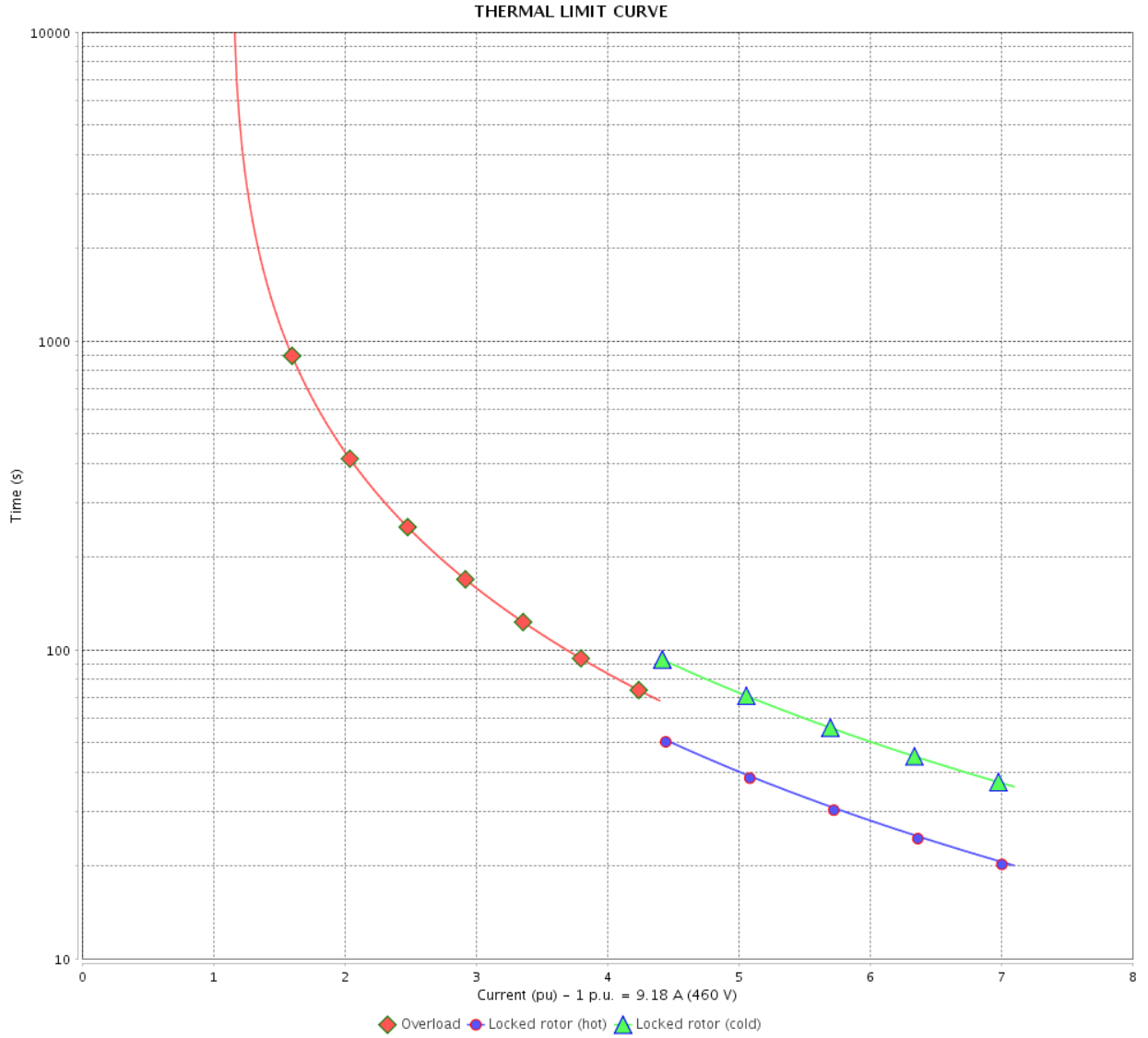

Rev.	Changes Summary	Performed	Checked	Date
Performed by		Page		Revision
Checked by		11 / 21		
Date		13/04/2022		

# THERMAL LIMIT CURVE

## Three Phase Induction Motor - Squirrel Cage



Customer :

Product line : NEMA Premium Efficiency Three-Phase  
Product code : 12445969  
Catalog # : 00718ET3E213TC-W22

Performance : 380 V 50 Hz 4P IE3

Rated current	: 11.0 A	Moment of inertia (J)	: 1.34 sq.ft.lb
LRC	: 5.6	Duty cycle	: Cont.(S1)
Rated torque	: 27.1 ft.lb	Insulation class	: F
Locked rotor torque	: 170 %	Service factor	: 1.25
Breakdown torque	: 240 %	Temperature rise	: 80 K
Rated speed	: 1455 rpm	Design	: B

Heating constant

Cooling constant

Rev.	Changes Summary	Performed	Checked	Date
Performed by				
Checked by			Page	Revision
Date	13/04/2022		12 / 21	

# THERMAL LIMIT CURVE

Three Phase Induction Motor - Squirrel Cage



Customer : \_\_\_\_\_

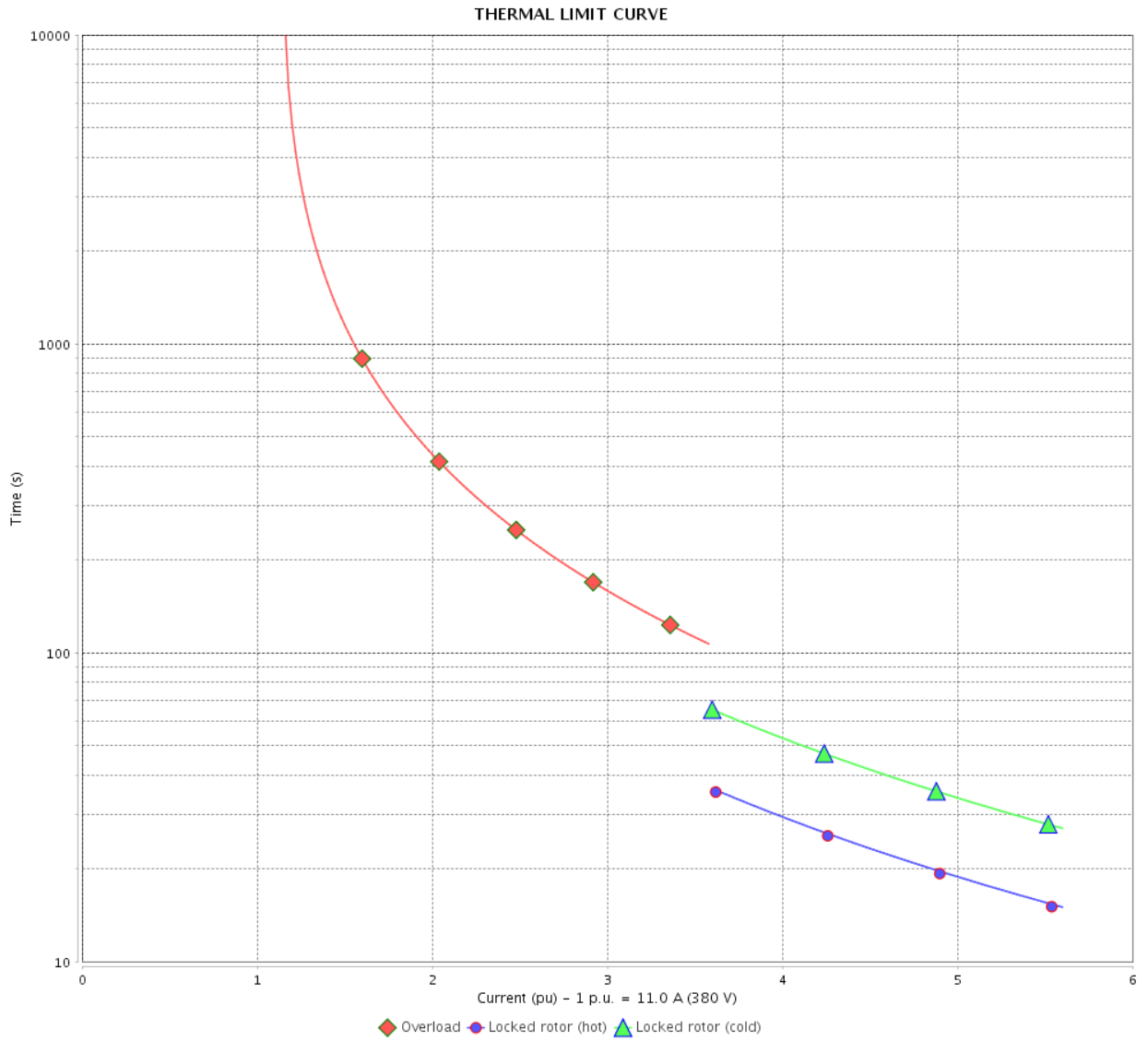

Rev.	Changes Summary	Performed	Checked	Date
Performed by		Page		Revision
Checked by		13 / 21		
Date		13/04/2022		

# THERMAL LIMIT CURVE

## Three Phase Induction Motor - Squirrel Cage



Customer :

Product line : NEMA Premium Efficiency Three-Phase

Product code : 12445969

Catalog # : 00718ET3E213TC-W22

Performance : 400 V 50 Hz 4P IE3

Rated current	: 10.5 A	Moment of inertia (J)	: 1.34 sq.ft.lb
LRC	: 6.2	Duty cycle	: Cont.(S1)
Rated torque	: 27.0 ft.lb	Insulation class	: F
Locked rotor torque	: 190 %	Service factor	: 1.25
Breakdown torque	: 270 %	Temperature rise	: 80 K
Rated speed	: 1460 rpm	Design	: B

Heating constant

Cooling constant

Rev.	Changes Summary	Performed	Checked	Date
Performed by				
Checked by			Page	Revision
Date	13/04/2022		14 / 21	

# THERMAL LIMIT CURVE

Three Phase Induction Motor - Squirrel Cage



Customer : \_\_\_\_\_

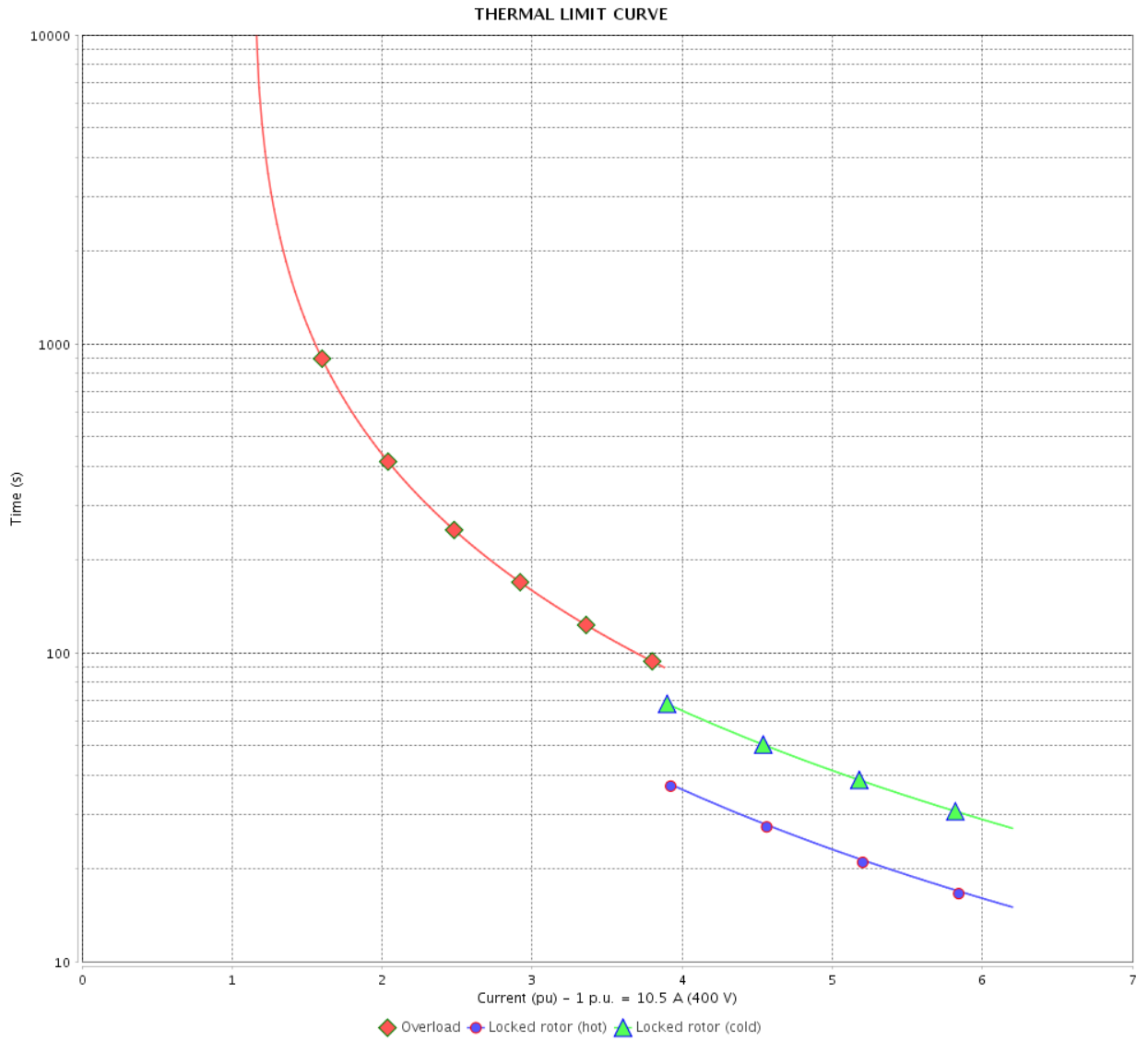

Rev.	Changes Summary	Performed	Checked	Date
Performed by		Page		Revision
Checked by		15 / 21		
Date		13/04/2022		

# THERMAL LIMIT CURVE

## Three Phase Induction Motor - Squirrel Cage



Customer :

Product line : NEMA Premium Efficiency Three-Phase  
Product code : 12445969  
Catalog # : 00718ET3E213TC-W22

Performance : 415 V 50 Hz 4P IE3

Rated current	: 10.3 A	Moment of inertia (J)	: 1.34 sq.ft.lb
LRC	: 6.7	Duty cycle	: Cont.(S1)
Rated torque	: 27.0 ft.lb	Insulation class	: F
Locked rotor torque	: 210 %	Service factor	: 1.25
Breakdown torque	: 290 %	Temperature rise	: 80 K
Rated speed	: 1460 rpm	Design	: B

Heating constant

Cooling constant

Rev.	Changes Summary	Performed	Checked	Date
Performed by				
Checked by			Page	Revision
Date	13/04/2022		16 / 21	



# THERMAL LIMIT CURVE

Three Phase Induction Motor - Squirrel Cage



Customer : \_\_\_\_\_

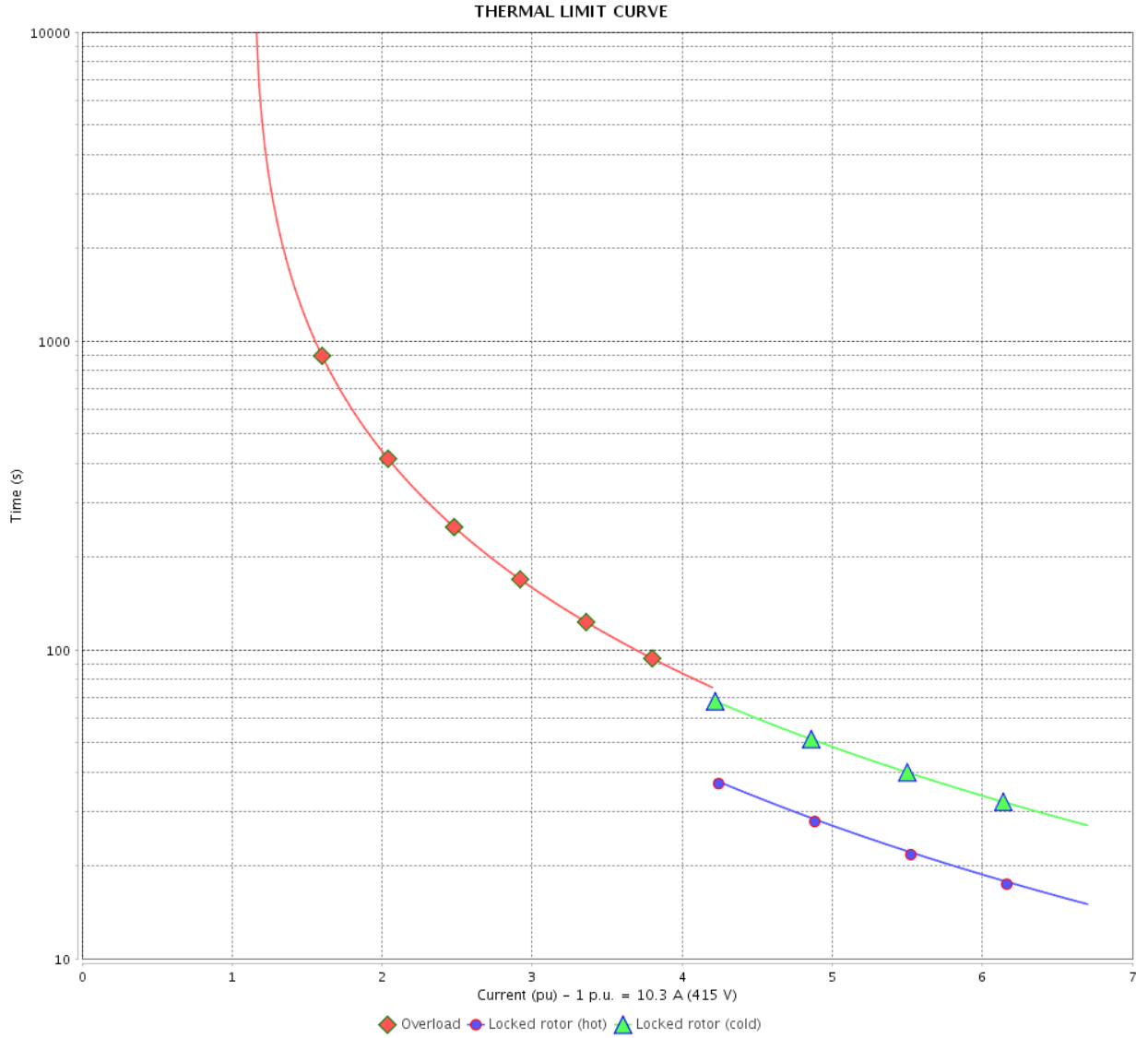

Rev.	Changes Summary	Performed	Checked	Date
Performed by		Page		Revision
Checked by		17 / 21		
Date	13/04/2022			

# VFD OPERATION CURVE

Three Phase Induction Motor - Squirrel Cage



Customer :

Product line : NEMA Premium Efficiency Three-Phase

Product code : 12445969

Catalog # : 00718ET3E213TC-W22

VFD OPERATION CURVE

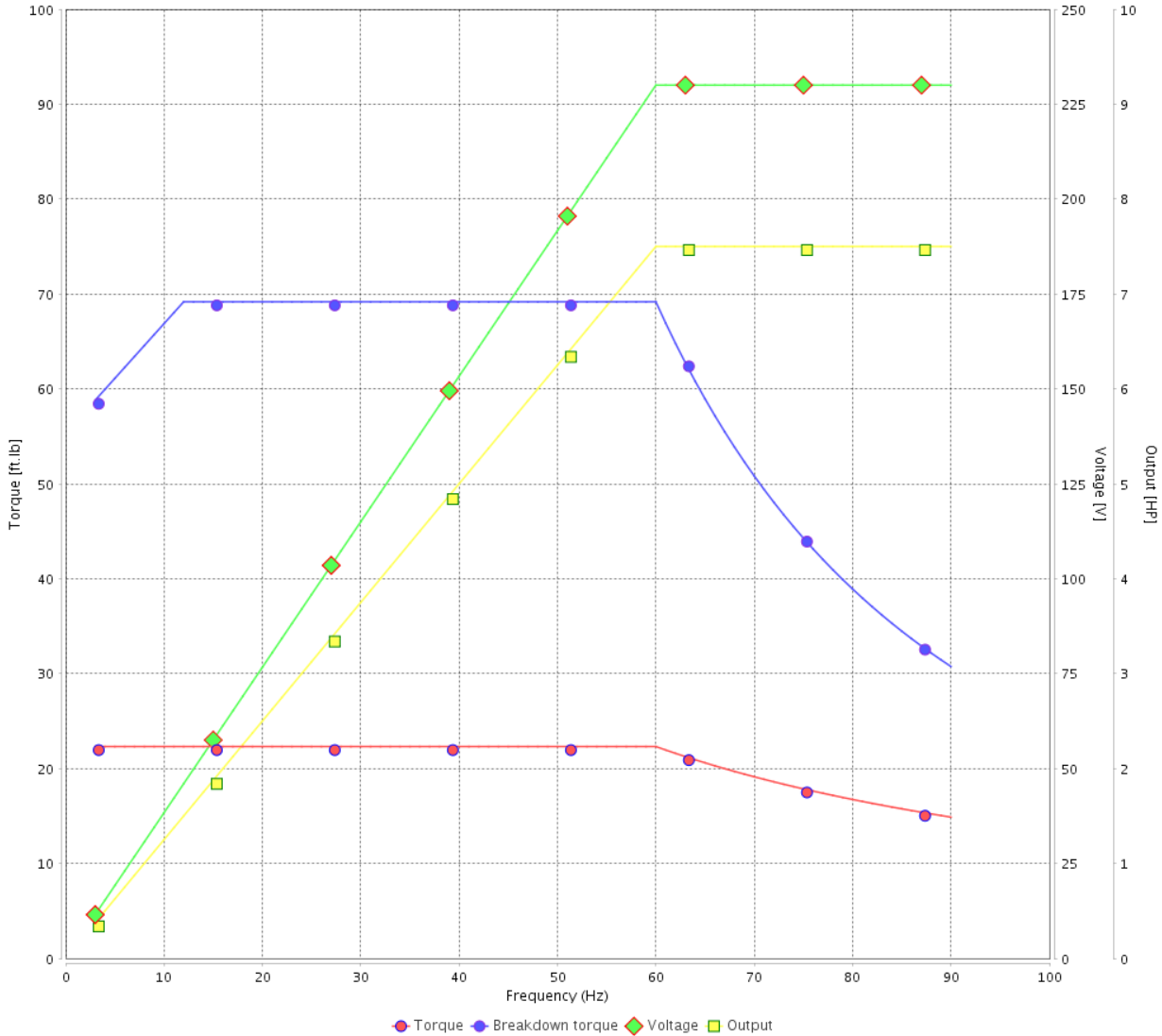

Performance : 230/460 V 60 Hz 4P

Rated current : 18.4/9.18 A  
 LRC : 7.1  
 Rated torque : 22.3 ft.lb  
 Locked rotor torque : 220 %  
 Breakdown torque : 310 %  
 Rated speed : 1765 rpm

Moment of inertia (J) : 1.34 sq.ft.lb  
 Duty cycle : Cont.(S1)  
 Insulation class : F  
 Service factor : 1.25  
 Temperature rise : 80 K  
 Design : B

Rev.	Changes Summary	Performed	Checked	Date
Performed by			Page	Revision
Checked by				
Date				

# VFD OPERATION CURVE

Three Phase Induction Motor - Squirrel Cage



Customer :

Product line : NEMA Premium Efficiency Three-Phase

Product code : 12445969

Catalog # : 00718ET3E213TC-W22

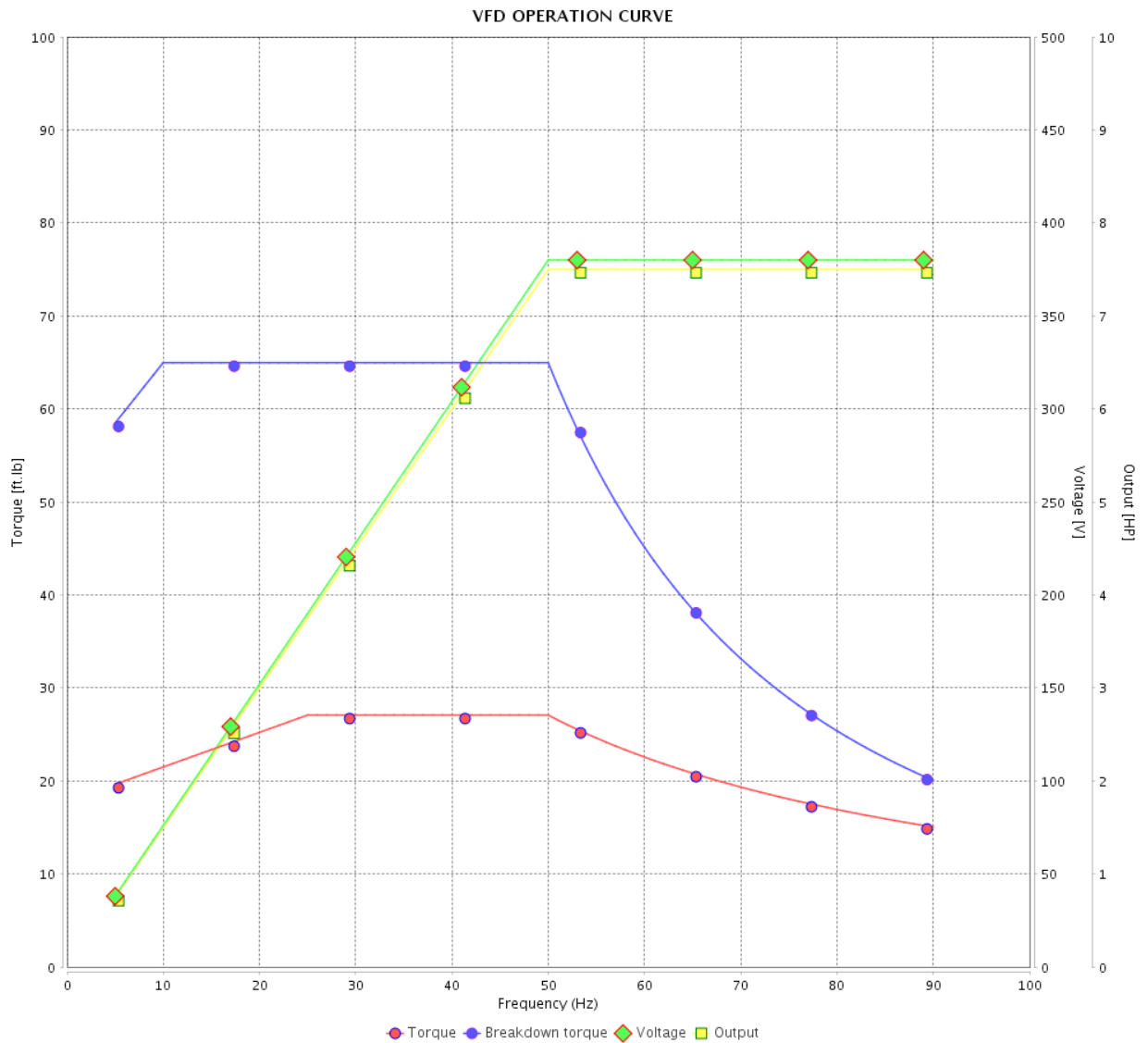

Performance : 380 V 50 Hz 4P IE3

Rated current : 11.0 A  
 LRC : 5.6  
 Rated torque : 27.1 ft.lb  
 Locked rotor torque : 170 %  
 Breakdown torque : 240 %  
 Rated speed : 1455 rpm

Moment of inertia (J) : 1.34 sq.ft.lb  
 Duty cycle : Cont.(S1)  
 Insulation class : F  
 Service factor : 1.25  
 Temperature rise : 80 K  
 Design : B

Rev.	Changes Summary	Performed	Checked	Date
Performed by			Page 19 / 21	Revision
Checked by				
Date	13/04/2022			

# VFD OPERATION CURVE

Three Phase Induction Motor - Squirrel Cage



Customer :

Product line : NEMA Premium Efficiency Three-Phase

Product code : 12445969

Catalog # : 00718ET3E213TC-W22

VFD OPERATION CURVE

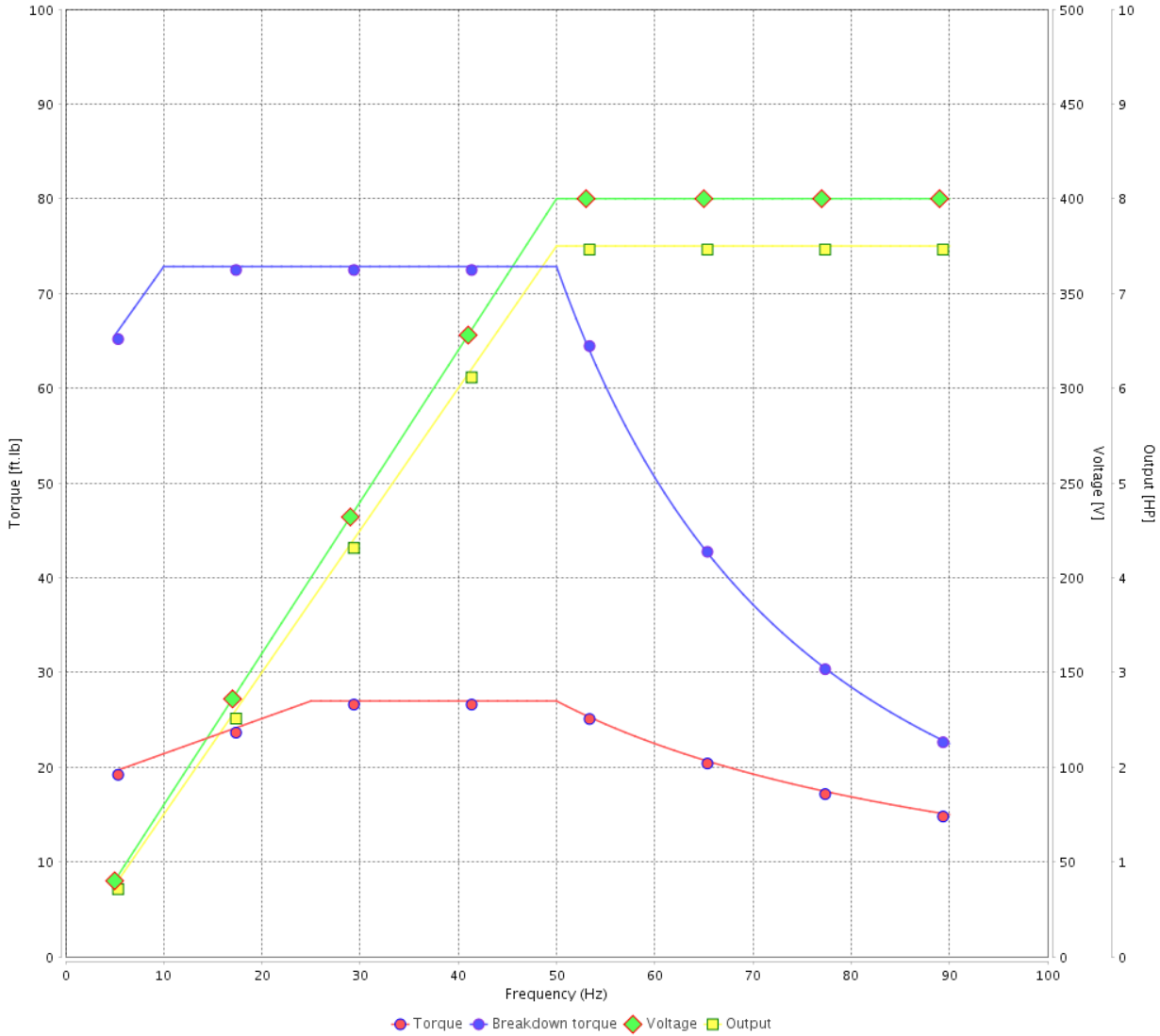

Performance : 400 V 50 Hz 4P IE3

Rated current : 10.5 A  
 LRC : 6.2  
 Rated torque : 27.0 ft.lb  
 Locked rotor torque : 190 %  
 Breakdown torque : 270 %  
 Rated speed : 1460 rpm

Moment of inertia (J) : 1.34 sq.ft.lb  
 Duty cycle : Cont.(S1)  
 Insulation class : F  
 Service factor : 1.25  
 Temperature rise : 80 K  
 Design : B

Rev.	Changes Summary	Performed	Checked	Date
Performed by			Page 20 / 21	Revision
Checked by				
Date	13/04/2022			

# VFD OPERATION CURVE

## Three Phase Induction Motor - Squirrel Cage



Customer : \_\_\_\_\_

Product line : NEMA Premium Efficiency Three-Phase

Product code : 12445969

Catalog # : 00718ET3E213TC-W22

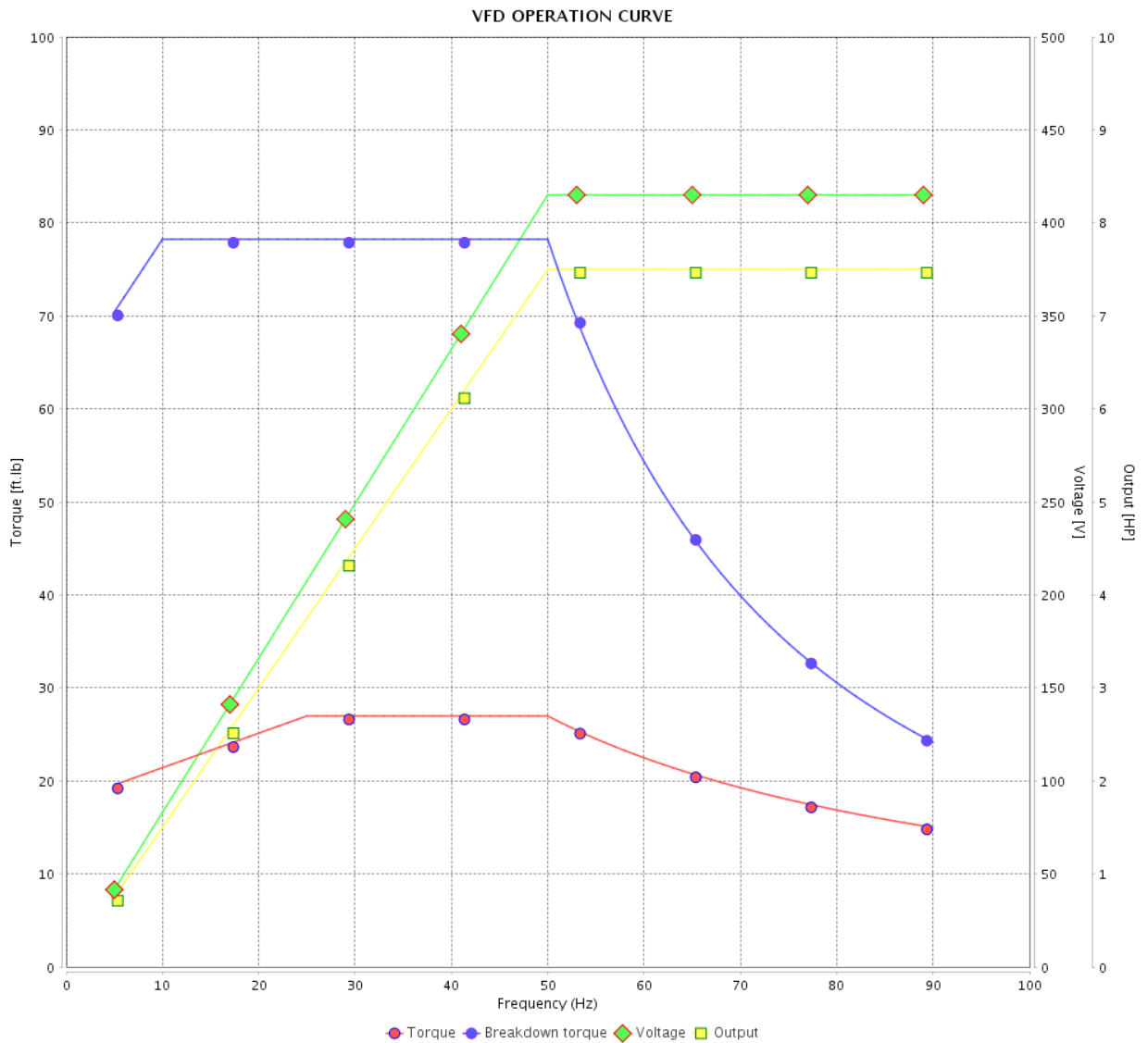

Performance : 415 V 50 Hz 4P IE3

Rated current : 10.3 A  
 LRC : 6.7  
 Rated torque : 27.0 ft.lb  
 Locked rotor torque : 210 %  
 Breakdown torque : 290 %  
 Rated speed : 1460 rpm

Moment of inertia (J) : 1.34 sq.ft.lb  
 Duty cycle : Cont.(S1)  
 Insulation class : F  
 Service factor : 1.25  
 Temperature rise : 80 K  
 Design : B

Rev.	Changes Summary	Performed	Checked	Date
Performed by				Page 21 / 21
Checked by				
Date	13/04/2022			

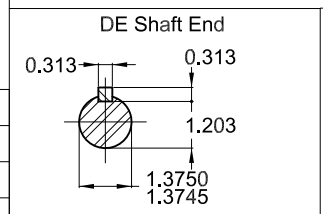
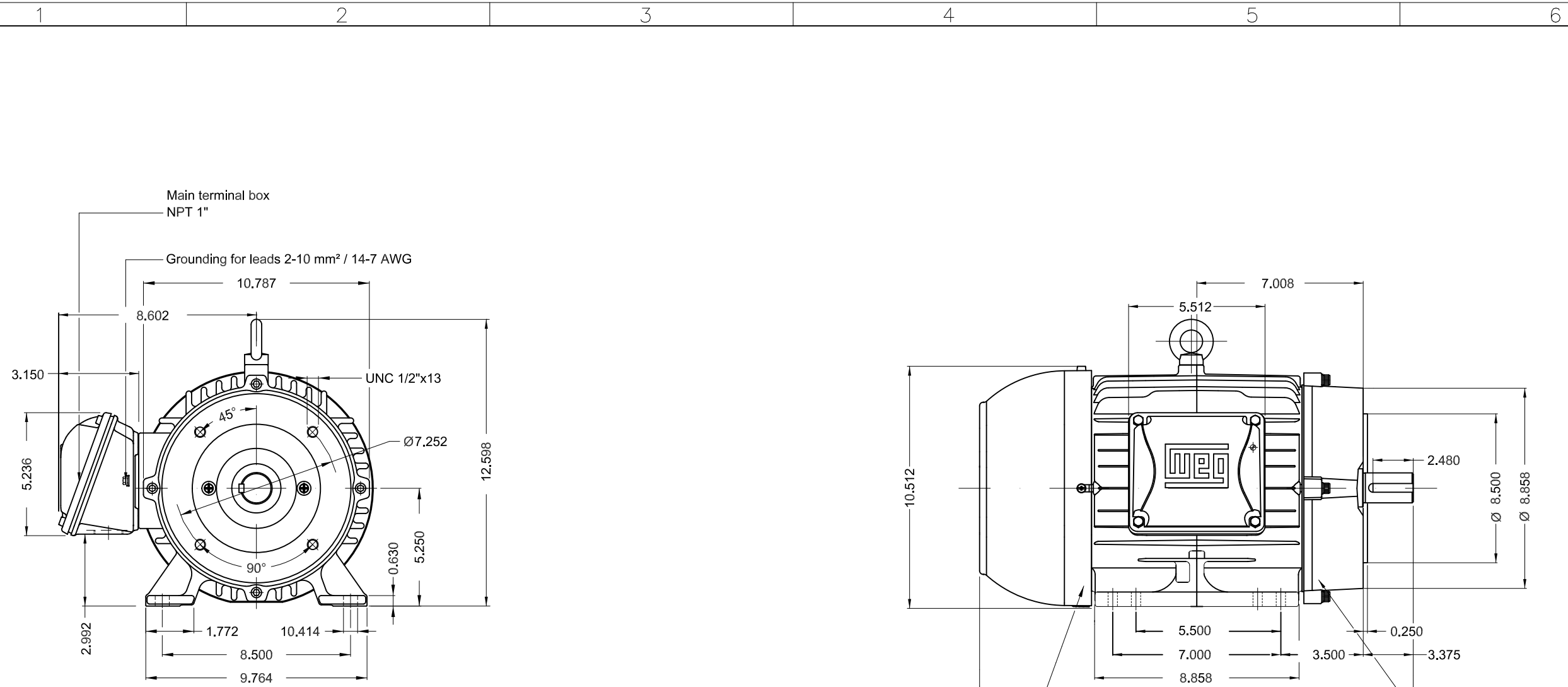

Bearing cap
Color RAL 5009
Painting plan 207A
Mounting B34R(D)

7.5 HP 04 Poles 60 Hz A

ECM	LOC	SUMMARY OF MODIFICATIONS	EXECUTED	CHECKED	RELEASED	DATE	VER
EXECUTED	PIRWBUSER	THREE PH. MOTOR W22 PREM. EFF.					
CHECKED		FRAME 213/5TC IP55 TEFC					
RELEASED							
REL DT.	WMO	Jaragua do Sul	Product Engineering	SHEET	1 / 1		

**PREVIEW**

WDD

Dimensions in inches XME A3

MADE IN BRAZIL  
12445969



W22

MODEL 00718ET3E213TC-W22

Inverter Duty Motor  
Severe Duty



For use on 60Hz  
Class I, Div 2, Gr A, B, C and D - T3  
Class I, Zone 2, IIC - T3  
Class II, Div 2, Gr F and G - T4  
For use on PWM: Gr. A, B, C, D and F,  
VT 1000:1, CT 20:1, 1.00SF - T3A



FOR SAFE AREA  
Mod. TE1BFOXON  
CC029A

PH3 60Hz Fr. 213/5TC 1000m.a.s.l. IP55 TEFC 171lb

V 230/460

A 18.4/9.18

HP 7.5

kW 5.5

SF 1.25

SFA 23.0/11.5

RPM 1765

PF 0.82

AMB 40°C

INS cl. F DT80K

NEMA NOM EFF 91.7%

DUTY CONT.

DES B Code H

USABLE @208V 19.9A SF 1.15 SFA 22.9

7.5HP 5.5kW 50Hz 380V 11.0A 1455RPM SF 1.25 SFA 13.8 EFF 89.6% (IE3)

