

DATA SHEET

Three Phase Induction Motor - Squirrel Cage



Customer : _____

Thermal protection

ID	Application	Type	Quantity	Sensing Temperature
1	Winding	Thermostat - 2 wires	1 x Phase	155 °C

Rev.	Changes Summary	Performed	Checked	Date
Performed by				
Checked by			Page	Revision
Date	12/04/2022		2 / 7	

TORQUE AND CURRENT VS SPEED CURVE



Three Phase Induction Motor - Squirrel Cage

Customer :

Product line : NEMA Premium Efficiency Three-Phase

Product code : 14407931

Catalog # : 01012XT3H256T

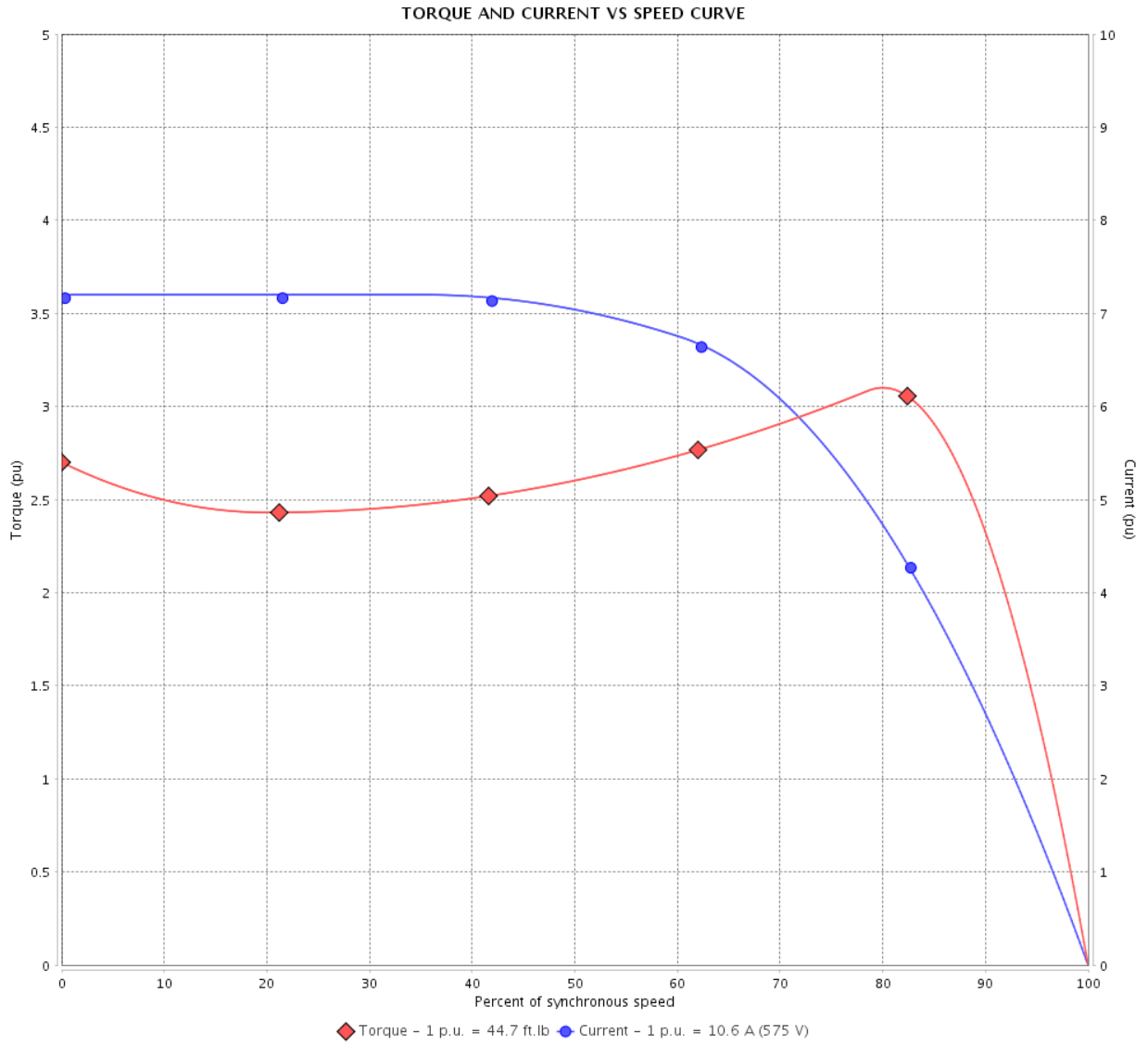

Performance : 575 V 60 Hz 6P

Rated current	: 10.6 A	Moment of inertia (J)	: 4.15 sq.ft.lb
LRC	: 7.2	Duty cycle	: Cont.(S1)
Rated torque	: 44.7 ft.lb	Insulation class	: F
Locked rotor torque	: 270 %	Service factor	: 1.15
Breakdown torque	: 310 %	Temperature rise	: 80 K
Rated speed	: 1175 rpm	Design	: B

Locked rotor time : 46s (cold) 26s (hot)

Rev.	Changes Summary	Performed	Checked	Date
Performed by			Page 3 / 7	Revision
Checked by				
Date	12/04/2022			

LOAD PERFORMANCE CURVE

Three Phase Induction Motor - Squirrel Cage



Customer :

Product line : NEMA Premium Efficiency Three-Phase

Product code : 14407931

Catalog # : 01012XT3H256T

LOAD PERFORMANCE CURVE

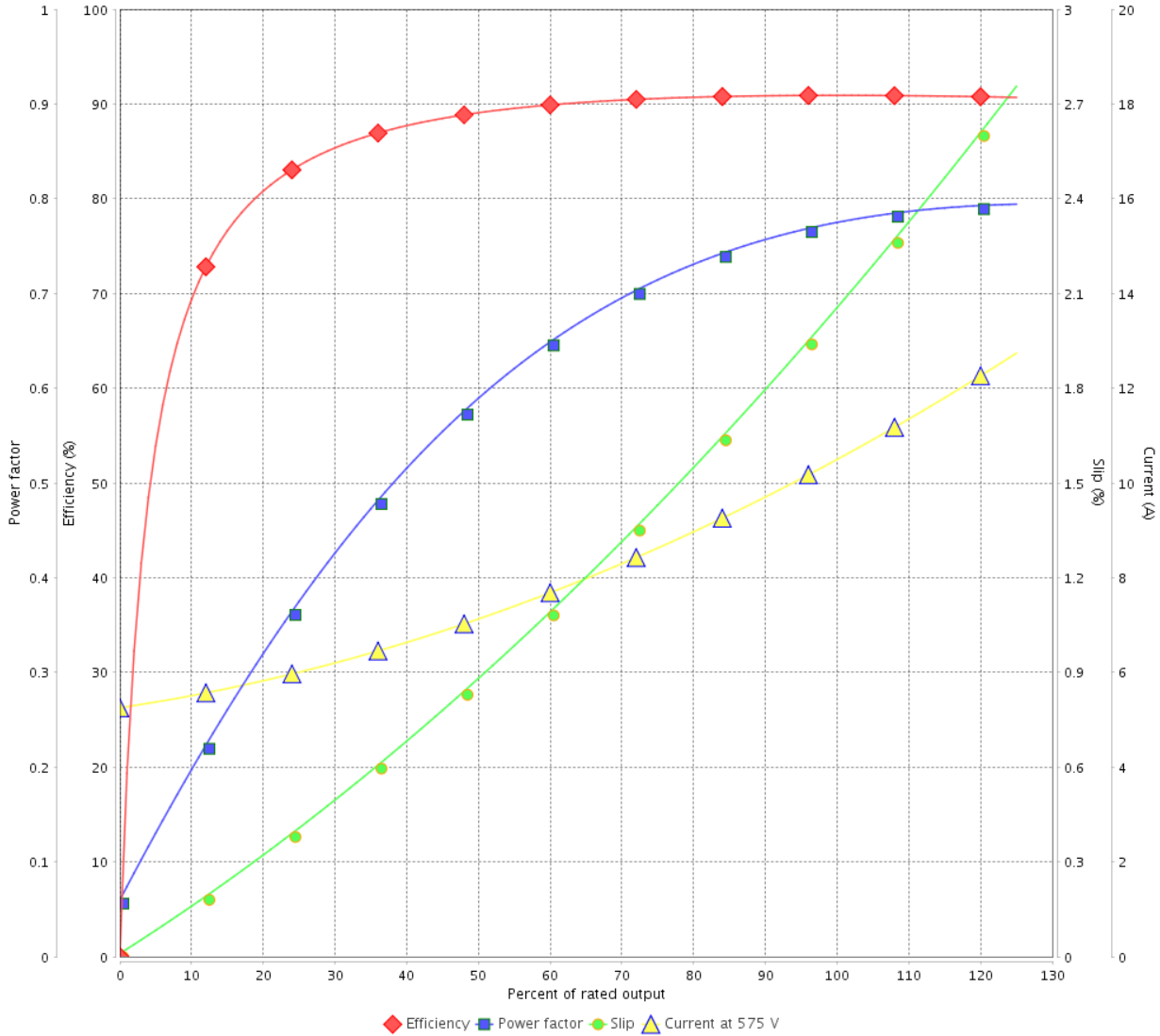

Performance : 575 V 60 Hz 6P

Rated current : 10.6 A
 LRC : 7.2
 Rated torque : 44.7 ft.lb
 Locked rotor torque : 270 %
 Breakdown torque : 310 %
 Rated speed : 1175 rpm

Moment of inertia (J) : 4.15 sq.ft.lb
 Duty cycle : Cont.(S1)
 Insulation class : F
 Service factor : 1.15
 Temperature rise : 80 K
 Design : B

Rev.	Changes Summary	Performed	Checked	Date
Performed by			Page 4 / 7	Revision
Checked by				
Date	12/04/2022			

THERMAL LIMIT CURVE



Three Phase Induction Motor - Squirrel Cage

Customer :

Product line : NEMA Premium Efficiency Three-Phase
 Product code : 14407931
 Catalog # : 01012XT3H256T

Performance : 575 V 60 Hz 6P

Rated current : 10.6 A	Moment of inertia (J) : 4.15 sq.ft.lb
LRC : 7.2	Duty cycle : Cont.(S1)
Rated torque : 44.7 ft.lb	Insulation class : F
Locked rotor torque : 270 %	Service factor : 1.15
Breakdown torque : 310 %	Temperature rise : 80 K
Rated speed : 1175 rpm	Design : B

Heating constant

Cooling constant

Rev.	Changes Summary	Performed	Checked	Date
Performed by			Page 5 / 7	Revision
Checked by				
Date	12/04/2022			

THERMAL LIMIT CURVE

Three Phase Induction Motor - Squirrel Cage



Customer : _____

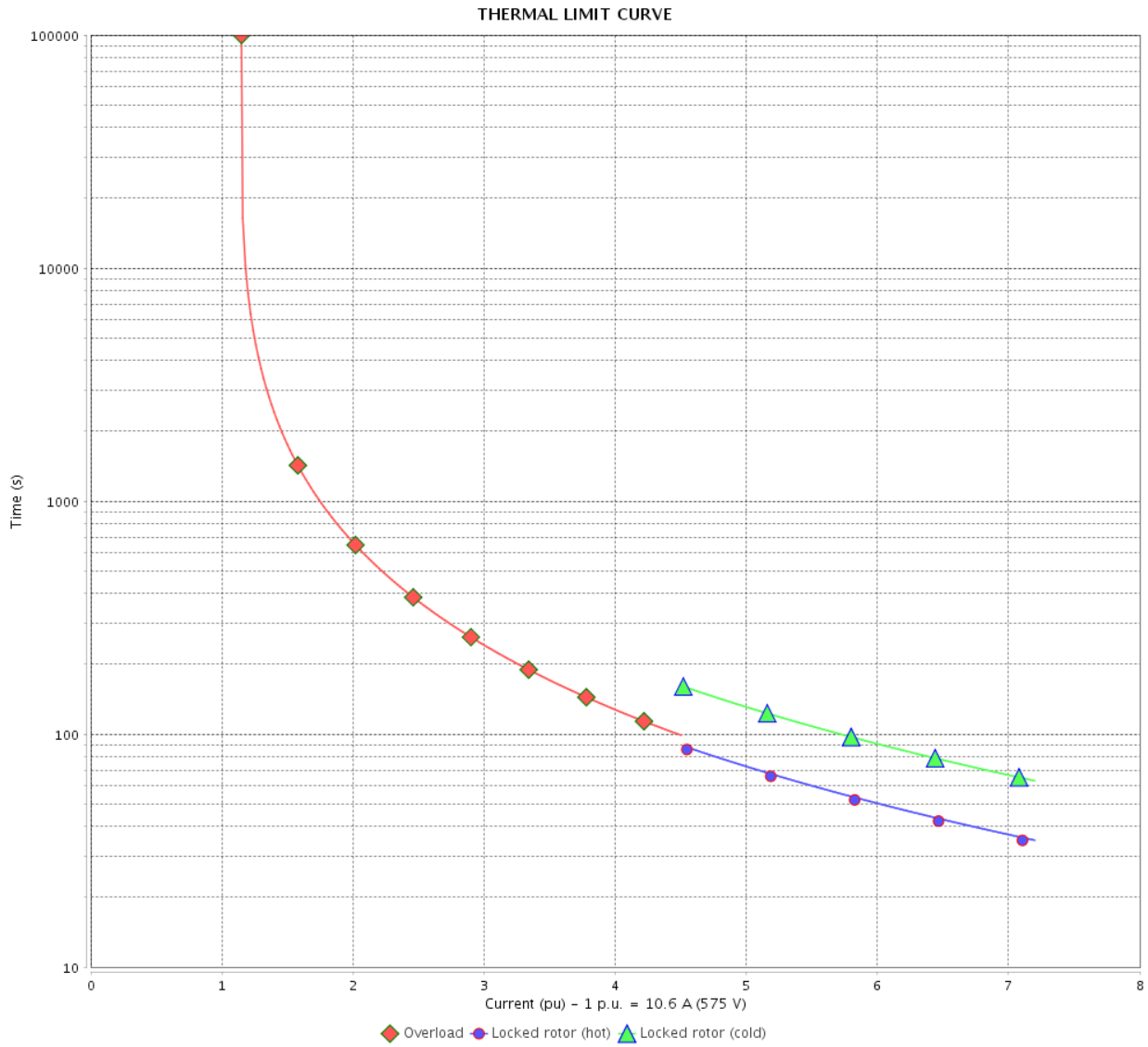

Rev.	Changes Summary	Performed	Checked	Date
Performed by		Page 6 / 7		Revision
Checked by				
Date				

VFD OPERATION CURVE

Three Phase Induction Motor - Squirrel Cage



Customer :

Product line : NEMA Premium Efficiency Three-Phase

Product code : 14407931

Catalog # : 01012XT3H256T

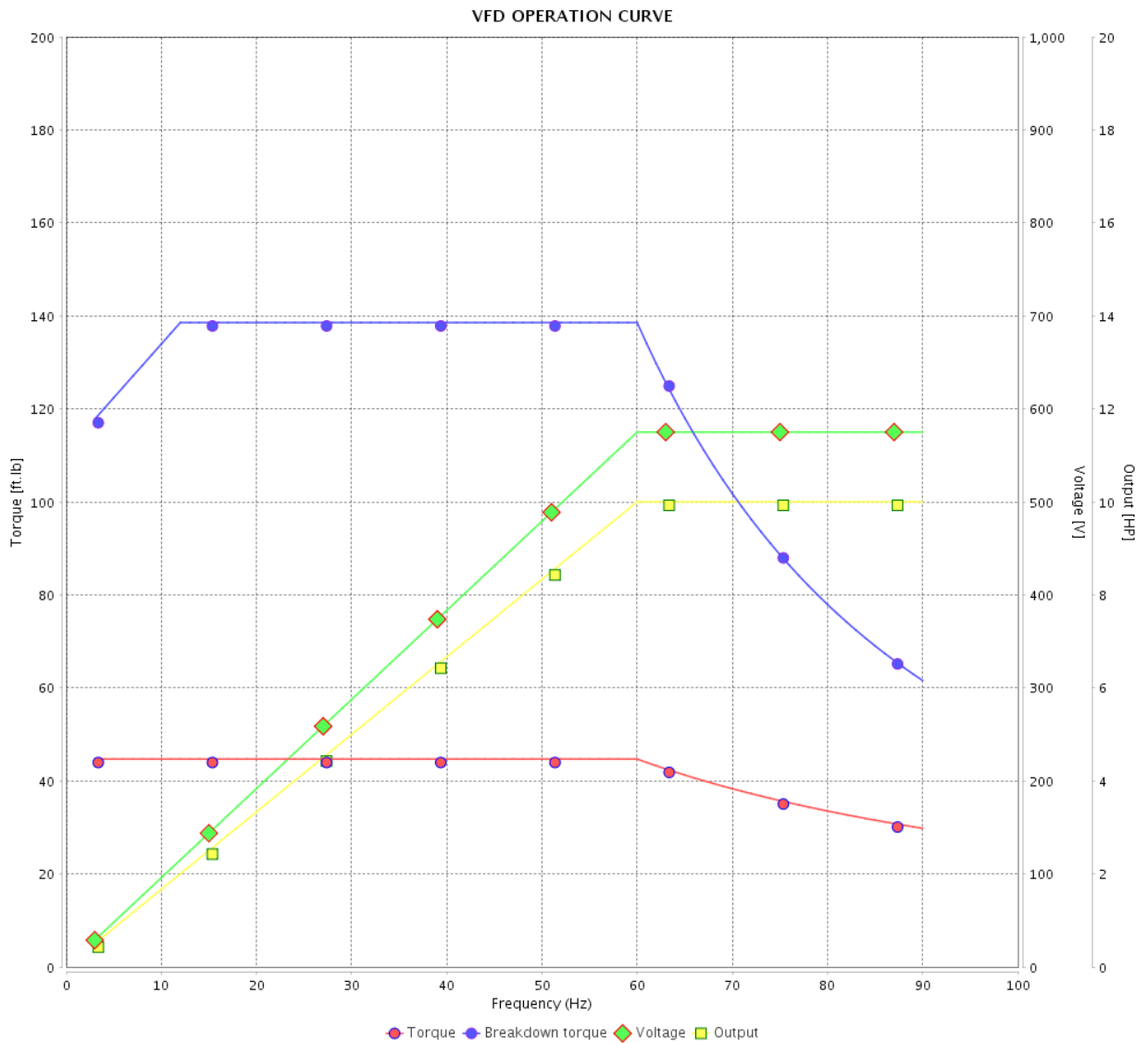

Performance : 575 V 60 Hz 6P

Rated current : 10.6 A
 LRC : 7.2
 Rated torque : 44.7 ft.lb
 Locked rotor torque : 270 %
 Breakdown torque : 310 %
 Rated speed : 1175 rpm

Moment of inertia (J) : 4.15 sq.ft.lb
 Duty cycle : Cont.(S1)
 Insulation class : F
 Service factor : 1.15
 Temperature rise : 80 K
 Design : B

Rev.	Changes Summary	Performed	Checked	Date
Performed by				Page 7 / 7
Checked by				
Date	12/04/2022			
				Revision

1 2 3 4 5 6

A

B

C

D

E

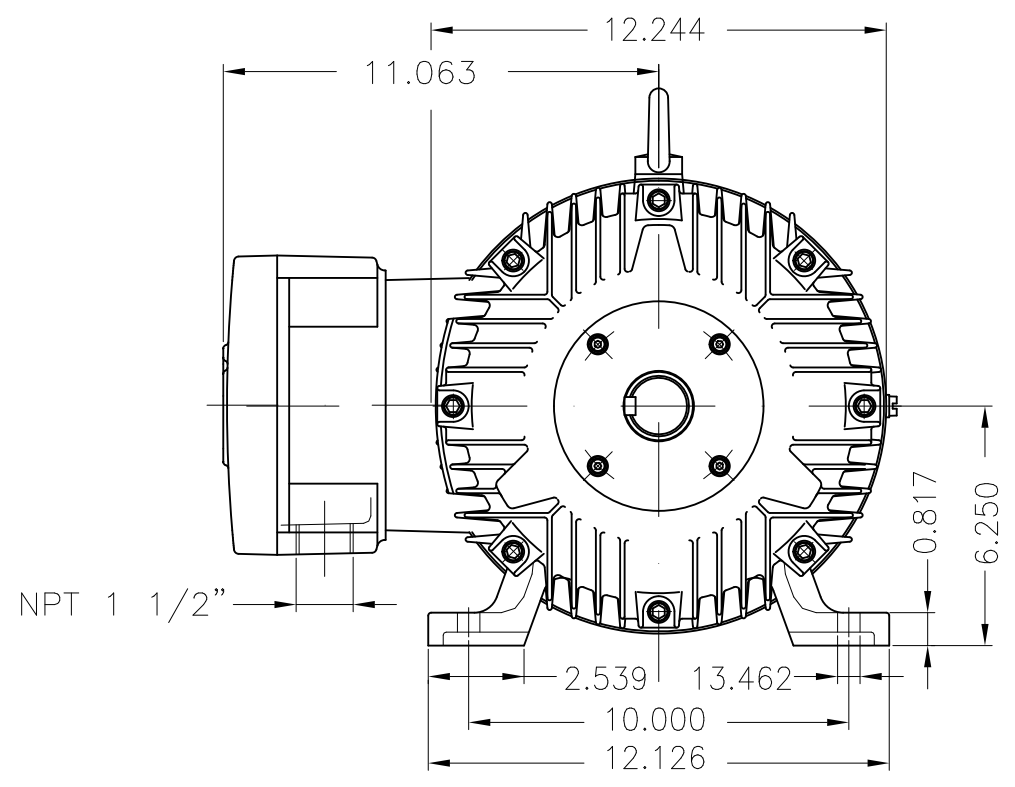

Grounding for leads 5.2–25 mm² / 10–4 AWG

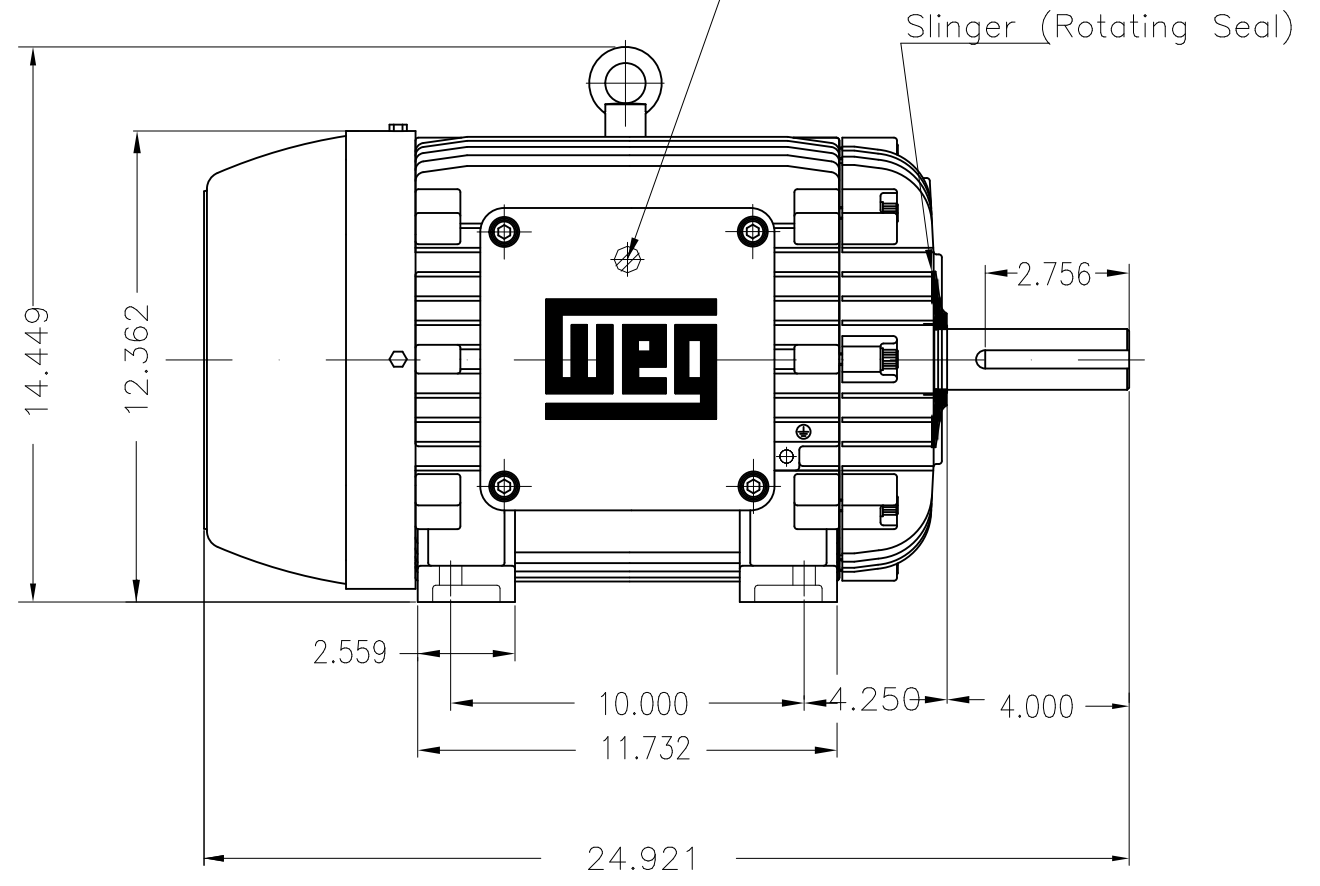

10 HP 06 Poles 60 Hz A

- With grease fitting
- Color RAL 5009
- Painting plan 202P
- Mounting NEMA F-1
- Mounting B3R(D)

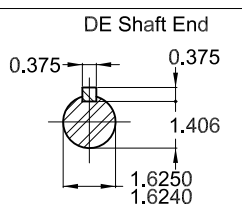

ECM	LOC	SUMMARY OF MODIFICATIONS	EXECUTED	CHECKED	RELEASED	DATE	VER
EXECUTED	PIRWBUSER	THREE PH. MOTOR EXPLOSION PROOF PREM. EFF.					
CHECKED		FRAME 256T IP55 TEFC					
RELEASED							
REL DT.	WMO	Jaragua do Sul	Product Engineering	SHEET	1 / 1		

PREVIEW
WDD



MADE IN BRAZIL

**W21X NEMA**
Premium

14407931



LISTED

CC029A

Inverter Duty Motor
Severe Duty

HX010506NPW21X

PH 3	FR 256T	
HP(kW) 10(7.5)		HZ 60 IP55
V 575		A 10.6
RPM 1175		NEMA NOM EFF 91.0%
PF 0.78	SFA 12.2	DES B
INS CL F Δ T 80 K	SF 1.15	ENCL TEFC
DUTY CONT.	CODE J	ALT 1000 m.a.s.l.
AMB 40°C		
AMB 55°C	SF1.0	

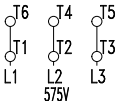

→ 6309-C3 MOBIL POLYREX EM
→ 6209-C3 13 g 20000 h

366 Lbs



TEMP CODE T3C
CSA/UL: Class I - Div. 1 - Groups C and D
CSA: Class II - Div. 1 - Groups F and G
CSA: Class I - Zone 1 - IIB

EXPLOSION PROOF MOTOR

FOR USE ON VPWM VFD 1000:1VT, 6:1CT, 1.0SF, T3C, AMB 40°C.