

# DATA SHEET



## Three Phase Induction Motor - Squirrel Cage

Customer :				
Product line	: NEMA Premium Efficiency Three-Phase			
Product code :	12712069			
Catalog # :	01036ET3H215JP-W22			
Frame : 213/5JP Output : 10 HP (7.5 kW) Poles : 2 Frequency : 60 Hz Rated voltage : 575 V Rated current : 9.28 A L. R. Amperes : 66.8 A LRC : 7.2x(Code H) No load current : 2.72 A Rated speed : 3510 rpm Slip : 2.50 % Rated torque : 15.0 ft.lb Locked rotor torque : 220 % Breakdown torque : 290 % Insulation class : F Service factor : 1.25 Moment of inertia (J) : 0.6362 sq.ft.lb Design : B	Locked rotor time : 43s (cold) 24s (hot) Temperature rise : 80 K Duty cycle : Cont.(S1) Ambient temperature : -20°C to +40°C Altitude : 1000 m.a.s.l. Protection degree : IP55 Cooling method : IC411 - TEFC Mounting : F-1 Rotation <sup>1</sup> : Both (CW and CCW) Noise level <sup>2</sup> : 68.0 dB(A) Starting method : Direct On Line Approx. weight <sup>3</sup> : 169 lb			
Output	25%    50%    75%    100%			
Efficiency (%)	89.3    89.5    90.2    90.2			
Power Factor	0.54    0.79    0.87    0.90			
Foundation loads				
Max. traction	: 160 lb			
Max. compression	: 329 lb			
Bearing type	: <u>Drive end</u> 6309 Z C3 <u>Non drive end</u> 6207 ZZ			
Sealing	: V'Ring    V'Ring			
Lubrication interval	: 19000 h    40000 h			
Lubricant amount	: 13 g    0 g			
Lubricant type	: Mobil Polyrex EM			
Notes				
This revision replaces and cancel the previous one, which must be eliminated. (1) Looking the motor from the shaft end. (2) Measured at 1m and with tolerance of +3dB(A). (3) Approximate weight subject to changes after manufacturing process. (4) At 100% of full load.				
These are average values based on tests with sinusoidal power supply, subject to the tolerances stipulated in NEMA MG-1.				
Rev.	Changes Summary	Performed	Checked	Date
Performed by				
Checked by			Page	Revision
Date	12/04/2022		1 / 6	

# TORQUE AND CURRENT VS SPEED CURVE

## Three Phase Induction Motor - Squirrel Cage



Customer :

Product line : NEMA Premium Efficiency Three-Phase

Product code : 12712069

Catalog # : 01036ET3H215JP-W22

TORQUE AND CURRENT VS SPEED CURVE

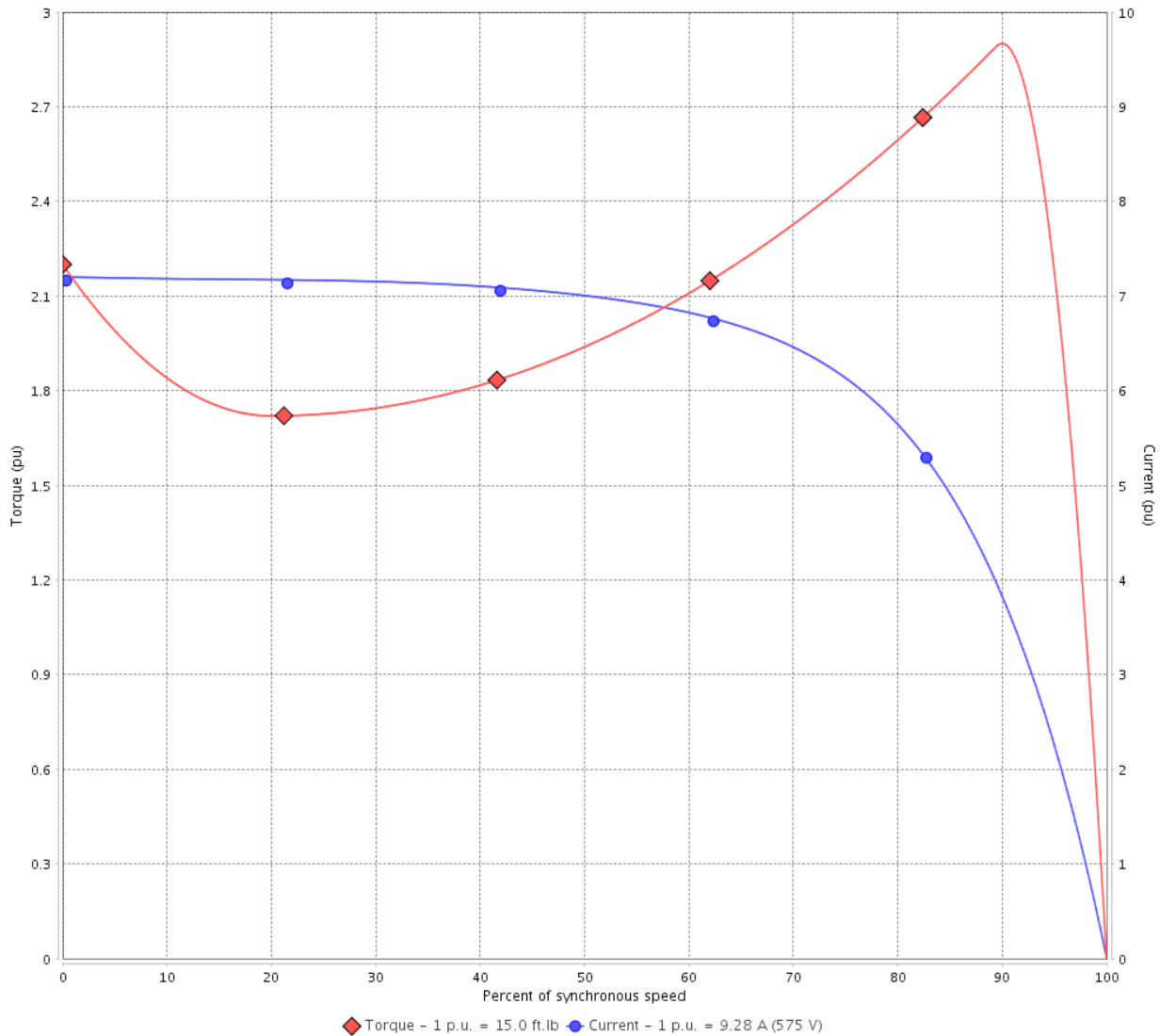

Performance : 575 V 60 Hz 2P

Rated current	: 9.28 A	Moment of inertia (J)	: 0.6362 sq.ft.lb
LRC	: 7.2	Duty cycle	: Cont.(S1)
Rated torque	: 15.0 ft.lb	Insulation class	: F
Locked rotor torque	: 220 %	Service factor	: 1.25
Breakdown torque	: 290 %	Temperature rise	: 80 K
Rated speed	: 3510 rpm	Design	: B

Locked rotor time : 43s (cold) 24s (hot)

Rev.	Changes Summary	Performed	Checked	Date
Performed by			Page 2 / 6	Revision
Checked by				
Date	12/04/2022			

# LOAD PERFORMANCE CURVE

## Three Phase Induction Motor - Squirrel Cage



Customer : \_\_\_\_\_

Product line : NEMA Premium Efficiency Three-Phase

Product code : 12712069

Catalog # : 01036ET3H215JP-W22

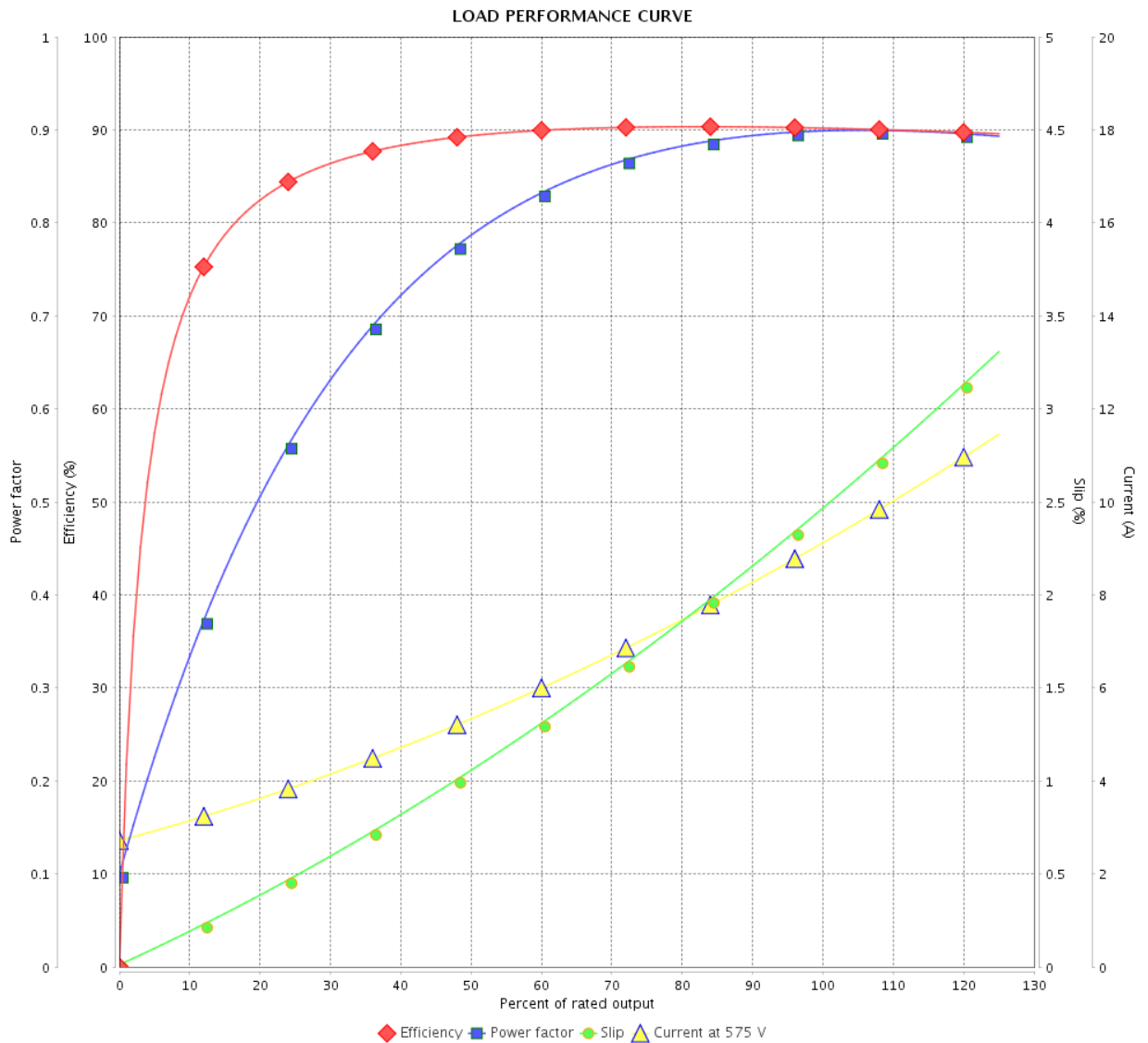

Performance : 575 V 60 Hz 2P

Rated current : 9.28 A  
 LRC : 7.2  
 Rated torque : 15.0 ft.lb  
 Locked rotor torque : 220 %  
 Breakdown torque : 290 %  
 Rated speed : 3510 rpm

Moment of inertia (J) : 0.6362 sq.ft.lb  
 Duty cycle : Cont.(S1)  
 Insulation class : F  
 Service factor : 1.25  
 Temperature rise : 80 K  
 Design : B

Rev.	Changes Summary	Performed	Checked	Date
Performed by		Page		Revision
Checked by		3 / 6		
Date		12/04/2022		

# THERMAL LIMIT CURVE



## Three Phase Induction Motor - Squirrel Cage

Customer :

Product line : NEMA Premium Efficiency Three-Phase  
 Product code : 12712069  
 Catalog # : 01036ET3H215JP-W22

Performance : 575 V 60 Hz 2P

Rated current : 9.28 A	Moment of inertia (J) : 0.6362 sq.ft.lb
LRC : 7.2	Duty cycle : Cont.(S1)
Rated torque : 15.0 ft.lb	Insulation class : F
Locked rotor torque : 220 %	Service factor : 1.25
Breakdown torque : 290 %	Temperature rise : 80 K
Rated speed : 3510 rpm	Design : B

Heating constant

Cooling constant

Rev.	Changes Summary	Performed	Checked	Date
Performed by			Page	Revision
Checked by				
Date	12/04/2022			

# THERMAL LIMIT CURVE

Three Phase Induction Motor - Squirrel Cage



Customer : \_\_\_\_\_

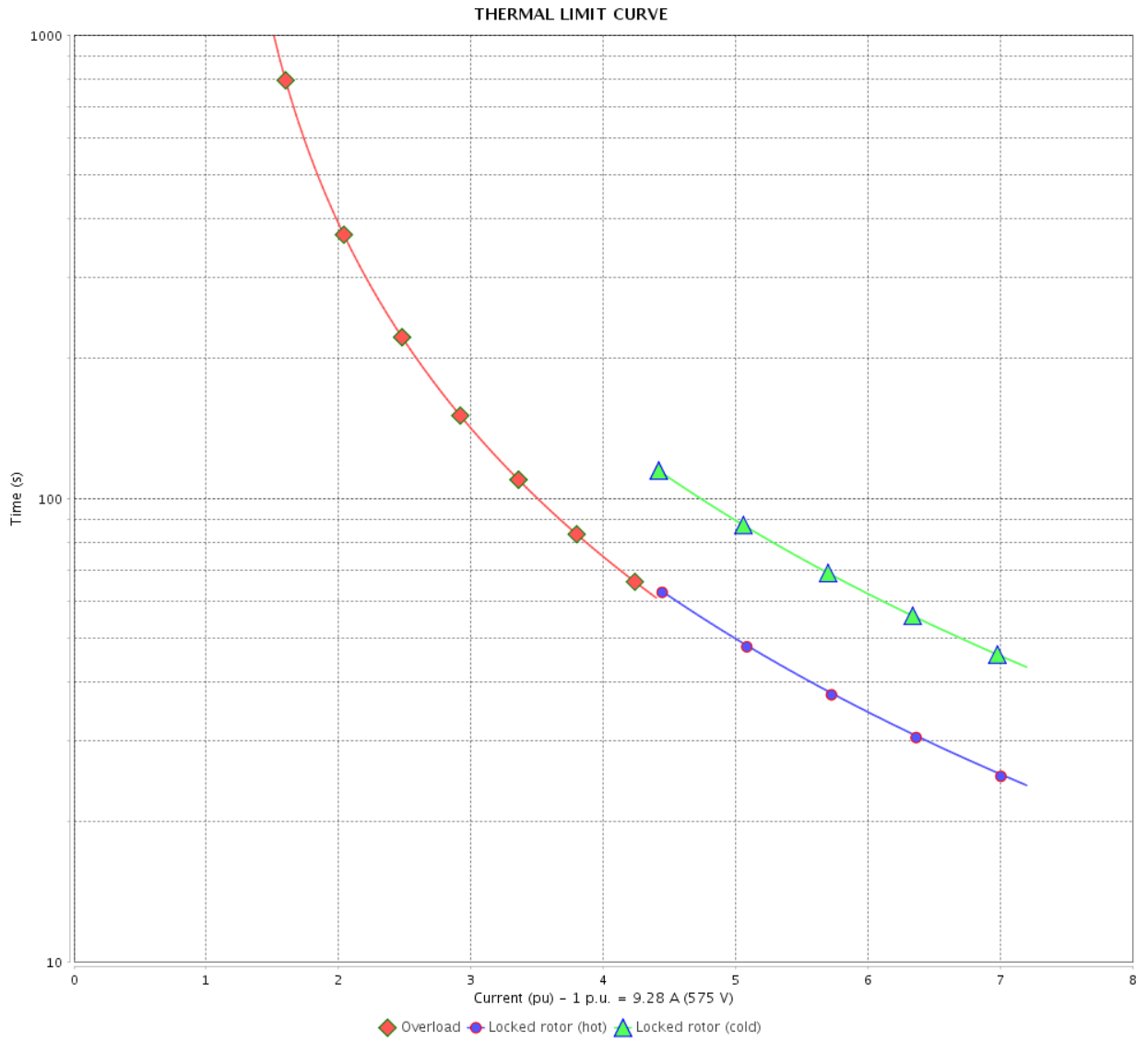

Rev.	Changes Summary	Performed	Checked	Date
Performed by		Page 5 / 6		Revision
Checked by				
Date				

# VFD OPERATION CURVE

Three Phase Induction Motor - Squirrel Cage



Customer :

Product line : NEMA Premium Efficiency Three-Phase

Product code : 12712069

Catalog # : 01036ET3H215JP-W22

VFD OPERATION CURVE

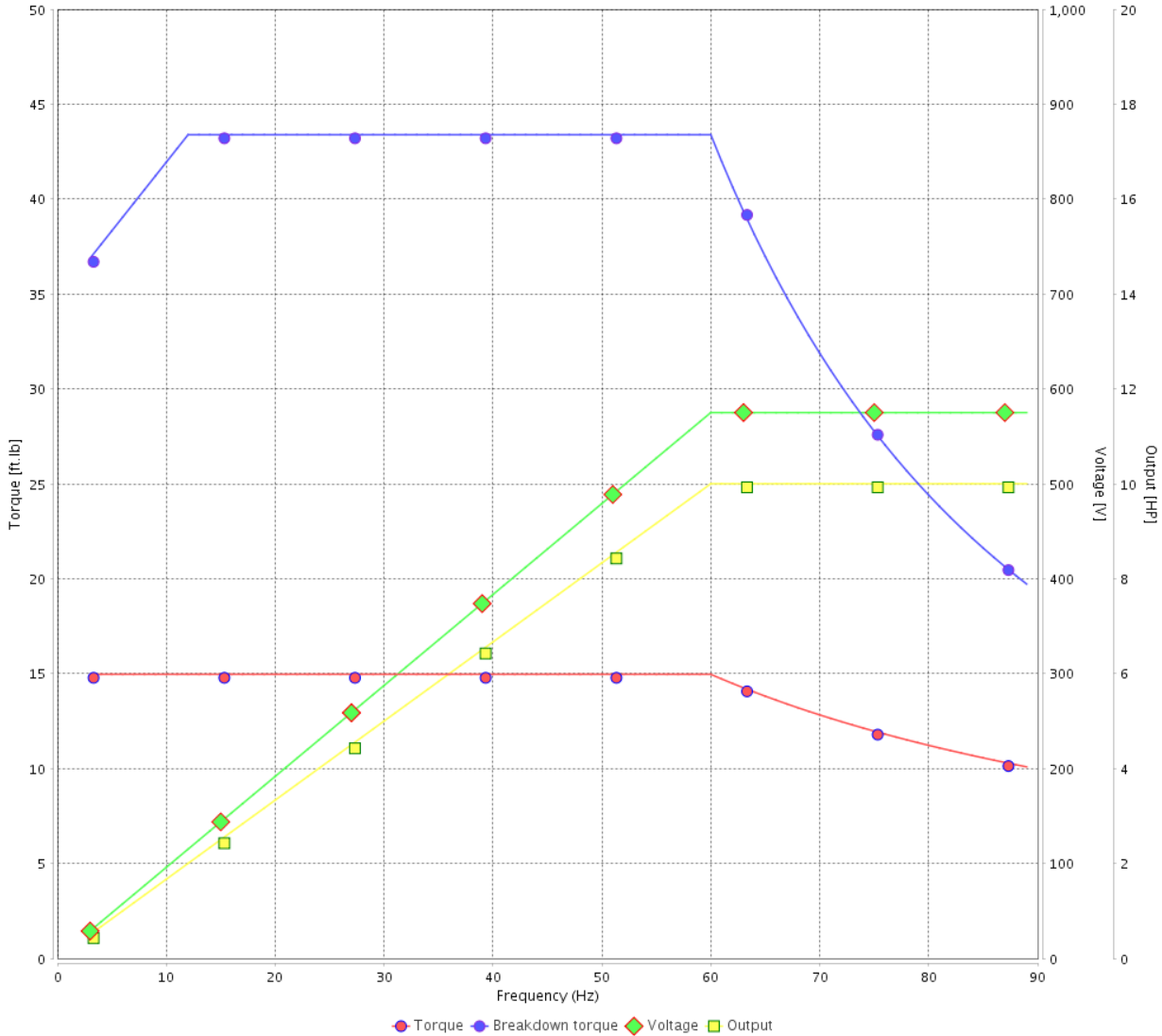

Performance : 575 V 60 Hz 2P

Rated current : 9.28 A  
 LRC : 7.2  
 Rated torque : 15.0 ft.lb  
 Locked rotor torque : 220 %  
 Breakdown torque : 290 %  
 Rated speed : 3510 rpm

Moment of inertia (J) : 0.6362 sq.ft.lb  
 Duty cycle : Cont.(S1)  
 Insulation class : F  
 Service factor : 1.25  
 Temperature rise : 80 K  
 Design : B

Rev.	Changes Summary	Performed	Checked	Date
Performed by			Page 6 / 6	Revision
Checked by				
Date	12/04/2022			

1 2 3 4 5 6

A

B

C

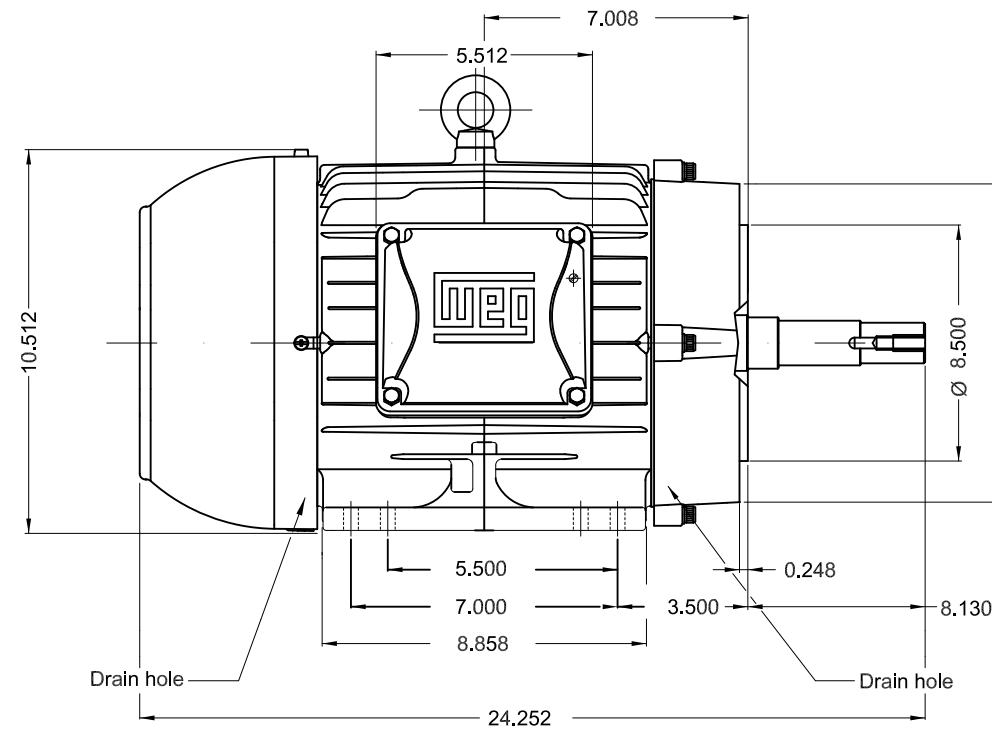
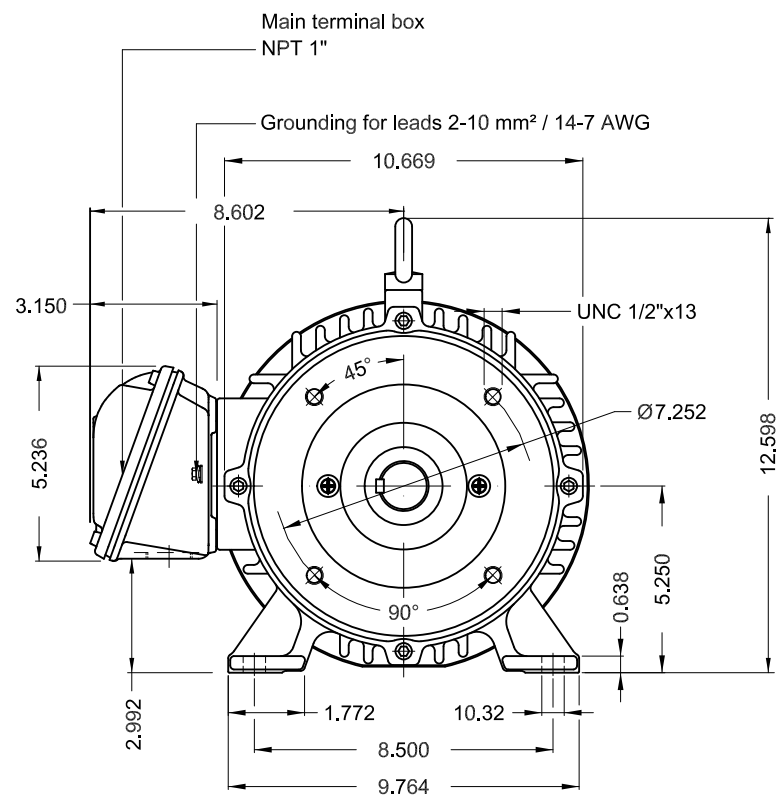

D

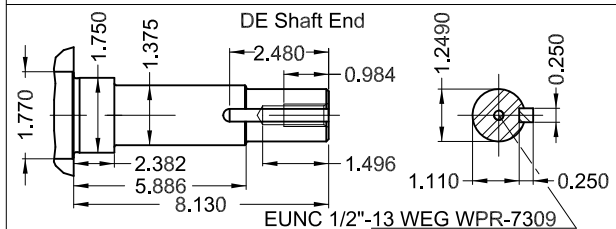

E

Color RAL 5009  
 Painting plan 207A  
 Mounting NEMA F-1  
 Mounting B34R(D)

10 HP 02 Poles 60 Hz A

ECM	LOC	SUMMARY OF MODIFICATIONS	EXECUTED	CHECKED	RELEASED	DATE	VER
EXECUTED	PIRWBUSER	THREE PH. MOTOR JM/JP/JET PUMP W22 PREM. EFF. FRAME 213/5JP IP55 TEFC					
CHECKED							
RELEASED							
REL DT.	WMO		Jaragua do Sul	Product Engineering	SHEET	1 / 1	

**PREVIEW**  
 WDD



**W22**

CC029A

® Inverter Duty Motor  
Severe Duty

12712069

MADE IN BRAZIL MODEL 01036ET3H215JP-W22

PH 3	FR 213/5JP	HP(kW) 10(7.5)	Hz 60	SF 1.25	PF 0.90
V 575	A 9.28	RPM 3530	INS. CL.F $\Delta$ T 80 K		
NEMA NOM EFF 90.2 %				DES B	DUTY CONT.
ENCL TEFC			IP55	SFA 11.6	ALT 1000 m.a.s.l.
					CODE H

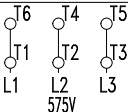

MOBIL POLYREX EM  
13 g 19000 h

183 Lbs

Class I, Div 2, Gr. A, B, C and D - T3  
 Class I, Zone 2, IIC - T3  
 Class II, Div 2, Gr. F and G - T4  
 For use on PWM, Gr. A, B, C, D and F  
 VT 1000:1, CT 20:1, 1.0SF, T3A



FOR SAFE AREA  
MOD.TE1BFOXON