

# DATA SHEET

## Three Phase Induction Motor - Squirrel Cage



Customer :					
Product line	: W40 JP Pump NEMA Premium Efficiency Three-Phase	Product code :	14485159		
		Catalog # :	02018OT3E256JP-W40		
Frame	: 254/6JP	Cooling method	: IC01 - ODP		
Insulation class	: F	Mounting	: F-1		
Duty cycle	: Cont.(S1)	Rotation <sup>1</sup>	: Both (CW and CCW)		
Ambient temperature	: -20°C to +40°C	Starting method	: Direct On Line		
Altitude	: 1000 m.a.s.l.	Approx. weight <sup>2</sup>	: 305 lb		
Protection degree	: IP23	Moment of inertia (J)	: 3.13 sq.ft.lb		
Design	: B				
Output [HP]	20	15	15	15	
Poles	4	4	4	4	
Frequency [Hz]	60	50	50	50	
Rated voltage [V]	230/460	380	400	415	
Rated current [A]	48.2/24.1	22.0	21.4	21.2	
L. R. Amperes [A]	308/154	154	156	155	
LRC [A]	6.4x(Code G)	7.0x(Code H)	7.3x(Code J)	7.3x(Code J)	
No load current [A]	20.0/10.0	9.90	10.7	11.3	
Rated speed [RPM]	1770	1475	1480	1480	
Slip [%]	1.67	1.67	1.33	1.33	
Rated torque [ft.lb]	59.3	53.4	53.2	53.2	
Locked rotor torque [%]	220	250	240	290	
Breakdown torque [%]	250	270	300	330	
Service factor	1.25	1.00	1.00	1.00	
Temperature rise	80 K	80 K	80 K	80 K	
Locked rotor time	46s (cold) 26s (hot)	61s (cold) 34s (hot)	52s (cold) 29s (hot)	46s (cold) 26s (hot)	
Noise level <sup>2</sup>	62.0 dB(A)				
Efficiency (%)	25%	92.2	90.9	91.0	91.0
	50%	92.4	91.1	91.1	91.1
	75%	93.0	91.5	91.5	91.5
	100%	93.0	91.5	91.5	91.5
Power Factor	25%	0.43	0.40	0.37	0.34
	50%	0.69	0.66	0.62	0.59
	75%	0.79	0.77	0.74	0.72
	100%	0.84	0.83	0.81	0.79
Bearing type	: Drive end : 6309 Z C3	Non drive end : 6209 Z C3	Foundation loads		
Sealing	: Without	Without	Max. traction		
	Bearing Seal	Bearing Seal	Max. compression		
Lubrication interval	: 20000 h	20000 h			
Lubricant amount	: 13 g	9 g			
Lubricant type	: Mobil Polyrex EM				
Notes USABLE @208V 53.3A SF 1.15 SFA 61.3A					
This revision replaces and cancel the previous one, which must be eliminated. (1) Looking the motor from the shaft end. (2) Measured at 1m and with tolerance of +3dB(A). (3) Approximate weight subject to changes after manufacturing process. (4) At 100% of full load.			These are average values based on tests with sinusoidal power supply, subject to the tolerances stipulated in NEMA MG-1.		
Rev.	Changes Summary		Performed	Checked	Date
Performed by					
Checked by				Page	Revision
Date	14/04/2022			1 / 21	

# TORQUE AND CURRENT VS SPEED CURVE

Three Phase Induction Motor - Squirrel Cage



Customer :

Product line : W40 JP Pump NEMA Premium Efficiency Three-Phase

Product code : 14485159

Catalog # : 02018OT3E256JP-W40

TORQUE AND CURRENT VS SPEED CURVE

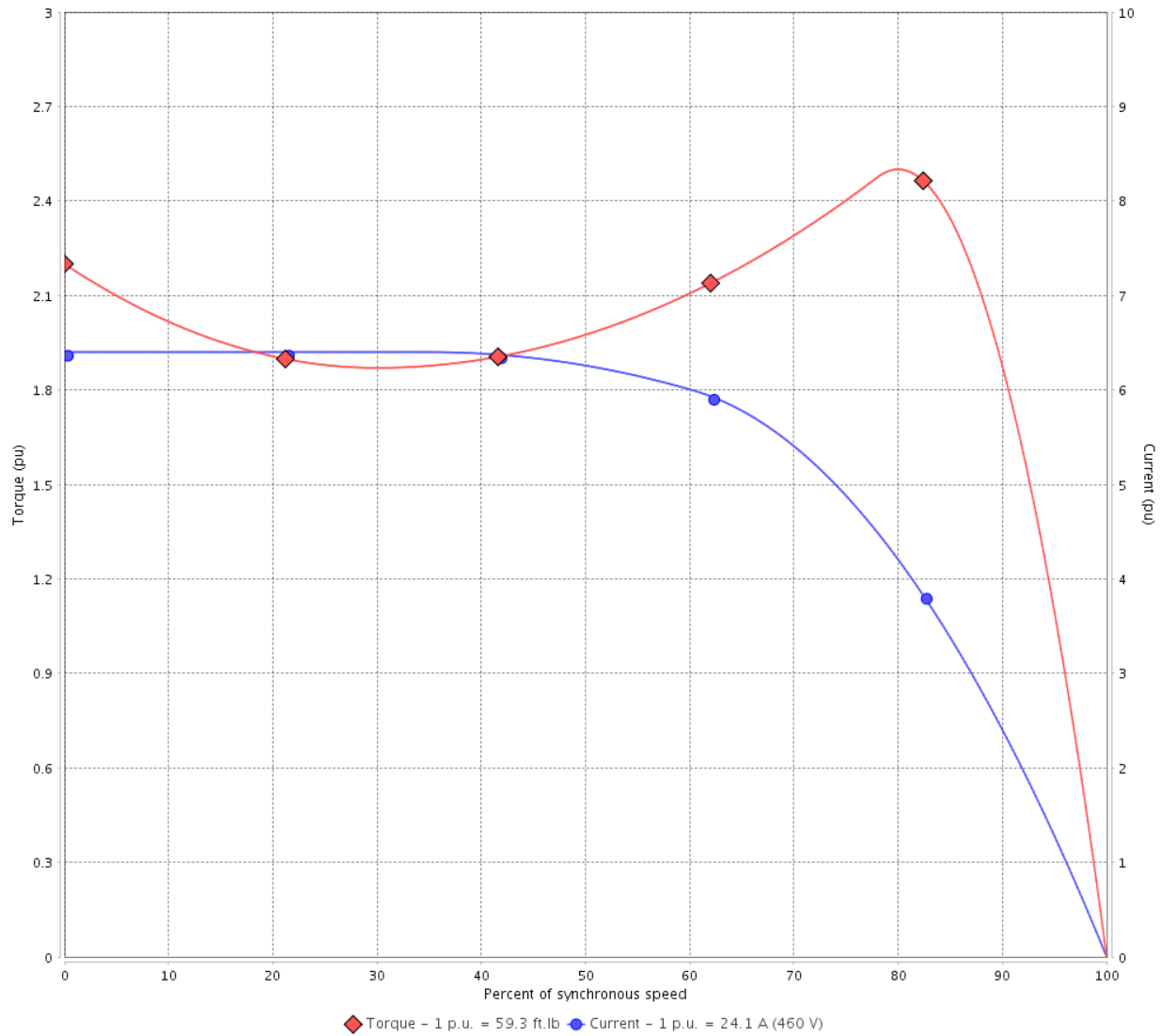

Performance : 230/460 V 60 Hz 4P

Rated current	: 48.2/24.1 A	Moment of inertia (J)	: 3.13 sq.ft.lb
LRC	: 6.4	Duty cycle	: Cont.(S1)
Rated torque	: 59.3 ft.lb	Insulation class	: F
Locked rotor torque	: 220 %	Service factor	: 1.25
Breakdown torque	: 250 %	Temperature rise	: 80 K
Rated speed	: 1770 rpm	Design	: B

Locked rotor time : 46s (cold) 26s (hot)

Rev.	Changes Summary	Performed	Checked	Date
Performed by		Page		Revision
Checked by		2 / 21		
Date	14/04/2022			

# TORQUE AND CURRENT VS SPEED CURVE



## Three Phase Induction Motor - Squirrel Cage

Customer :

Product line : W40 JP Pump NEMA Premium Efficiency Three-Phase

Product code : 14485159

Catalog # : 02018OT3E256JP-W40

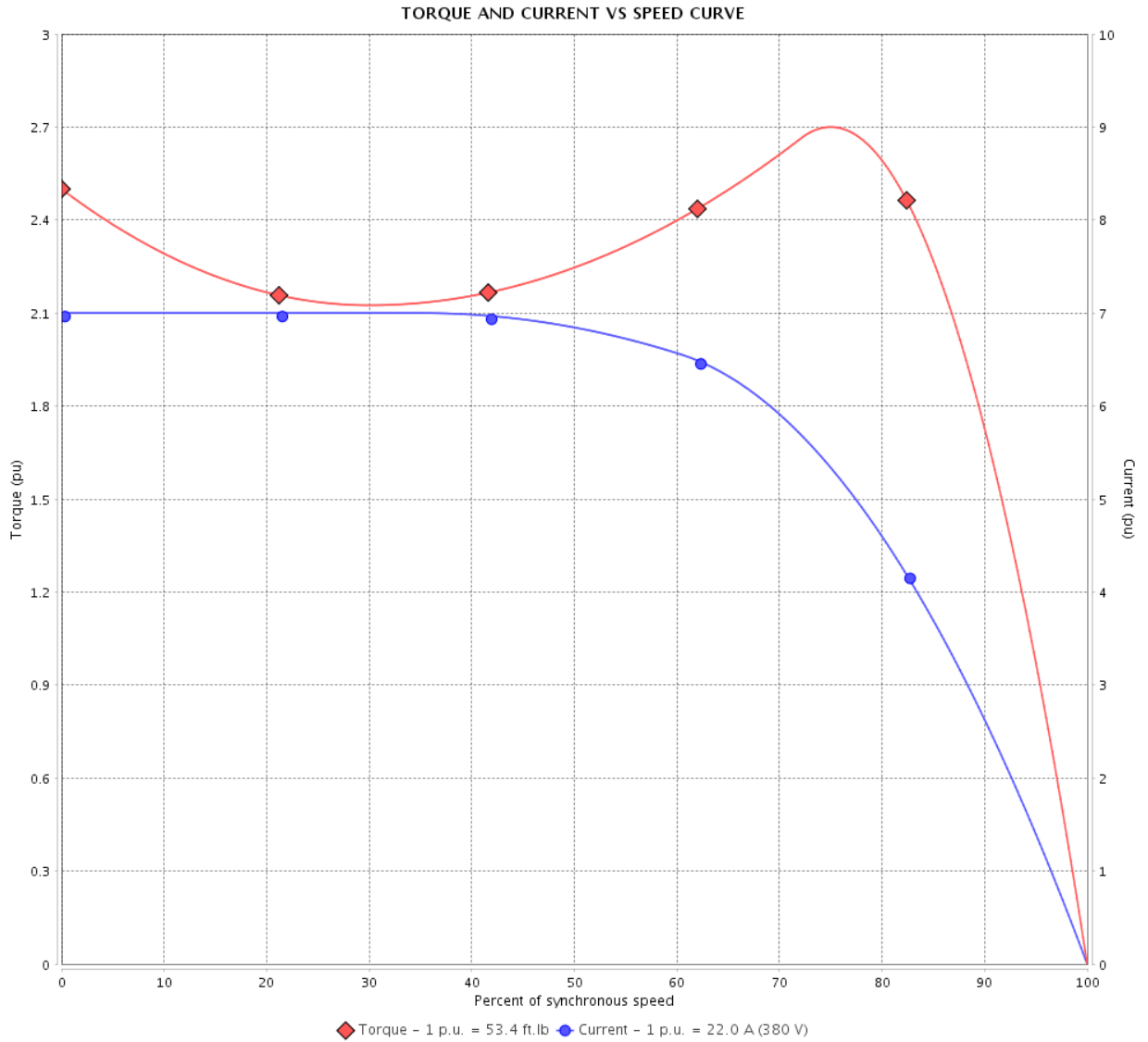

Performance : 380 V 50 Hz 4P IE3

Rated current	: 22.0 A	Moment of inertia (J)	: 3.13 sq.ft.lb
LRC	: 7.0	Duty cycle	: Cont.(S1)
Rated torque	: 53.4 ft.lb	Insulation class	: F
Locked rotor torque	: 250 %	Service factor	: 1.00
Breakdown torque	: 270 %	Temperature rise	: 80 K
Rated speed	: 1475 rpm	Design	: B

Locked rotor time : 61s (cold) 34s (hot)

Rev.	Changes Summary	Performed	Checked	Date
Performed by			Page 3 / 21	Revision
Checked by				
Date	14/04/2022			

# TORQUE AND CURRENT VS SPEED CURVE

## Three Phase Induction Motor - Squirrel Cage



Customer :

Product line : W40 JP Pump NEMA Premium Efficiency Three-Phase

Product code : 14485159

Catalog # : 02018OT3E256JP-W40

TORQUE AND CURRENT VS SPEED CURVE

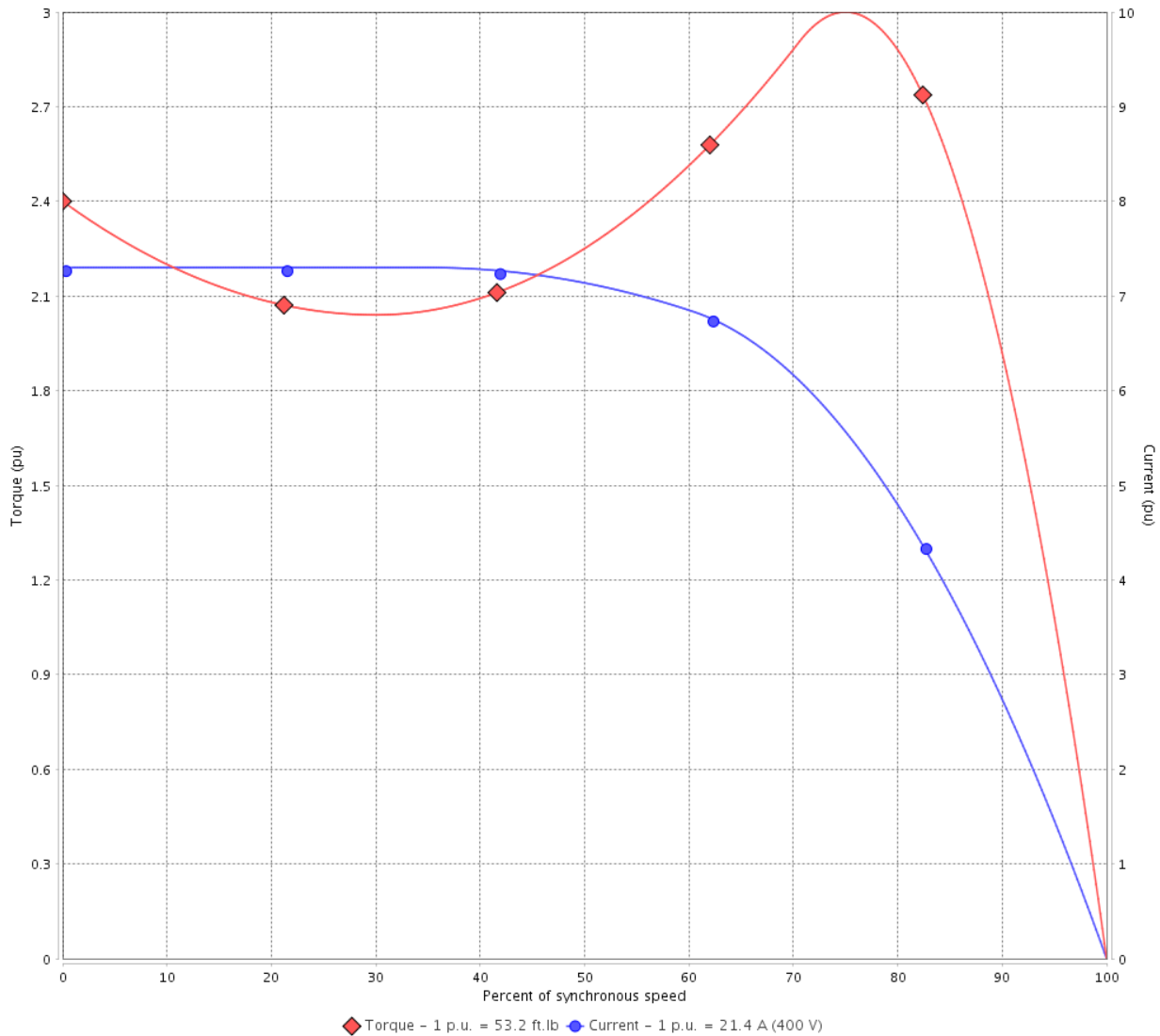

Performance : 400 V 50 Hz 4P IE3

Rated current	: 21.4 A	Moment of inertia (J)	: 3.13 sq.ft.lb
LRC	: 7.3	Duty cycle	: Cont.(S1)
Rated torque	: 53.2 ft.lb	Insulation class	: F
Locked rotor torque	: 240 %	Service factor	: 1.00
Breakdown torque	: 300 %	Temperature rise	: 80 K
Rated speed	: 1480 rpm	Design	: B

Locked rotor time : 52s (cold) 29s (hot)

Rev.	Changes Summary	Performed	Checked	Date
Performed by			Page 4 / 21	Revision
Checked by				
Date	14/04/2022			

# TORQUE AND CURRENT VS SPEED CURVE



## Three Phase Induction Motor - Squirrel Cage

Customer :

Product line : W40 JP Pump NEMA Premium Efficiency Three-Phase

Product code : 14485159

Catalog # : 02018OT3E256JP-W40

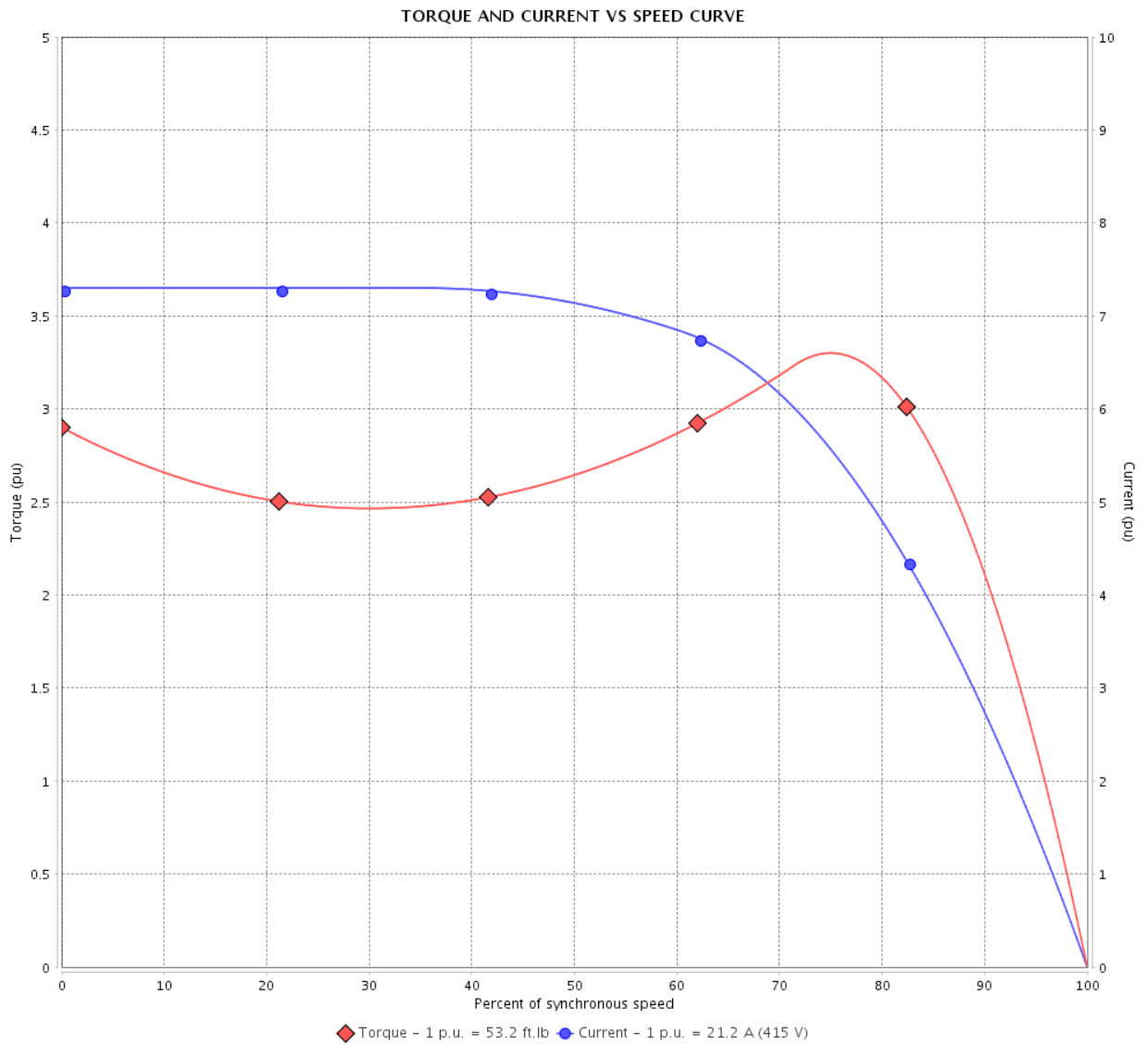

Performance : 415 V 50 Hz 4P IE3

Rated current	: 21.2 A	Moment of inertia (J)	: 3.13 sq.ft.lb
LRC	: 7.3	Duty cycle	: Cont.(S1)
Rated torque	: 53.2 ft.lb	Insulation class	: F
Locked rotor torque	: 290 %	Service factor	: 1.00
Breakdown torque	: 330 %	Temperature rise	: 80 K
Rated speed	: 1480 rpm	Design	: B

Locked rotor time : 46s (cold) 26s (hot)

Rev.	Changes Summary	Performed	Checked	Date
Performed by			Page	Revision
Checked by				
Date	14/04/2022			
			5 / 21	

# LOAD PERFORMANCE CURVE

Three Phase Induction Motor - Squirrel Cage



Customer :

Product line : W40 JP Pump NEMA Premium Efficiency Three-Phase

Product code : 14485159

Catalog # : 02018OT3E256JP-W40

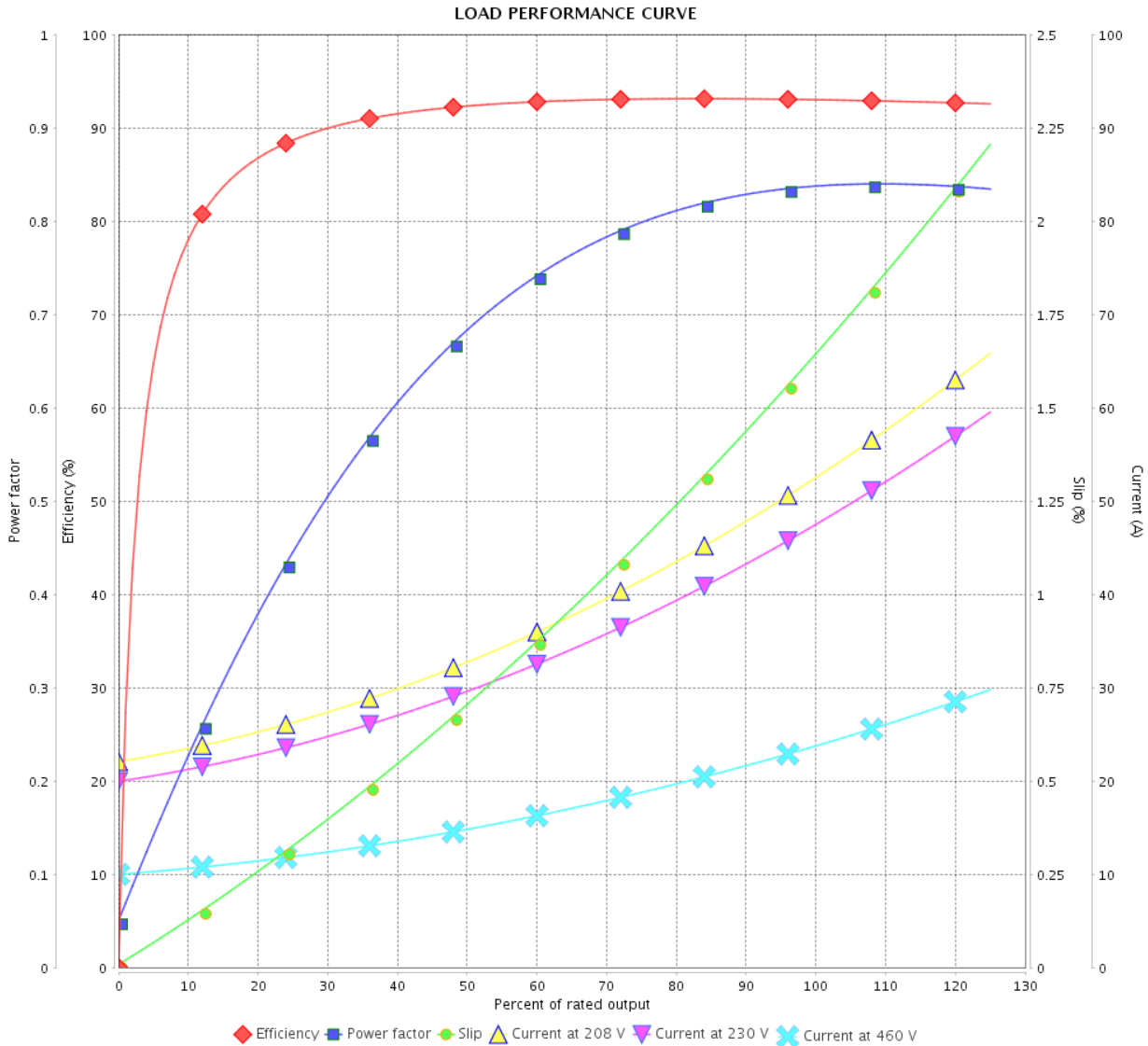

Performance : 230/460 V 60 Hz 4P

Rated current : 48.2/24.1 A  
 LRC : 6.4  
 Rated torque : 59.3 ft.lb  
 Locked rotor torque : 220 %  
 Breakdown torque : 250 %  
 Rated speed : 1770 rpm

Moment of inertia (J) : 3.13 sq.ft.lb  
 Duty cycle : Cont.(S1)  
 Insulation class : F  
 Service factor : 1.25  
 Temperature rise : 80 K  
 Design : B

Rev.	Changes Summary	Performed	Checked	Date
Performed by			Page 6 / 21	Revision
Checked by				
Date	14/04/2022			

# LOAD PERFORMANCE CURVE

## Three Phase Induction Motor - Squirrel Cage



Customer :

Product line : W40 JP Pump NEMA Premium Efficiency Three-Phase

Product code : 14485159

Catalog # : 02018OT3E256JP-W40

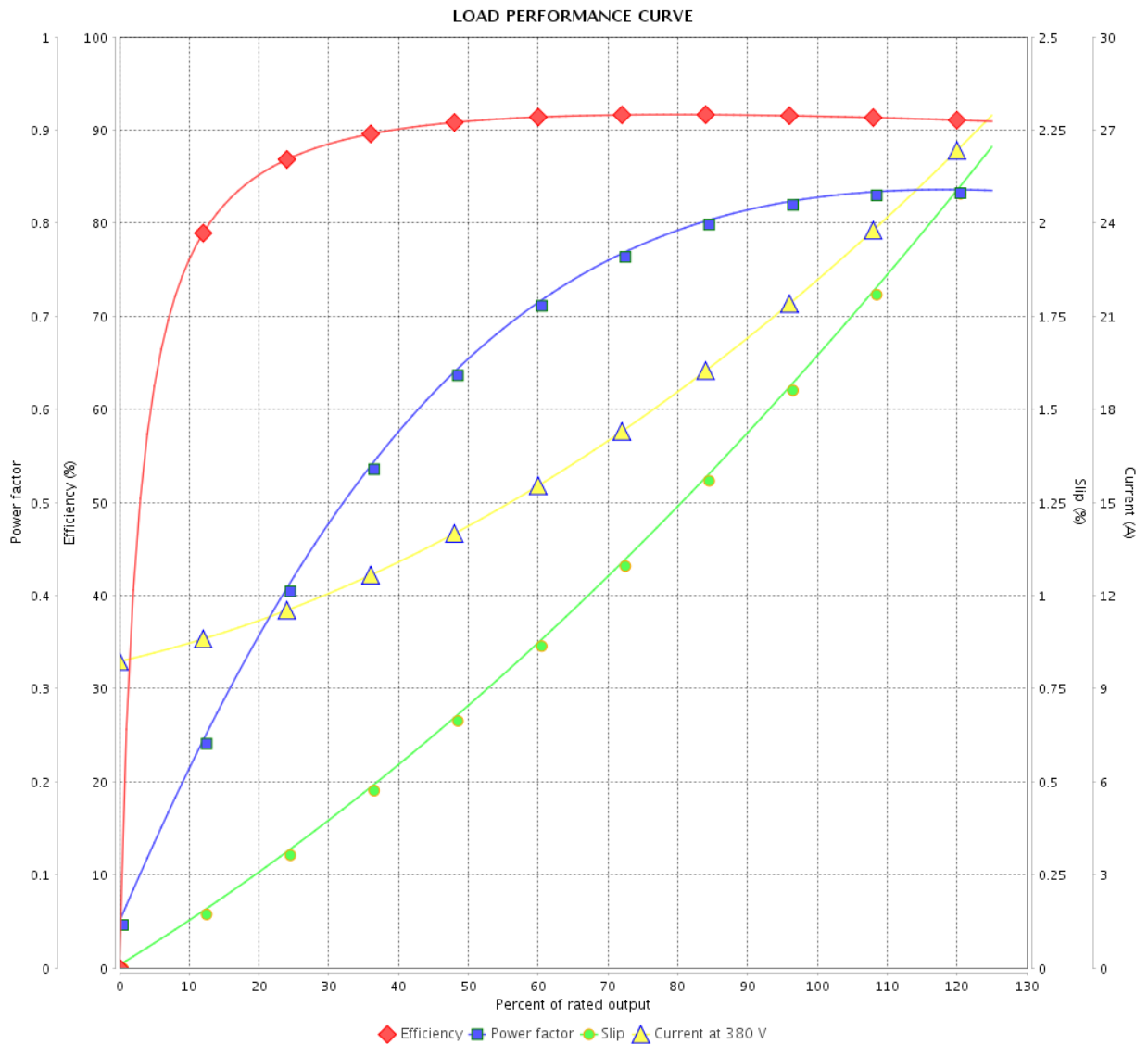

Performance : 380 V 50 Hz 4P IE3

Rated current : 22.0 A  
 LRC : 7.0  
 Rated torque : 53.4 ft.lb  
 Locked rotor torque : 250 %  
 Breakdown torque : 270 %  
 Rated speed : 1475 rpm

Moment of inertia (J) : 3.13 sq.ft.lb  
 Duty cycle : Cont.(S1)  
 Insulation class : F  
 Service factor : 1.00  
 Temperature rise : 80 K  
 Design : B

Rev.	Changes Summary	Performed	Checked	Date
Performed by			Page	Revision
Checked by				
Date				

# LOAD PERFORMANCE CURVE

Three Phase Induction Motor - Squirrel Cage



Customer :

Product line : W40 JP Pump NEMA Premium  
Efficiency Three-Phase

Product code : 14485159

Catalog # : 02018OT3E256JP-W40

LOAD PERFORMANCE CURVE

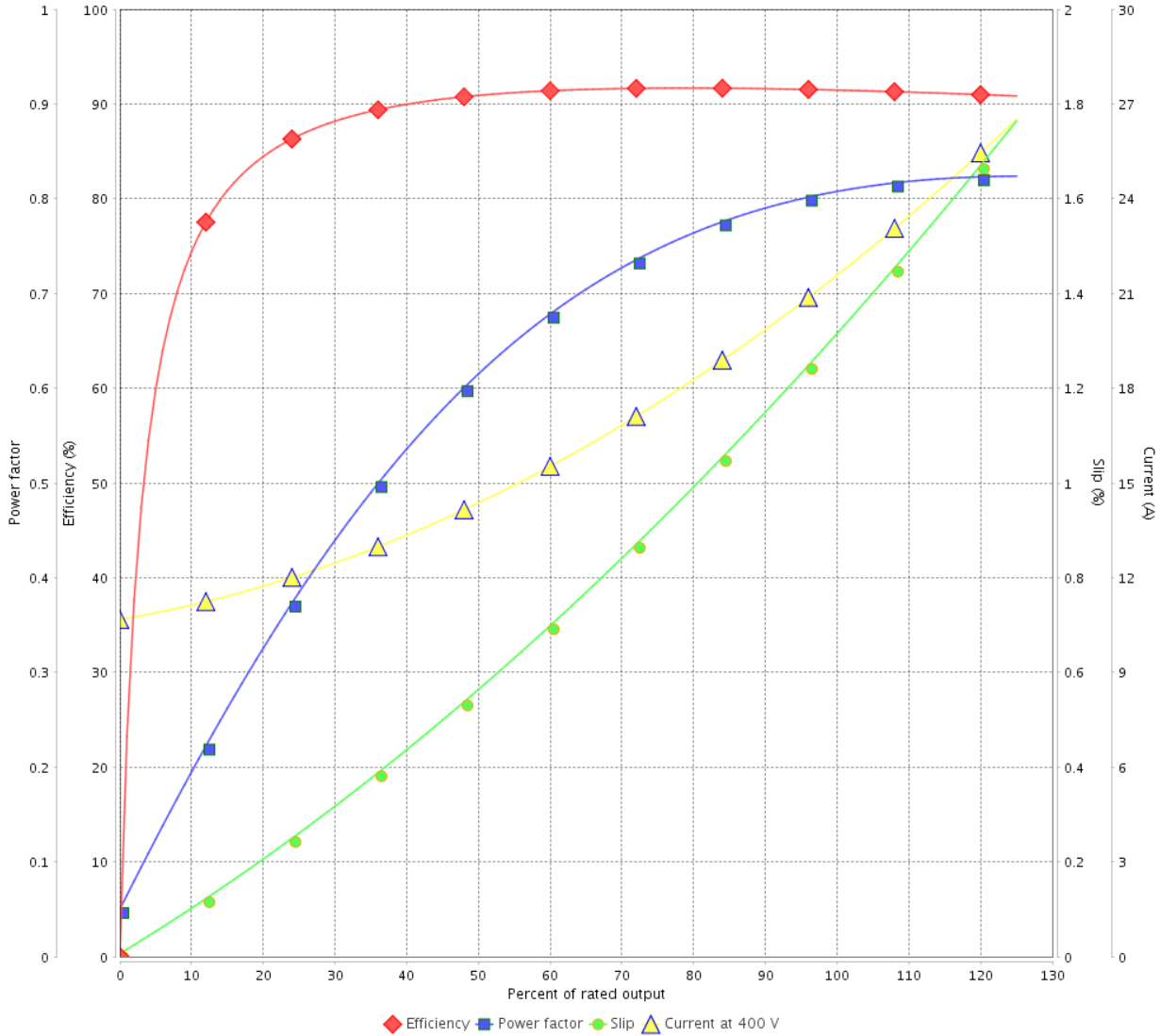

Performance : 400 V 50 Hz 4P IE3

Rated current : 21.4 A  
LRC : 7.3  
Rated torque : 53.2 ft.lb  
Locked rotor torque : 240 %  
Breakdown torque : 300 %  
Rated speed : 1480 rpm

Moment of inertia (J) : 3.13 sq.ft.lb  
Duty cycle : Cont.(S1)  
Insulation class : F  
Service factor : 1.00  
Temperature rise : 80 K  
Design : B

Rev.	Changes Summary	Performed	Checked	Date
Performed by		Page		Revision
Checked by		8 / 21		
Date	14/04/2022			



# LOAD PERFORMANCE CURVE

## Three Phase Induction Motor - Squirrel Cage



Customer :

Product line : W40 JP Pump NEMA Premium Efficiency Three-Phase

Product code : 14485159

Catalog # : 02018OT3E256JP-W40

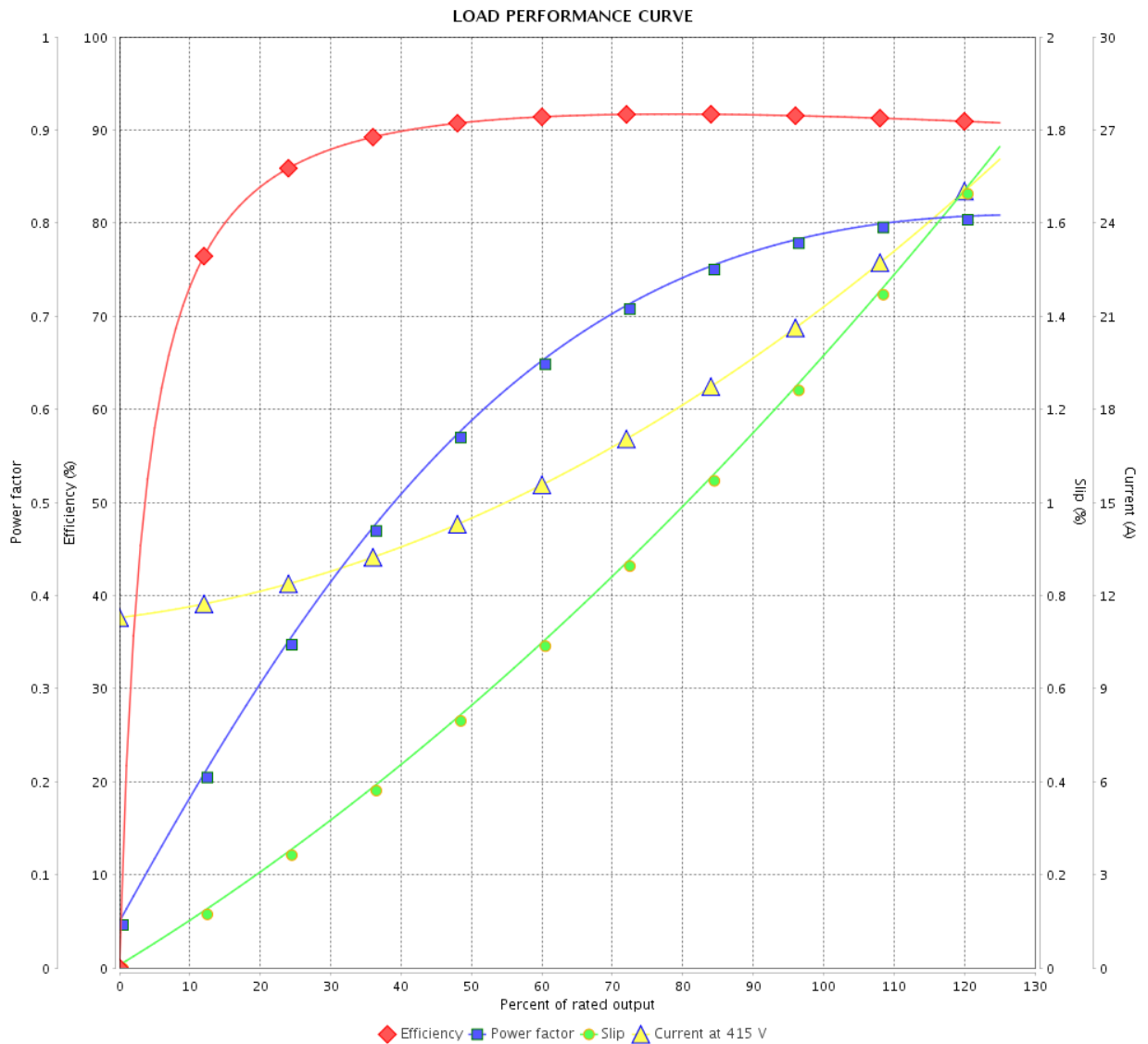

Performance : 415 V 50 Hz 4P IE3

Rated current : 21.2 A  
 LRC : 7.3  
 Rated torque : 53.2 ft.lb  
 Locked rotor torque : 290 %  
 Breakdown torque : 330 %  
 Rated speed : 1480 rpm

Moment of inertia (J) : 3.13 sq.ft.lb  
 Duty cycle : Cont.(S1)  
 Insulation class : F  
 Service factor : 1.00  
 Temperature rise : 80 K  
 Design : B

Rev.	Changes Summary	Performed	Checked	Date
Performed by				
Checked by				
Date				
		Page	Revision	
		9 / 21		

# THERMAL LIMIT CURVE



## Three Phase Induction Motor - Squirrel Cage

Customer :

Product line : W40 JP Pump NEMA Premium  
Efficiency Three-Phase

Product code : 14485159

Catalog # : 02018OT3E256JP-W40

Performance : 230/460 V 60 Hz 4P

Rated current : 48.2/24.1 A  
LRC : 6.4  
Rated torque : 59.3 ft.lb  
Locked rotor torque : 220 %  
Breakdown torque : 250 %  
Rated speed : 1770 rpm

Moment of inertia (J) : 3.13 sq.ft.lb  
Duty cycle : Cont.(S1)  
Insulation class : F  
Service factor : 1.25  
Temperature rise : 80 K  
Design : B

Heating constant

Cooling constant

Rev.	Changes Summary	Performed	Checked	Date
Performed by				
Checked by			Page	Revision
Date	14/04/2022		10 / 21	

# THERMAL LIMIT CURVE

Three Phase Induction Motor - Squirrel Cage



Customer : \_\_\_\_\_

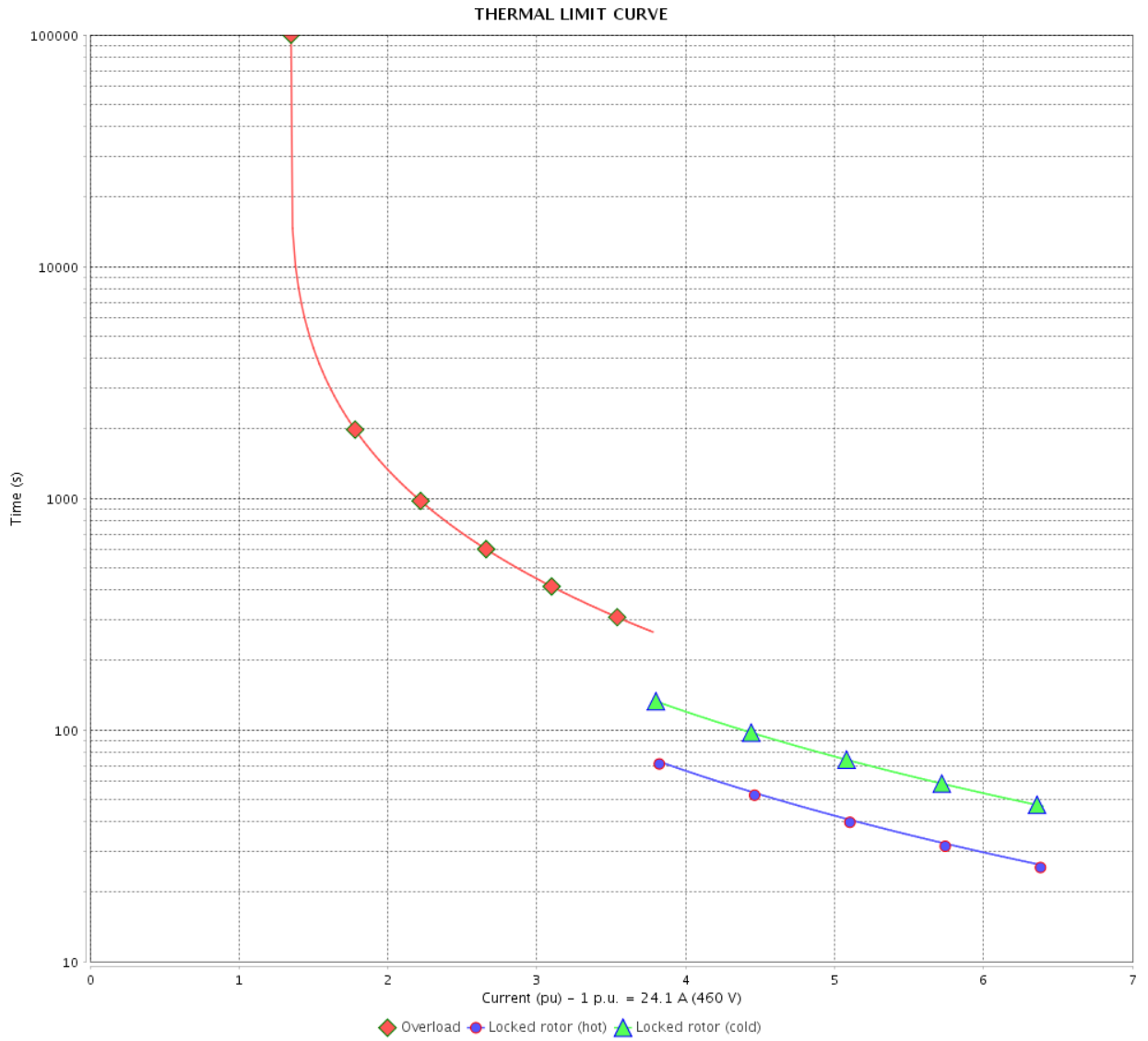

Rev.	Changes Summary	Performed	Checked	Date
Performed by		Page		Revision
Checked by		11 / 21		
Date		14/04/2022		

# THERMAL LIMIT CURVE



## Three Phase Induction Motor - Squirrel Cage

Customer :

Product line : W40 JP Pump NEMA Premium  
Efficiency Three-Phase

Product code : 14485159

Catalog # : 02018OT3E256JP-W40

Performance : 380 V 50 Hz 4P IE3

Rated current	: 22.0 A	Moment of inertia (J)	: 3.13 sq.ft.lb
LRC	: 7.0	Duty cycle	: Cont.(S1)
Rated torque	: 53.4 ft.lb	Insulation class	: F
Locked rotor torque	: 250 %	Service factor	: 1.00
Breakdown torque	: 270 %	Temperature rise	: 80 K
Rated speed	: 1475 rpm	Design	: B

Heating constant

Cooling constant

Rev.	Changes Summary	Performed	Checked	Date
Performed by				
Checked by			Page	Revision
Date	14/04/2022		12 / 21	

# THERMAL LIMIT CURVE

Three Phase Induction Motor - Squirrel Cage



Customer : \_\_\_\_\_

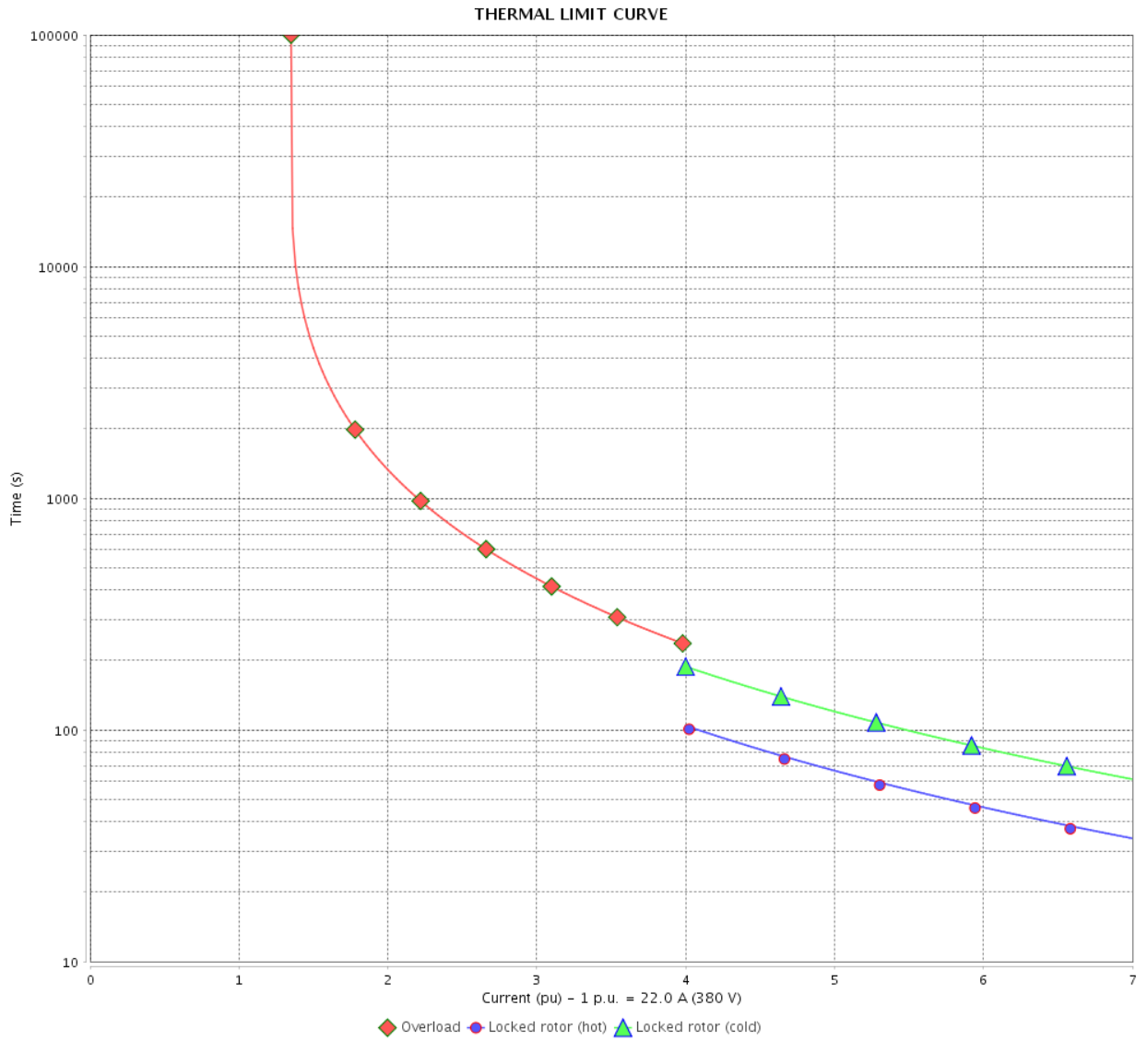

Rev.	Changes Summary	Performed	Checked	Date
Performed by		Page		Revision
Checked by		13 / 21		
Date		14/04/2022		

# THERMAL LIMIT CURVE

## Three Phase Induction Motor - Squirrel Cage



Customer :

Product line : W40 JP Pump NEMA Premium  
Efficiency Three-Phase

Product code : 14485159

Catalog # : 02018OT3E256JP-W40

Performance : 400 V 50 Hz 4P IE3

Rated current	: 21.4 A	Moment of inertia (J)	: 3.13 sq.ft.lb
LRC	: 7.3	Duty cycle	: Cont.(S1)
Rated torque	: 53.2 ft.lb	Insulation class	: F
Locked rotor torque	: 240 %	Service factor	: 1.00
Breakdown torque	: 300 %	Temperature rise	: 80 K
Rated speed	: 1480 rpm	Design	: B

Heating constant

Cooling constant

Rev.	Changes Summary	Performed	Checked	Date
Performed by				
Checked by			Page	Revision
Date	14/04/2022		14 / 21	

# THERMAL LIMIT CURVE

Three Phase Induction Motor - Squirrel Cage



Customer : \_\_\_\_\_

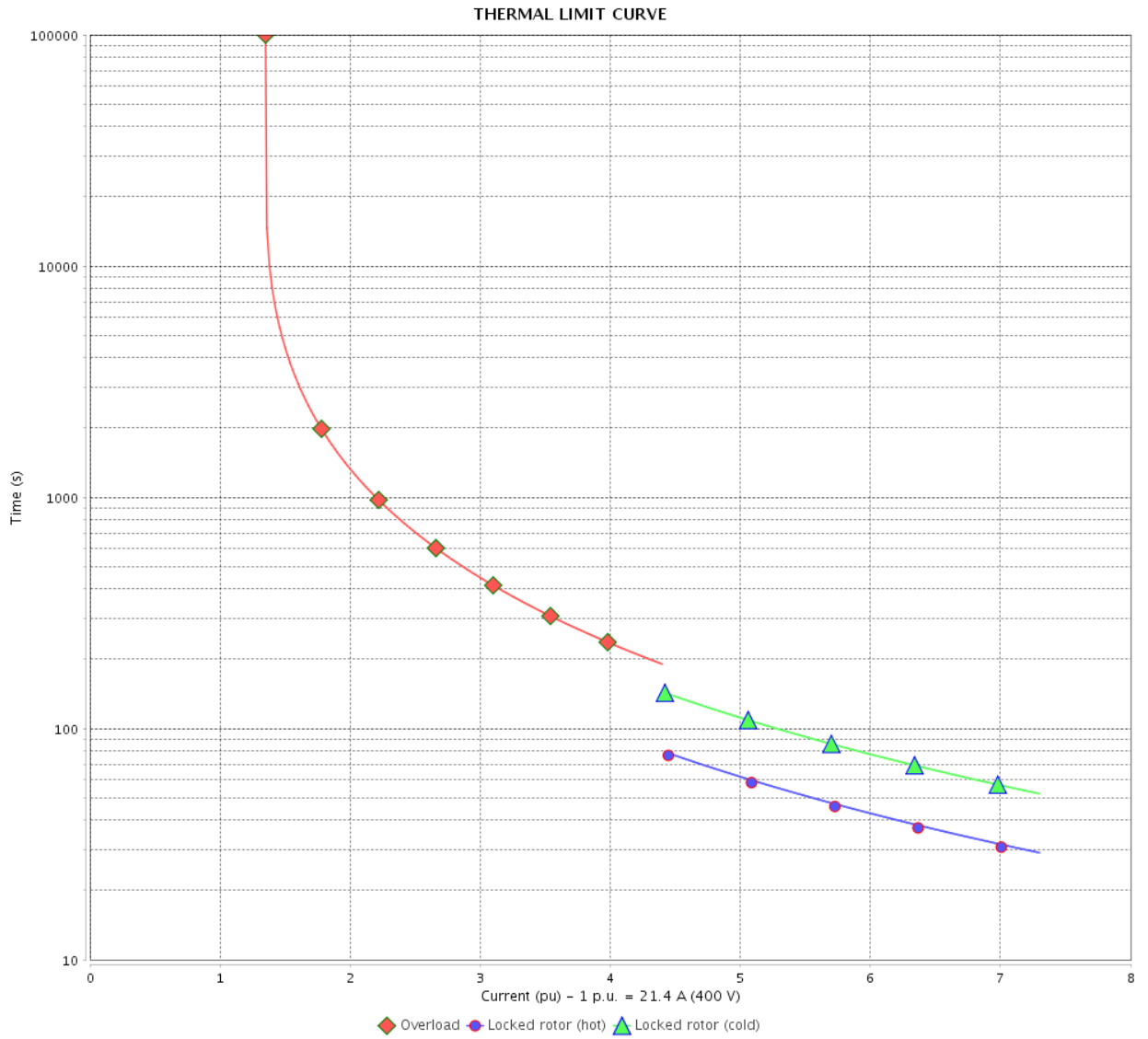

Rev.	Changes Summary	Performed	Checked	Date
Performed by				
Checked by				
Date				
			Page	Revision
			15 / 21	

# THERMAL LIMIT CURVE



## Three Phase Induction Motor - Squirrel Cage

Customer :

Product line : W40 JP Pump NEMA Premium  
Efficiency Three-Phase

Product code : 14485159

Catalog # : 02018OT3E256JP-W40

Performance : 415 V 50 Hz 4P IE3

Rated current	: 21.2 A	Moment of inertia (J)	: 3.13 sq.ft.lb
LRC	: 7.3	Duty cycle	: Cont.(S1)
Rated torque	: 53.2 ft.lb	Insulation class	: F
Locked rotor torque	: 290 %	Service factor	: 1.00
Breakdown torque	: 330 %	Temperature rise	: 80 K
Rated speed	: 1480 rpm	Design	: B

Heating constant

Cooling constant

Rev.	Changes Summary	Performed	Checked	Date
Performed by				
Checked by			Page	Revision
Date	14/04/2022		16 / 21	



# THERMAL LIMIT CURVE

Three Phase Induction Motor - Squirrel Cage



Customer : \_\_\_\_\_

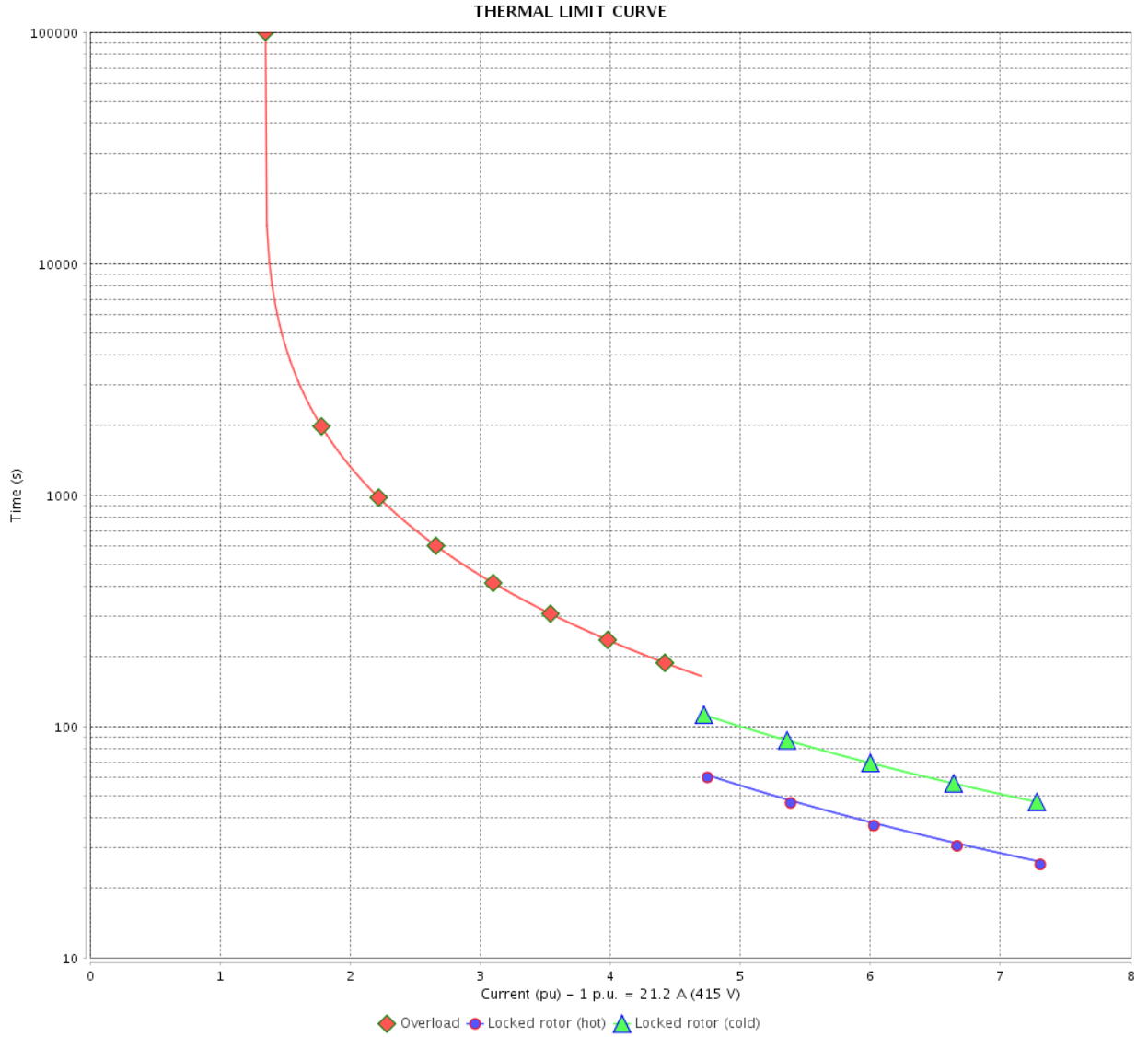

Rev.	Changes Summary	Performed	Checked	Date
Performed by		Page 17 / 21		Revision
Checked by				
Date				

# VFD OPERATION CURVE

Three Phase Induction Motor - Squirrel Cage



Customer :

Product line : W40 JP Pump NEMA Premium Efficiency Three-Phase

Product code : 14485159

Catalog # : 02018OT3E256JP-W40

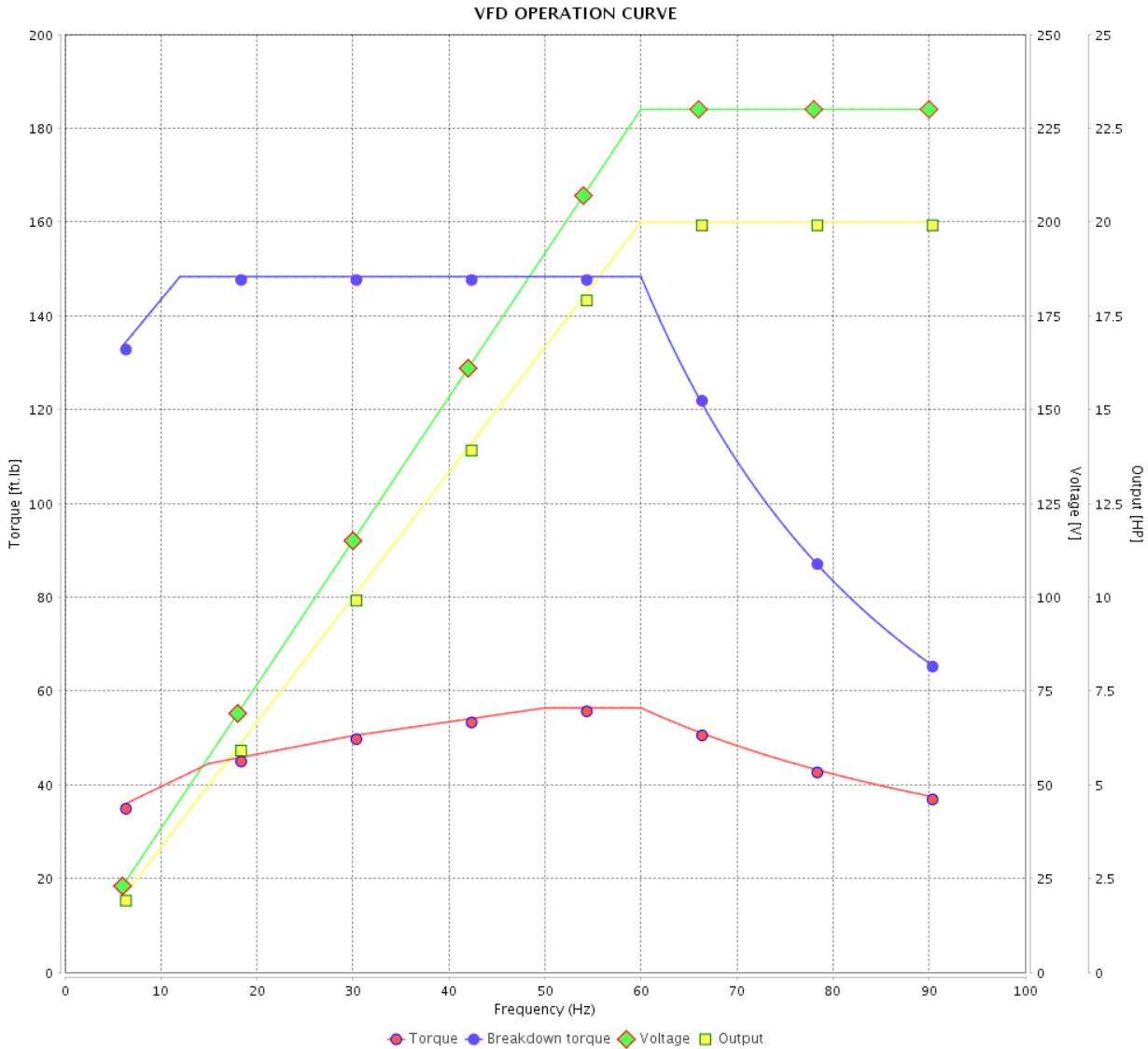

Performance : 230/460 V 60 Hz 4P

Rated current : 48.2/24.1 A  
 LRC : 6.4  
 Rated torque : 59.3 ft.lb  
 Locked rotor torque : 220 %  
 Breakdown torque : 250 %  
 Rated speed : 1770 rpm

Moment of inertia (J) : 3.13 sq.ft.lb  
 Duty cycle : Cont.(S1)  
 Insulation class : F  
 Service factor : 1.25  
 Temperature rise : 80 K  
 Design : B

Rev.	Changes Summary	Performed	Checked	Date
Performed by			Page 18 / 21	Revision
Checked by				
Date	14/04/2022			

# VFD OPERATION CURVE

## Three Phase Induction Motor - Squirrel Cage



Customer :

Product line : W40 JP Pump NEMA Premium Efficiency Three-Phase

Product code : 14485159

Catalog # : 02018OT3E256JP-W40

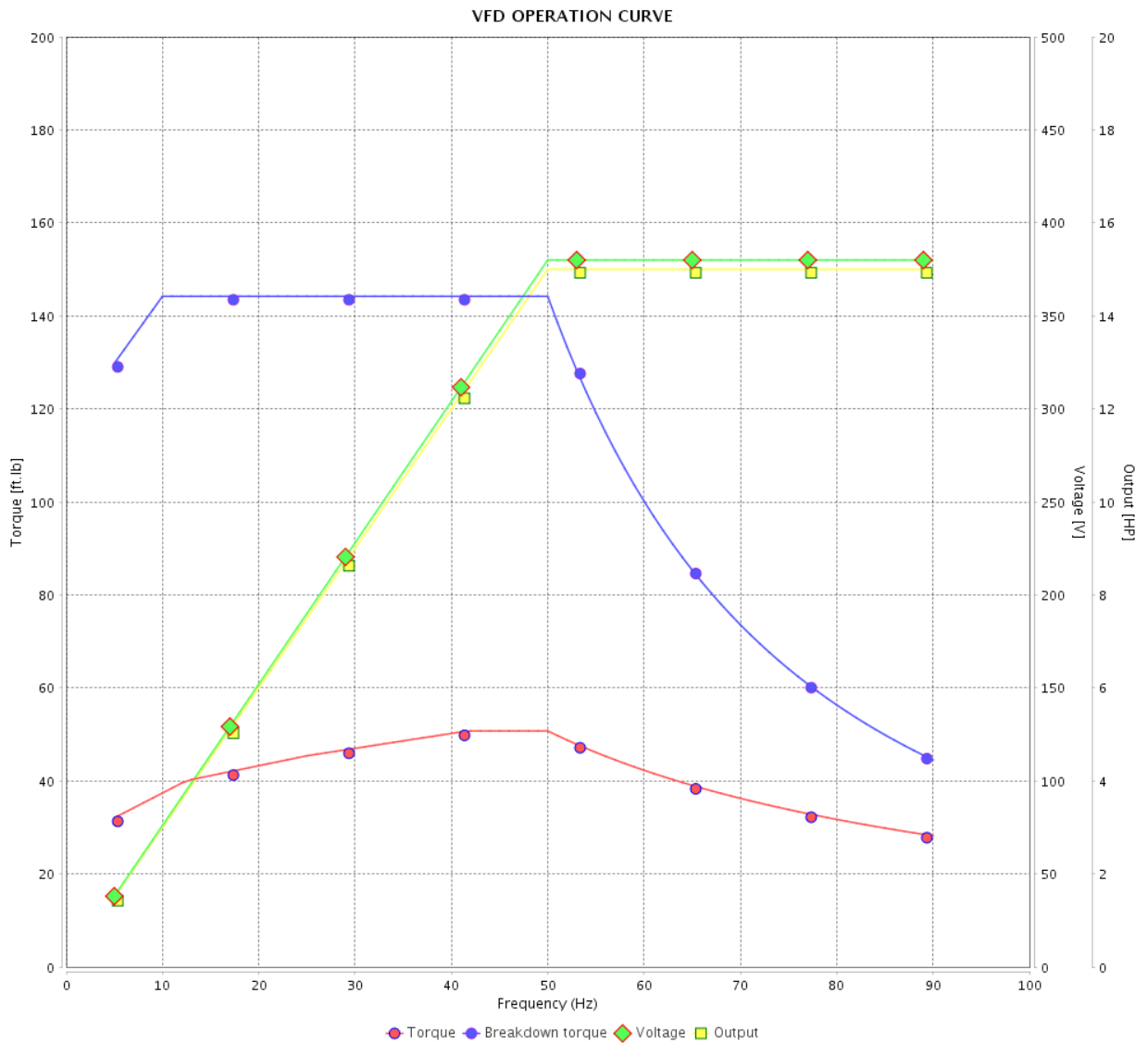

Performance : 380 V 50 Hz 4P IE3

Rated current : 22.0 A  
 LRC : 7.0  
 Rated torque : 53.4 ft.lb  
 Locked rotor torque : 250 %  
 Breakdown torque : 270 %  
 Rated speed : 1475 rpm

Moment of inertia (J) : 3.13 sq.ft.lb  
 Duty cycle : Cont.(S1)  
 Insulation class : F  
 Service factor : 1.00  
 Temperature rise : 80 K  
 Design : B

Rev.	Changes Summary	Performed	Checked	Date
Performed by				Page 19 / 21
Checked by				
Date	14/04/2022			
				Revision

# VFD OPERATION CURVE

Three Phase Induction Motor - Squirrel Cage



Customer : \_\_\_\_\_

Product line : W40 JP Pump NEMA Premium Efficiency Three-Phase

Product code : 14485159

Catalog # : 02018OT3E256JP-W40

VFD OPERATION CURVE

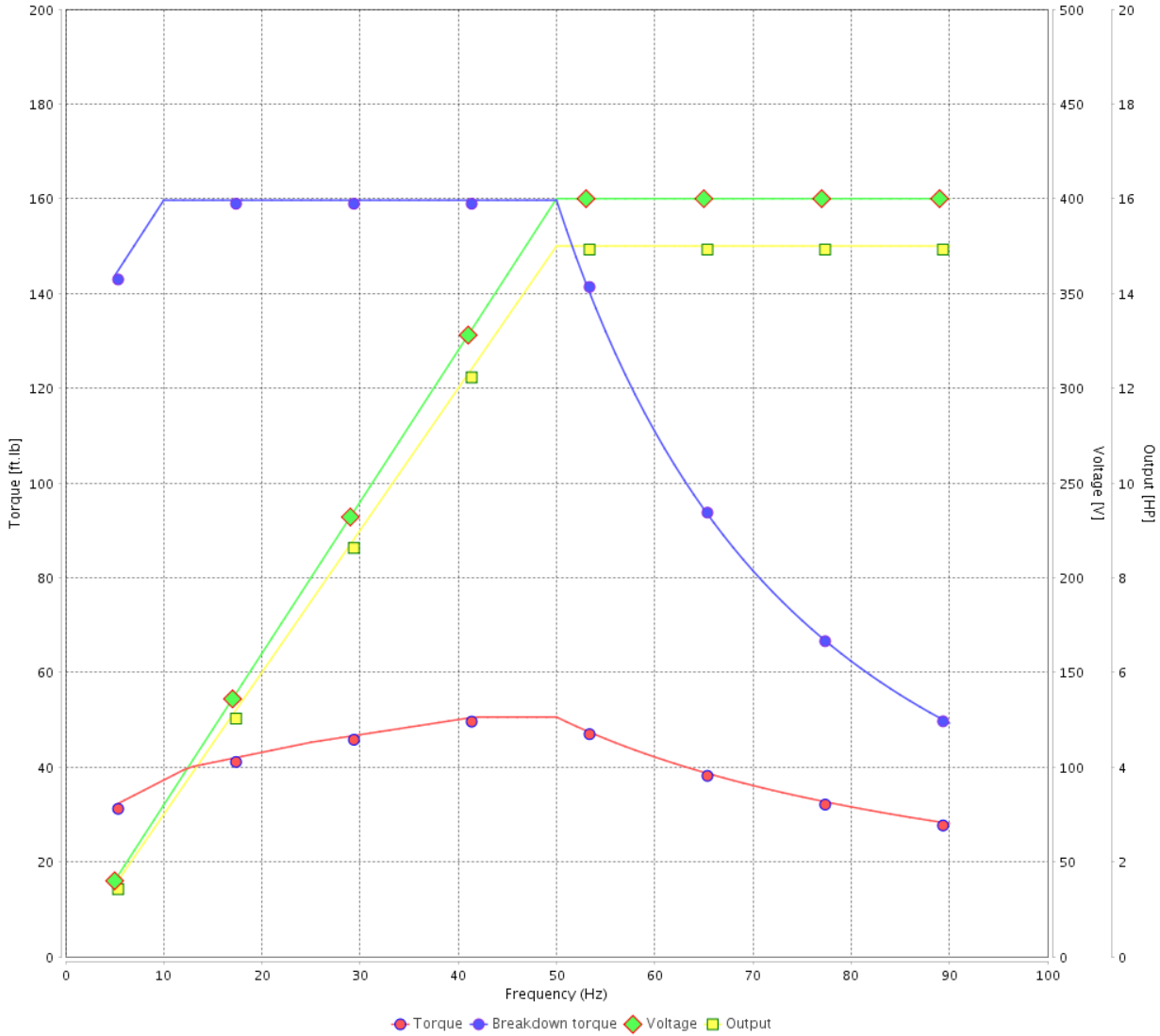

Performance : 400 V 50 Hz 4P IE3

Rated current : 21.4 A  
 LRC : 7.3  
 Rated torque : 53.2 ft.lb  
 Locked rotor torque : 240 %  
 Breakdown torque : 300 %  
 Rated speed : 1480 rpm

Moment of inertia (J) : 3.13 sq.ft.lb  
 Duty cycle : Cont.(S1)  
 Insulation class : F  
 Service factor : 1.00  
 Temperature rise : 80 K  
 Design : B

Rev.	Changes Summary	Performed	Checked	Date
Performed by			Page 20 / 21	Revision
Checked by				
Date	14/04/2022			

# VFD OPERATION CURVE

Three Phase Induction Motor - Squirrel Cage



Customer :

Product line : W40 JP Pump NEMA Premium Efficiency Three-Phase

Product code : 14485159

Catalog # : 02018OT3E256JP-W40

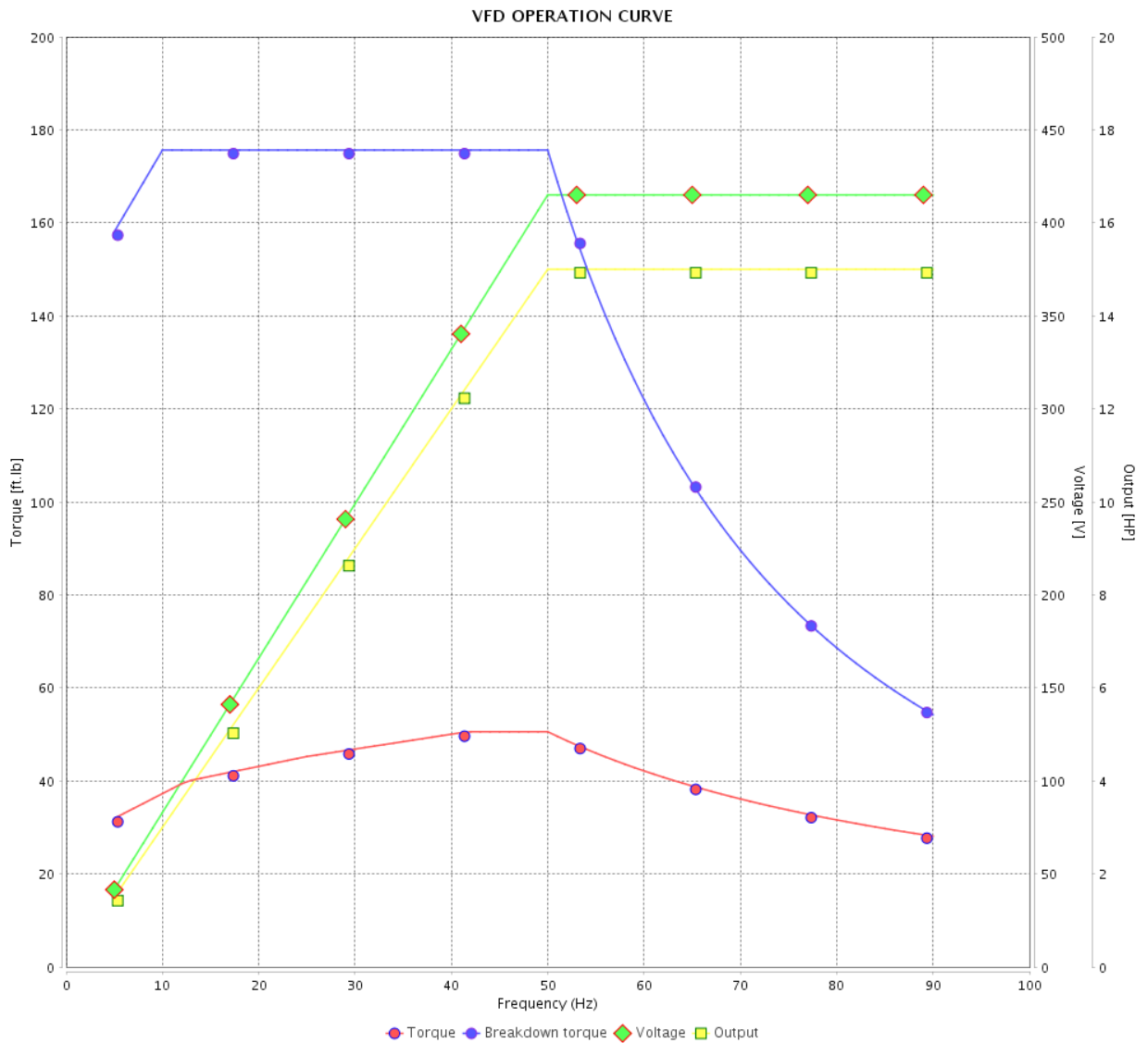

Performance : 415 V 50 Hz 4P IE3

Rated current : 21.2 A  
 LRC : 7.3  
 Rated torque : 53.2 ft.lb  
 Locked rotor torque : 290 %  
 Breakdown torque : 330 %  
 Rated speed : 1480 rpm

Moment of inertia (J) : 3.13 sq.ft.lb  
 Duty cycle : Cont.(S1)  
 Insulation class : F  
 Service factor : 1.00  
 Temperature rise : 80 K  
 Design : B

Rev.	Changes Summary	Performed	Checked	Date
Performed by			Page 21 / 21	Revision
Checked by				
Date	14/04/2022			

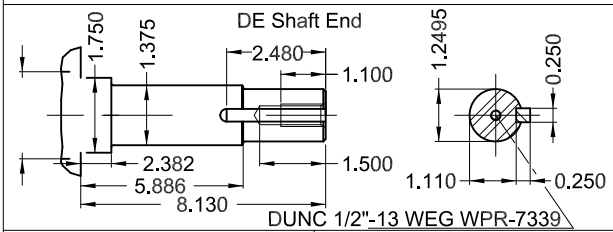
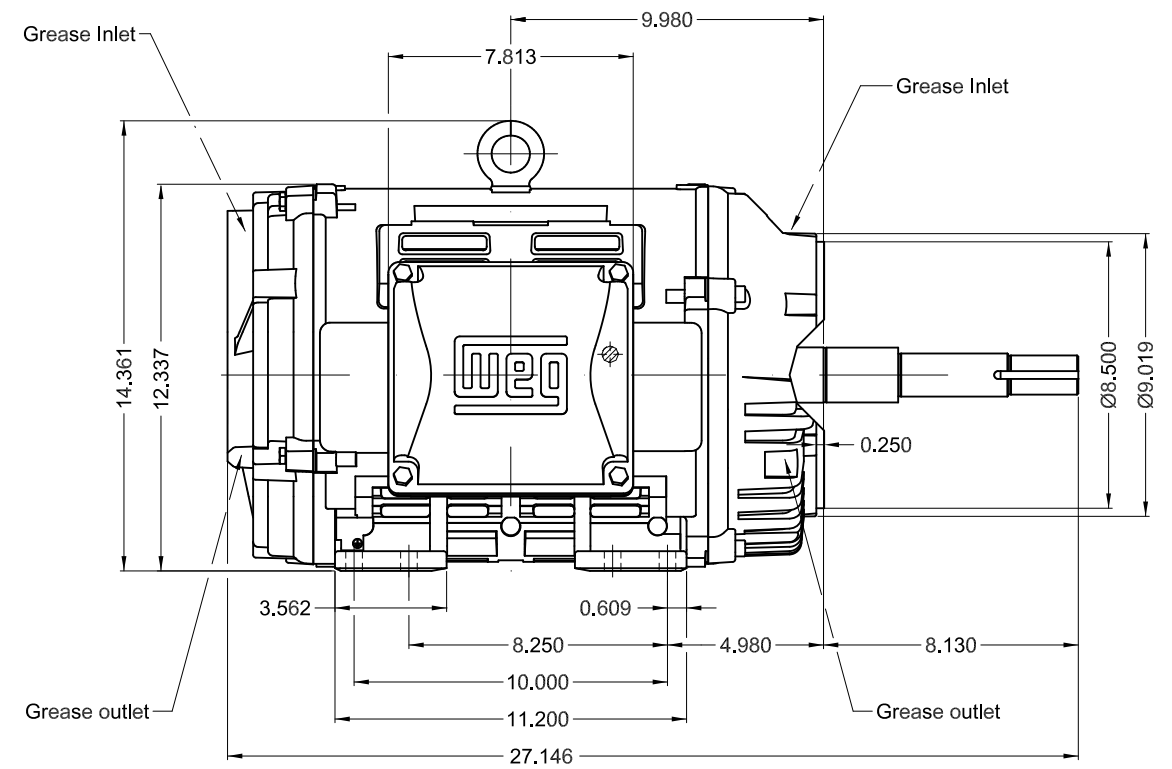
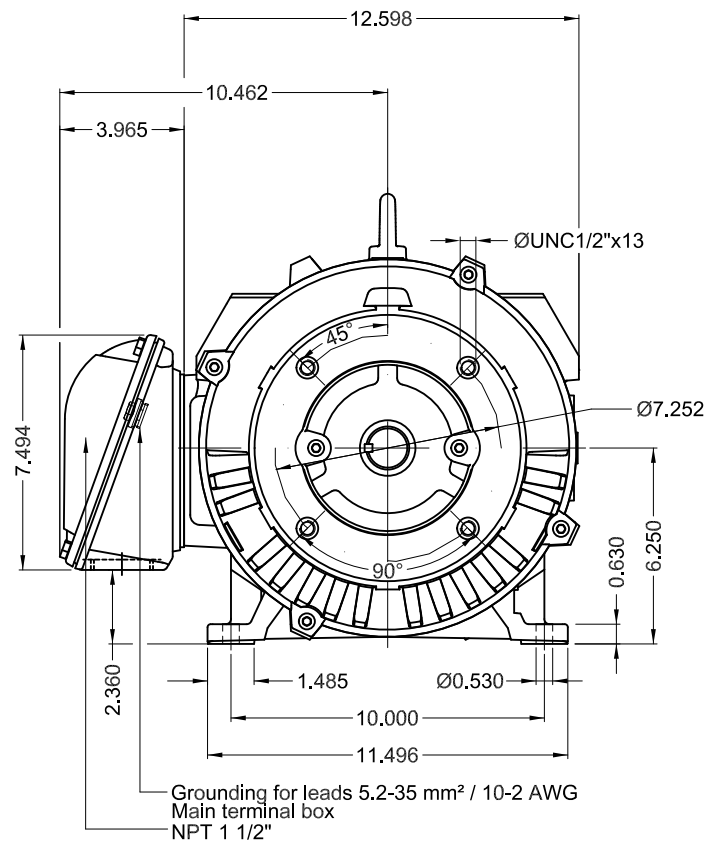

20 HP 04 Poles 60 Hz

A

1:6

ECM	LOC	SUMMARY OF MODIFICATIONS	EXECUTED	CHECKED	RELEASED	DATE	VER
EXECUTED	PIRWBUSER	THREE PH. MOTOR W40 CLOSE COUPLED PUMP JP TYPE PREM. FT.					
CHECKED		FRAME 254/6JP IP23 ODP					
RELEASED							
REL DT.		WMO Jaragua do Sul					

Color RAL 5009  
Painting plan 203A  
Mounting NEMA F-1  
Mounting B34R(D)

PREVIEW  
WDD



SHEET 1 / 1

**WEG** **W40 NEMA**  
**CC029A Premium**  
*Inverter Duty Motor*



IEC 60034-1  
 MOD.T01#FOXON



For 60Hz use on PWM, VT 1000:1, CT 3:1, 1.0SF

MODEL 020180T3E256JP-W40  
 MADE IN BRAZIL  
 14485159

PH 3	FR 254/6JP	HP(kW) 20.0(15.0)	Hz 60
V 230/460	A 48.2/24.1	RPM 1770	DES B
NEMA NOM EFF 93.0 %	INS. CL. F $\Delta$ T 80 K	IP23	
ENCL ODP	DUTY CONT.	AMB. 40°C	
CODE G	PF 0.84	SF 1.25	SFA 60.3/30.1
USABLE @208V	53.3 A	SF 1.15	SFA 61.3
15HP 11kW 50Hz 380V 22.0A 1475RPM SF1.00 EFF 91.5% (IE3)	ALT 1000 m.a.s.l.		

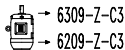
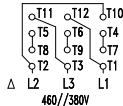
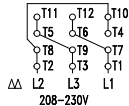

MOBIL POLYREX EM  
 13 g 20000 h

ALT 1000 m.a.s.l. 284 Lbs