

DATA SHEET

Three Phase Induction Motor - Squirrel Cage



Customer					
Product line		: W40 JM Pump NEMA Premium Efficiency Three-Phase		Product code : 14837500	
				Catalog # : 04018OT3E324JMV-W40	
Frame : 324/6JM		Cooling method : IC01 - ODP			
Insulation class : F		Mounting : W-6			
Duty cycle : Cont.(S1)		Rotation ¹ : Both (CW and CCW)			
Ambient temperature : -20°C to +40°C		Starting method : Direct On Line			
Altitude : 1000 m.a.s.l.		Approx. weight ² : 463 lb			
Protection degree : IP23		Moment of inertia (J) : 5.69 sq.ft.lb			
Design : B					
Output [HP]	40	30	30	30	
Poles	4	4	4	4	
Frequency [Hz]	60	50	50	50	
Rated voltage [V]	230/460	380	400	415	
Rated current [A]	95.2/47.6	43.3	42.2	41.7	
L. R. Amperes [A]	590/295	290	283	313	
LRC [A]	6.2x(Code G)	6.7x(Code H)	6.7x(Code H)	7.5x(Code J)	
No load current [A]	37.0/18.5	18.3	20.3	22.1	
Rated speed [RPM]	1775	1475	1480	1480	
Slip [%]	1.39	1.67	1.33	1.33	
Rated torque [ft.lb]	118	107	106	106	
Locked rotor torque [%]	200	229	260	280	
Breakdown torque [%]	240	270	300	330	
Service factor	1.25	1.00	1.00	1.00	
Temperature rise	80 K	80 K	80 K	80 K	
Locked rotor time	23s (cold) 13s (hot)	30s (cold) 17s (hot)	30s (cold) 17s (hot)	25s (cold) 14s (hot)	
Noise level ²	66.0 dB(A)				
Efficiency (%)	25%	93.5	92.4	92.5	92.4
	50%	93.6	92.6	92.6	92.5
	75%	94.1	93.0	93.0	93.0
	100%	94.1	93.0	93.0	93.0
Power Factor	25%	0.44	0.42	0.38	0.34
	50%	0.70	0.68	0.63	0.59
	75%	0.80	0.78	0.75	0.72
	100%	0.84	0.83	0.81	0.79
Bearing type		Drive end : 6312 Z C3	Non drive end : 6211 Z C3	Foundation loads	
Sealing		Without	Without	Max. traction	
Lubrication interval		Bearing Seal : 20000 h	Bearing Seal : 20000 h	Max. compression	
Lubricant amount		21 g	11 g		
Lubricant type		Mobil Polyrex EM			
Notes					
USABLE @208V 105A SF 1.15 SFA 121A					
This revision replaces and cancel the previous one, which must be eliminated. (1) Looking the motor from the shaft end. (2) Measured at 1m and with tolerance of +3dB(A). (3) Approximate weight subject to changes after manufacturing process. (4) At 100% of full load.			These are average values based on tests with sinusoidal power supply, subject to the tolerances stipulated in NEMA MG-1.		
Rev.	Changes Summary		Performed	Checked	Date
Performed by					
Checked by				Page	Revision
Date	12/04/2022			1 / 21	

TORQUE AND CURRENT VS SPEED CURVE

Three Phase Induction Motor - Squirrel Cage



Customer :

Product line : W40 JM Pump NEMA Premium Efficiency Three-Phase

Product code : 14837500

Catalog # : 04018OT3E324JMV-W40

TORQUE AND CURRENT VS SPEED CURVE

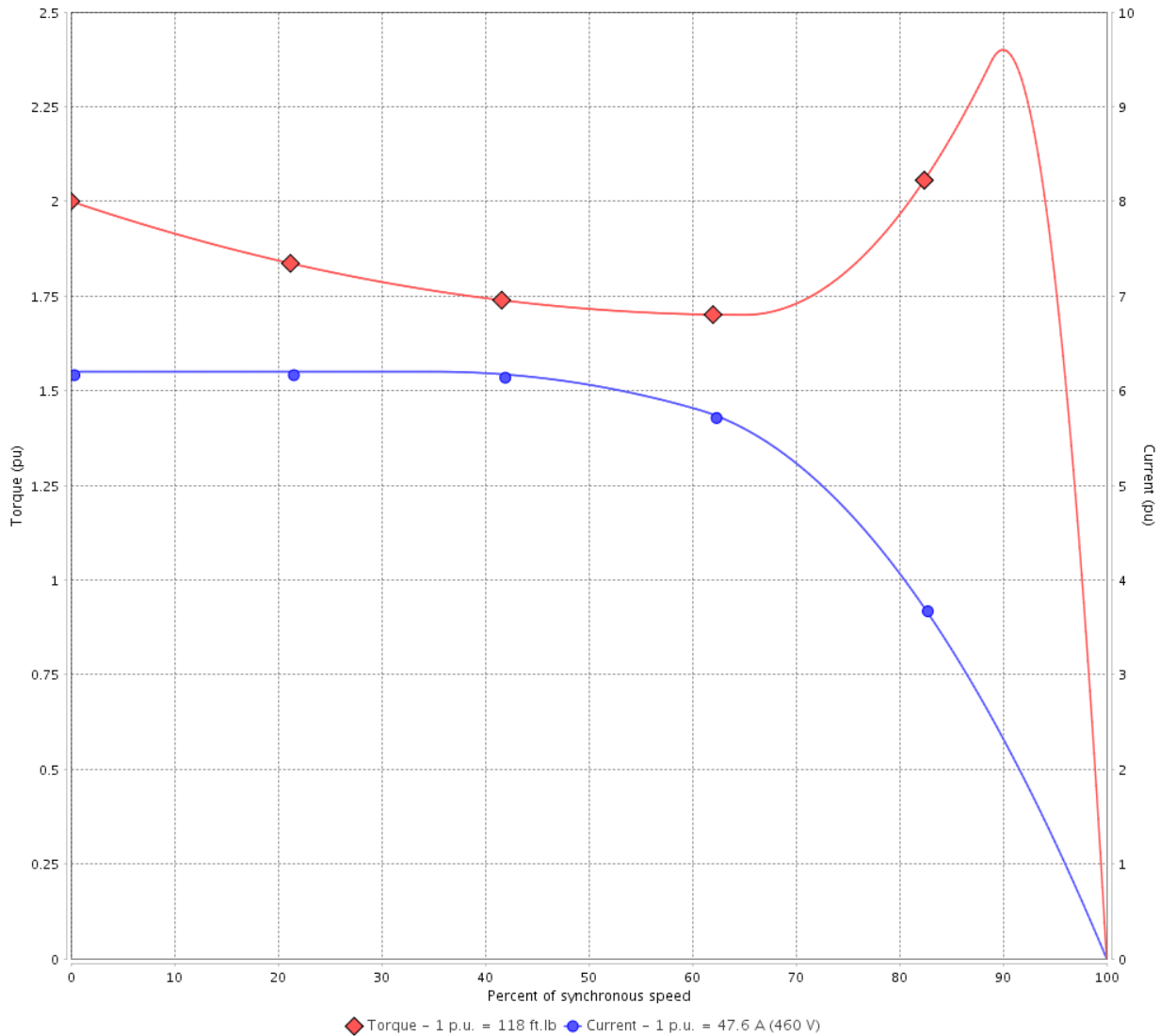

Performance : 230/460 V 60 Hz 4P

Rated current : 95.2/47.6 A
 LRC : 6.2
 Rated torque : 118 ft.lb
 Locked rotor torque : 200 %
 Breakdown torque : 240 %
 Rated speed : 1775 rpm

Moment of inertia (J) : 5.69 sq.ft.lb
 Duty cycle : Cont.(S1)
 Insulation class : F
 Service factor : 1.25
 Temperature rise : 80 K
 Design : B

Locked rotor time : 23s (cold) 13s (hot)

Rev.	Changes Summary	Performed	Checked	Date
Performed by			Page 2 / 21	Revision
Checked by				
Date	12/04/2022			

TORQUE AND CURRENT VS SPEED CURVE



Three Phase Induction Motor - Squirrel Cage

Customer :

Product line : W40 JM Pump NEMA Premium Efficiency Three-Phase

Product code : 14837500

Catalog # : 04018OT3E324JMV-W40

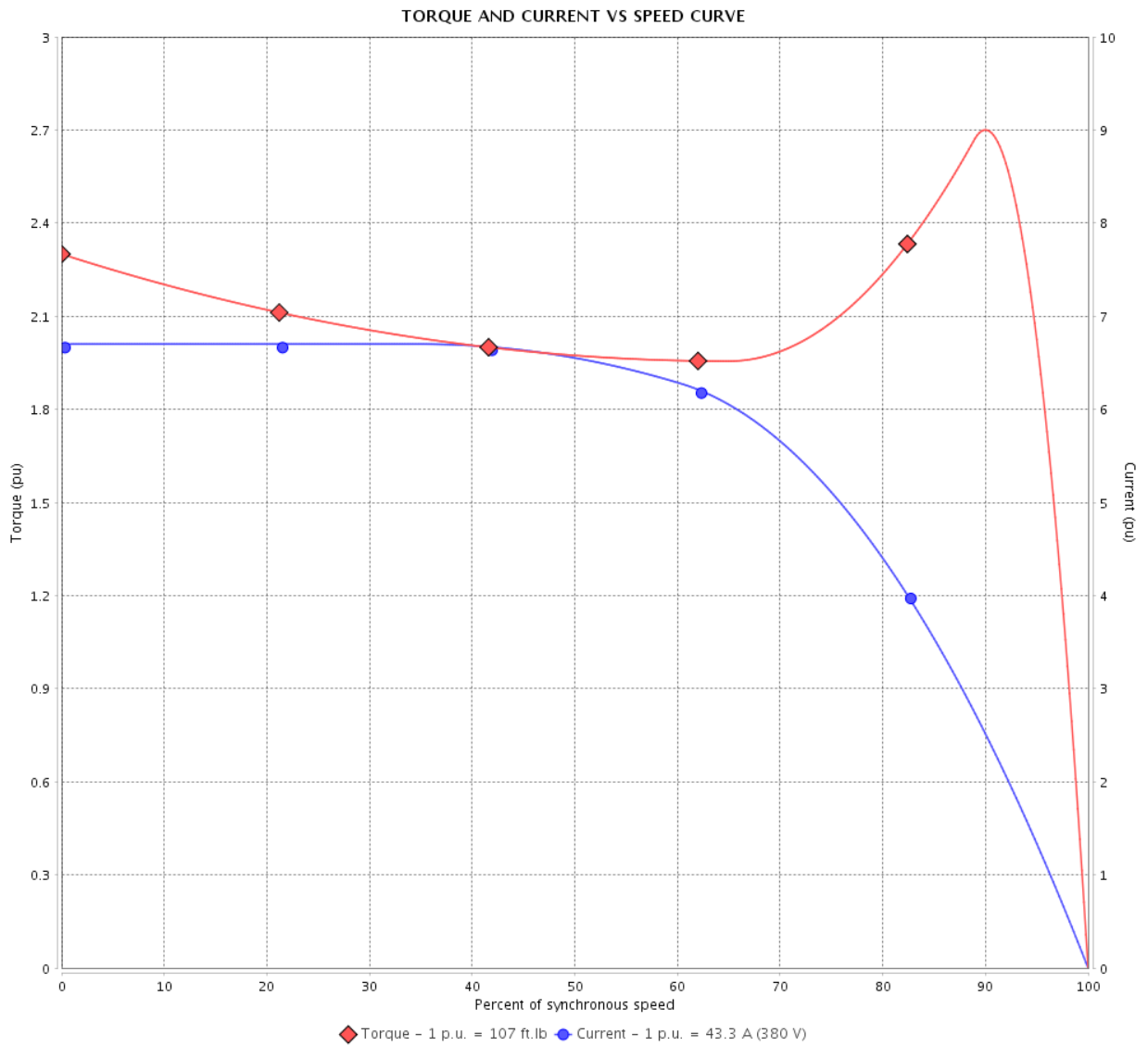

Performance : 380 V 50 Hz 4P IE3

Rated current	: 43.3 A	Moment of inertia (J)	: 5.69 sq.ft.lb
LRC	: 6.7	Duty cycle	: Cont.(S1)
Rated torque	: 107 ft.lb	Insulation class	: F
Locked rotor torque	: 229 %	Service factor	: 1.00
Breakdown torque	: 270 %	Temperature rise	: 80 K
Rated speed	: 1475 rpm	Design	: B

Locked rotor time : 30s (cold) 17s (hot)

Rev.	Changes Summary	Performed	Checked	Date
Performed by			Page 3 / 21	Revision
Checked by				
Date	12/04/2022			

TORQUE AND CURRENT VS SPEED CURVE

Three Phase Induction Motor - Squirrel Cage



Customer :

Product line : W40 JM Pump NEMA Premium Efficiency Three-Phase

Product code : 14837500

Catalog # : 04018OT3E324JMV-W40

TORQUE AND CURRENT VS SPEED CURVE

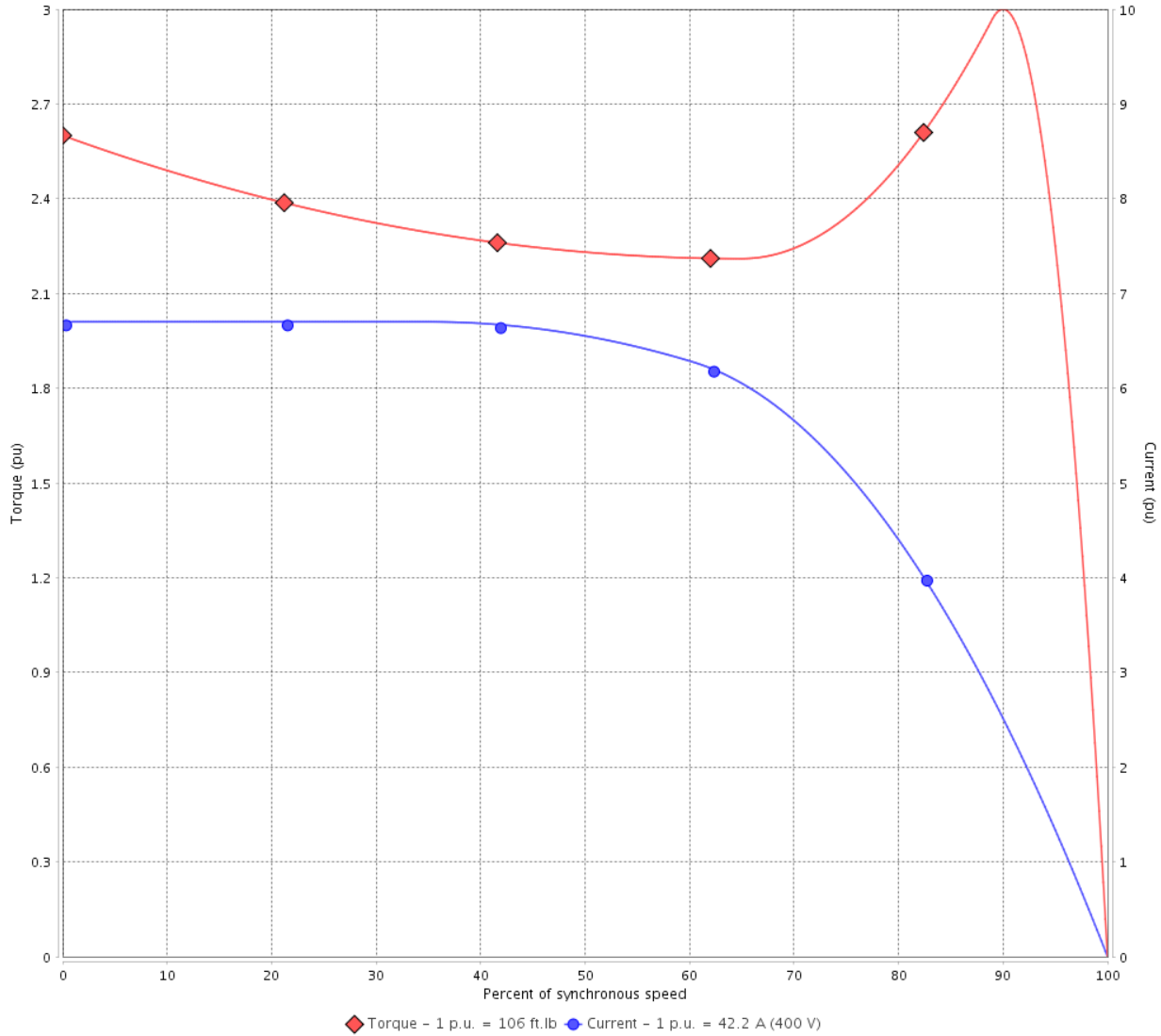

Performance : 400 V 50 Hz 4P IE3

Rated current	: 42.2 A	Moment of inertia (J)	: 5.69 sq.ft.lb
LRC	: 6.7	Duty cycle	: Cont.(S1)
Rated torque	: 106 ft.lb	Insulation class	: F
Locked rotor torque	: 260 %	Service factor	: 1.00
Breakdown torque	: 300 %	Temperature rise	: 80 K
Rated speed	: 1480 rpm	Design	: B

Locked rotor time : 30s (cold) 17s (hot)

Rev.	Changes Summary	Performed	Checked	Date
Performed by			Page 4 / 21	Revision
Checked by				
Date	12/04/2022			

TORQUE AND CURRENT VS SPEED CURVE



Three Phase Induction Motor - Squirrel Cage

Customer :

Product line : W40 JM Pump NEMA Premium Efficiency Three-Phase

Product code : 14837500

Catalog # : 04018OT3E324JMV-W40

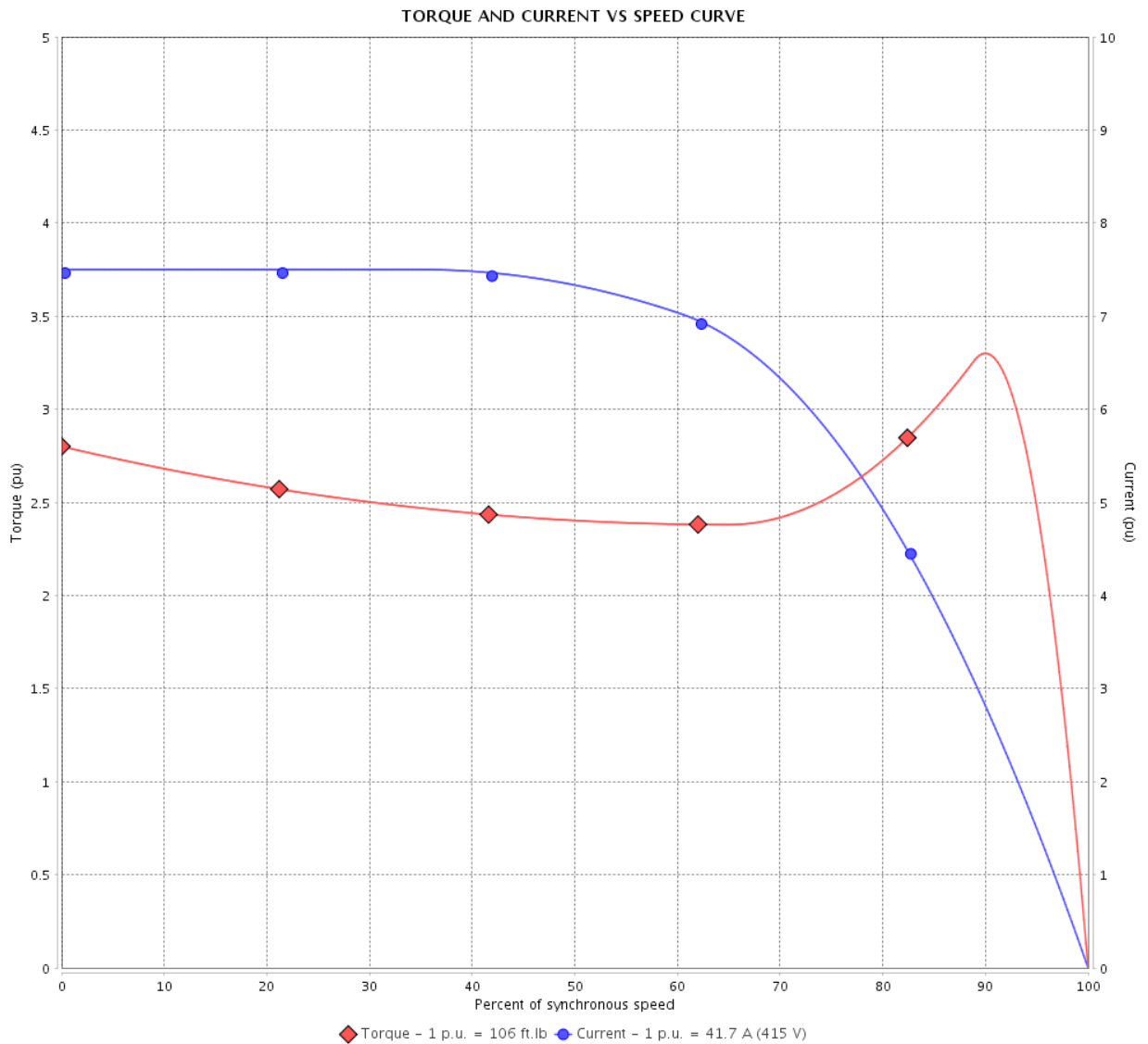

Performance : 415 V 50 Hz 4P IE3

Rated current	: 41.7 A	Moment of inertia (J)	: 5.69 sq.ft.lb
LRC	: 7.5	Duty cycle	: Cont.(S1)
Rated torque	: 106 ft.lb	Insulation class	: F
Locked rotor torque	: 280 %	Service factor	: 1.00
Breakdown torque	: 330 %	Temperature rise	: 80 K
Rated speed	: 1480 rpm	Design	: B

Locked rotor time : 25s (cold) 14s (hot)

Rev.	Changes Summary	Performed	Checked	Date
Performed by			Page 5 / 21	Revision
Checked by				
Date	12/04/2022			

LOAD PERFORMANCE CURVE

Three Phase Induction Motor - Squirrel Cage



Customer :

Product line : W40 JM Pump NEMA Premium Efficiency Three-Phase

Product code : 14837500

Catalog # : 04018OT3E324JMV-W40

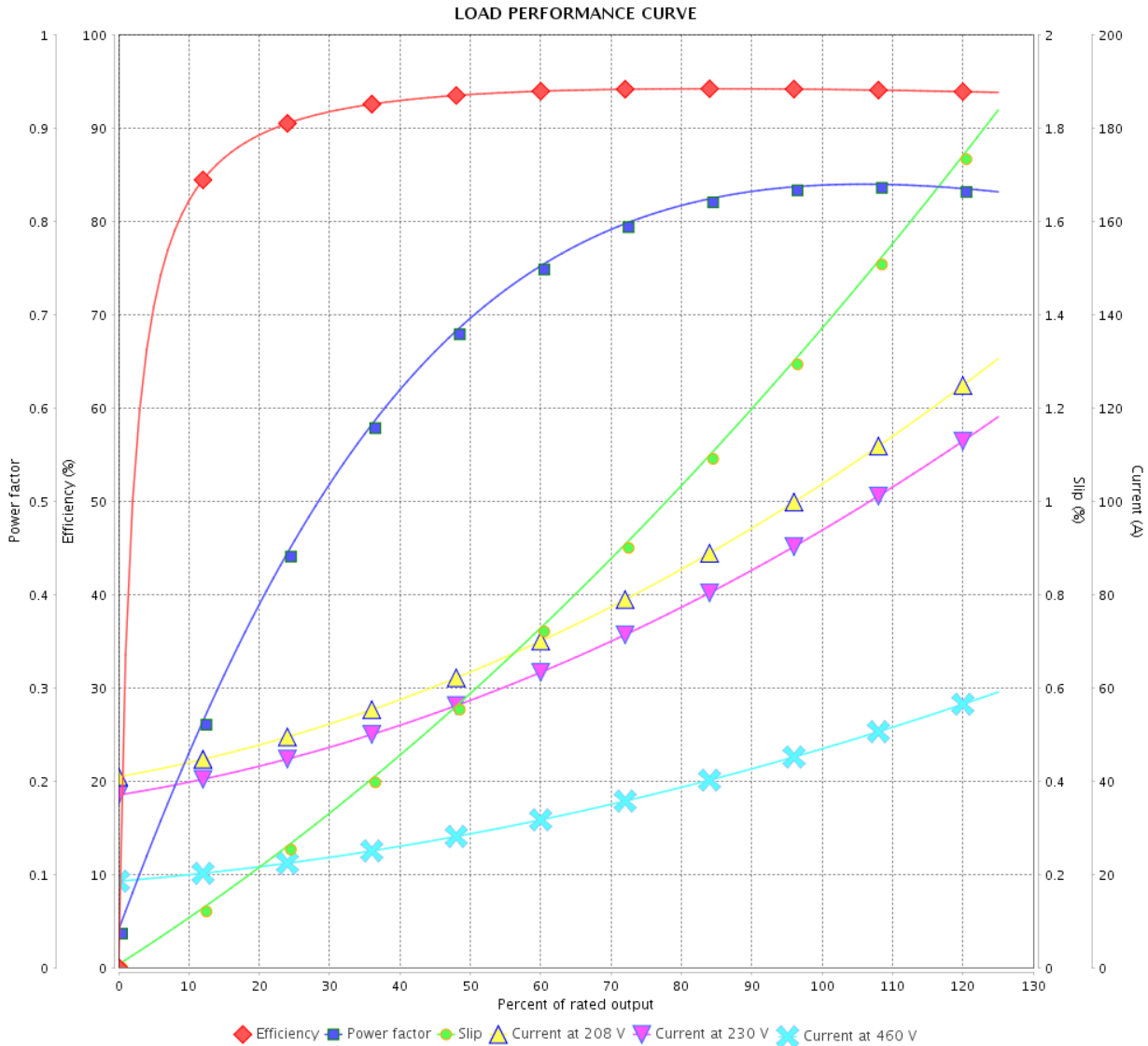

Performance : 230/460 V 60 Hz 4P

Rated current : 95.2/47.6 A
 LRC : 6.2
 Rated torque : 118 ft.lb
 Locked rotor torque : 200 %
 Breakdown torque : 240 %
 Rated speed : 1775 rpm

Moment of inertia (J) : 5.69 sq.ft.lb
 Duty cycle : Cont.(S1)
 Insulation class : F
 Service factor : 1.25
 Temperature rise : 80 K
 Design : B

Rev.	Changes Summary	Performed	Checked	Date
Performed by			Page	Revision
Checked by			6 / 21	
Date	12/04/2022			

LOAD PERFORMANCE CURVE

Three Phase Induction Motor - Squirrel Cage



Customer :

Product line : W40 JM Pump NEMA Premium Efficiency Three-Phase

Product code : 14837500

Catalog # : 04018OT3E324JMV-W40

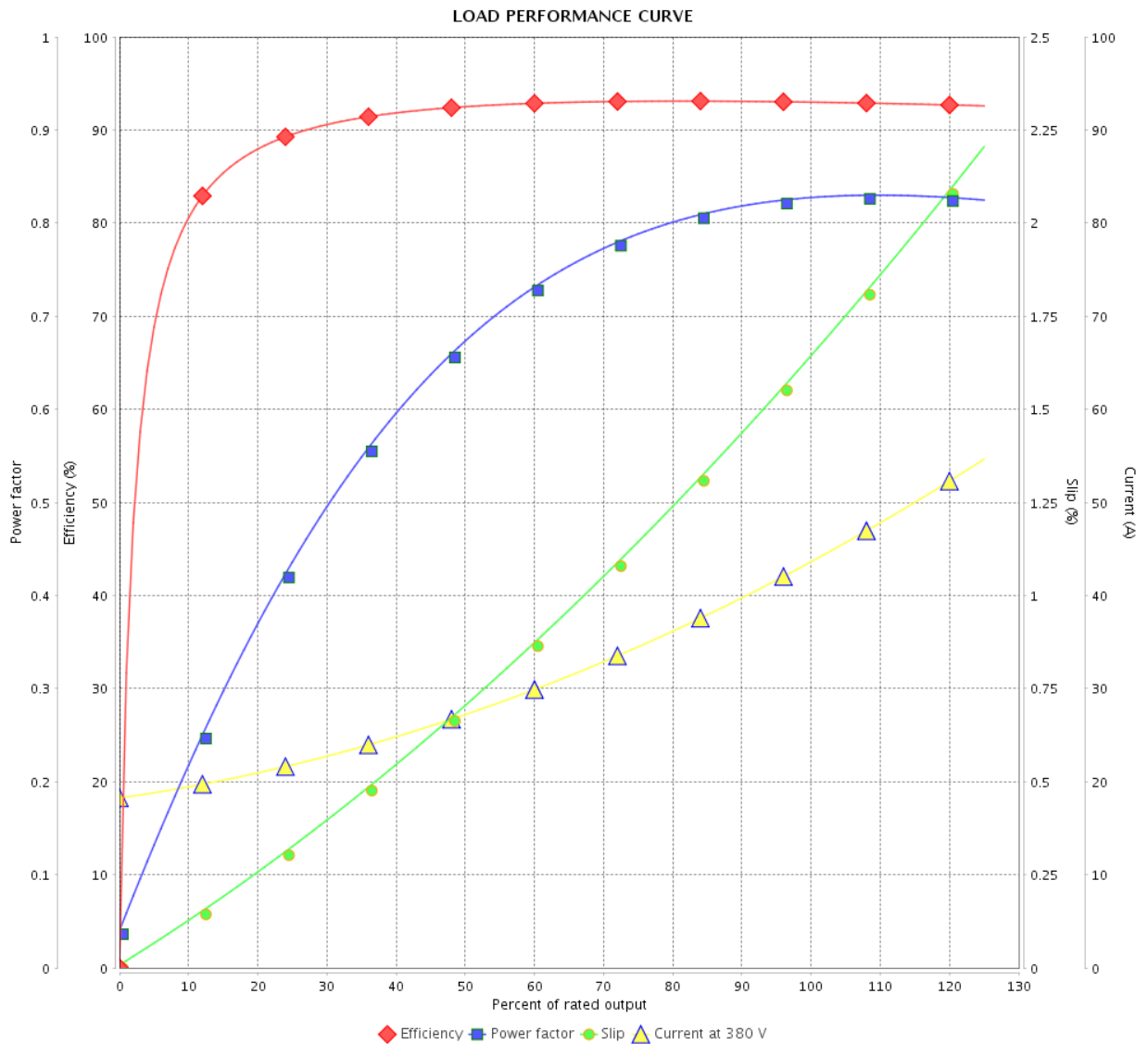

Performance : 380 V 50 Hz 4P IE3

Rated current : 43.3 A
 LRC : 6.7
 Rated torque : 107 ft.lb
 Locked rotor torque : 229 %
 Breakdown torque : 270 %
 Rated speed : 1475 rpm

Moment of inertia (J) : 5.69 sq.ft.lb
 Duty cycle : Cont.(S1)
 Insulation class : F
 Service factor : 1.00
 Temperature rise : 80 K
 Design : B

Rev.	Changes Summary	Performed	Checked	Date
Performed by				
Checked by				
Date				
		Page	Revision	
		7 / 21		

LOAD PERFORMANCE CURVE

Three Phase Induction Motor - Squirrel Cage



Customer :

Product line : W40 JM Pump NEMA Premium
Efficiency Three-Phase

Product code : 14837500

Catalog # : 04018OT3E324JMV-W40

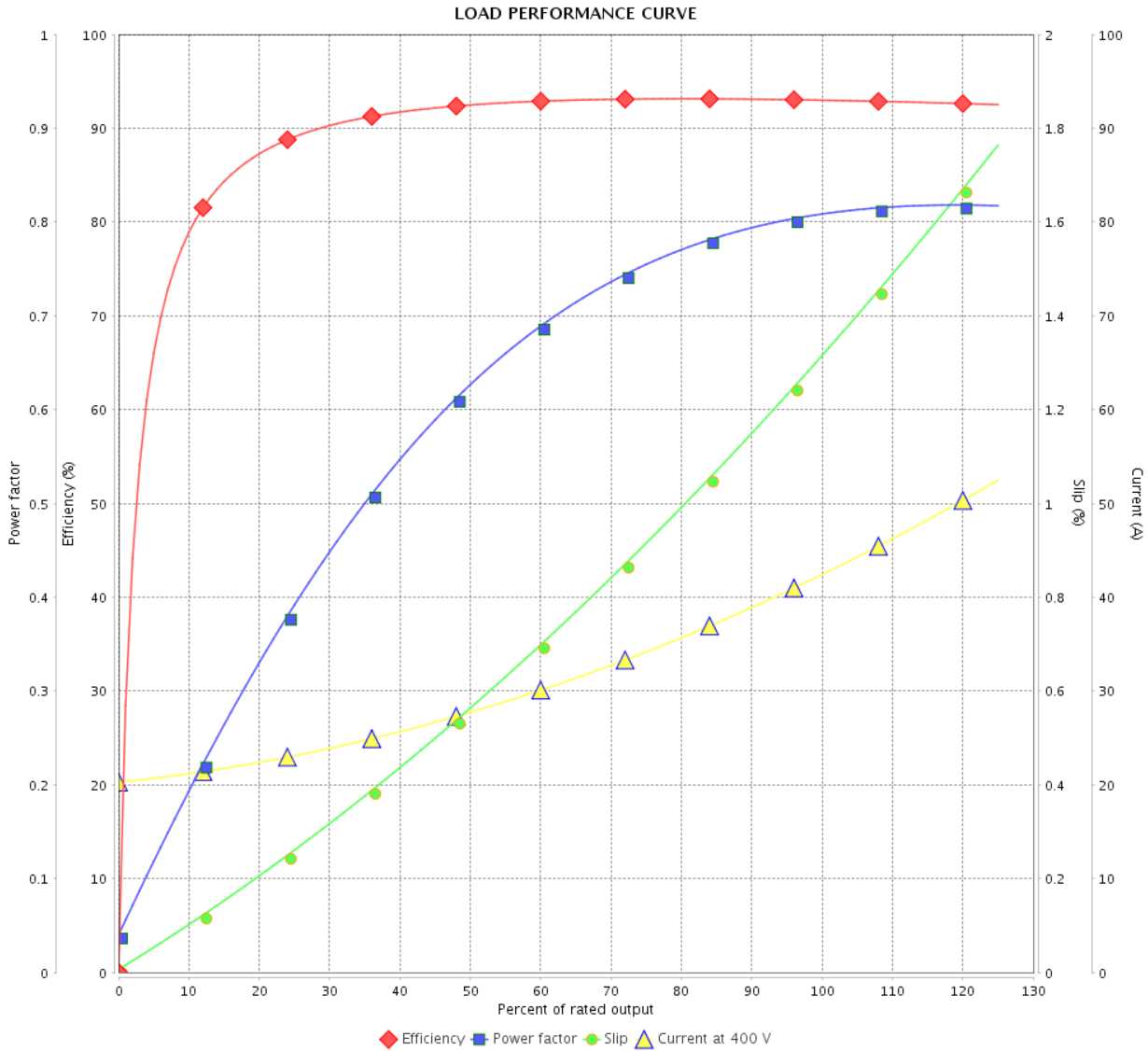

Performance : 400 V 50 Hz 4P IE3

Rated current : 42.2 A
LRC : 6.7
Rated torque : 106 ft.lb
Locked rotor torque : 260 %
Breakdown torque : 300 %
Rated speed : 1480 rpm

Moment of inertia (J) : 5.69 sq.ft.lb
Duty cycle : Cont.(S1)
Insulation class : F
Service factor : 1.00
Temperature rise : 80 K
Design : B

Rev.	Changes Summary	Performed	Checked	Date
Performed by			Page 8 / 21	Revision
Checked by				
Date	12/04/2022			

LOAD PERFORMANCE CURVE

Three Phase Induction Motor - Squirrel Cage



Customer :

Product line : W40 JM Pump NEMA Premium Efficiency Three-Phase

Product code : 14837500

Catalog # : 04018OT3E324JMV-W40

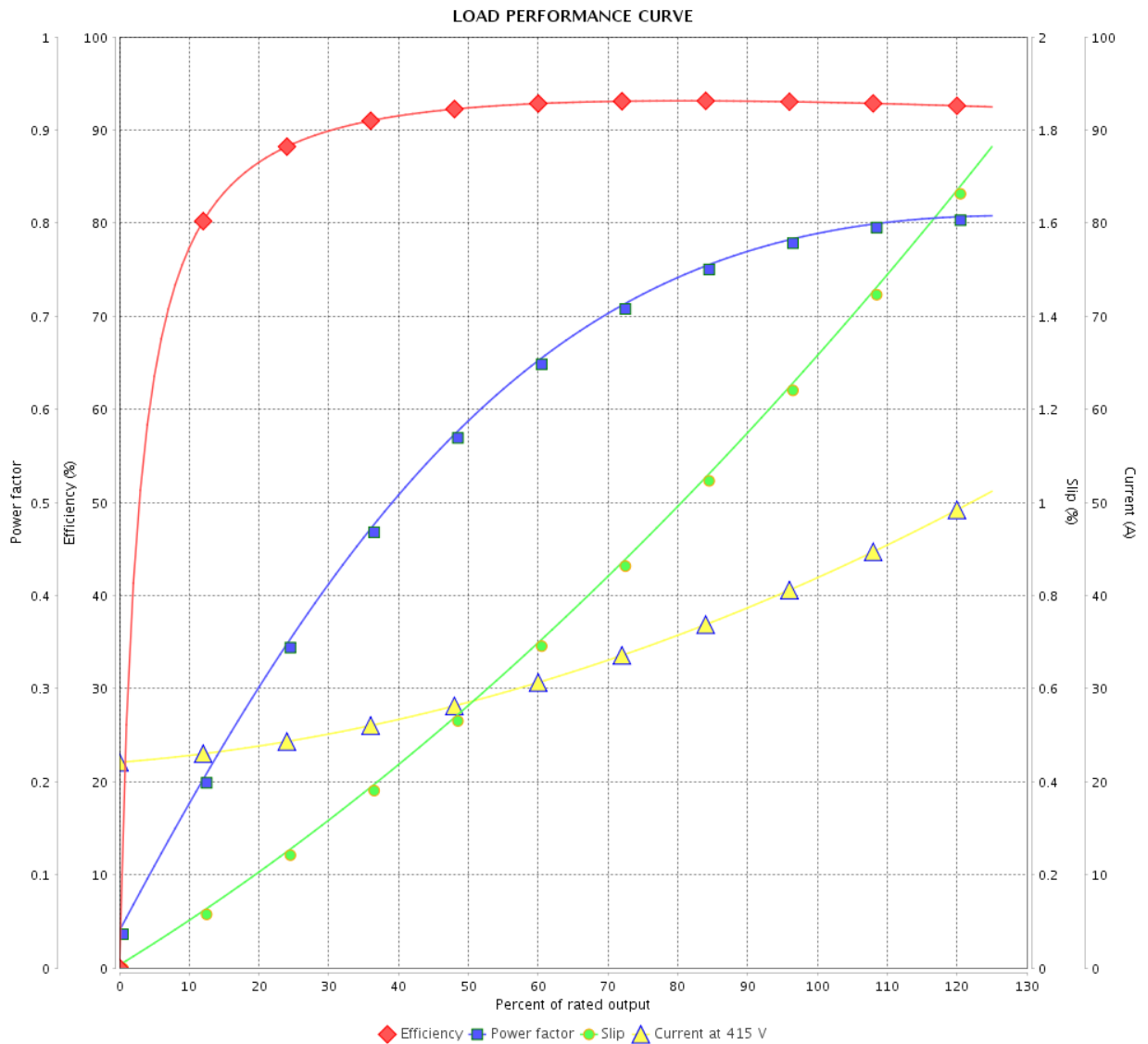

Performance : 415 V 50 Hz 4P IE3

Rated current : 41.7 A
 LRC : 7.5
 Rated torque : 106 ft.lb
 Locked rotor torque : 280 %
 Breakdown torque : 330 %
 Rated speed : 1480 rpm

Moment of inertia (J) : 5.69 sq.ft.lb
 Duty cycle : Cont.(S1)
 Insulation class : F
 Service factor : 1.00
 Temperature rise : 80 K
 Design : B

Rev.	Changes Summary	Performed	Checked	Date
Performed by			Page	Revision
Checked by				
Date				

THERMAL LIMIT CURVE



Three Phase Induction Motor - Squirrel Cage

Customer :

Product line : W40 JM Pump NEMA Premium
Efficiency Three-Phase

Product code : 14837500

Catalog # : 04018OT3E324JMV-W40

Performance : 230/460 V 60 Hz 4P

Rated current : 95.2/47.6 A
LRC : 6.2
Rated torque : 118 ft.lb
Locked rotor torque : 200 %
Breakdown torque : 240 %
Rated speed : 1775 rpm

Moment of inertia (J) : 5.69 sq.ft.lb
Duty cycle : Cont.(S1)
Insulation class : F
Service factor : 1.25
Temperature rise : 80 K
Design : B

Heating constant

Cooling constant

Rev.	Changes Summary	Performed	Checked	Date
Performed by				
Checked by			Page	Revision
Date	12/04/2022		10 / 21	

THERMAL LIMIT CURVE

Three Phase Induction Motor - Squirrel Cage



Customer : _____

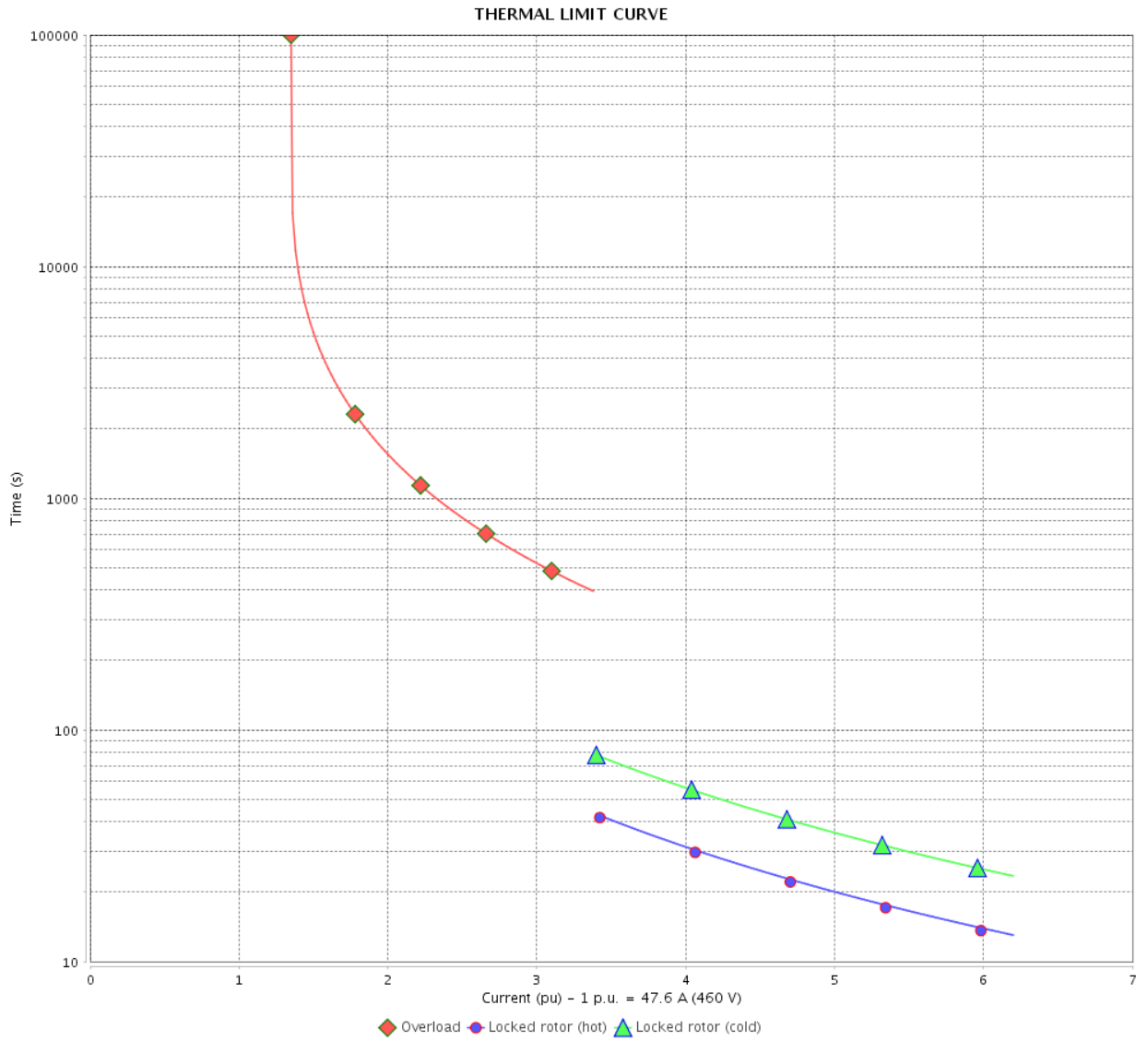

Rev.	Changes Summary	Performed	Checked	Date
Performed by		Page		Revision
Checked by		11 / 21		
Date		12/04/2022		

THERMAL LIMIT CURVE



Three Phase Induction Motor - Squirrel Cage

Customer :

Product line : W40 JM Pump NEMA Premium
Efficiency Three-Phase

Product code : 14837500

Catalog # : 04018OT3E324JMV-W40

Performance : 380 V 50 Hz 4P IE3

Rated current	: 43.3 A	Moment of inertia (J)	: 5.69 sq.ft.lb
LRC	: 6.7	Duty cycle	: Cont.(S1)
Rated torque	: 107 ft.lb	Insulation class	: F
Locked rotor torque	: 229 %	Service factor	: 1.00
Breakdown torque	: 270 %	Temperature rise	: 80 K
Rated speed	: 1475 rpm	Design	: B

Heating constant

Cooling constant

Rev.	Changes Summary	Performed	Checked	Date
Performed by				
Checked by			Page	Revision
Date	12/04/2022		12 / 21	

THERMAL LIMIT CURVE

Three Phase Induction Motor - Squirrel Cage



Customer : _____

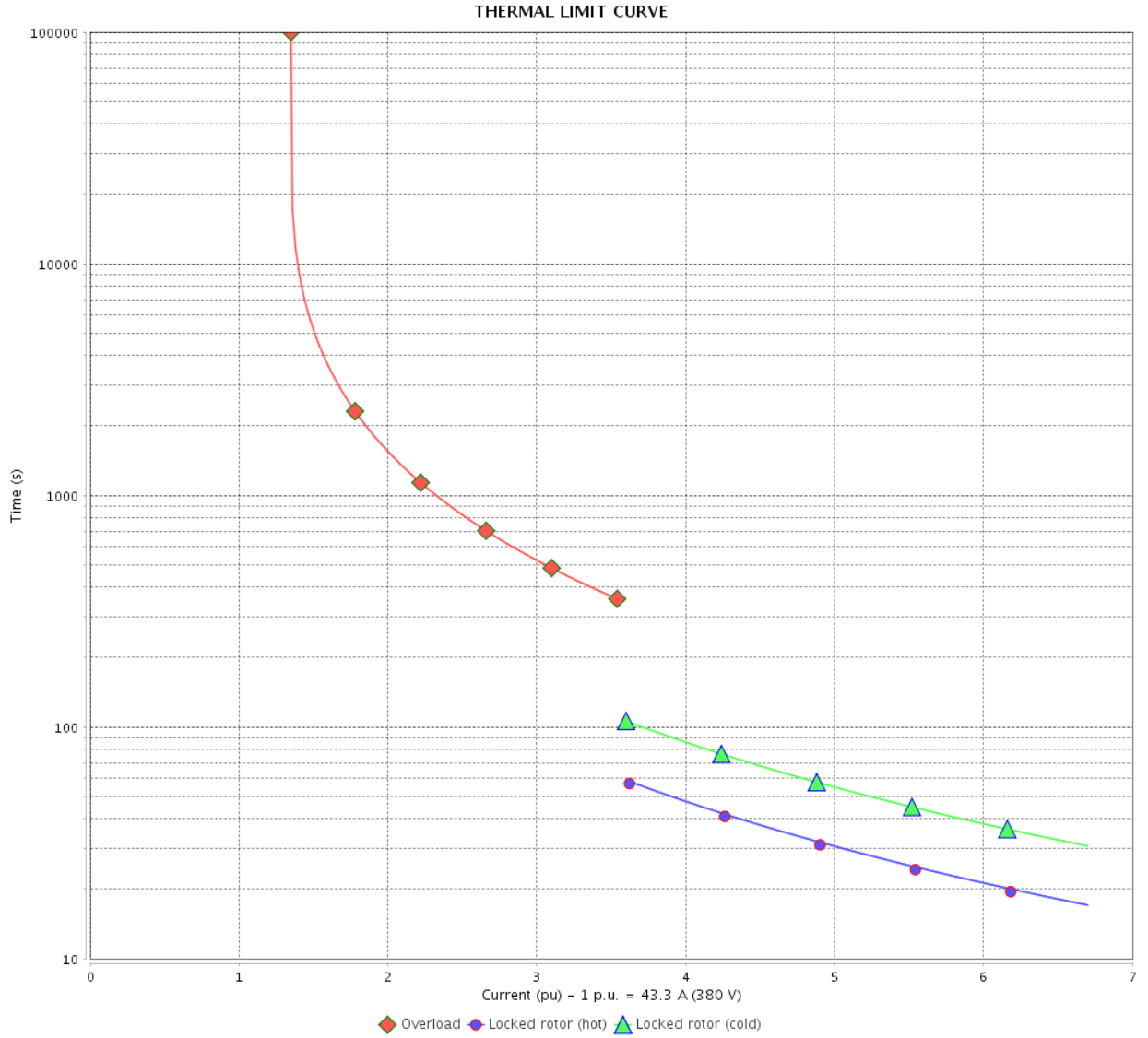

Rev.	Changes Summary	Performed	Checked	Date
Performed by		Page		Revision
Checked by		13 / 21		
Date		12/04/2022		

THERMAL LIMIT CURVE



Three Phase Induction Motor - Squirrel Cage

Customer :

Product line : W40 JM Pump NEMA Premium
Efficiency Three-Phase

Product code : 14837500

Catalog # : 04018OT3E324JMV-W40

Performance : 400 V 50 Hz 4P IE3

Rated current	: 42.2 A	Moment of inertia (J)	: 5.69 sq.ft.lb
LRC	: 6.7	Duty cycle	: Cont.(S1)
Rated torque	: 106 ft.lb	Insulation class	: F
Locked rotor torque	: 260 %	Service factor	: 1.00
Breakdown torque	: 300 %	Temperature rise	: 80 K
Rated speed	: 1480 rpm	Design	: B

Heating constant

Cooling constant

Rev.	Changes Summary	Performed	Checked	Date
Performed by				
Checked by			Page	Revision
Date	12/04/2022		14 / 21	

THERMAL LIMIT CURVE

Three Phase Induction Motor - Squirrel Cage



Customer : _____

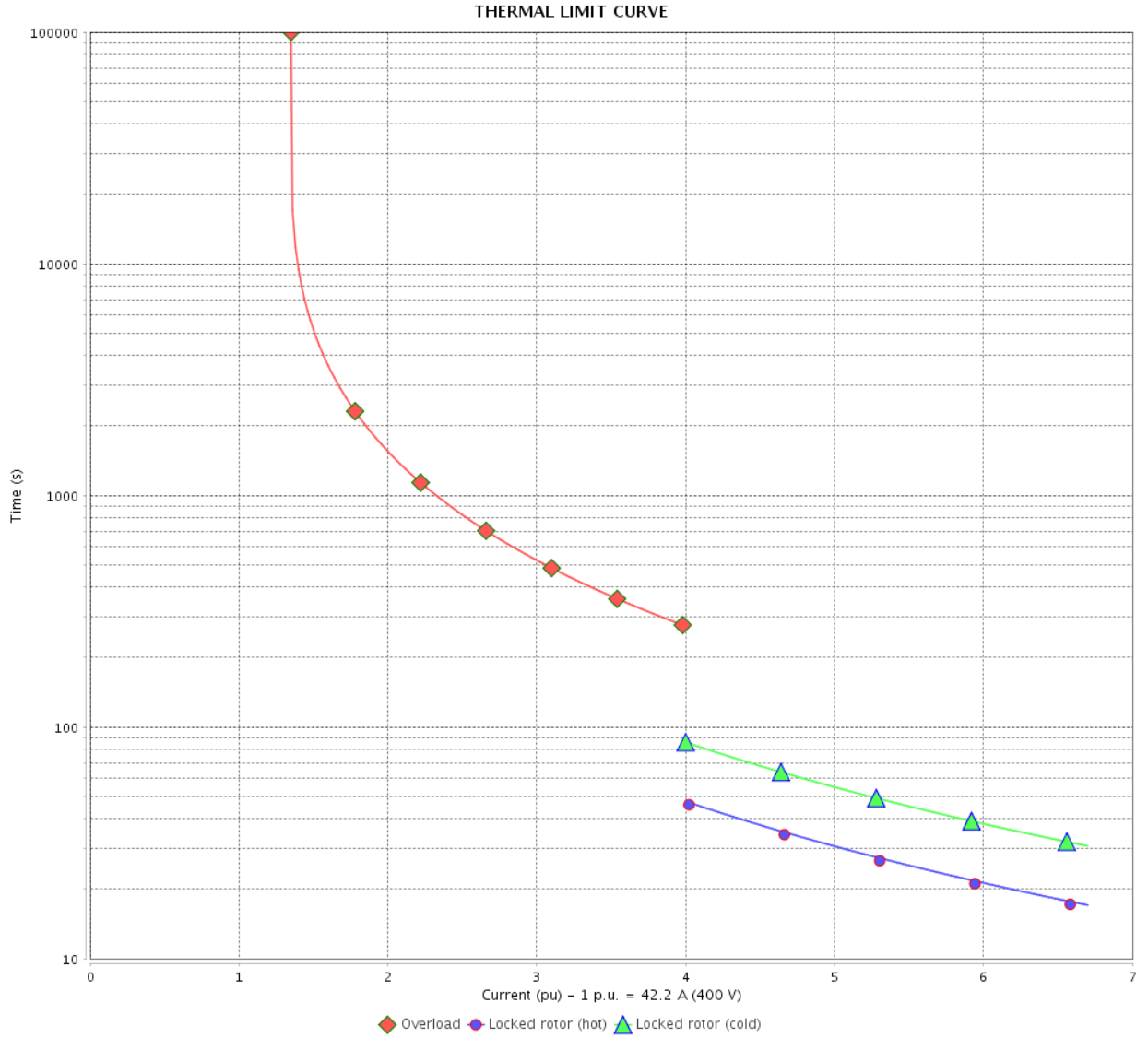

Rev.	Changes Summary	Performed	Checked	Date
Performed by		Page		Revision
Checked by		15 / 21		
Date		12/04/2022		

THERMAL LIMIT CURVE



Three Phase Induction Motor - Squirrel Cage

Customer :

Product line : W40 JM Pump NEMA Premium
Efficiency Three-Phase

Product code : 14837500

Catalog # : 04018OT3E324JMV-W40

Performance : 415 V 50 Hz 4P IE3

Rated current	: 41.7 A	Moment of inertia (J)	: 5.69 sq.ft.lb
LRC	: 7.5	Duty cycle	: Cont.(S1)
Rated torque	: 106 ft.lb	Insulation class	: F
Locked rotor torque	: 280 %	Service factor	: 1.00
Breakdown torque	: 330 %	Temperature rise	: 80 K
Rated speed	: 1480 rpm	Design	: B

Heating constant

Cooling constant

Rev.	Changes Summary	Performed	Checked	Date
Performed by				
Checked by			Page	Revision
Date	12/04/2022		16 / 21	

THERMAL LIMIT CURVE

Three Phase Induction Motor - Squirrel Cage



Customer : _____

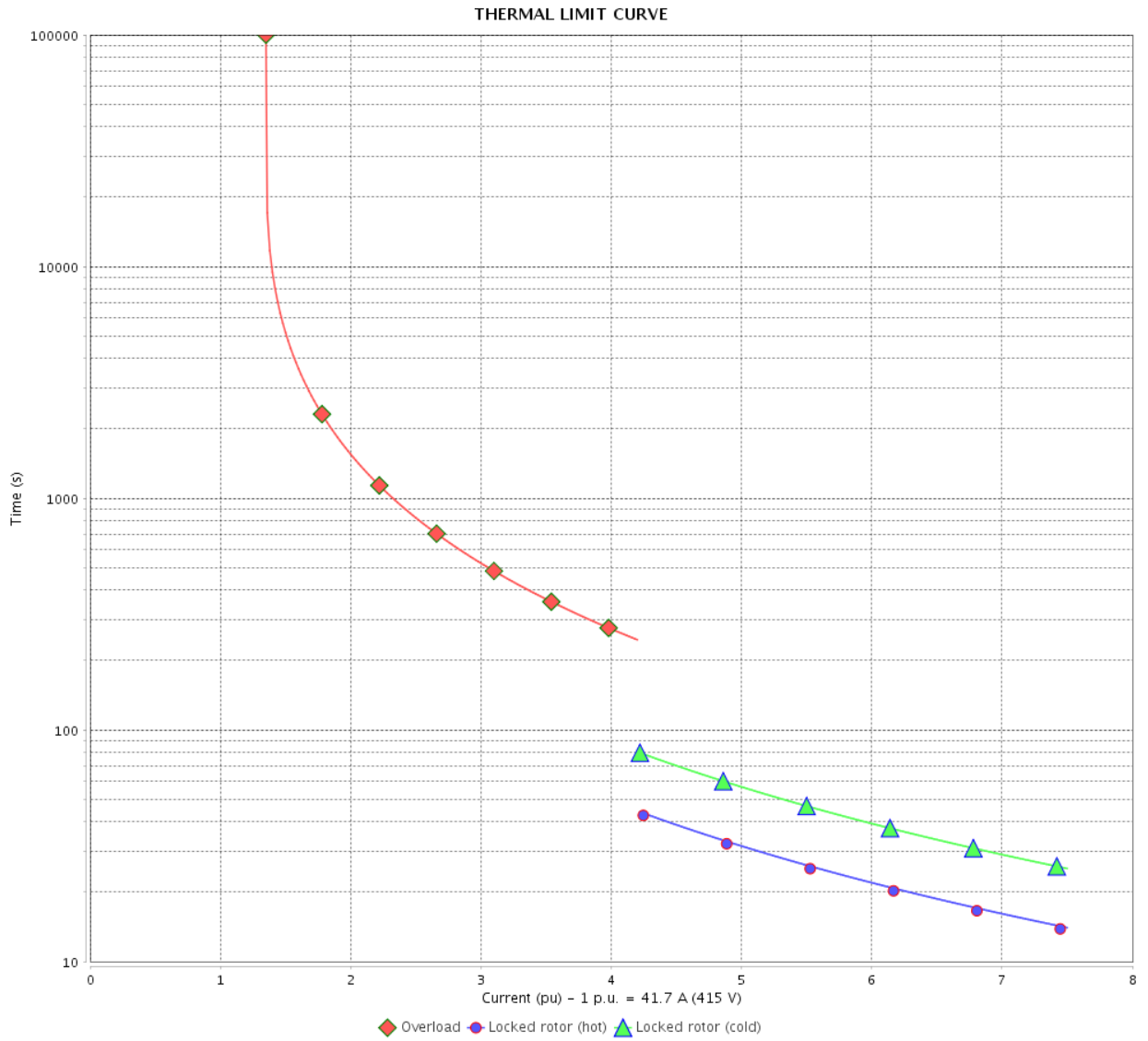

Rev.	Changes Summary	Performed	Checked	Date
Performed by		Page 17 / 21		Revision
Checked by				
Date				

VFD OPERATION CURVE

Three Phase Induction Motor - Squirrel Cage



Customer :

Product line : W40 JM Pump NEMA Premium Efficiency Three-Phase

Product code : 14837500

Catalog # : 04018OT3E324JMV-W40

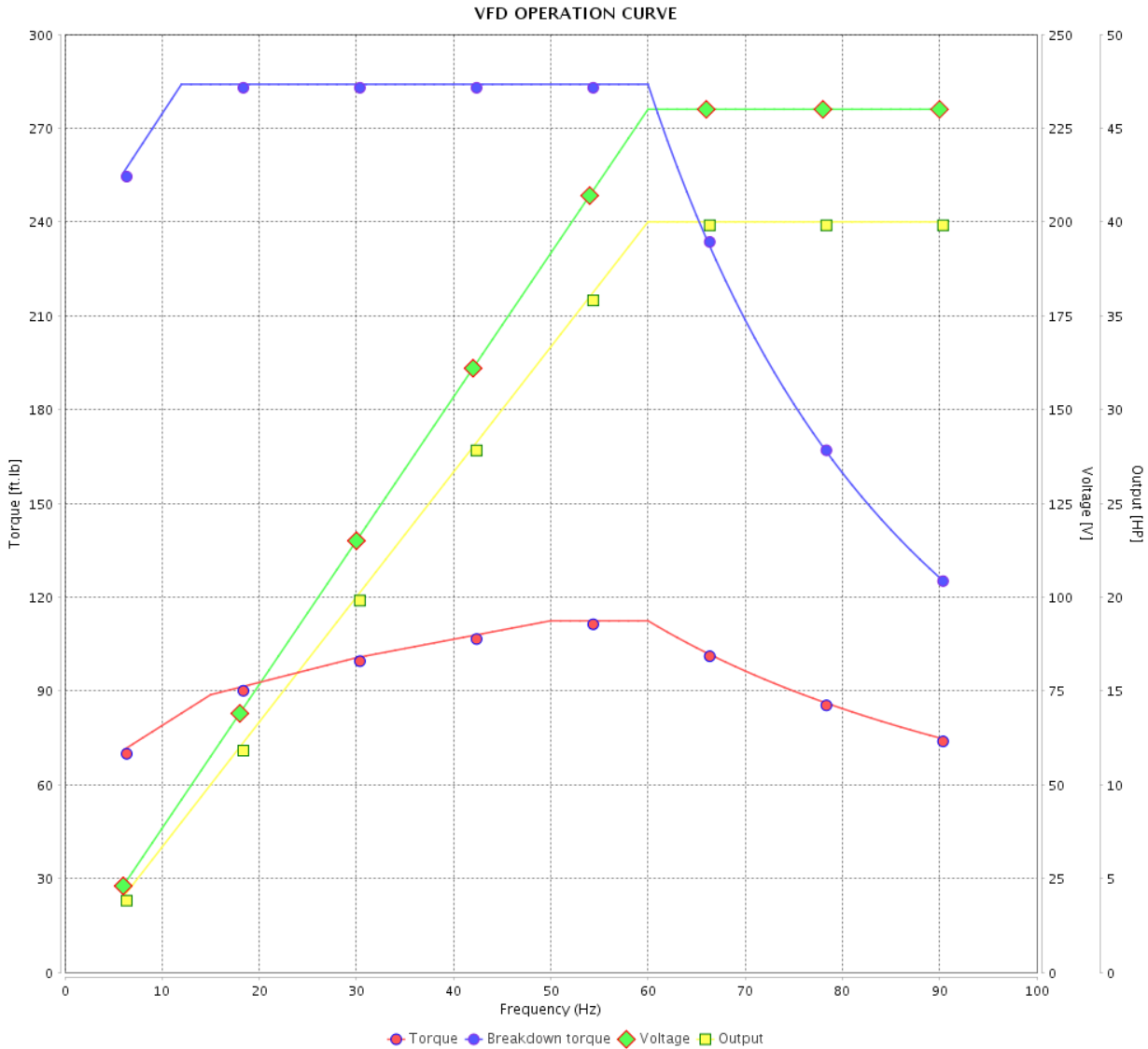

Performance : 230/460 V 60 Hz 4P

Rated current : 95.2/47.6 A
 LRC : 6.2
 Rated torque : 118 ft.lb
 Locked rotor torque : 200 %
 Breakdown torque : 240 %
 Rated speed : 1775 rpm

Moment of inertia (J) : 5.69 sq.ft.lb
 Duty cycle : Cont.(S1)
 Insulation class : F
 Service factor : 1.25
 Temperature rise : 80 K
 Design : B

Rev.	Changes Summary	Performed	Checked	Date
Performed by			Page 18 / 21	Revision
Checked by				
Date	12/04/2022			

VFD OPERATION CURVE

Three Phase Induction Motor - Squirrel Cage



Customer :

Product line : W40 JM Pump NEMA Premium Efficiency Three-Phase

Product code : 14837500

Catalog # : 04018OT3E324JMV-W40

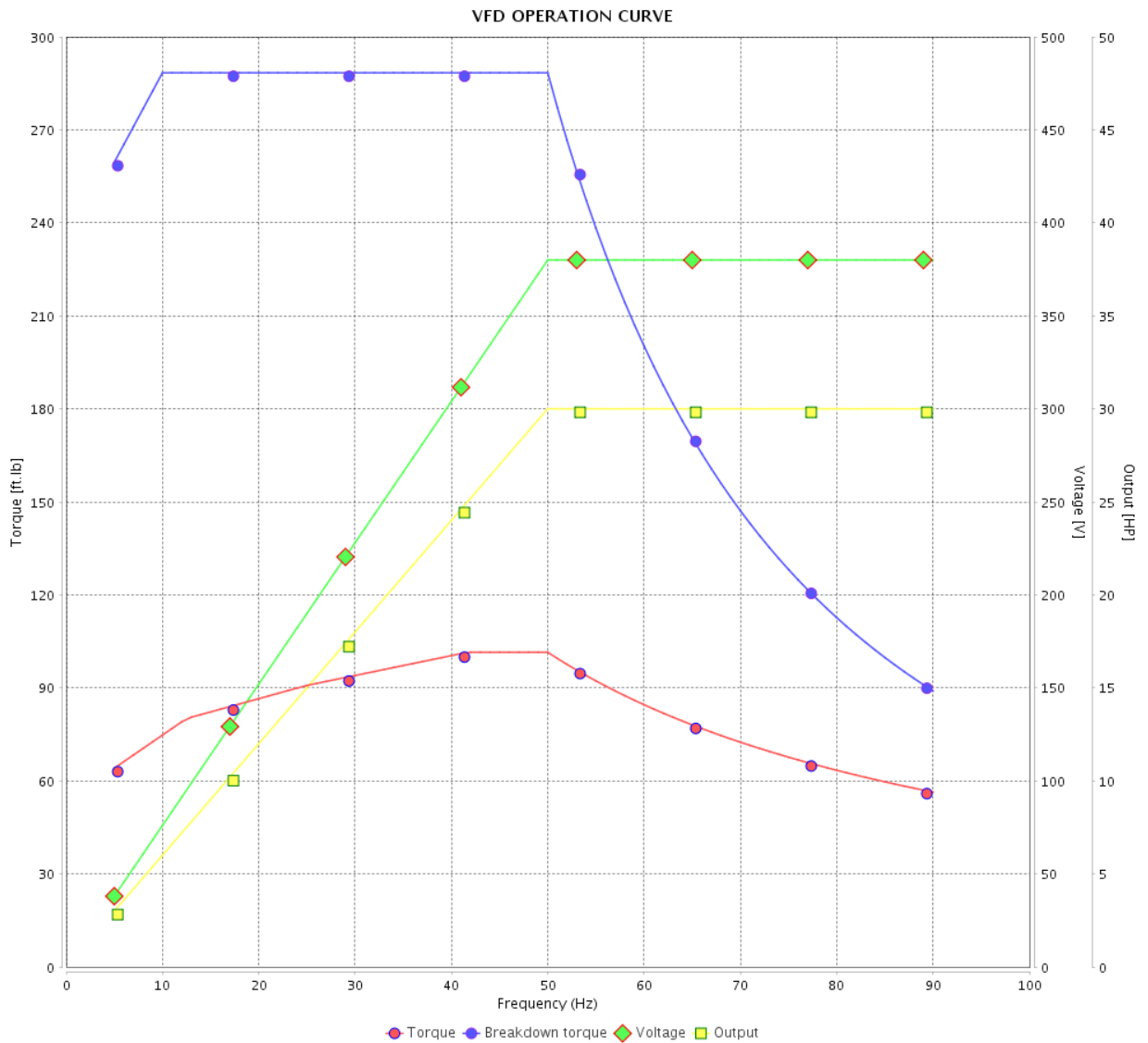

Performance : 380 V 50 Hz 4P IE3

Rated current : 43.3 A
 LRC : 6.7
 Rated torque : 107 ft.lb
 Locked rotor torque : 229 %
 Breakdown torque : 270 %
 Rated speed : 1475 rpm

Moment of inertia (J) : 5.69 sq.ft.lb
 Duty cycle : Cont.(S1)
 Insulation class : F
 Service factor : 1.00
 Temperature rise : 80 K
 Design : B

Rev.	Changes Summary	Performed	Checked	Date
Performed by			Page	Revision
Checked by			19 / 21	
Date	12/04/2022			

VFD OPERATION CURVE

Three Phase Induction Motor - Squirrel Cage



Customer :

Product line : W40 JM Pump NEMA Premium Efficiency Three-Phase

Product code : 14837500

Catalog # : 04018OT3E324JMV-W40

VFD OPERATION CURVE

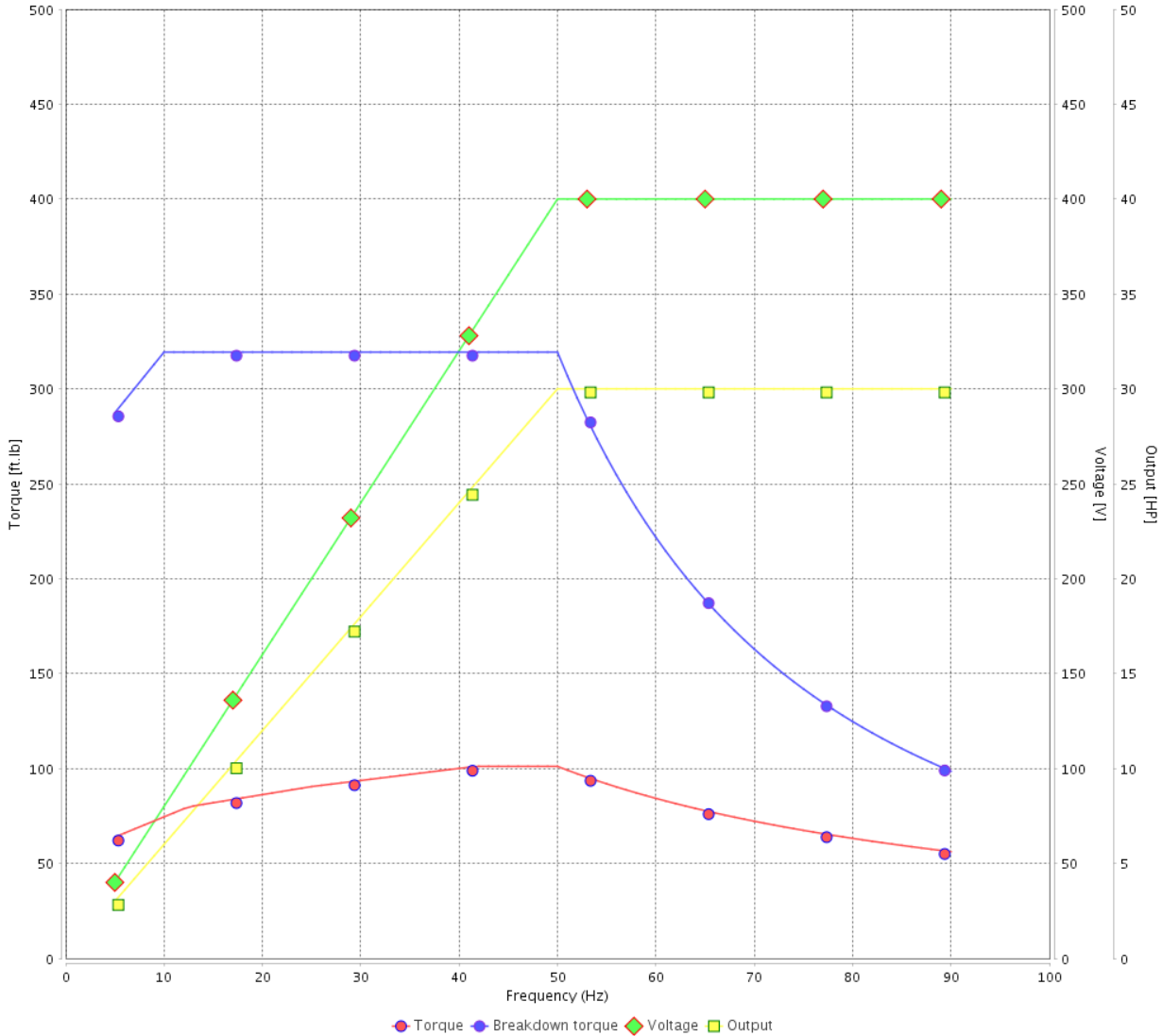

Performance : 400 V 50 Hz 4P IE3

Rated current : 42.2 A
 LRC : 6.7
 Rated torque : 106 ft.lb
 Locked rotor torque : 260 %
 Breakdown torque : 300 %
 Rated speed : 1480 rpm

Moment of inertia (J) : 5.69 sq.ft.lb
 Duty cycle : Cont.(S1)
 Insulation class : F
 Service factor : 1.00
 Temperature rise : 80 K
 Design : B

Rev.	Changes Summary	Performed	Checked	Date
Performed by			Page	Revision
Checked by				
Date				

VFD OPERATION CURVE

Three Phase Induction Motor - Squirrel Cage



Customer :

Product line : W40 JM Pump NEMA Premium Efficiency Three-Phase

Product code : 14837500

Catalog # : 04018OT3E324JMV-W40

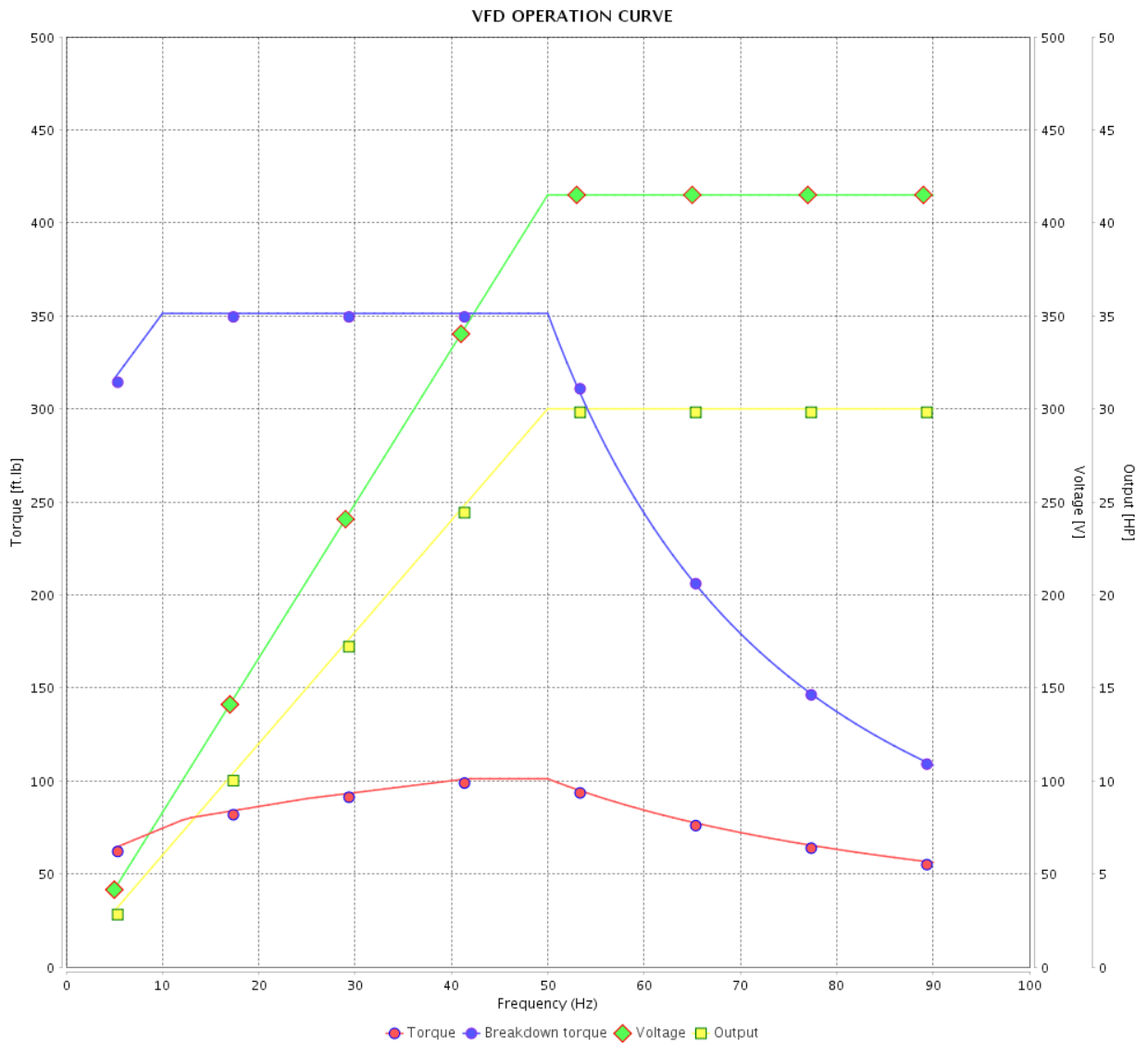

Performance : 415 V 50 Hz 4P IE3

Rated current : 41.7 A
 LRC : 7.5
 Rated torque : 106 ft.lb
 Locked rotor torque : 280 %
 Breakdown torque : 330 %
 Rated speed : 1480 rpm

Moment of inertia (J) : 5.69 sq.ft.lb
 Duty cycle : Cont.(S1)
 Insulation class : F
 Service factor : 1.00
 Temperature rise : 80 K
 Design : B

Rev.	Changes Summary	Performed	Checked	Date
Performed by			Page 21 / 21	Revision
Checked by				
Date	12/04/2022			

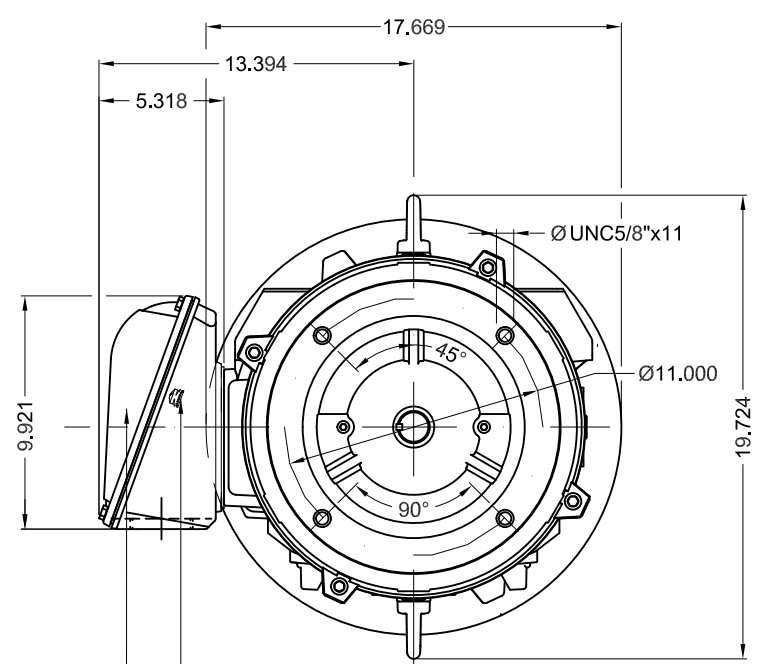

Grounding for leads 5.2-35 mm² / 10-2 AWG
Main terminal box
NPT 2"

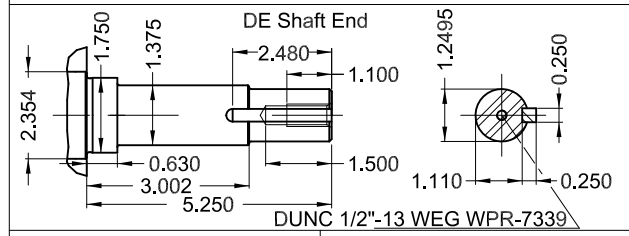
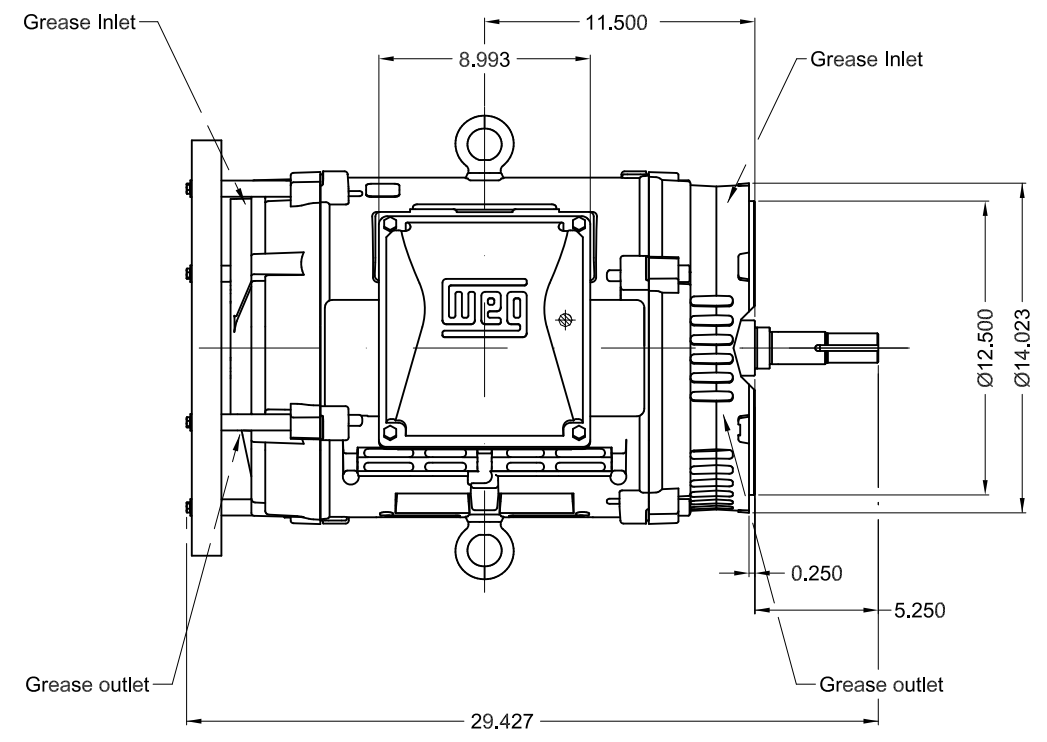

40 HP 04 Poles 60 Hz A

1:8

ECM	LOC	SUMMARY OF MODIFICATIONS	EXECUTED	CHECKED	RELEASED	DATE	VER
EXECUTED	PIRWBUSER	THREE PH. MOTOR W40 CLOSE COUPLED PUMP JM TYPE PREM-EST.					
CHECKED		FRAME 324/6JM IP23 ODP					
RELEASED							
REL DT.	WMO	Jaragua do Sul	Product Engineering	SHEET	1 / 1		

Color RAL 5009
Painting plan 203A
Mounting NEMA W-6
Mounting V18

PREVIEW
WDD

