

DATA SHEET



Three Phase Induction Motor - Squirrel Cage

Customer : _____						
Product line : NEMA Premium Efficiency Three-Phase		Product code : 11508504		Catalog # : 05012XT3H365T		
Frame : 364/5T Output : 50 HP (37 kW) Poles : 6 Frequency : 60 Hz Rated voltage : 575 V Rated current : 46.5 A L. R. Amperes : 344 A LRC : 7.4x(Code H) No load current : 19.2 A Rated speed : 1185 rpm Slip : 1.25 % Rated torque : 222 ft.lb Locked rotor torque : 260 % Breakdown torque : 280 % Insulation class : F Service factor : 1.15 Moment of inertia (J) : 29.4 sq.ft.lb Design : B	Locked rotor time : 36s (cold) 20s (hot) Temperature rise : 80 K Duty cycle : Cont.(S1) Ambient temperature : -20°C to +40°C Altitude : 1000 m.a.s.l. Protection degree : IP55 Cooling method : IC411 - TEFC Mounting : F-1 Rotation ¹ : Both (CW and CCW) Noise level ² : 65.0 dB(A) Starting method : Direct On Line Approx. weight ³ : 1017 lb					
Output	25%	50%	75%	100%	Foundation loads	
Efficiency (%)	93.5	93.6	94.1	94.1	Max. traction : 1618 lb	
Power Factor	0.44	0.71	0.81	0.85	Max. compression : 2634 lb	
			<u>Drive end</u>		<u>Non drive end</u>	
Bearing type	:		6314 C3		6314 C3	
Sealing	:		Oil Seal		Lip Seal	
Lubrication interval	:		14267 h		14267 h	
Lubricant amount	:		27 g		27 g	
Lubricant type	:		Mobil Polyrex EM			
Notes						
This revision replaces and cancel the previous one, which must be eliminated. (1) Looking the motor from the shaft end. (2) Measured at 1m and with tolerance of +3dB(A). (3) Approximate weight subject to changes after manufacturing process. (4) At 100% of full load.			These are average values based on tests with sinusoidal power supply, subject to the tolerances stipulated in NEMA MG-1.			
Rev.	Changes Summary			Performed	Checked	Date
Performed by						
Checked by					Page	Revision
Date	12/04/2022				1 / 7	

DATA SHEET

Three Phase Induction Motor - Squirrel Cage



Customer : _____

Thermal protection

ID	Application	Type	Quantity	Sensing Temperature
1	Winding	Thermostat - 2 wires	1 x Phase	155 °C

Rev.	Changes Summary	Performed	Checked	Date
Performed by				
Checked by			Page	Revision
Date	12/04/2022		2 / 7	

TORQUE AND CURRENT VS SPEED CURVE



Three Phase Induction Motor - Squirrel Cage

Customer :

Product line : NEMA Premium Efficiency Three-Phase

Product code : 11508504

Catalog # : 05012XT3H365T

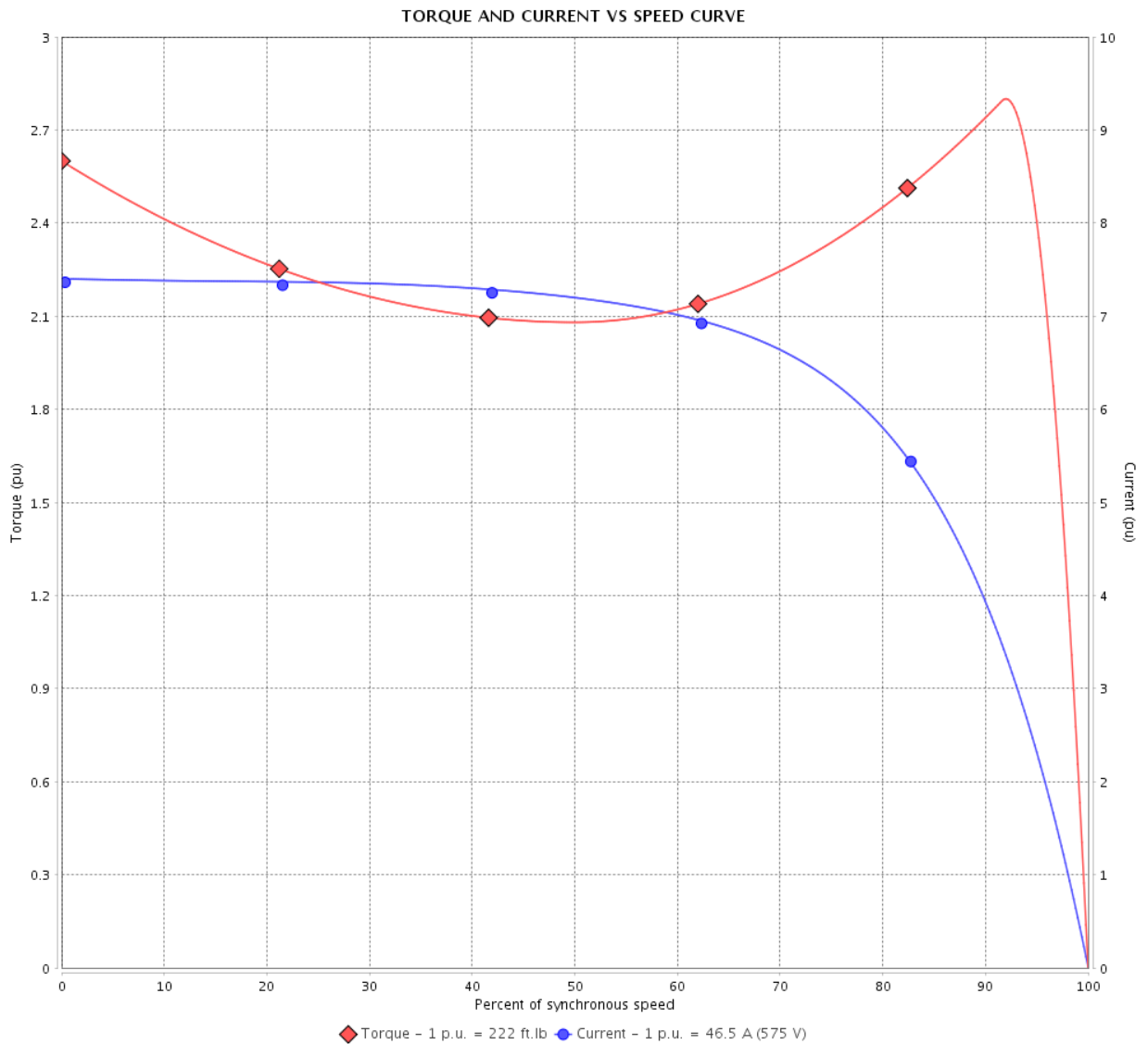

Performance : 575 V 60 Hz 6P

Rated current	: 46.5 A	Moment of inertia (J)	: 29.4 sq.ft.lb
LRC	: 7.4	Duty cycle	: Cont.(S1)
Rated torque	: 222 ft.lb	Insulation class	: F
Locked rotor torque	: 260 %	Service factor	: 1.15
Breakdown torque	: 280 %	Temperature rise	: 80 K
Rated speed	: 1185 rpm	Design	: B

Locked rotor time : 36s (cold) 20s (hot)

Rev.	Changes Summary	Performed	Checked	Date
Performed by			Page 3 / 7	Revision
Checked by				
Date	12/04/2022			

LOAD PERFORMANCE CURVE

Three Phase Induction Motor - Squirrel Cage



Customer :

Product line : NEMA Premium Efficiency Three-Phase

Product code : 11508504

Catalog # : 05012XT3H365T

LOAD PERFORMANCE CURVE

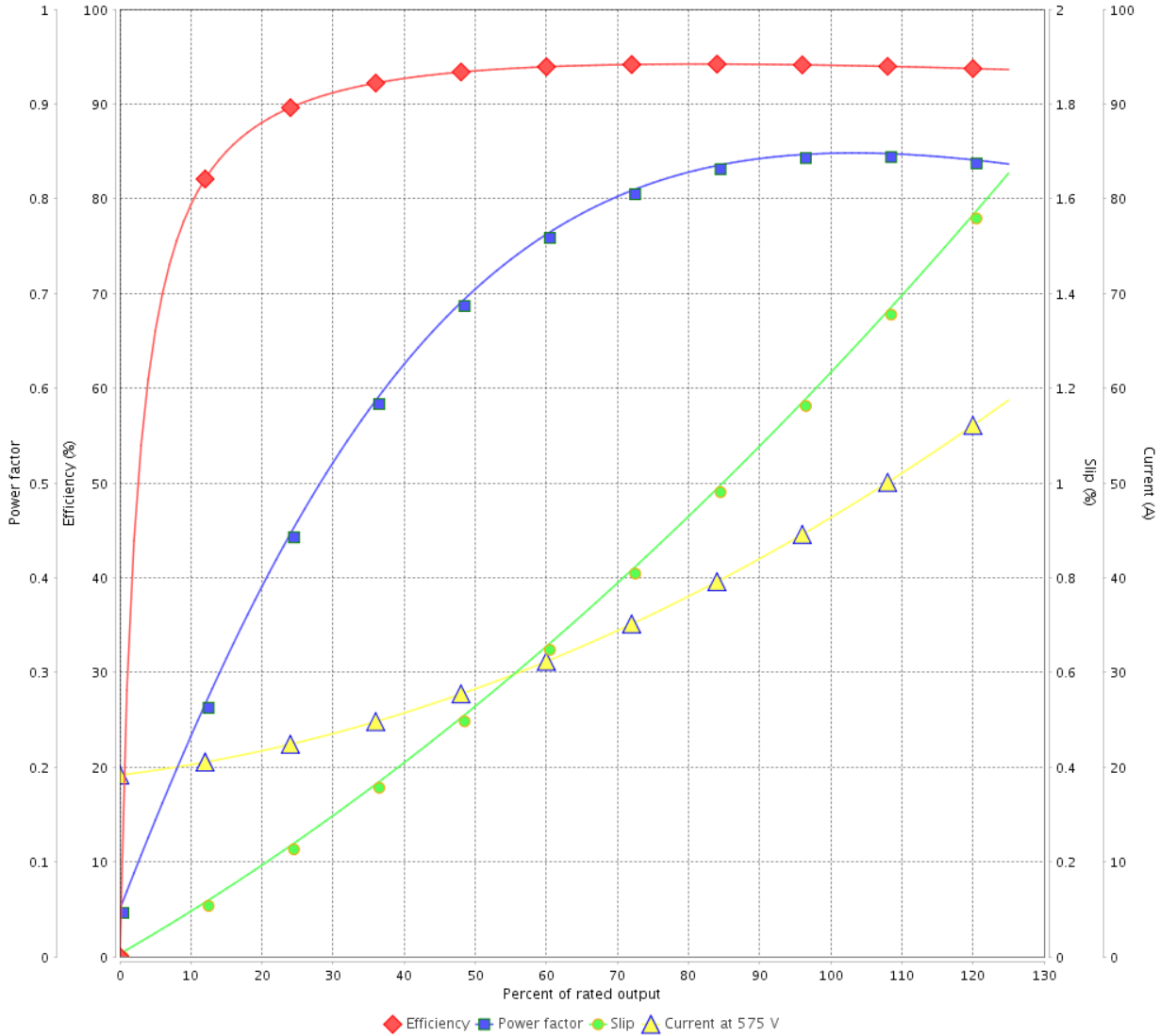

Performance : 575 V 60 Hz 6P

Rated current	: 46.5 A	Moment of inertia (J)	: 29.4 sq.ft.lb
LRC	: 7.4	Duty cycle	: Cont.(S1)
Rated torque	: 222 ft.lb	Insulation class	: F
Locked rotor torque	: 260 %	Service factor	: 1.15
Breakdown torque	: 280 %	Temperature rise	: 80 K
Rated speed	: 1185 rpm	Design	: B

Rev.	Changes Summary	Performed	Checked	Date
Performed by			Page 4 / 7	Revision
Checked by				
Date	12/04/2022			

THERMAL LIMIT CURVE



Three Phase Induction Motor - Squirrel Cage

Customer :

Product line : NEMA Premium Efficiency Three-Phase
 Product code : 11508504
 Catalog # : 05012XT3H365T

Performance : 575 V 60 Hz 6P

Rated current : 46.5 A	Moment of inertia (J) : 29.4 sq.ft.lb
LRC : 7.4	Duty cycle : Cont.(S1)
Rated torque : 222 ft.lb	Insulation class : F
Locked rotor torque : 260 %	Service factor : 1.15
Breakdown torque : 280 %	Temperature rise : 80 K
Rated speed : 1185 rpm	Design : B

Heating constant

Cooling constant

Rev.	Changes Summary	Performed	Checked	Date
Performed by			Page 5 / 7	Revision
Checked by				
Date	12/04/2022			

THERMAL LIMIT CURVE

Three Phase Induction Motor - Squirrel Cage



Customer : _____

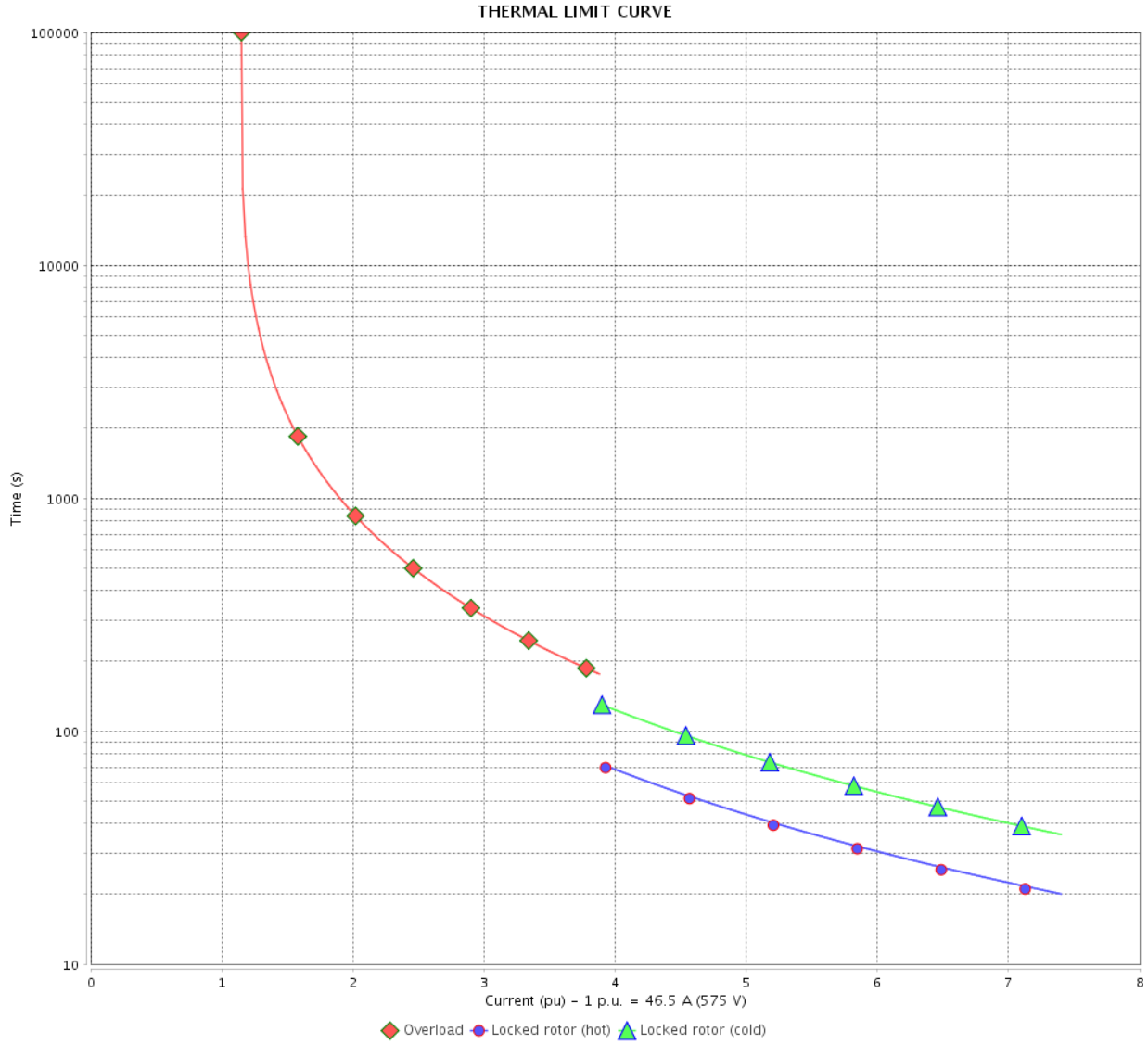

Rev.	Changes Summary	Performed	Checked	Date
Performed by		Page 6 / 7		Revision
Checked by				
Date				

VFD OPERATION CURVE

Three Phase Induction Motor - Squirrel Cage



Customer :

Product line : NEMA Premium Efficiency Three-Phase

Product code : 11508504

Catalog # : 05012XT3H365T

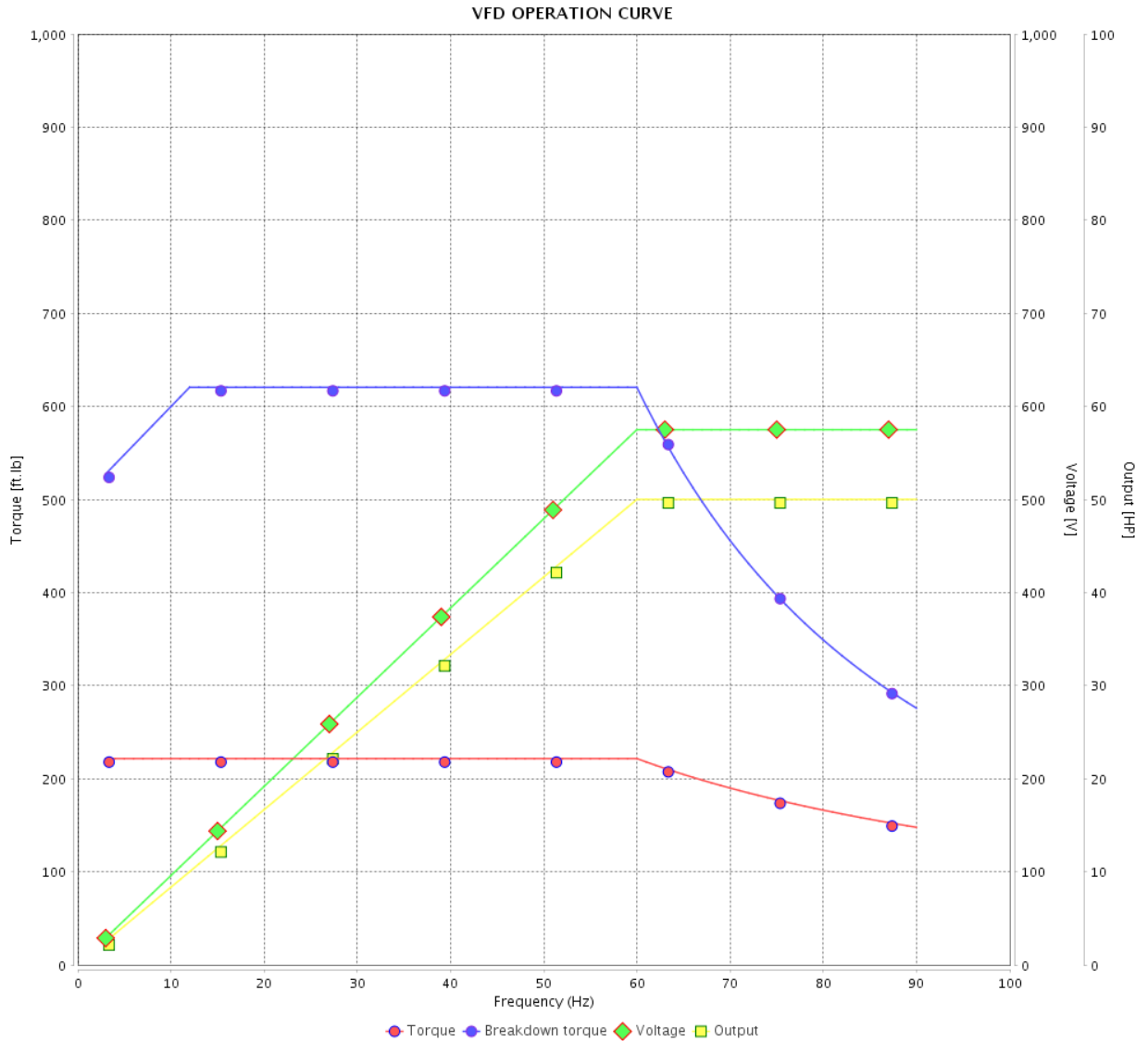

Performance : 575 V 60 Hz 6P

Rated current : 46.5 A
 LRC : 7.4
 Rated torque : 222 ft.lb
 Locked rotor torque : 260 %
 Breakdown torque : 280 %
 Rated speed : 1185 rpm

Moment of inertia (J) : 29.4 sq.ft.lb
 Duty cycle : Cont.(S1)
 Insulation class : F
 Service factor : 1.15
 Temperature rise : 80 K
 Design : B

Rev.	Changes Summary	Performed	Checked	Date
Performed by				Page 7 / 7
Checked by				
Date	12/04/2022			

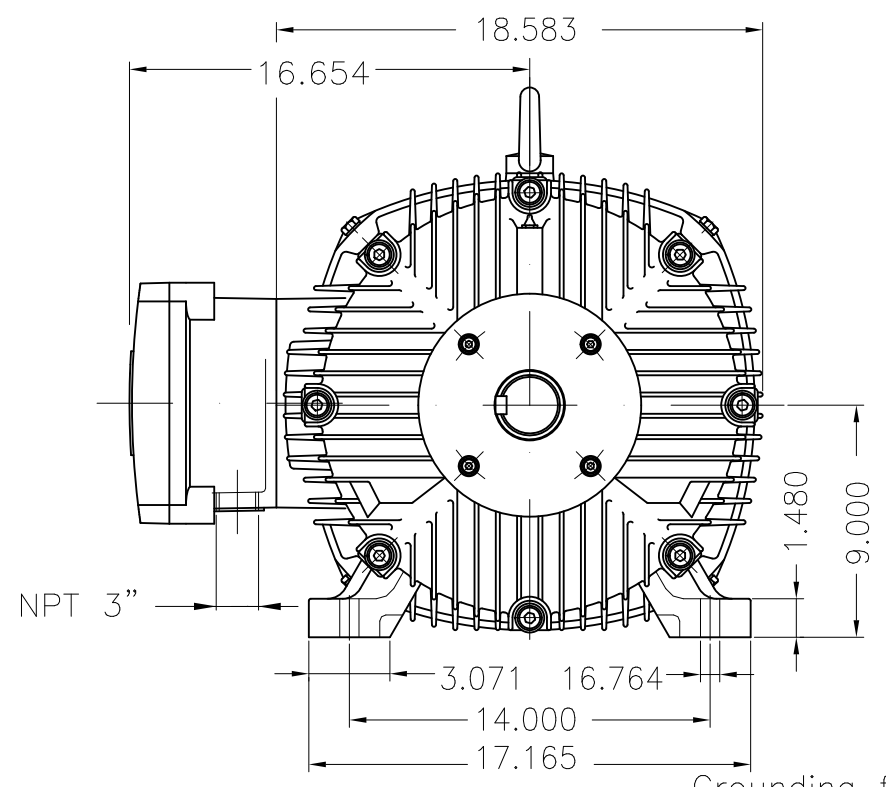

Grounding for leads 25-50 mm² / 3-1 AWG

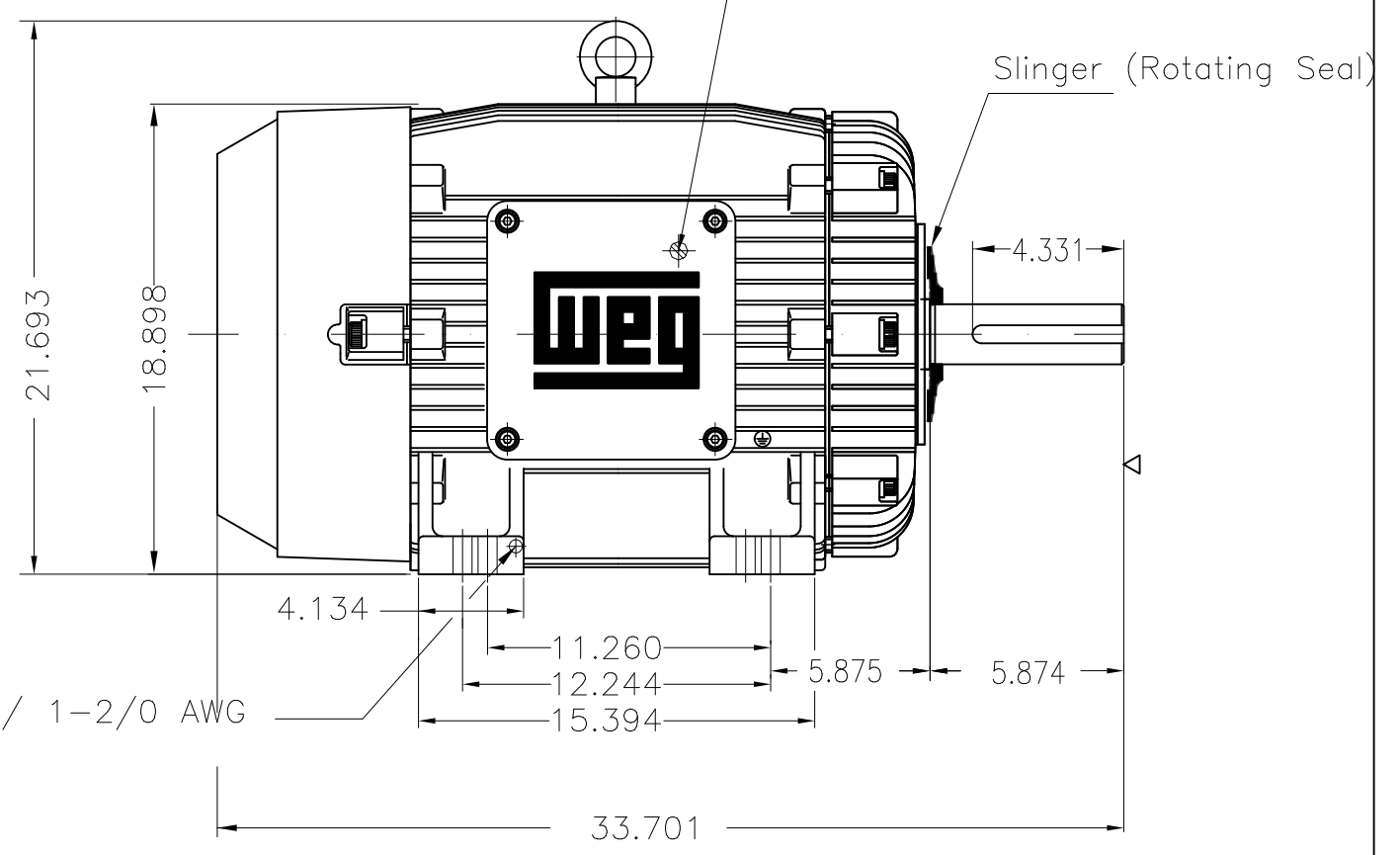

Grounding for leads 35-70 mm² / 1-2/0 AWG

50 HP 06 Poles 60 Hz A

Color RAL 5009
 Painting plan 202P
 Mounting B3R(D)

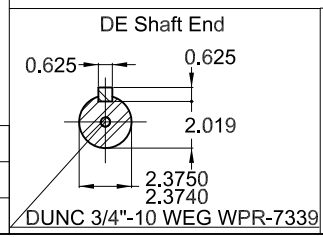

ECM	LOC	SUMMARY OF MODIFICATIONS	EXECUTED	CHECKED	RELEASED	DATE	VER
EXECUTED	PIRWBUSER	THREE PH. MOTOR EXPLOSION PROOF PREM. EFF.					
CHECKED		FRAME 364/5T IP55 TEFC					
RELEASED							
REL DT.	WMO	Jaragua do Sul	Product Engineering				

PREVIEW
 WDD



SHEET 1 / 1