

DATA SHEET



Three Phase Induction Motor - Squirrel Cage

Customer :				
Product line	: NEMA Premium Efficiency Three-Phase	Product code :	12693674	
		Catalog # :	06018ET3E364T-W22G	
Frame	: 364/5T	Cooling method	: IC411 - TEFC	
Insulation class	: F	Mounting	: F-1	
Duty cycle	: Cont.(S1)	Rotation ¹	: Both (CW and CCW)	
Ambient temperature	: -20°C to +40°C	Starting method	: Direct On Line	
Altitude	: 1000 m.a.s.l.	Approx. weight ²	: 919 lb	
Protection degree	: IP55	Moment of inertia (J)		
Design	: B			
Output [HP]	60		60	
Poles	4		4	
Frequency [Hz]	60		50	
Rated voltage [V]	208-230/460		380	
Rated current [A]	151-137/68.5		86.5	
L. R. Amperes [A]	936-849/425		450	
LRC [A]	6.2x(Code G)		5.2x(Code E)	
No load current [A]	44.8-52.0/26.0		23.8	
Rated speed [RPM]	1780		1470	
Slip [%]	1.11		2.00	
Rated torque [ft.lb]	177		214	
Locked rotor torque [%]	220		160	
Breakdown torque [%]	240		200	
Service factor	1.25		1.00	
Temperature rise	80 K		80 K	
Locked rotor time	27s (cold) 15s (hot)		18s (cold) 10s (hot)	
Noise level ²	67.0 dB(A)		63.0 dB(A)	
Efficiency (%)	25%	0.000	0.000	
	50%	94.1	94.1	
	75%	94.5	93.6	
	100%	95.0	93.0	
Power Factor	25%	0.00	0.00	
	50%	0.71	0.76	
	75%	0.80	0.82	
	100%	0.83	0.85	
Bearing type	: <u>Drive end</u> 6314 C3 <u>Non drive end</u> 6314 C3	Foundation loads		
Sealing	: WSeal WSeal	Max. traction	: 1007 lb	
Lubrication interval	: 12000 h 12000 h	Max. compression	: 1927 lb	
Lubricant amount	: 27 g 27 g			
Lubricant type	: Mobil Polyrex EM			
Notes				
This revision replaces and cancel the previous one, which must be eliminated. (1) Looking the motor from the shaft end. (2) Measured at 1m and with tolerance of +3dB(A). (3) Approximate weight subject to changes after manufacturing process. (4) At 100% of full load.		These are average values based on tests with sinusoidal power supply, subject to the tolerances stipulated in NEMA MG-1.		
Rev.	Changes Summary	Performed	Checked	Date
Performed by				
Checked by			Page	Revision
Date	13/04/2022		1 / 11	

TORQUE AND CURRENT VS SPEED CURVE

Three Phase Induction Motor - Squirrel Cage



Customer :

Product line : NEMA Premium Efficiency Three-Phase

Product code : 12693674

Catalog # : 06018ET3E364T-W22G

TORQUE AND CURRENT VS SPEED CURVE

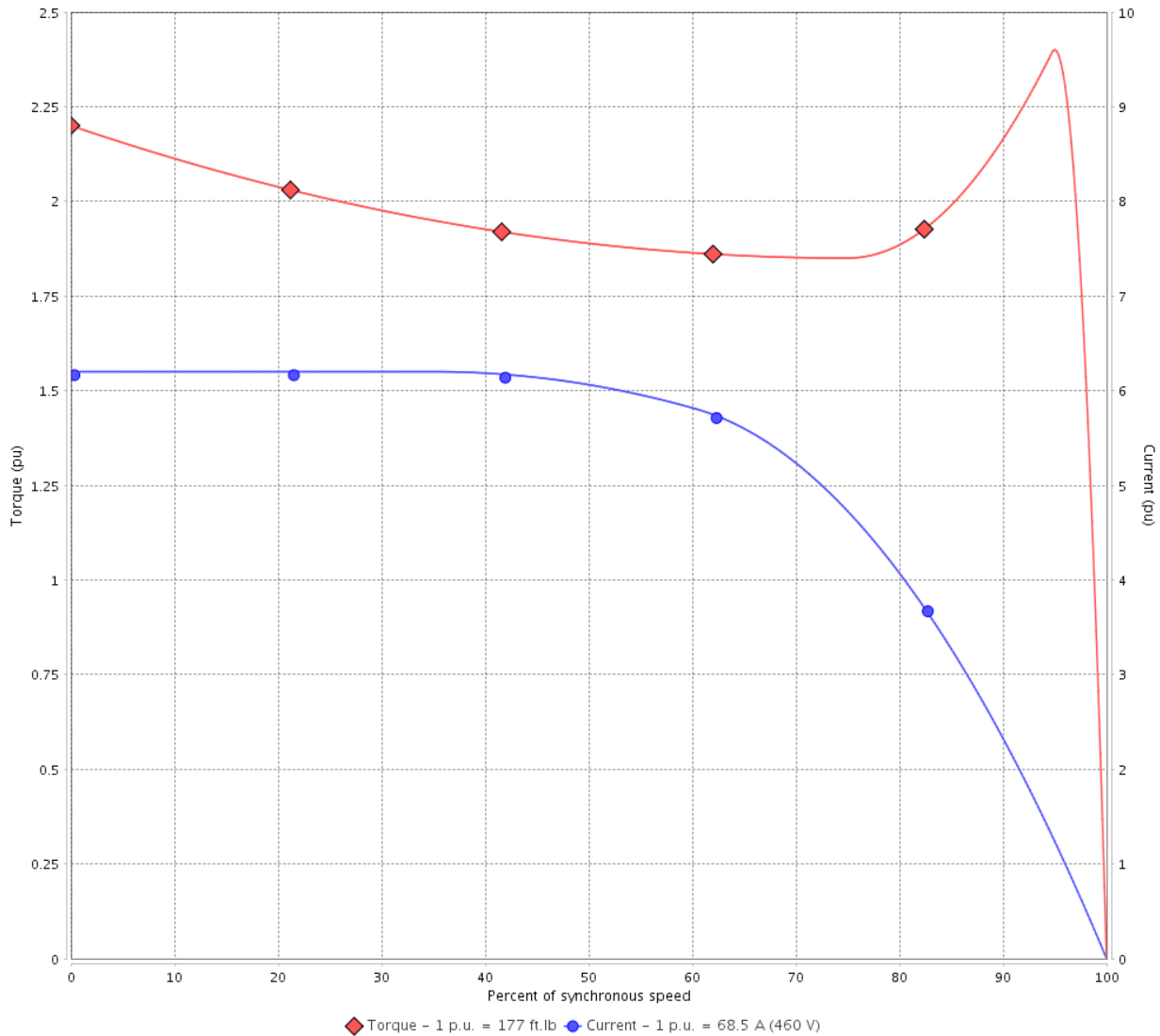

Performance : 208-230/460 V 60 Hz 4P

Rated current	: 151-137/68.5 A	Moment of inertia (J)	
LRC	: 6.2	Duty cycle	: Cont.(S1)
Rated torque	: 177 ft.lb	Insulation class	: F
Locked rotor torque	: 220 %	Service factor	: 1.25
Breakdown torque	: 240 %	Temperature rise	: 80 K
Rated speed	: 1780 rpm	Design	: B

Locked rotor time : 27s (cold) 15s (hot)

Rev.	Changes Summary	Performed	Checked	Date
Performed by			Page 2 / 11	Revision
Checked by				
Date	13/04/2022			

TORQUE AND CURRENT VS SPEED CURVE



Three Phase Induction Motor - Squirrel Cage

Customer :

Product line : NEMA Premium Efficiency Three-Phase

Product code : 12693674

Catalog # : 06018ET3E364T-W22G

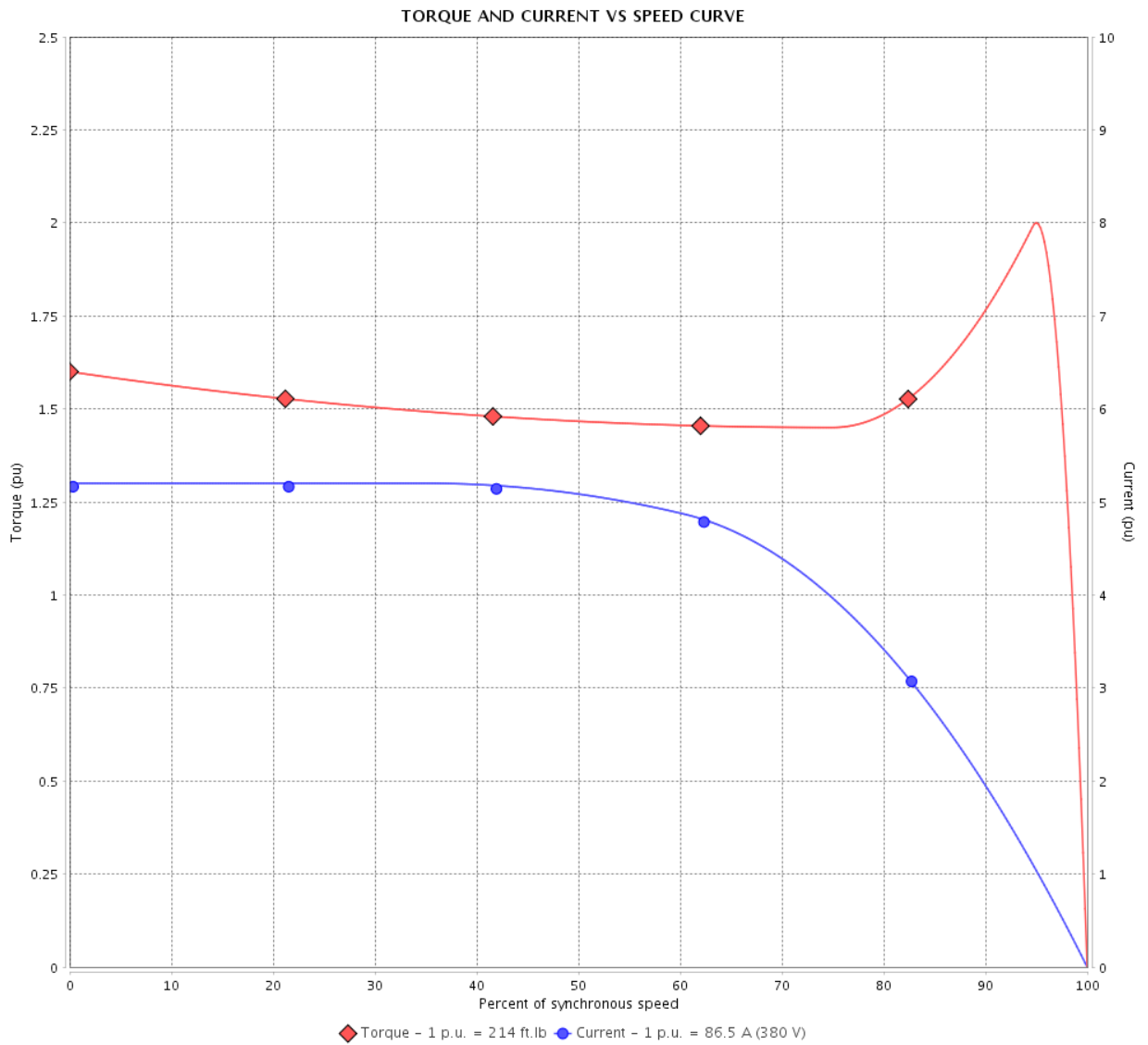

Performance : 380 V 50 Hz 4P

Rated current : 86.5 A
 LRC : 5.2
 Rated torque : 214 ft.lb
 Locked rotor torque : 160 %
 Breakdown torque : 200 %
 Rated speed : 1470 rpm

Moment of inertia (J)
 Duty cycle : Cont.(S1)
 Insulation class : F
 Service factor : 1.00
 Temperature rise : 80 K
 Design : B

Locked rotor time : 18s (cold) 10s (hot)

Rev.	Changes Summary	Performed	Checked	Date
Performed by			Page 3 / 11	Revision
Checked by				
Date	13/04/2022			

LOAD PERFORMANCE CURVE

Three Phase Induction Motor - Squirrel Cage



Customer :

Product line : NEMA Premium Efficiency Three-Phase

Product code : 12693674

Catalog # : 06018ET3E364T-W22G

LOAD PERFORMANCE CURVE

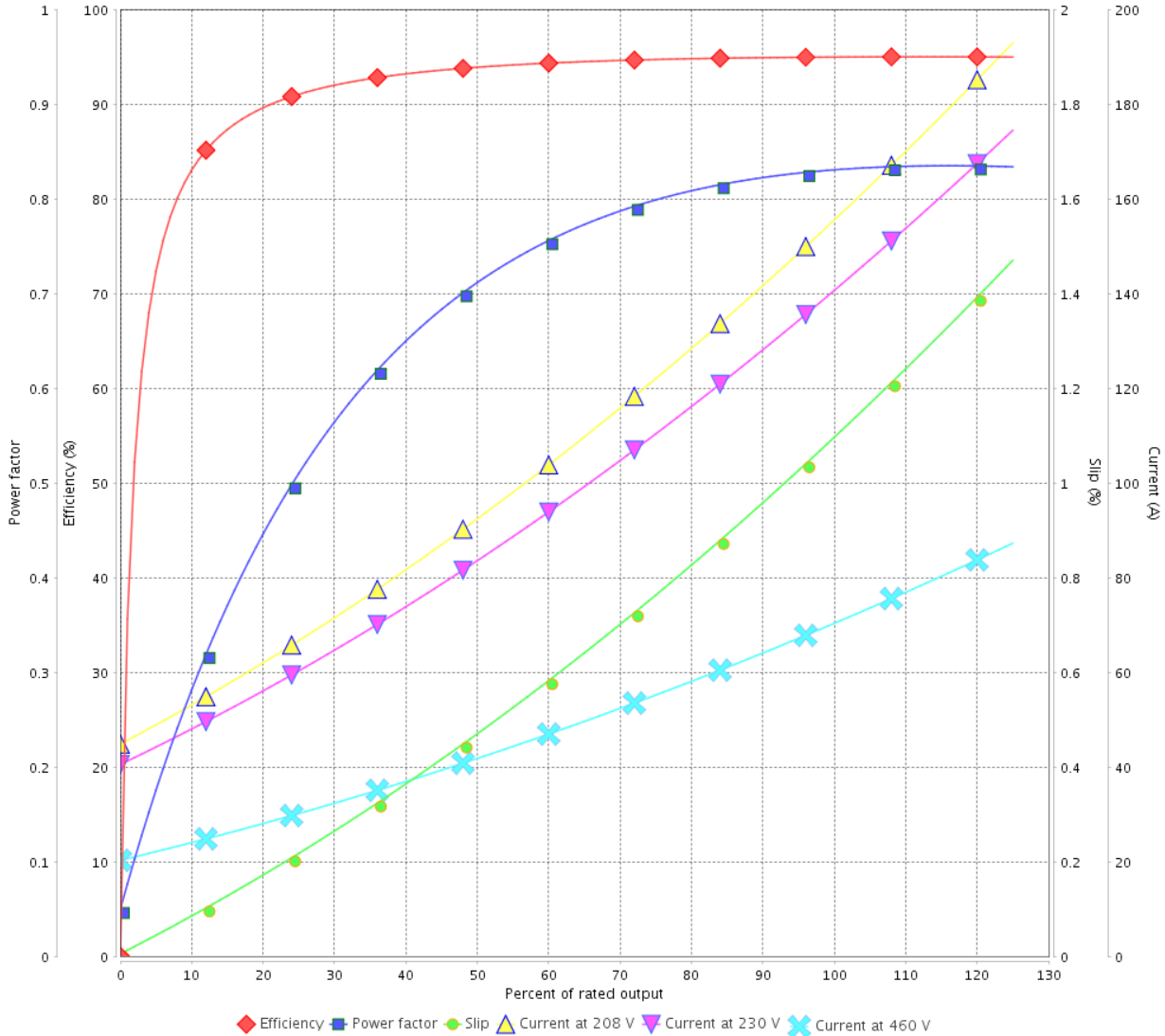

Performance : 208-230/460 V 60 Hz 4P

Rated current : 151-137/68.5 A
 LRC : 6.2
 Rated torque : 177 ft.lb
 Locked rotor torque : 220 %
 Breakdown torque : 240 %
 Rated speed : 1780 rpm

Moment of inertia (J)
 Duty cycle : Cont.(S1)
 Insulation class : F
 Service factor : 1.25
 Temperature rise : 80 K
 Design : B

Rev.	Changes Summary	Performed	Checked	Date
Performed by			Page	Revision
Checked by			4 / 11	
Date	13/04/2022			

LOAD PERFORMANCE CURVE

Three Phase Induction Motor - Squirrel Cage



Customer : _____

Product line : NEMA Premium Efficiency Three-Phase

Product code : 12693674

Catalog # : 06018ET3E364T-W22G

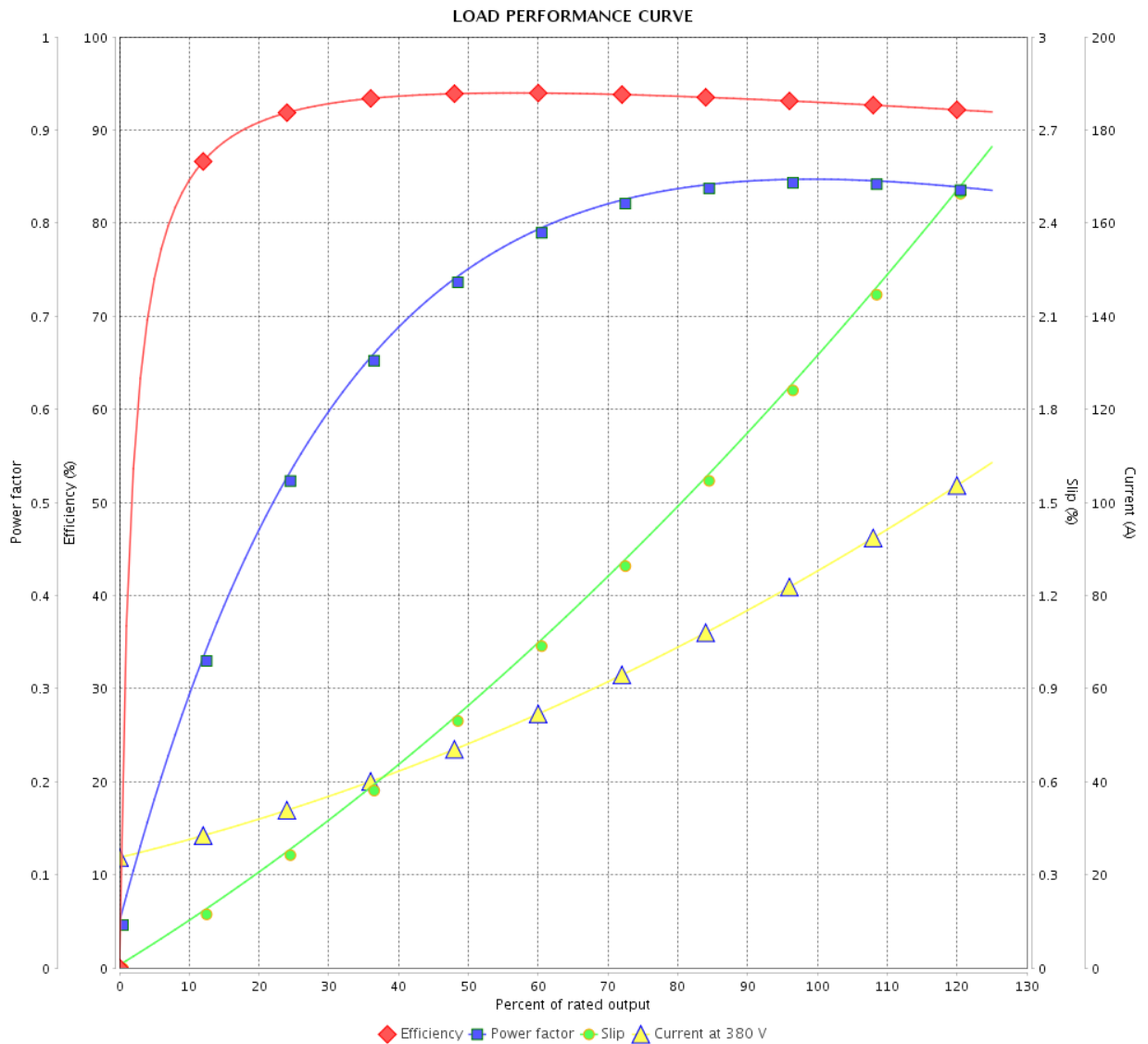

Performance : 380 V 50 Hz 4P

Rated current : 86.5 A
 LRC : 5.2
 Rated torque : 214 ft.lb
 Locked rotor torque : 160 %
 Breakdown torque : 200 %
 Rated speed : 1470 rpm

Moment of inertia (J)
 Duty cycle : Cont.(S1)
 Insulation class : F
 Service factor : 1.00
 Temperature rise : 80 K
 Design : B

Rev.	Changes Summary	Performed	Checked	Date
Performed by			Page	Revision
Checked by				
Date				

THERMAL LIMIT CURVE



Three Phase Induction Motor - Squirrel Cage

Customer :

Product line : NEMA Premium Efficiency Three-Phase
 Product code : 12693674
 Catalog # : 06018ET3E364T-W22G

Performance : 208-230/460 V 60 Hz 4P

Rated current : 151-137/68.5 A	Moment of inertia (J)
LRC : 6.2	Duty cycle : Cont.(S1)
Rated torque : 177 ft.lb	Insulation class : F
Locked rotor torque : 220 %	Service factor : 1.25
Breakdown torque : 240 %	Temperature rise : 80 K
Rated speed : 1780 rpm	Design : B

Heating constant

Cooling constant

Rev.	Changes Summary	Performed	Checked	Date
Performed by			Page 6 / 11	Revision
Checked by				
Date	13/04/2022			

THERMAL LIMIT CURVE

Three Phase Induction Motor - Squirrel Cage



Customer : _____

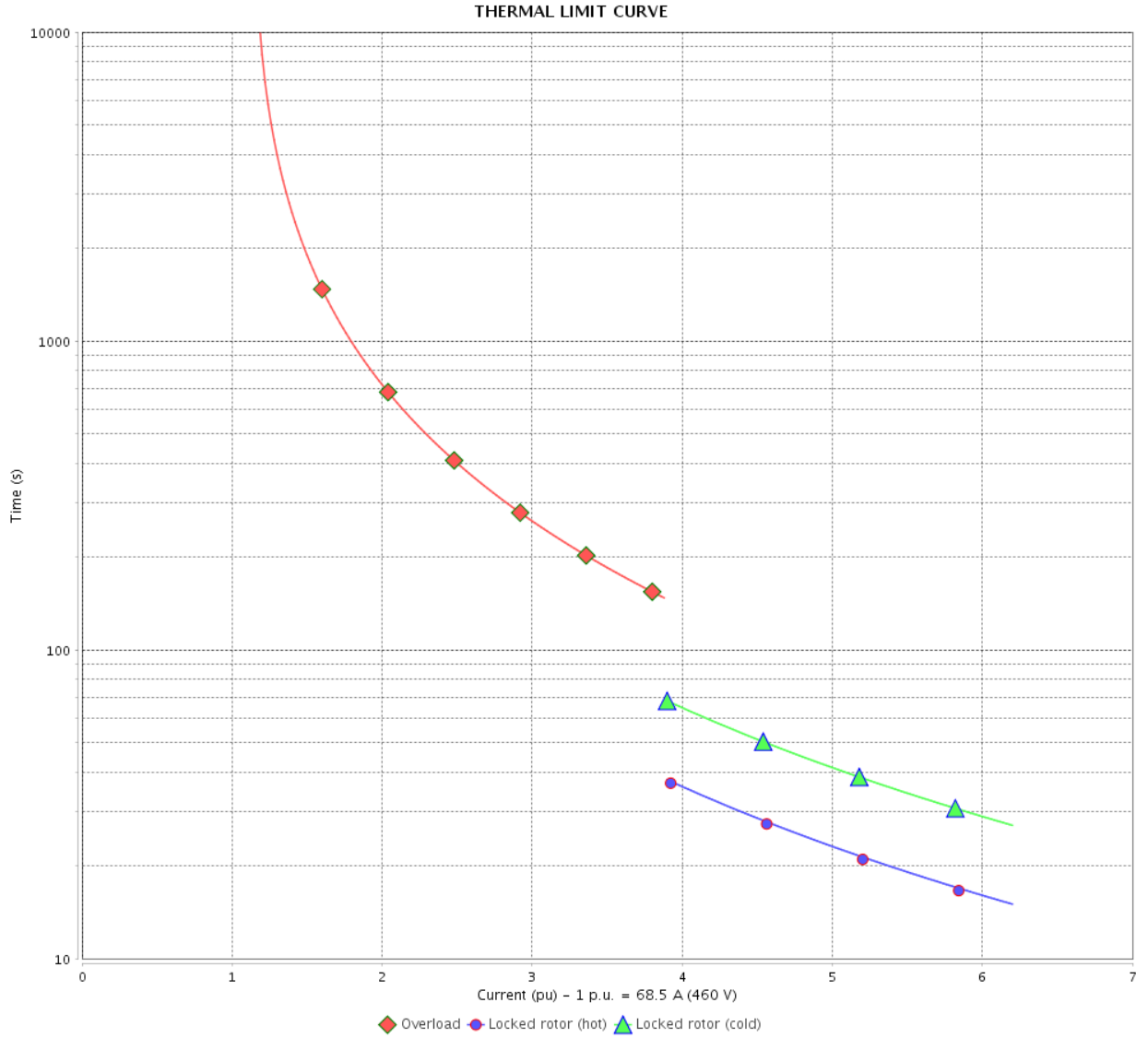

Rev.	Changes Summary	Performed	Checked	Date
Performed by		Page		Revision
Checked by		7 / 11		
Date		13/04/2022		

THERMAL LIMIT CURVE



Three Phase Induction Motor - Squirrel Cage

Customer :

Product line : NEMA Premium Efficiency Three-Phase
Product code : 12693674
Catalog # : 06018ET3E364T-W22G

Performance : 380 V 50 Hz 4P

Rated current	: 86.5 A	Moment of inertia (J)	
LRC	: 5.2	Duty cycle	: Cont.(S1)
Rated torque	: 214 ft.lb	Insulation class	: F
Locked rotor torque	: 160 %	Service factor	: 1.00
Breakdown torque	: 200 %	Temperature rise	: 80 K
Rated speed	: 1470 rpm	Design	: B

Heating constant

Cooling constant

Rev.	Changes Summary	Performed	Checked	Date
Performed by				
Checked by			Page	Revision
Date	13/04/2022		8 / 11	

THERMAL LIMIT CURVE

Three Phase Induction Motor - Squirrel Cage



Customer : _____

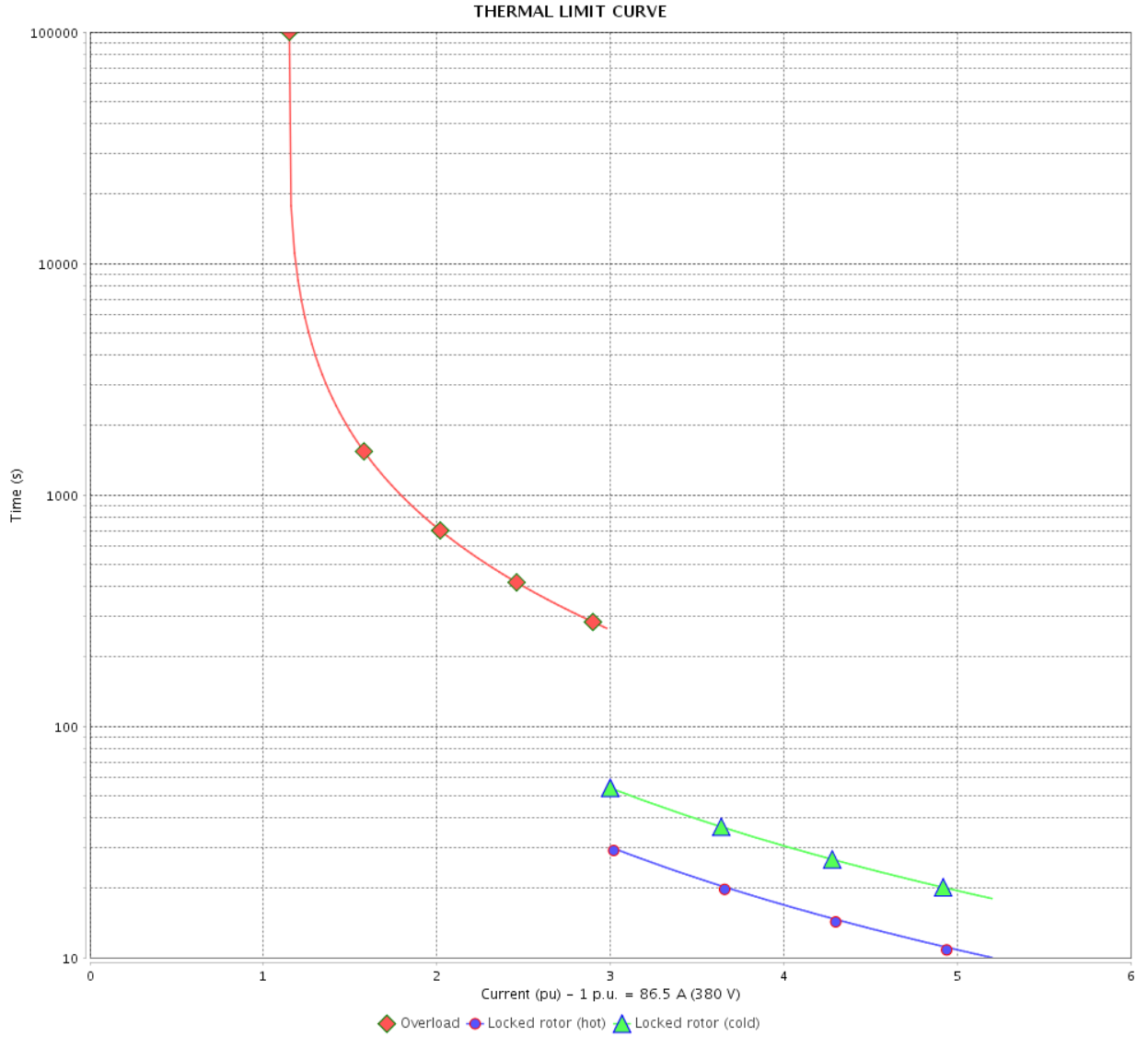

Rev.	Changes Summary	Performed	Checked	Date
Performed by				
Checked by				
Date				
			Page	Revision
			9 / 11	

VFD OPERATION CURVE

Three Phase Induction Motor - Squirrel Cage



Customer :

Product line : NEMA Premium Efficiency Three-Phase

Product code : 12693674

Catalog # : 06018ET3E364T-W22G

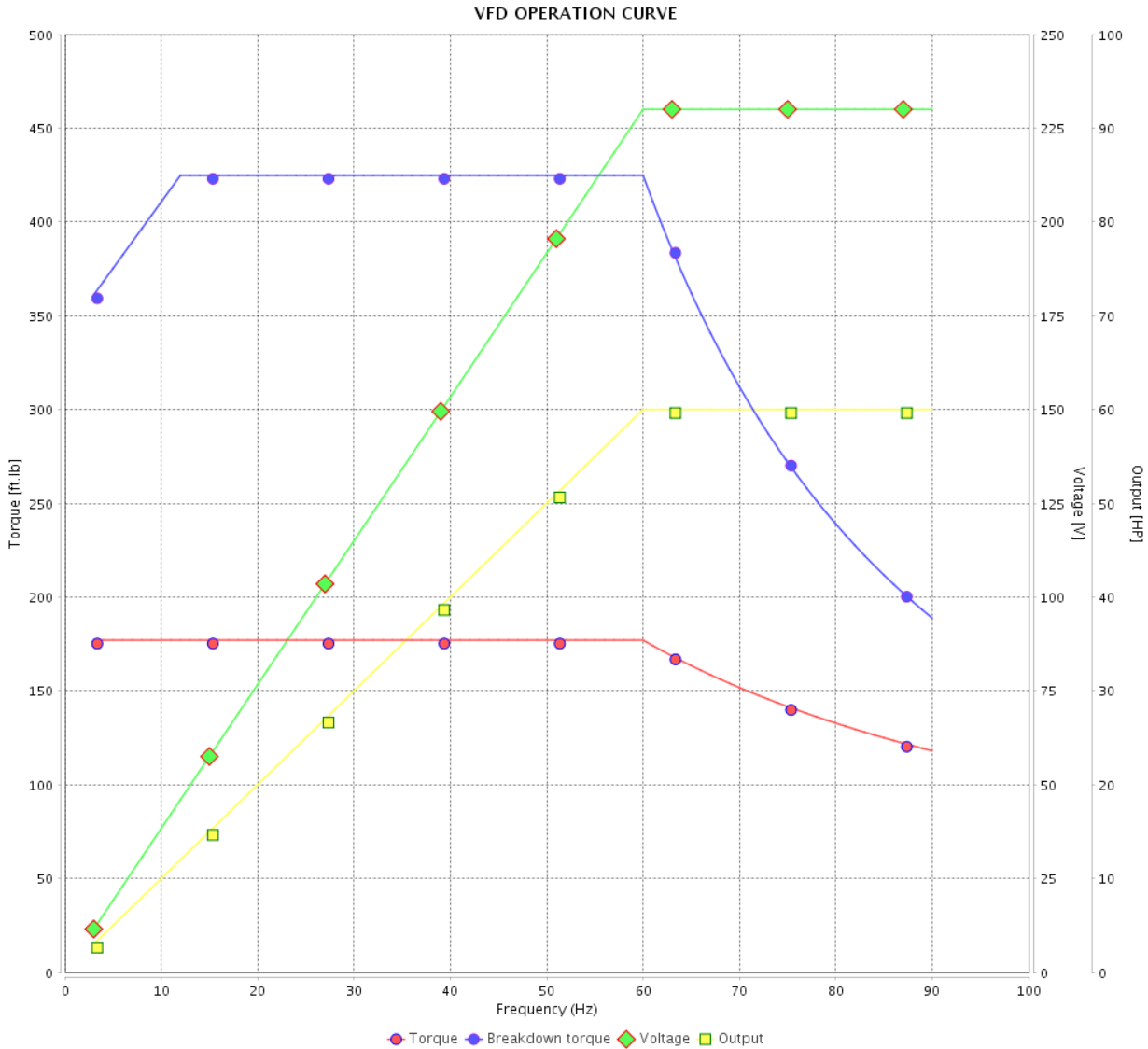

Performance : 208-230/460 V 60 Hz 4P

Rated current : 151-137/68.5 A
 LRC : 6.2
 Rated torque : 177 ft.lb
 Locked rotor torque : 220 %
 Breakdown torque : 240 %
 Rated speed : 1780 rpm

Moment of inertia (J)
 Duty cycle : Cont.(S1)
 Insulation class : F
 Service factor : 1.25
 Temperature rise : 80 K
 Design : B

Rev.	Changes Summary	Performed	Checked	Date
Performed by			Page	Revision
Checked by				
Date				

VFD OPERATION CURVE

Three Phase Induction Motor - Squirrel Cage



Customer :

Product line : NEMA Premium Efficiency Three-Phase

Product code : 12693674

Catalog # : 06018ET3E364T-W22G

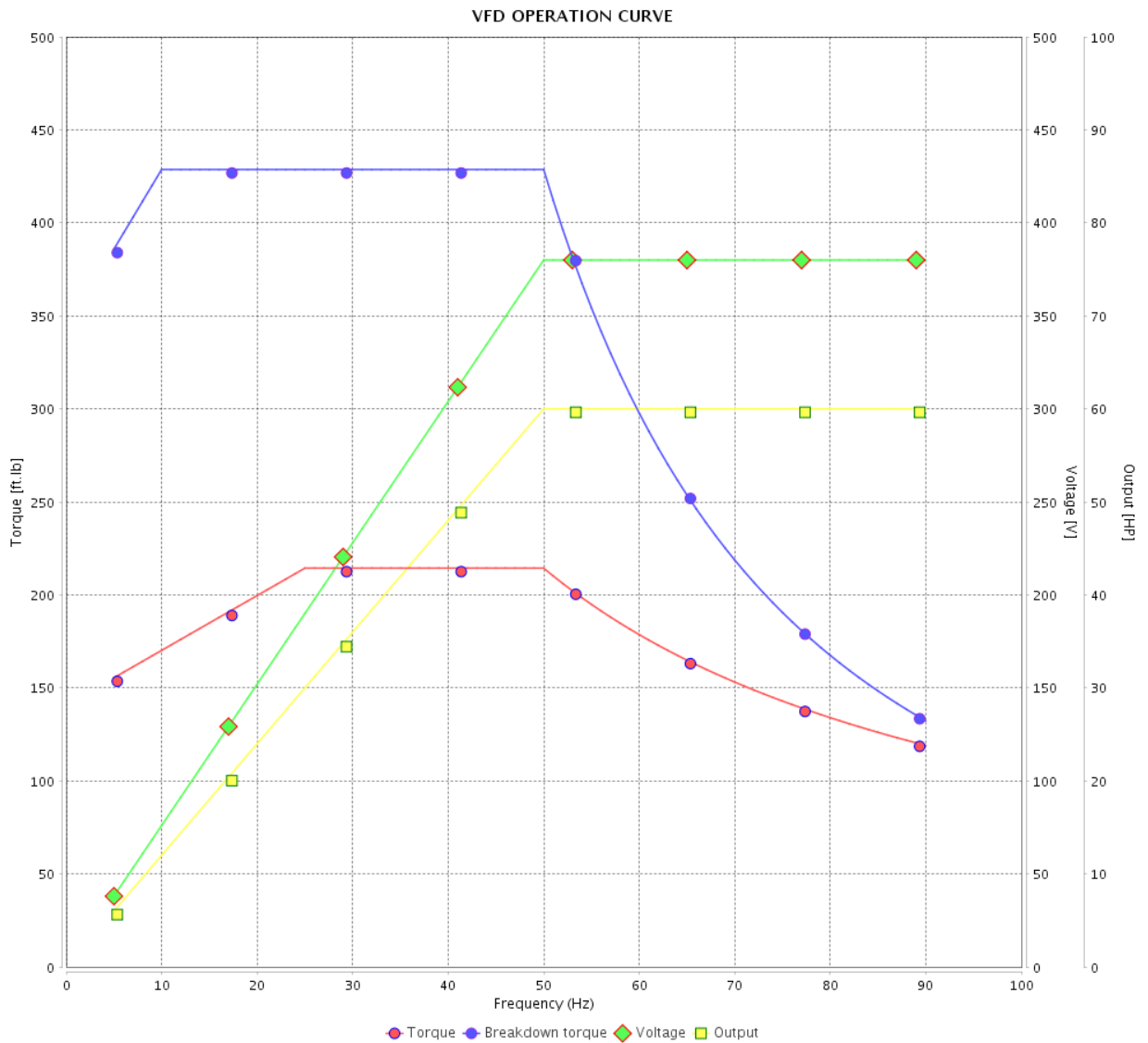

Performance : 380 V 50 Hz 4P

Rated current : 86.5 A
 LRC : 5.2
 Rated torque : 214 ft.lb
 Locked rotor torque : 160 %
 Breakdown torque : 200 %
 Rated speed : 1470 rpm

Moment of inertia (J)
 Duty cycle : Cont.(S1)
 Insulation class : F
 Service factor : 1.00
 Temperature rise : 80 K
 Design : B

Rev.	Changes Summary	Performed	Checked	Date
Performed by		Page		Revision
Checked by		11 / 11		
Date	13/04/2022			

EIXO/SHAFT	
PADRÃO/STANDARD	X
OPCIONAL/OPTIONAL	
ESPECIAL/SPECIAL	

Dimensões em polegadas
Dimensions in inches

THIS IS AN UPDATED REVISION, THE PREVIOUS ONE MUST BE DISREGARDED.

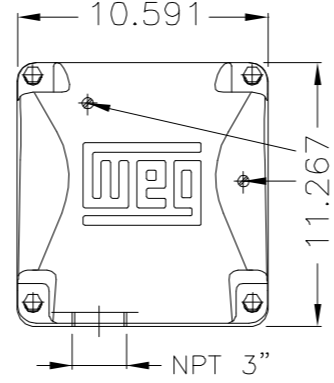

Main terminal box

Grounding for leads 25-50mm²

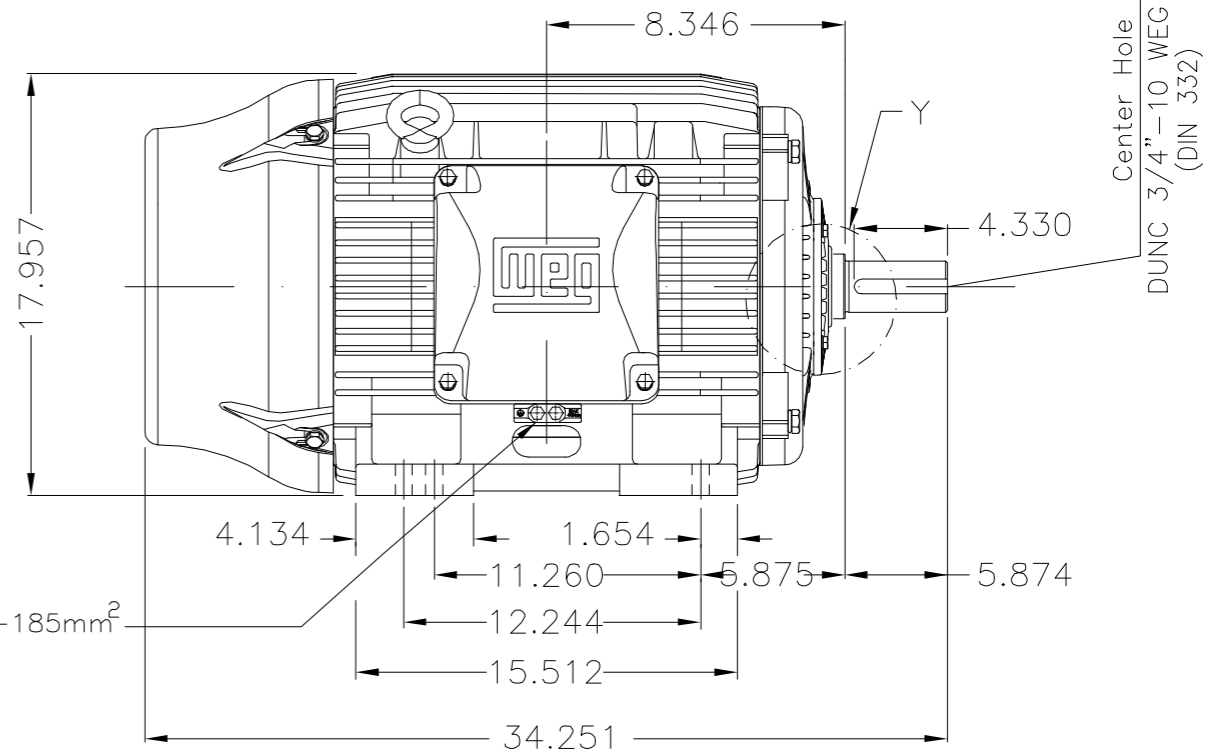
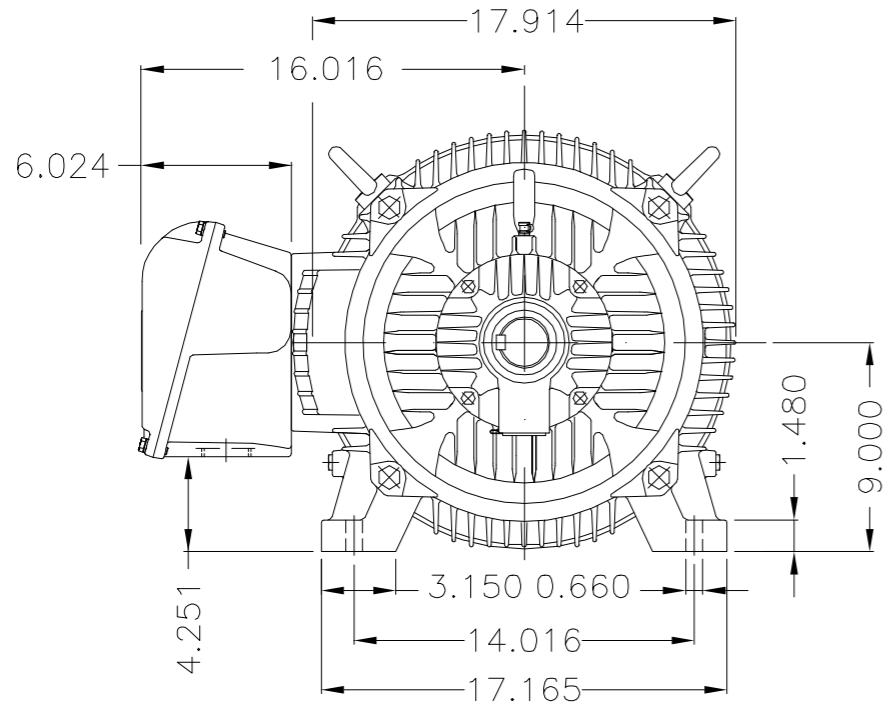

Center Hole
DUNC 3/4"-10 WEG TBG12
(DIN 332)

Grounding for leads 25-185mm²

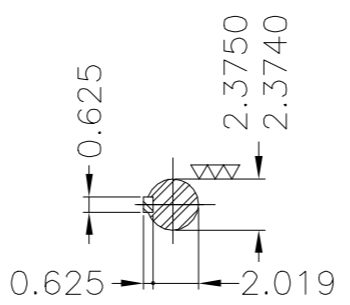

DE Shaft End

Anel de aterramento

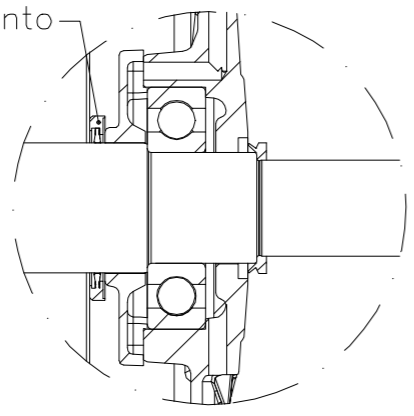

Detail Y

Kit porta escova de aterramento AEGIS interno na tampa dianteira /
Brush holder Kit AEGIS internal D.E.
Plano de pintura 203A / Painting plan 203A
Forma construtiva NEMA F-1 / Mounting NEMA F-1
Forma construtiva B3D / Mounting B3R(D)

WEG ELECTRIC CORP.

500000900937		RETIRADO NOTA MANCAL ISOLADO	WILLIANR	PATRICKL	11.06.2014	03
500000893425		RETIRADO CARIMBO LOTE PILOTO	WILLIANR	DWAGNER	22.05.2014	02
ECM	LOC	SUMMARY OF MODIFICATIONS	EXECUTED	CHECKED	RELEASED	DATE
EXECUTED	PATRICKL	THREE PHASE W22 MOTOR - NEMA PREMIUM EFF FRAME 364/5T IP55				
CHECKED						
RELEASED	ALCHINI					
REL DT	10.02.2014	WMO	JARAGUA DO SUL	ENGENHARIA DE PRODUTO	SHEET 1 / 1	

OV: 3053340
PC: ATL000021712

60 HP 04 Poles 60Hz



UNCONTROLLED COPY RELEASED ZME A3



Mod.TE1BFOXON
CC029A

MODEL 06018ET3E364T-W22G

Inverter Duty Motor
Severe Duty

60Hz: For use on PWM: VT 1000:1,
CT 20:1, 1.00SF

MADE IN BRAZIL
12693674

PH3 60Hz Fr. 364/5T 1000m.a.s.l. IP55 TEFC 865lb

V 230/460

A 143/71.6

HP 60

kW 45

SF 1.25

SFA 179/89.5

RPM 1780

PF 0.83

AMB 40°C

INS cl. F DT80K

NEMA NOM EFF 95.0%

DUTY CONT.

DES B Code G

USABLE @208V 151A SF 1.10 SFA 166

60HP 45kW 50Hz 380V 86.5A 1470RPM SF 1.00 EFF 93.0% (IE1)

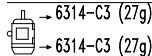
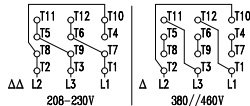

MOBIL POLYREX EM (12000h)

