



# TORQUE AND CURRENT VS SPEED CURVE

## Three Phase Induction Motor - Squirrel Cage



Customer :

Product line : W40 NEMA Premium Efficiency  
Three-Phase

Product code : 14270945

Catalog # : 07518OT3H365TS-W40

TORQUE AND CURRENT VS SPEED CURVE

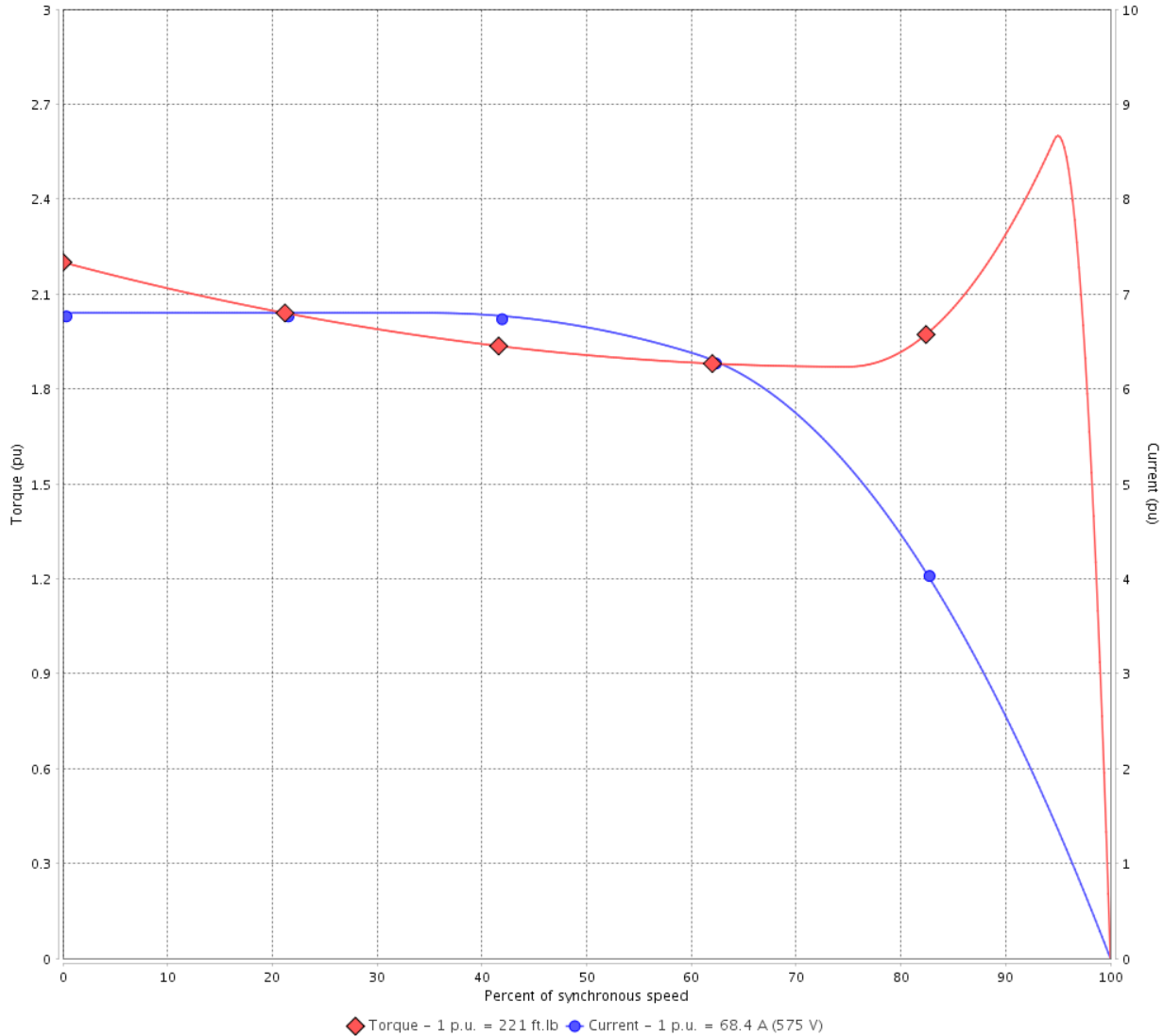

Performance : 575 V 60 Hz 4P

Rated current	: 68.4 A	Moment of inertia (J)	: 16.8 sq.ft.lb
LRC	: 6.8	Duty cycle	: Cont.(S1)
Rated torque	: 221 ft.lb	Insulation class	: F
Locked rotor torque	: 220 %	Service factor	: 1.25
Breakdown torque	: 260 %	Temperature rise	: 80 K
Rated speed	: 1780 rpm	Design	: B

Locked rotor time : 25s (cold) 14s (hot)

Rev.	Changes Summary	Performed	Checked	Date
Performed by			Page 2 / 6	Revision
Checked by				
Date	13/04/2022			

# LOAD PERFORMANCE CURVE

## Three Phase Induction Motor - Squirrel Cage



Customer :

Product line : W40 NEMA Premium Efficiency Three-Phase

Product code : 14270945

Catalog # : 07518OT3H365TS-W40

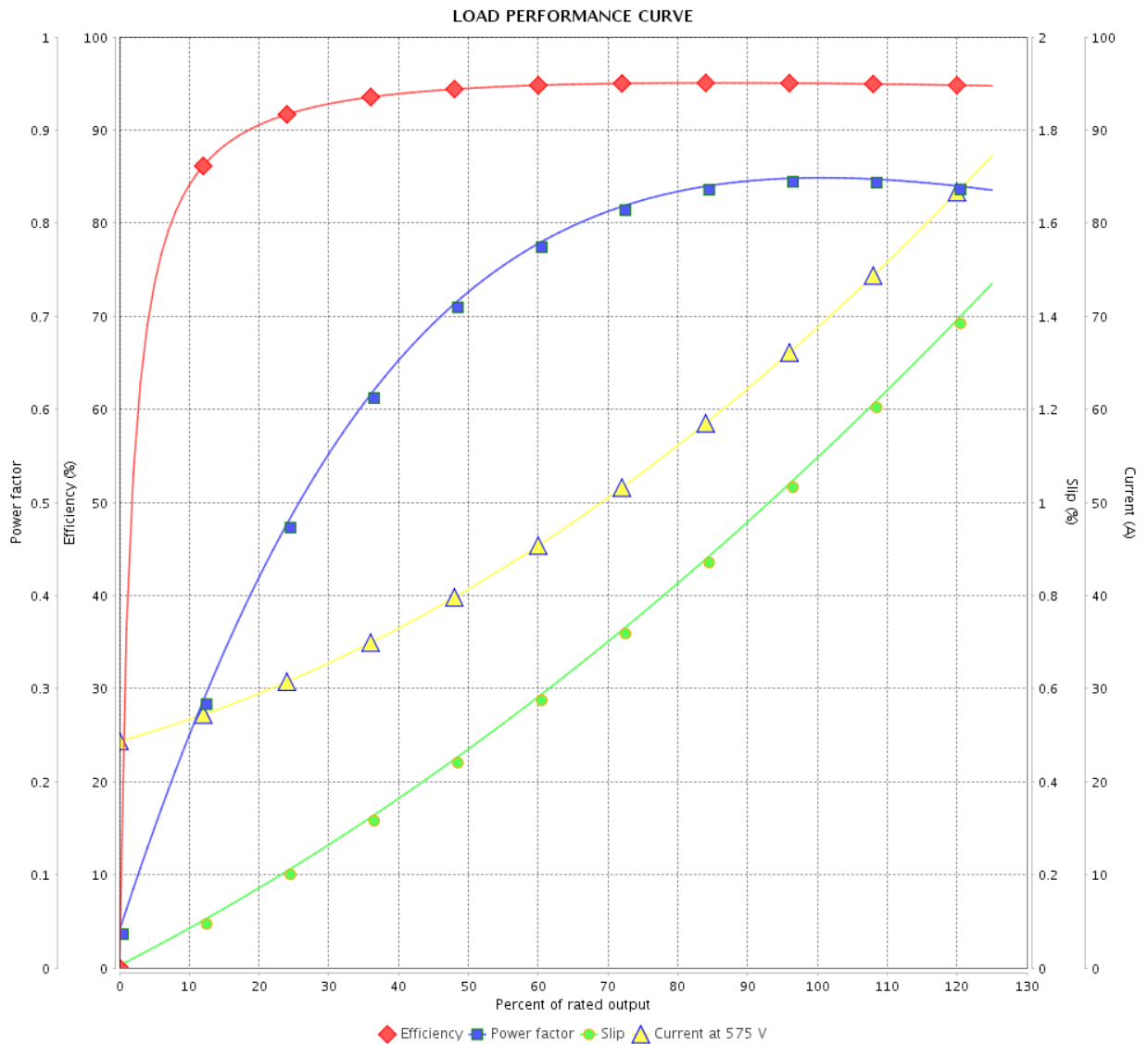

Performance : 575 V 60 Hz 4P

Rated current : 68.4 A  
 LRC : 6.8  
 Rated torque : 221 ft.lb  
 Locked rotor torque : 220 %  
 Breakdown torque : 260 %  
 Rated speed : 1780 rpm

Moment of inertia (J) : 16.8 sq.ft.lb  
 Duty cycle : Cont.(S1)  
 Insulation class : F  
 Service factor : 1.25  
 Temperature rise : 80 K  
 Design : B

Rev.	Changes Summary	Performed	Checked	Date
Performed by		Page		Revision
Checked by		3 / 6		
Date		13/04/2022		

# THERMAL LIMIT CURVE



## Three Phase Induction Motor - Squirrel Cage

Customer :

Product line : W40 NEMA Premium Efficiency  
Three-Phase

Product code : 14270945

Catalog # : 07518OT3H365TS-W40

Performance : 575 V 60 Hz 4P

Rated current	: 68.4 A	Moment of inertia (J)	: 16.8 sq.ft.lb
LRC	: 6.8	Duty cycle	: Cont.(S1)
Rated torque	: 221 ft.lb	Insulation class	: F
Locked rotor torque	: 220 %	Service factor	: 1.25
Breakdown torque	: 260 %	Temperature rise	: 80 K
Rated speed	: 1780 rpm	Design	: B

Heating constant

Cooling constant

Rev.	Changes Summary	Performed	Checked	Date
Performed by				
Checked by			Page	Revision
Date	13/04/2022		4 / 6	

# THERMAL LIMIT CURVE

Three Phase Induction Motor - Squirrel Cage



Customer : \_\_\_\_\_

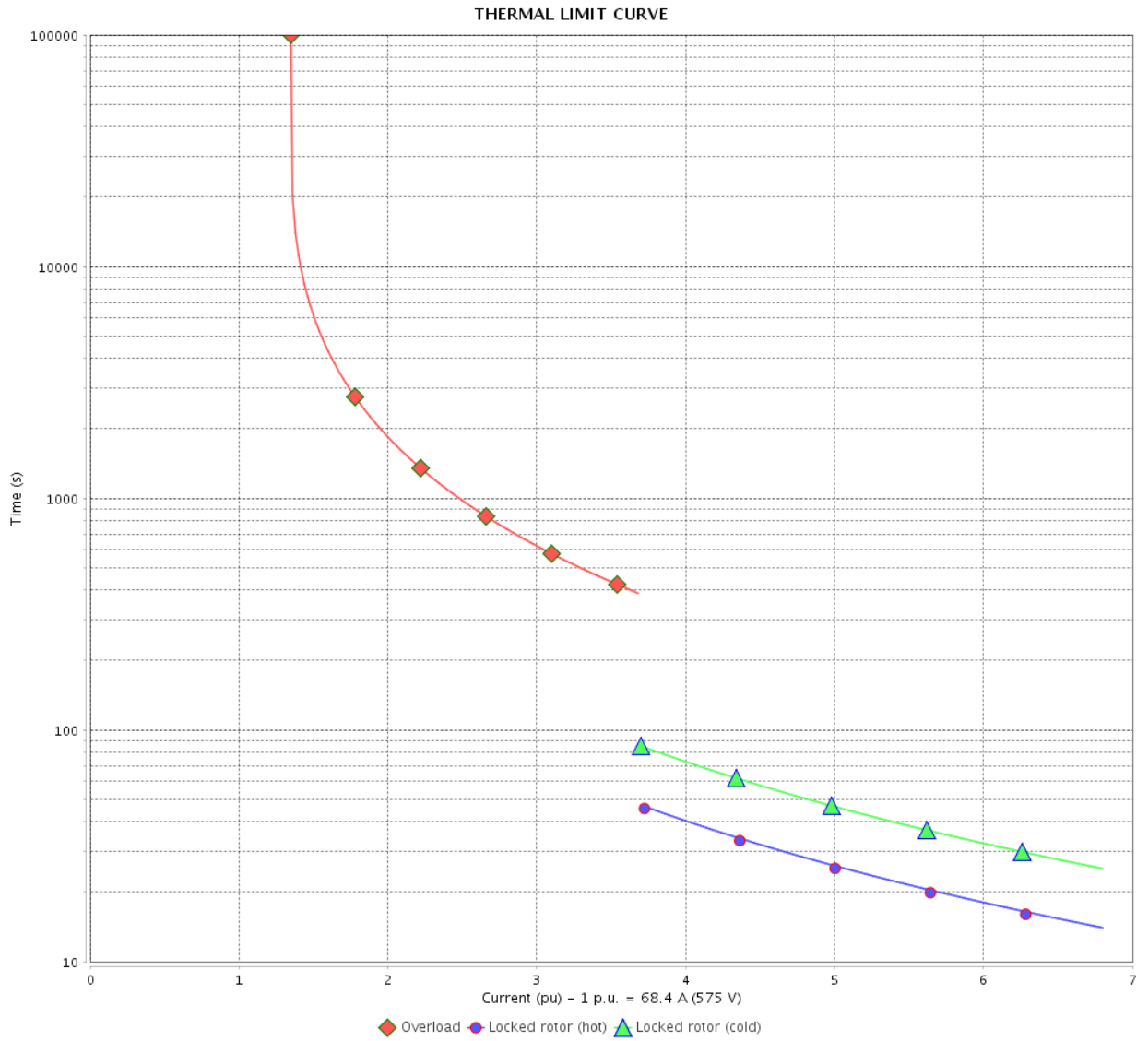

Rev.	Changes Summary	Performed	Checked	Date
Performed by		Page 5 / 6		Revision
Checked by				
Date				

# VFD OPERATION CURVE

Three Phase Induction Motor - Squirrel Cage



Customer : \_\_\_\_\_

Product line : W40 NEMA Premium Efficiency Three-Phase

Product code : 14270945

Catalog # : 07518OT3H365TS-W40

VFD OPERATION CURVE

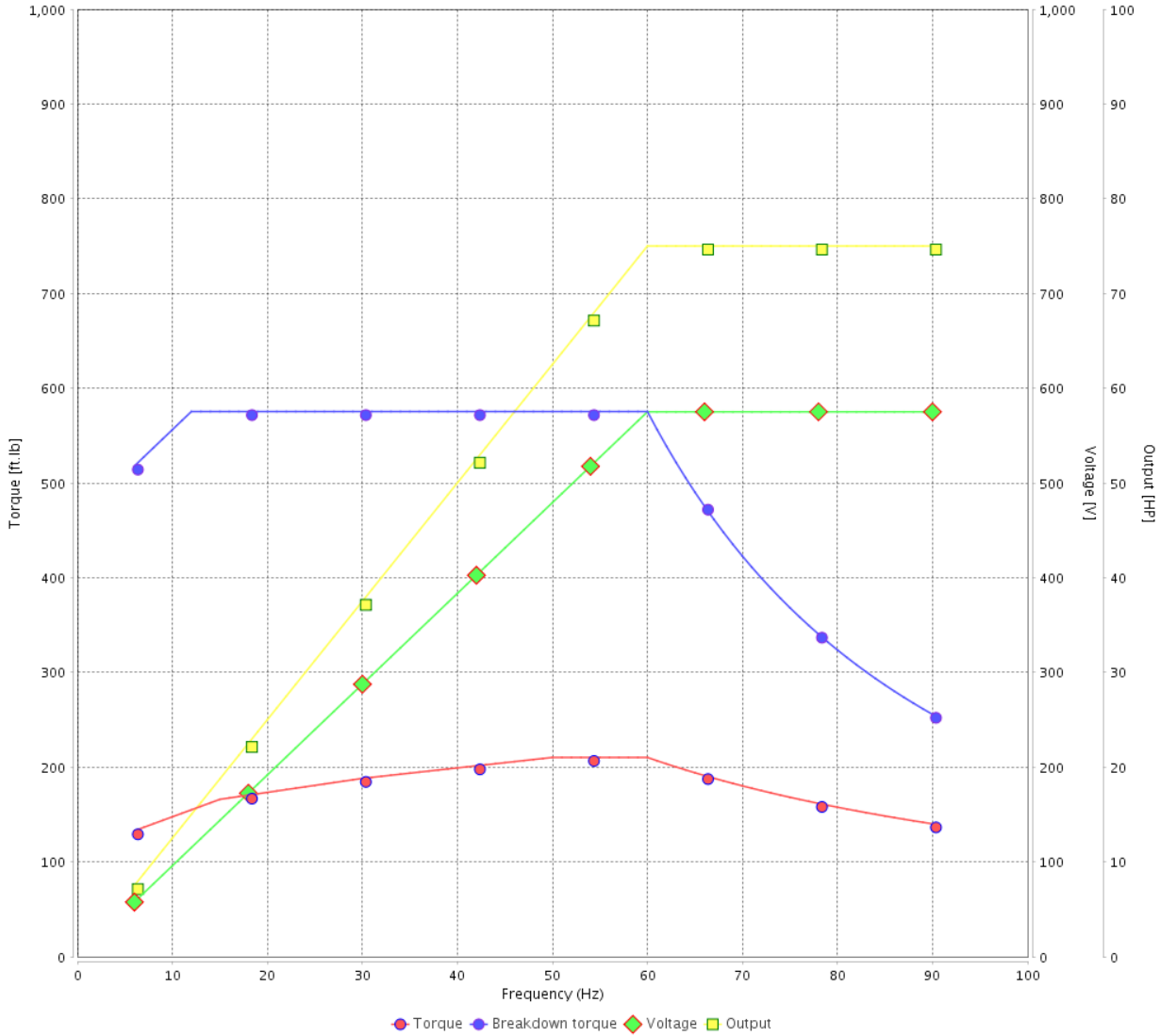

Performance : 575 V 60 Hz 4P

Rated current : 68.4 A  
 LRC : 6.8  
 Rated torque : 221 ft.lb  
 Locked rotor torque : 220 %  
 Breakdown torque : 260 %  
 Rated speed : 1780 rpm

Moment of inertia (J) : 16.8 sq.ft.lb  
 Duty cycle : Cont.(S1)  
 Insulation class : F  
 Service factor : 1.25  
 Temperature rise : 80 K  
 Design : B

Rev.	Changes Summary	Performed	Checked	Date
Performed by			Page 6 / 6	Revision
Checked by				
Date	13/04/2022			

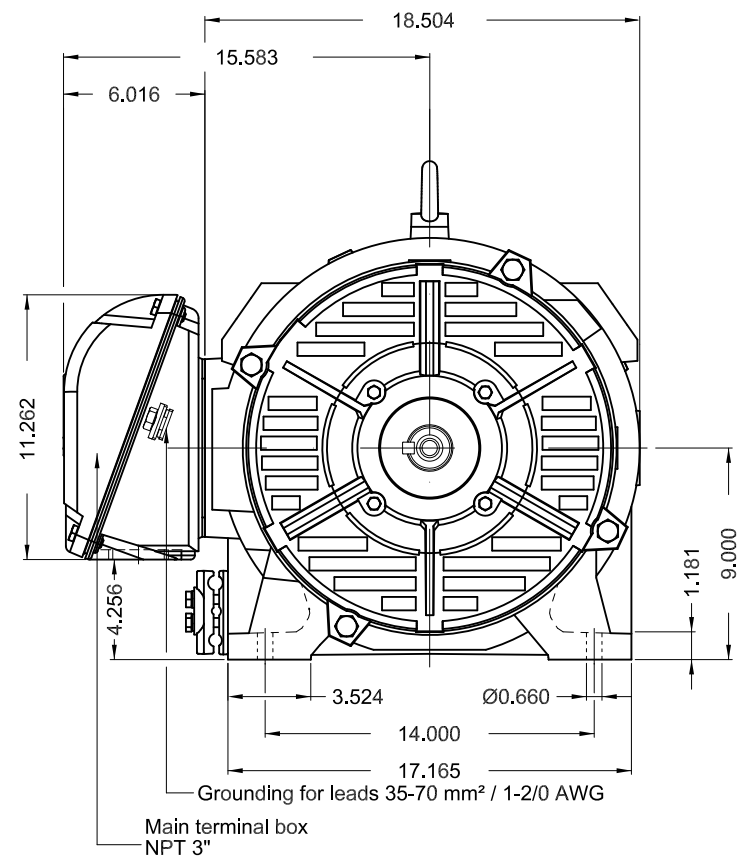

Main terminal box  
NPT 3"

Grounding for leads 35-70 mm<sup>2</sup> / 1-2/0 AWG

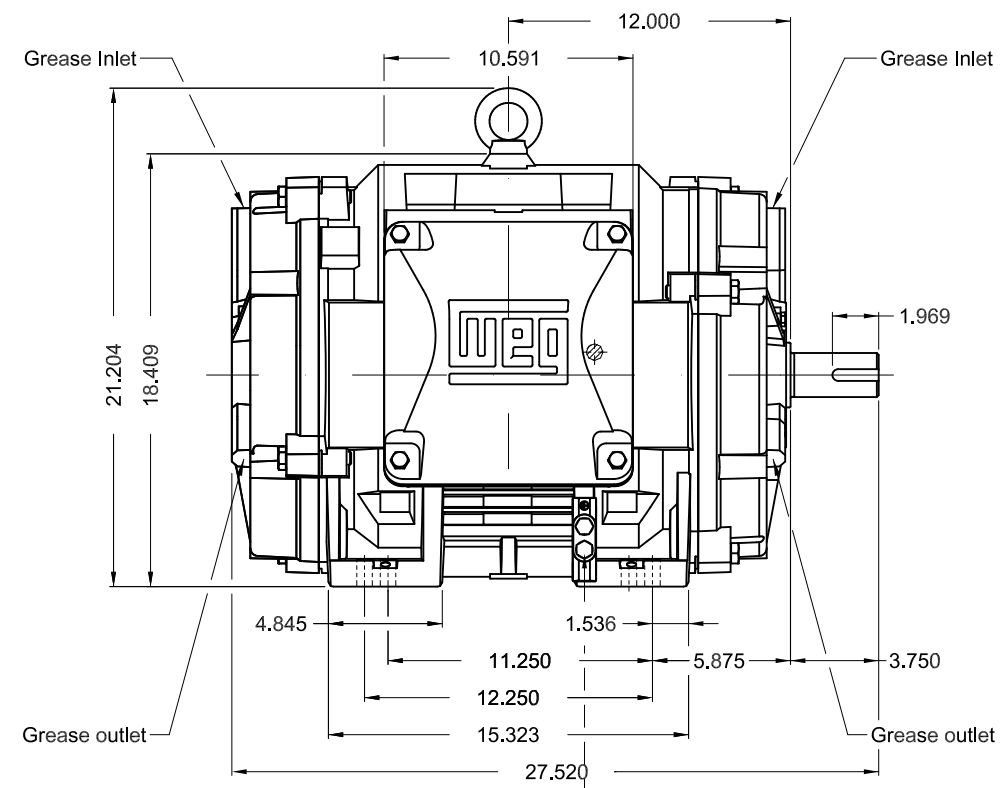

Grounding for leads 25-185 mm<sup>2</sup> / 3AWG-350MCM

75 HP 04 Poles 60 Hz

A

1:8

TS shaft end

Color RAL 5009

Painting plan 203A

Mounting NEMA F-1

Mounting B3R(D)

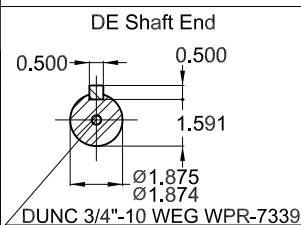

DUNC 3/4"-10 WEG WPR-7339

ECM	LOC	SUMMARY OF MODIFICATIONS	EXECUTED	CHECKED	RELEASED	DATE	VER
EXECUTED	PIRWBUSER	THREE PH. MOTOR W40 PREM. EFF.					
CHECKED		FRAME 364/STS IP23 ODP					
RELEASED							
REL DT.	WMO	Jaragua do Sul	Product Engineering				

PREVIEW

WDD



SHEET 1 / 1

MODEL 075180T3H365TS-W40  
MADE IN BRAZIL  
14270945

**WEG** **W40 NEMA**  
**CC029A Premium**  
*Inverter Duty Motor*



MOD.T01#FOXON



For use on PWM, VT 1000:1, CT 2:1, 1.0SF

PH 3	FR 364/5TS	HP(kW) 75(55)		Hz 60
V 575		A 68.4		IP23
NEMA NOM EFF		95.0	%	RPM 1780
ENCL ODP	DUTY CONT.		INS. CL. F $\Delta$ T 80 K	
PF 0.85		DES B	CODE G	AMB. 40°C
SF 1.25	SFA 85.5		ALT 1000 m.a.s.l.	

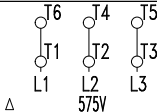

→ 6314-C3(27g)  
→ 6212-Z-C3(13g)

MOBIL POLYREX EM  
20000 h

763 Lbs