

# DATA SHEET



## Three Phase Induction Motor - Squirrel Cage

Customer :				
Product line	: W40 NEMA Premium Efficiency Three-Phase	Product code :	14270960	
		Catalog # :	07536OT3V364TS-W40	
Frame	: 364/5TS	Locked rotor time	: 34s (cold) 19s (hot)	
Output	: 75 HP (55 kW)	Temperature rise	: 80 K	
Poles	: 2	Duty cycle	: Cont.(S1)	
Frequency	: 60 Hz	Ambient temperature	: -20°C to +40°C	
Rated voltage	: 200/400 V	Altitude	: 1000 m.a.s.l.	
Rated current	: 195/97.5 A	Protection degree	: IP23	
L. R. Amperes	: 1287/644 A	Cooling method	: IC01 - ODP	
LRC	: 6.6x(Code G)	Mounting	: F-1	
No load current	: 49.5/24.7 A	Rotation <sup>1</sup>	: Both (CW and CCW)	
Rated speed	: 3555 rpm	Noise level <sup>2</sup>	: 84.0 dB(A)	
Slip	: 1.25 %	Starting method	: Direct On Line	
Rated torque	: 111 ft.lb	Approx. weight <sup>3</sup>	: 680 lb	
Locked rotor torque	: 200 %			
Breakdown torque	: 250 %			
Insulation class	: F			
Service factor	: 1.25			
Moment of inertia (J)	: 6.40 sq.ft.lb			
Design	: B			
Output	25%    50%    75%    100%	Foundation loads		
Efficiency (%)	91.0    91.7    93.0    93.6	Max. traction	: 609 lb	
Power Factor	0.56    0.77    0.84    0.87	Max. compression	: 1289 lb	
	<u>Drive end</u>	<u>Non drive end</u>		
Bearing type	: 6314 C3	6212 Z C3		
Sealing	: Without Bearing Seal	Without Bearing Seal		
Lubrication interval	: 14418 h	20000 h		
Lubricant amount	: 27 g	13 g		
Lubricant type	: Mobil Polyrex EM			
Notes				
This revision replaces and cancel the previous one, which must be eliminated. (1) Looking the motor from the shaft end. (2) Measured at 1m and with tolerance of +3dB(A). (3) Approximate weight subject to changes after manufacturing process. (4) At 100% of full load.		These are average values based on tests with sinusoidal power supply, subject to the tolerances stipulated in NEMA MG-1.		
Rev.	Changes Summary	Performed	Checked	Date
Performed by		Page		Revision
Checked by		1 / 6		
Date	13/04/2022			

# TORQUE AND CURRENT VS SPEED CURVE

## Three Phase Induction Motor - Squirrel Cage



Customer :

Product line : W40 NEMA Premium Efficiency  
Three-Phase

Product code : 14270960

Catalog # : 07536OT3V364TS-W40

TORQUE AND CURRENT VS SPEED CURVE

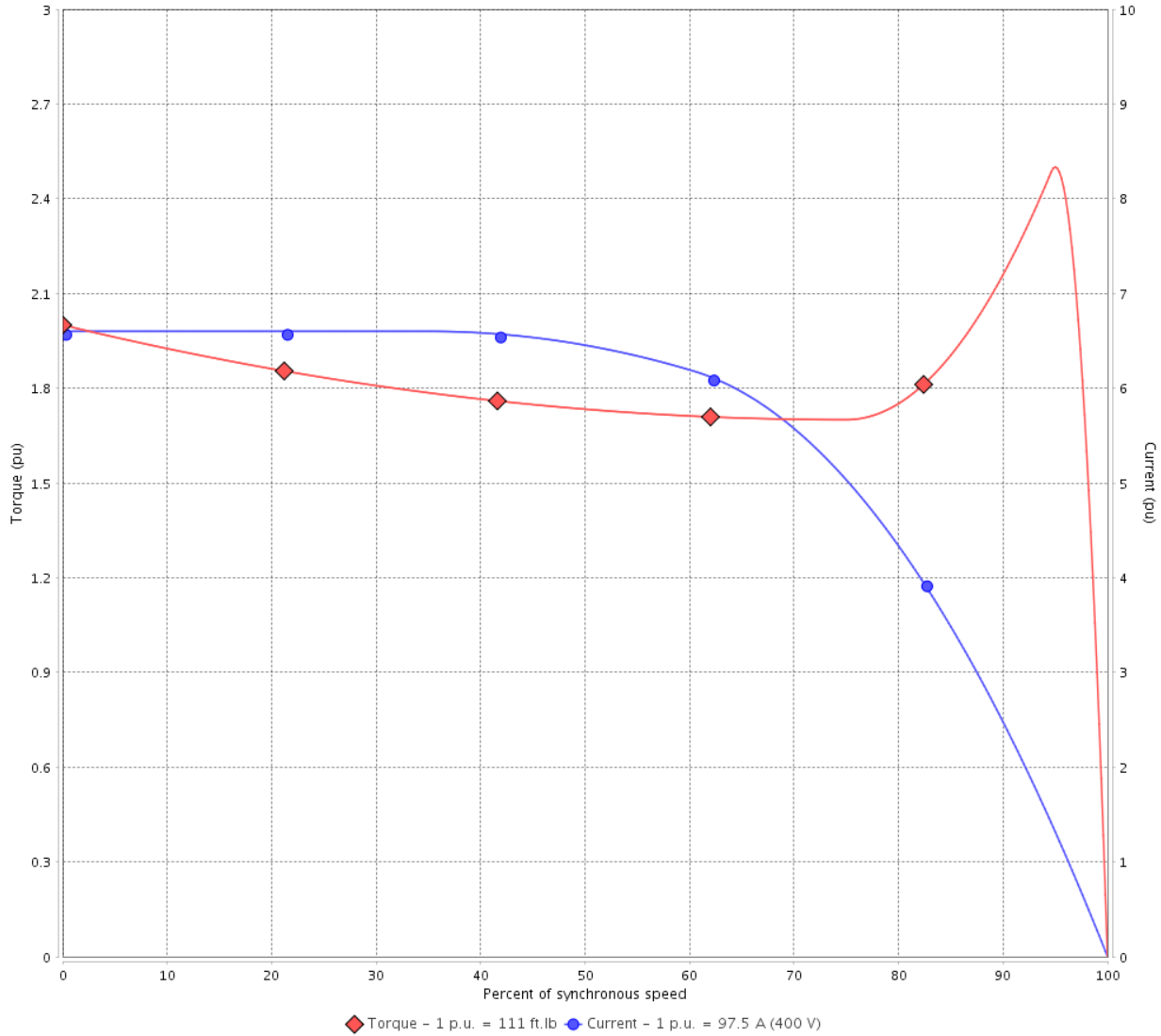

Performance : 200/400 V 60 Hz 2P

Rated current	: 195/97.5 A	Moment of inertia (J)	: 6.40 sq.ft.lb
LRC	: 6.6	Duty cycle	: Cont.(S1)
Rated torque	: 111 ft.lb	Insulation class	: F
Locked rotor torque	: 200 %	Service factor	: 1.25
Breakdown torque	: 250 %	Temperature rise	: 80 K
Rated speed	: 3555 rpm	Design	: B

Locked rotor time : 34s (cold) 19s (hot)

Rev.	Changes Summary	Performed	Checked	Date
Performed by			Page 2 / 6	Revision
Checked by				
Date	13/04/2022			

# LOAD PERFORMANCE CURVE

## Three Phase Induction Motor - Squirrel Cage



Customer :

Product line : W40 NEMA Premium Efficiency Three-Phase

Product code : 14270960

Catalog # : 07536OT3V364TS-W40

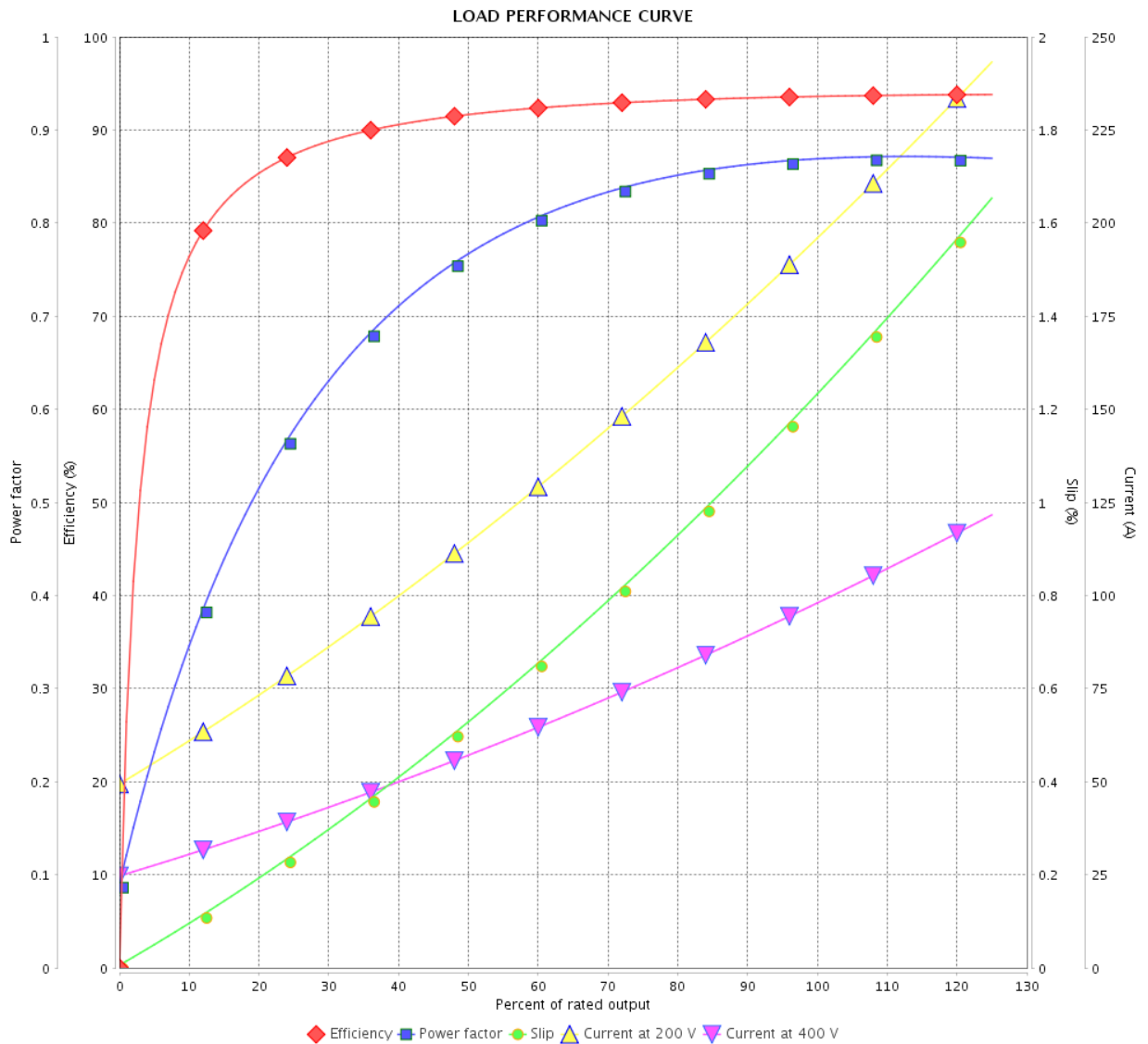

Performance : 200/400 V 60 Hz 2P

Rated current : 195/97.5 A  
 LRC : 6.6  
 Rated torque : 111 ft.lb  
 Locked rotor torque : 200 %  
 Breakdown torque : 250 %  
 Rated speed : 3555 rpm

Moment of inertia (J) : 6.40 sq.ft.lb  
 Duty cycle : Cont.(S1)  
 Insulation class : F  
 Service factor : 1.25  
 Temperature rise : 80 K  
 Design : B

Rev.	Changes Summary	Performed	Checked	Date
Performed by			Page	Revision
Checked by				
Date				
			3 / 6	

# THERMAL LIMIT CURVE



## Three Phase Induction Motor - Squirrel Cage

Customer :

Product line : W40 NEMA Premium Efficiency  
Three-Phase

Product code : 14270960

Catalog # : 07536OT3V364TS-W40

Performance : 200/400 V 60 Hz 2P

Rated current : 195/97.5 A  
LRC : 6.6  
Rated torque : 111 ft.lb  
Locked rotor torque : 200 %  
Breakdown torque : 250 %  
Rated speed : 3555 rpm

Moment of inertia (J) : 6.40 sq.ft.lb  
Duty cycle : Cont.(S1)  
Insulation class : F  
Service factor : 1.25  
Temperature rise : 80 K  
Design : B

Heating constant

Cooling constant

Rev.	Changes Summary	Performed	Checked	Date
Performed by				
Checked by			Page	Revision
Date	13/04/2022		4 / 6	

# THERMAL LIMIT CURVE

Three Phase Induction Motor - Squirrel Cage



Customer : \_\_\_\_\_

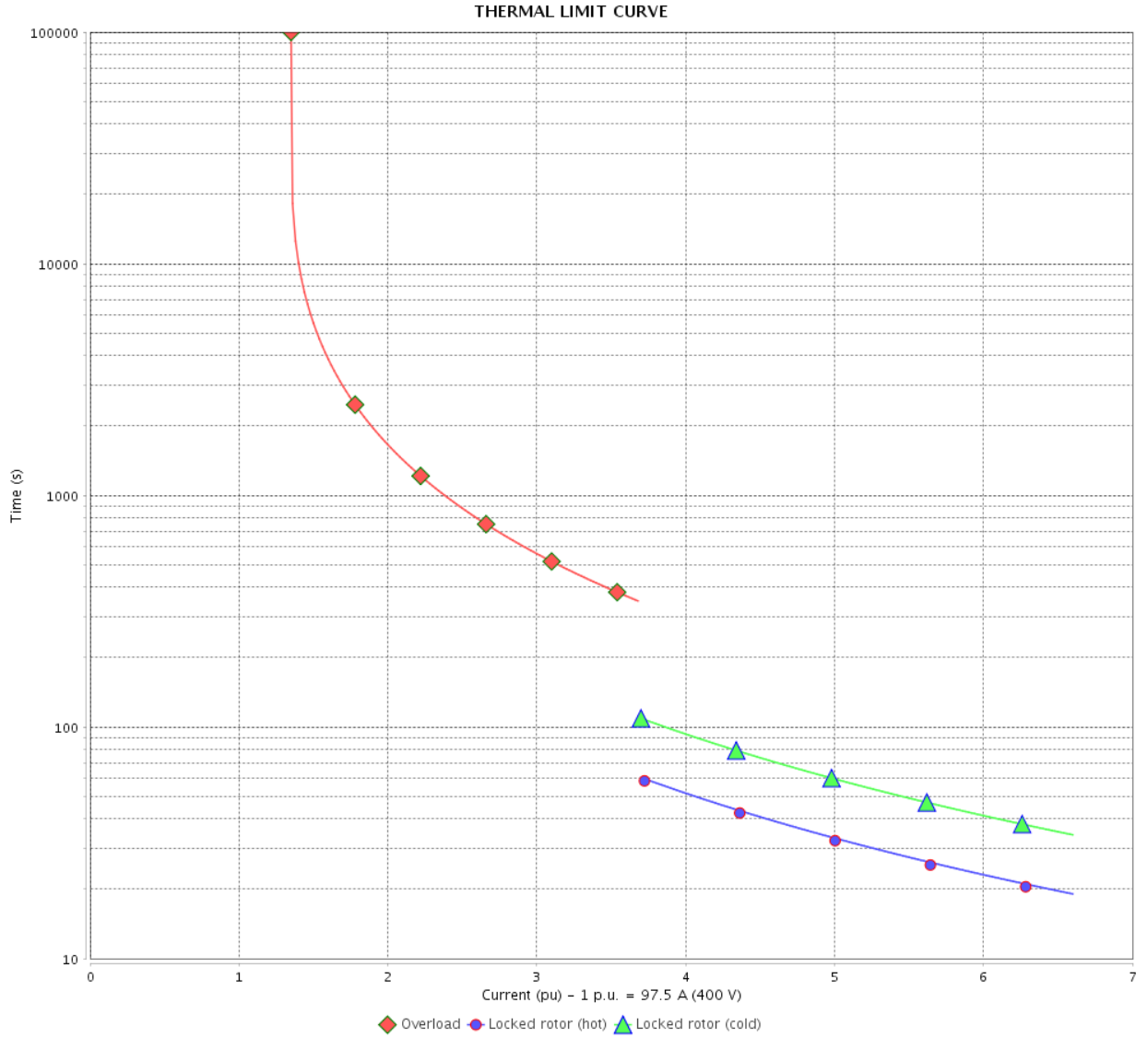

Rev.	Changes Summary	Performed	Checked	Date
Performed by				
Checked by				
Date				
			Page 5 / 6	Revision

# VFD OPERATION CURVE

Three Phase Induction Motor - Squirrel Cage



Customer :

Product line : W40 NEMA Premium Efficiency  
Three-Phase

Product code : 14270960

Catalog # : 07536OT3V364TS-W40

VFD OPERATION CURVE

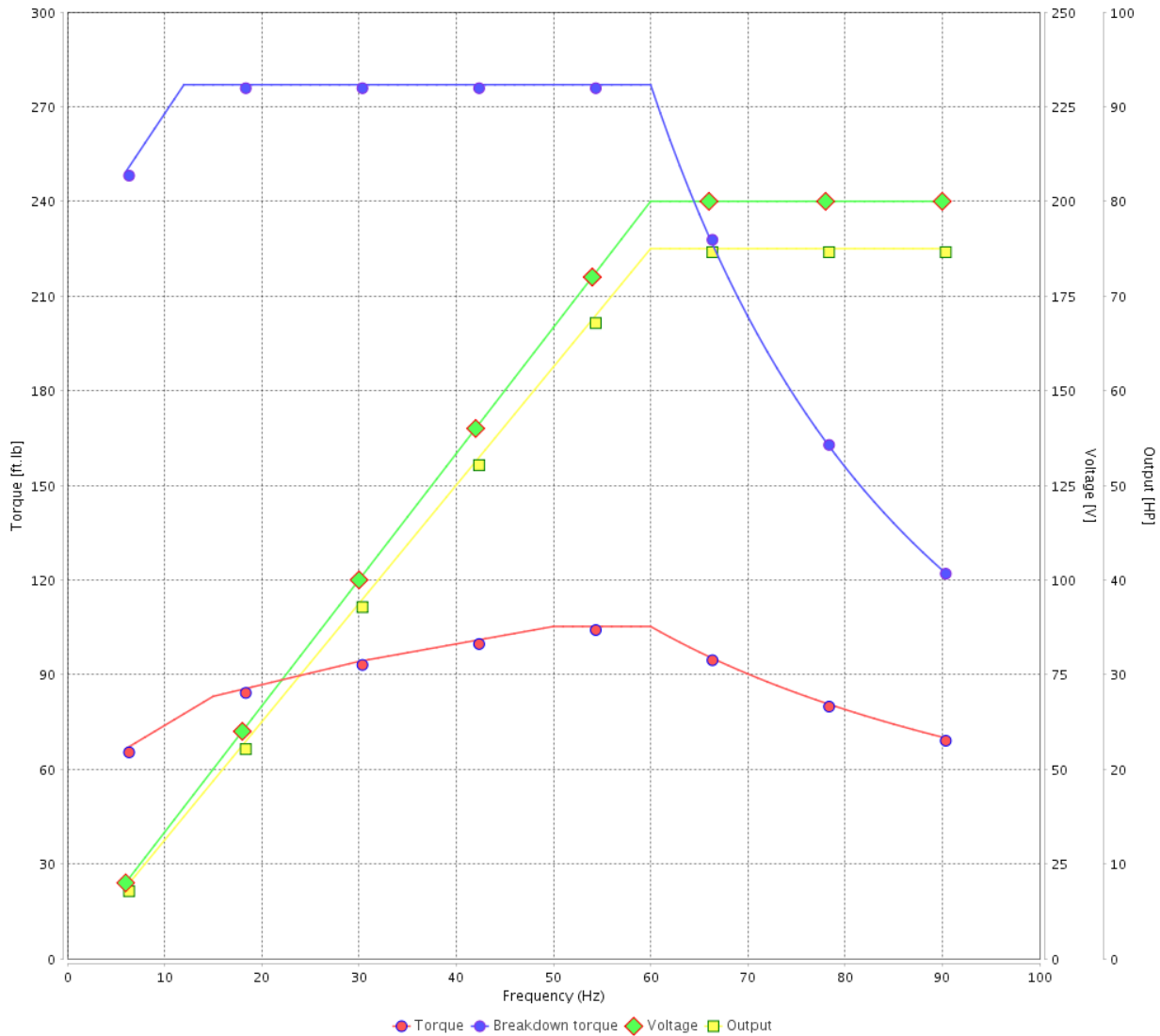

Performance : 200/400 V 60 Hz 2P

Rated current : 195/97.5 A  
LRC : 6.6  
Rated torque : 111 ft.lb  
Locked rotor torque : 200 %  
Breakdown torque : 250 %  
Rated speed : 3555 rpm

Moment of inertia (J) : 6.40 sq.ft.lb  
Duty cycle : Cont.(S1)  
Insulation class : F  
Service factor : 1.25  
Temperature rise : 80 K  
Design : B

Rev.	Changes Summary	Performed	Checked	Date
Performed by			Page 6 / 6	Revision
Checked by				
Date	13/04/2022			

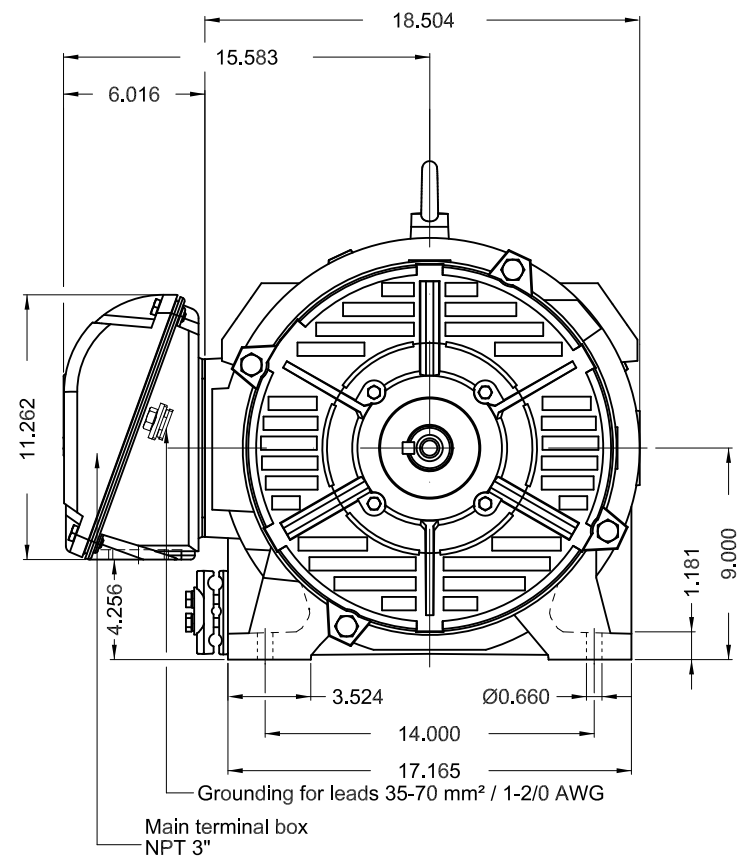

Main terminal box  
NPT 3"

Grounding for leads 35-70 mm<sup>2</sup> / 1-2/0 AWG

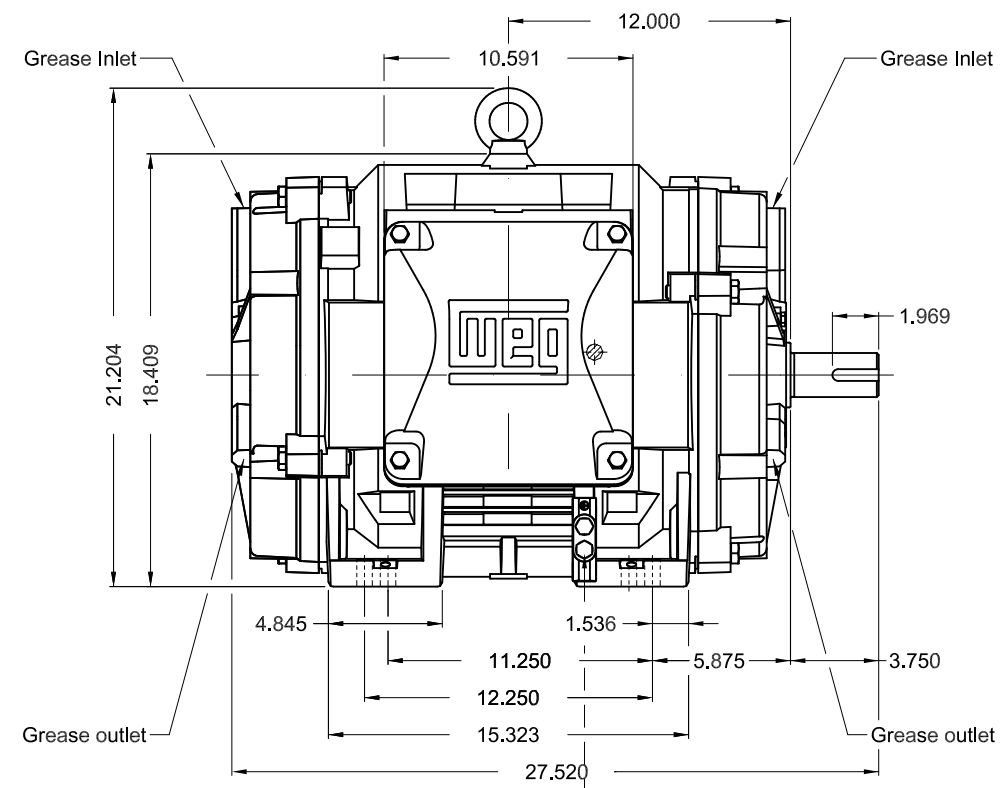

Grounding for leads 25-185 mm<sup>2</sup> / 3AWG-350MCM

75 HP 02 Poles 60 Hz

A

1:8

ECM	LOC	SUMMARY OF MODIFICATIONS	EXECUTED	CHECKED	RELEASED	DATE	VER
EXECUTED	PIRWBUSER	THREE PH. MOTOR W40 PREM. EFF.					
CHECKED		FRAME 364/STS IP23 ODP					
RELEASED							
REL DT.	WMO	Jaragua do Sul	Product Engineering	SHEET	1 / 1		

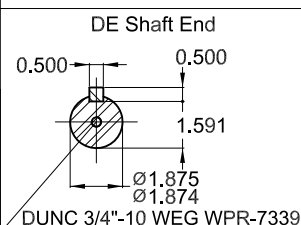

DUNC 3/4"-10 WEG WPR-7339

Color RAL 5009  
Painting plan 203A  
Mounting NEMA F-1  
Mounting B3R(D)

Dimensions in inches

XME A3



PREVIEW  
WDD