

DATA SHEET

Three Phase Induction Motor - Squirrel Cage



Customer : _____

Thermal protection

ID	Application	Type	Quantity	Sensing Temperature
1	Winding	Thermostat - 2 wires	1 x Phase	155 °C

Rev.	Changes Summary	Performed	Checked	Date
Performed by				
Checked by			Page	Revision
Date	14/04/2022		2 / 7	

TORQUE AND CURRENT VS SPEED CURVE



Three Phase Induction Motor - Squirrel Cage

Customer :

Product line : NEMA Premium Efficiency Three-Phase

Product code : 11483103

Catalog # : 10018XT3H405T

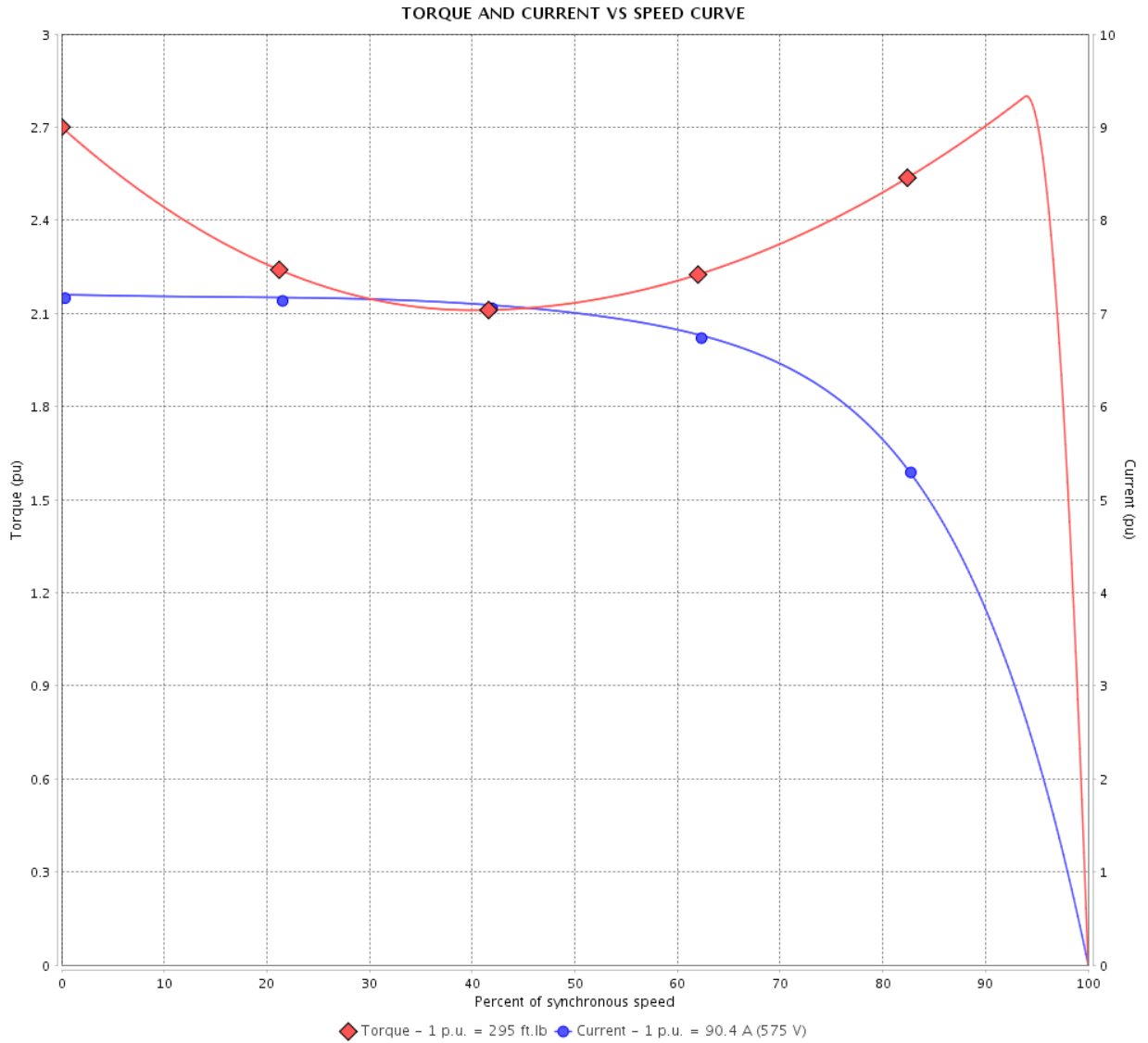

Performance : 575 V 60 Hz 4P

Rated current	: 90.4 A	Moment of inertia (J)	: 26.4 sq.ft.lb
LRC	: 7.2	Duty cycle	: Cont.(S1)
Rated torque	: 295 ft.lb	Insulation class	: F
Locked rotor torque	: 270 %	Service factor	: 1.15
Breakdown torque	: 280 %	Temperature rise	: 80 K
Rated speed	: 1780 rpm	Design	: B

Locked rotor time : 23s (cold) 13s (hot)

Rev.	Changes Summary	Performed	Checked	Date
Performed by			Page 3 / 7	Revision
Checked by				
Date	14/04/2022			

LOAD PERFORMANCE CURVE

Three Phase Induction Motor - Squirrel Cage



Customer :

Product line : NEMA Premium Efficiency Three-Phase

Product code : 11483103

Catalog # : 10018XT3H405T

LOAD PERFORMANCE CURVE

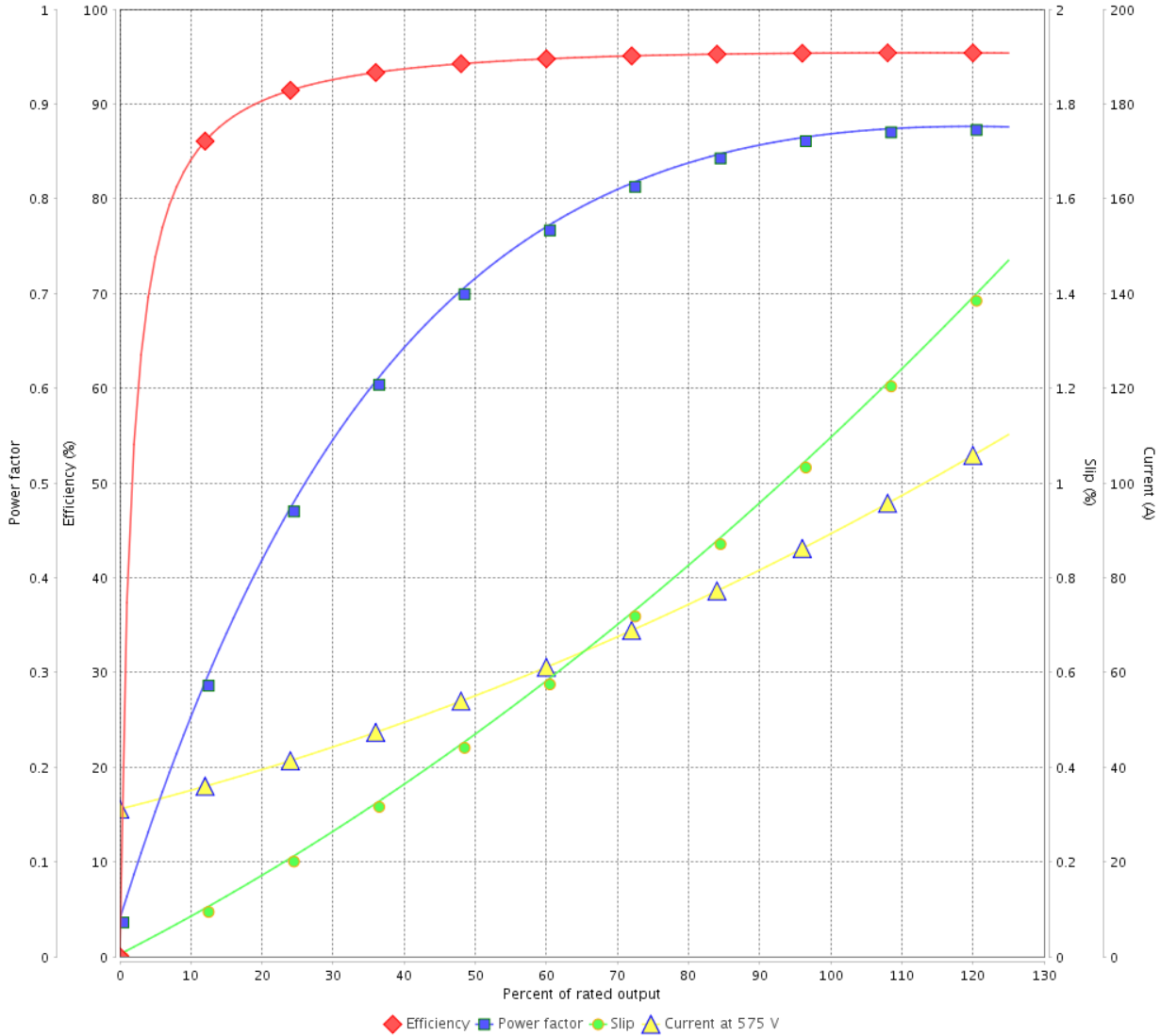

Performance : 575 V 60 Hz 4P

Rated current : 90.4 A
 LRC : 7.2
 Rated torque : 295 ft.lb
 Locked rotor torque : 270 %
 Breakdown torque : 280 %
 Rated speed : 1780 rpm

Moment of inertia (J) : 26.4 sq.ft.lb
 Duty cycle : Cont.(S1)
 Insulation class : F
 Service factor : 1.15
 Temperature rise : 80 K
 Design : B

Rev.	Changes Summary	Performed	Checked	Date
Performed by			Page 4 / 7	Revision
Checked by				
Date	14/04/2022			

THERMAL LIMIT CURVE



Three Phase Induction Motor - Squirrel Cage

Customer :

Product line : NEMA Premium Efficiency Three-Phase
 Product code : 11483103
 Catalog # : 10018XT3H405T

Performance : 575 V 60 Hz 4P

Rated current : 90.4 A	Moment of inertia (J) : 26.4 sq.ft.lb
LRC : 7.2	Duty cycle : Cont.(S1)
Rated torque : 295 ft.lb	Insulation class : F
Locked rotor torque : 270 %	Service factor : 1.15
Breakdown torque : 280 %	Temperature rise : 80 K
Rated speed : 1780 rpm	Design : B

Heating constant

Cooling constant

Rev.	Changes Summary	Performed	Checked	Date
Performed by			Page 5 / 7	Revision
Checked by				
Date	14/04/2022			

THERMAL LIMIT CURVE

Three Phase Induction Motor - Squirrel Cage



Customer : _____

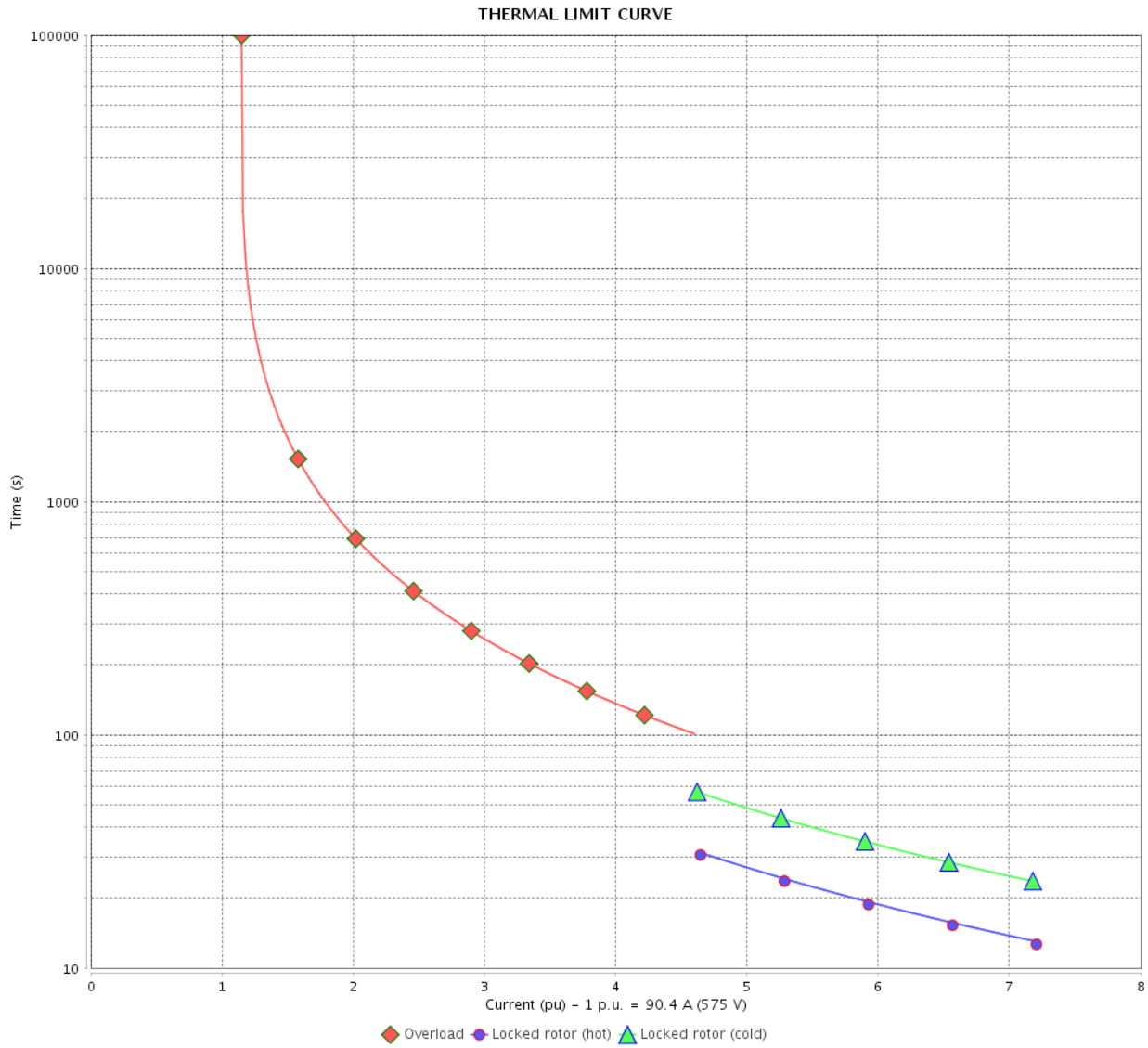

Rev.	Changes Summary	Performed	Checked	Date
Performed by		Page 6 / 7		Revision
Checked by				
Date				

VFD OPERATION CURVE

Three Phase Induction Motor - Squirrel Cage



Customer : _____

Product line : NEMA Premium Efficiency Three-Phase

Product code : 11483103

Catalog # : 10018XT3H405T

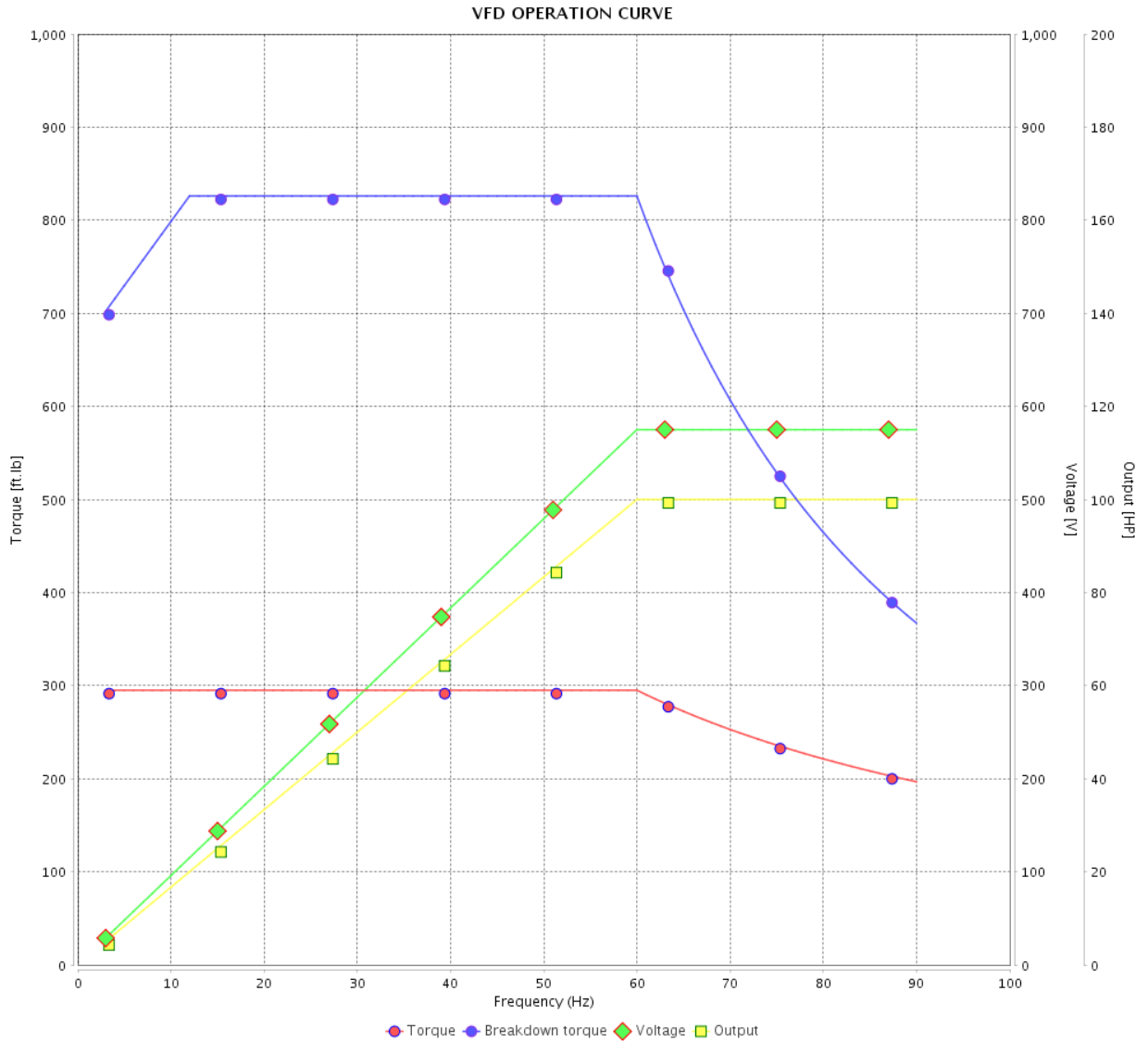

Performance : 575 V 60 Hz 4P

Rated current : 90.4 A
 LRC : 7.2
 Rated torque : 295 ft.lb
 Locked rotor torque : 270 %
 Breakdown torque : 280 %
 Rated speed : 1780 rpm

Moment of inertia (J) : 26.4 sq.ft.lb
 Duty cycle : Cont.(S1)
 Insulation class : F
 Service factor : 1.15
 Temperature rise : 80 K
 Design : B

Rev.	Changes Summary	Performed	Checked	Date
Performed by				Page 7 / 7
Checked by				
Date	14/04/2022			
				Revision

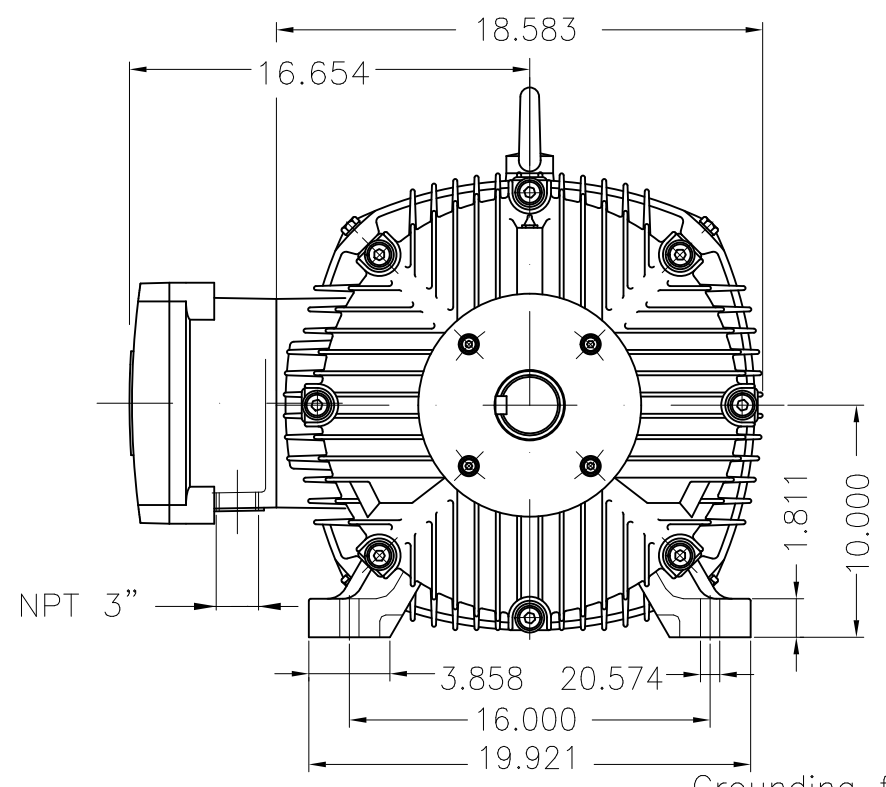

Grounding for leads 25–50 mm² / 3–1 AWG

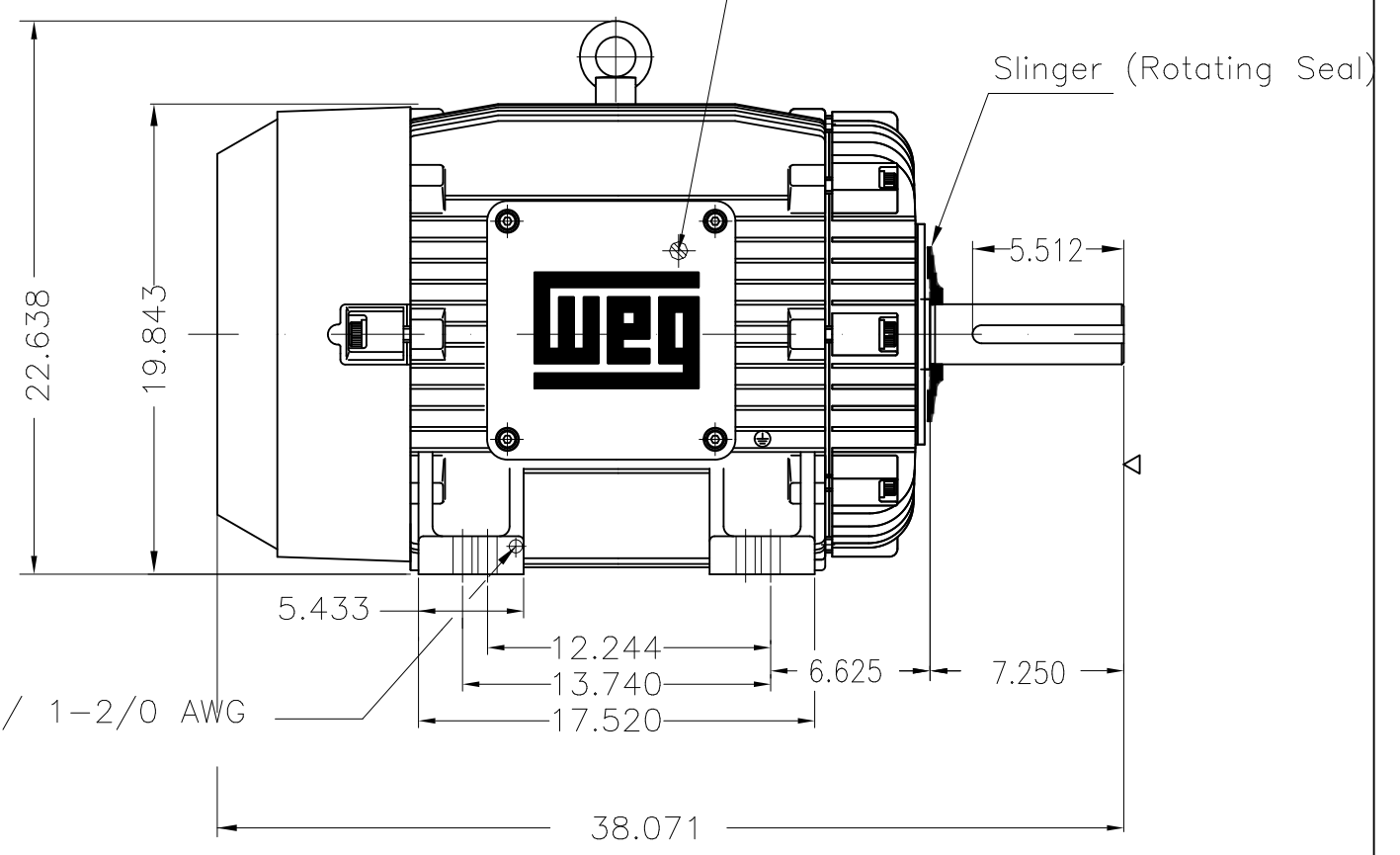

Grounding for leads 35–70 mm² / 1–2/0 AWG

100 HP 04 Poles 60 Hz A

Color RAL 5009
 Painting plan 202P
 Mounting B3R(D)

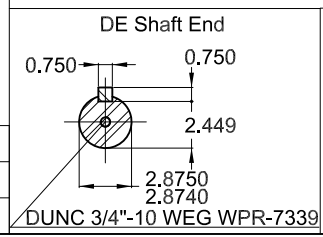

ECM	LOC	SUMMARY OF MODIFICATIONS	EXECUTED	CHECKED	RELEASED	DATE	VER
EXECUTED	PIRWBUSER	THREE PH. MOTOR EXPLOSION PROOF PREM. EFF.					
CHECKED		FRAME 404/5T IP55 TEFC					
RELEASED							
REL DT.	WMO	Jaragua do Sul	Product Engineering	SHEET	1 / 1		

PREVIEW
 WDD





W21X NEMA
CC029A Premium

*Inverter Duty Motor
 Severe Duty*



TEMP CODE T3C
 CSA/UL: Class I - Div. 1 - Groups C and D
 CSA: Class II - Div. 1 - Groups F and G
 CSA: Class I - Zone 1 - IIB
EXPLOSION PROOF MOTOR
 FOR USE ON VPWM VFD 1000:1VT, 2:1CT, 1.0SF, T3C, AMB 40°C.

HX100504NPBBW21X
 MADE IN BRAZIL
 11483103

PH 3	FR 404/5T	HP(kW) 100(75)	Hz 60
V 575	A 90.4	RPM 1780	
NEMA NOM. EFF. 95.4%		INS CL F Δ T 80 K	IP55
PF 0.87	DUTY CONT.		CODE H
ENCL. TEFC	SF 1.15	SFA 104	
AMB 40°C	DES B		
AMB 55°C SF1.0	-bearings lub interval reduced by a factor of 50%		

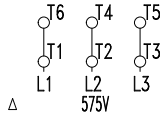

→ 6217-C3(21g) MOBIL POLYREX EM
 → 6314-C3(27g) 9149 h
 ALT 1000 m.a.s.l | 1195 Lbs