

TORQUE AND CURRENT VS SPEED CURVE

Three Phase Induction Motor - Squirrel Cage



Customer :

Product line : W40 NEMA Premium Efficiency
Three-Phase

Product code : 14272481

Catalog # : 100360T3V365TS-W40

TORQUE AND CURRENT VS SPEED CURVE

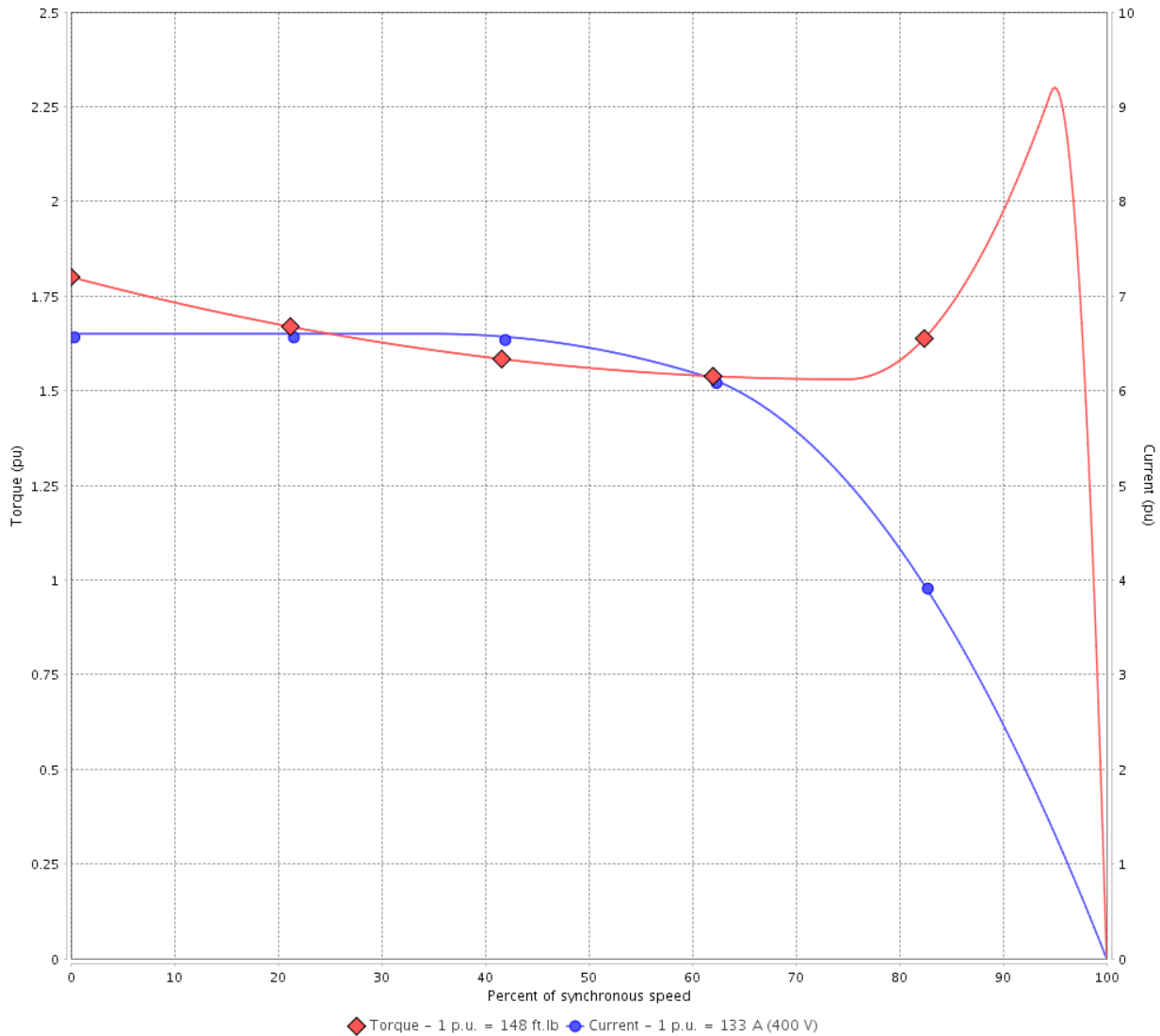

Performance : 200/400 V 60 Hz 2P

Rated current	: 267/133 A	Moment of inertia (J)	: 7.20 sq.ft.lb
LRC	: 6.6	Duty cycle	: Cont.(S1)
Rated torque	: 148 ft.lb	Insulation class	: F
Locked rotor torque	: 180 %	Service factor	: 1.25
Breakdown torque	: 229 %	Temperature rise	: 80 K
Rated speed	: 3555 rpm	Design	: B

Locked rotor time : 23s (cold) 13s (hot)

Rev.	Changes Summary	Performed	Checked	Date
Performed by			Page 2 / 6	Revision
Checked by				
Date	12/04/2022			

LOAD PERFORMANCE CURVE

Three Phase Induction Motor - Squirrel Cage



Customer : _____

Product line : W40 NEMA Premium Efficiency
Three-Phase

Product code : 14272481

Catalog # : 10036OT3V365TS-W40

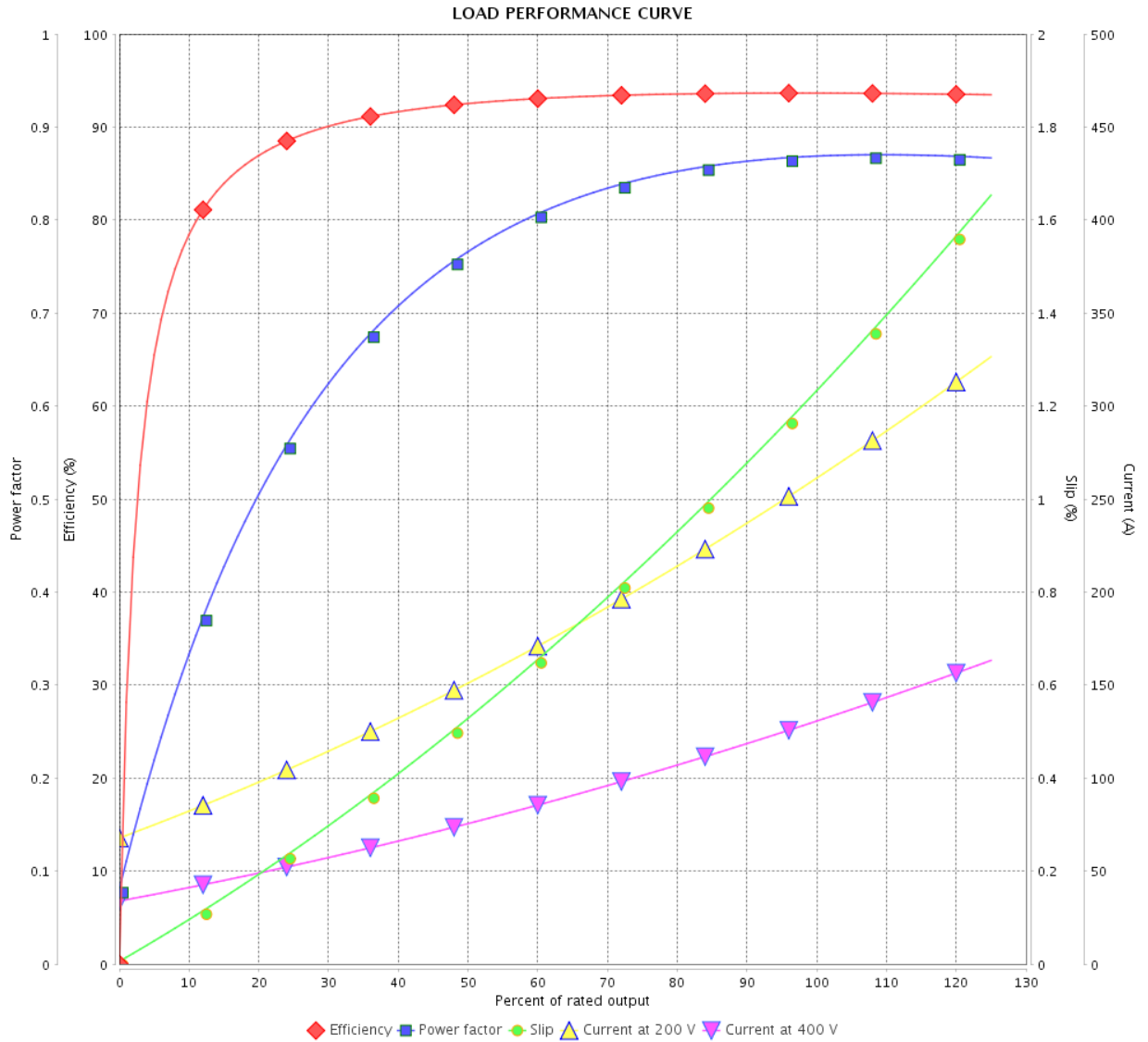

Performance : 200/400 V 60 Hz 2P

Rated current : 267/133 A
 LRC : 6.6
 Rated torque : 148 ft.lb
 Locked rotor torque : 180 %
 Breakdown torque : 229 %
 Rated speed : 3555 rpm

Moment of inertia (J) : 7.20 sq.ft.lb
 Duty cycle : Cont.(S1)
 Insulation class : F
 Service factor : 1.25
 Temperature rise : 80 K
 Design : B

Rev.	Changes Summary	Performed	Checked	Date
Performed by		Page		Revision
Checked by		3 / 6		
Date		12/04/2022		

THERMAL LIMIT CURVE

Three Phase Induction Motor - Squirrel Cage



Customer :

Product line : W40 NEMA Premium Efficiency
Three-Phase

Product code : 14272481

Catalog # : 10036OT3V365TS-W40

Performance : 200/400 V 60 Hz 2P

Rated current : 267/133 A
LRC : 6.6
Rated torque : 148 ft.lb
Locked rotor torque : 180 %
Breakdown torque : 229 %
Rated speed : 3555 rpm

Moment of inertia (J) : 7.20 sq.ft.lb
Duty cycle : Cont.(S1)
Insulation class : F
Service factor : 1.25
Temperature rise : 80 K
Design : B

Heating constant

Cooling constant

Rev.	Changes Summary	Performed	Checked	Date
Performed by				
Checked by			Page	Revision
Date	12/04/2022		4 / 6	

THERMAL LIMIT CURVE

Three Phase Induction Motor - Squirrel Cage



Customer : _____

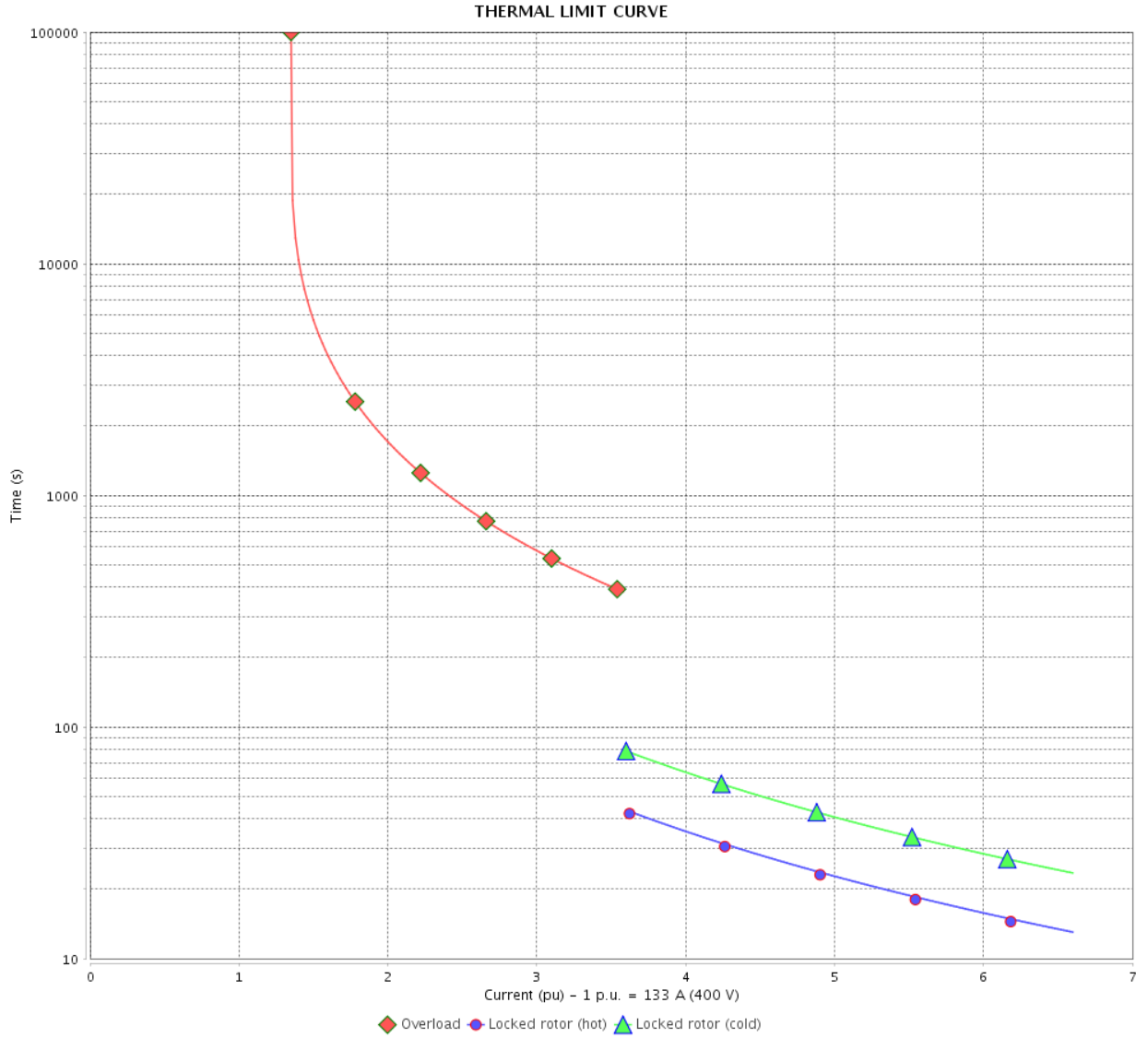

Rev.	Changes Summary	Performed	Checked	Date
Performed by		Page 5 / 6		Revision
Checked by				
Date				

VFD OPERATION CURVE

Three Phase Induction Motor - Squirrel Cage



Customer :

Product line : W40 NEMA Premium Efficiency
Three-Phase

Product code : 14272481

Catalog # : 10036OT3V365TS-W40

VFD OPERATION CURVE

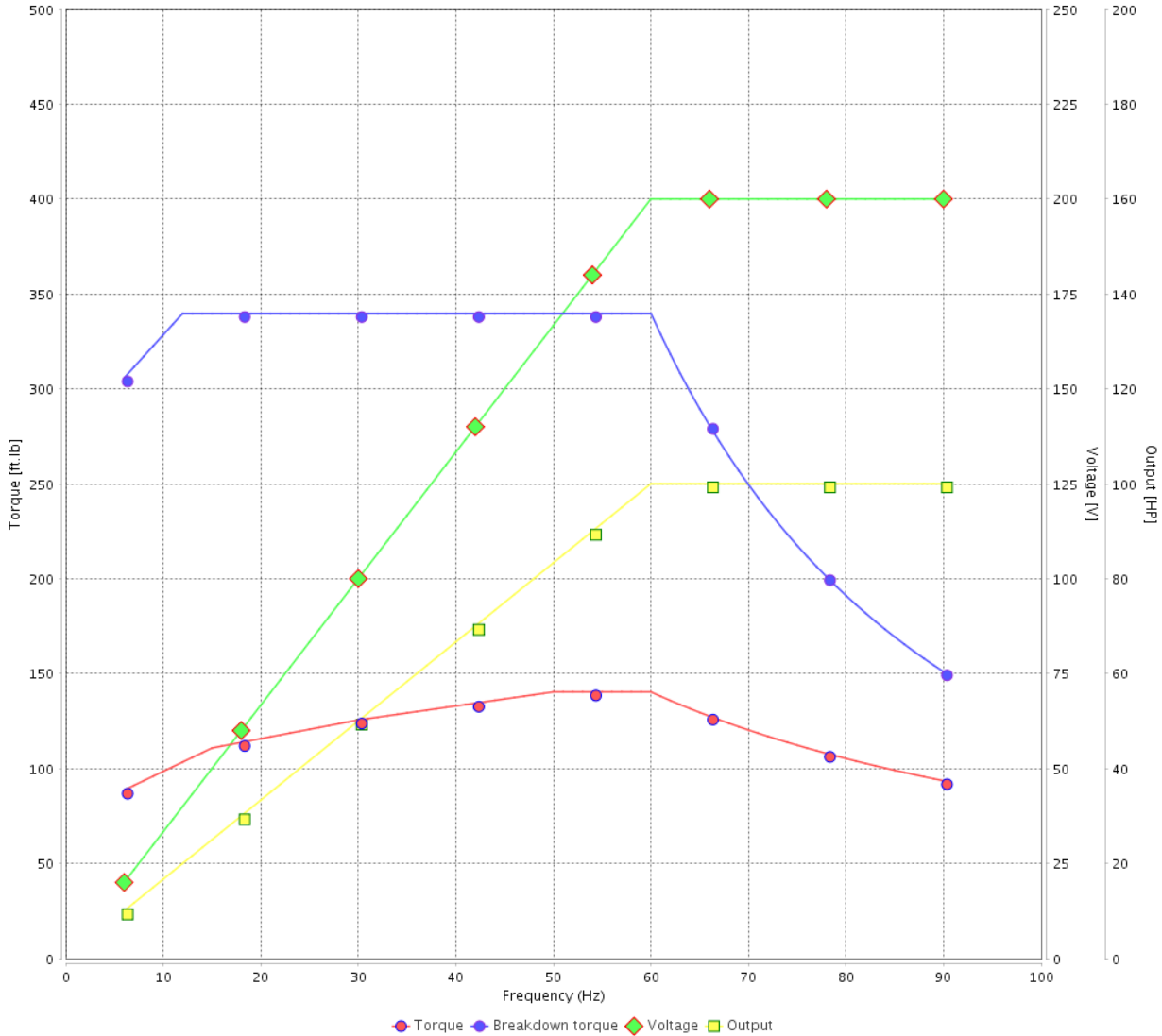

Performance : 200/400 V 60 Hz 2P

Rated current : 267/133 A
LRC : 6.6
Rated torque : 148 ft.lb
Locked rotor torque : 180 %
Breakdown torque : 229 %
Rated speed : 3555 rpm

Moment of inertia (J) : 7.20 sq.ft.lb
Duty cycle : Cont.(S1)
Insulation class : F
Service factor : 1.25
Temperature rise : 80 K
Design : B

Rev.	Changes Summary	Performed	Checked	Date
Performed by			Page 6 / 6	Revision
Checked by				
Date	12/04/2022			

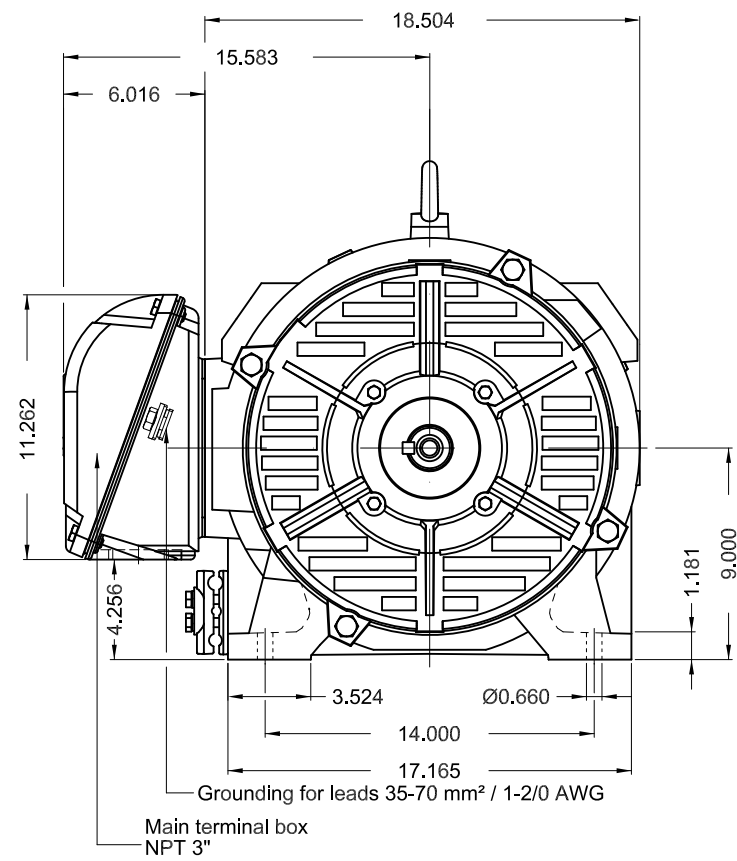

Main terminal box
NPT 3"

Grounding for leads 35-70 mm² / 1-2/0 AWG

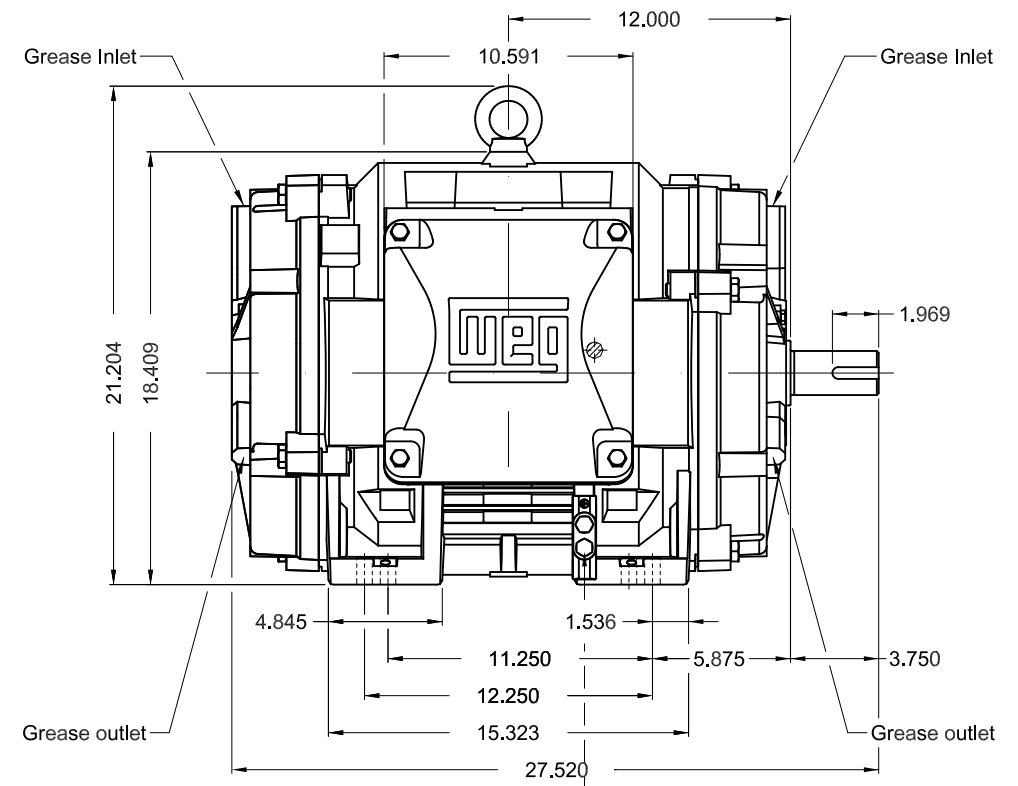

Grounding for leads 25-185 mm² / 3AWG-350MCM

100 HP 02 Poles 60 Hz

A

1:8

ECM	LOC	SUMMARY OF MODIFICATIONS	EXECUTED	CHECKED	RELEASED	DATE	VER
EXECUTED	PIRWUSER	THREE PH. MOTOR W40 PREM. EFF.					
CHECKED		FRAME 364/STS IP23 ODP					
RELEASED							
REL DT.	WMO	Jaragua do Sul	Product Engineering	SHEET	1 / 1		

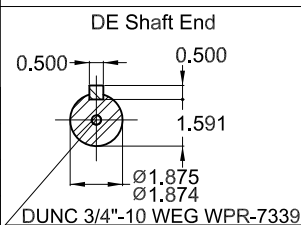

Color RAL 5009
Painting plan 203A
Mounting NEMA F-1
Mounting B3R(D)

Dimensions in inches

XME A3



PREVIEW
WDD