

DATA SHEET

Three Phase Induction Motor - Squirrel Cage



Customer : _____

Thermal protection

ID	Application	Type	Quantity	Sensing Temperature
1	Winding	Thermostat - 2 wires	1 x Phase	155 °C

Rev.	Changes Summary	Performed	Checked	Date
Performed by				
Checked by			Page	Revision
Date	12/04/2022		2 / 7	

TORQUE AND CURRENT VS SPEED CURVE



Three Phase Induction Motor - Squirrel Cage

Customer :

Product line : NEMA Premium Efficiency Three-Phase

Product code : 11360897

Catalog # : 10036XT3H405TS

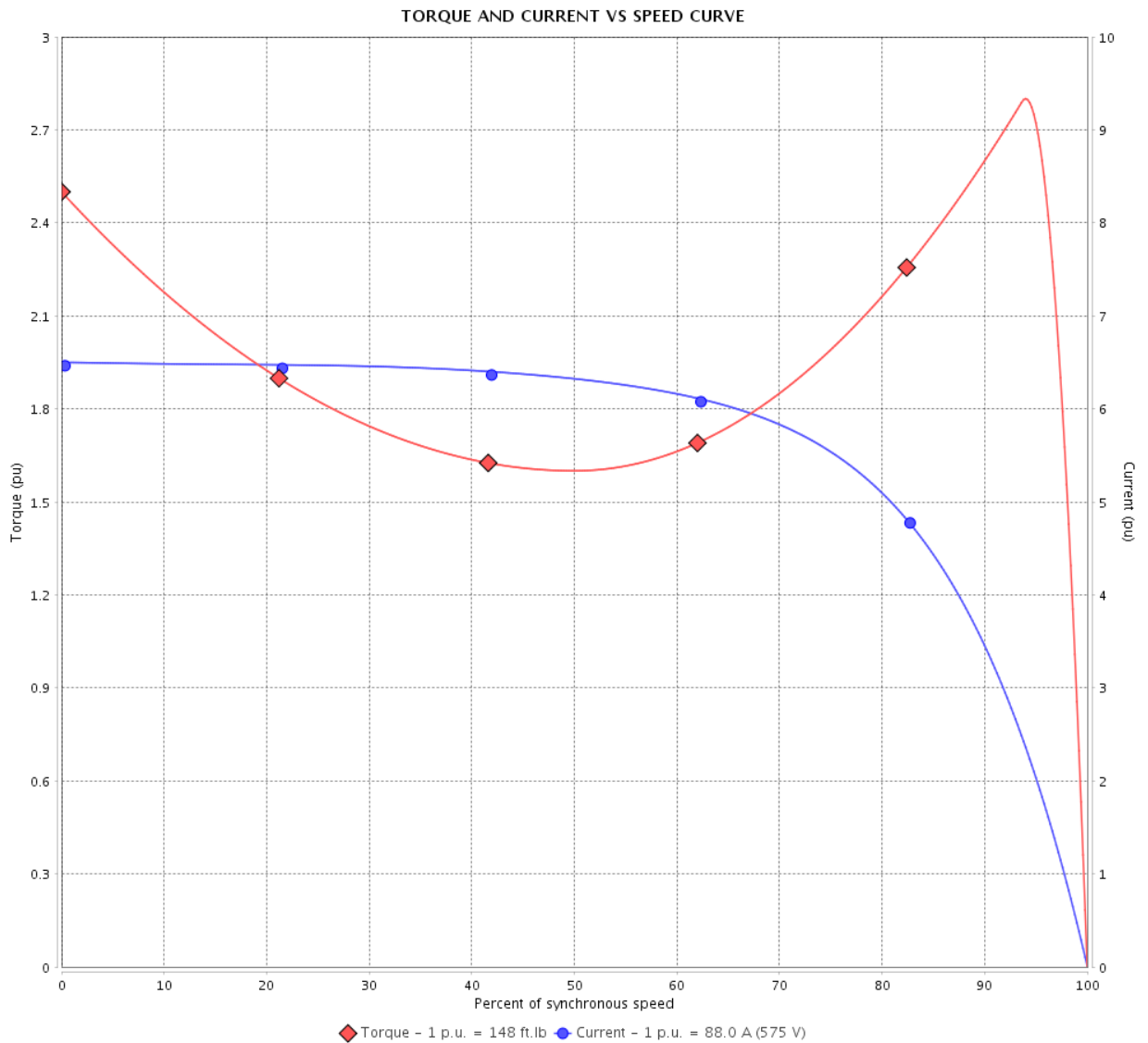

Performance : 575 V 60 Hz 2P

Rated current	: 88.0 A	Moment of inertia (J)	: 13.2 sq.ft.lb
LRC	: 6.5	Duty cycle	: Cont.(S1)
Rated torque	: 148 ft.lb	Insulation class	: F
Locked rotor torque	: 250 %	Service factor	: 1.15
Breakdown torque	: 280 %	Temperature rise	: 80 K
Rated speed	: 3550 rpm	Design	: B

Locked rotor time : 37s (cold) 21s (hot)

Rev.	Changes Summary	Performed	Checked	Date
Performed by			Page 3 / 7	Revision
Checked by				
Date	12/04/2022			

LOAD PERFORMANCE CURVE

Three Phase Induction Motor - Squirrel Cage



Customer :

Product line : NEMA Premium Efficiency Three-Phase

Product code : 11360897

Catalog # : 10036XT3H405TS

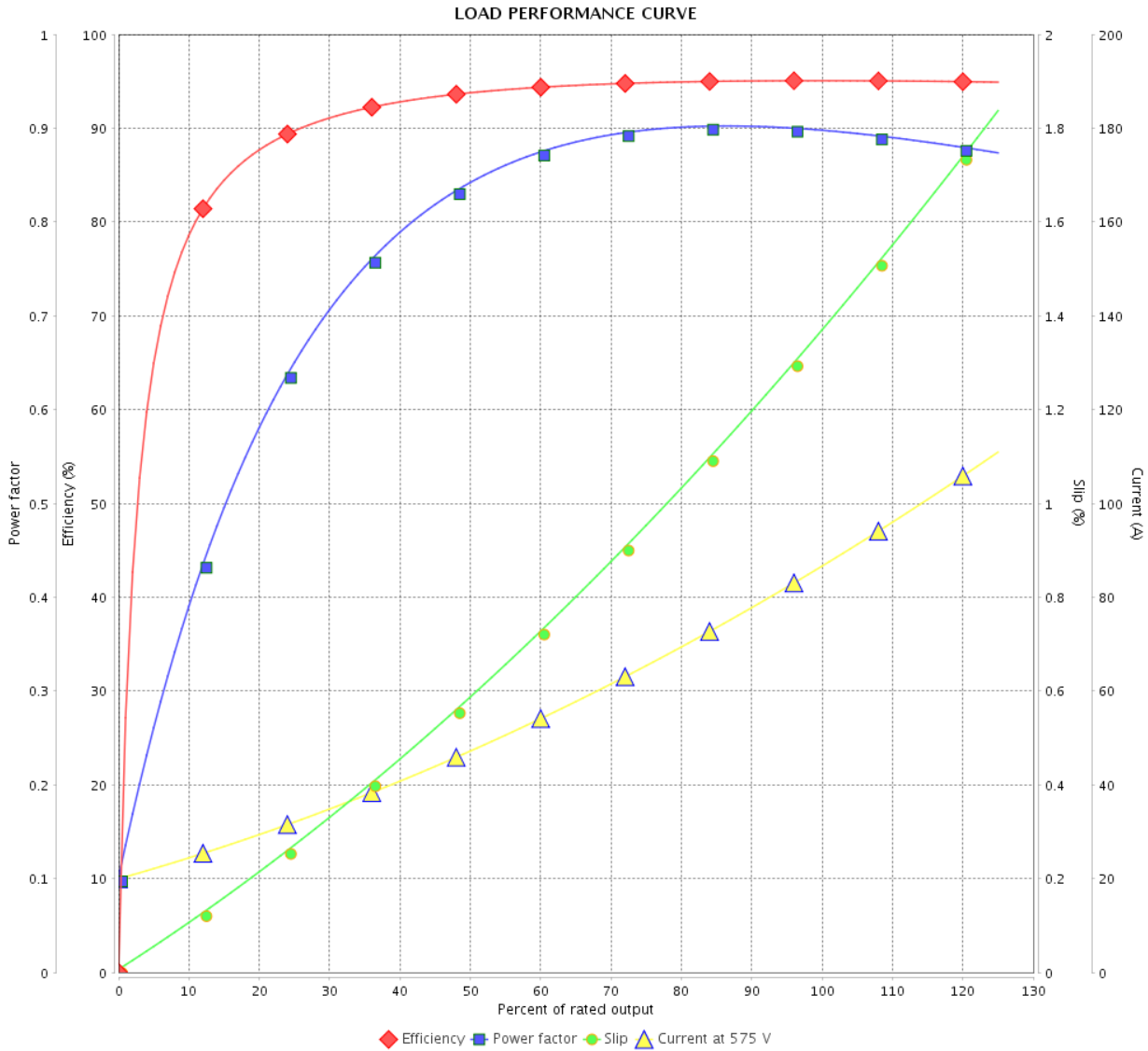

Performance : 575 V 60 Hz 2P

Rated current : 88.0 A
 LRC : 6.5
 Rated torque : 148 ft.lb
 Locked rotor torque : 250 %
 Breakdown torque : 280 %
 Rated speed : 3550 rpm

Moment of inertia (J) : 13.2 sq.ft.lb
 Duty cycle : Cont.(S1)
 Insulation class : F
 Service factor : 1.15
 Temperature rise : 80 K
 Design : B

Rev.	Changes Summary	Performed	Checked	Date
Performed by			Page 4 / 7	Revision
Checked by				
Date	12/04/2022			

THERMAL LIMIT CURVE



Three Phase Induction Motor - Squirrel Cage

Customer :

Product line : NEMA Premium Efficiency Three-Phase
 Product code : 11360897
 Catalog # : 10036XT3H405TS

Performance : 575 V 60 Hz 2P

Rated current : 88.0 A	Moment of inertia (J) : 13.2 sq.ft.lb
LRC : 6.5	Duty cycle : Cont.(S1)
Rated torque : 148 ft.lb	Insulation class : F
Locked rotor torque : 250 %	Service factor : 1.15
Breakdown torque : 280 %	Temperature rise : 80 K
Rated speed : 3550 rpm	Design : B

Heating constant

Cooling constant

Rev.	Changes Summary	Performed	Checked	Date
Performed by			Page 5 / 7	Revision
Checked by				
Date	12/04/2022			

THERMAL LIMIT CURVE

Three Phase Induction Motor - Squirrel Cage



Customer : _____

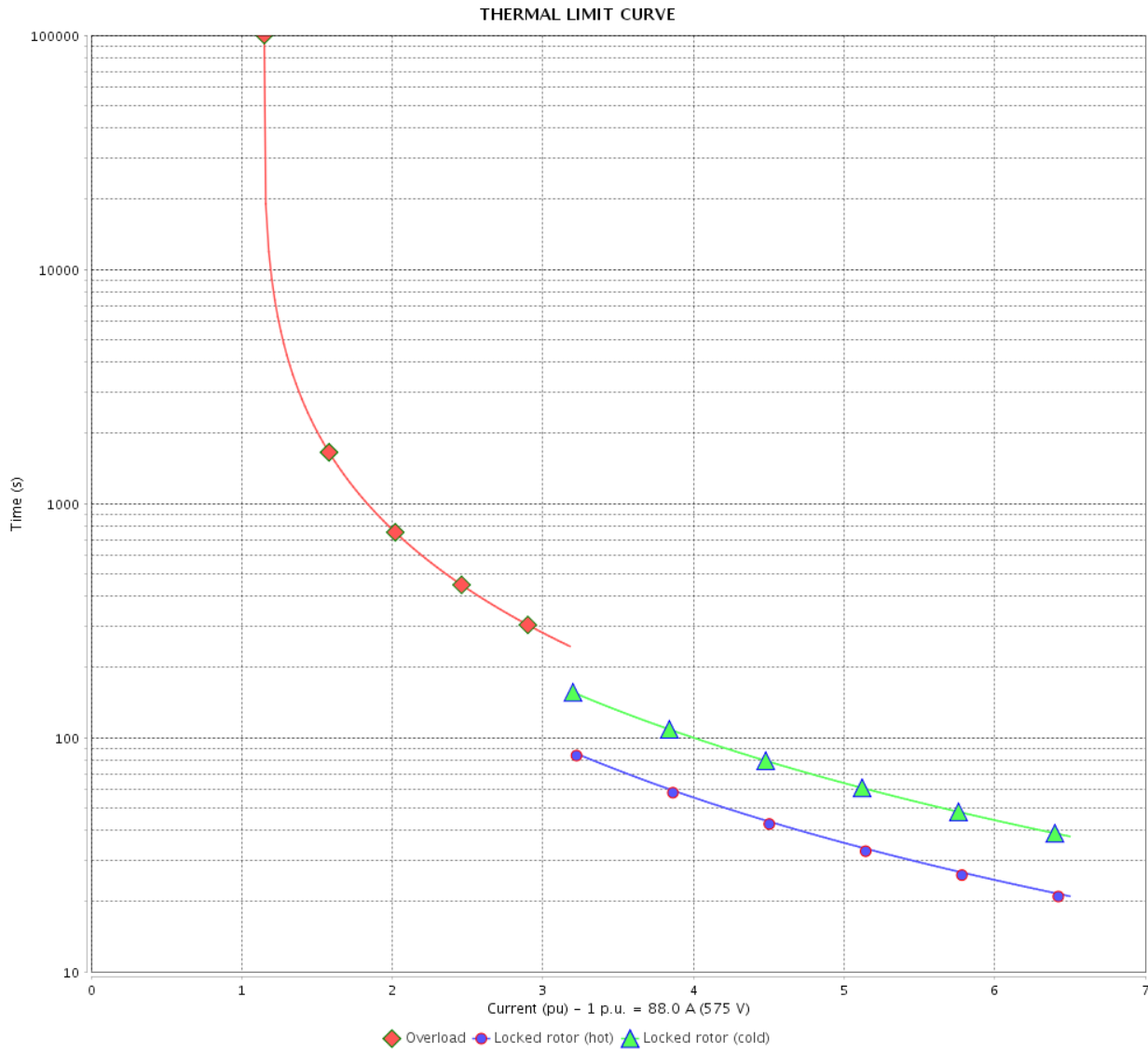

Rev.	Changes Summary	Performed	Checked	Date
Performed by		Page		Revision
Checked by		6 / 7		
Date		12/04/2022		

VFD OPERATION CURVE

Three Phase Induction Motor - Squirrel Cage



Customer :

Product line : NEMA Premium Efficiency Three-Phase

Product code : 11360897

Catalog # : 10036XT3H405TS

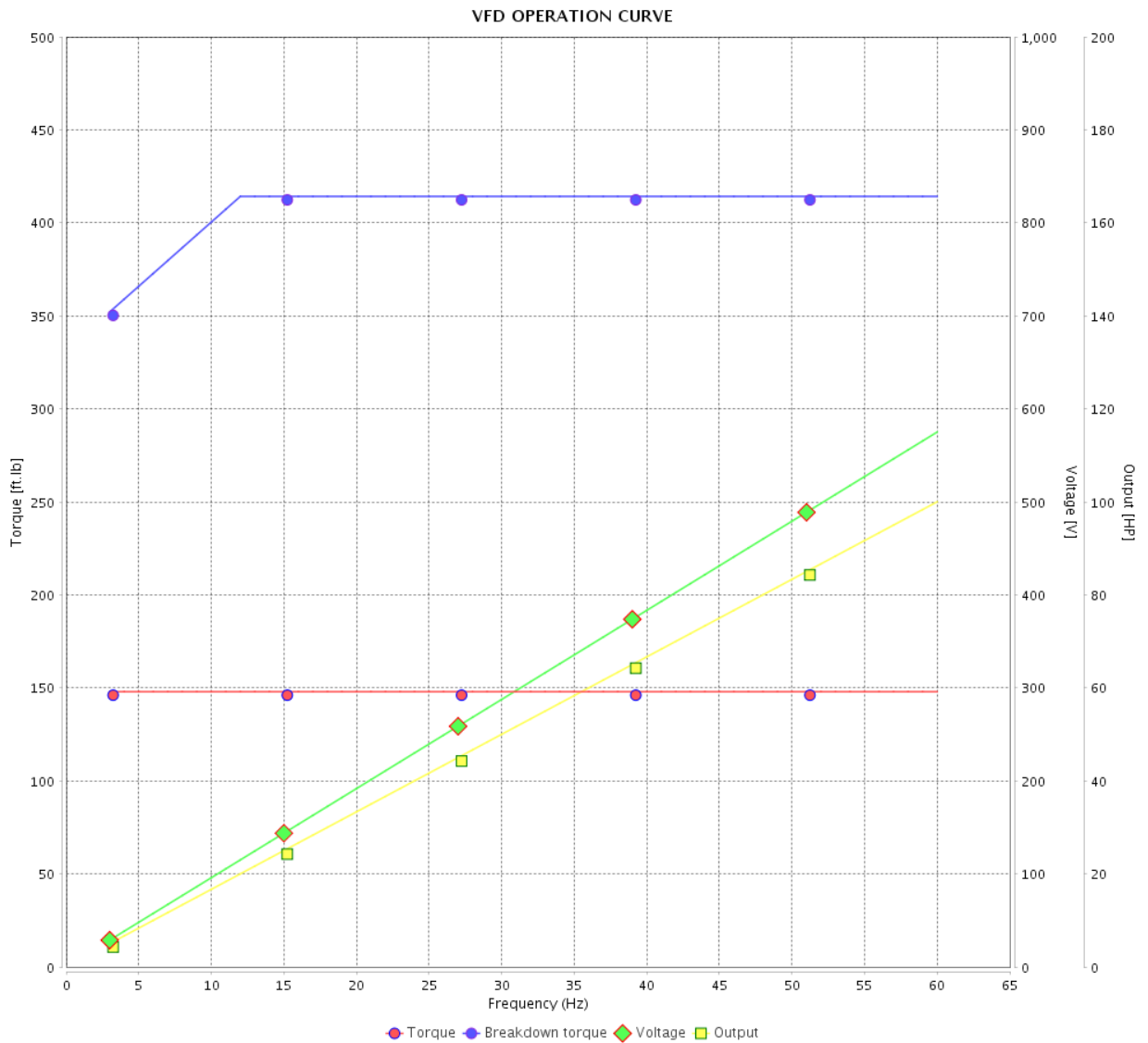

Performance : 575 V 60 Hz 2P

Rated current : 88.0 A
 LRC : 6.5
 Rated torque : 148 ft.lb
 Locked rotor torque : 250 %
 Breakdown torque : 280 %
 Rated speed : 3550 rpm

Moment of inertia (J) : 13.2 sq.ft.lb
 Duty cycle : Cont.(S1)
 Insulation class : F
 Service factor : 1.15
 Temperature rise : 80 K
 Design : B

Rev.	Changes Summary	Performed	Checked	Date
Performed by			Page 7 / 7	Revision
Checked by				
Date	12/04/2022			

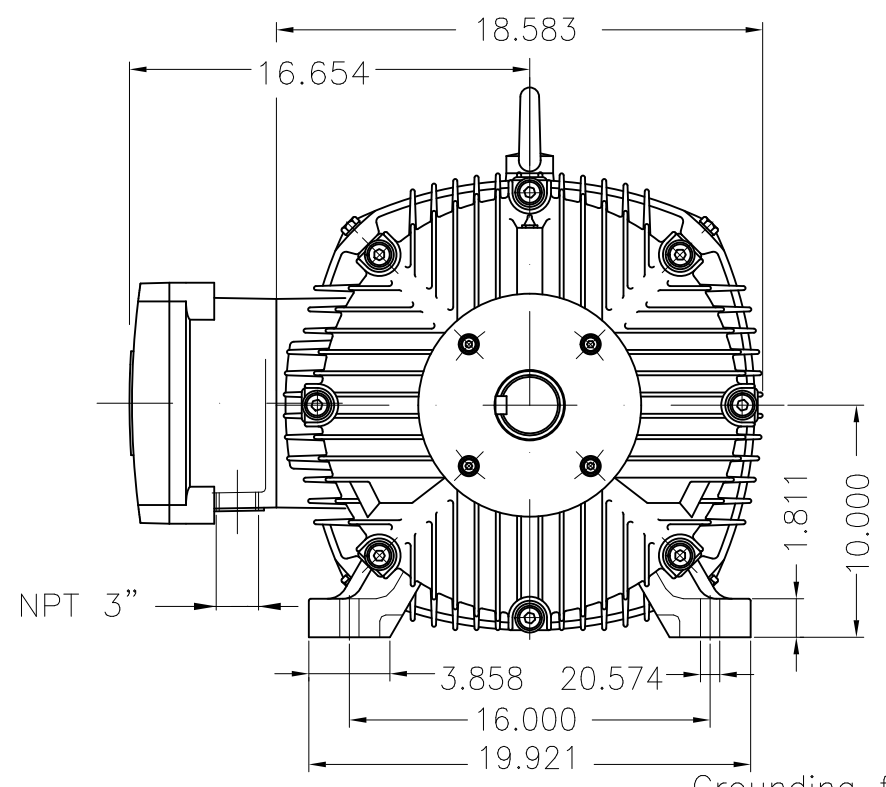

Grounding for leads 25-50 mm² / 3-1 AWG

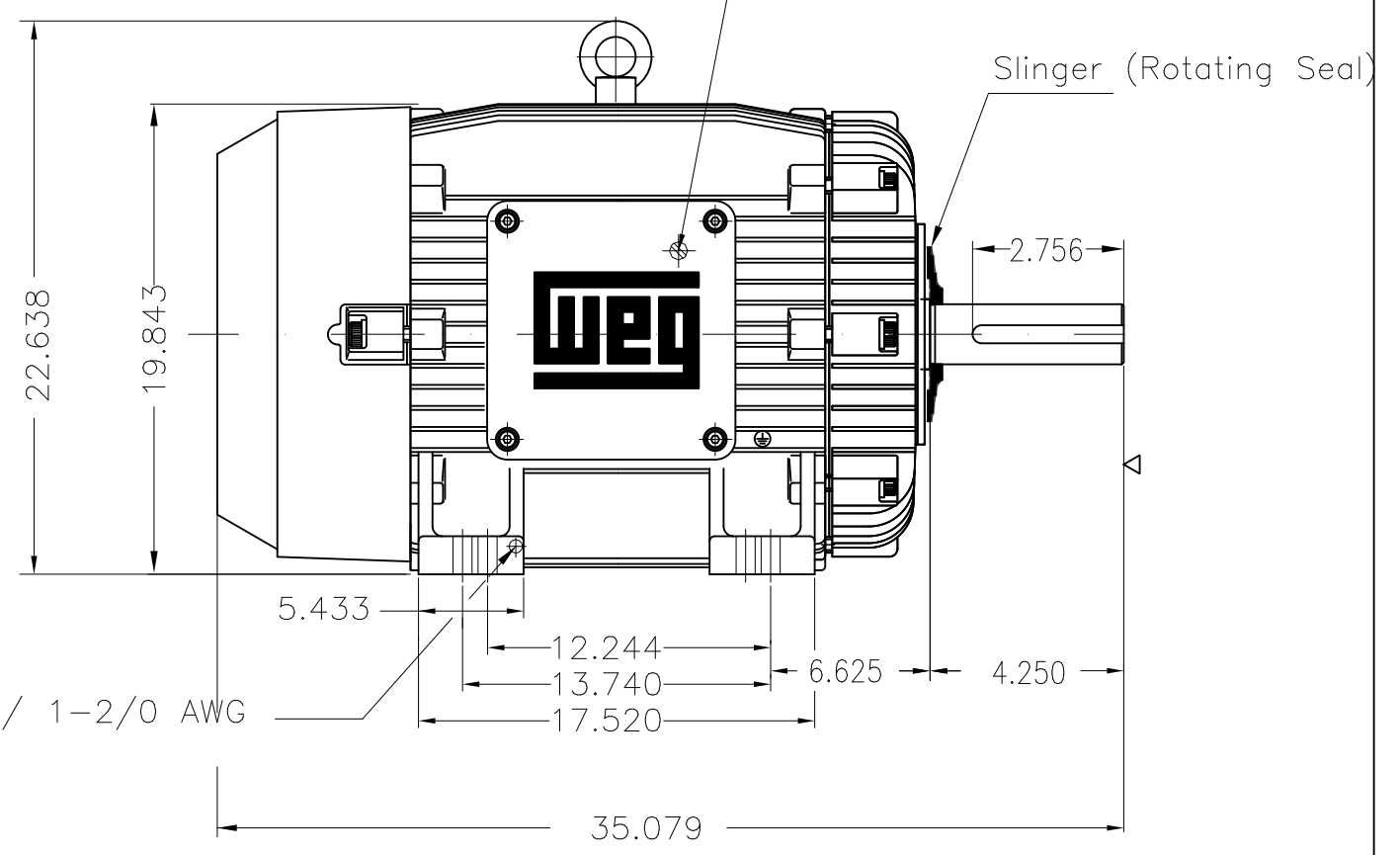

Grounding for leads 35-70 mm² / 1-2/0 AWG

Color RAL 5009
 Painting plan 202P
 Mounting B3R(D)

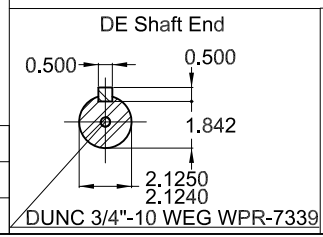

100 HP 02 Poles 60 Hz A

ECM	LOC	SUMMARY OF MODIFICATIONS	EXECUTED	CHECKED	RELEASED	DATE	VER
EXECUTED	PIRWBUSER	THREE PH. MOTOR EXPLOSION PROOF PREM. EFF.					
CHECKED		FRAME 404/STS IP55 TEFC					
RELEASED							
REL DT.	WMO	Jaragua do Sul	Product Engineering				

PREVIEW
 WDD



SHEET 1 / 1



W21X NEMA
CC029A Premium

*Inverter Duty Motor
 Severe Duty*



TEMP CODE T3C
 CSA/UL: Class I - Div. 1 - Groups C and D
 CSA: Class II - Div. 1 - Groups F and G
 CSA: Class I - Zone 1 - IIB
EXPLOSION PROOF MOTOR
 FOR USE ON VPWM VFD 1000:1VT, 2:1CT, 1.0SF, T3C, AMB 40°C.

HX100502NPW21X
 MADE IN BRAZIL
 11360897

PH 3	FR 404/5TS	HP(kW) 100(75)	Hz 60
V 575	A 88.0	RPM 3550	
NEMA NOM. EFF. 95.0%		INS CL F Δ T 80 K	IP55
PF 0.90	DUTY CONT.	CODE G	
ENCL. TEFC	SF 1.15	SFA 101	
AMB 40°C	DES B		
AMB 55°C SF1.0	-bearings lub interval reduced by a factor of 50%		

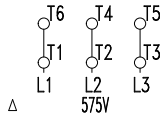

→ 6314-C3(27g) MOBIL POLYREX EM
 → 6314-C3(27g) 3604 h
 ALT 1000 m.a.s.l | 1186 Lbs