

DATA SHEET



Three Phase Induction Motor - Squirrel Cage

Customer :

Product line : W40 NEMA Premium Efficiency Three-Phase Product code : 14272436
Catalog # : 12536OT3H404TS-W40

Frame	: 404/5TS	Locked rotor time	: 21s (cold) 12s (hot)
Output	: 125 HP	Temperature rise	: 80 K
Poles	: 2	Duty cycle	: Cont.(S1)
Frequency	: 60 Hz	Ambient temperature	: -20°C to +40°C
Rated voltage	: 575 V	Altitude	: 1000 m.a.s.l.
Rated current	: 109 A	Protection degree	: IP23
L. R. Amperes	: 740 A	Cooling method	: IC01 - ODP
LRC	: 6.8x(Code G)	Mounting	: F-1
No load current	: 28.8 A	Rotation ¹	: Both (CW and CCW)
Rated speed	: 3557 rpm	Noise level ²	: 84.0 dB(A)
Slip	: 1.19 %	Starting method	: Direct On Line
Rated torque	: 185 ft.lb	Approx. weight ³	: 861 lb
Locked rotor torque	: 170 %		
Breakdown torque	: 260 %		
Insulation class	: F		
Service factor	: 1.25		
Moment of inertia (J)	: 8.23 sq.ft.lb		
Design	: B		

Output	25%	50%	75%	100%	Foundation loads
Efficiency (%)	92.8	93.0	94.1	94.1	Max. traction : 1008 lb
Power Factor	0.57	0.79	0.86	0.88	Max. compression : 1869 lb

	Drive end	Non drive end
Bearing type	: 6314 C3	: 6212 Z C3
Sealing	: Without Bearing Seal	: Without Bearing Seal
Lubrication interval	: 14418 h	: 20000 h
Lubricant amount	: 27 g	: 13 g
Lubricant type	: Mobil Polyrex EM	

Notes

This revision replaces and cancel the previous one, which must be eliminated.
(1) Looking the motor from the shaft end.
(2) Measured at 1m and with tolerance of +3dB(A).
(3) Approximate weight subject to changes after manufacturing process.
(4) At 100% of full load.

These are average values based on tests with sinusoidal power supply, subject to the tolerances stipulated in NEMA MG-1.

Rev.	Changes Summary	Performed	Checked	Date
Performed by				
Checked by			Page	Revision
Date	13/04/2022		1 / 6	

TORQUE AND CURRENT VS SPEED CURVE

Three Phase Induction Motor - Squirrel Cage



Customer :

Product line : W40 NEMA Premium Efficiency
Three-Phase

Product code : 14272436

Catalog # : 12536OT3H404TS-W40

TORQUE AND CURRENT VS SPEED CURVE

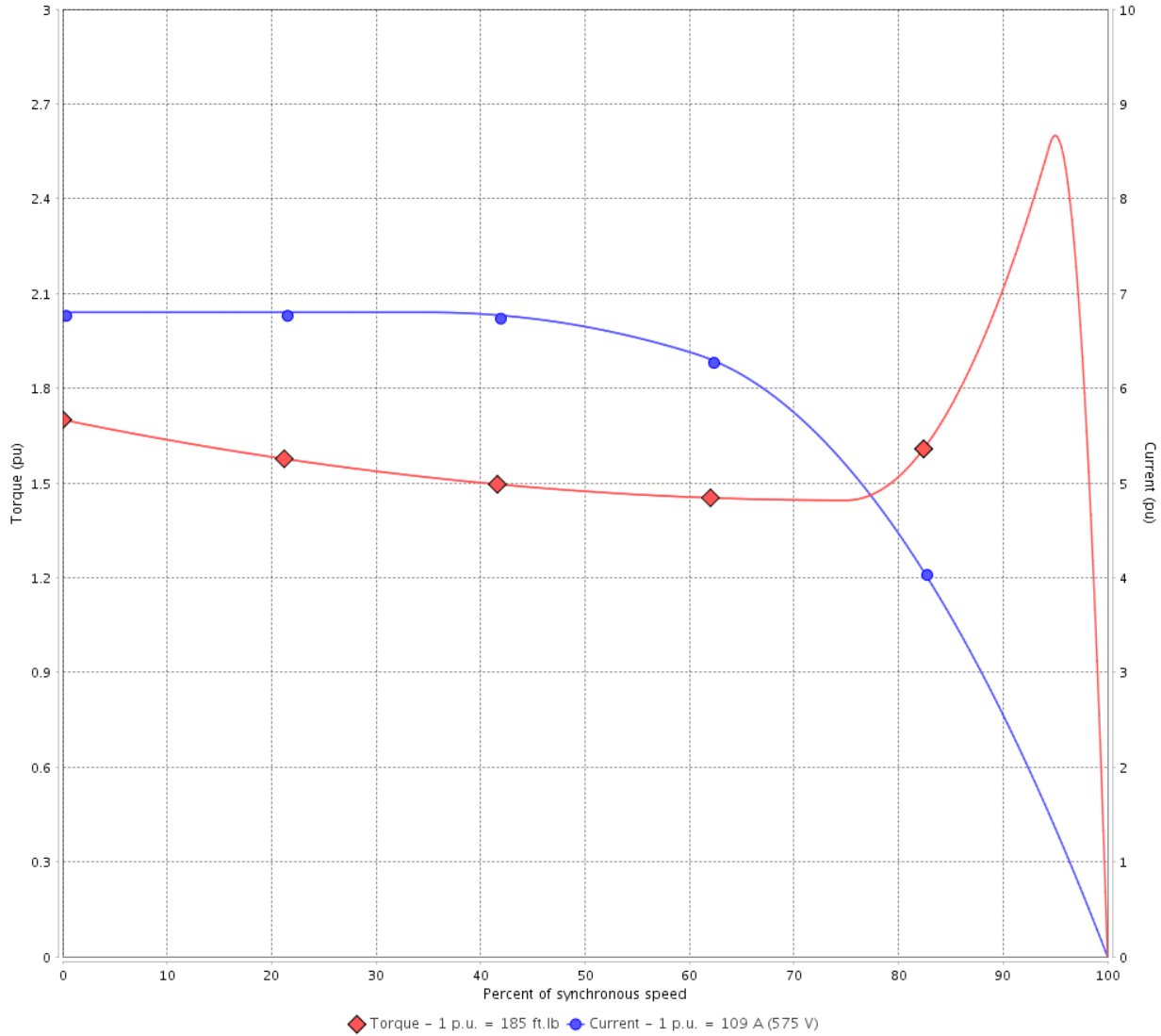

Performance : 575 V 60 Hz 2P

Rated current	: 109 A	Moment of inertia (J)	: 8.23 sq.ft.lb
LRC	: 6.8	Duty cycle	: Cont.(S1)
Rated torque	: 185 ft.lb	Insulation class	: F
Locked rotor torque	: 170 %	Service factor	: 1.25
Breakdown torque	: 260 %	Temperature rise	: 80 K
Rated speed	: 3557 rpm	Design	: B

Locked rotor time : 21s (cold) 12s (hot)

Rev.	Changes Summary	Performed	Checked	Date
Performed by			Page 2 / 6	Revision
Checked by				
Date	13/04/2022			

LOAD PERFORMANCE CURVE

Three Phase Induction Motor - Squirrel Cage



Customer :

Product line : W40 NEMA Premium Efficiency Three-Phase

Product code : 14272436

Catalog # : 12536OT3H404TS-W40

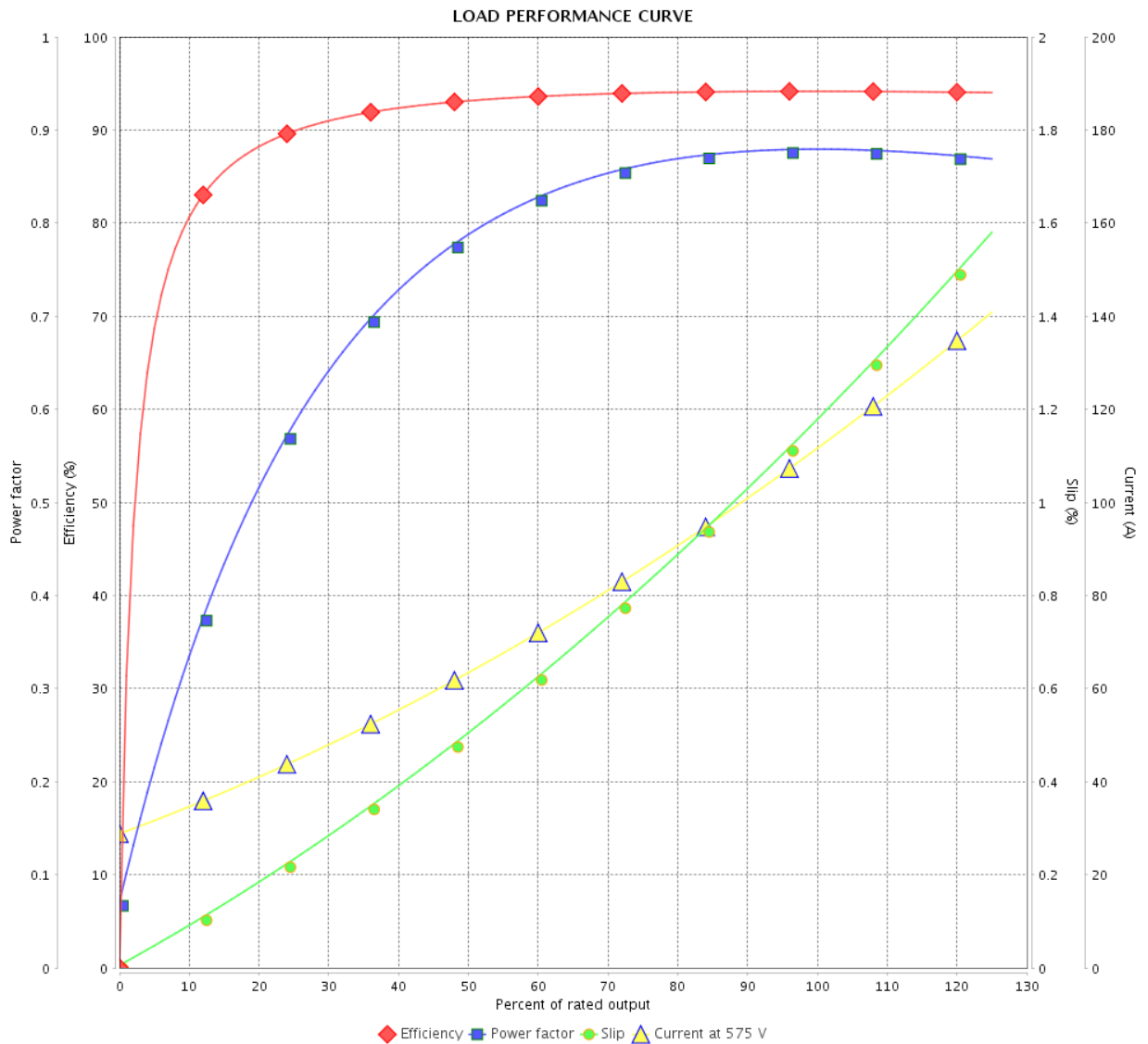

Performance : 575 V 60 Hz 2P

Rated current : 109 A
 LRC : 6.8
 Rated torque : 185 ft.lb
 Locked rotor torque : 170 %
 Breakdown torque : 260 %
 Rated speed : 3557 rpm

Moment of inertia (J) : 8.23 sq.ft.lb
 Duty cycle : Cont.(S1)
 Insulation class : F
 Service factor : 1.25
 Temperature rise : 80 K
 Design : B

Rev.	Changes Summary	Performed	Checked	Date
Performed by		Page		Revision
Checked by		3 / 6		
Date		13/04/2022		

THERMAL LIMIT CURVE



Three Phase Induction Motor - Squirrel Cage

Customer :

Product line : W40 NEMA Premium Efficiency
Three-Phase

Product code : 14272436

Catalog # : 12536OT3H404TS-W40

Performance : 575 V 60 Hz 2P

Rated current	: 109 A	Moment of inertia (J)	: 8.23 sq.ft.lb
LRC	: 6.8	Duty cycle	: Cont.(S1)
Rated torque	: 185 ft.lb	Insulation class	: F
Locked rotor torque	: 170 %	Service factor	: 1.25
Breakdown torque	: 260 %	Temperature rise	: 80 K
Rated speed	: 3557 rpm	Design	: B

Heating constant

Cooling constant

Rev.	Changes Summary	Performed	Checked	Date
Performed by				
Checked by			Page	Revision
Date	13/04/2022		4 / 6	

THERMAL LIMIT CURVE

Three Phase Induction Motor - Squirrel Cage



Customer : _____

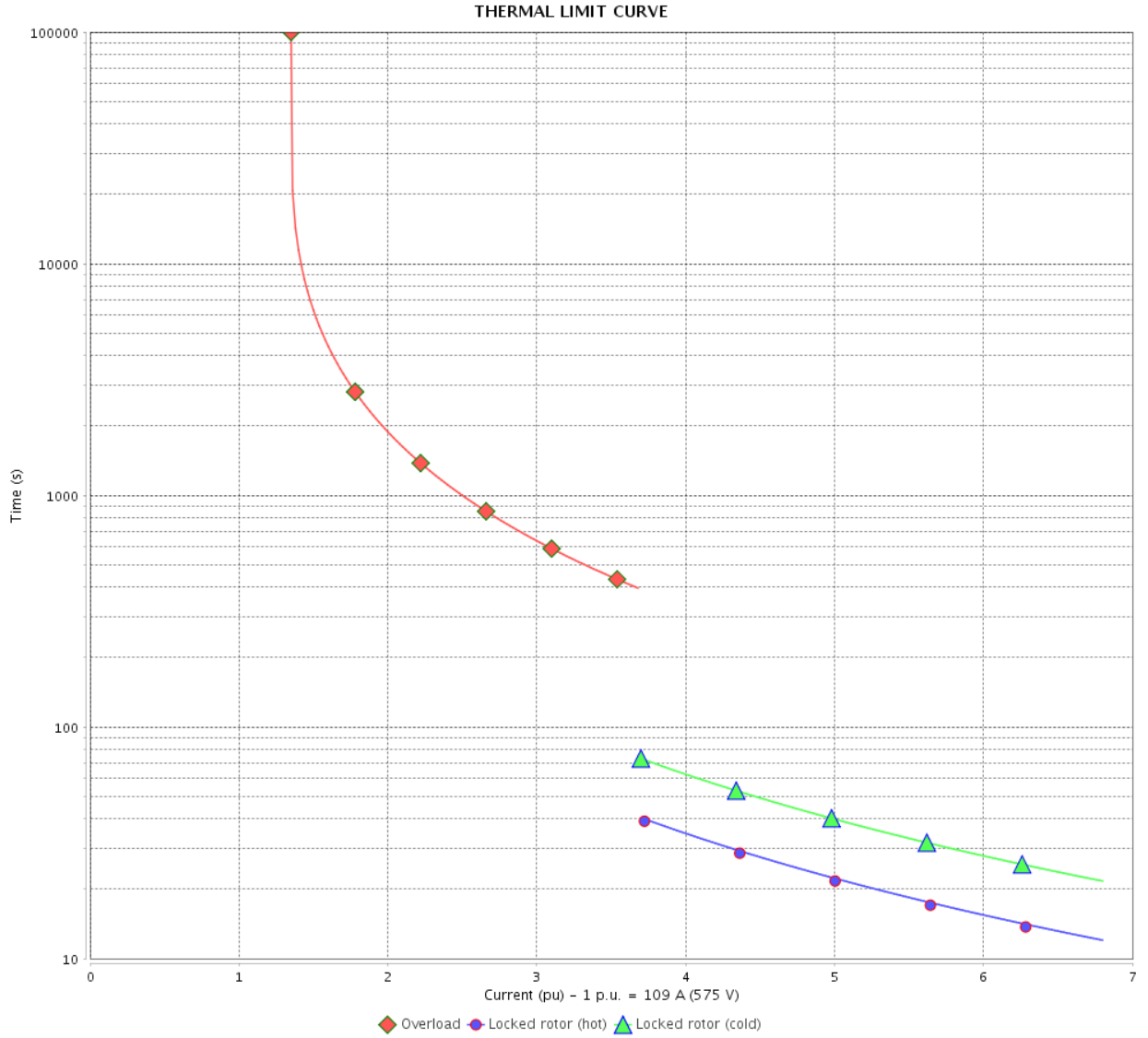

Rev.	Changes Summary	Performed	Checked	Date
Performed by		Page 5 / 6		Revision
Checked by				
Date				

VFD OPERATION CURVE

Three Phase Induction Motor - Squirrel Cage



Customer :

Product line : W40 NEMA Premium Efficiency
Three-Phase

Product code : 14272436

Catalog # : 12536OT3H404TS-W40

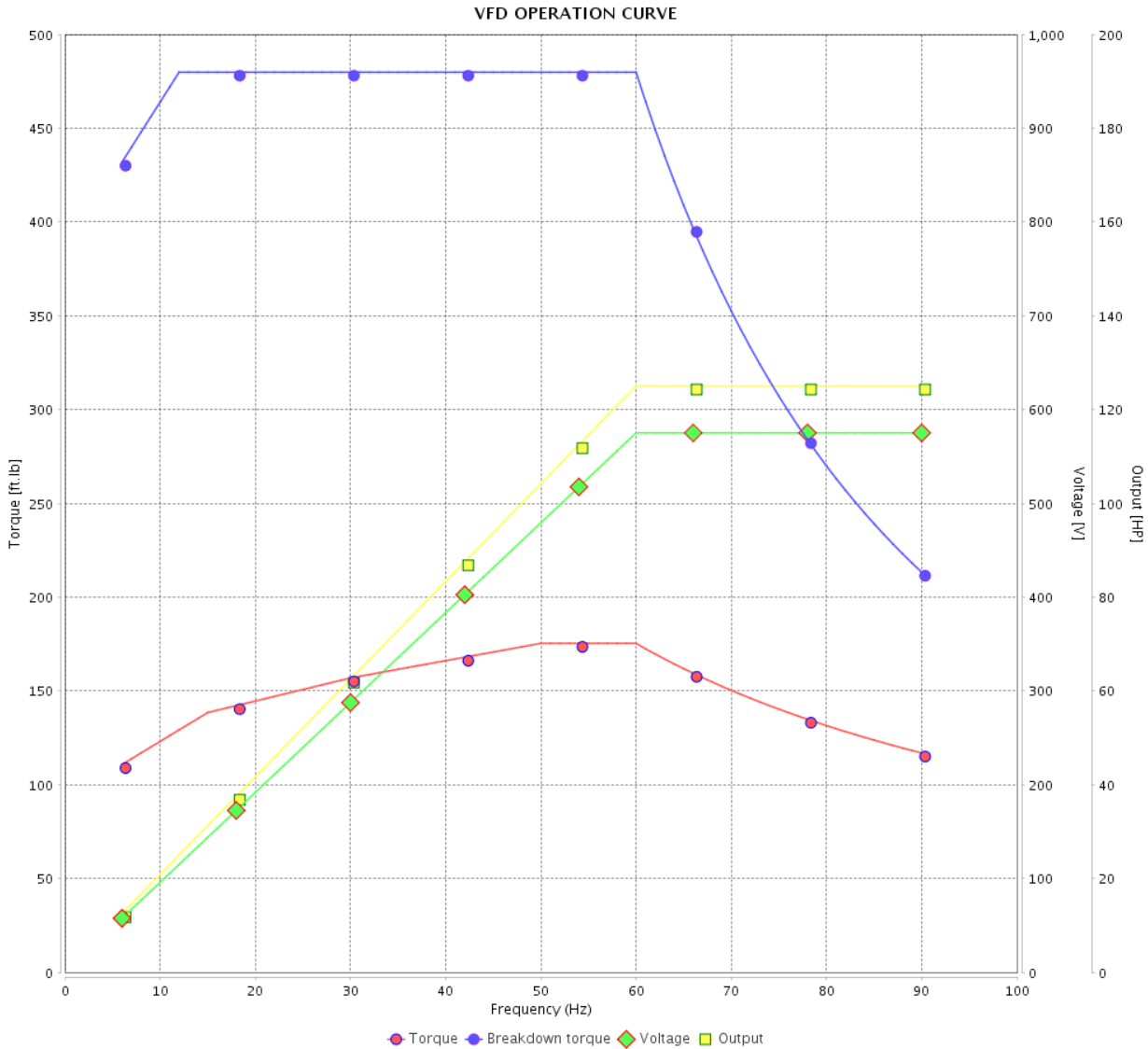

Performance : 575 V 60 Hz 2P

Rated current : 109 A
LRC : 6.8
Rated torque : 185 ft.lb
Locked rotor torque : 170 %
Breakdown torque : 260 %
Rated speed : 3557 rpm

Moment of inertia (J) : 8.23 sq.ft.lb
Duty cycle : Cont.(S1)
Insulation class : F
Service factor : 1.25
Temperature rise : 80 K
Design : B

Rev.	Changes Summary	Performed	Checked	Date
Performed by			Page 6 / 6	Revision
Checked by				
Date	13/04/2022			

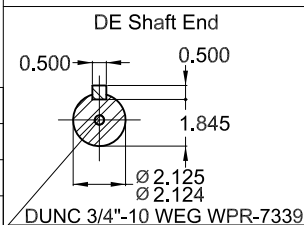
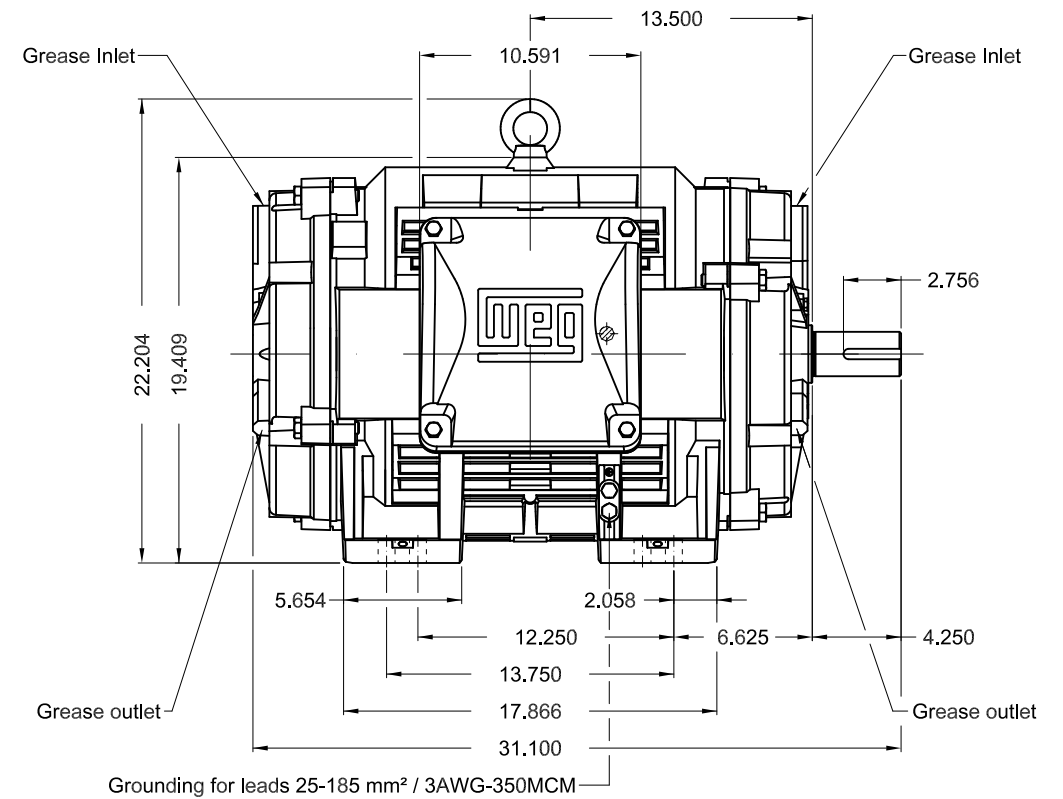
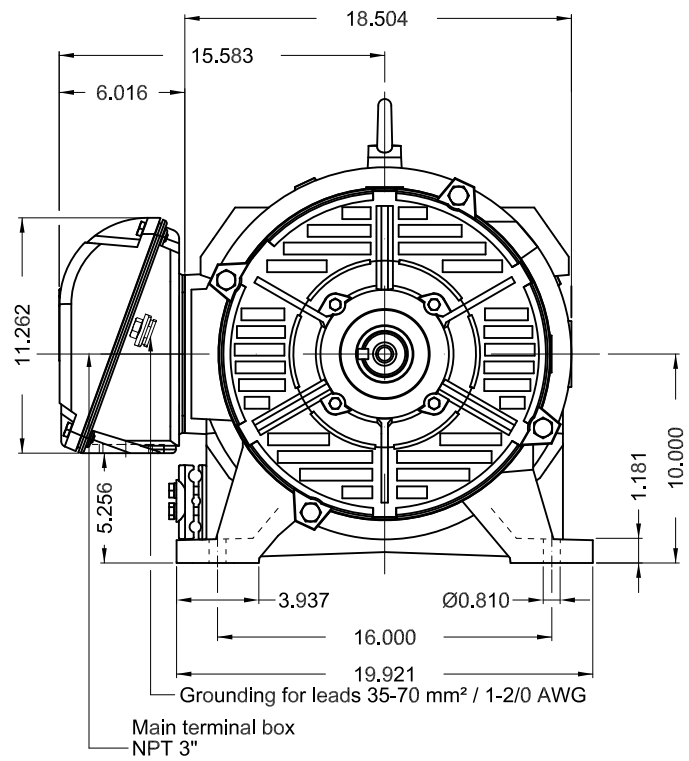

Color RAL 5009
Painting plan 203A
Mounting NEMA F-1
Mounting B3R(D)

125 HP 02 Poles 60 Hz

A

1:9

ECM	LOC	SUMMARY OF MODIFICATIONS	EXECUTED	CHECKED	RELEASED	DATE	VER
EXECUTED	PIRWBUSER	THREE PH. MOTOR W40 PREM. EFF.					
CHECKED		FRAME 404/5TS IP23 ODP					
RELEASED							
REL DT.	WMO	Jaragua do Sul	Product Engineering	SHEET	1 / 1		

PREVIEW
WDD



MODEL 125360T3H404TS-W40
MADE IN BRAZIL
14272436

WEG **W40 NEMA**
CC029A Premium
Inverter Duty Motor



MOD.T01#FOXON



For use on PWM, VT 1000:1, CT 2:1, 1.0SF

PH 3	FR 404/5TS	HP(kW) 125(90)		Hz 60
V 575		A 109		IP23
NEMA NOM EFF		94.1	%	RPM 3557
ENCL ODP	DUTY CONT.		INS. CL. F Δ T 80 K	
PF 0.88		DES B	CODE G	AMB. 40°C
SF 1.25		SFA 136		ALT 1000 m.a.s.l.

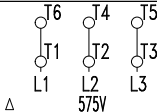

→ 6314-C3(27g)
→ 6212-Z-C3(13g)

MOBIL POLYREX EM
14418 h

860 Lbs