

TORQUE AND CURRENT VS SPEED CURVE

Three Phase Induction Motor - Squirrel Cage



Customer :

Product line : NEMA Premium Efficiency Three-Phase

Product code : 12139519

Catalog # : 20009ST3QIERB449T-W2

TORQUE AND CURRENT VS SPEED CURVE

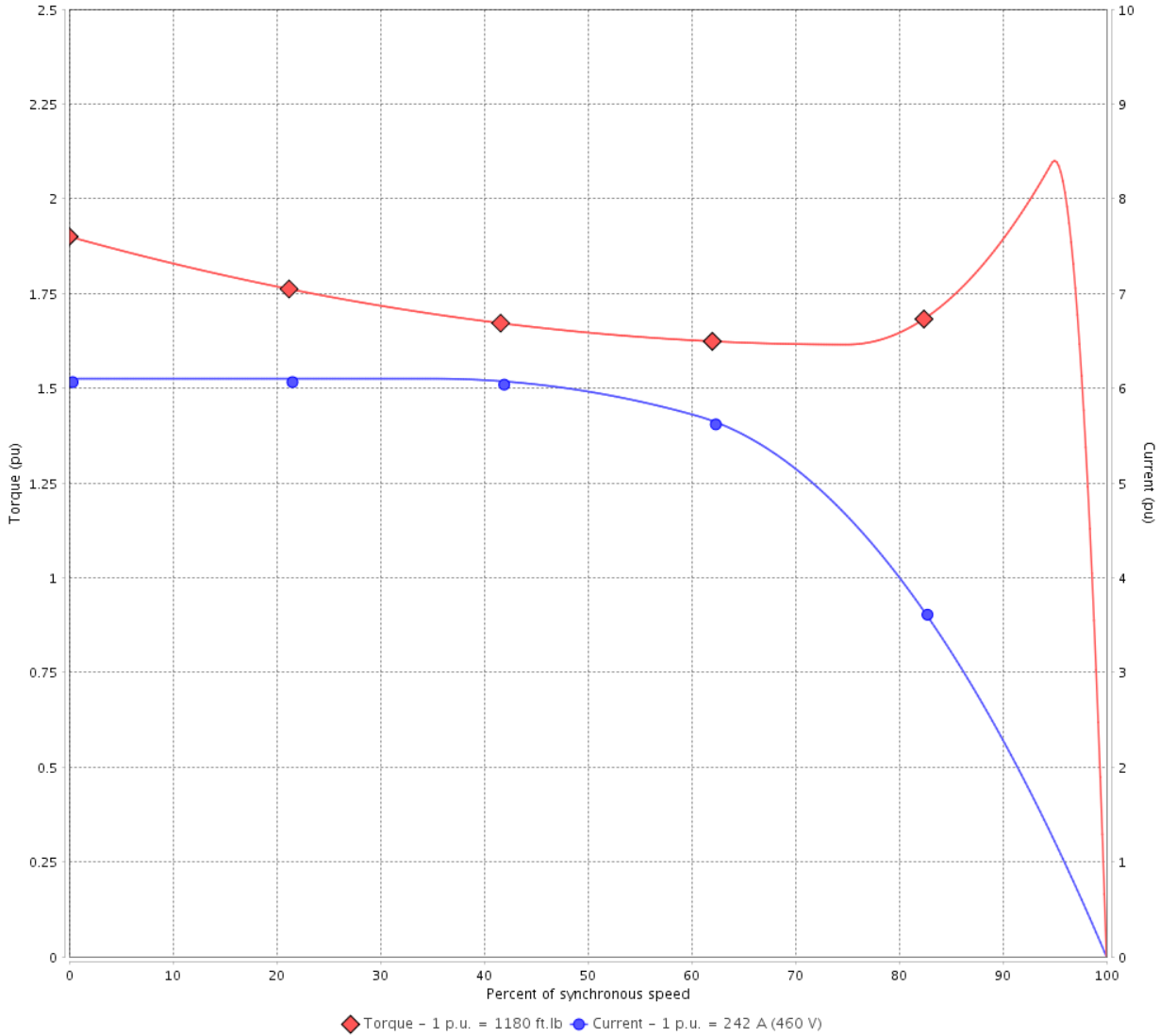

Performance : 460 V 60 Hz 8P

Rated current	: 242 A	Moment of inertia (J)	: 255 sq.ft.lb
LRC	: 6.1	Duty cycle	: Cont.(S1)
Rated torque	: 1180 ft.lb	Insulation class	: F
Locked rotor torque	: 190 %	Service factor	: 1.15
Breakdown torque	: 210 %	Temperature rise	: 80 K
Rated speed	: 891 rpm	Design	: B

Locked rotor time : 45s (cold) 25s (hot)

Rev.	Changes Summary	Performed	Checked	Date
Performed by			Page 2 / 6	Revision
Checked by				
Date	14/04/2022			

LOAD PERFORMANCE CURVE

Three Phase Induction Motor - Squirrel Cage



Customer :

Product line : NEMA Premium Efficiency Three-Phase

Product code : 12139519

Catalog # : 20009ST3QIERB449T-W2

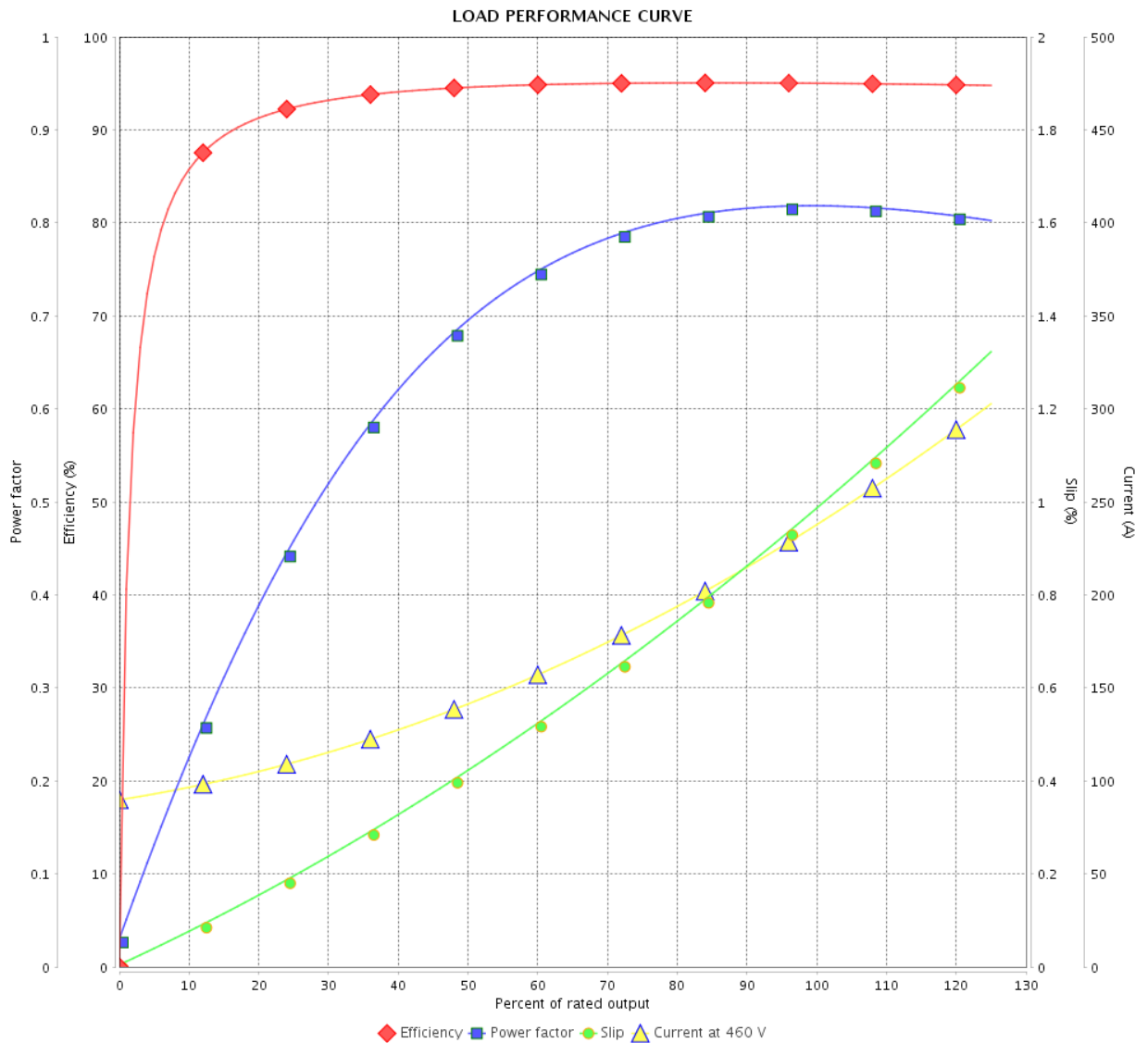

Performance : 460 V 60 Hz 8P

Rated current : 242 A
 LRC : 6.1
 Rated torque : 1180 ft.lb
 Locked rotor torque : 190 %
 Breakdown torque : 210 %
 Rated speed : 891 rpm

Moment of inertia (J) : 255 sq.ft.lb
 Duty cycle : Cont.(S1)
 Insulation class : F
 Service factor : 1.15
 Temperature rise : 80 K
 Design : B

Rev.	Changes Summary	Performed	Checked	Date
Performed by		Page		Revision
Checked by		3 / 6		
Date		14/04/2022		

THERMAL LIMIT CURVE



Three Phase Induction Motor - Squirrel Cage

Customer :

Product line : NEMA Premium Efficiency Three-Phase
Product code : 12139519
Catalog # : 20009ST3QIERB449T-W2

Performance : 460 V 60 Hz 8P

Rated current	: 242 A	Moment of inertia (J)	: 255 sq.ft.lb
LRC	: 6.1	Duty cycle	: Cont.(S1)
Rated torque	: 1180 ft.lb	Insulation class	: F
Locked rotor torque	: 190 %	Service factor	: 1.15
Breakdown torque	: 210 %	Temperature rise	: 80 K
Rated speed	: 891 rpm	Design	: B

Heating constant

Cooling constant

Rev.	Changes Summary	Performed	Checked	Date
Performed by				
Checked by			Page	Revision
Date	14/04/2022		4 / 6	

THERMAL LIMIT CURVE

Three Phase Induction Motor - Squirrel Cage



Customer : _____

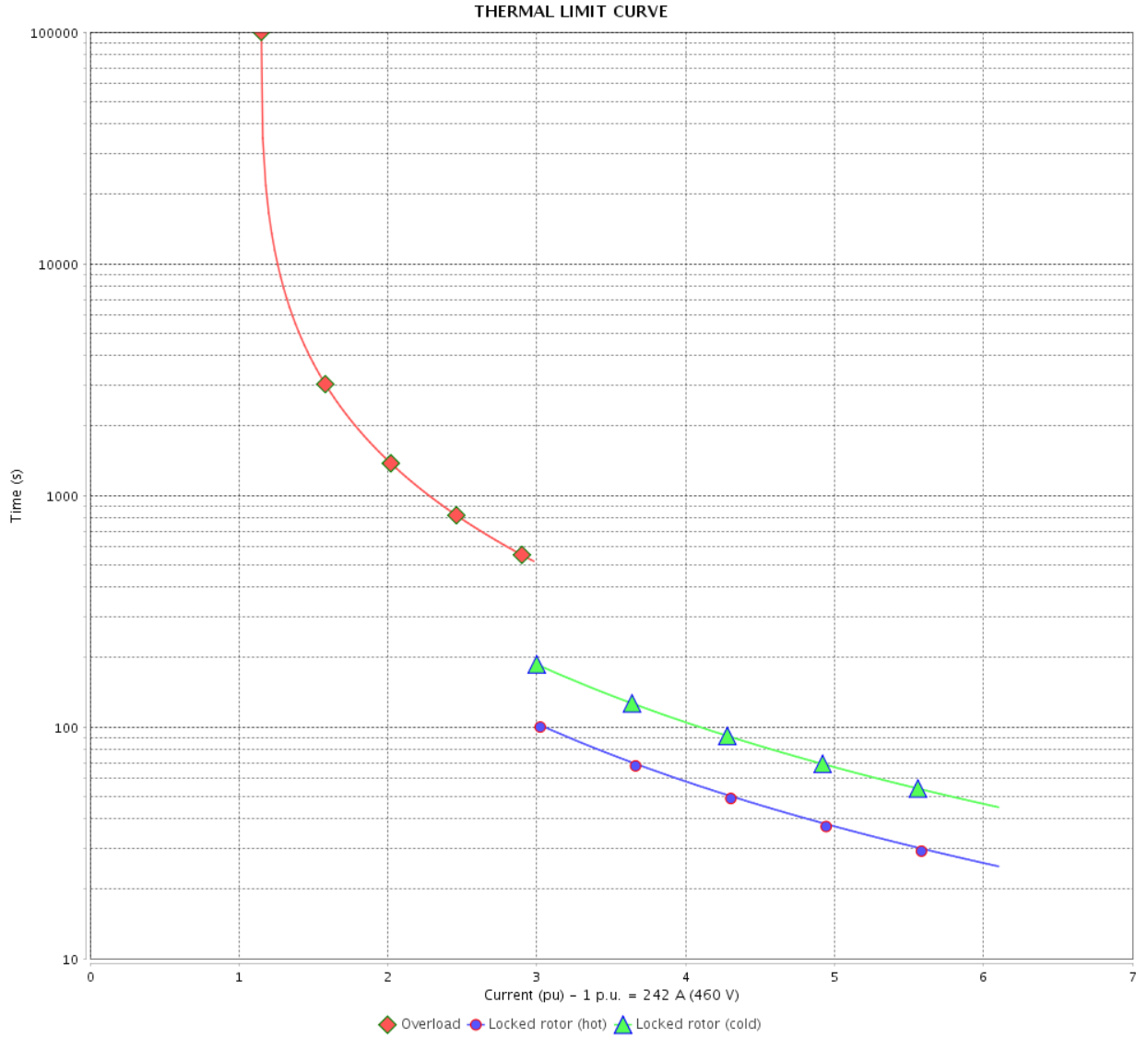

Rev.	Changes Summary	Performed	Checked	Date
Performed by		Page 5 / 6		Revision
Checked by				
Date				

VFD OPERATION CURVE

Three Phase Induction Motor - Squirrel Cage



Customer :

Product line : NEMA Premium Efficiency Three-Phase

Product code : 12139519

Catalog # : 20009ST3QIERB449T-W2

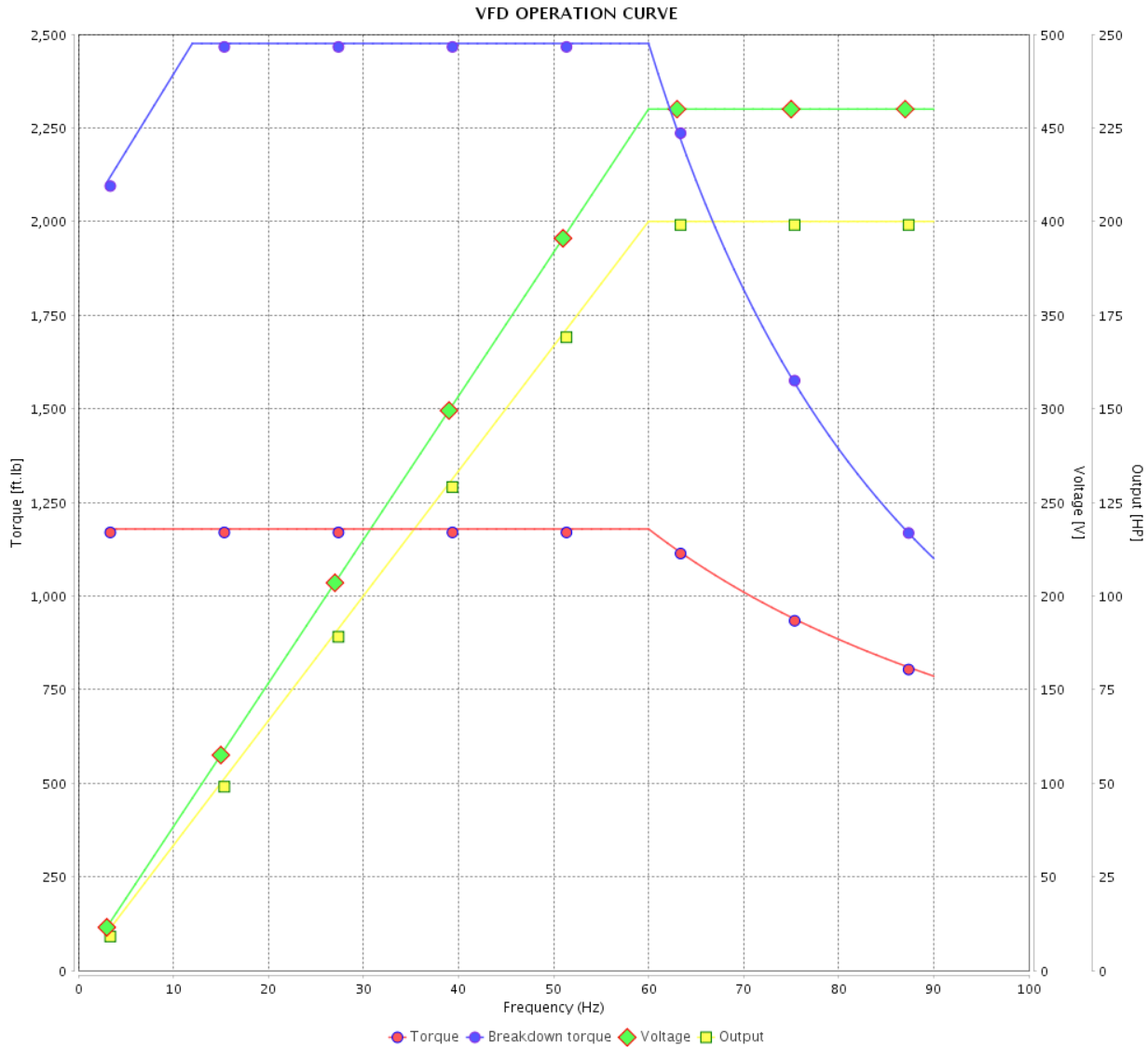

Performance : 460 V 60 Hz 8P

Rated current : 242 A
 LRC : 6.1
 Rated torque : 1180 ft.lb
 Locked rotor torque : 190 %
 Breakdown torque : 210 %
 Rated speed : 891 rpm

Moment of inertia (J) : 255 sq.ft.lb
 Duty cycle : Cont.(S1)
 Insulation class : F
 Service factor : 1.15
 Temperature rise : 80 K
 Design : B

Rev.	Changes Summary	Performed	Checked	Date
Performed by			Page	Revision
Checked by				
Date				

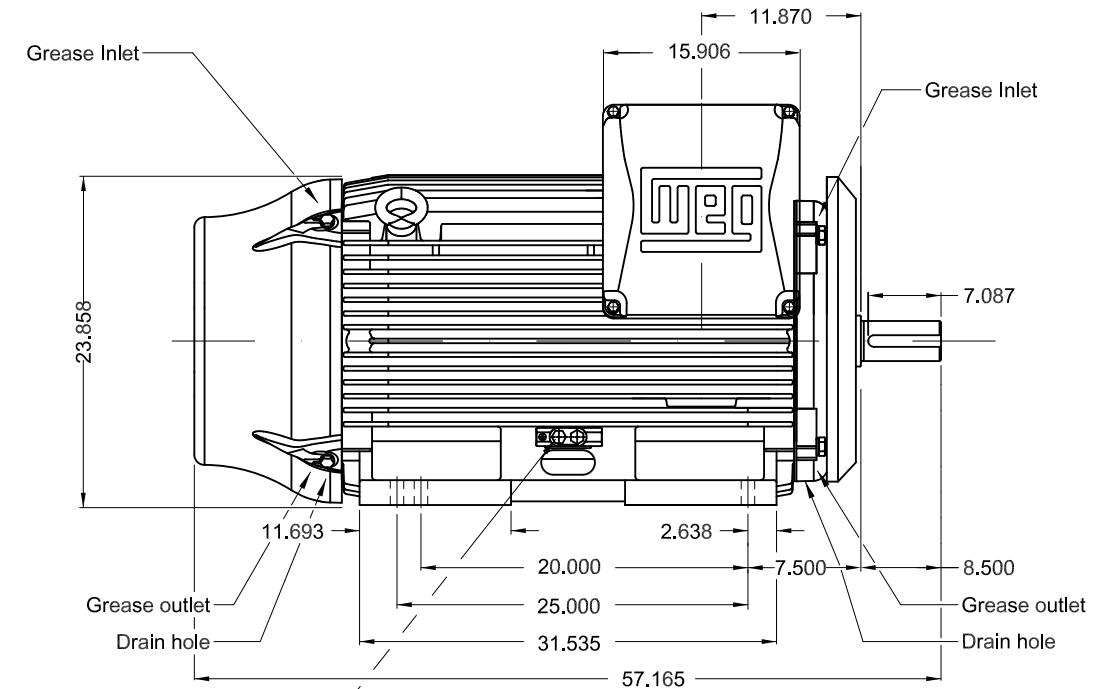
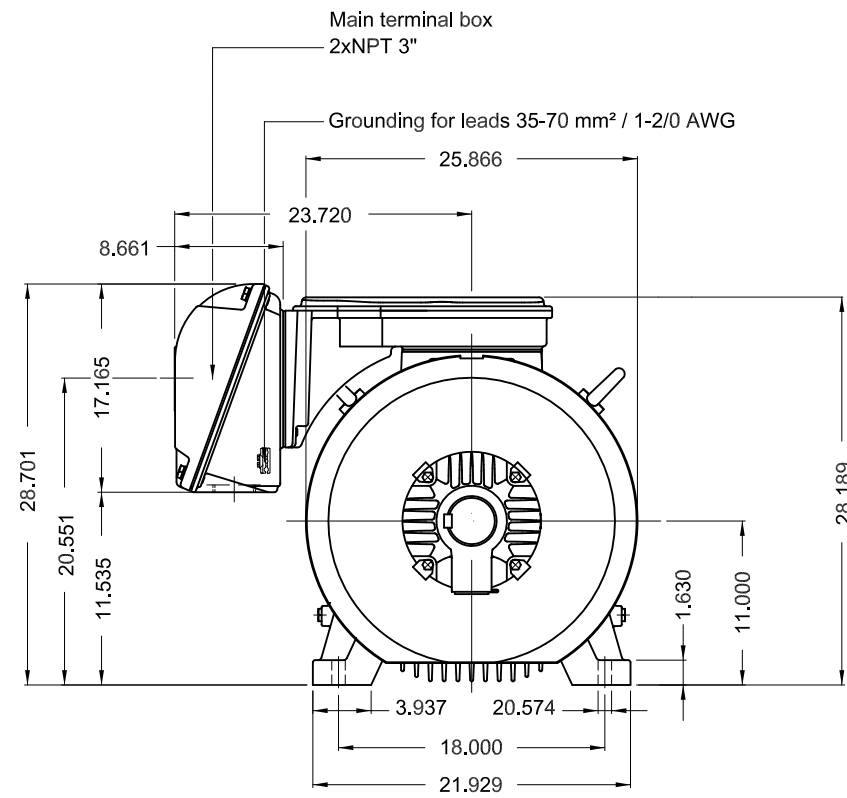

Grounding for leads 25-185 mm² / 3AWG-350MCM

200 HP 08 Poles 60 Hz

A

- DE roller bearing
- Shaft locking device
- NDE endshield with electrically insulated bearing hub
- Drive-End Air Deflector
- Color RAL 5009
- Painting plan 202E
- Mounting B3R(D)

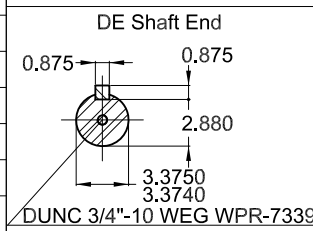

ECM	LOC	SUMMARY OF MODIFICATIONS				EXECUTED	CHECKED	RELEASED	DATE	VER
EXECUTED	PIRWBUSER		THREE PH. MOTOR IEEE 841 W22 PREM. EFF.				PREVIEW WDD		SHEET 1 / 1	XME A3
CHECKED			FRAME L447/9T IP55 TEFC							
RELEASED										
REL DT.			WMO	Jaragua do Sul	Product Engineering					