

# DATA SHEET



## Three Phase Induction Motor - Squirrel Cage

Customer :																			
Product line : NEMA Premium Efficiency Three-Phase	Product code : 13890650																		
	Catalog # : 35018ST3HIE449T-W22																		
Frame : L447/9T	Locked rotor time : 81s (cold) 45s (hot)																		
Output : 350 HP (260 kW)	Temperature rise : 80 K																		
Poles : 4	Duty cycle : Cont.(S1)																		
Frequency : 60 Hz	Ambient temperature : -20°C to +40°C																		
Rated voltage : 575 V	Altitude : 1000 m.a.s.l.																		
Rated current : 315 A	Protection degree : IP55																		
L. R. Amperes : 2175 A	Cooling method : IC411 - TEFC																		
LRC : 6.9x(Code G)	Mounting : F-1																		
No load current : 92.0 A	Rotation <sup>1</sup> : Both (CW and CCW)																		
Rated speed : 1787 rpm	Noise level <sup>2</sup> : 77.0 dB(A)																		
Slip : 0.72 %	Starting method : Direct On Line																		
Rated torque : 1030 ft.lb	Approx. weight <sup>3</sup> : 3192 lb																		
Locked rotor torque : 260 %																			
Breakdown torque : 229 %																			
Insulation class : F																			
Service factor : 1.15																			
Moment of inertia (J) : 131 sq.ft.lb																			
Design : B																			
Output 25% 50% 75% 100%	Foundation loads																		
Efficiency (%) 95.7 95.8 96.2 96.2	Max. traction : 4710 lb																		
Power Factor 0.52 0.76 0.83 0.86	Max. compression : 7903 lb																		
	<table border="1"><thead><tr><th></th><th>Drive end</th><th>Non drive end</th></tr></thead><tbody><tr><td>Bearing type :</td><td>6322 C3</td><td>6319 C3</td></tr><tr><td>Sealing :</td><td>Inpro/Seal</td><td>Inpro/Seal</td></tr><tr><td>Lubrication interval :</td><td>6000 h</td><td>8000 h</td></tr><tr><td>Lubricant amount :</td><td>60 g</td><td>45 g</td></tr><tr><td>Lubricant type :</td><td colspan="2">Mobil Polyrex EM</td></tr></tbody></table>		Drive end	Non drive end	Bearing type :	6322 C3	6319 C3	Sealing :	Inpro/Seal	Inpro/Seal	Lubrication interval :	6000 h	8000 h	Lubricant amount :	60 g	45 g	Lubricant type :	Mobil Polyrex EM	
	Drive end	Non drive end																	
Bearing type :	6322 C3	6319 C3																	
Sealing :	Inpro/Seal	Inpro/Seal																	
Lubrication interval :	6000 h	8000 h																	
Lubricant amount :	60 g	45 g																	
Lubricant type :	Mobil Polyrex EM																		
Notes																			
This revision replaces and cancel the previous one, which must be eliminated. (1) Looking the motor from the shaft end. (2) Measured at 1m and with tolerance of +3dB(A). (3) Approximate weight subject to changes after manufacturing process. (4) At 100% of full load.	These are average values based on tests with sinusoidal power supply, subject to the tolerances stipulated in NEMA MG-1.																		
Rev.	Changes Summary	Performed	Checked	Date															
Performed by																			
Checked by			Page	Revision															
Date	13/04/2022		1 / 6																

# TORQUE AND CURRENT VS SPEED CURVE

Three Phase Induction Motor - Squirrel Cage



Customer :

Product line : NEMA Premium Efficiency Three-Phase

Product code : 13890650

Catalog # : 35018ST3HIE449T-W22

TORQUE AND CURRENT VS SPEED CURVE

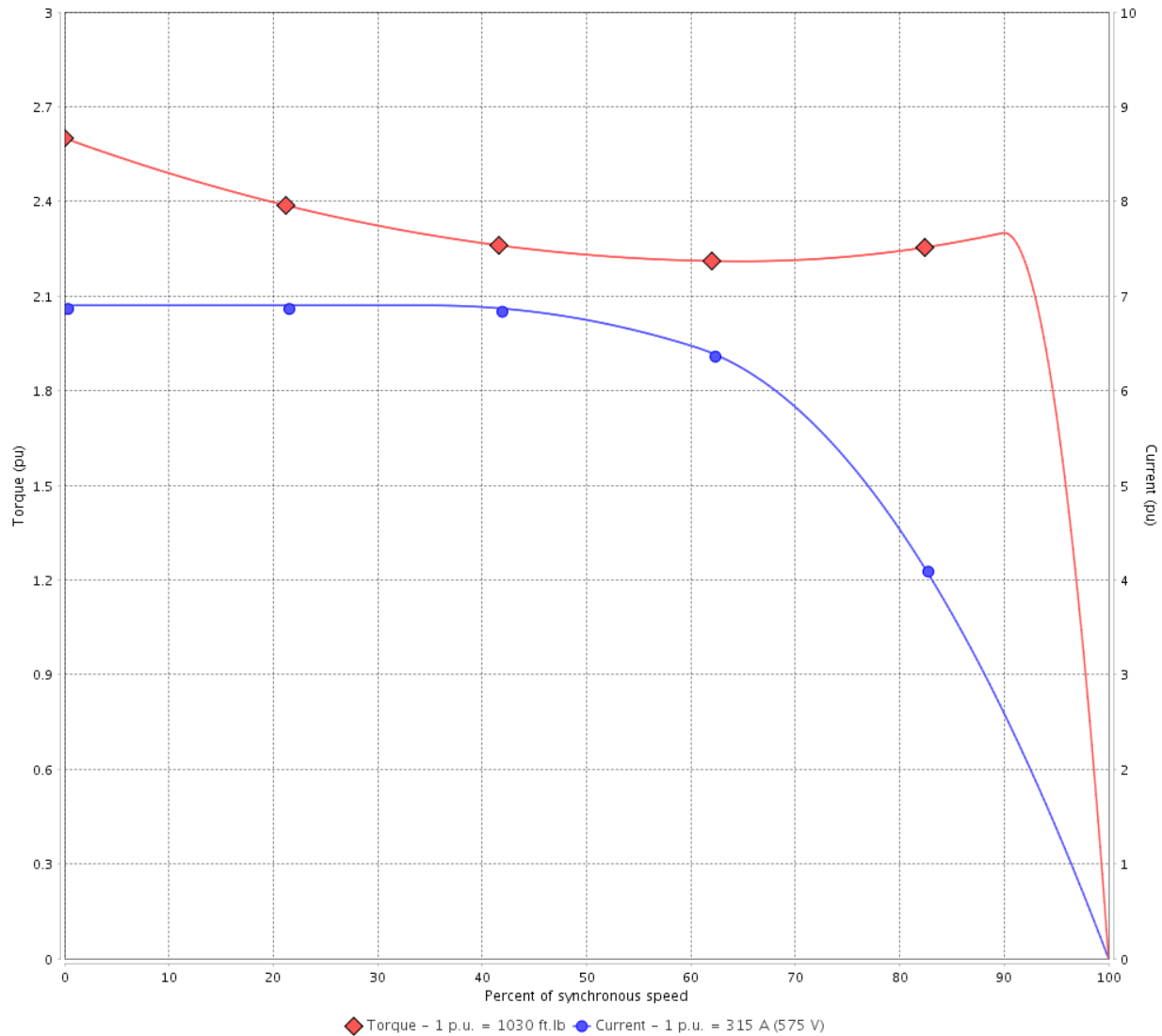

Performance : 575 V 60 Hz 4P

Rated current	: 315 A	Moment of inertia (J)	: 131 sq.ft.lb
LRC	: 6.9	Duty cycle	: Cont.(S1)
Rated torque	: 1030 ft.lb	Insulation class	: F
Locked rotor torque	: 260 %	Service factor	: 1.15
Breakdown torque	: 229 %	Temperature rise	: 80 K
Rated speed	: 1787 rpm	Design	: B

Locked rotor time : 81s (cold) 45s (hot)

Rev.	Changes Summary	Performed	Checked	Date
Performed by			Page 2 / 6	Revision
Checked by				
Date	13/04/2022			

# LOAD PERFORMANCE CURVE

## Three Phase Induction Motor - Squirrel Cage



Customer :

Product line : NEMA Premium Efficiency Three-Phase

Product code : 13890650

Catalog # : 35018ST3HIE449T-W22

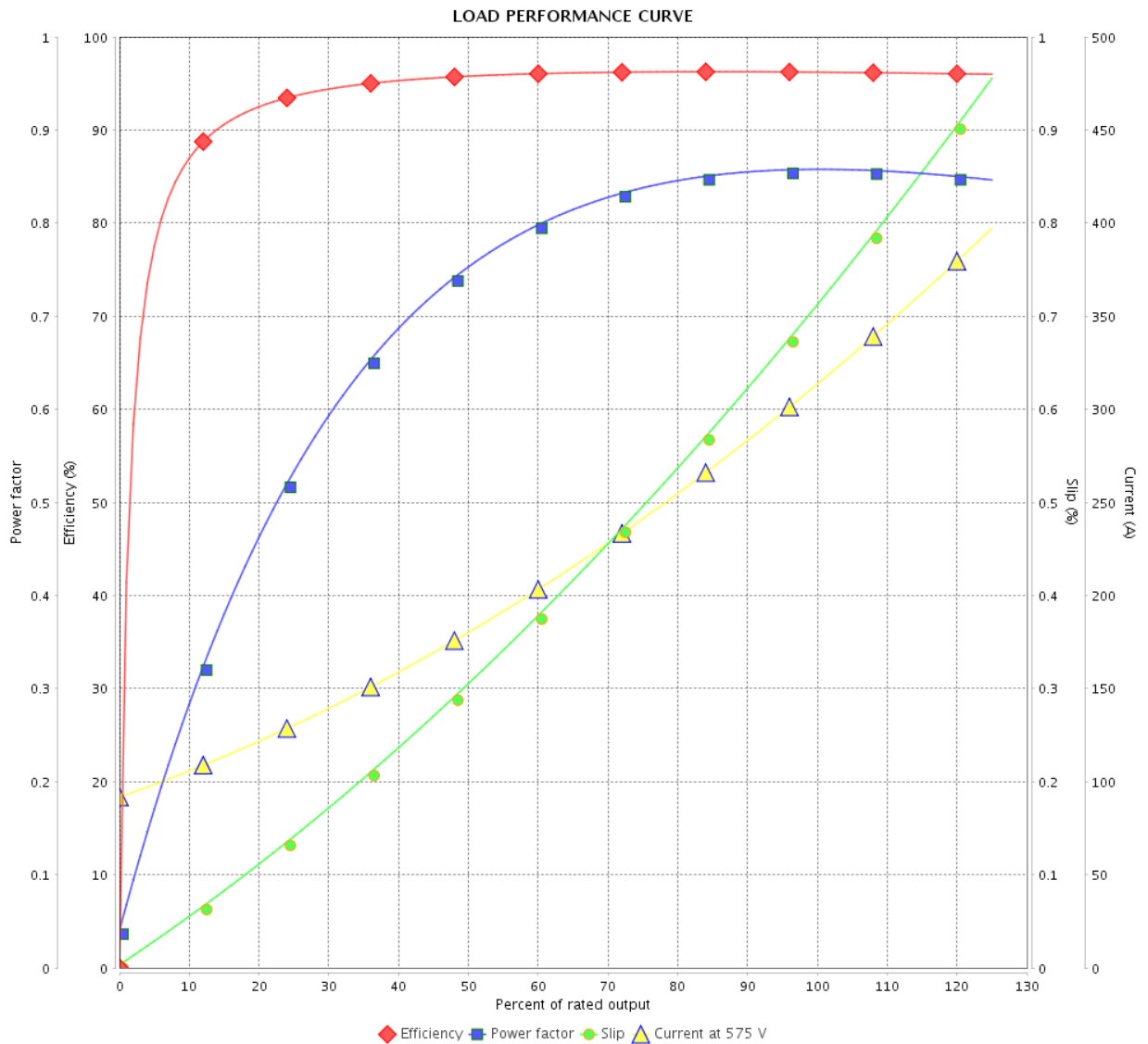

Performance : 575 V 60 Hz 4P

Rated current : 315 A  
 LRC : 6.9  
 Rated torque : 1030 ft.lb  
 Locked rotor torque : 260 %  
 Breakdown torque : 229 %  
 Rated speed : 1787 rpm

Moment of inertia (J) : 131 sq.ft.lb  
 Duty cycle : Cont.(S1)  
 Insulation class : F  
 Service factor : 1.15  
 Temperature rise : 80 K  
 Design : B

Rev.	Changes Summary	Performed	Checked	Date
Performed by		Page		Revision
Checked by		3 / 6		
Date		13/04/2022		

# THERMAL LIMIT CURVE

## Three Phase Induction Motor - Squirrel Cage



Customer :

Product line : NEMA Premium Efficiency Three-Phase  
Product code : 13890650  
Catalog # : 35018ST3HIE449T-W22

Performance : 575 V 60 Hz 4P

Rated current	: 315 A	Moment of inertia (J)	: 131 sq.ft.lb
LRC	: 6.9	Duty cycle	: Cont.(S1)
Rated torque	: 1030 ft.lb	Insulation class	: F
Locked rotor torque	: 260 %	Service factor	: 1.15
Breakdown torque	: 229 %	Temperature rise	: 80 K
Rated speed	: 1787 rpm	Design	: B

Heating constant

Cooling constant

Rev.	Changes Summary	Performed	Checked	Date
Performed by				
Checked by			Page	Revision
Date	13/04/2022		4 / 6	

# THERMAL LIMIT CURVE

Three Phase Induction Motor - Squirrel Cage



Customer : \_\_\_\_\_

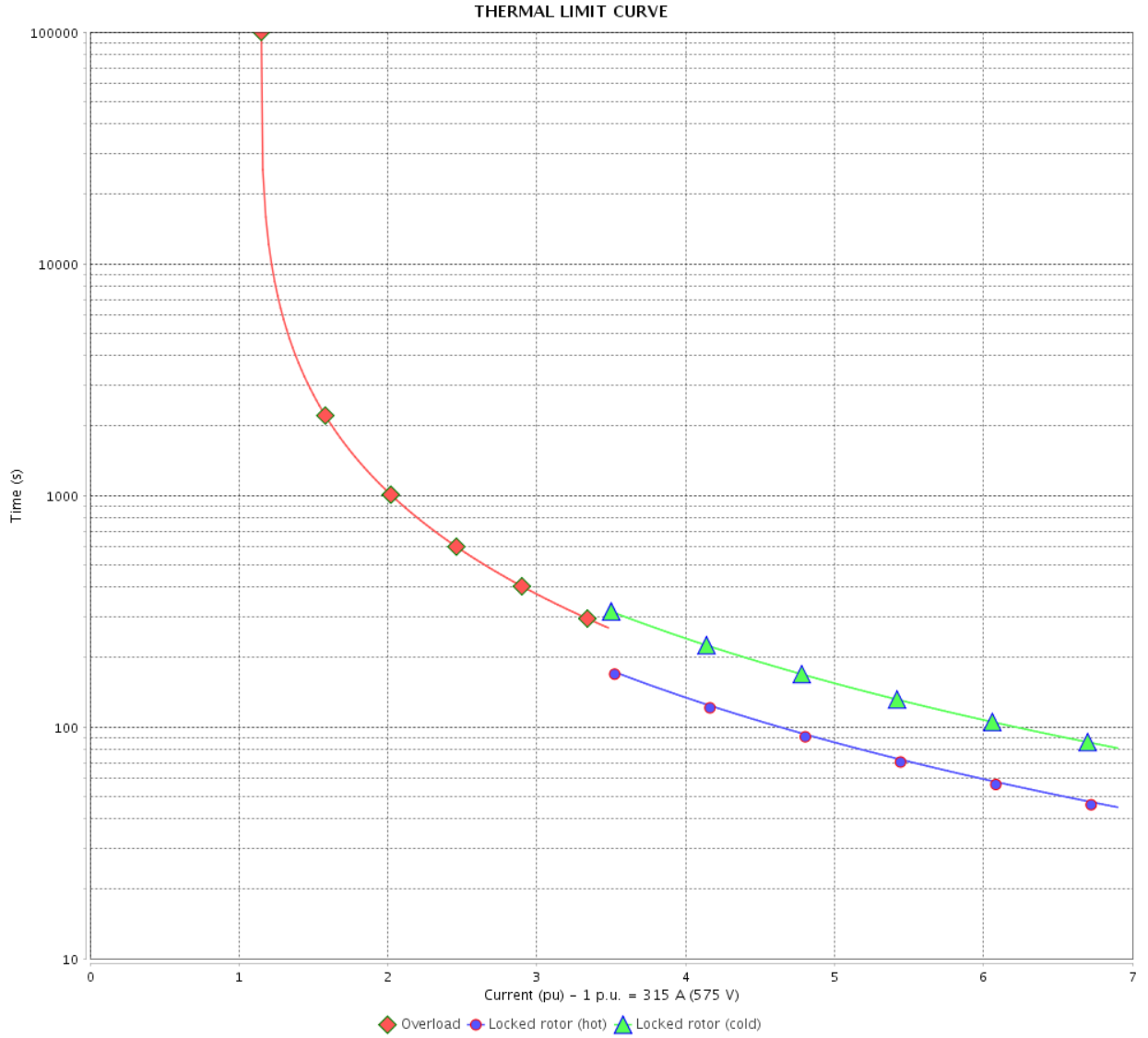

Rev.	Changes Summary	Performed	Checked	Date
Performed by		Page 5 / 6		Revision
Checked by				
Date				

# VFD OPERATION CURVE

Three Phase Induction Motor - Squirrel Cage



Customer :

Product line : NEMA Premium Efficiency Three-Phase

Product code : 13890650

Catalog # : 35018ST3HIE449T-W22

VFD OPERATION CURVE

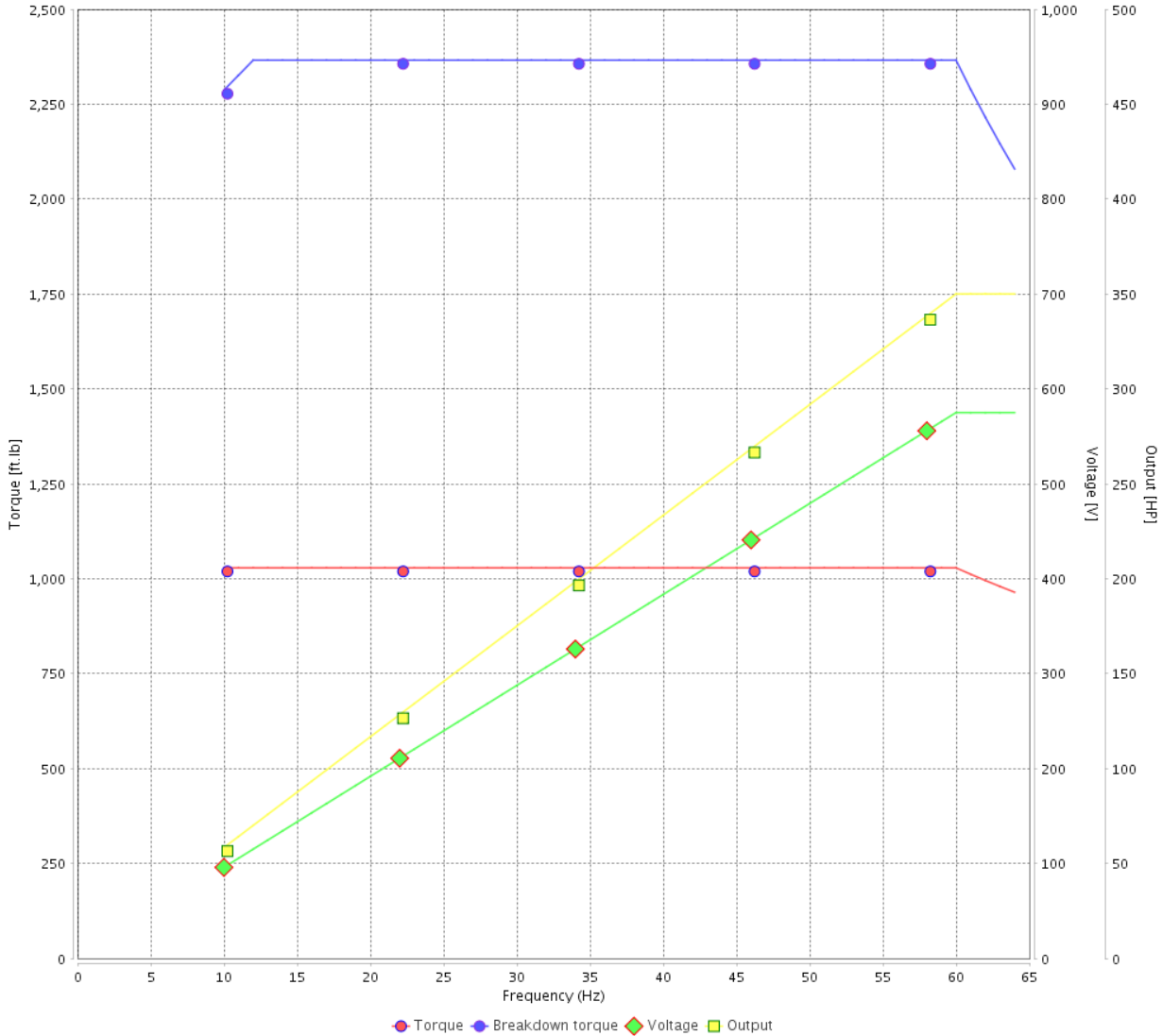

Performance : 575 V 60 Hz 4P

Rated current	: 315 A	Moment of inertia (J)	: 131 sq.ft.lb
LRC	: 6.9	Duty cycle	: Cont.(S1)
Rated torque	: 1030 ft.lb	Insulation class	: F
Locked rotor torque	: 260 %	Service factor	: 1.15
Breakdown torque	: 229 %	Temperature rise	: 80 K
Rated speed	: 1787 rpm	Design	: B

Rev.	Changes Summary	Performed	Checked	Date
Performed by			Page 6 / 6	Revision
Checked by				
Date	13/04/2022			

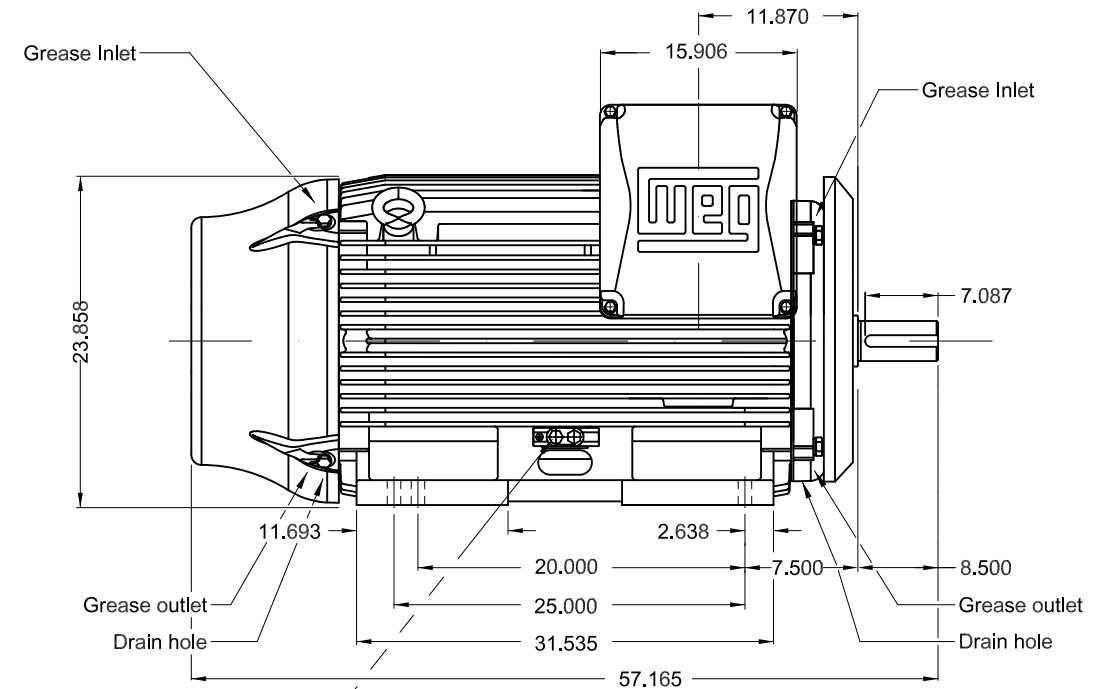
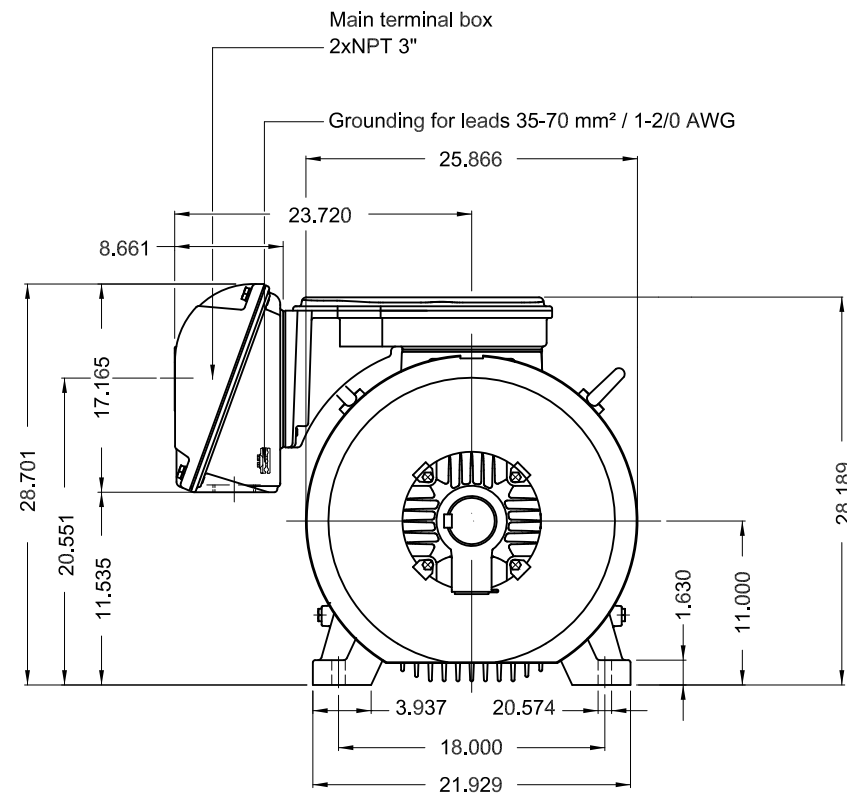

Grounding for leads 25-185 mm<sup>2</sup> / 3AWG-350MCM

350 HP 04 Poles 60 Hz

Dimensions in inches

- NDE endshield with electrically insulated bearing hub
- Drive-End Air Deflector
- Color RAL 5009
- Painting plan 202E
- Mounting NEMA F-1
- Mounting B3R(D)

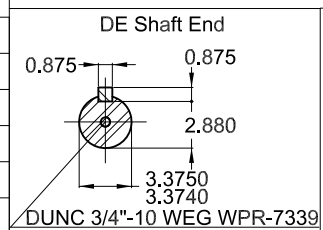

ECM	LOC	SUMMARY OF MODIFICATIONS	EXECUTED	CHECKED	RELEASED	DATE	VER
EXECUTED	PIRWBUSER	THREE PH. MOTOR IEEE 841 W22 PREM. EFF. FRAME L447/9T IP55 TEFC					
CHECKED							
RELEASED							
REL DT.	WMO		Jaragua do Sul	Product Engineering	SHEET	1 / 1	

**PREVIEW**  
WDD

