

DATA SHEET



Three Phase Induction Motor - Squirrel Cage

Customer :																			
Product line	: NEMA Premium Efficiency Three-Phase																		
Product code :	11623898																		
Catalog # :	40018ET3H449T-W22																		
Frame : L447/9T Output : 400 HP (300 kW) Poles : 4 Frequency : 60 Hz Rated voltage : 575 V Rated current : 356 A L. R. Amperes : 2314 A LRC : 6.5x(Code G) No load current : 100 A Rated speed : 1785 rpm Slip : 0.83 % Rated torque : 1180 ft.lb Locked rotor torque : 250 % Breakdown torque : 260 % Insulation class : F Service factor : 1.15 Moment of inertia (J) : 136 sq.ft.lb Design : B	Locked rotor time : 37s (cold) 21s (hot) Temperature rise : 80 K Duty cycle : Cont.(S1) Ambient temperature : -20°C to +40°C Altitude : 1000 m.a.s.l. Protection degree : IP55 Cooling method : IC411 - TEFC Mounting : F-1 Rotation ¹ : Both (CW and CCW) Noise level ² : 79.0 dB(A) Starting method : Direct On Line Approx. weight ³ : 3217 lb																		
Output	25% 50% 75% 100%																		
Efficiency (%)	94.9 95.4 95.8 96.2																		
Power Factor	0.55 0.80 0.85 0.88																		
Foundation loads																			
Max. traction	: 6548 lb																		
Max. compression	: 9765 lb																		
	<table border="0"> <tr> <td></td> <td style="text-align: center;"><u>Drive end</u></td> <td style="text-align: center;"><u>Non drive end</u></td> </tr> <tr> <td>Bearing type</td> <td>: 6322 C3</td> <td>6319 C3</td> </tr> <tr> <td>Sealing</td> <td>: WSeal</td> <td>WSeal</td> </tr> <tr> <td>Lubrication interval</td> <td>: 6000 h</td> <td>8000 h</td> </tr> <tr> <td>Lubricant amount</td> <td>: 60 g</td> <td>45 g</td> </tr> <tr> <td>Lubricant type</td> <td colspan="2">: Mobil Polyrex EM</td> </tr> </table>		<u>Drive end</u>	<u>Non drive end</u>	Bearing type	: 6322 C3	6319 C3	Sealing	: WSeal	WSeal	Lubrication interval	: 6000 h	8000 h	Lubricant amount	: 60 g	45 g	Lubricant type	: Mobil Polyrex EM	
	<u>Drive end</u>	<u>Non drive end</u>																	
Bearing type	: 6322 C3	6319 C3																	
Sealing	: WSeal	WSeal																	
Lubrication interval	: 6000 h	8000 h																	
Lubricant amount	: 60 g	45 g																	
Lubricant type	: Mobil Polyrex EM																		
Notes																			
This revision replaces and cancel the previous one, which must be eliminated. (1) Looking the motor from the shaft end. (2) Measured at 1m and with tolerance of +3dB(A). (3) Approximate weight subject to changes after manufacturing process. (4) At 100% of full load.																			
These are average values based on tests with sinusoidal power supply, subject to the tolerances stipulated in NEMA MG-1.																			
Rev.	Changes Summary	Performed	Checked	Date															
Performed by																			
Checked by			Page	Revision															
Date	13/04/2022		1 / 6																

TORQUE AND CURRENT VS SPEED CURVE

Three Phase Induction Motor - Squirrel Cage



Customer :

Product line : NEMA Premium Efficiency Three-Phase

Product code : 11623898

Catalog # : 40018ET3H449T-W22

TORQUE AND CURRENT VS SPEED CURVE

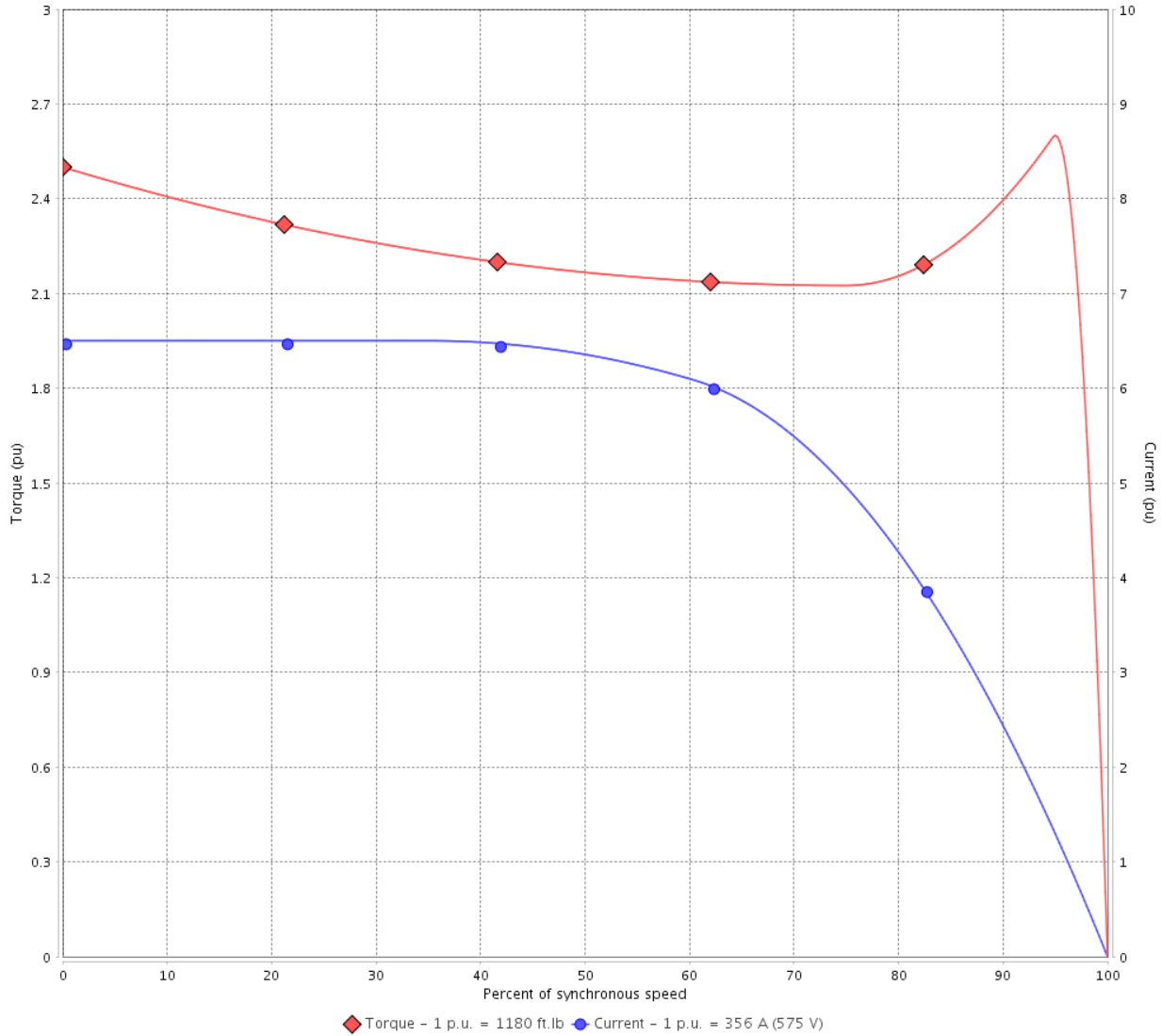

Performance : 575 V 60 Hz 4P

Rated current	: 356 A	Moment of inertia (J)	: 136 sq.ft.lb
LRC	: 6.5	Duty cycle	: Cont.(S1)
Rated torque	: 1180 ft.lb	Insulation class	: F
Locked rotor torque	: 250 %	Service factor	: 1.15
Breakdown torque	: 260 %	Temperature rise	: 80 K
Rated speed	: 1785 rpm	Design	: B

Locked rotor time : 37s (cold) 21s (hot)

Rev.	Changes Summary	Performed	Checked	Date
Performed by			Page 2 / 6	Revision
Checked by				
Date	13/04/2022			

LOAD PERFORMANCE CURVE

Three Phase Induction Motor - Squirrel Cage



Customer : _____

Product line : NEMA Premium Efficiency Three-Phase

Product code : 11623898

Catalog # : 40018ET3H449T-W22

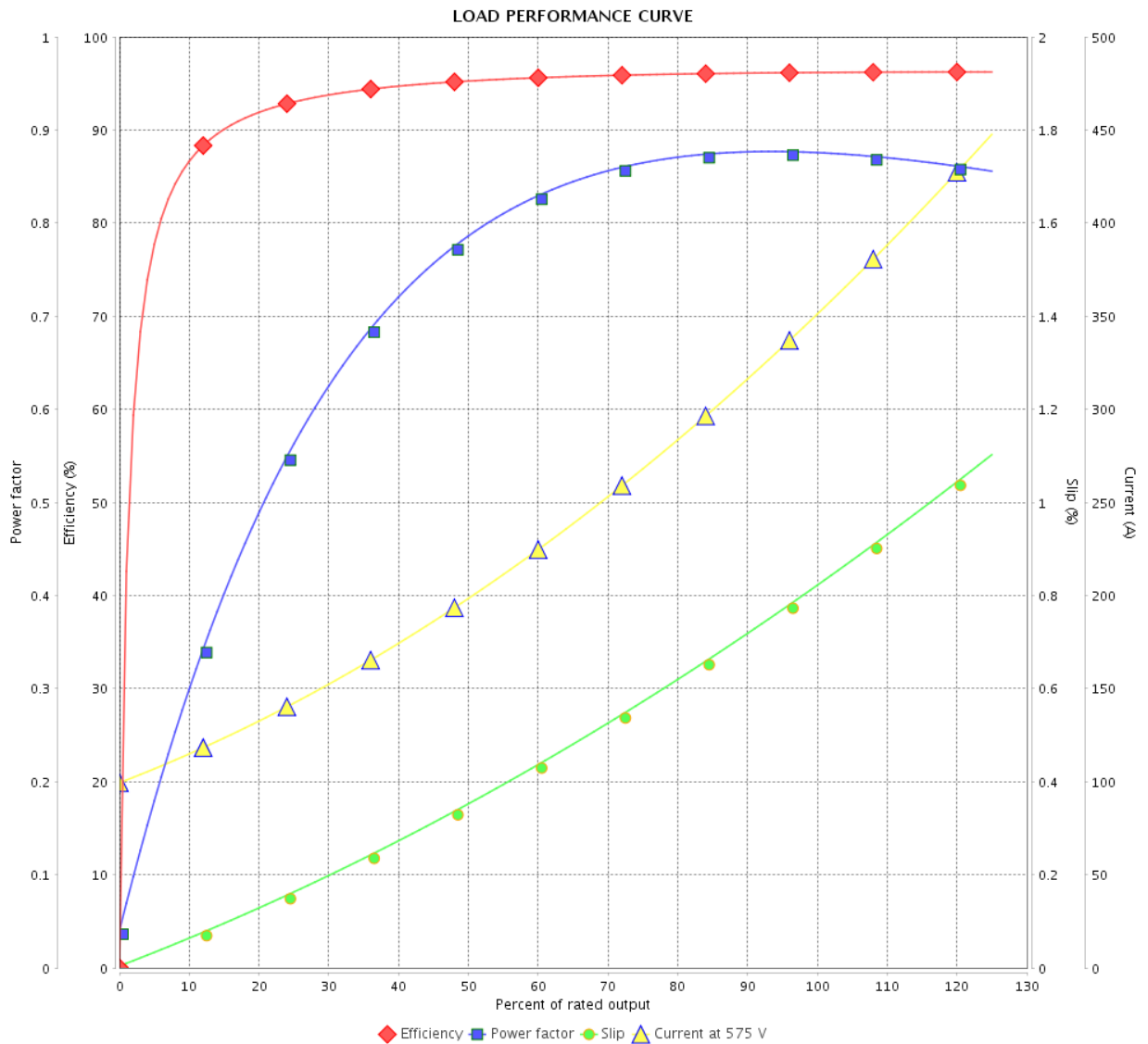

Performance : 575 V 60 Hz 4P

Rated current : 356 A
 LRC : 6.5
 Rated torque : 1180 ft.lb
 Locked rotor torque : 250 %
 Breakdown torque : 260 %
 Rated speed : 1785 rpm

Moment of inertia (J) : 136 sq.ft.lb
 Duty cycle : Cont.(S1)
 Insulation class : F
 Service factor : 1.15
 Temperature rise : 80 K
 Design : B

Rev.	Changes Summary	Performed	Checked	Date
Performed by			Page	Revision
Checked by				
Date				
			3 / 6	

THERMAL LIMIT CURVE

Three Phase Induction Motor - Squirrel Cage



Customer :

Product line : NEMA Premium Efficiency Three-Phase
Product code : 11623898
Catalog # : 40018ET3H449T-W22

Performance : 575 V 60 Hz 4P

Rated current	: 356 A	Moment of inertia (J)	: 136 sq.ft.lb
LRC	: 6.5	Duty cycle	: Cont.(S1)
Rated torque	: 1180 ft.lb	Insulation class	: F
Locked rotor torque	: 250 %	Service factor	: 1.15
Breakdown torque	: 260 %	Temperature rise	: 80 K
Rated speed	: 1785 rpm	Design	: B

Heating constant

Cooling constant

Rev.	Changes Summary	Performed	Checked	Date
Performed by				
Checked by			Page	Revision
Date	13/04/2022		4 / 6	

THERMAL LIMIT CURVE

Three Phase Induction Motor - Squirrel Cage



Customer : _____

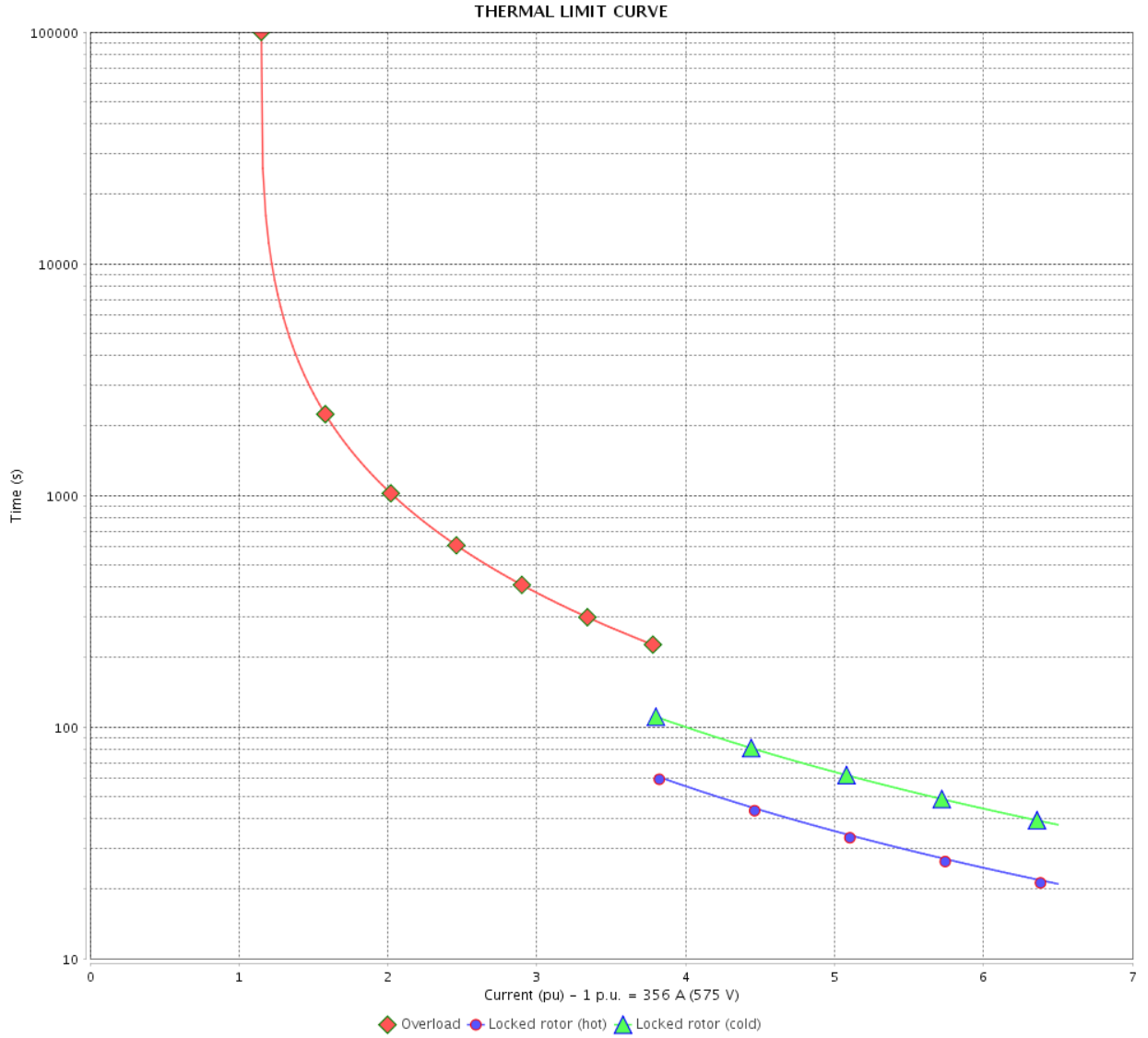

Rev.	Changes Summary	Performed	Checked	Date
Performed by		Page		Revision
Checked by				
Date				

VFD OPERATION CURVE

Three Phase Induction Motor - Squirrel Cage



Customer :

Product line : NEMA Premium Efficiency Three-Phase

Product code : 11623898

Catalog # : 40018ET3H449T-W22

VFD OPERATION CURVE

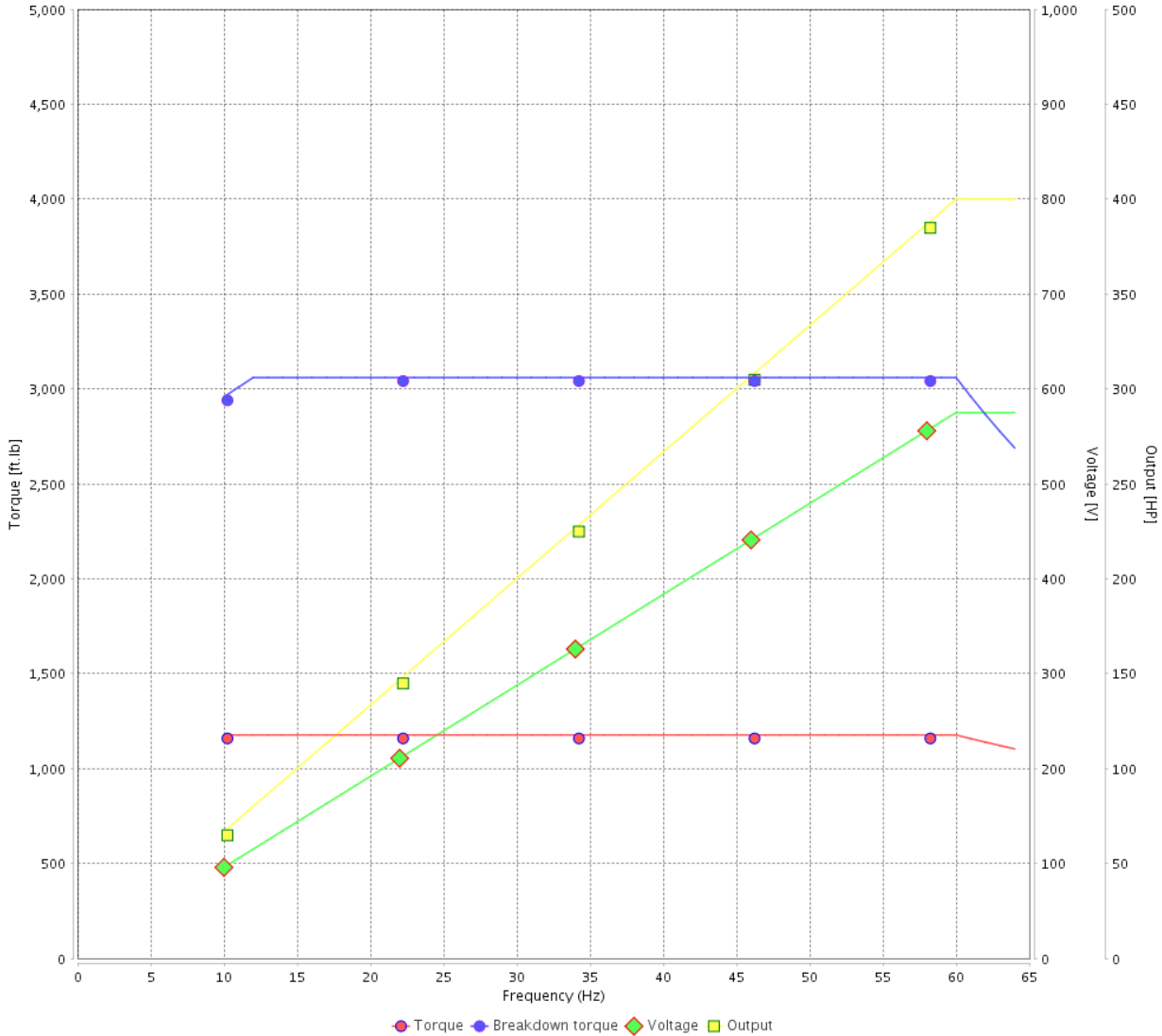

Performance : 575 V 60 Hz 4P

Rated current	: 356 A	Moment of inertia (J)	: 136 sq.ft.lb
LRC	: 6.5	Duty cycle	: Cont.(S1)
Rated torque	: 1180 ft.lb	Insulation class	: F
Locked rotor torque	: 250 %	Service factor	: 1.15
Breakdown torque	: 260 %	Temperature rise	: 80 K
Rated speed	: 1785 rpm	Design	: B

Rev.	Changes Summary	Performed	Checked	Date
Performed by			Page 6 / 6	Revision
Checked by				
Date	13/04/2022			

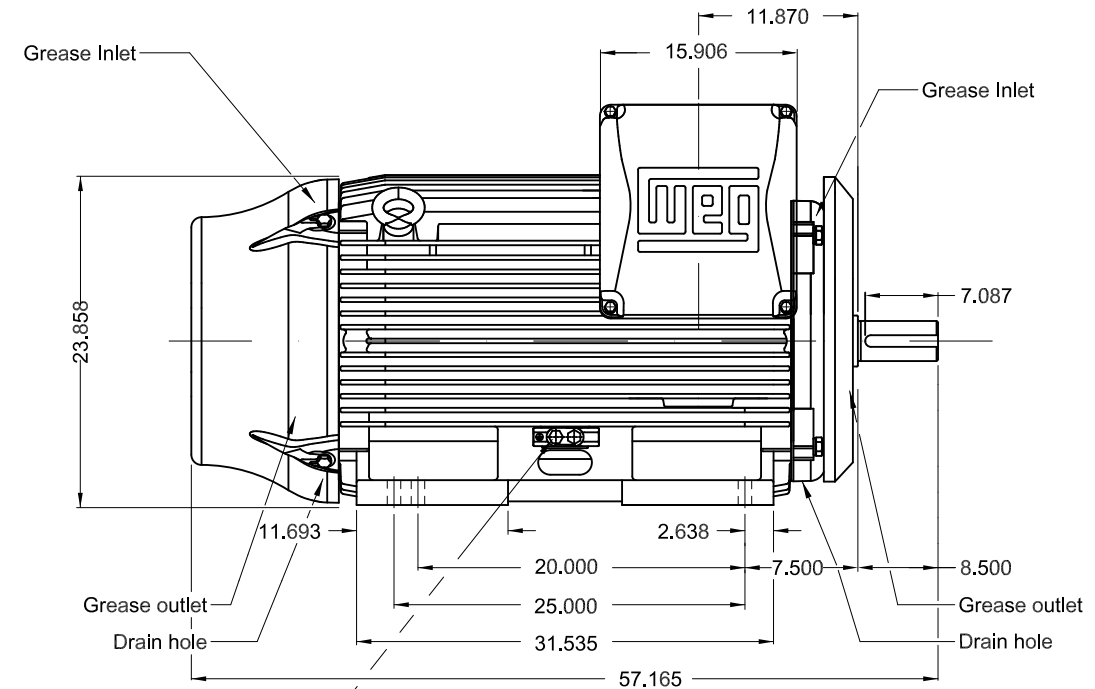
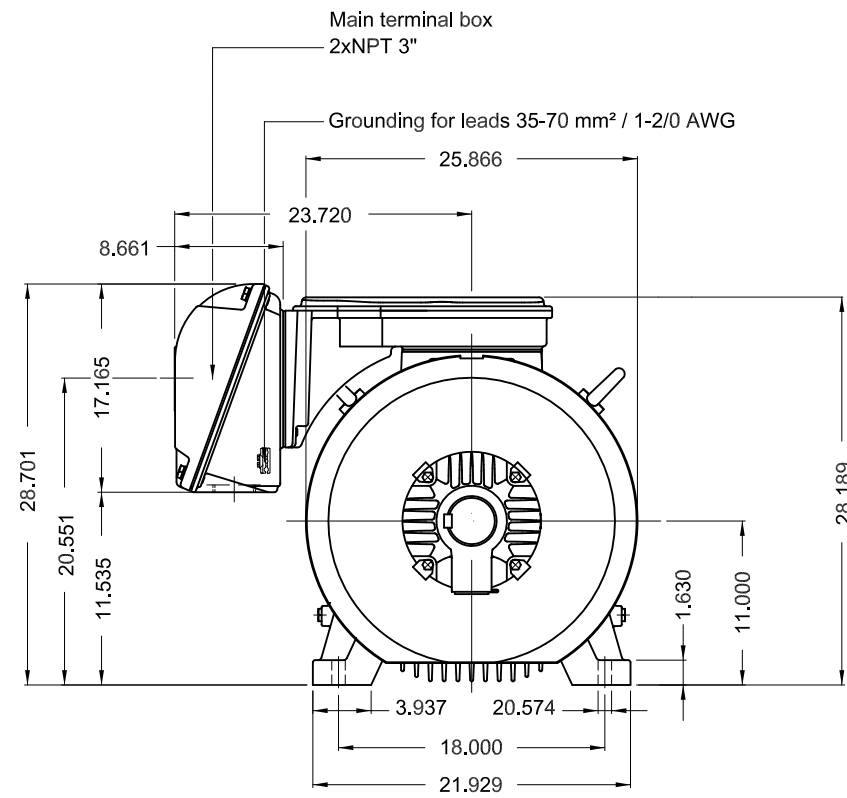

Grounding for leads 25-185 mm² / 3AWG-350MCM

400 HP 04 Poles 60 Hz

Dimensions in inches

- NDE endshield with electrically insulated bearing hub
- Drive-End Air Deflector
- Color RAL 5009
- Painting plan 203A
- Mounting B3R(D)

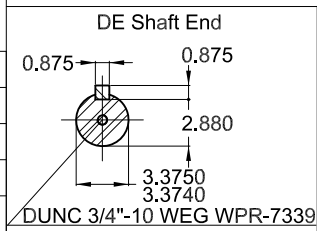

ECM	LOC	SUMMARY OF MODIFICATIONS	EXECUTED	CHECKED	RELEASED	DATE	VER
EXECUTED	PIRWBUSER	THREE PH. MOTOR W22 PREM. EFF.					
CHECKED		FRAME L447/9T IP55 TEFC					
RELEASED							
REL DT.	WMO	Jaragua do Sul	Product Engineering	SHEET	1 / 1		

PREVIEW
WDD





NEMA
Premium
W22



FOR SAFE AREA
Mod.TE1BFOXON
CC029A



Class I, Div 2, Gr A, B, C and D - T3
Class I, Zone 2, IIC - T3
Class II, Div 2, Gr F and G - T3C
For use on PWM: Gr. A, B, C, D and F,
VT 1000:1, CT 6:1, 1.00SF - T3

MODEL 40018ET3H449T-W22

Inverter Duty Motor
Severe Duty

PH3 60Hz Fr. L447/9T 1000m.a.s.l. IP55 TEFC 3217lb

V 575

A 356

HP 400

kW 300

SF 1.15

SFA 409

RPM 1785

PF 0.88

AMB 40°C

INS cl. F DT80K

NEMA NOM EFF 96.2%

DUTY CONT.

DES B Code G

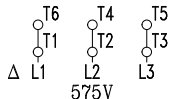

→ 6322-C3 (60g)

→ 6319-C3 (45g)



MOBIL POLYREX EM (6000h)

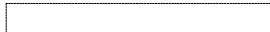

MADE IN BRAZIL
11623898