

DATA SHEET



Three Phase Induction Motor - Squirrel Cage

Customer :				
Product line	: NEMA Premium Efficiency Three-Phase			
Product code :	11679237			
Catalog # :	60018ET3G586/7-W22			
Frame : 586/7T Output : 600 HP (440 kW) Poles : 4 Frequency : 60 Hz Rated voltage : 460 V Rated current : 665 A L. R. Amperes : 4722 A LRC : 7.1x(Code G) No load current : 210 A Rated speed : 1790 rpm Slip : 0.56 % Rated torque : 1760 ft.lb Locked rotor torque : 229 % Breakdown torque : 250 % Insulation class : F Service factor : 1.15 Moment of inertia (J) : 235 sq.ft.lb	Locked rotor time : 28s (cold) 16s (hot) Temperature rise : 80 K Duty cycle : Cont.(S1) Ambient temperature : -20°C to +40°C Altitude : 1000 m.a.s.l. Protection degree : IP55 Cooling method : IC411 - TEFC Mounting : F-1 Rotation ¹ : Both (CW and CCW) Noise level ² : 78.0 dB(A) Starting method : Direct On Line Approx. weight ³ : 4335 lb			
Output	25% 50% 75% 100%			
Efficiency (%)	0.000 96.2 96.4 96.5			
Power Factor	0.00 0.74 0.82 0.86			
Foundation loads				
Max. traction	: 7014 lb			
Max. compression	: 11349 lb			
Bearing type	: <u>Drive end</u> 6322 C3 <u>Non drive end</u> 6319 C3			
Sealing	: Taconite Labyrinth Taconite Labyrinth			
Lubrication interval	: 6000 h 8000 h			
Lubricant amount	: 60 g 45 g			
Lubricant type	: Mobil Polyrex EM			
Notes				
This revision replaces and cancel the previous one, which must be eliminated. (1) Looking the motor from the shaft end. (2) Measured at 1m and with tolerance of +3dB(A). (3) Approximate weight subject to changes after manufacturing process. (4) At 100% of full load.				
These are average values based on tests with sinusoidal power supply, subject to the tolerances stipulated in NEMA MG-1.				
Rev.	Changes Summary	Performed	Checked	Date
Performed by				
Checked by			Page	Revision
Date	12/04/2022		1 / 7	

DATA SHEET

Three Phase Induction Motor - Squirrel Cage



Customer : _____

Space heater information

Voltage: 200 - 240 V

Rev.	Changes Summary	Performed	Checked	Date
Performed by				
Checked by			Page	Revision
Date	12/04/2022		2 / 7	

TORQUE AND CURRENT VS SPEED CURVE



Three Phase Induction Motor - Squirrel Cage

Customer :

Product line : NEMA Premium Efficiency Three-Phase

Product code : 11679237

Catalog # : 60018ET3G586/7-W22

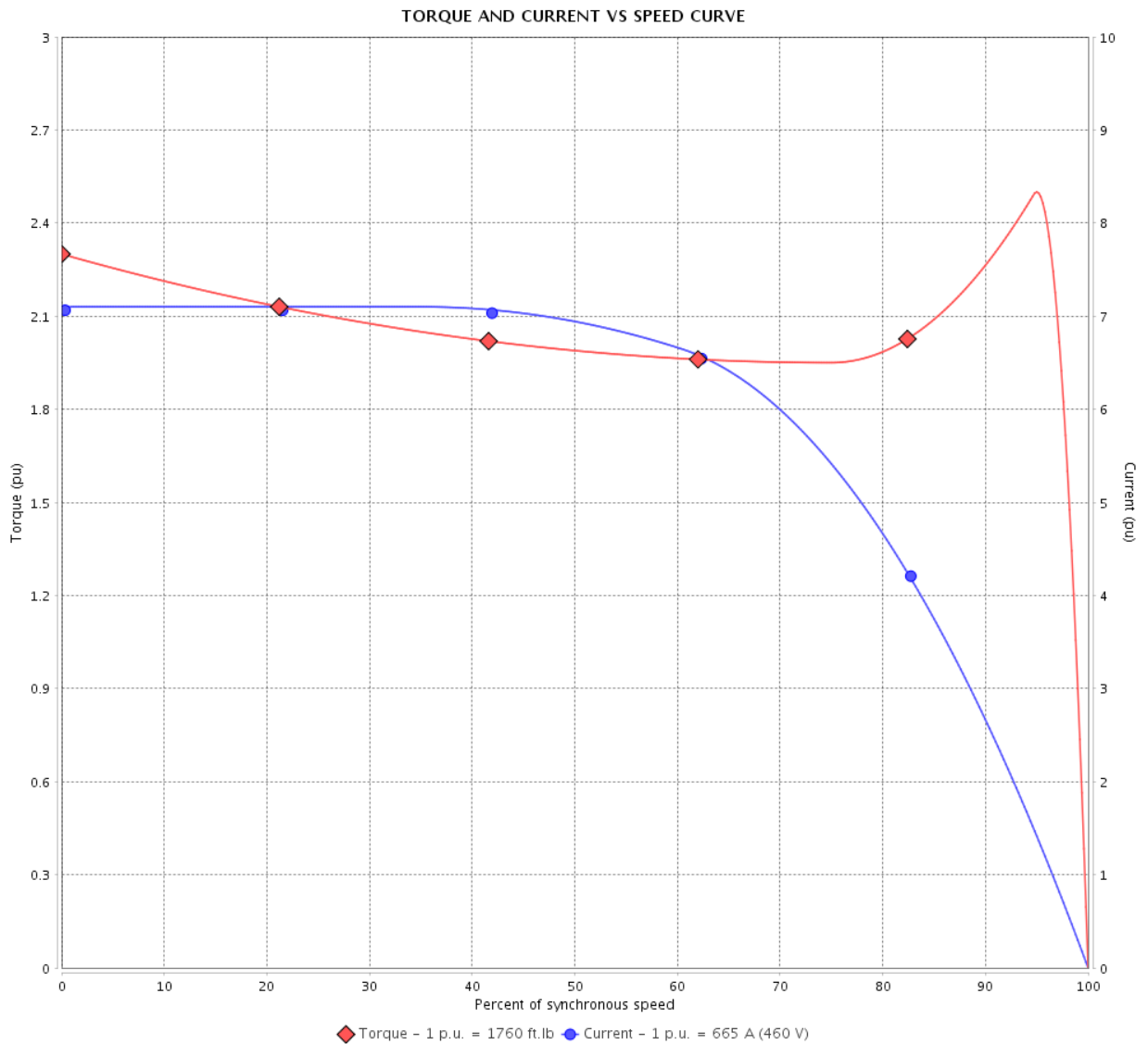

Performance : 460 V 60 Hz 4P

Rated current : 665 A
 LRC : 7.1
 Rated torque : 1760 ft.lb
 Locked rotor torque : 229 %
 Breakdown torque : 250 %
 Rated speed : 1790 rpm

Moment of inertia (J) : 235 sq.ft.lb
 Duty cycle : Cont.(S1)
 Insulation class : F
 Service factor : 1.15
 Temperature rise : 80 K

Locked rotor time : 28s (cold) 16s (hot)

Rev.	Changes Summary	Performed	Checked	Date
Performed by			Page 3 / 7	Revision
Checked by				
Date	12/04/2022			

LOAD PERFORMANCE CURVE

Three Phase Induction Motor - Squirrel Cage



Customer : _____

Product line : NEMA Premium Efficiency Three-Phase

Product code : 11679237

Catalog # : 60018ET3G586/7-W22

LOAD PERFORMANCE CURVE

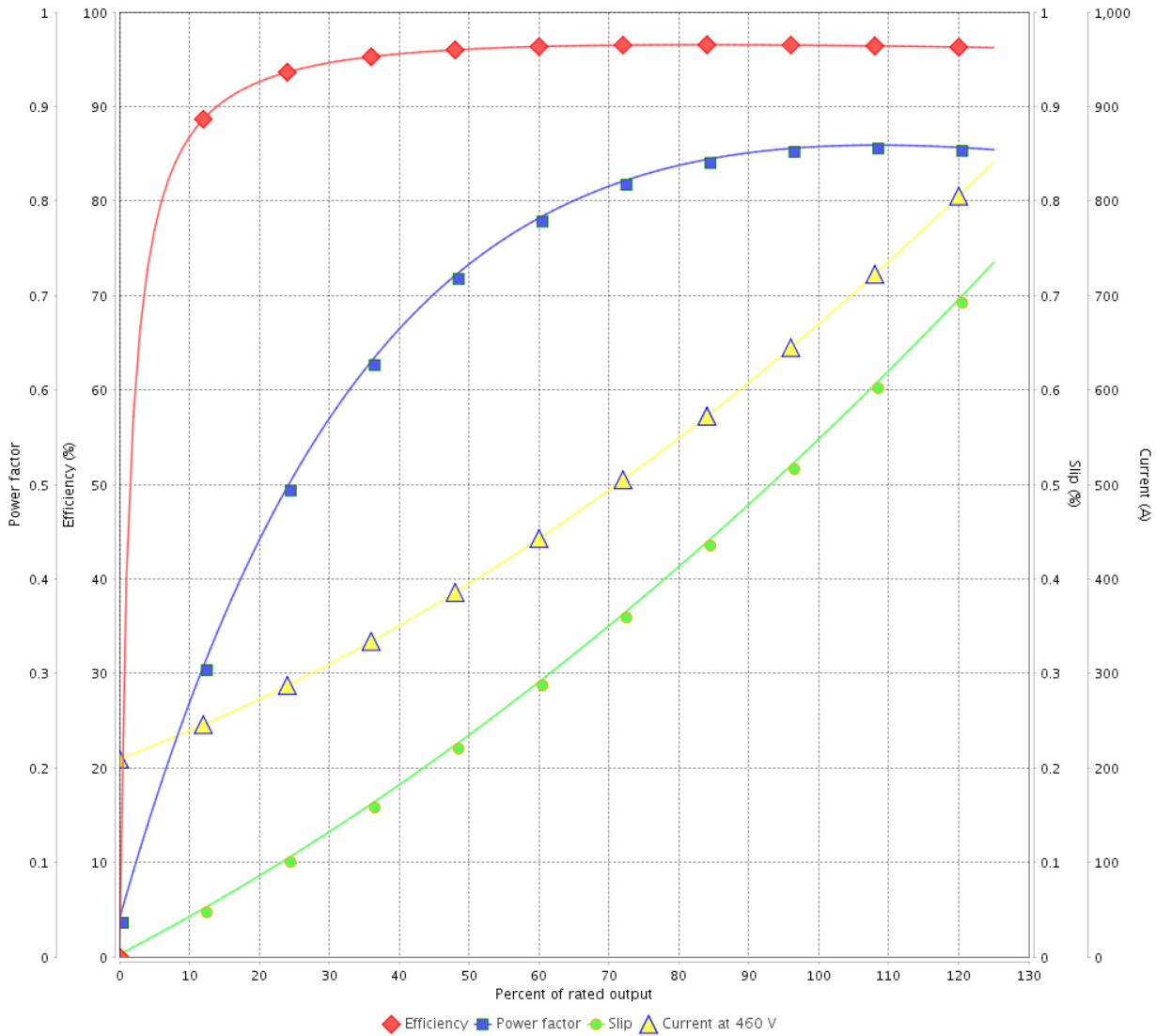

Performance : 460 V 60 Hz 4P

Rated current : 665 A
 LRC : 7.1
 Rated torque : 1760 ft.lb
 Locked rotor torque : 229 %
 Breakdown torque : 250 %
 Rated speed : 1790 rpm

Moment of inertia (J) : 235 sq.ft.lb
 Duty cycle : Cont.(S1)
 Insulation class : F
 Service factor : 1.15
 Temperature rise : 80 K

Rev.	Changes Summary	Performed	Checked	Date
Performed by			Page 4 / 7	Revision
Checked by				
Date	12/04/2022			

THERMAL LIMIT CURVE



Three Phase Induction Motor - Squirrel Cage

Customer :

Product line : NEMA Premium Efficiency Three-Phase
 Product code : 11679237
 Catalog # : 60018ET3G586/7-W22

Performance : 460 V 60 Hz 4P

Rated current : 665 A	Moment of inertia (J) : 235 sq.ft.lb
LRC : 7.1	Duty cycle : Cont.(S1)
Rated torque : 1760 ft.lb	Insulation class : F
Locked rotor torque : 229 %	Service factor : 1.15
Breakdown torque : 250 %	Temperature rise : 80 K
Rated speed : 1790 rpm	

Heating constant

Cooling constant

Rev.	Changes Summary	Performed	Checked	Date
Performed by				
Checked by			Page	Revision
Date	12/04/2022		5 / 7	

THERMAL LIMIT CURVE

Three Phase Induction Motor - Squirrel Cage



Customer : _____

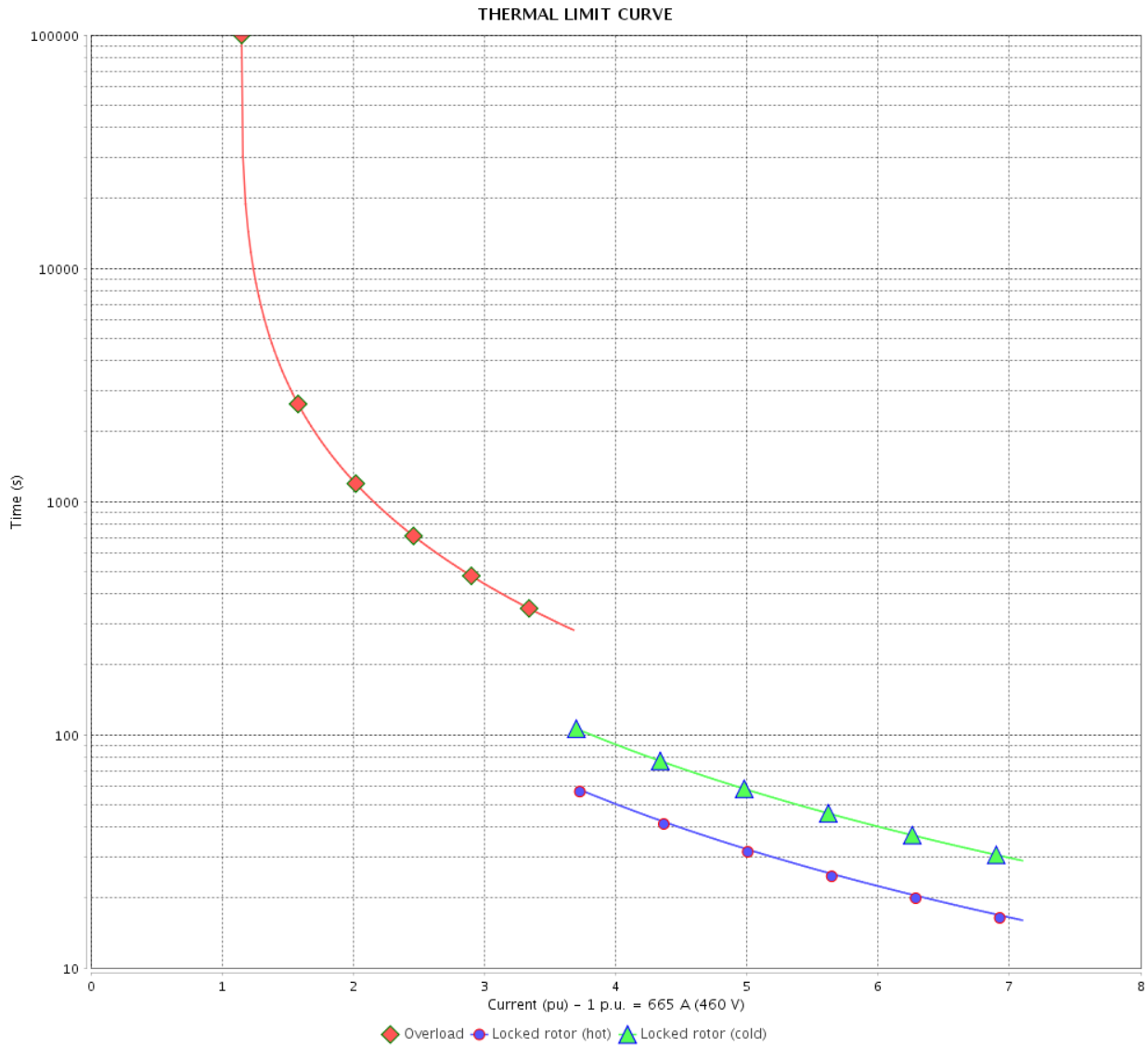

Rev.	Changes Summary	Performed	Checked	Date
Performed by		Page 6 / 7		Revision
Checked by				
Date				

VFD OPERATION CURVE

Three Phase Induction Motor - Squirrel Cage



Customer :

Product line : NEMA Premium Efficiency Three-Phase

Product code : 11679237

Catalog # : 60018ET3G586/7-W22

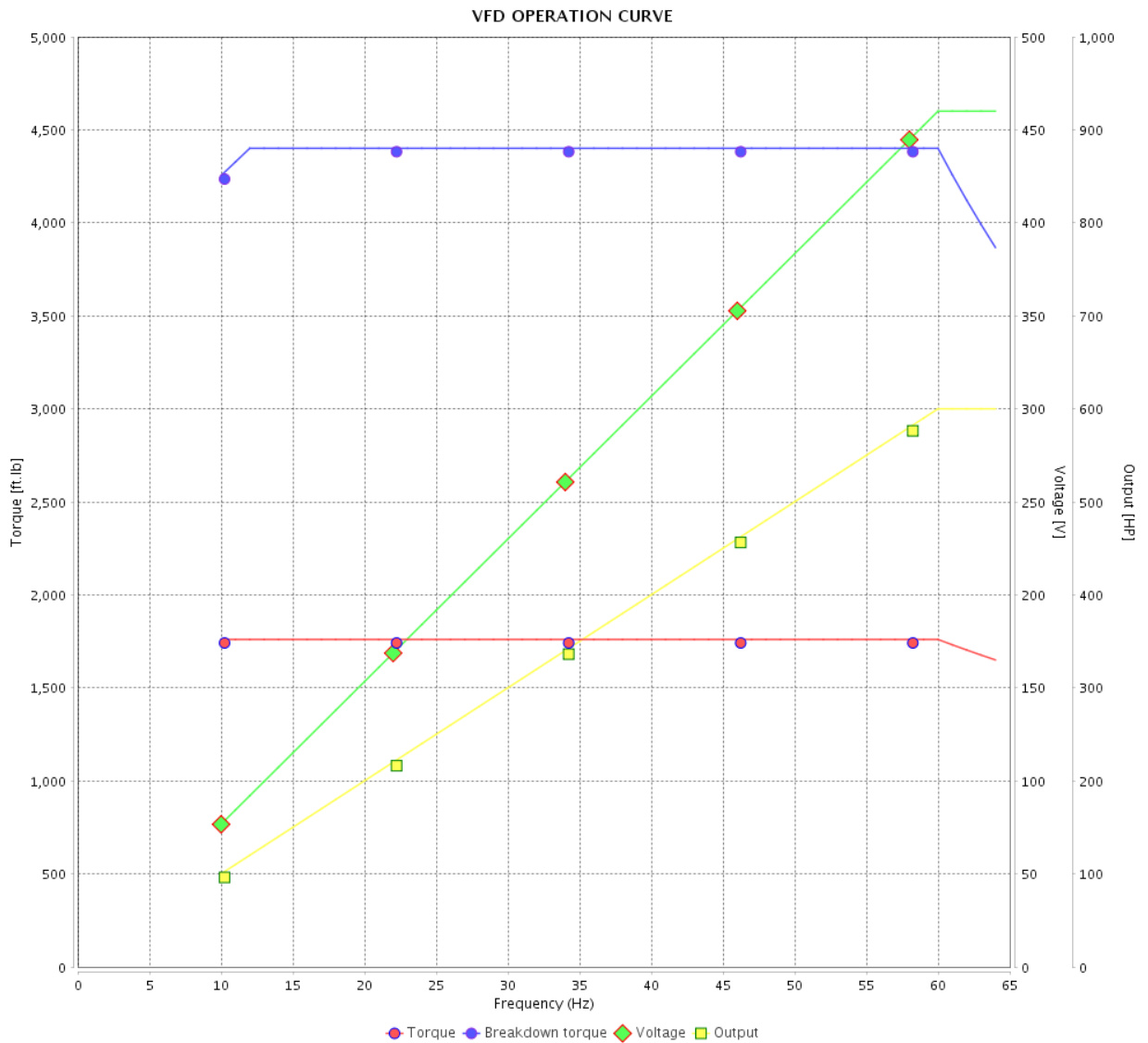

Performance : 460 V 60 Hz 4P

Rated current : 665 A
 LRC : 7.1
 Rated torque : 1760 ft.lb
 Locked rotor torque : 229 %
 Breakdown torque : 250 %
 Rated speed : 1790 rpm

Moment of inertia (J) : 235 sq.ft.lb
 Duty cycle : Cont.(S1)
 Insulation class : F
 Service factor : 1.15
 Temperature rise : 80 K

Rev.	Changes Summary	Performed	Checked	Date
Performed by			Page	Revision
Checked by			7 / 7	
Date	12/04/2022			

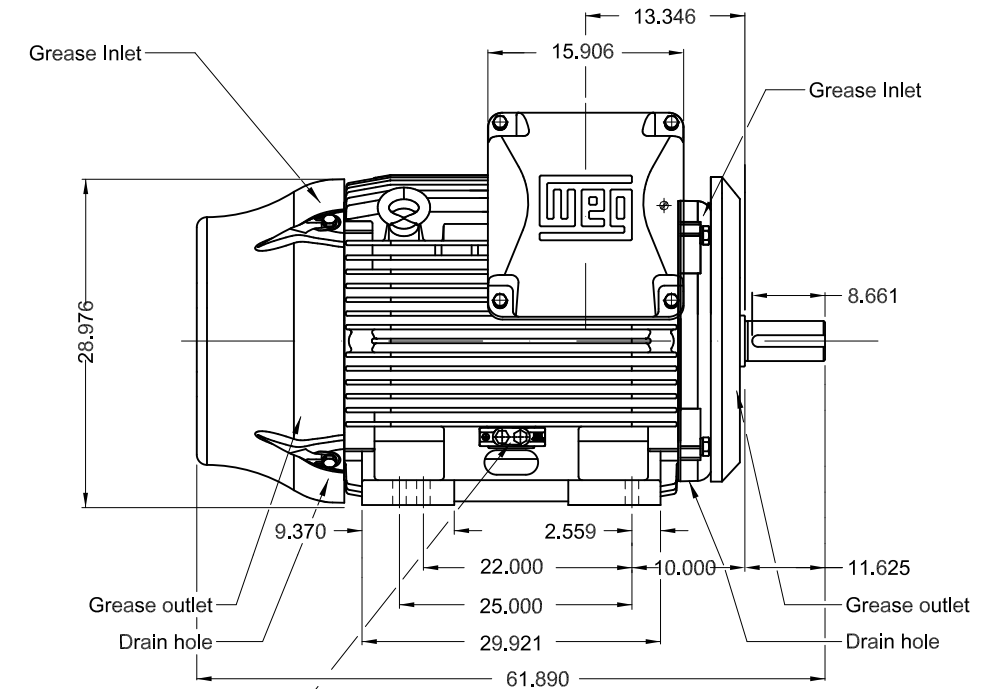
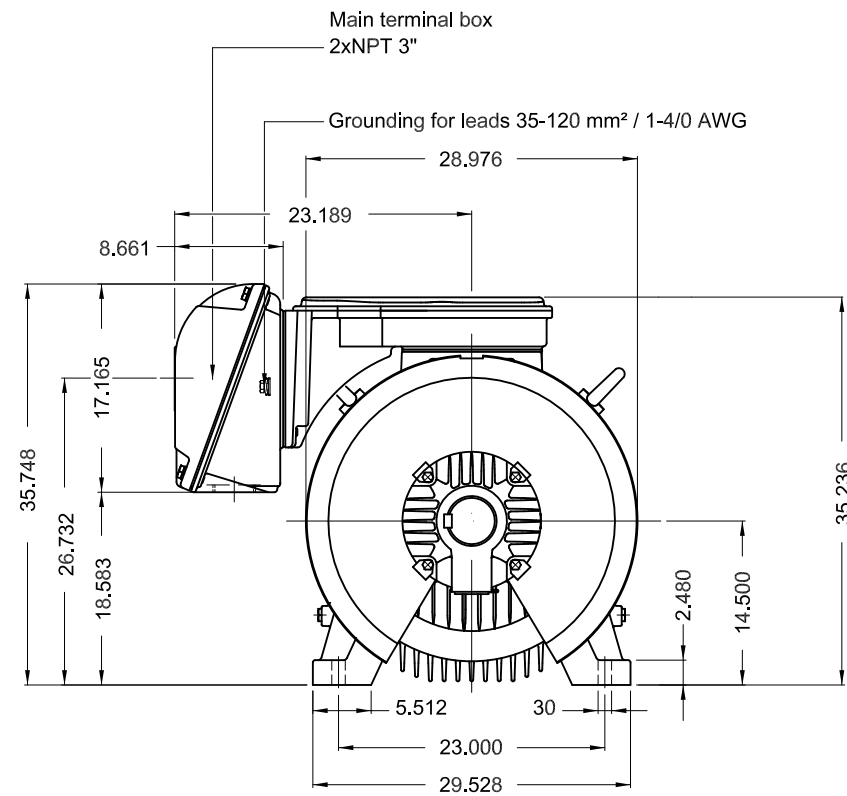

Grounding for leads 25-185 mm² / 3AWG-350MCM

600 HP 04 Poles 60 Hz

Dimensions in inches

- Without vertical jackscrews
- NDE endshield with electrically insulated bearing hub
- Drive-End Air Deflector
- Color RAL 5009
- Painting plan 203A
- Mounting NEMA F-1
- Mounting B3R(D)

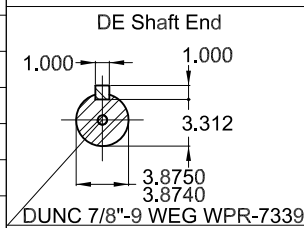

ECM	LOC	SUMMARY OF MODIFICATIONS	EXECUTED	CHECKED	RELEASED	DATE	VER
EXECUTED	PIRWBUSER	THREE PH. MOTOR W22 PREM. EFF.					
CHECKED		FRAME 586/7T IP55 TEFC					
RELEASED							
REL DT.	WMO	Jaragua do Sul	Product Engineering				

PREVIEW
WDD



SHEET 1 / 1

MADE IN MEXICO
11679237



FOR SAFE AREA
Mod.TE1BFOXON





Class I, Div 2, Gr A, B, C and D - T2C
Class I, Zone 2, IIC - T2C
Class II, Div 2, Gr F and G - T3C
For use on PWM: Gr. A, B, C and D,
VT 1000:1, CT 6:1, 1.00SF - T2B

MODEL 60018ET3G586/7-W22

Inverter Duty Motor
Severe Duty

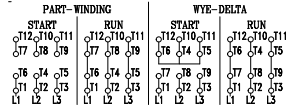
PH3	60Hz	Fr. 586/7T	1000m.a.s.l.	IP55	TEFC	4672lb
V 460				A 665		
HP 600				kW 440		
SF 1.15				SFA 765		
RPM 1790				PF 0.86		
AMB 40°C				INS cl. F DT80K	NEMA NOM EFF 96.5%	
DUTY CONT.				DES - Code G		



-  → 6322-C3 (60g)
-  → 6319-C3 (45g)

 MOBIL POLYREX EM (6000h)