

# DATA SHEET

## Three Phase Induction Motor - Squirrel Cage



|  |                            |                                       |  |                      |          |
|--|----------------------------|---------------------------------------|--|----------------------|----------|
| Customer :   |                            |                                       |  |                      |          |
| Product line   |                            | : NEMA Premium Efficiency Three-Phase | Product code :   | 11997252             |          |
|  |                            |                                       | Catalog # :  | 70018ET3G588/9-W22   |          |
| Frame  | : 588/9T                   | Cooling method                        | : IC411 - TEFC   |                      |          |
| Insulation class   | : F                        | Mounting                              | : F-1  |                      |          |
| Duty cycle   | : Cont.(S1)                | Rotation <sup>1</sup>                 | : Both (CW and CCW)  |                      |          |
| Ambient temperature  | : -20°C to +40°C           | Starting method                       | : Direct On Line   |                      |          |
| Altitude   | : 1000 m.a.s.l.            | Approx. weight <sup>2</sup>           | : 5613 lb  |                      |          |
| Protection degree  | : IP55                     | Moment of inertia (J)                 | : 335 sq.ft.lb   |                      |          |
| Output [HP]  | 700                        | 600                                   | 600  | 600                  |          |
| Poles  | 4                          | 4                                     | 4  | 4                    |          |
| Frequency [Hz]   | 60                         | 50                                    | 50   | 50                   |          |
| Rated voltage [V]  | 460                        | 380                                   | 400  | 415                  |          |
| Rated current [A]  | 788                        | 815                                   | 783  | 764                  |          |
| L. R. Amperes [A]  | 5122                       | 4890                                  | 5324   | 5654                 |          |
| LRC [A]  | 6.5x(Code G)               | 6.0x(Code F)                          | 6.8x(Code G)   | 7.4x(Code H)         |          |
| No load current [A]  | 240                        | 240                                   | 260  | 280                  |          |
| Rated speed [RPM]  | 1790                       | 1490                                  | 1490   | 1490                 |          |
| Slip [%]   | 0.56                       | 0.67                                  | 0.67   | 0.67                 |          |
| Rated torque [ft.lb]   | 2050                       | 2110                                  | 2110   | 2110                 |          |
| Locked rotor torque [%]  | 250                        | 229                                   | 250  | 280                  |          |
| Breakdown torque [%]   | 220                        | 210                                   | 229  | 260                  |          |
| Service factor   | 1.00                       | 1.00                                  | 1.00   | 1.00                 |          |
| Temperature rise   | 80 K                       | 80 K                                  | 80 K   | 80 K                 |          |
| Locked rotor time  | 41s (cold) 23s (hot)       | 41s (cold) 23s (hot)                  | 41s (cold) 23s (hot)   | 41s (cold) 23s (hot) |          |
| Noise level <sup>2</sup>   | 81.0 dB(A)                 | 76.0 dB(A)                            | 76.0 dB(A)   | 76.0 dB(A)           |          |
| Efficiency (%)   | 25%                        | 96.0                                  | 96.1   | 96.1                 |          |
|  | 50%                        | 96.2                                  | 96.2   | 96.2                 |          |
|  | 75%                        | 96.5                                  | 96.5   | 96.5                 |          |
|  | 100%                       | 96.6                                  | 96.5   | 96.5                 |          |
| Power Factor   | 25%                        | 0.51                                  | 0.53   | 0.48                 |          |
|  | 50%                        | 0.76                                  | 0.77   | 0.73                 |          |
|  | 75%                        | 0.81                                  | 0.82   | 0.79                 |          |
|  | 100%                       | 0.85                                  | 0.85   | 0.84                 |          |
| Bearing type   | : <u>Drive end</u> 6322 C3 | <u>Non drive end</u> 6319 C3          | Foundation loads   |                      |          |
| Sealing  | : Taconite                 | Taconite                              | Max. traction  | : 8664 lb            |          |
|  | Labyrinth                  | Labyrinth                             | Max. compression   | : 14278 lb           |          |
| Lubrication interval   | : 6000 h                   | 8000 h                                |  |                      |          |
| Lubricant amount   | : 60 g                     | 45 g                                  |  |                      |          |
| Lubricant type   | : Mobil Polyrex EM         |                                       |  |                      |          |
| Notes  |                            |                                       |  |                      |          |
| This revision replaces and cancel the previous one, which must be eliminated.<br>(1) Looking the motor from the shaft end.<br>(2) Measured at 1m and with tolerance of +3dB(A).<br>(3) Approximate weight subject to changes after manufacturing process.<br>(4) At 100% of full load. |                            |                                       | These are average values based on tests with sinusoidal power supply, subject to the tolerances stipulated in NEMA MG-1. |                      |          |
| Rev.   | Changes Summary            |                                       | Performed  | Checked              | Date     |
| Performed by   |                            |                                       |  |                      |          |
| Checked by   |                            |                                       |  | Page                 | Revision |
| Date   | 13/04/2022                 |                                       |  | 1 / 22               |          |

# DATA SHEET

## Three Phase Induction Motor - Squirrel Cage



Customer : \_\_\_\_\_

### Space heater information

Voltage: 200 - 240 V

| Rev.         | Changes Summary | Performed | Checked        | Date     |
|--------------|-----------------|-----------|----------------|----------|
| Performed by |                 |           |                |          |
| Checked by   |                 |           |                |          |
| Date         | 13/04/2022      |           | Page<br>2 / 22 | Revision |

# TORQUE AND CURRENT VS SPEED CURVE



## Three Phase Induction Motor - Squirrel Cage

Customer :

Product line : NEMA Premium Efficiency Three-Phase

Product code : 11997252

Catalog # : 70018ET3G588/9-W22

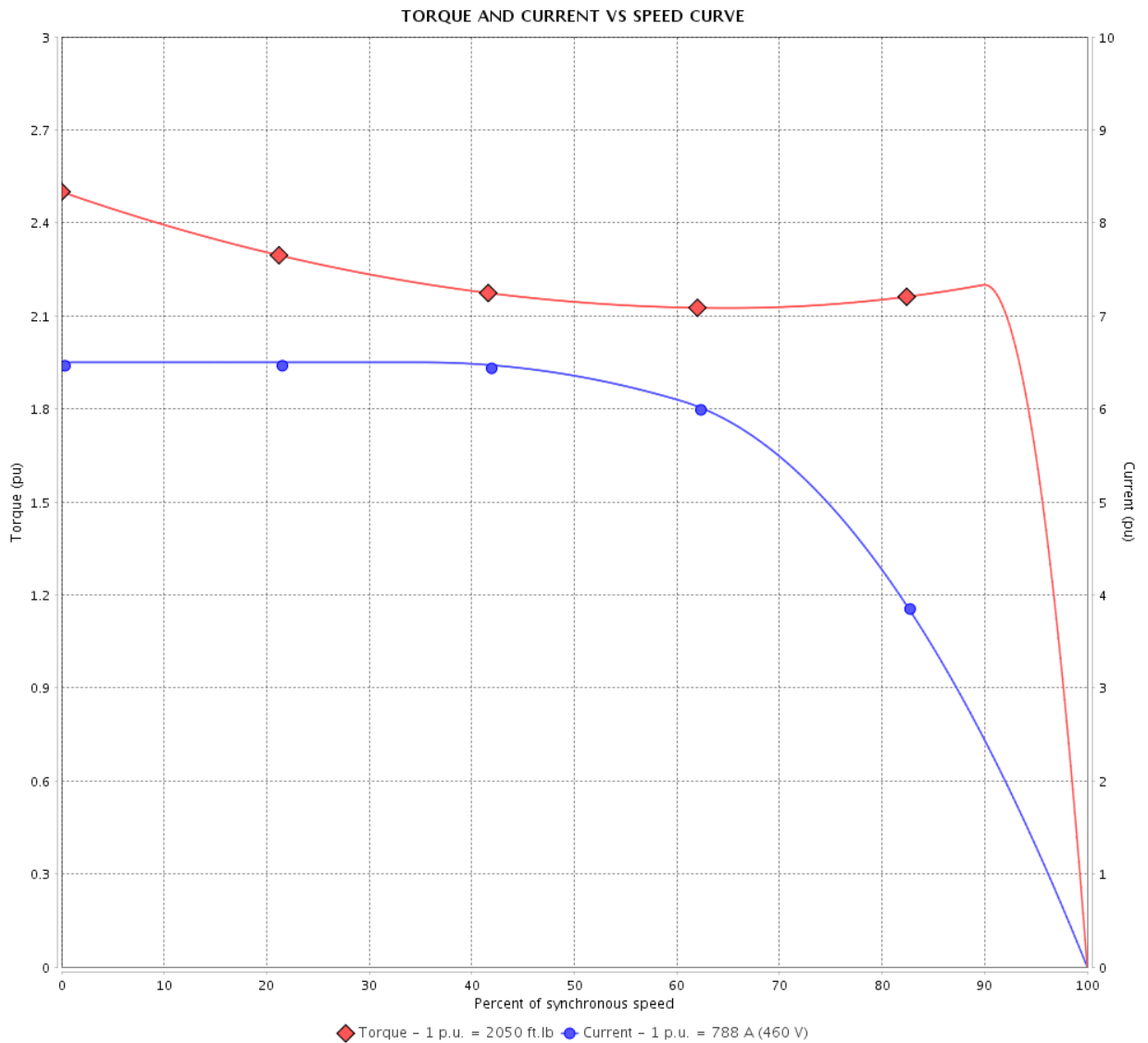

Performance : 460 V 60 Hz 4P

Rated current : 788 A  
 LRC : 6.5  
 Rated torque : 2050 ft.lb  
 Locked rotor torque : 250 %  
 Breakdown torque : 220 %  
 Rated speed : 1790 rpm

Moment of inertia (J) : 335 sq.ft.lb  
 Duty cycle : Cont.(S1)  
 Insulation class : F  
 Service factor : 1.00  
 Temperature rise : 80 K

Locked rotor time : 41s (cold) 23s (hot)

| Rev.         | Changes Summary | Performed | Checked        | Date     |
|--------------|-----------------|-----------|----------------|----------|
|              |                 |           |                |          |
| Performed by |                 |           | Page<br>3 / 22 | Revision |
| Checked by   |                 |           |                |          |
| Date         | 13/04/2022      |           |                |          |

# TORQUE AND CURRENT VS SPEED CURVE

## Three Phase Induction Motor - Squirrel Cage



Customer :

Product line : NEMA Premium Efficiency Three-Phase

Product code : 11997252

Catalog # : 70018ET3G588/9-W22

TORQUE AND CURRENT VS SPEED CURVE

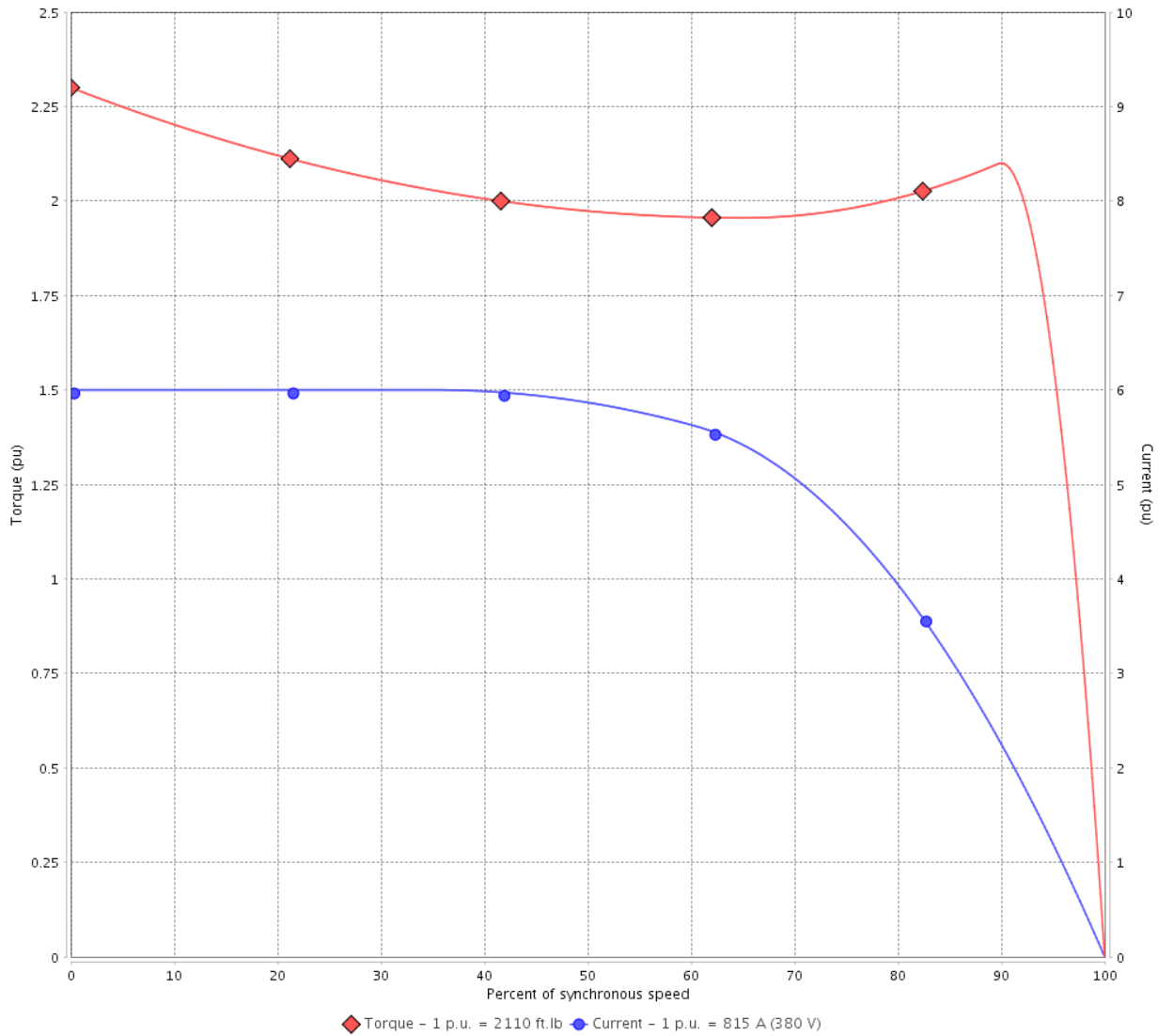

Performance : 380 V 50 Hz 4P IE3

|                     |              |                       |                |
|---------------------|--------------|-----------------------|----------------|
| Rated current       | : 815 A      | Moment of inertia (J) | : 335 sq.ft.lb |
| LRC                 | : 6.0        | Duty cycle            | : Cont.(S1)    |
| Rated torque        | : 2110 ft.lb | Insulation class      | : F            |
| Locked rotor torque | : 229 %      | Service factor        | : 1.00         |
| Breakdown torque    | : 210 %      | Temperature rise      | : 80 K         |
| Rated speed         | : 1490 rpm   |                       |                |

Locked rotor time : 41s (cold) 23s (hot)

| Rev.         | Changes Summary | Performed | Checked        | Date     |
|--------------|-----------------|-----------|----------------|----------|
|              |                 |           |                |          |
| Performed by |                 |           | Page<br>4 / 22 | Revision |
| Checked by   |                 |           |                |          |
| Date         | 13/04/2022      |           |                |          |

# TORQUE AND CURRENT VS SPEED CURVE



## Three Phase Induction Motor - Squirrel Cage

Customer :

Product line : NEMA Premium Efficiency Three-Phase

Product code : 11997252

Catalog # : 70018ET3G588/9-W22

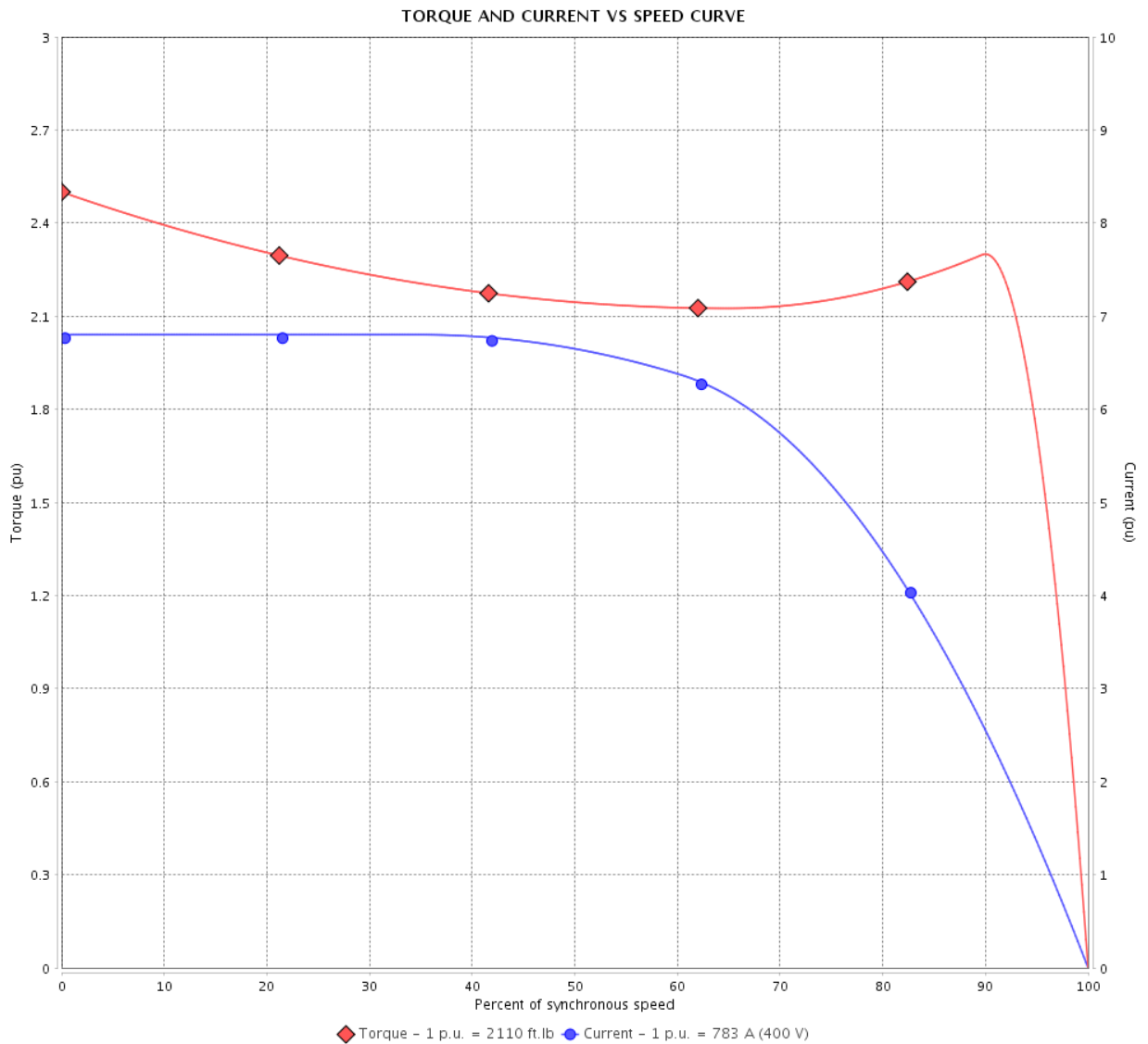

Performance : 400 V 50 Hz 4P IE3

Rated current : 783 A  
 LRC : 6.8  
 Rated torque : 2110 ft.lb  
 Locked rotor torque : 250 %  
 Breakdown torque : 229 %  
 Rated speed : 1490 rpm

Moment of inertia (J) : 335 sq.ft.lb  
 Duty cycle : Cont.(S1)  
 Insulation class : F  
 Service factor : 1.00  
 Temperature rise : 80 K

Locked rotor time : 41s (cold) 23s (hot)

| Rev.         | Changes Summary | Performed | Checked        | Date     |
|--------------|-----------------|-----------|----------------|----------|
|              |                 |           |                |          |
| Performed by |                 |           | Page<br>5 / 22 | Revision |
| Checked by   |                 |           |                |          |
| Date         | 13/04/2022      |           |                |          |

# TORQUE AND CURRENT VS SPEED CURVE

Three Phase Induction Motor - Squirrel Cage



Customer :

Product line : NEMA Premium Efficiency Three-Phase

Product code : 11997252

Catalog # : 70018ET3G588/9-W22

TORQUE AND CURRENT VS SPEED CURVE

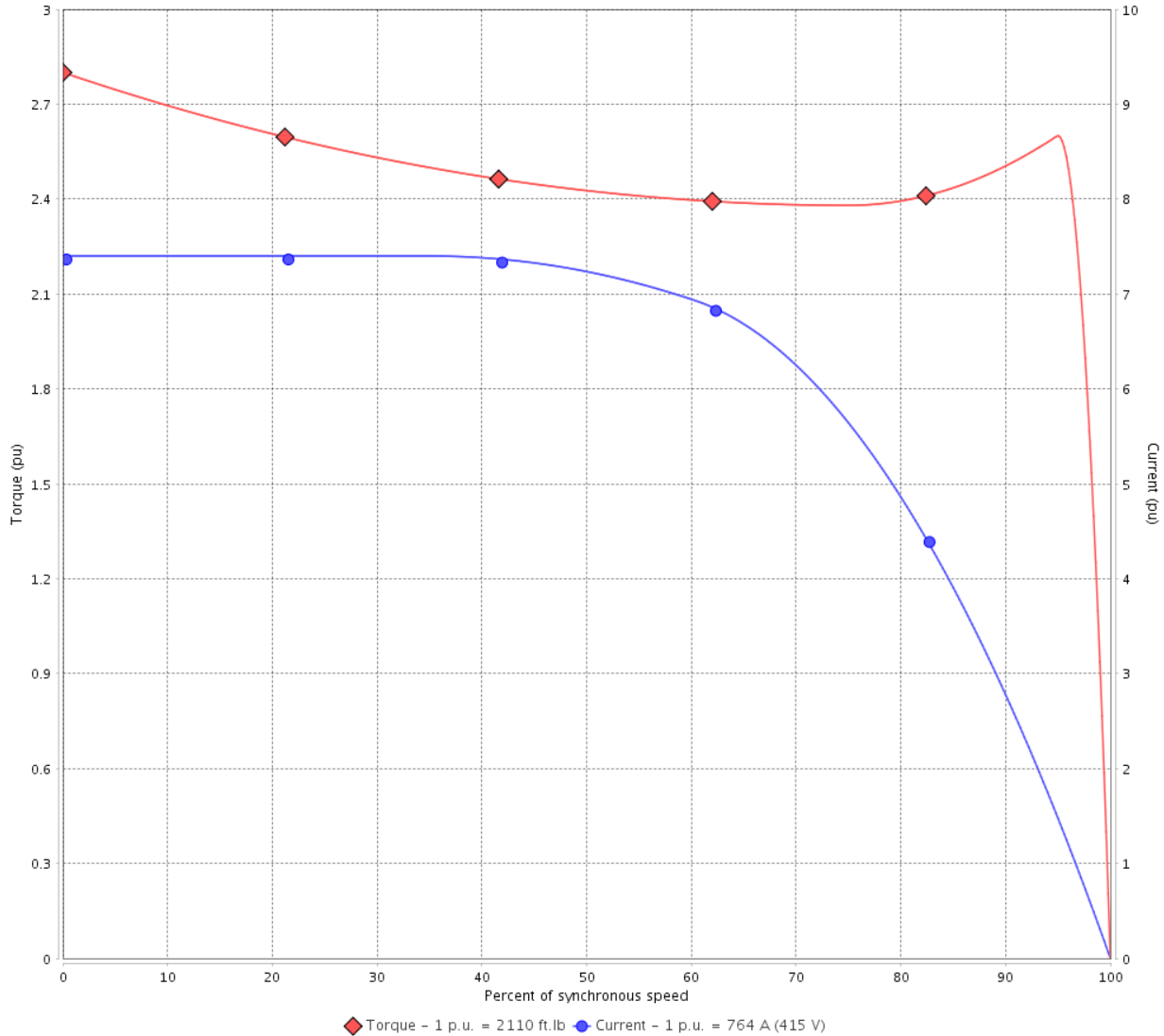

Performance : 415 V 50 Hz 4P IE3

|                     |              |                       |                |
|---------------------|--------------|-----------------------|----------------|
| Rated current       | : 764 A      | Moment of inertia (J) | : 335 sq.ft.lb |
| LRC                 | : 7.4        | Duty cycle            | : Cont.(S1)    |
| Rated torque        | : 2110 ft.lb | Insulation class      | : F            |
| Locked rotor torque | : 280 %      | Service factor        | : 1.00         |
| Breakdown torque    | : 260 %      | Temperature rise      | : 80 K         |
| Rated speed         | : 1490 rpm   |                       |                |

Locked rotor time : 41s (cold) 23s (hot)

| Rev.         | Changes Summary | Performed | Checked        | Date     |
|--------------|-----------------|-----------|----------------|----------|
|              |                 |           |                |          |
| Performed by |                 |           | Page<br>6 / 22 | Revision |
| Checked by   |                 |           |                |          |
| Date         | 13/04/2022      |           |                |          |

# LOAD PERFORMANCE CURVE

## Three Phase Induction Motor - Squirrel Cage



Customer :

Product line : NEMA Premium Efficiency Three-Phase

Product code : 11997252

Catalog # : 70018ET3G588/9-W22

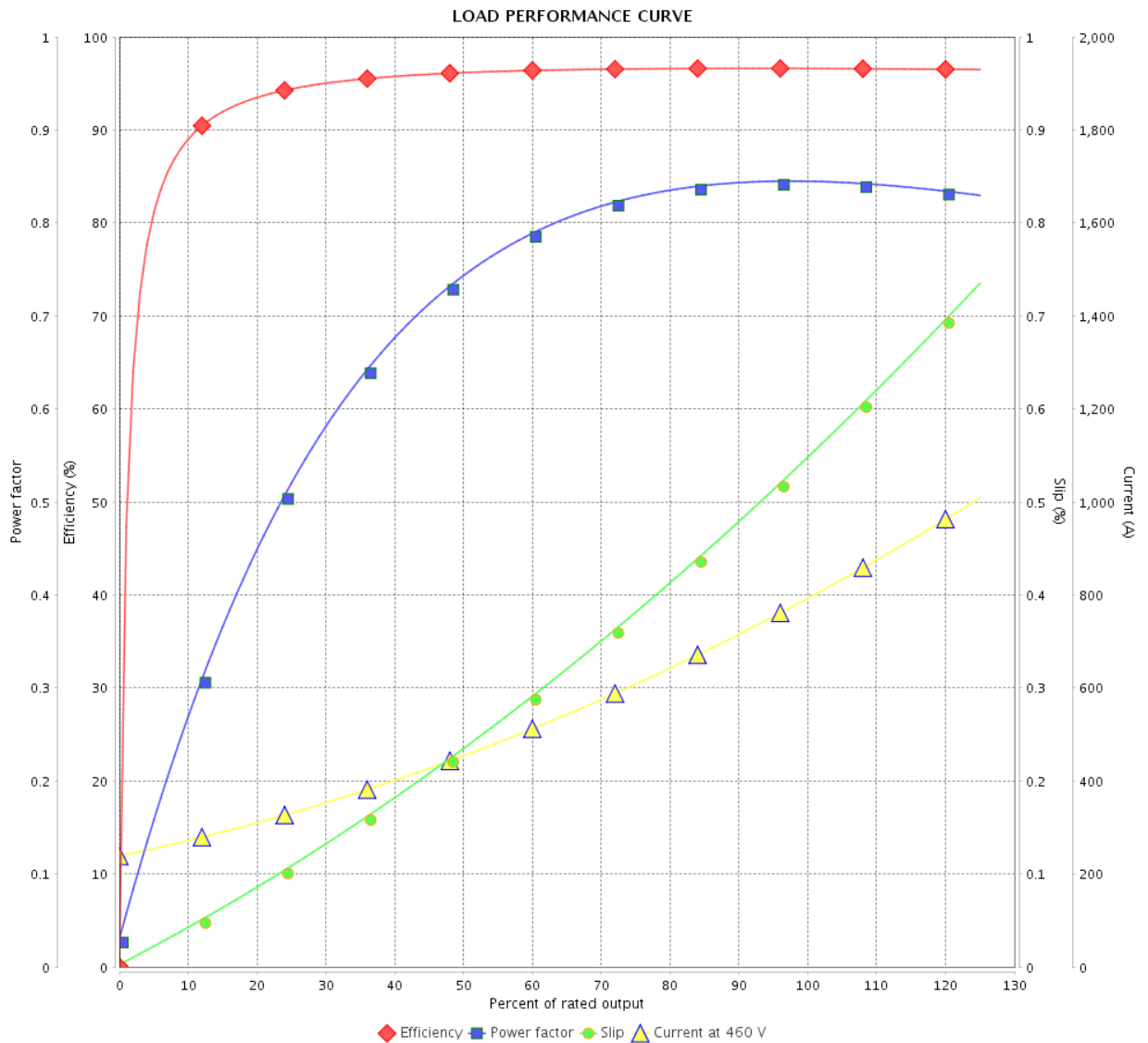

Performance : 460 V 60 Hz 4P

Rated current : 788 A  
 LRC : 6.5  
 Rated torque : 2050 ft.lb  
 Locked rotor torque : 250 %  
 Breakdown torque : 220 %  
 Rated speed : 1790 rpm

Moment of inertia (J) : 335 sq.ft.lb  
 Duty cycle : Cont.(S1)  
 Insulation class : F  
 Service factor : 1.00  
 Temperature rise : 80 K

| Rev.         | Changes Summary | Performed | Checked | Date     |
|--------------|-----------------|-----------|---------|----------|
|              |                 |           |         |          |
| Performed by |                 |           | Page    | Revision |
| Checked by   |                 |           |         |          |
| Date         |                 |           |         |          |

# LOAD PERFORMANCE CURVE

Three Phase Induction Motor - Squirrel Cage



Customer :

Product line : NEMA Premium Efficiency Three-Phase

Product code : 11997252

Catalog # : 70018ET3G588/9-W22

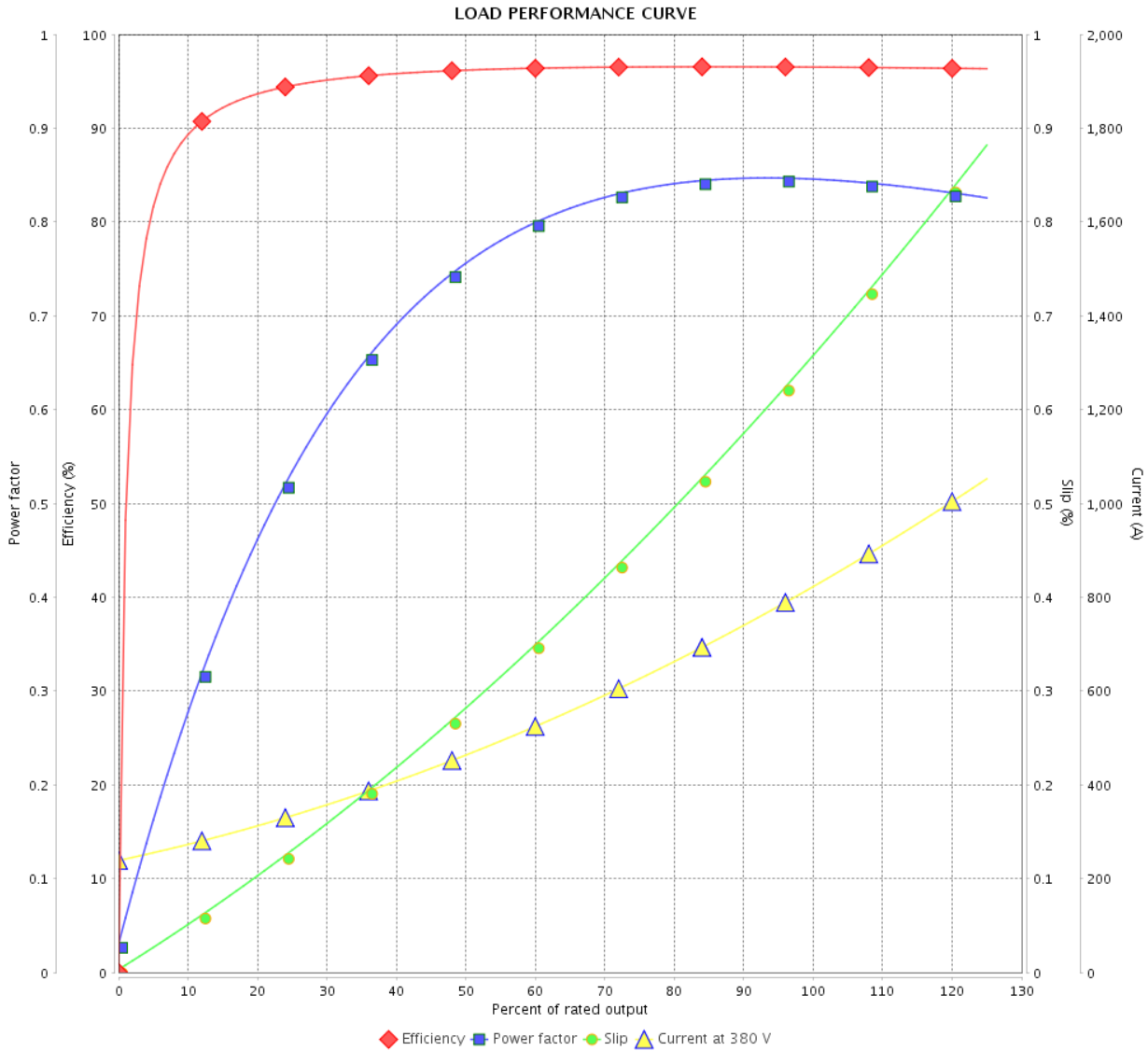

Performance : 380 V 50 Hz 4P IE3

Rated current : 815 A  
 LRC : 6.0  
 Rated torque : 2110 ft.lb  
 Locked rotor torque : 229 %  
 Breakdown torque : 210 %  
 Rated speed : 1490 rpm

Moment of inertia (J) : 335 sq.ft.lb  
 Duty cycle : Cont.(S1)  
 Insulation class : F  
 Service factor : 1.00  
 Temperature rise : 80 K

| Rev.         | Changes Summary | Performed | Checked | Date     |
|--------------|-----------------|-----------|---------|----------|
|              |                 |           |         |          |
| Performed by |                 |           |         |          |
| Checked by   |                 |           |         |          |
| Date         |                 |           |         |          |
|              |                 |           | Page    | Revision |
|              |                 |           | 8 / 22  |          |



# LOAD PERFORMANCE CURVE

## Three Phase Induction Motor - Squirrel Cage



Customer :

Product line : NEMA Premium Efficiency Three-Phase

Product code : 11997252

Catalog # : 70018ET3G588/9-W22

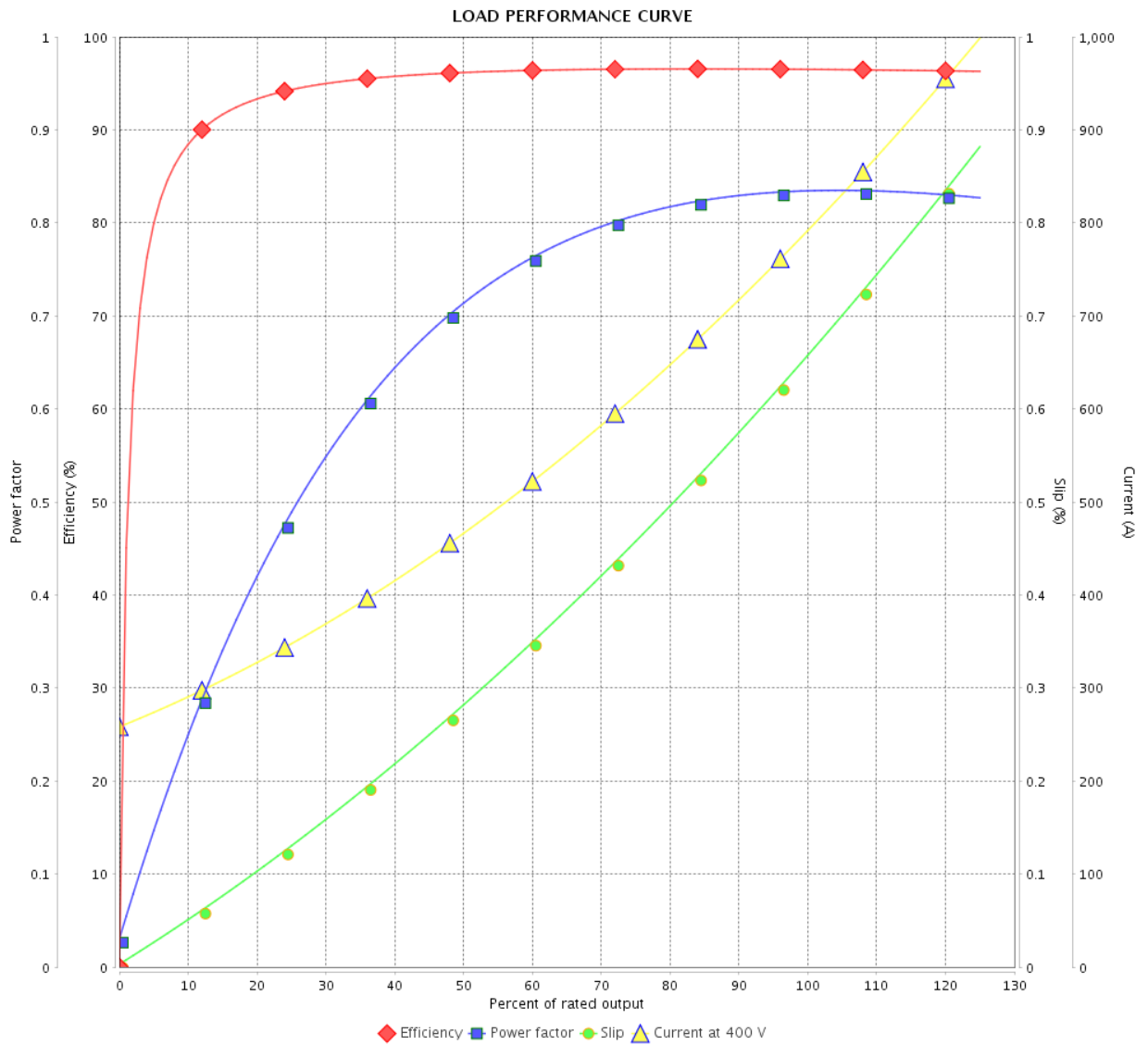

Performance : 400 V 50 Hz 4P IE3

Rated current : 783 A  
 LRC : 6.8  
 Rated torque : 2110 ft.lb  
 Locked rotor torque : 250 %  
 Breakdown torque : 229 %  
 Rated speed : 1490 rpm

Moment of inertia (J) : 335 sq.ft.lb  
 Duty cycle : Cont.(S1)  
 Insulation class : F  
 Service factor : 1.00  
 Temperature rise : 80 K

| Rev.         | Changes Summary | Performed | Checked  | Date |
|--------------|-----------------|-----------|----------|------|
|              |                 |           |          |      |
| Performed by |                 |           |          |      |
| Checked by   |                 |           |          |      |
| Date         |                 |           |          |      |
|              |                 | Page      | Revision |      |
|              |                 | 9 / 22    |          |      |

# LOAD PERFORMANCE CURVE

Three Phase Induction Motor - Squirrel Cage



Customer :

Product line : NEMA Premium Efficiency Three-Phase

Product code : 11997252

Catalog # : 70018ET3G588/9-W22

LOAD PERFORMANCE CURVE

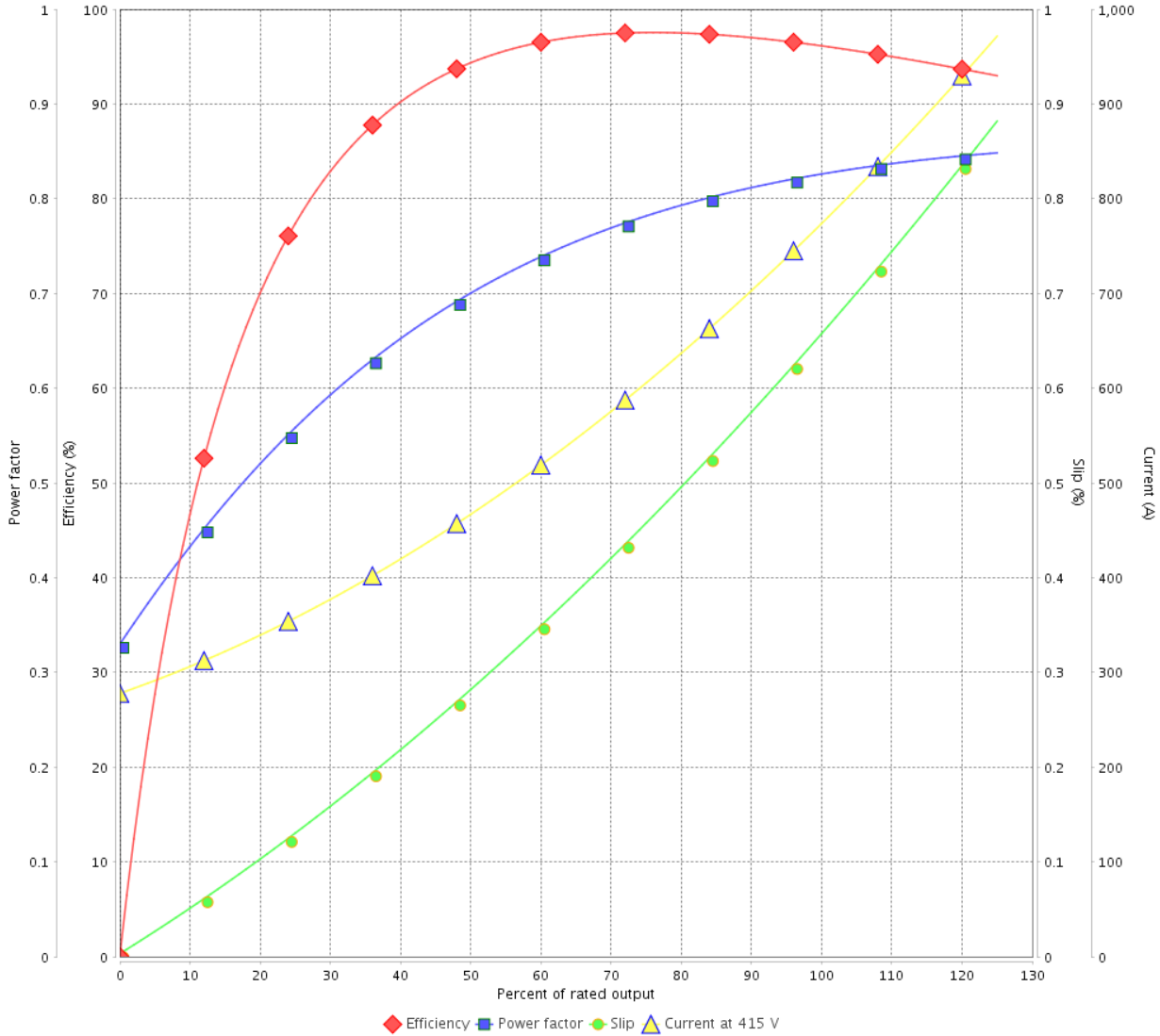

Performance : 415 V 50 Hz 4P IE3

Rated current : 764 A  
 LRC : 7.4  
 Rated torque : 2110 ft.lb  
 Locked rotor torque : 280 %  
 Breakdown torque : 260 %  
 Rated speed : 1490 rpm

Moment of inertia (J) : 335 sq.ft.lb  
 Duty cycle : Cont.(S1)  
 Insulation class : F  
 Service factor : 1.00  
 Temperature rise : 80 K

| Rev.         | Changes Summary | Performed | Checked | Date     |
|--------------|-----------------|-----------|---------|----------|
|              |                 |           |         |          |
| Performed by |                 |           | Page    | Revision |
| Checked by   |                 |           | 10 / 22 |          |
| Date         | 13/04/2022      |           |         |          |

# THERMAL LIMIT CURVE



## Three Phase Induction Motor - Squirrel Cage

Customer :

Product line : NEMA Premium Efficiency Three-Phase  
 Product code : 11997252  
 Catalog # : 70018ET3G588/9-W22

Performance : 460 V 60 Hz 4P

|                             |                                      |
|-----------------------------|--------------------------------------|
| Rated current : 788 A       | Moment of inertia (J) : 335 sq.ft.lb |
| LRC : 6.5                   | Duty cycle : Cont.(S1)               |
| Rated torque : 2050 ft.lb   | Insulation class : F                 |
| Locked rotor torque : 250 % | Service factor : 1.00                |
| Breakdown torque : 220 %    | Temperature rise : 80 K              |
| Rated speed : 1790 rpm      |                                      |

Heating constant

Cooling constant

| Rev.         | Changes Summary | Performed | Checked | Date     |
|--------------|-----------------|-----------|---------|----------|
|              |                 |           |         |          |
| Performed by |                 |           |         |          |
| Checked by   |                 |           | Page    | Revision |
| Date         | 13/04/2022      |           | 11 / 22 |          |

# THERMAL LIMIT CURVE

Three Phase Induction Motor - Squirrel Cage



Customer : \_\_\_\_\_

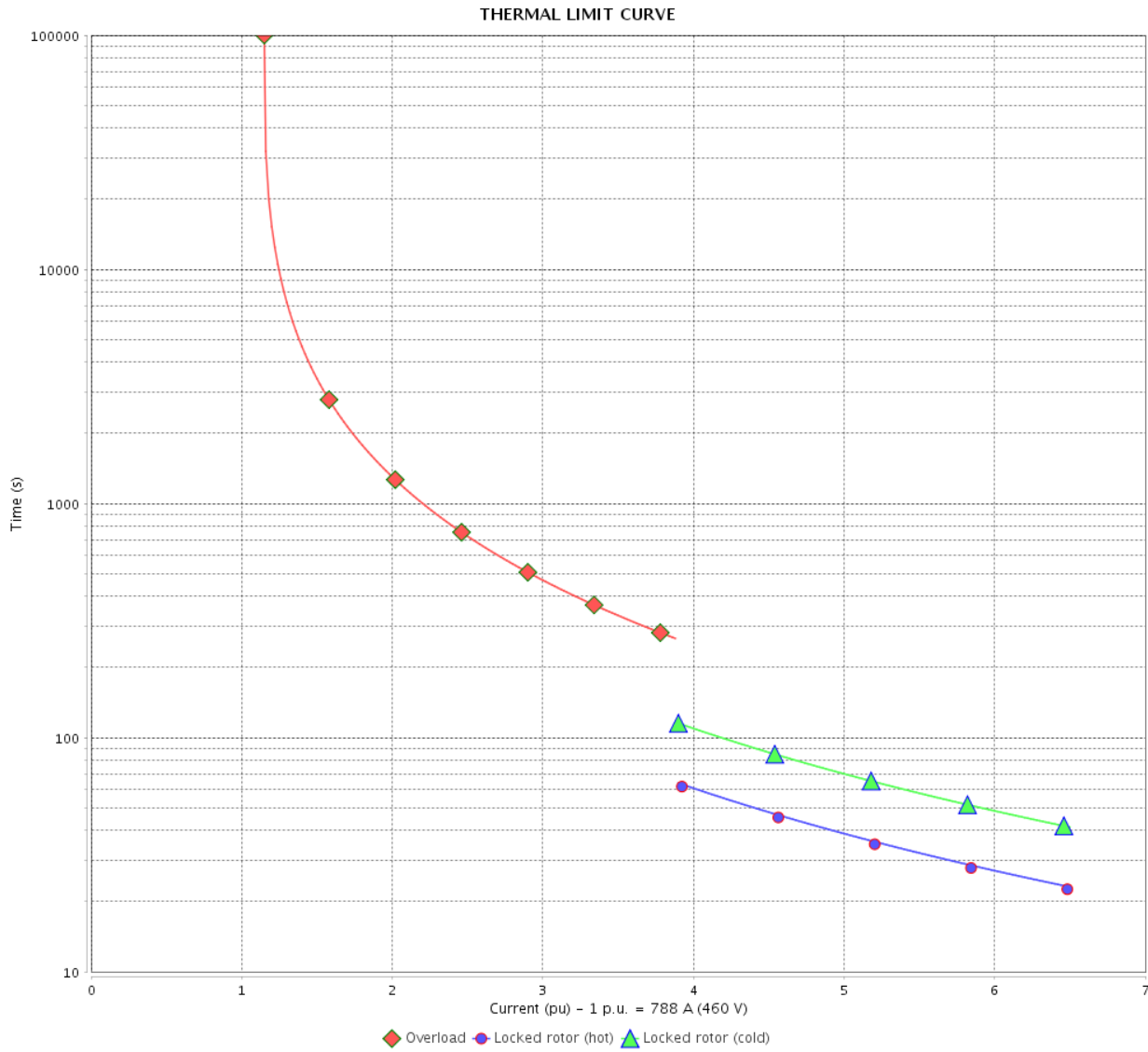

| Rev.         | Changes Summary | Performed  | Checked | Date     |
|--------------|-----------------|------------|---------|----------|
|              |                 |            |         |          |
| Performed by |                 | Page       |         | Revision |
| Checked by   |                 | 12 / 22    |         |          |
| Date         |                 | 13/04/2022 |         |          |

# THERMAL LIMIT CURVE

## Three Phase Induction Motor - Squirrel Cage



Customer :

Product line : NEMA Premium Efficiency Three-Phase  
Product code : 11997252  
Catalog # : 70018ET3G588/9-W22

Performance : 380 V 50 Hz 4P IE3

|                             |                                      |
|-----------------------------|--------------------------------------|
| Rated current : 815 A       | Moment of inertia (J) : 335 sq.ft.lb |
| LRC : 6.0                   | Duty cycle : Cont.(S1)               |
| Rated torque : 2110 ft.lb   | Insulation class : F                 |
| Locked rotor torque : 229 % | Service factor : 1.00                |
| Breakdown torque : 210 %    | Temperature rise : 80 K              |
| Rated speed : 1490 rpm      |                                      |

Heating constant

Cooling constant

| Rev.         | Changes Summary | Performed | Checked | Date     |
|--------------|-----------------|-----------|---------|----------|
|              |                 |           |         |          |
| Performed by |                 |           |         |          |
| Checked by   |                 |           | Page    | Revision |
| Date         | 13/04/2022      |           | 13 / 22 |          |

# THERMAL LIMIT CURVE

Three Phase Induction Motor - Squirrel Cage



Customer : \_\_\_\_\_

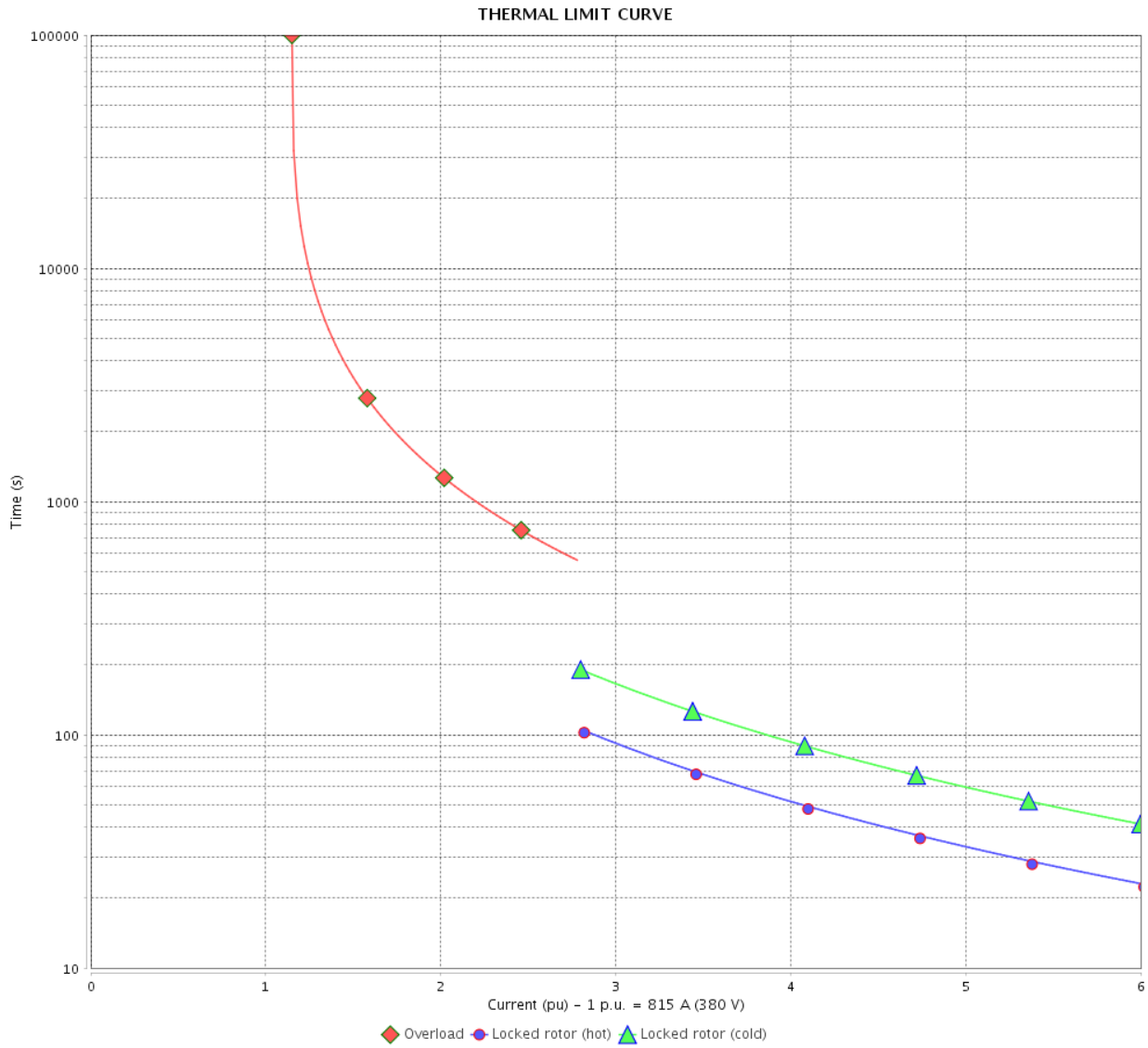

| Rev.         | Changes Summary | Performed  | Checked | Date     |
|--------------|-----------------|------------|---------|----------|
|              |                 |            |         |          |
| Performed by |                 | Page       |         | Revision |
| Checked by   |                 | 14 / 22    |         |          |
| Date         |                 | 13/04/2022 |         |          |

# THERMAL LIMIT CURVE



## Three Phase Induction Motor - Squirrel Cage

Customer :

Product line : NEMA Premium Efficiency Three-Phase  
 Product code : 11997252  
 Catalog # : 70018ET3G588/9-W22

Performance : 400 V 50 Hz 4P IE3

|                             |                                      |
|-----------------------------|--------------------------------------|
| Rated current : 783 A       | Moment of inertia (J) : 335 sq.ft.lb |
| LRC : 6.8                   | Duty cycle : Cont.(S1)               |
| Rated torque : 2110 ft.lb   | Insulation class : F                 |
| Locked rotor torque : 250 % | Service factor : 1.00                |
| Breakdown torque : 229 %    | Temperature rise : 80 K              |
| Rated speed : 1490 rpm      |                                      |

Heating constant

Cooling constant

| Rev.         | Changes Summary | Performed | Checked | Date     |
|--------------|-----------------|-----------|---------|----------|
|              |                 |           |         |          |
| Performed by |                 |           |         |          |
| Checked by   |                 |           | Page    | Revision |
| Date         | 13/04/2022      |           | 15 / 22 |          |

# THERMAL LIMIT CURVE

Three Phase Induction Motor - Squirrel Cage



Customer : \_\_\_\_\_

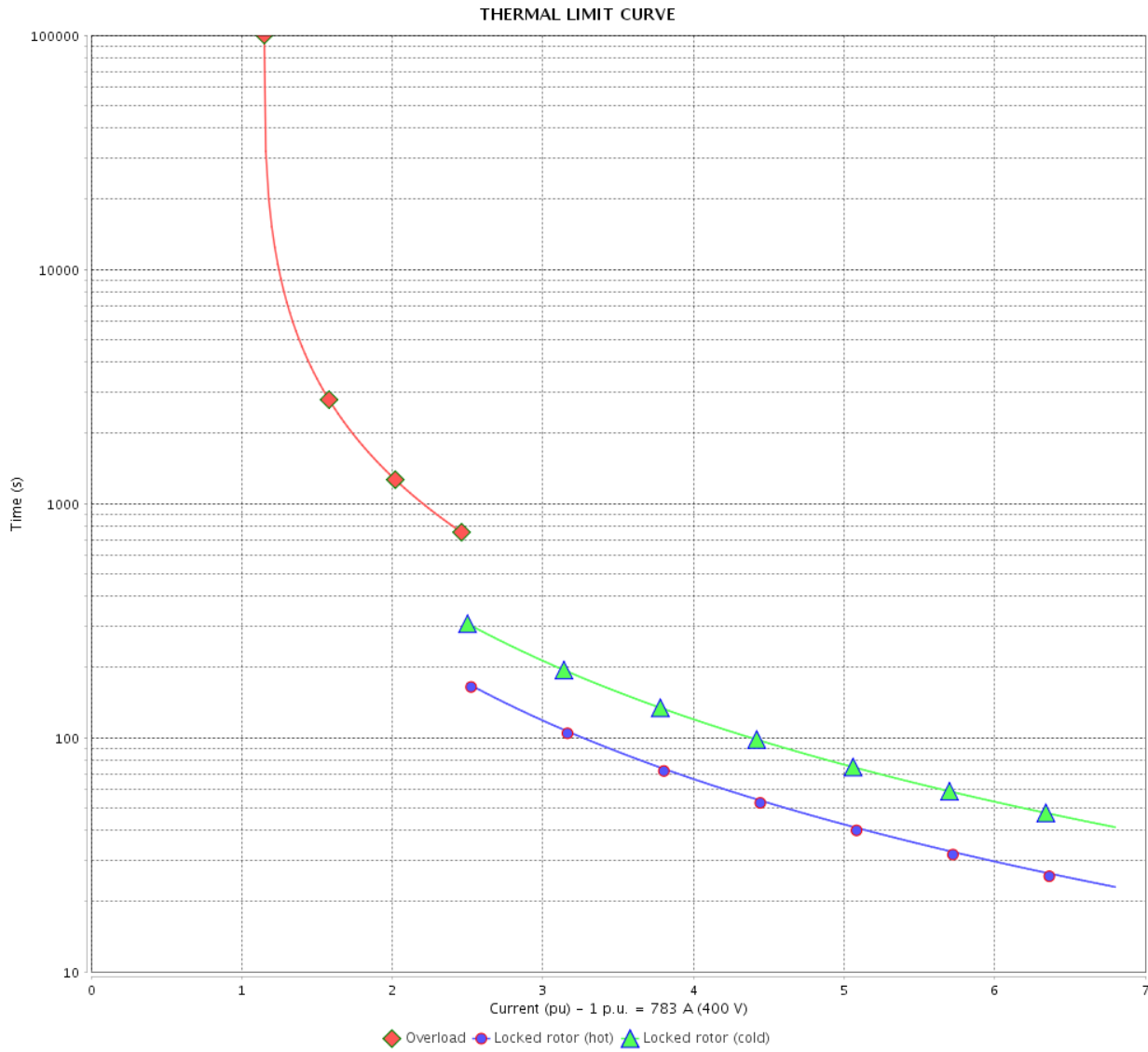

| Rev.         | Changes Summary | Performed  | Checked | Date     |
|--------------|-----------------|------------|---------|----------|
|              |                 |            |         |          |
| Performed by |                 | Page       |         | Revision |
| Checked by   |                 | 16 / 22    |         |          |
| Date         |                 | 13/04/2022 |         |          |



# THERMAL LIMIT CURVE



## Three Phase Induction Motor - Squirrel Cage

Customer :

Product line : NEMA Premium Efficiency Three-Phase  
 Product code : 11997252  
 Catalog # : 70018ET3G588/9-W22

Performance : 415 V 50 Hz 4P IE3

|                             |                                      |
|-----------------------------|--------------------------------------|
| Rated current : 764 A       | Moment of inertia (J) : 335 sq.ft.lb |
| LRC : 7.4                   | Duty cycle : Cont.(S1)               |
| Rated torque : 2110 ft.lb   | Insulation class : F                 |
| Locked rotor torque : 280 % | Service factor : 1.00                |
| Breakdown torque : 260 %    | Temperature rise : 80 K              |
| Rated speed : 1490 rpm      |                                      |

Heating constant

Cooling constant

| Rev.         | Changes Summary | Performed | Checked | Date     |
|--------------|-----------------|-----------|---------|----------|
|              |                 |           |         |          |
| Performed by |                 |           |         |          |
| Checked by   |                 |           | Page    | Revision |
| Date         | 13/04/2022      |           | 17 / 22 |          |

# THERMAL LIMIT CURVE

Three Phase Induction Motor - Squirrel Cage



Customer : \_\_\_\_\_

THERMAL LIMIT CURVE

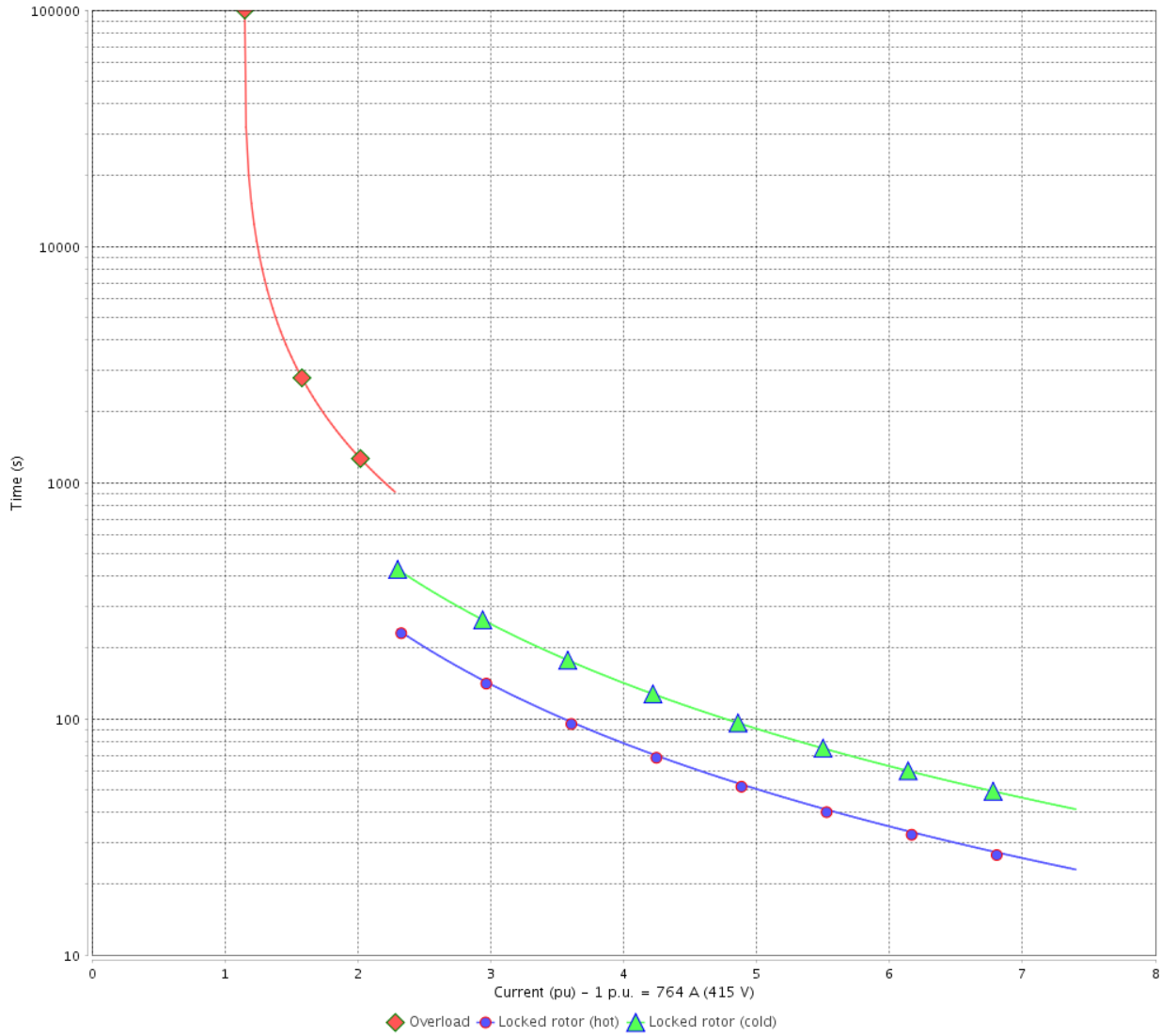

| Rev.         | Changes Summary | Performed  | Checked | Date     |
|--------------|-----------------|------------|---------|----------|
|              |                 |            |         |          |
| Performed by |                 | Page       |         | Revision |
| Checked by   |                 | 18 / 22    |         |          |
| Date         |                 | 13/04/2022 |         |          |

# VFD OPERATION CURVE

## Three Phase Induction Motor - Squirrel Cage



Customer :

Product line : NEMA Premium Efficiency Three-Phase  
 Product code : 11997252  
 Catalog # : 70018ET3G588/9-W22

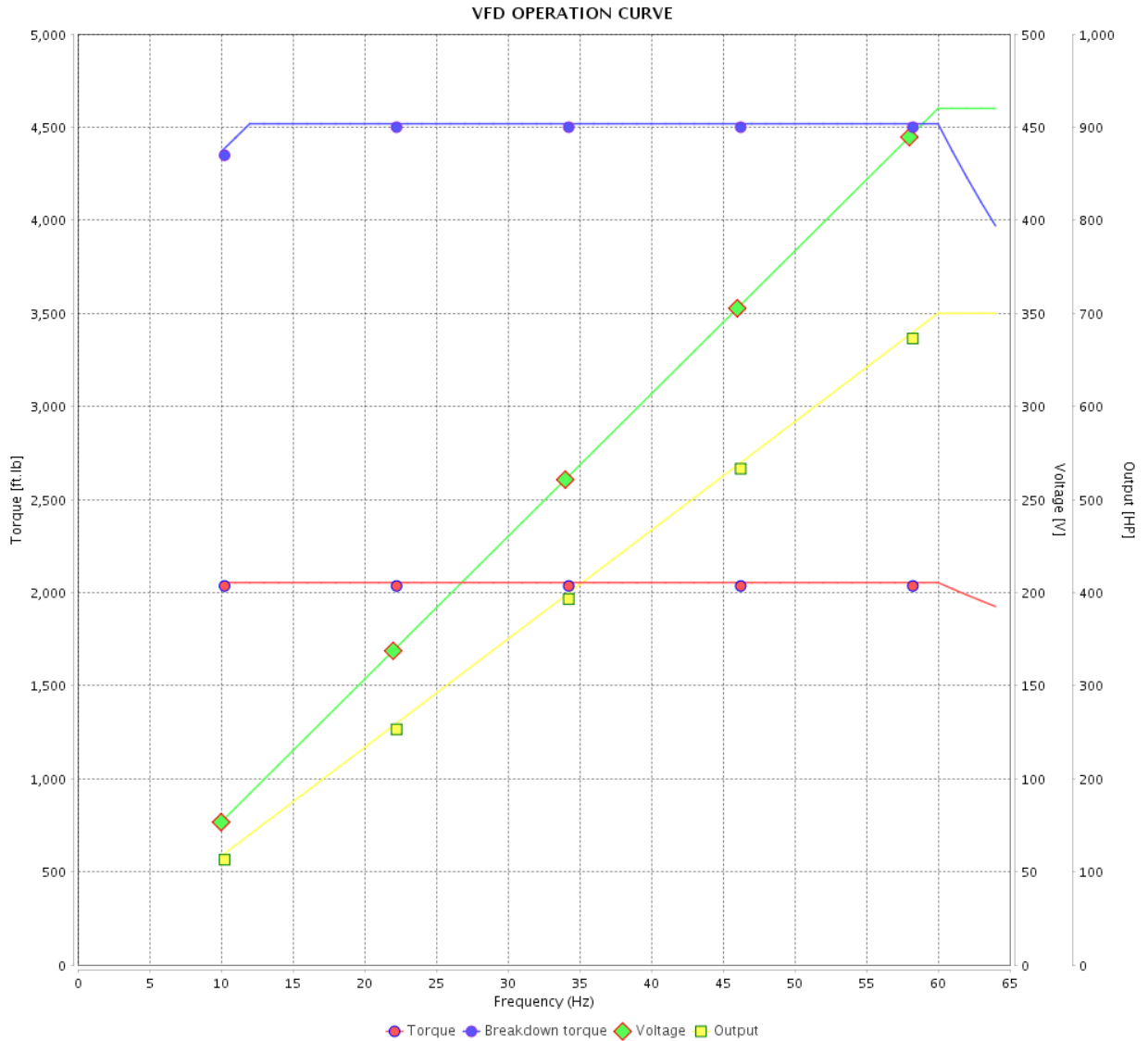

Performance : 460 V 60 Hz 4P

Rated current : 788 A  
 LRC : 6.5  
 Rated torque : 2050 ft.lb  
 Locked rotor torque : 250 %  
 Breakdown torque : 220 %  
 Rated speed : 1790 rpm

Moment of inertia (J) : 335 sq.ft.lb  
 Duty cycle : Cont.(S1)  
 Insulation class : F  
 Service factor : 1.00  
 Temperature rise : 80 K

| Rev.         | Changes Summary | Performed | Checked | Date     |
|--------------|-----------------|-----------|---------|----------|
|              |                 |           |         |          |
| Performed by |                 |           | Page    | Revision |
| Checked by   |                 |           | 19 / 22 |          |
| Date         | 13/04/2022      |           |         |          |

# VFD OPERATION CURVE

Three Phase Induction Motor - Squirrel Cage



Customer :

Product line : NEMA Premium Efficiency Three-Phase

Product code : 11997252

Catalog # : 70018ET3G588/9-W22

VFD OPERATION CURVE

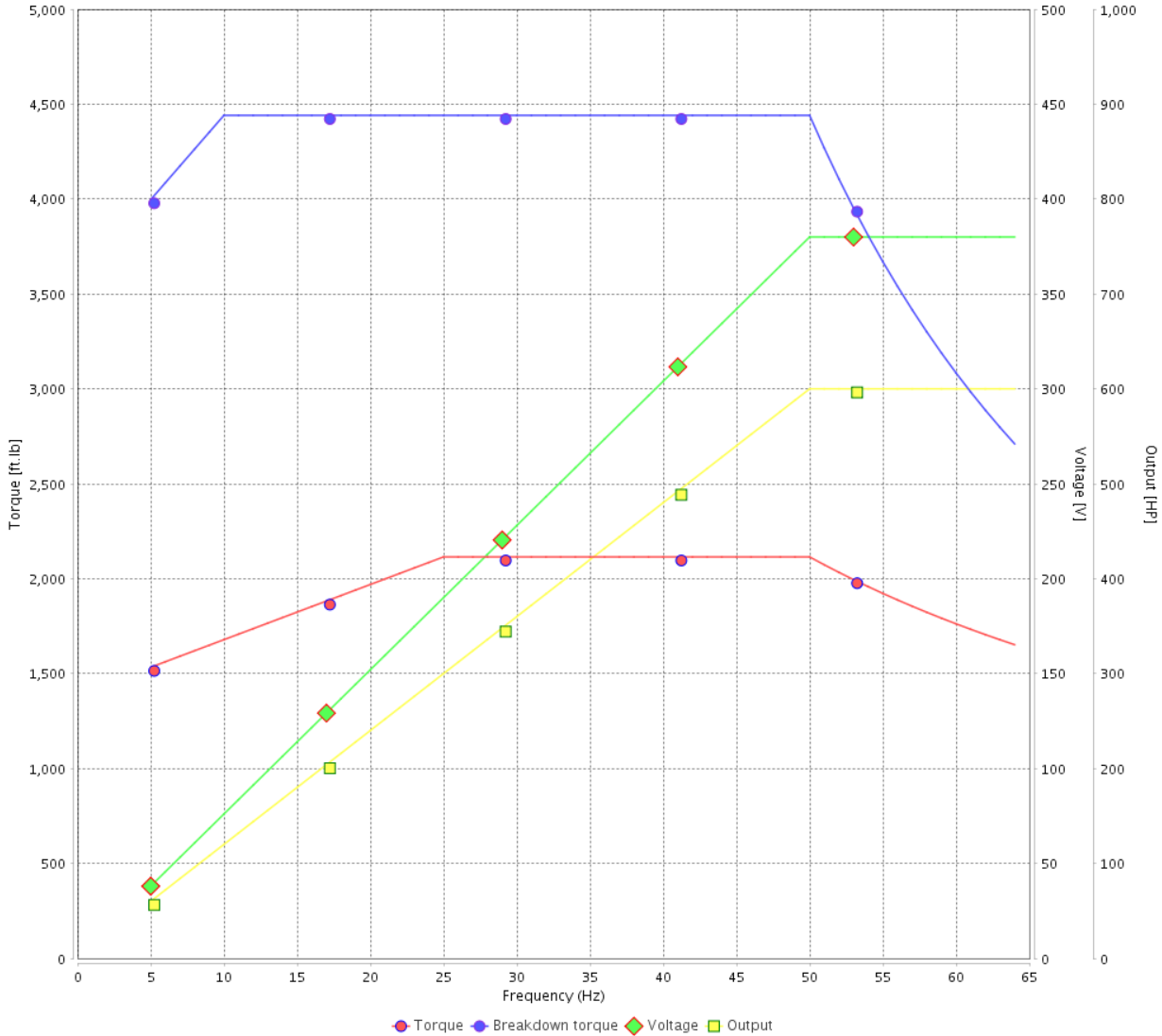

Performance : 380 V 50 Hz 4P IE3

Rated current : 815 A  
 LRC : 6.0  
 Rated torque : 2110 ft.lb  
 Locked rotor torque : 229 %  
 Breakdown torque : 210 %  
 Rated speed : 1490 rpm

Moment of inertia (J) : 335 sq.ft.lb  
 Duty cycle : Cont.(S1)  
 Insulation class : F  
 Service factor : 1.00  
 Temperature rise : 80 K

| Rev.         | Changes Summary | Performed | Checked | Date     |
|--------------|-----------------|-----------|---------|----------|
|              |                 |           |         |          |
| Performed by |                 |           | Page    | Revision |
| Checked by   |                 |           |         |          |
| Date         |                 |           |         |          |

# VFD OPERATION CURVE

## Three Phase Induction Motor - Squirrel Cage



Customer :

Product line : NEMA Premium Efficiency Three-Phase

Product code : 11997252

Catalog # : 70018ET3G588/9-W22

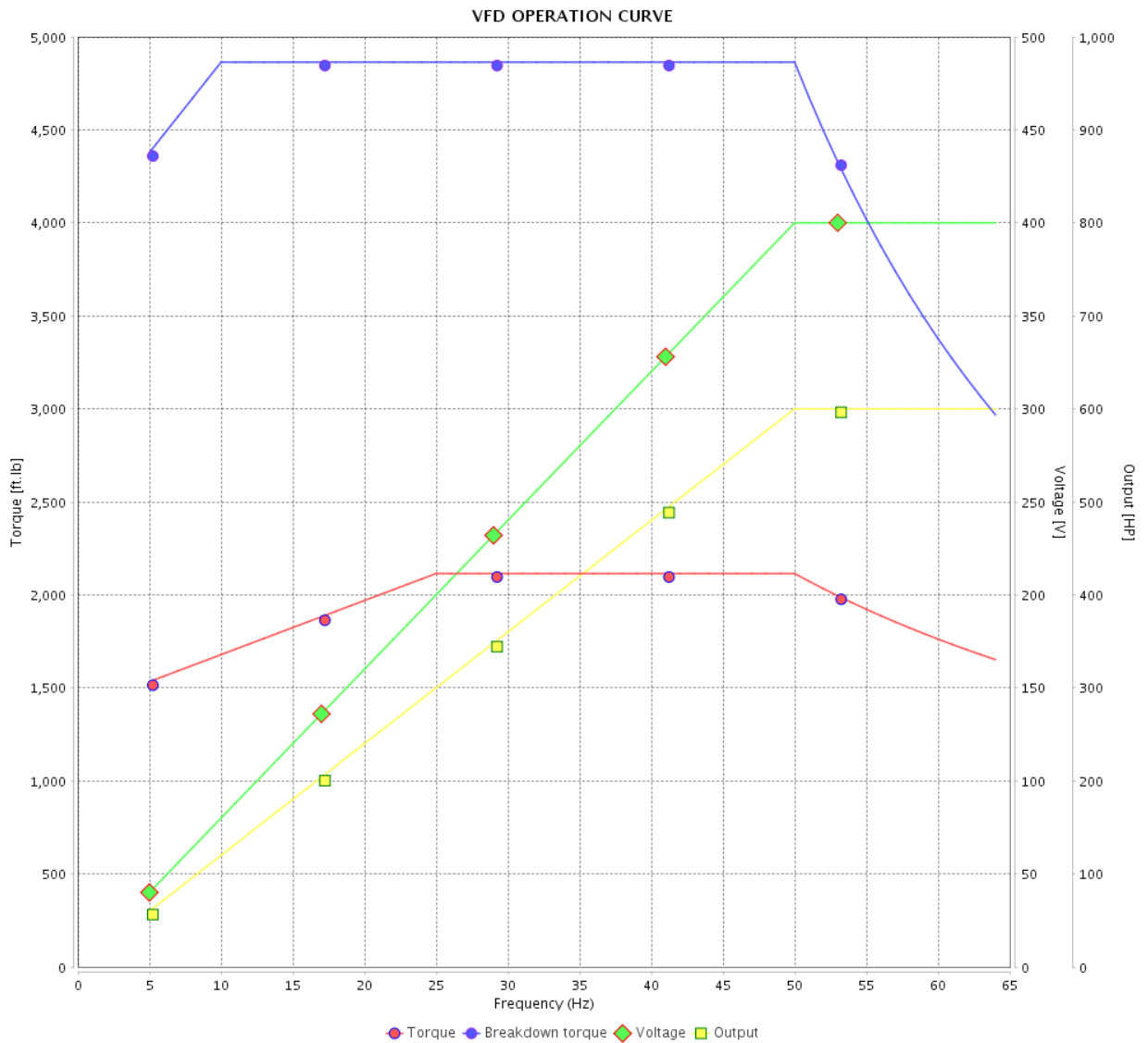

Performance : 400 V 50 Hz 4P IE3

Rated current : 783 A  
 LRC : 6.8  
 Rated torque : 2110 ft.lb  
 Locked rotor torque : 250 %  
 Breakdown torque : 229 %  
 Rated speed : 1490 rpm

Moment of inertia (J) : 335 sq.ft.lb  
 Duty cycle : Cont.(S1)  
 Insulation class : F  
 Service factor : 1.00  
 Temperature rise : 80 K

| Rev.         | Changes Summary | Performed | Checked | Date     |
|--------------|-----------------|-----------|---------|----------|
|              |                 |           |         |          |
| Performed by |                 |           | Page    | Revision |
| Checked by   |                 |           |         |          |
| Date         |                 |           |         |          |

# VFD OPERATION CURVE

Three Phase Induction Motor - Squirrel Cage



Customer :

Product line : NEMA Premium Efficiency Three-Phase

Product code : 11997252

Catalog # : 70018ET3G588/9-W22

VFD OPERATION CURVE

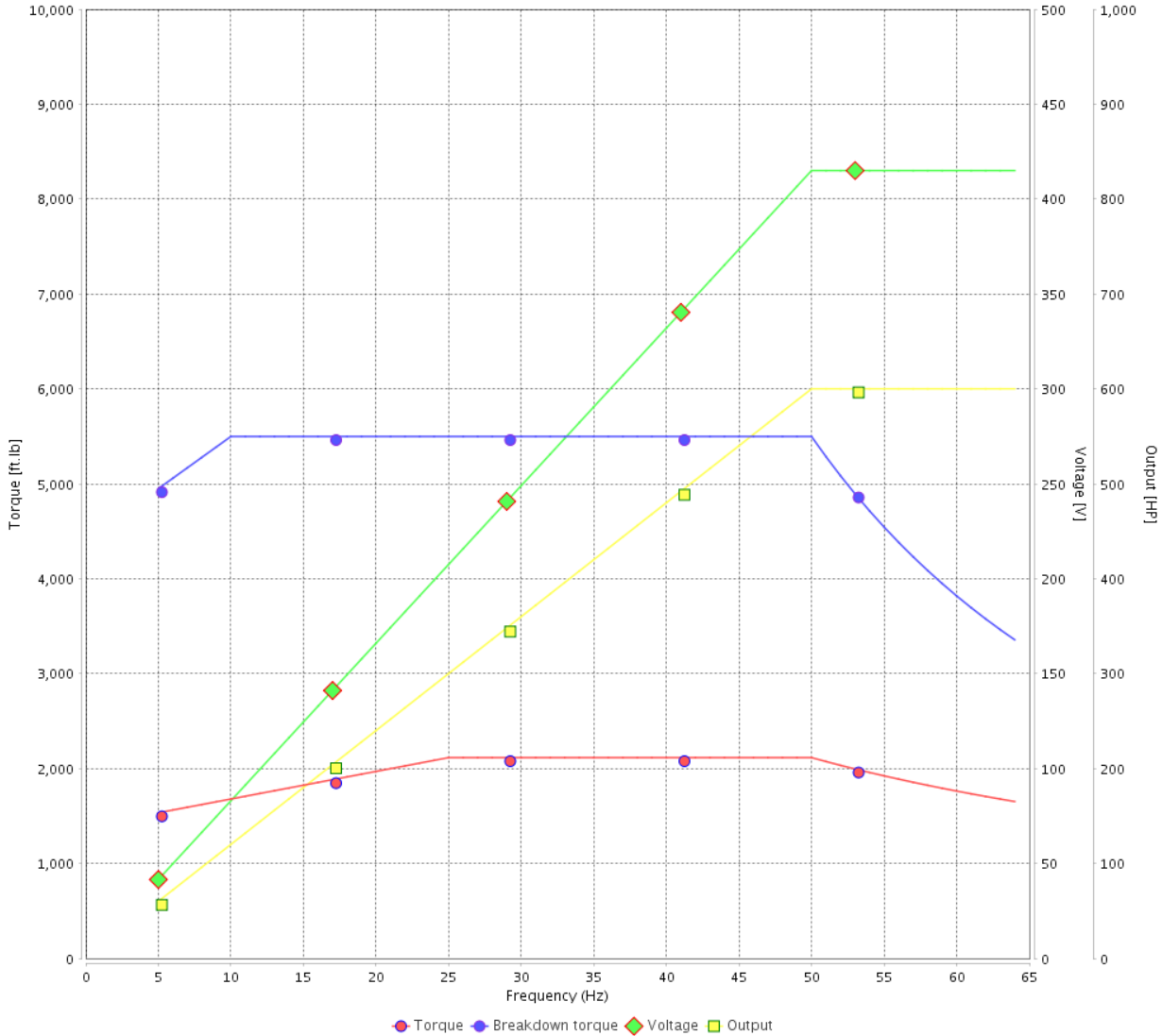

Performance : 415 V 50 Hz 4P IE3

Rated current : 764 A  
 LRC : 7.4  
 Rated torque : 2110 ft.lb  
 Locked rotor torque : 280 %  
 Breakdown torque : 260 %  
 Rated speed : 1490 rpm

Moment of inertia (J) : 335 sq.ft.lb  
 Duty cycle : Cont.(S1)  
 Insulation class : F  
 Service factor : 1.00  
 Temperature rise : 80 K

| Rev.         | Changes Summary | Performed | Checked | Date     |
|--------------|-----------------|-----------|---------|----------|
|              |                 |           |         |          |
| Performed by |                 |           | Page    | Revision |
| Checked by   |                 |           |         |          |
| Date         |                 |           |         |          |

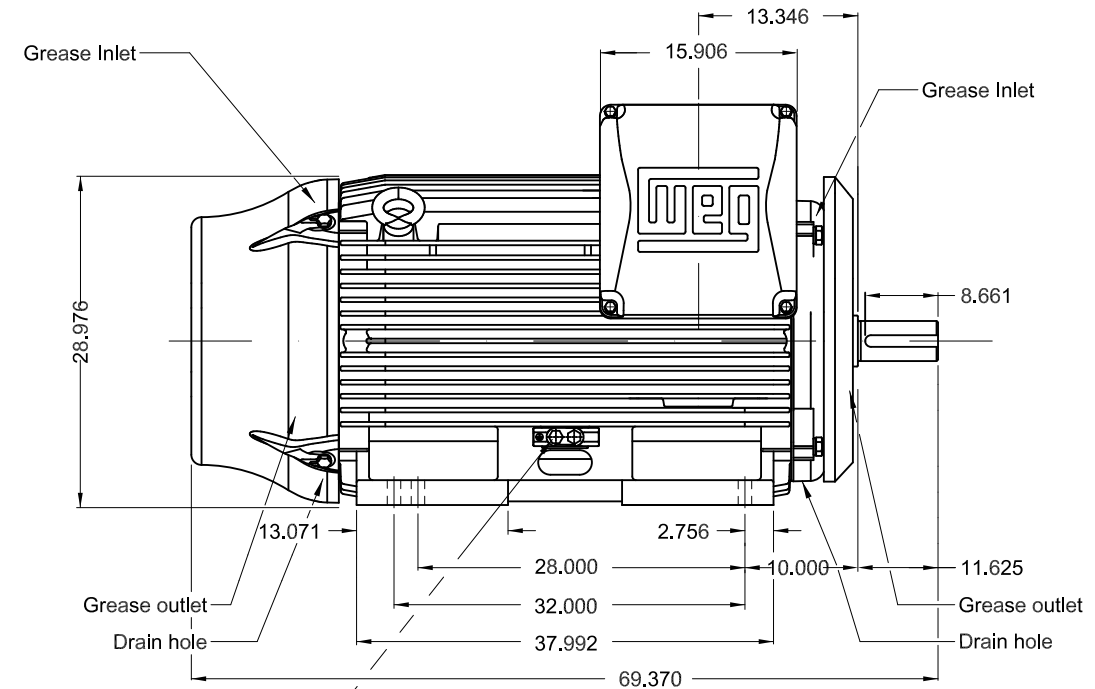
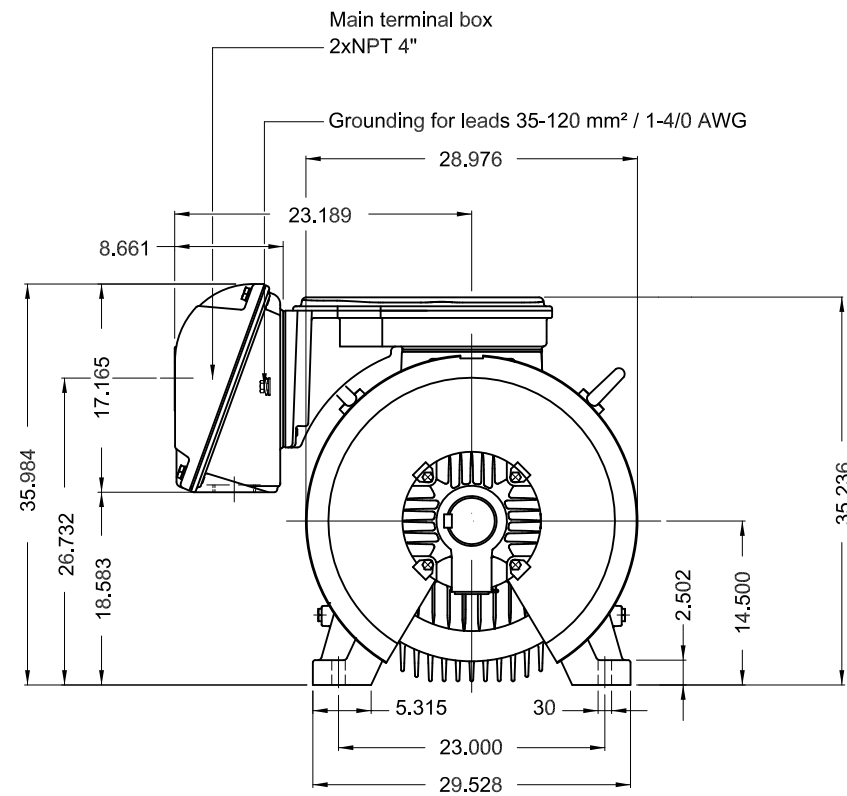

Grounding for leads 25-185 mm² / 3AWG-350MCM

700 HP 04 Poles 60 Hz

Dimensions in inches

- Without vertical jackscrews
- NDE endshield with electrically insulated bearing hub
- Drive-End Air Deflector
- Color RAL 5009
- Painting plan 203A
- Mounting B3R(D)

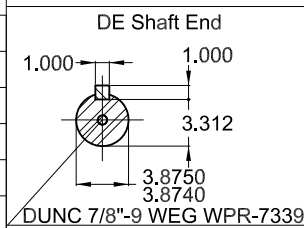

| ECM      | LOC       | SUMMARY OF MODIFICATIONS                                 | EXECUTED       | CHECKED             | RELEASED | DATE  | VER |
|----------|-----------|--|----------------|---------------------|----------|-------|-----|
| EXECUTED | PIRWBUSER | THREE PH. MOTOR W22 PREM. EFF.<br>FRAME 588/9T IP55 TEFC |                |                     |          |       |     |
| CHECKED  |           |  |                |                     |          |       |     |
| RELEASED |           |  |                |                     |          |       |     |
| REL DT.  | WMO       |  | Jaragua do Sul | Product Engineering | SHEET    | 1 / 1 |     |

**PREVIEW**  
WDD

