

DATA SHEET



Three Phase Induction Motor - Squirrel Cage

Customer :				
Product line	: NEMA Premium Efficiency Three-Phase			
Product code :	12088976			
Catalog # :	70036ET3G588/9S-W22			
Frame : 588/9TS Output : 700 HP (515.20 kW) Poles : 2 Frequency : 60 Hz Rated voltage : 460 V Rated current : 736 A L. R. Amperes : 5299 A LRC : 7.2x(Code G) No load current : 155 A Rated speed : 3585 rpm Slip : 0.42 % Rated torque : 1030 ft.lb Locked rotor torque : 229 % Breakdown torque : 250 % Insulation class : F Service factor : 1.00	Locked rotor time : 61s (cold) 34s (hot) Temperature rise : 105 K Duty cycle : Cont.(S1) Ambient temperature : -20°C to +40°C Altitude : 1000 m.a.s.l. Protection degree : IP55 Cooling method : IC411 - TEFC Mounting : F-1 Rotation ¹ : Both (CW and CCW) Noise level ² : 89.0 dB(A) Starting method : Direct On Line Approx. weight ³ : 5321 lb			
Output	25% 50% 75% 100%			
Efficiency (%)	0.000 96.2 96.6 96.6			
Power Factor	0.00 0.86 0.90 0.91			
Foundation loads				
Max. traction	: 2688 lb			
Max. compression	: 8008 lb			
Bearing type	: <u>Drive end</u> 6314 C3 <u>Non drive end</u> 6314 C3			
Sealing	: Taconite Labyrinth Taconite Labyrinth			
Lubrication interval	: 4000 h 4000 h			
Lubricant amount	: 27 g 27 g			
Lubricant type	: Mobil Polyrex EM			
Notes				
This revision replaces and cancel the previous one, which must be eliminated. (1) Looking the motor from the shaft end. (2) Measured at 1m and with tolerance of +3dB(A). (3) Approximate weight subject to changes after manufacturing process. (4) At 100% of full load.				
These are average values based on tests with sinusoidal power supply, subject to the tolerances stipulated in NEMA MG-1.				
Rev.	Changes Summary	Performed	Checked	Date
Performed by				
Checked by			Page	Revision
Date	13/04/2022		1 / 7	

DATA SHEET

Three Phase Induction Motor - Squirrel Cage



Customer : _____

Space heater information

Voltage: 200 - 240 V

Rev.	Changes Summary	Performed	Checked	Date
Performed by				
Checked by			Page	Revision
Date	13/04/2022		2 / 7	

TORQUE AND CURRENT VS SPEED CURVE



Three Phase Induction Motor - Squirrel Cage

Customer :

Product line : NEMA Premium Efficiency Three-Phase

Product code : 12088976

Catalog # : 70036ET3G588/9S-W22

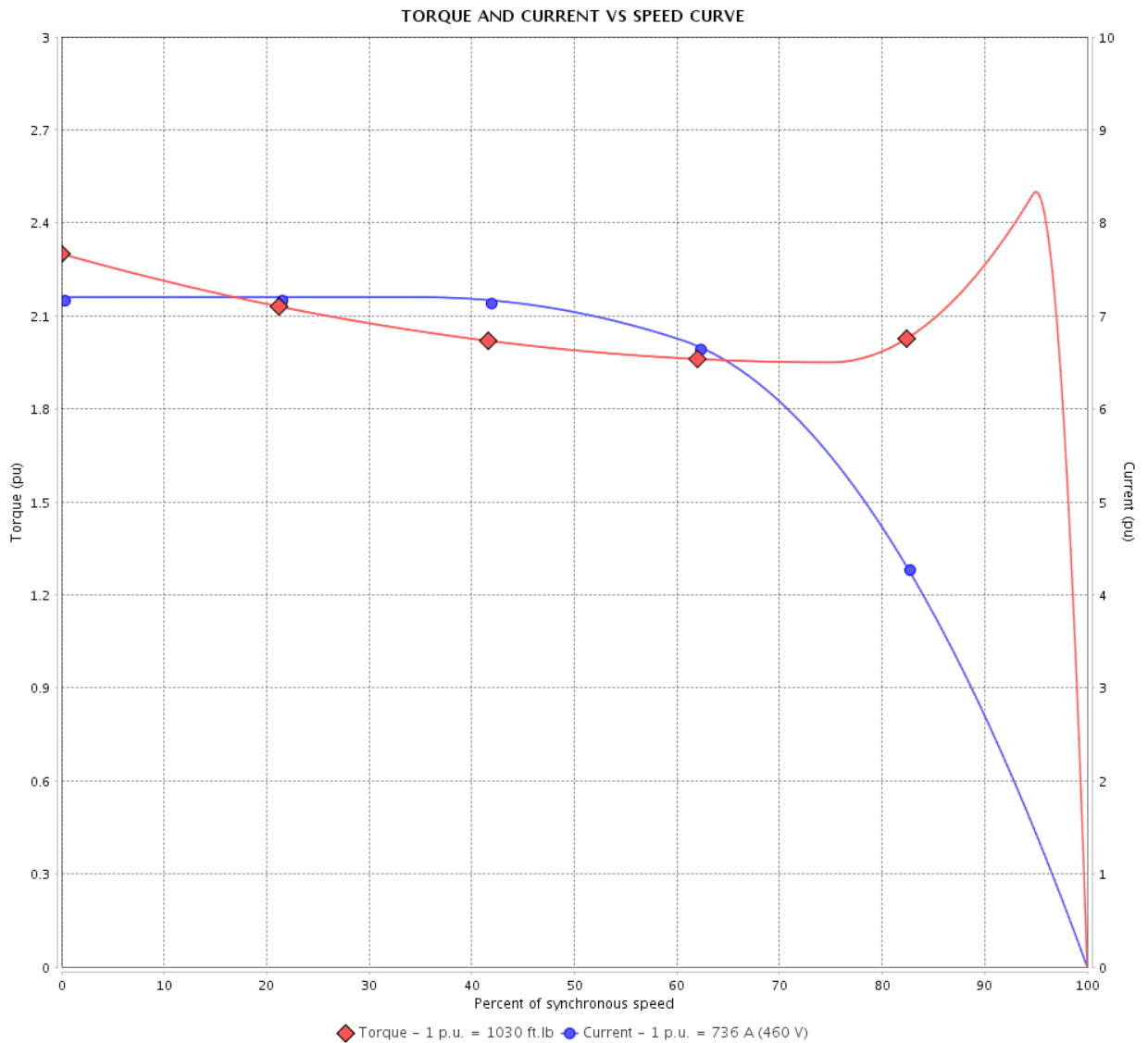

Performance : 460 V 60 Hz 2P

Rated current : 736 A
 LRC : 7.2
 Rated torque : 1030 ft.lb
 Locked rotor torque : 229 %
 Breakdown torque : 250 %
 Rated speed : 3585 rpm

Moment of inertia (J)
 Duty cycle : Cont.(S1)
 Insulation class : F
 Service factor : 1.00
 Temperature rise : 105 K

Locked rotor time : 61s (cold) 34s (hot)

Rev.	Changes Summary	Performed	Checked	Date
Performed by			Page 3 / 7	Revision
Checked by				
Date	13/04/2022			

LOAD PERFORMANCE CURVE

Three Phase Induction Motor - Squirrel Cage



Customer :

Product line : NEMA Premium Efficiency Three-Phase

Product code : 12088976

Catalog # : 70036ET3G588/9S-W22

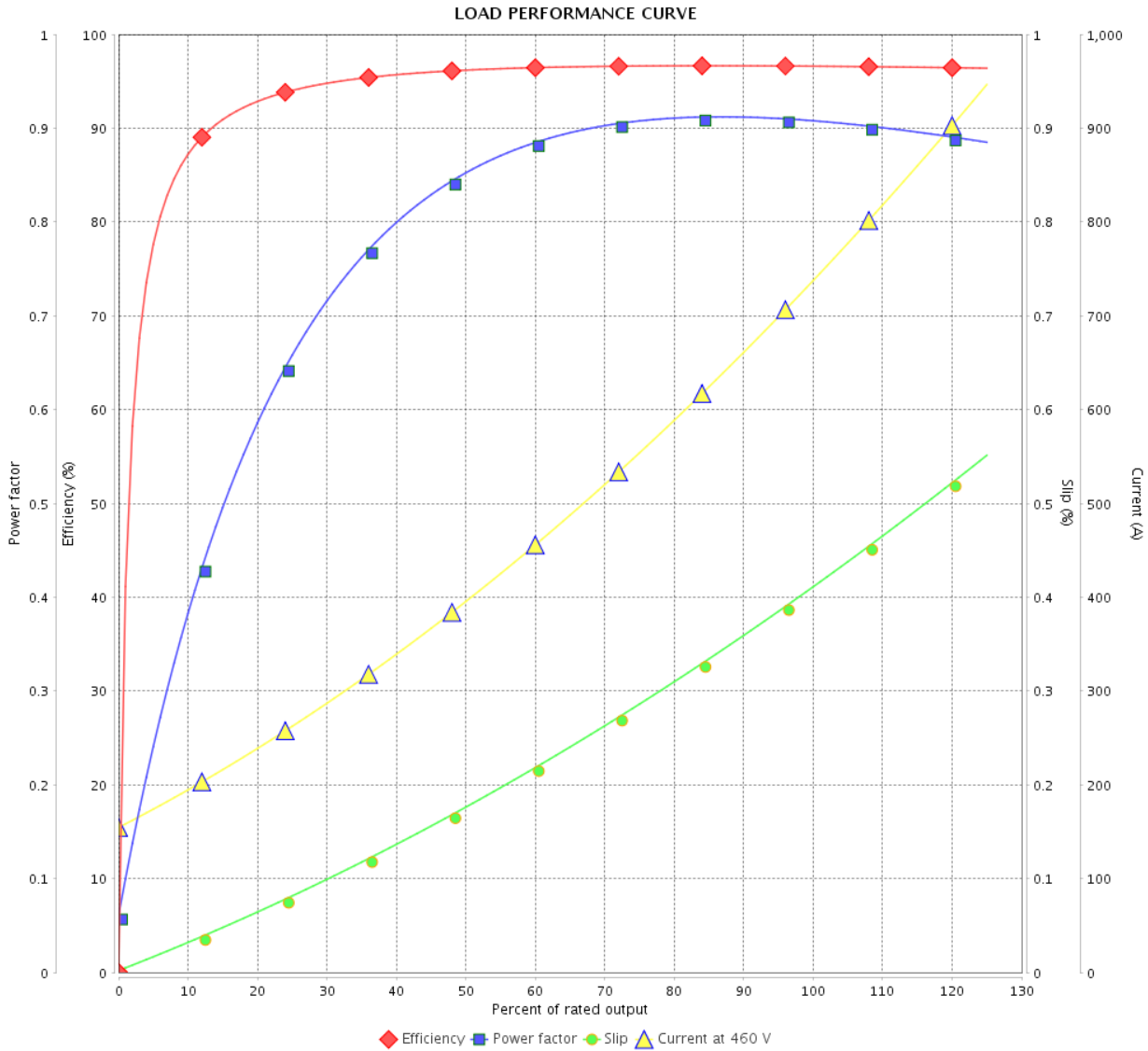

Performance : 460 V 60 Hz 2P

Rated current : 736 A
 LRC : 7.2
 Rated torque : 1030 ft.lb
 Locked rotor torque : 229 %
 Breakdown torque : 250 %
 Rated speed : 3585 rpm

Moment of inertia (J)
 Duty cycle : Cont.(S1)
 Insulation class : F
 Service factor : 1.00
 Temperature rise : 105 K

Rev.	Changes Summary	Performed	Checked	Date
Performed by			Page	Revision
Checked by				
Date				

THERMAL LIMIT CURVE



Three Phase Induction Motor - Squirrel Cage

Customer :

Product line : NEMA Premium Efficiency Three-Phase
 Product code : 12088976
 Catalog # : 70036ET3G588/9S-W22

Performance : 460 V 60 Hz 2P

Rated current : 736 A	Moment of inertia (J)
LRC : 7.2	Duty cycle : Cont.(S1)
Rated torque : 1030 ft.lb	Insulation class : F
Locked rotor torque : 229 %	Service factor : 1.00
Breakdown torque : 250 %	Temperature rise : 105 K
Rated speed : 3585 rpm	

Heating constant

Cooling constant

Rev.	Changes Summary	Performed	Checked	Date
Performed by				
Checked by			Page	Revision
Date	13/04/2022		5 / 7	

THERMAL LIMIT CURVE

Three Phase Induction Motor - Squirrel Cage



Customer : _____

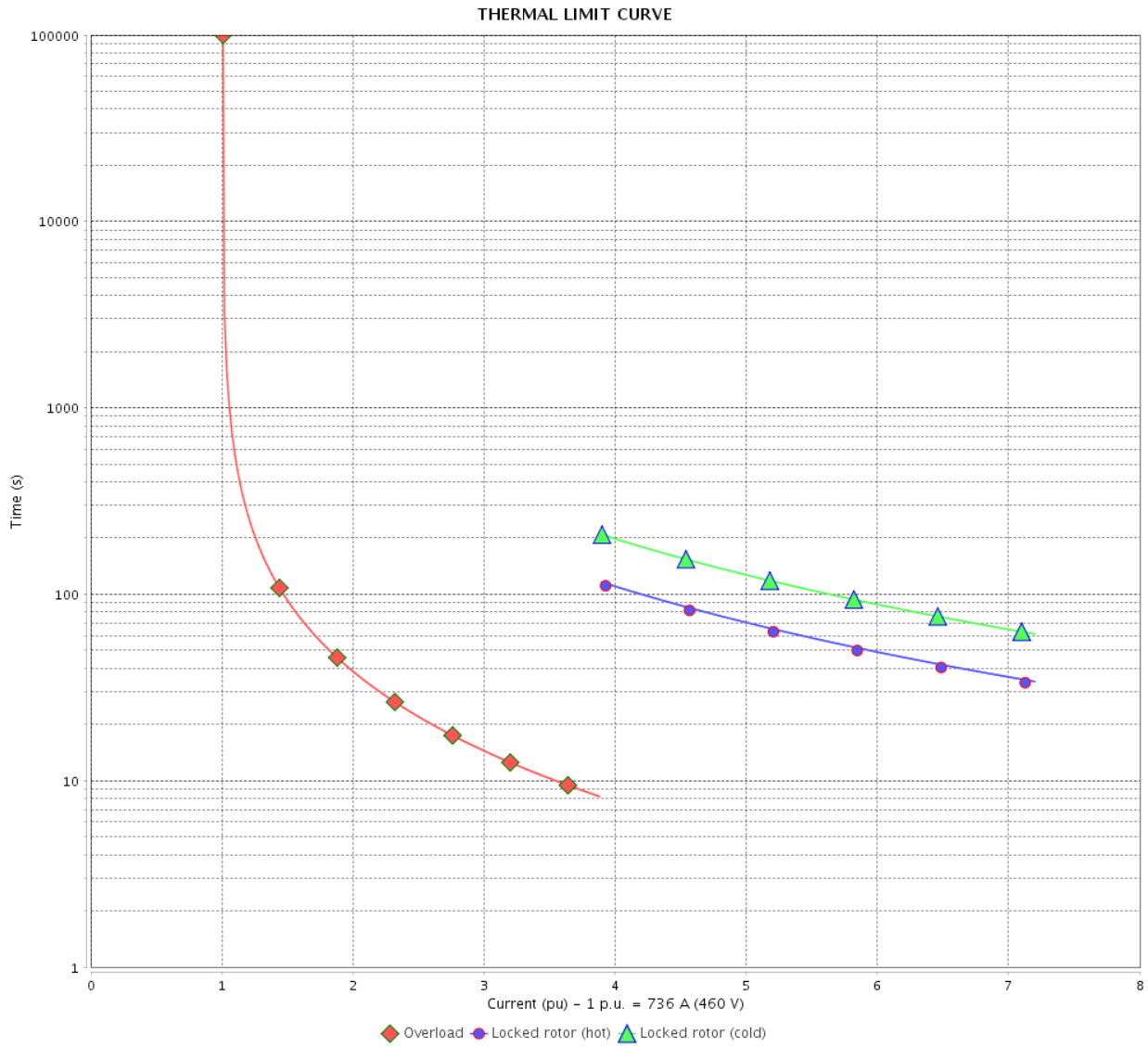

Rev.	Changes Summary	Performed	Checked	Date
Performed by		Page 6 / 7		Revision
Checked by				
Date				

VFD OPERATION CURVE

Three Phase Induction Motor - Squirrel Cage



Customer :

Product line : NEMA Premium Efficiency Three-Phase

Product code : 12088976

Catalog # : 70036ET3G588/9S-W22

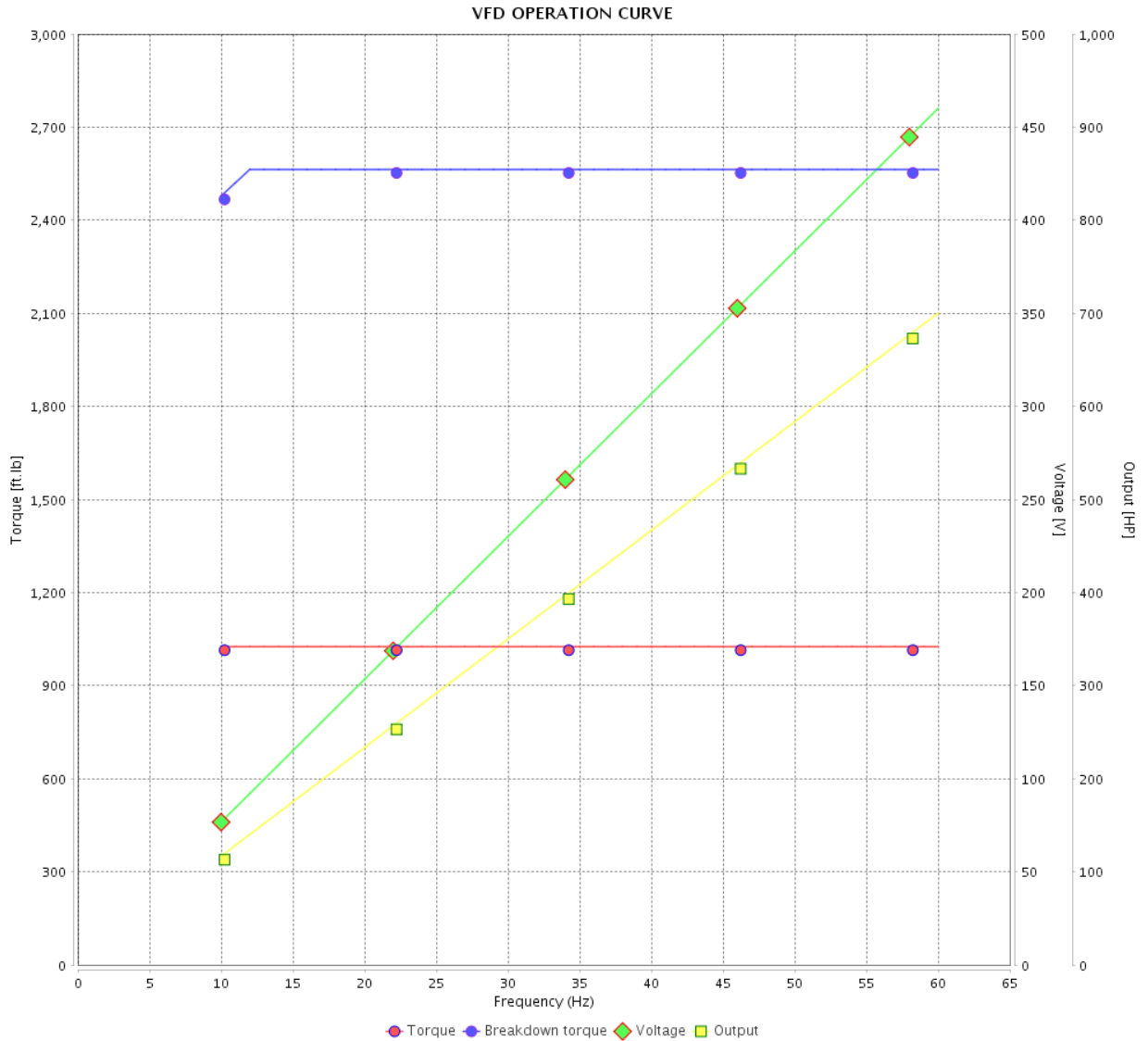

Performance : 460 V 60 Hz 2P

Rated current : 736 A
 LRC : 7.2
 Rated torque : 1030 ft.lb
 Locked rotor torque : 229 %
 Breakdown torque : 250 %
 Rated speed : 3585 rpm

Moment of inertia (J)
 Duty cycle : Cont.(S1)
 Insulation class : F
 Service factor : 1.00
 Temperature rise : 105 K

Rev.	Changes Summary	Performed	Checked	Date
Performed by			Page 7 / 7	Revision
Checked by				
Date	13/04/2022			

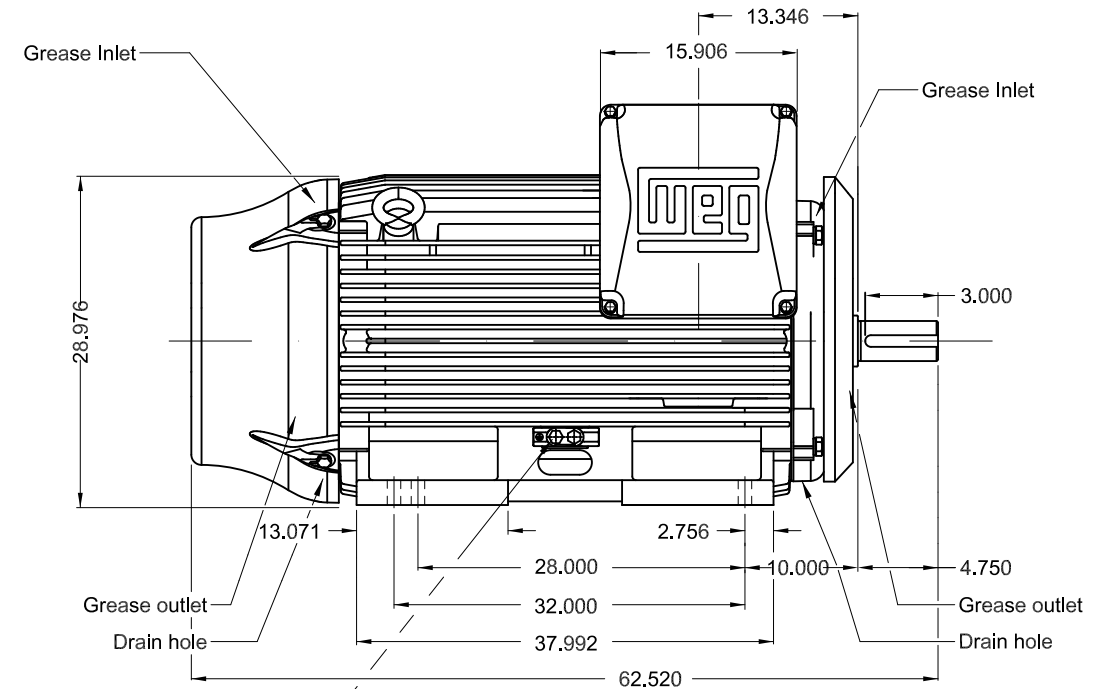
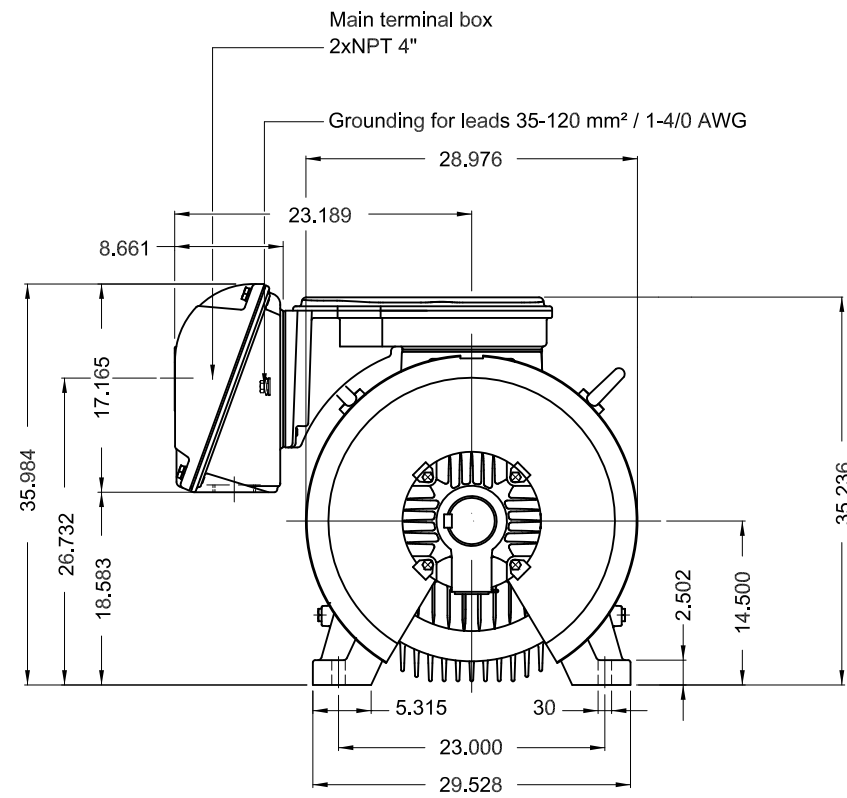

Grounding for leads 25-185 mm² / 3AWG-350MCM

700 HP 02 Poles 60 Hz

A

- Without vertical jackscrews
- NDE endshield with electrically insulated bearing hub
- Drive-End Air Deflector
- Color RAL 5009
- Painting plan 203A
- Mounting NEMA F-1
- Mounting B3R(D)

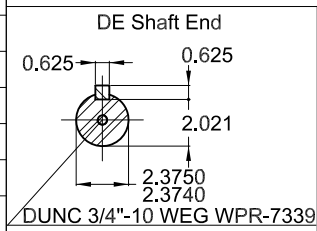

ECM	LOC	SUMMARY OF MODIFICATIONS	EXECUTED	CHECKED	RELEASED	DATE	VER
EXECUTED	PIRWBUSER	THREE PH. MOTOR W22 PREM. EFF.					
CHECKED		FRAME 588/9TS IP55 TEFC					
RELEASED							
REL DT.	WMO	Jaragua do Sul	Product Engineering				

PREVIEW
WDD



SHEET 1 / 1

Dimensions in inches XME A3

MADE IN BRAZIL
12088976



NEMA
Premium
W22



FOR SAFE AREA
Mod.TE1BFOXON



Class I, Div 2, Gr A, B, C and D - T2C
Class I, Zone 2, IIC - T2C
Class II, Div 2, Gr F and G - T4

MODEL 70036ET3G588/9S-W22

Electric Motor
Severe Duty

PH3 60Hz Fr. 588/9TS 1000m.a.s.l. IP55 TEFC 5364lb

V 460

A 736

HP 700

kW 515.2

SF 1.00

SFA -

RPM 3585

PF 0.91

AMB 40°C

INS cl. F

NEMA NOM EFF 96.6%

DUTY CONT.

DES - Code G

PART-WINDING

WYE-DELTA

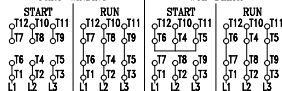

→ 6314-C3 (27g)

→ 6314-C3 (27g)

MOBIL POLYREX EM (4000h)

