

DATA SHEET

Three Phase Induction Motor - Squirrel Cage



Customer :				
Product line	: Premium Efficiency Three-Phase	Product code :	12809251	
		Catalog # :	.7512OT3E56C-S	
Frame	: 56HC	Cooling method	: IC01 - ODP	
Insulation class	: F	Mounting	: F-1	
Duty cycle	: Cont.(S1)	Rotation ¹	: Both (CW and CCW)	
Ambient temperature	: -20°C to +40°C	Starting method	: Direct On Line	
Altitude	: 1000 m.a.s.l.	Approx. weight ²	: 36.1 lb	
Design	: A	Moment of inertia (J)	: 0.1685 sq.ft.lb	
Output [HP]	0.75	0.75	0.75	
Poles	6	6	6	
Frequency [Hz]	60	50	50	
Rated voltage [V]	208-230/460	190/380	220/415	
Rated current [A]	2.78-2.52/1.26	2.86/1.43	2.64/1.40	
L. R. Amperes [A]	16.4-14.9/7.43	13.2/6.58	13.2/7.00	
LRC [A]	5.9x(Code J)	4.6x(Code G)	5.0x(Code H)	
No load current [A]	1.55-1.79/0.896	1.77/0.886	1.78/0.943	
Rated speed [RPM]	1160	945	950	
Slip [%]	3.33	5.50	5.00	
Rated torque [ft.lb]	3.40	4.17	4.15	
Locked rotor torque [%]	220	170	200	
Breakdown torque [%]	280	229	260	
Service factor		1.15	1.15	
Temperature rise	80 K	80 K	80 K	
Locked rotor time	59s (cold) 33s (hot)	64s (cold) 36s (hot)	57s (cold) 32s (hot)	
Noise level ²	50.0 dB(A)	48.0 dB(A)	48.0 dB(A)	
Efficiency (%)	25%	73.7	75.9	
	50%	75.5	76.2	
	75%	80.0	78.9	
	100%	81.7	78.7	
Power Factor	25%	0.25	0.27	
	50%	0.45	0.49	
	75%	0.58	0.63	
	100%	0.67	0.72	
Bearing type	: Drive end 6204 ZZ Non drive end 6202 ZZ	Foundation loads		
Sealing	: Without Without Bearing Seal Bearing Seal	Max. traction	: 88 lb	
		Max. compression	: 124 lb	
Lubrication interval	: - -			
Lubricant amount	: - -			
Lubricant type	: Mobil Polyrex EM			
Notes USABLE @208V SF 1.00				
This revision replaces and cancel the previous one, which must be eliminated. (1) Looking the motor from the shaft end. (2) Measured at 1m and with tolerance of +3dB(A). (3) Approximate weight subject to changes after manufacturing process. (4) At 100% of full load.		These are average values based on tests with sinusoidal power supply, subject to the tolerances stipulated in NEMA MG-1.		
Rev.	Changes Summary	Performed	Checked	Date
Performed by				
Checked by			Page	Revision
Date	11/04/2022		1 / 10	

TORQUE AND CURRENT VS SPEED CURVE

Three Phase Induction Motor - Squirrel Cage



Customer :

Product line : Premium Efficiency Three-Phase Product code : 12809251
 Catalog # : .7512OT3E56C-S

TORQUE AND CURRENT VS SPEED CURVE

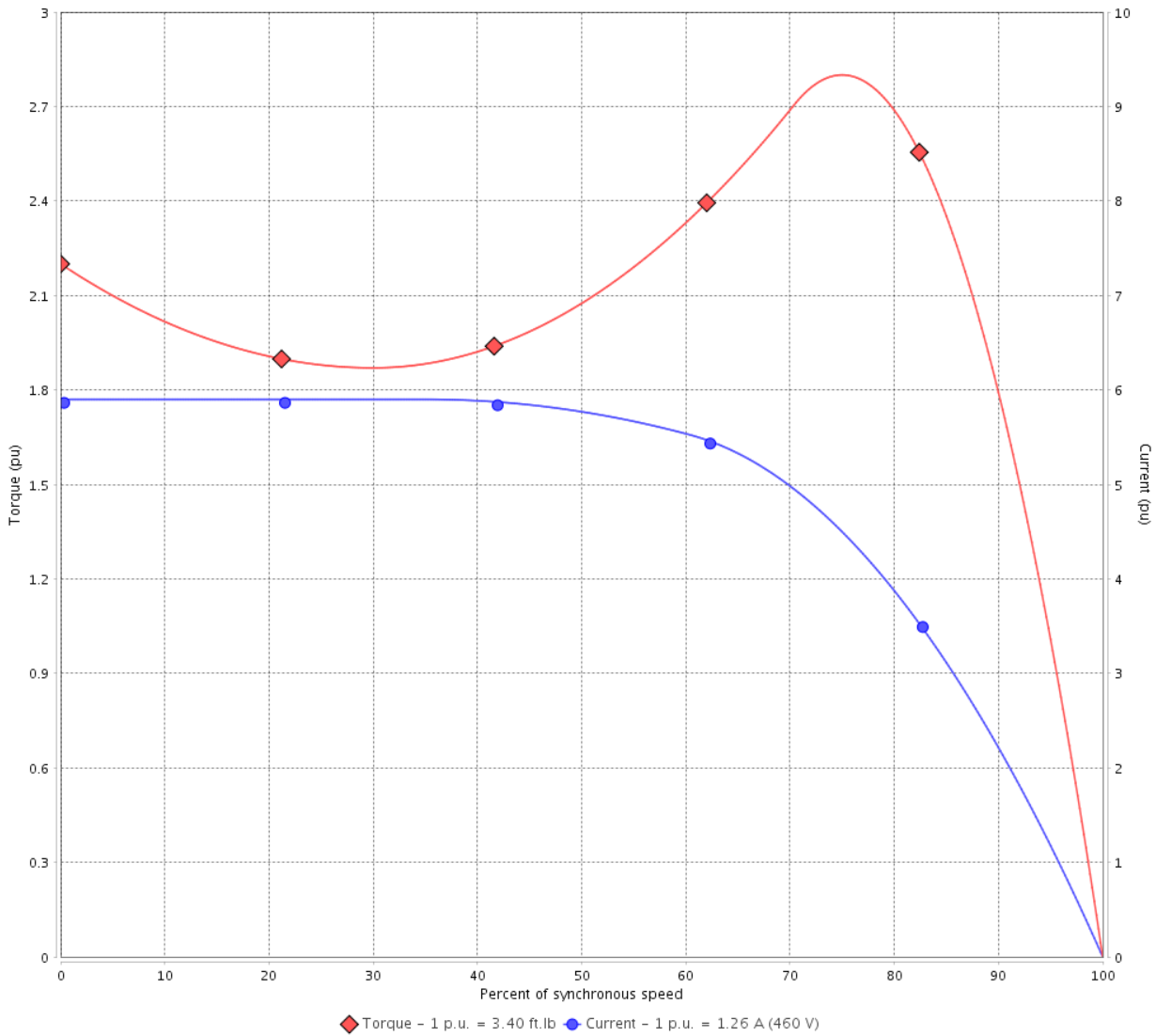

Performance : 208-230/460 V 60 Hz 6P

Rated current	: 2.78-2.52/1.26 A	Moment of inertia (J)	: 0.1685 sq.ft.lb
LRC	: 5.9	Duty cycle	: Cont.(S1)
Rated torque	: 3.40 ft.lb	Insulation class	: F
Locked rotor torque	: 220 %	Service factor	:
Breakdown torque	: 280 %	Temperature rise	: 80 K
Rated speed	: 1160 rpm	Design	: A

Locked rotor time : 59s (cold) 33s (hot)

Rev.	Changes Summary	Performed	Checked	Date
Performed by			Page 2 / 10	Revision
Checked by				
Date	11/04/2022			

TORQUE AND CURRENT VS SPEED CURVE

Three Phase Induction Motor - Squirrel Cage



Customer :

Product line : Premium Efficiency Three-Phase

Product code :

12809251

Catalog # :

.75120T3E56C-S

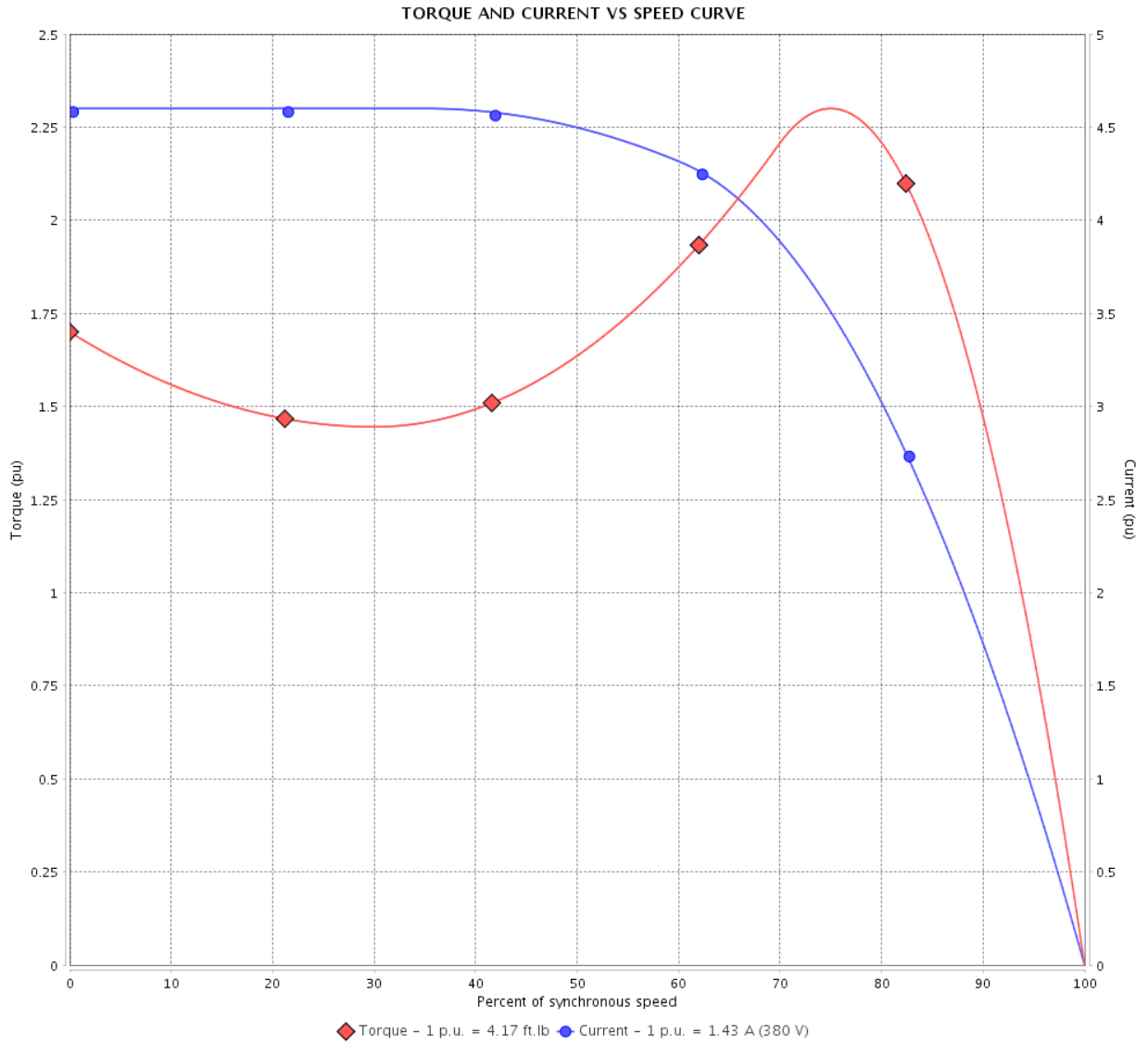

Performance : 190/380 V 50 Hz 6P

Rated current : 2.86/1.43 A
 LRC : 4.6
 Rated torque : 4.17 ft.lb
 Locked rotor torque : 170 %
 Breakdown torque : 229 %
 Rated speed : 945 rpm

Moment of inertia (J) : 0.1685 sq.ft.lb
 Duty cycle : Cont.(S1)
 Insulation class : F
 Service factor : 1.15
 Temperature rise : 80 K
 Design : A

Locked rotor time : 64s (cold) 36s (hot)

Rev.	Changes Summary	Performed	Checked	Date
Performed by			Page 3 / 10	Revision
Checked by				
Date	11/04/2022			

TORQUE AND CURRENT VS SPEED CURVE

Three Phase Induction Motor - Squirrel Cage



Customer :

Product line : Premium Efficiency Three-Phase Product code : 12809251
 Catalog # : .7512OT3E56C-S

TORQUE AND CURRENT VS SPEED CURVE

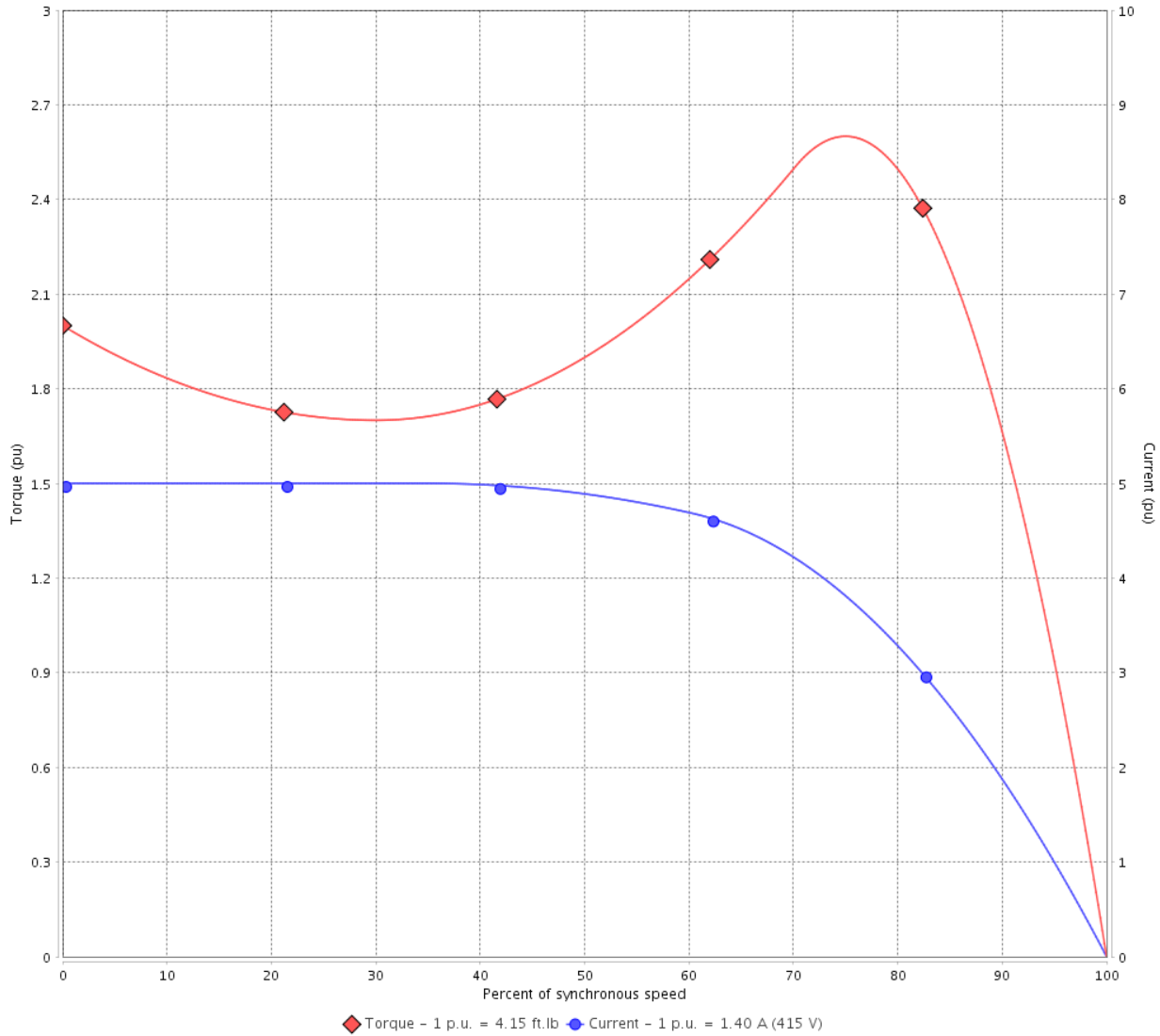

Performance : 220/415 V 50 Hz 6P

Rated current	: 2.64/1.40 A	Moment of inertia (J)	: 0.1685 sq.ft.lb
LRC	: 5.0	Duty cycle	: Cont.(S1)
Rated torque	: 4.15 ft.lb	Insulation class	: F
Locked rotor torque	: 200 %	Service factor	: 1.15
Breakdown torque	: 260 %	Temperature rise	: 80 K
Rated speed	: 950 rpm	Design	: A

Locked rotor time : 57s (cold) 32s (hot)

Rev.	Changes Summary	Performed	Checked	Date
Performed by			Page 4 / 10	Revision
Checked by				
Date	11/04/2022			

LOAD PERFORMANCE CURVE

Three Phase Induction Motor - Squirrel Cage



Customer :

Product line : Premium Efficiency Three-Phase

Product code :

12809251

Catalog # :

.75120T3E56C-S

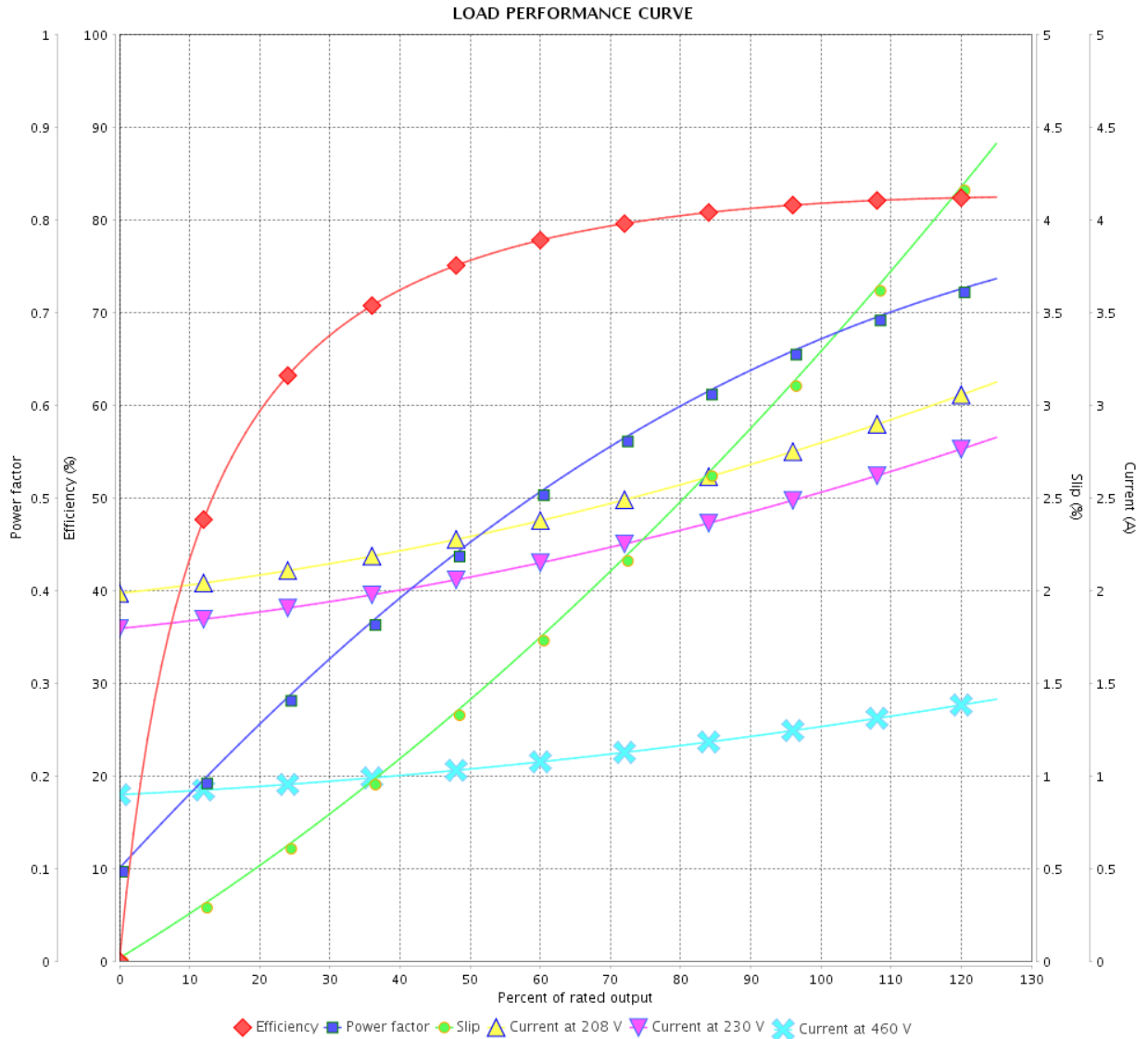

Performance : 208-230/460 V 60 Hz 6P

Rated current : 2.78-2.52/1.26 A
 LRC : 5.9
 Rated torque : 3.40 ft.lb
 Locked rotor torque : 220 %
 Breakdown torque : 280 %
 Rated speed : 1160 rpm

Moment of inertia (J) : 0.1685 sq.ft.lb
 Duty cycle : Cont.(S1)
 Insulation class : F
 Service factor :
 Temperature rise : 80 K
 Design : A

Rev.	Changes Summary	Performed	Checked	Date
Performed by			Page	Revision
Checked by				
Date				

LOAD PERFORMANCE CURVE

Three Phase Induction Motor - Squirrel Cage



Customer :

Product line : Premium Efficiency Three-Phase Product code : 12809251
 Catalog # : .7512OT3E56C-S

LOAD PERFORMANCE CURVE

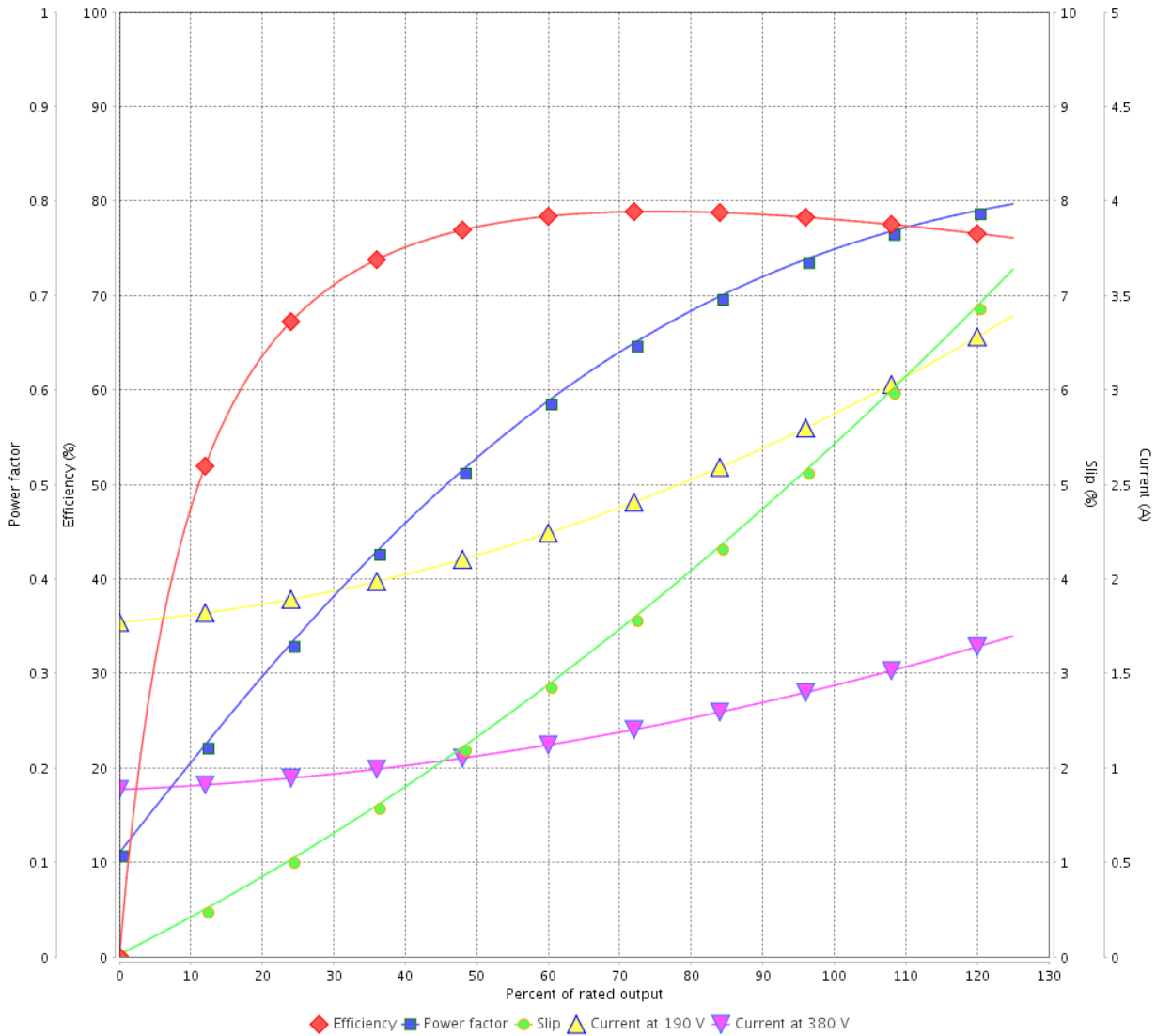

Performance : 190/380 V 50 Hz 6P

Rated current	: 2.86/1.43 A	Moment of inertia (J)	: 0.1685 sq.ft.lb
LRC	: 4.6	Duty cycle	: Cont.(S1)
Rated torque	: 4.17 ft.lb	Insulation class	: F
Locked rotor torque	: 170 %	Service factor	: 1.15
Breakdown torque	: 229 %	Temperature rise	: 80 K
Rated speed	: 945 rpm	Design	: A

Rev.	Changes Summary	Performed	Checked	Date
Performed by			Page	Revision
Checked by			6 / 10	
Date	11/04/2022			

LOAD PERFORMANCE CURVE

Three Phase Induction Motor - Squirrel Cage



Customer : _____

Product line : Premium Efficiency Three-Phase

Product code :

12809251

Catalog # :

.7512OT3E56C-S

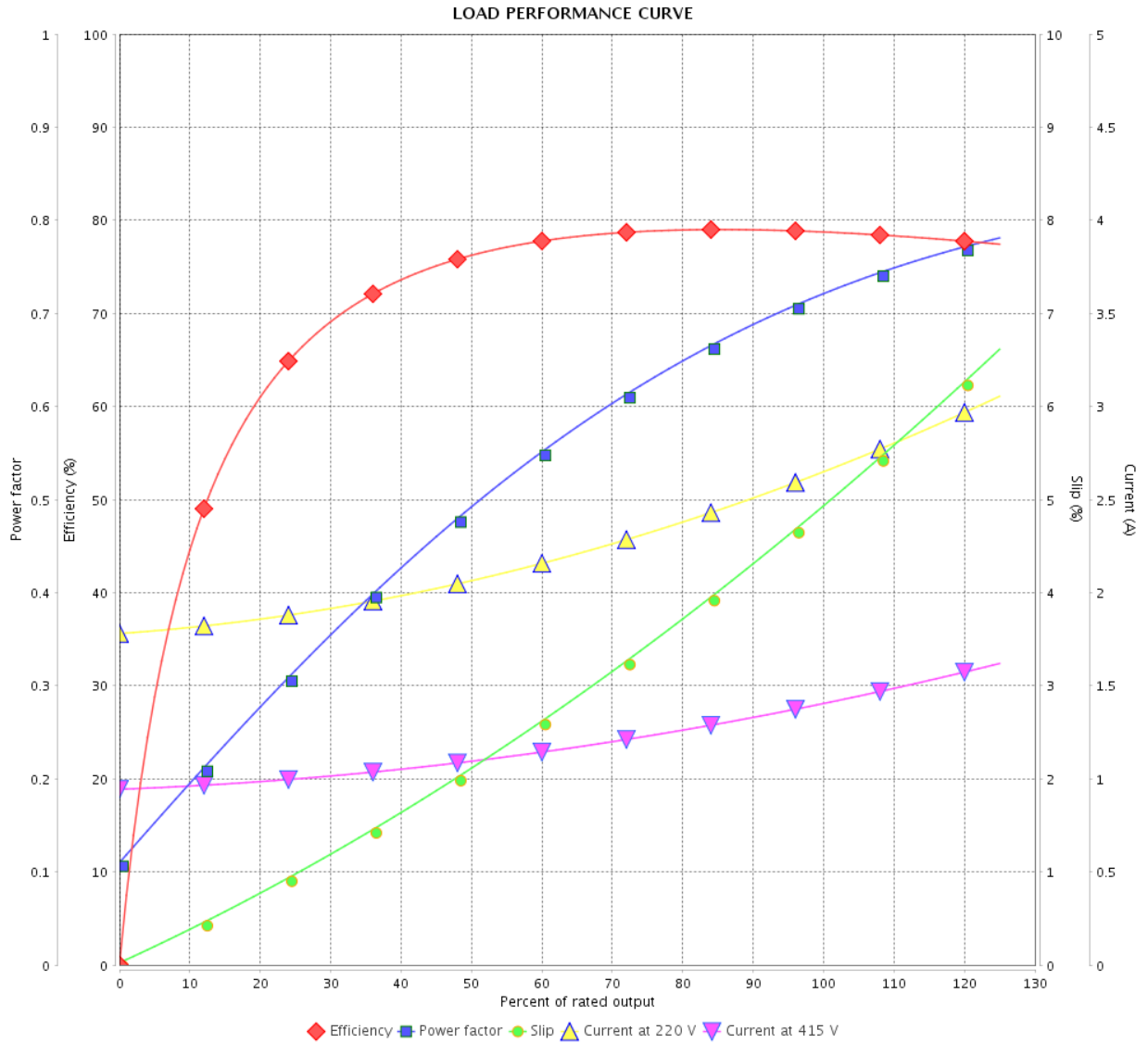

Performance : 220/415 V 50 Hz 6P

Rated current : 2.64/1.40 A
 LRC : 5.0
 Rated torque : 4.15 ft.lb
 Locked rotor torque : 200 %
 Breakdown torque : 260 %
 Rated speed : 950 rpm

Moment of inertia (J) : 0.1685 sq.ft.lb
 Duty cycle : Cont.(S1)
 Insulation class : F
 Service factor : 1.15
 Temperature rise : 80 K
 Design : A

Rev.	Changes Summary	Performed	Checked	Date
Performed by		Page		Revision
Checked by		7 / 10		
Date		11/04/2022		

THERMAL LIMIT CURVE

Three Phase Induction Motor - Squirrel Cage



Customer : _____

Product line : Premium Efficiency Three-Phase

Product code :

12809251

Catalog # :

.7512OT3E56C-S

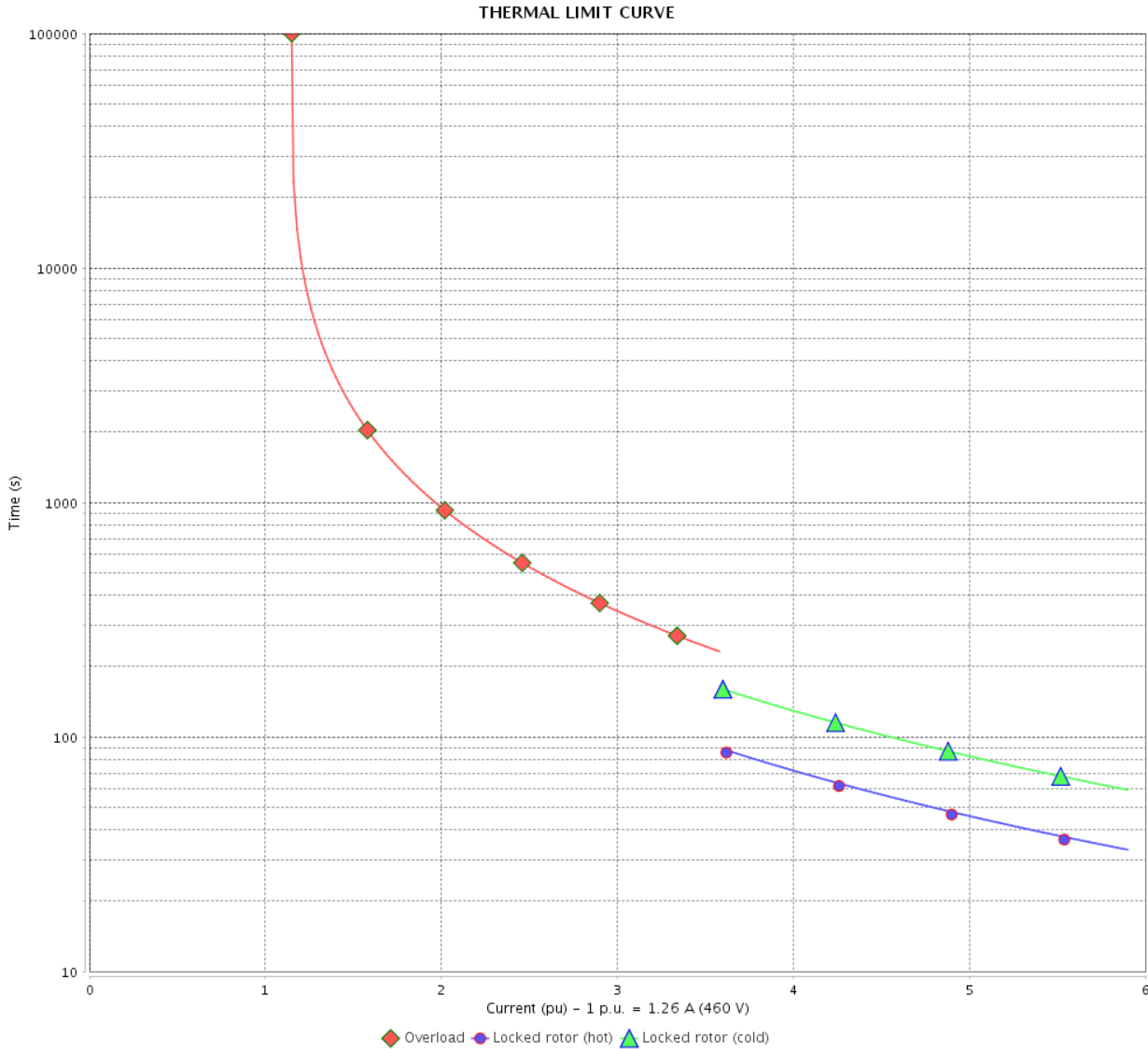

Performance : 208-230/460 V 60 Hz 6P

Rated current : 2.78-2.52/1.26 A
 LRC : 5.9
 Rated torque : 3.40 ft.lb
 Locked rotor torque : 220 %
 Breakdown torque : 280 %
 Rated speed : 1160 rpm

Moment of inertia (J) : 0.1685 sq.ft.lb
 Duty cycle : Cont.(S1)
 Insulation class : F
 Service factor :
 Temperature rise : 80 K
 Design : A

Heating constant

Cooling constant

Rev.	Changes Summary	Performed	Checked	Date
Performed by	11/04/2022	Page		Revision
Checked by		8 / 10		
Date				

THERMAL LIMIT CURVE

Three Phase Induction Motor - Squirrel Cage



Customer : _____

Product line : Premium Efficiency Three-Phase

Product code :

12809251

Catalog # :

.7512OT3E56C-S

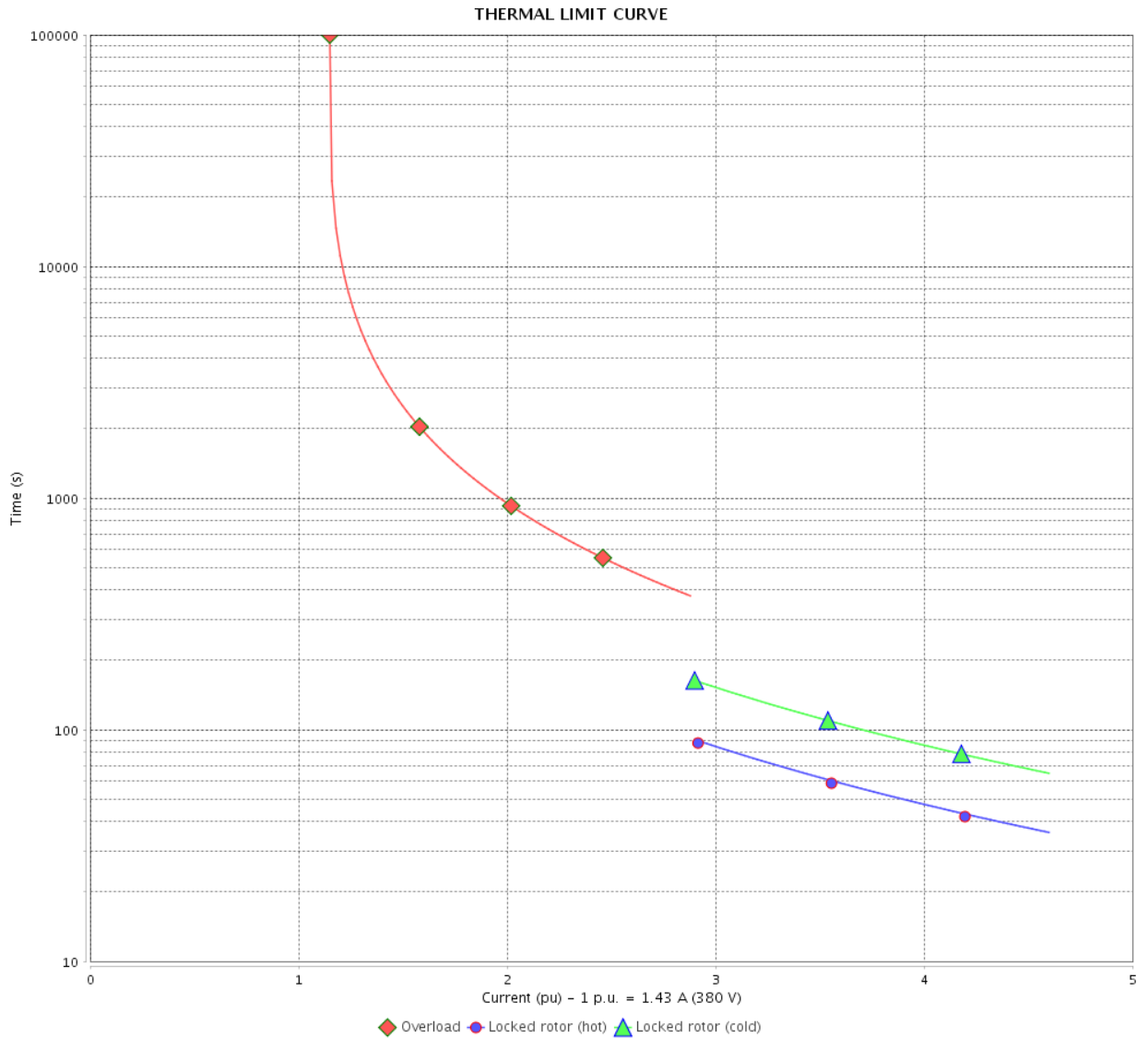

Performance : 190/380 V 50 Hz 6P

Rated current : 2.86/1.43 A
 LRC : 4.6
 Rated torque : 4.17 ft.lb
 Locked rotor torque : 170 %
 Breakdown torque : 229 %
 Rated speed : 945 rpm

Moment of inertia (J) : 0.1685 sq.ft.lb
 Duty cycle : Cont.(S1)
 Insulation class : F
 Service factor : 1.15
 Temperature rise : 80 K
 Design : A

Heating constant

Cooling constant

Rev.	Changes Summary	Performed	Checked	Date
Performed by				
Checked by				
Date				
			Page	Revision
			9 / 10	

THERMAL LIMIT CURVE

Three Phase Induction Motor - Squirrel Cage



Customer : _____

Product line : Premium Efficiency Three-Phase

Product code :

12809251

Catalog # :

.7512OT3E56C-S

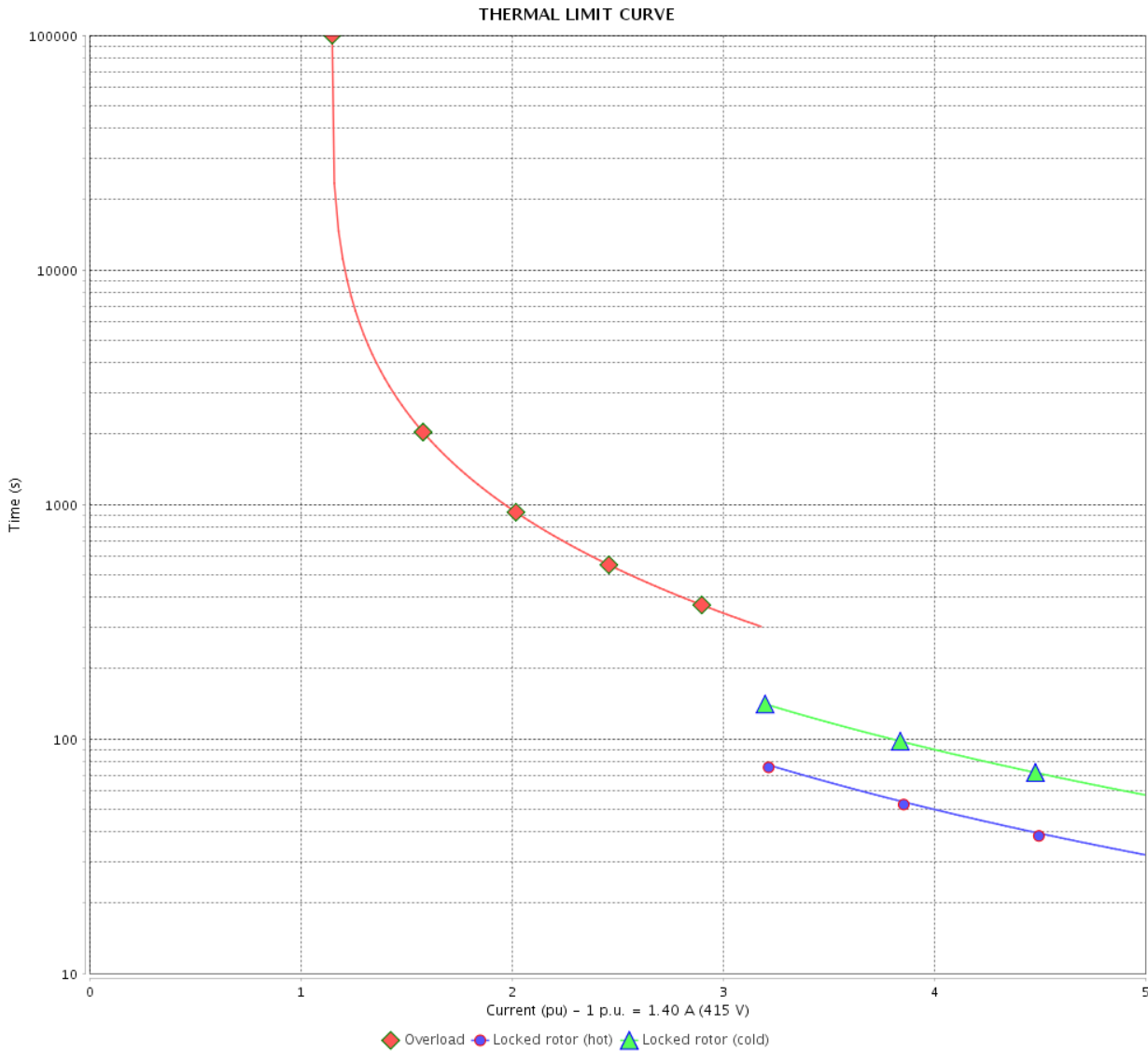

Performance : 220/415 V 50 Hz 6P

Rated current : 2.64/1.40 A
 LRC : 5.0
 Rated torque : 4.15 ft.lb
 Locked rotor torque : 200 %
 Breakdown torque : 260 %
 Rated speed : 950 rpm

Moment of inertia (J) : 0.1685 sq.ft.lb
 Duty cycle : Cont.(S1)
 Insulation class : F
 Service factor : 1.15
 Temperature rise : 80 K
 Design : A

Heating constant

Cooling constant

Rev.	Changes Summary	Performed	Checked	Date
Performed by		Page		Revision
Checked by		10 / 10		
Date		11/04/2022		

1 2 3 4 5 6

A

B

C

D

E

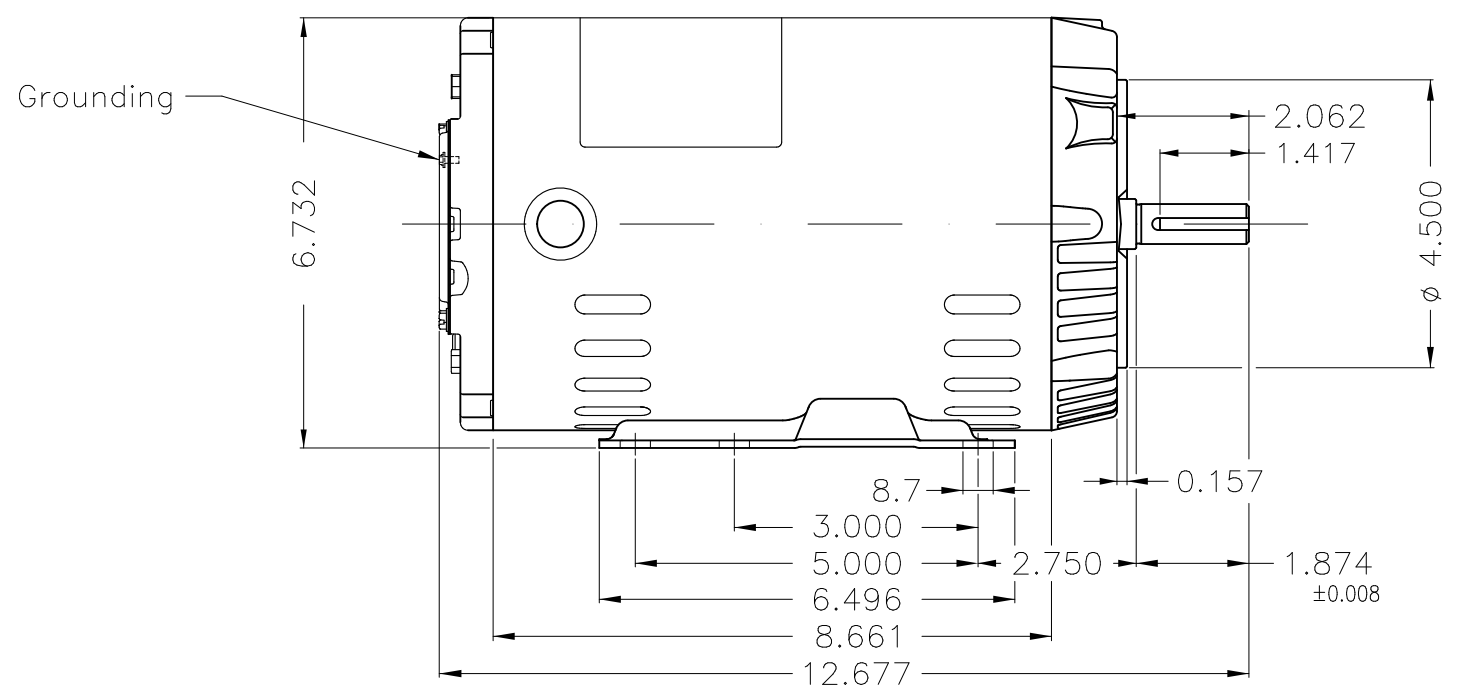
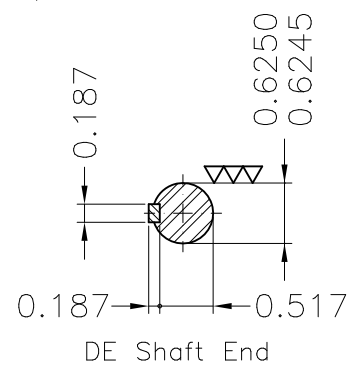
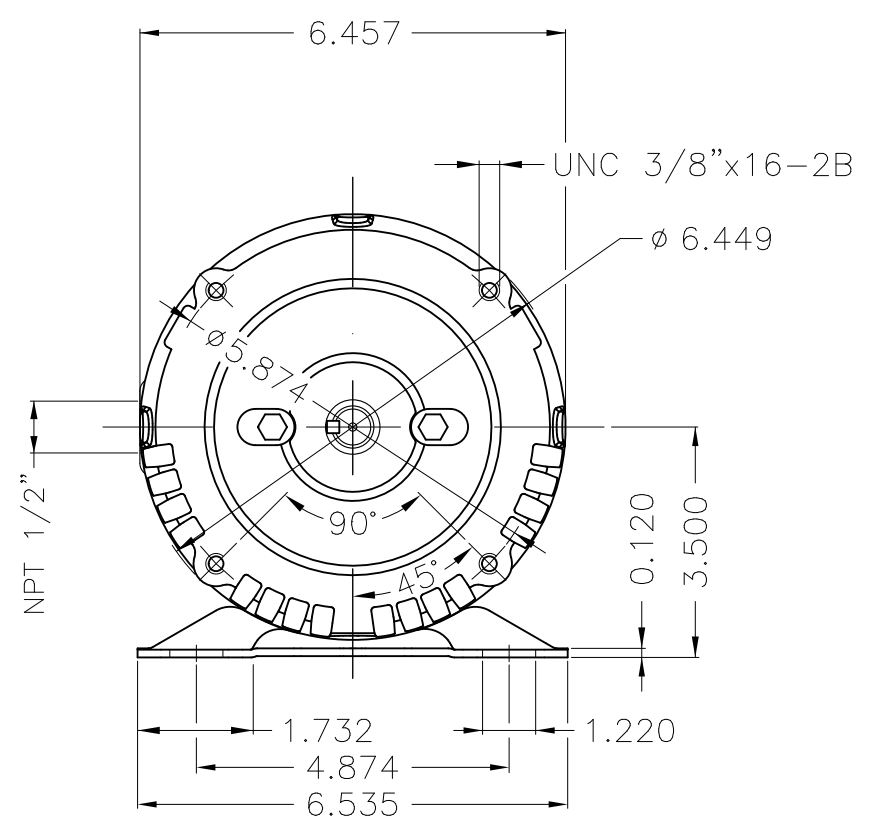

Dimensions in inches

Without coating										
Mounting F-1/B34R(D)										
ECM	LOC	SUMMARY OF MODIFICATIONS				EXECUTED	CHECKED	RELEASED	DATE	VER
EXECUTED	PIRWUSER	THREE PH. MOTOR ROLLED STEEL PREM. EFF.					PREVIEW WDD			
CHECKED		FRAME 56HC IP21 ODP								
RELEASED										
REL DT.		WMO	Jaragua do Sul	Product Engineering	SHEET	1 / 1				

0.75 HP 06 Poles 60 Hz

A

XME A3