

BALDOR® • RELIANCE 

Product Information Packet

XM14242T-5

2HP,1755RPM,3PH,60HZ,145T,3540M,XPFC,F1

| Part Detail | | | | | | | |
|-------------|--------|-------------|------------|-------------|--------|---------------|------------|
| Revision: | B | Status: | PRD/A | Change #: | | Proprietary: | No |
| Type: | AC | Elec. Spec: | 35WGG370 | CD Diagram: | CD0006 | Mfg Plant: | |
| Mech. Spec: | 35Q558 | Layout: | 35LYQ558 | Poles: | 04 | Created Date: | 04-23-2021 |
| Base: | RG | Eff. Date: | 02-14-2022 | Leads: | 3#18 | | |

| Specs | | | |
|---------------------------------|-------------------------|--------------------------------|--------------------------|
| Catalog Number: | XM14242T-5 | Inverter Code: | Inverter Duty |
| Enclosure: | XPFC | IP Rating: | NONE |
| Frame: | 145T | KVA Code: | L |
| Frame Material: | Steel | Lifting Lugs: | No Lifting Lugs |
| Output @ Frequency: | 2.000 HP @ 60 HZ | Locked Bearing Indicator: | No Locked Bearing |
| Synchronous Speed @ Frequency: | 1800 RPM @ 60 HZ | Motor Lead Quantity/Wire Size: | 3 @ 18 AWG |
| Voltage @ Frequency: | 575.0 V @ 60 HZ | Motor Lead Termination: | Flying Leads |
| XP Class and Group: | CLI GP D; CLII GP F,G | Motor Type: | X3528M |
| XP Division: | Division I | Mounting Arrangement: | F1 |
| Agency Approvals: | UR | Power Factor: | 74 |
| | CSA EEV | Product Family: | Hazardous Location Motor |
| | CSA | Pulley End Bearing Type: | Ball |
| Auxillary Box: | No Auxillary Box | Pulley Face Code: | Standard |
| Auxillary Box Lead Termination: | None | Pulley Shaft Indicator: | Standard |
| Base Indicator: | Rigid | Rodent Screen: | None |
| Bearing Grease Type: | Polyrex EM (-20F +300F) | RoHS Status: | ROHS NON-COMPLIANT |
| Blower: | None | Shaft Ground Indicator: | No Shaft Grounding |
| Constant Torque Speed Range: | 1.5 | Shaft Rotation: | Reversible |

| | | | |
|---------------------------------------|---------------------------|------------------------------------|----------------------------|
| Current @ Voltage: | 2.300 A @ 575.0 V | Shaft Slinger Indicator: | No Slinger |
| Design Code: | B | Speed Code: | Single Speed |
| Drip Cover: | No Drip Cover | Motor Standards: | NEMA |
| Duty Rating: | CONT | Starting Method: | Direct on line |
| Electrically Isolated Bearing: | Not Electrically Isolated | Thermal Device - Bearing: | None |
| Feedback Device: | NO FEEDBACK | Thermal Device - Winding: | Normally Closed Thermostat |
| Front Shaft Indicator: | None | Vibration Sensor Indicator: | No Vibration Sensor |
| Heater Indicator: | No Heater | Winding Thermal 1: | None |
| Insulation Class: | F | Winding Thermal 2: | None |
| | | XP Temp Code: | T3C |

| | | | | | | | | | | |
|-------------------------------|--------------|--------|--------------|-------|------------------|------------|-------|--|----------|----|
| Nameplate NP0887XPSLEV | | | | | | | | | | |
| NO. | | | | | | CC | 010A | | | |
| S/N | | | | | | TEMP CODE | T3C | | | |
| SPEC. | 35Q558G370G1 | | | | | INV.TYPE | PWM | | | |
| CAT.NO. | XM14242T-5 | | | | | C HP FR | 60 | | C HP TO | 90 |
| HP | 2 | | | | | CT HZ FROM | 1.5 | | CT HZ TO | 60 |
| VOLTS | 575 | | | | | VT HZ FROM | 1.5 | | VT HZ TO | 60 |
| AMPS | 2.16 | | | | | MAG CUR | 1.19 | | | |
| RPM | 1755 | | | | | MX RPM | 2700 | | | |
| HZ | 60 | PH | 3 | CL | F | NOM.EFF. | 88.5 | | | |
| SER.F. | 1.00 | DES | B | SL HZ | 1.5 | WK2 | 0.236 | | | |
| FRAME | 145T | RATING | 40C AMB-CONT | | | | | | | |
| 55C AMB AT 1.00 SF SINEWAVE | | | | | | | | | | |
| NEMA MG-1 PART 5, IP54 | | | | | 1.15 SF SINEWAVE | | | | | |
| | | | | | | | | | | |

| Parts List | | |
|---------------|--|----------|
| Part Number | Description | Quantity |
| SA392900 | SA 35Q558G370G1 | 1.000 EA |
| RA383501 | RA 35Q558G370G1 | 1.000 EA |
| 34FN3002B01 | EXTERNAL FAN, PLASTIC, .637/.639 HUB W/ | 1.000 EA |
| 35CB3001A02SP | EXPL PROOF CONDUIT BOX, 3/4"PIPE TAP LEA | 1.000 EA |
| 11XW1032G06 | 10-32 X .38, TAPTITE II, HEX WSHR SLTD U | 1.000 EA |
| HW3001B01 | BRASS CUP WASHER, FOR #10 SCREW | 1.000 EA |
| 35EP3700A01SP | FR ENDPLATE, XPFC | 1.000 EA |
| HW5100A03 | WAVY WASHER (W1543-017) | 1.000 EA |
| 35EP3701A01 | PU ENDPLATE, XPFC - 205 BRG | 1.000 EA |
| XY3118A12 | 5/16-18 HEX NUT DIRECTIONAL SERRATION | 4.000 EA |
| 35FH4005A01SP | IEC FH NO GREASER W/PRIMED | 1.000 EA |
| 51XW1032A06 | 10-32 X .38, TAPTITE II, HEX WSHR SLTD S | 3.000 EA |
| 35CB3500A01SP | CONDUIT BOX LID, MACH | 1.000 EA |
| 51XN2520A16 | SCREW, HEX WS SLT, ZN, 1/4-20 X 1.00 | 4.000 EA |
| HW2501D13 | KEY, 3/16 SQ X 1.375 | 1.000 EA |
| HA7000A01 | KEY RETAINER 7/8" DIA SHAFT | 1.000 EA |
| 85XU0407S04 | 4X1/4 U DRIVE PIN STAINLESS | 6.000 EA |
| NP0018F | ALUM UL XP CONDUIT BOX NAMEPLATE | 1.000 EA |
| HA1025A21 | WSHR,FELT .125" THK | 1.000 EA |
| MJ1000A02 | GREASE, MOBIL POLYREX EM - 124047 | 0.050 LB |
| 51XB1214A16 | 12-14X1.00 HXWSSLD SERTYB | 1.000 EA |
| MG1025G29 | WILKOFASST, 789.229, DARK CHARCOAL GRAY | 0.017 GA |
| HA3104A34 | THRUBOLT .31-18 X 11.625 | 4.000 EA |
| LB1119N | WARNING LABEL | 1.000 EA |

| Parts List (continued) | | |
|-------------------------------|---|-----------------|
| Part Number | Description | Quantity |
| LC0006 | CONNECTION LABEL | 1.000 EA |
| NP0887XPSLEV | SS XP INV UL CSA-EEV CC CL-I GP-D | 1.000 EA |
| 36PA1001 | PKG GRP, PRINT PK1017A06 | 1.000 EA |
| MN416A01 | TAG-INSTAL-MAINT no wire (2100/bx) 4/22 | 1.000 EA |

AC Induction Motor Performance Data

Record # 88082

Typical performance - not guaranteed values

| Winding: 35WGG370-R001 | | Type: 3540M | | Enclosure: XPFC | |
|-------------------------------|--------------------------|----------------------------|---|--------------------------|--|
| Nameplate Data | | | 575 V, 60 Hz: Single Voltage Motor | | |
| Rated Output (HP) | 2 | Full Load Torque | 5.99 LB-FT | | |
| Volts | 575 | Start Configuration | direct on line | | |
| Full Load Amps | 2.16 | Breakdown Torque | 27.31 LB-FT | | |
| R.P.M. | 1755 | Pull-up Torque | 11.65 LB-FT | | |
| Hz | 60 Phase | 3 | Locked-rotor Torque | 19.25 LB-FT | |
| NEMA Design Code | B KVA Code | H | Starting Current | 20.78 A | |
| Service Factor (S.F.) | | 1 | No-load Current | 1.2 A | |
| NEMA Nom. Eff. | 88.5 Power Factor | 78 | Line-line Res. @ 25°C | 10.2 Ω | |
| Rating - Duty | 40C AMB-CONT | | Temp. Rise @ Rated Load | 48°C | |
| | | | Locked-rotor Power Factor | 45.8 | |
| | | | Rotor inertia | 0.236 lb-ft ² | |

Load Characteristics 575 V, 60 Hz, 2 HP

| % of Rated Load | 25 | 50 | 75 | 100 | 125 | 150 |
|------------------------|-----------|-----------|-----------|------------|------------|------------|
| Power Factor | 36 | 56 | 70 | 77 | 82 | 85 |
| Efficiency | 81.4 | 87.5 | 89.1 | 89.1 | 88.4 | 87.3 |
| Speed | 1790 | 1781 | 1771 | 1760 | 1749 | 1736 |
| Line amperes | 1.3 | 1.52 | 1.82 | 2.19 | 2.59 | 3.04 |

Performance Graph at 575V, 60Hz, 2.0HP Typical performance - Not guaranteed values

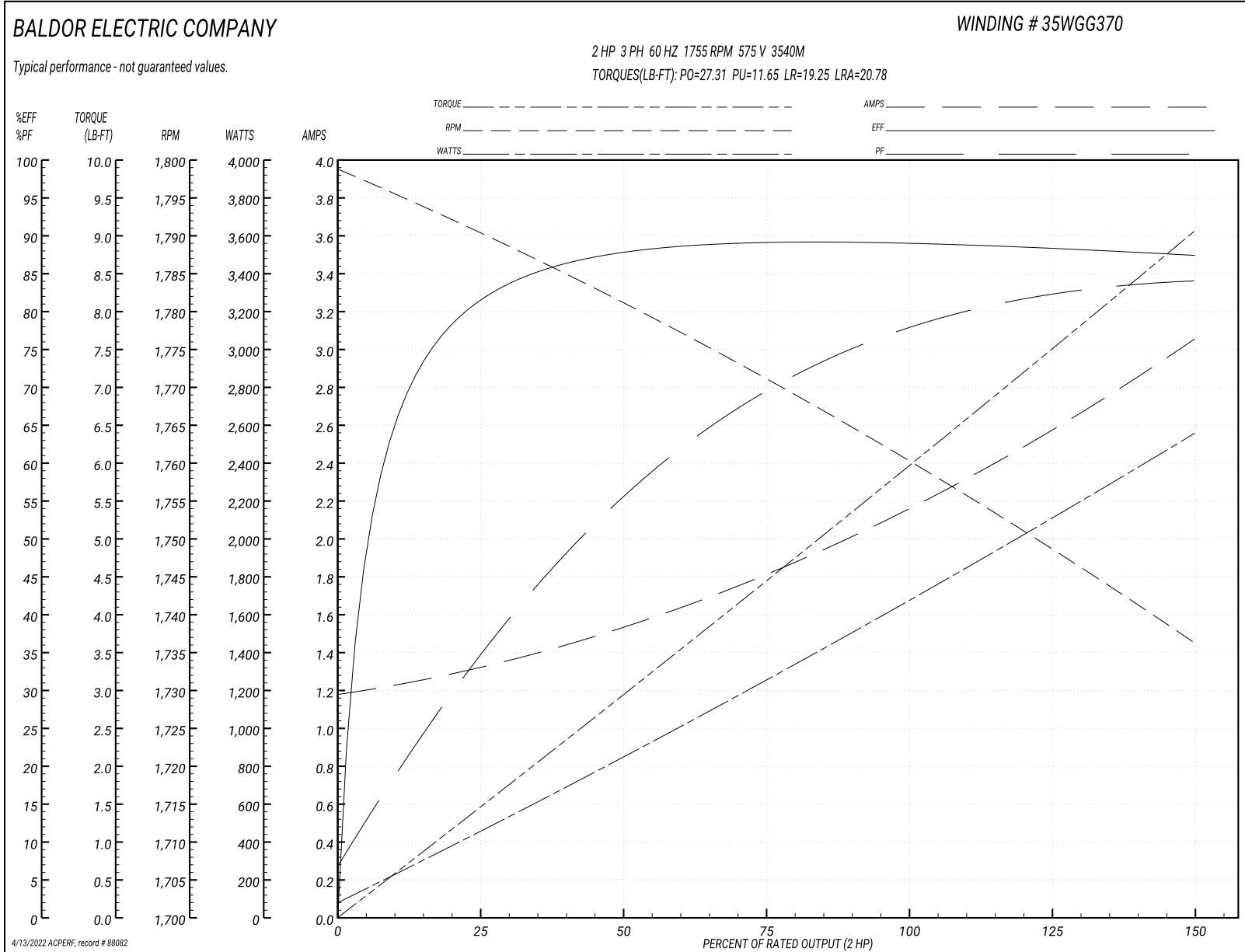

35LYQ558

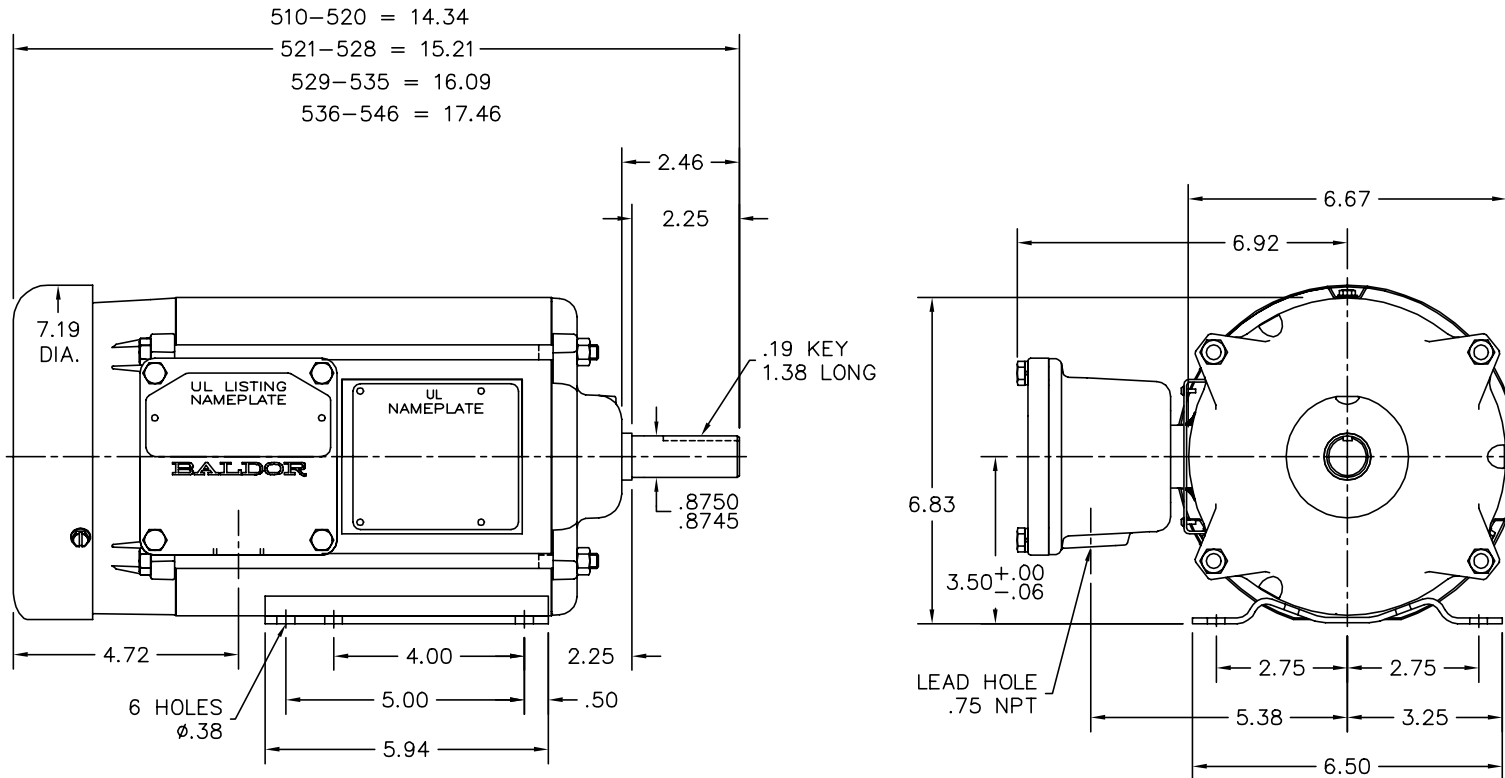

CUSTOMER IS RESPONSIBLE FOR DETERMINING THAT BALDOR'S PRODUCT WILL PERFORM SUITABLY IN THE INTENDED APPLICATION.

| | | |
|-------------------------|------------------------------|-------------------|
| REV. DESC: UPDATE PARTS | | |
| REV. LTR: A | VERSION: 01 | TDR: 000000983996 |
| FILE: \AAA\00059\703 | REVISED: 11:44:51 06/13/2016 | BY: ENBENBO |
| MTL: - | ☉ □ | |

BALDOR

HORZ 143-5T XPFC 35M CL I GP-D, CL II GP-F&G (INVERTER)

SH 1 of 1

35LYQ558

CD0006

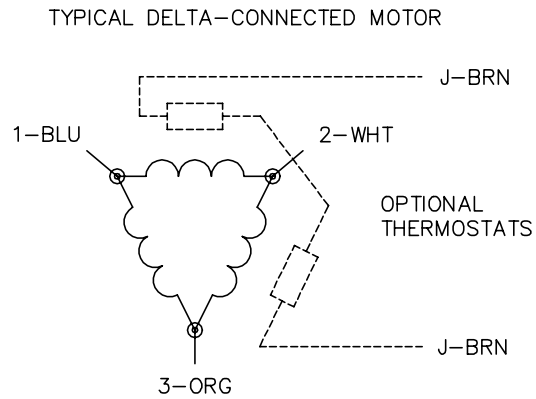
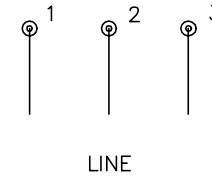
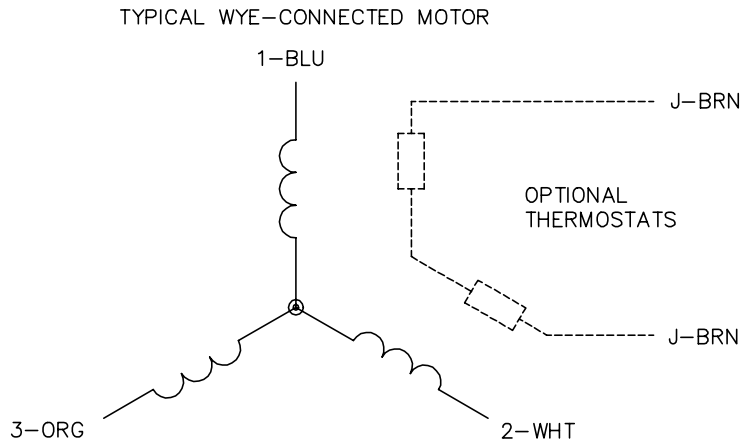

NOTES:

1. THREE LEAD MOTOR MAY BE EITHER WYE CONNECTED OR DELTA CONNECTED.
2. INTERCHANGE ANY TWO LINE LEADS TO REVERSE ROTATION.
3. OPTIONAL THERMOSTATS ARE PROVIDED WHEN SPECIFIED.
4. ACTUAL NUMBER OF INTERNAL PARALLEL CIRCUITS MAY VARY.
5. LEAD COLORS ARE OPTIONAL. LEADS MUST BE NUMBERED AS SHOWN.

CD0006

| | | |
|-----------------------------------|------------------------------|-------------------|
| REV. DESC: ADD CLASS CONN00000007 | | |
| REV. LTR: E | VERSION: 01 | TDR: 000001099922 |
| FILE: \AAA\00005\141 | REVISED: 10:24:49 02/19/2019 | BY: ENBRIRO |
| MTL: - | © □ | |

BALDOR - RELIANCE®

3PH, SV, 3 LEADS, WYE OR DELTA CONNECTED

SH 1 of 1

Marketing maintained PDF of MN416:

<http://www.baldor.com/support/Literature/Load.ashx/MN416?ManNumber=MN416>